

ROUTE NO	SECTION	COUNTY	SHEET NO.	TOTAL SHEETS
F.A.P. 793	05-00025-00-TL	MADISON	1	135
F.A.U. 9393	07-00025-01-WR			
FEDERAL AID PROJECT				
CONTRACT NO. 97352				

INDEX OF SHEETS

SHEET NO.	DESCRIPTION
1.	COVER SHEET
2.	GENERAL NOTES
3-4.	SUMMARY OF QUANTITIES
5-8.	SCHEDULE OF QUANTITIES
9-19.	TYPICAL SECTIONS
20-30.	PLAN AND PROFILE SHEETS
31-39.	TEMPORARY EROSION CONTROL PLAN
40-50.	DRAINAGE SHEETS
51-61.	RIGHT-OF-WAY PLAN
62-70.	PAVEMENT MARKING AND SIGNING PLAN
71-76.	TRAFFIC CONTROL STAGING PLAN
77-79.	TRAFFIC SIGNAL PLAN
80-82.	INTERSECTION DETAILS
83-93.	SPECIAL DETAILS
94-107.	CROSS SECTIONS (US 40)
108-135.	CROSS SECTIONS (TROY-O'FALLON ROAD)

STATE OF ILLINOIS  
DEPARTMENT OF TRANSPORTATION  
DIVISION OF HIGHWAYS  
**PLANS FOR PROPOSED  
FEDERAL AID HIGHWAY**

F.A.P. 793 (U.S. ROUTE 40)  
F.A.U. 9393 (TROY-O'FALLON ROAD)  
CITY OF TROY  
MADISON COUNTY  
SECTION 05-00025-00-TL  
SECTION 07-00025-01-WR  
PROJECT NO. CMM-5011(192)  
JOB NO. C-98-302-06

STANDARDS

280001-04	604036-02	701901-01
420001-07	604041-02	720001-01
424001-05	604086-02	720006-02
442101-07	604091-02	720016-02
442201-03	606001-04	780001-02
482001-02	606101-04	781001-03
542101-02	606201-02	805001-01
542116-02	701001-02	814001-02
542301-02	701006-03	814006-02
542401-01	701011-02	873001-02
602301-02	701201-03	877001-04
602306-02	701301-03	878001-07
602401-02	701306-02	880006-01
602601-02	701311-03	886001-01
602701-02	701326-03	886006-01
604006-04	701801-04	

SCALES UNLESS OTHERWISE NOTED  
 PLAN PROFILE HORIZ. 1"=20'  
 PROFILE VERT. 1"=20'  
 CROSS SECTIONS 1"=5' HORIZ. 1"=5' VERT. 1"=2' VERT.

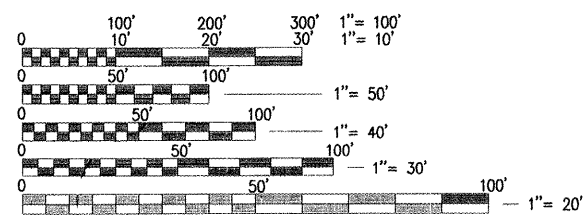
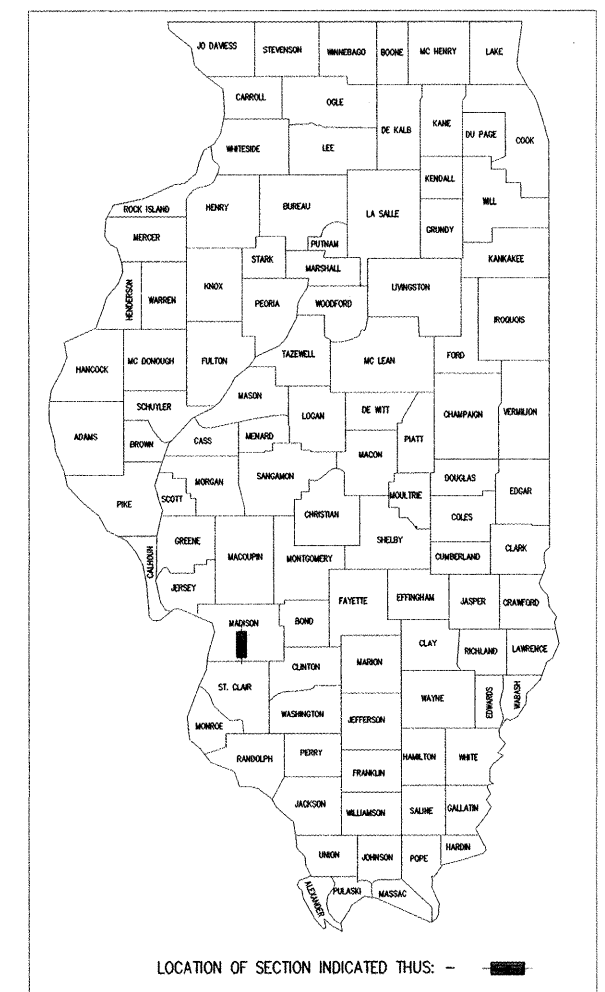

FULL SIZE PLANS HAVE BEEN PREPARED USING STANDARD ENGINEERING SCALES, REDUCED SIZED PLANS WILL NOT CONFORM TO STANDARD SCALES, IN MAKING MEASUREMENTS ON REDUCED PLANS, THE ABOVE SCALES MAY BE USED.

F.A.P. ROUTE 793 DESIGN DESIGNATION	F.A.U. ROUTE 9393 DESIGN DESIGNATION
ROADWAY CLASSIFICATION = PRINCIPLE ARTERIAL	ROADWAY CLASSIFICATION = MINOR ARTERIAL
DESIGN SPEED = 45 M.P.H.	DESIGN SPEED = 45 M.P.H.
CURRENT TRAFFIC (ADT) = 12,000	CURRENT TRAFFIC (ADT) = 11,500
DESIGN TRAFFIC (ADT) = 14,000	DESIGN TRAFFIC (ADT) = 13,300

J.U.L.I.E.  
JOINT UTILITY LOCATION INFORMATION FOR EXCAVATION  
1-800-892-0123

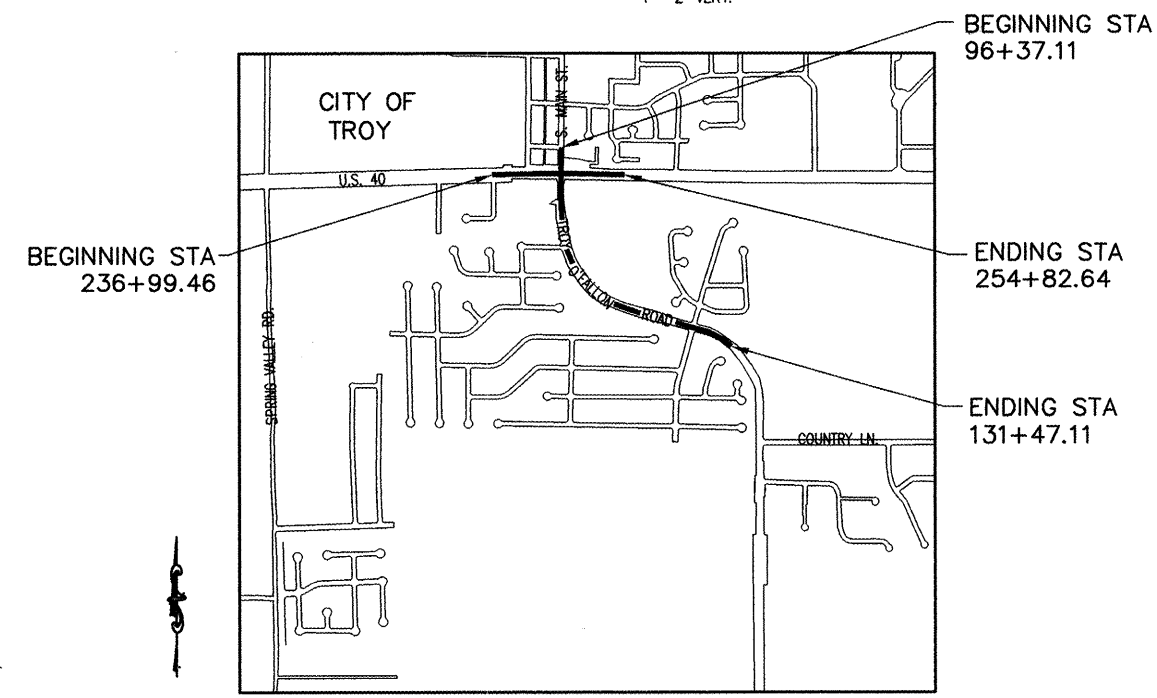

LOCATION MAP

GROSS LENGTH (US 40)= 1,783.18' (0.338 MILES)  
 GROSS LENGTH (SOUTH MAIN ST./TROY-O'FALLON RD.)= 3,510.00' (0.665 MILES)  
 TOTAL LENGTH= 5,293.18' (1.002 MILES)

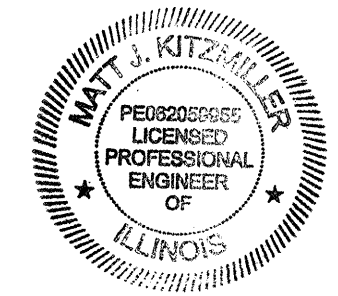

APPROVED: *[Signature]* MAYOR OF TROY

PASSED: 11/10 2008  
*[Signature]* DISTRICT 8 ENGINEER OF LOCAL ROADS

RELEASING FOR BID BASED ON LIMITED REVIEW: 11/10 2008  
*[Signature]* MARY C. LAMIE, P.E.  
 DEPUTY DIRECTOR OF HIGHWAYS  
 REGION FIVE ENGINEER

STATE OF ILLINOIS  
DEPARTMENT OF TRANSPORTATION

*[Signature]* MATT J. KITZMILLER, P.E. NO. 062-059955 DATE 11/7/08  
 EXPIRES NOVEMBER 30, 2009



THOUVENOT, WADE & MOERCHEN, INC.

P:\050162D\dwg\050162CD\VER.dwg 4/15/2008 3:15:35 PM CDT