

FILE NO.	SECTION	COUNTY	TOTAL SHEETS	SHEET NO.
793 9393	05-00025-00-TL 07-00025-01-WR	MADISON	135	80

STA. TO STA.
INTERSECTION WARPING DETAILS

CONTRACT NO. 97352

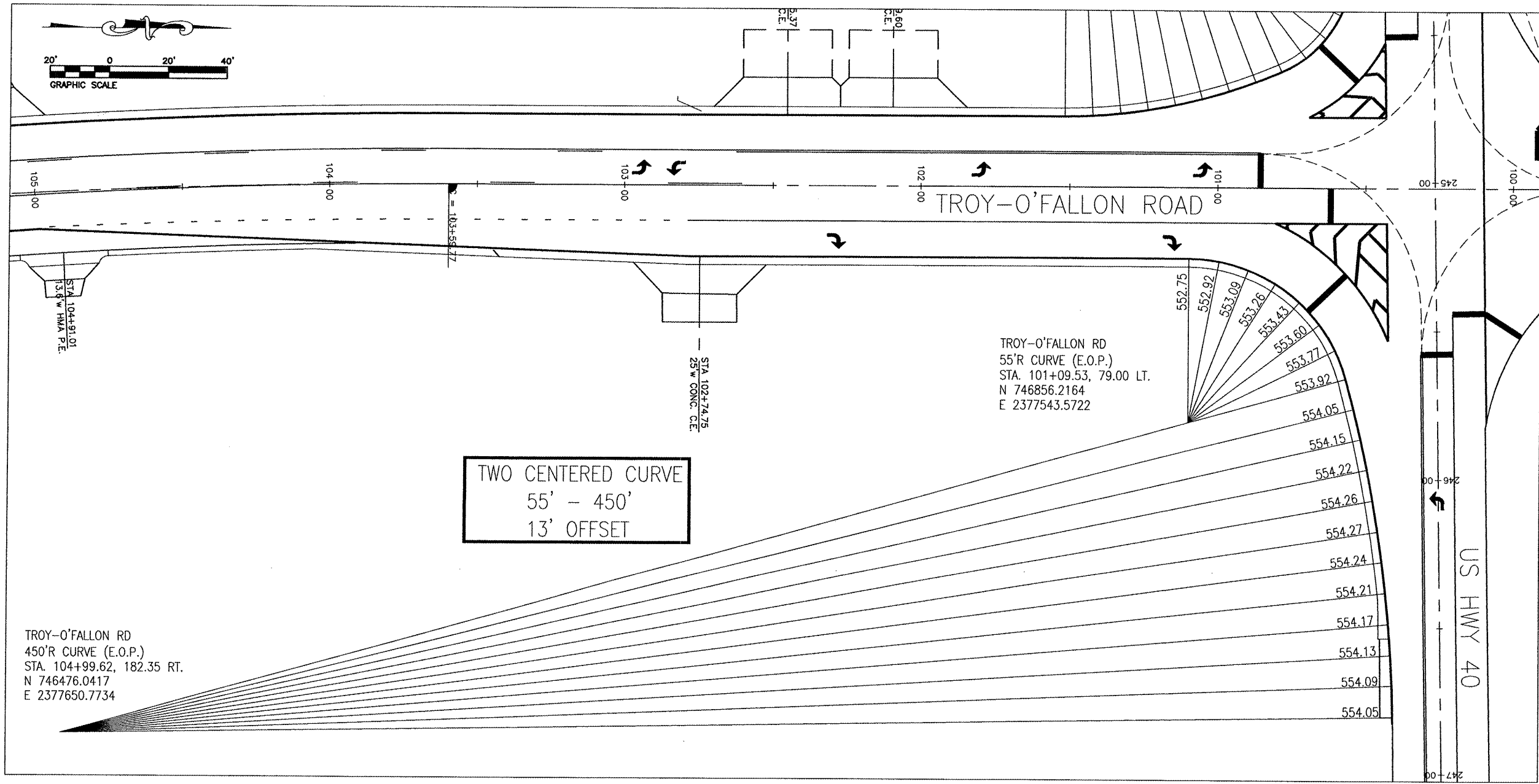

TWO CENTERED CURVE
55' - 450'
13' OFFSET

TROY-O'FALLON RD
450'R CURVE (E.O.P.)
STA. 104+99.62, 182.35 RT.
N 746476.0417
E 2377650.7734

TROY-O'FALLON RD
55'R CURVE (E.O.P.)
STA. 101+09.53, 79.00 LT.
N 746856.2164
E 2377543.5722

NOTE: ALL ELEVATIONS
ARE GIVEN AT THE
EDGE OF PAVEMENT

REVISIONS	
NAME	DATE

INTERSECTION WARPING
DETAILS

US 40 & TROY-O'FALLON ROAD
IMPROVEMENTS
CITY OF TROY
MADISON COUNTY, ILLINOIS

PLANNING AND DESIGN SERVICES, INC. 7/1/2008 5:16:28 PM