

INDEX OF SHEETS

<u>SHEET NO.</u>	<u>ITEM</u>
1	COVER SHEET
2	INDEX OF SHEETS, HIGHWAY STANDARDS AND GENERAL NOTES
3-4	SUMMARY OF QUANTITIES
5-7	TYPICAL CROSS-SECTIONS
8	SCHEDULE OF QUANTITIES
9-24	PLAN SHEETS
25-32	DETAILS

GENERAL NOTES

- TRAFFIC SHALL NOT DRIVE ON MILLED SURFACE.
- GROOVING FOR PAVEMENT MARKING LETTERS AND SYMBOLS SHALL BE DONE IN THE SHAPE OF THE PROPOSED MARKINGS.
- WHEN APPLYING SHORT TERM PAVEMENT MARKINGS, TEMPORARY TAPE SHALL BE USED ON THE SURFACE AND PAINT SHALL BE US THE MILLED AND BINDER SURFACES.
- REQUIRED SEQUENCE OF OPERATIONS:
- SET UP TRAFFIC CONTROL TO CLOSE ONE LANE.

MILL TRAFFIC LANE AND SHOULDER.

PLACE THE LONGITUDINAL JOINT SEALANT HALF-WIDTH AT THE CENTERLINE.

PLACE THE SURFACE COURSE IN THE MILLED LANE AND ADJACENT SHOULDER.
BEFORE DOING THE SAME ON THE OTHER LANE AND SHOULDER
- THE FOLLOWING RATES OF APPLICATION HAVE BEEN USED IN THE CALCULATION OF PLAN QUANTITIES:
- BITUMINOUS MATERIALS (TACK COAT)

0.05 LBS/SQFT

HOT-MIX ASPHALT (OTHER THAN STONE MATRIX ASPHALT)

112 LBS/SQYD/INCH

HOT-MIX ASPHALT (STONE MATRIX ASPHALT)

130 LBS/SQ YD/INCH

THE FOLLOWING STANDARDS ARE A PART OF THESE PLANS AND ARE INCLUDED FOLLOWING THE LAST NUMBERED SHEET OF THE PLANS.

<u>STD. NO.</u>	<u>DESCRIPTION</u>
000001-09	STANDARD SYMBOLS, ABBREVIATIONS, AND PATTERNS
001006	DECIMAL OF AN INCH AND OF A FOOT
642001-03	SHOULDER RUMBLE STRIPS, 16 IN
701101-05	OFF-RD OPERATIONS, MULTILANE, 15' (4.5 M) TO 24" (600 MM) FROM PAVEMENT EDGE
701106-02	OFF-RD OPERATIONS, MULTILANE, MORE THAN 15' (4.5 M) AWAY
701400-12	APPROACH TO LANE CLOSURE, FREEWAY/EXPRESSWAY
701401-13	LANE CLOSURE, FREEWAY/EXPRESSWAY
701406-13	LANE CLOSURE, FREEWAY/EXPRESSWAY, DAY OPERATIONS ONLY
701411-09	LANE CLOSURE, MULTILANE, AT ENTRANCE OR EXIT RAMP, FOR SPEEDS ≥ 45 MPH
701456-05	PARTIAL EXIT RAMP CLOSURE, FREEWAY/EXPRESSWAY
701901-11	TRAFFIC CONTROL DEVICES
780001-05	TYPICAL PAVEMENT MARKINGS
781001-04	TYPICAL APPLICATIONS RAISED REFLECTIVE PAVEMENT MARKERS
442201-04	CLASS C AND D PATCHES
701451-05	RAMP CLOSURE FREEWAY/EXPRESSWAY

THE FOLLOWING MIXTURE REQUIREMENTS ARE APPLICABLE TO THIS PROJECT:

LOCATION(S)	MIXTURE USE(S)	PG	DESIGN AIR VOIDS	MIXTURE COMPOSITION	FRICTION AGGREGATE	MIXTURE WEIGHT	QUALITY MANAGEMENT PROGRAM	SUBLOT SIZE	MATERIAL TRANSFER DEVICE (REQUIRED?)
MAINLINE	POLYMERIZED HOT-MIX ASPHALT SURFACE COURSE, STONE MATRIX ASPHALT, IL-12.5, MIX "E", N80	SBS PG 76-22	4.0% @ N=80	IL - 12.5	MIXTURE E	N80	PFP	1000	YES
SHOULDERS	HOT-MIX ASPHALT SURFACE COURSE, IL-9.5, MIX "C", N70	PG 64-22	4.0% @ N=90	IL - 9.5	MIXTURE C	N70	QC/QA	3000	N/A
RAMPS	POLYMERIZED HOT-MIX ASPHALT SURFACE COURSE, IL-9.5, MIX "D", N90	PG 70-22	4.0% @ N=90	IL - 9.5	MIXTURE D	N90	QC/QA	3000	N/A

REV - MS

MODEL: Index of Sheets [Sheet]
FILE NAME: c:\pwworking\road\und\hd0910589\0774C61-shh-gennote.dgn

	USER NAME = lvi,lund	DESIGNED -	REVISED -	STATE OF ILLINOIS DEPARTMENT OF TRANSPORTATION	INDEX OF SHEETS			F.A.I RTE.	SECTION	COUNTY	TOTAL SHEETS	SHEET NO.
		DRAWN -	REVISED -					57	(25-6-1)RS-9 & (13-1)RS-3	*	32	2
		CHECKED -	REVISED -					CONTRACT NO. 74C61				
	PLOT DATE = 8/28/2025	DATE -	REVISED -		SCALE:	SHEET 1	OF 1 SHEETS	STA.	TO STA.	ILLINOIS FED. AID PROJECT		

*EFFINGHAM,CLAY

90% FED
10% STATE

CODE NO.	ITEM	UNIT	TOTAL QUANTITY	CLAY	EFFINGHAM
				ROADWAY	ROADWAY
				0005 RURAL	0005 RURAL
40600290	BITUMINOUS MATERIALS (TACK COAT)	POUND	51583	2004	49579
40600372	LONGITUDINAL JOINT SEALANT, HALF-WIDTH	FOOT	91209	3340	87869
40600405	MATERIAL TRANSFER DEVICE	TON	15506	579	14927
40604064	HOT-MX ASPHALT SURFACE COURSE, IL-9.5, MIX "D", N90	TON	840	0	840
40605034	POLYMERIZED HOT-MIX ASPHALT SURFACE COURSE, STONE MATRIX ASPHALT, 12.5, MIX "E", N80	TON	14666	579	14087
44000157	HOT-MX ASPHALT SURFACE REMOVAL, 2"	SQ YD	200790	7422	193368
44200565	CLASS A PATCHES, TYPE II, 11 INCH	SQ YD	48	24	24
44200571	CLASS A PATCHES, TYPE IV, 11 INCH	SQ YD	95	0	95
44200577	CLASS A PATCHES, TYPE II, 12 INCH	SQ YD	72	0	72
44200581	CLASS A PATCHES, TYPE III, 12 INCH	SQ YD	40	0	40
44200583	CLASS A PATCHES, TYPE IV, 12 INCH	SQ YD	74	0	74
44213000	PATCHING REINFORCEMENT	SQ YD	329	24	305
44213200	SAW CUTS	FOOT	1020	108	912
44213204	TIE BARS 3/4"	EACH	35	0	35

90% FED
10% STATE

CODE NO.	ITEM	UNIT	TOTAL QUANTITY	CLAY	EFFINGHAM
				ROADWAY	ROADWAY
				0005 RURAL	0005 RURAL
48102100	AGGREGATE WEDGE SHOULDER, TYPE B	TON	1656	71	1585
48203100	HOT-MIX ASPHALT SHOULDERS	TON	8632	333	8299
64200116	SHOULDER RUMBLE STRIPS, 16 INCH	FOOT	79151	3340	75811
67000400	ENGINEER'S FIELD OFFICE, TYPE A	CAL MO	3	0.1	2.9
67000600	ENGINEER'S FIELD LABORATORY	CAL MO	3	0.1	2.9
67100100	MOBILIZATION	L SUM	1	0.1	0.9
70100420	TRAFFIC CONTROL AND PROTECTION, STANDARD 701411	EACH	2	0	2
70100700	TRAFFIC CONTROL AND PROTECTION, STANDARD 701406	L SUM	1	0.1	0.9
70100800	TRAFFIC CONTROL AND PROTECTION, STANDARD 701401	L SUM	1	0.1	0.9
70100825	TRAFFIC CONTROL AND PROTECTION, STANDARD 701456	L SUM	1	0.1	0.9
70100820	TRAFFIC CONTROL AND PROTECTION, STANDARD 701451	L SUM	1	0	1
70107025	CHANGEABLE MESSAGE SIGN	CAL DA	14	14	0
70300100	SHORT TERM PAVEMENT MARKING	FOOT	7620	301	7319
70300150	SHORT TERM PAVEMENT MARKING REMOVAL	SQ FT	2540	100	2440
70300211	TEMPORARY PAVEMENT MARKING LETTERS AND SYMBOLS - PAINT	SQ FT	32	0	32
70300241	TEMPORARY PAVEMENT MARKING - LINE 6"- PAINT	FOOT	94527	3757	90770

MODEL: Summary of Quantities [Sheet]
FILE NAME: c:\paw\work\paw\illinois.gov\stacy.anderson@illinois.gov\10910589D774C61-aitt-sq.dgn

REV - MS

F.A.I RTE.	SECTION	COUNTY	TOTAL SHEETS	SHEET NO.
57	(25-6-1)RS-9 & (13-1)RS-3	*	32	3
CONTRACT NO. 74C61				
ILLINOIS FED. AID PROJECT				

STATE OF ILLINOIS
DEPARTMENT OF TRANSPORTATION

SUMMARY OF QUANTITIES

SCALE: SHEET 1 OF 2 SHEETS STA. TO STA.

USER NAME = stacy.anderson	DESIGNED -	REVISED -
	DRAWN -	REVISED -
	CHECKED -	REVISED -
PLOT DATE = 11/7/2025	DATE -	REVISED -

*EFFINGHAM,CLAY

MODEL: Summary of Quantities-1 [Sheet]
FILE NAME: c:\pva_work\pva\illinois.gov\stacy.anderson@illinois.gov\74C61-shl-sq.dgn

				90% FED 10% STATE	
				CLAY	EFFINGHAM
CODE NO.	ITEM	UNIT	TOTAL QUANTITY	ROADWAY	ROADWAY
				0005	0005
				RURAL	RURAL
70300251	TEMPORARY PAVEMENT MARKING - LINE 8"- PAINT	FOOT	2339	0	2339
70300261	TEMPORARY PAVEMENT MARKING - LINE 12"- PAINT	FOOT	64	0	64
70300281	TEMPORARY PAVEMENT MARKING - LINE 24"- PAINT	FOOT	38	0	38
* 78000100	THERMOPLASTIC PAVEMENT MARKING - LETTERS AND SYMBOLS	SQ FT	32	0	32
* 78000400	THERMOPLASTIC PAVEMENT MARKING - LINE 6"	FOOT	84167	3340	80827
* 78000500	THERMOPLASTIC PAVEMENT MARKING - LINE 8"	FOOT	2339	0	2339
* 78000600	THERMOPLASTIC PAVEMENT MARKING - LINE 12"	FOOT	64	0	64
* 78000650	THERMOPLASTIC PAVEMENT MARKING - LINE 24"	FOOT	38	0	38
* 78004630	PREFORMED PLASTIC PAVEMENT MARKING, TYPE D - STANDARD - LINE 6"	FOOT	10361	417	9944
* 78011000	GROOVING FOR RECESSED PAVEMENT MARKING, LETTERS AND SYMBOLS	SQ FT	32	0	32
* 78011035	GROOVING FOR RECESSED PAVEMENT MARKING 7"	FOOT	84167	3340	80827
* 78011045	GROOVING FOR RECESSED PAVEMENT MARKING 9"	FOOT	2339	0	2339
* 78011065	GROOVING FOR RECESSED PAVEMENT MARKING 13"	FOOT	64	0	64
* 78011125	GROOVING FOR RECESSED PAVEMENT MARKING 25"	FOOT	38	0	38

* SPECIALTY ITEM

				90% FED 10% STATE	
				CLAY	EFFINGHAM
CODE NO.	ITEM	UNIT	TOTAL QUANTITY	ROADWAY	ROADWAY
				0005	0005
				RURAL	RURAL
* 78100100	RAISED REFLECTIVE PAVEMENT MARKER	EACH	1067	42	1025
78300200	RAISED REFLECTIVE PAVEMENT MARKER REMOVAL	EACH	1067	42	1025
78300202	PAVEMENT MARKING REMOVAL - WATER BLASTING	SQ FT	48963	1852	47111

	USER NAME = stacy.anderson	DESIGNED -	REVISED -	STATE OF ILLINOIS DEPARTMENT OF TRANSPORTATION	SUMMARY OF QUANTITIES			F.A.I RTE.	SECTION	COUNTY	TOTAL SHEETS	SHEET NO.
		DRAWN -	REVISED -					57	(25-6-1)RS-9 & (13-1)RS-3	*	32	4
		CHECKED -	REVISED -					CONTRACT NO. 74C61				
	PLOT DATE = 11/7/2025	DATE -	REVISED -		SCALE:	SHEET 2	OF 2	SHEETS	STA.	TO STA.	ILLINOIS FED. AID PROJECT	

TYPICAL
NORTHBOUND LANE ONLY

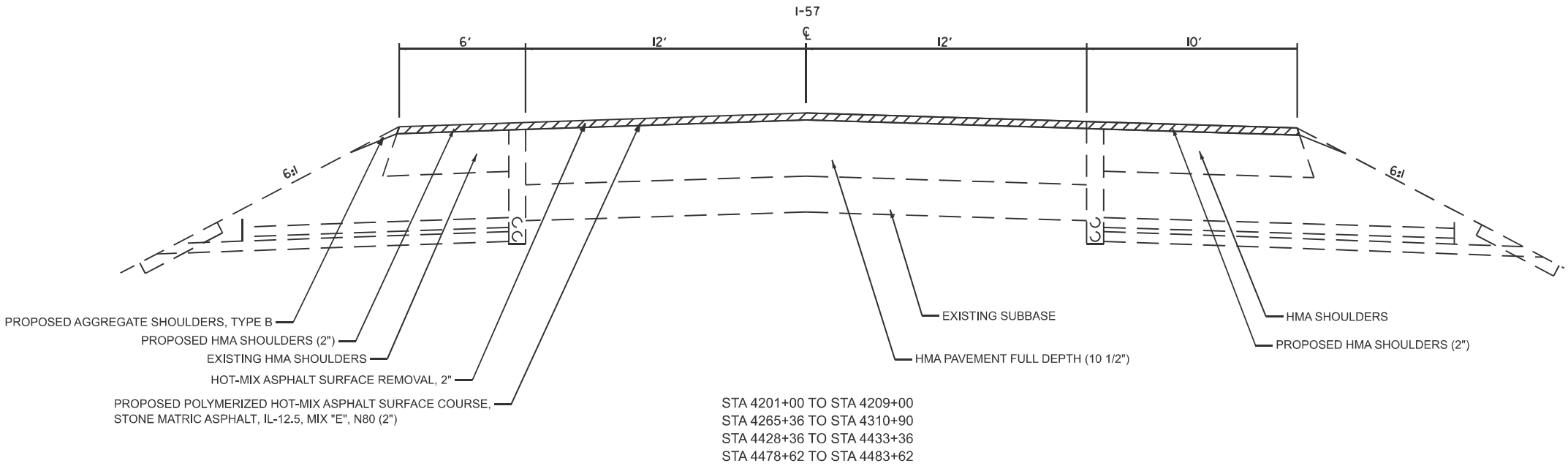
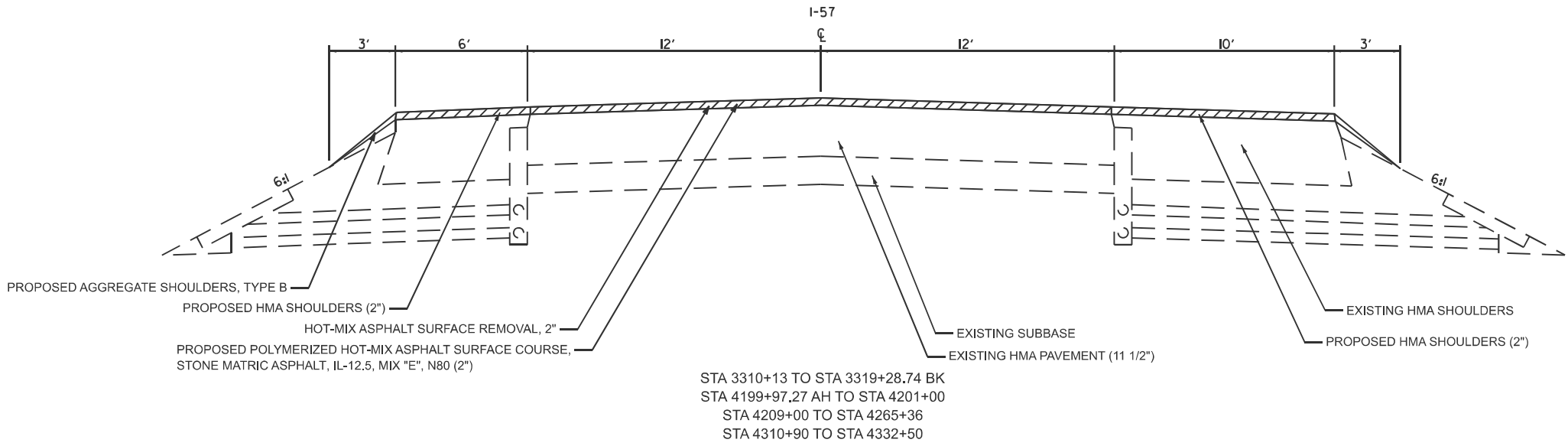

NOTE: TYPICALS NOT TO SCALE

MODEL: Typical 1 [Sheet]
FILE NAME: c:\paw\work\wiscot\lund\dd910589\DD74C61-shh-typicals.dgn

USER NAME	= levi.lund	DESIGNED	-	REVISED	-
		DRAWN	-	REVISED	-
		CHECKED	-	REVISED	-
PLOT DATE	= 9/2/2025	DATE	-	REVISED	-

STATE OF ILLINOIS
DEPARTMENT OF TRANSPORTATION

TYPICAL CROSS SECTIONS

SCALE: SHEET 1 OF 3 SHEETS STA. TO STA.

F.A.I RTE.	SECTION	COUNTY	TOTAL SHEETS	SHEET NO.
57	(25-6-1)RS-9 & (13-1)RS-3	*	32	5
CONTRACT NO. 74C61				
ILLINOIS FED. AID PROJECT				

*EFFINGHAM, CLAY

TYPICAL
NORTHBOUND LANE ONLY

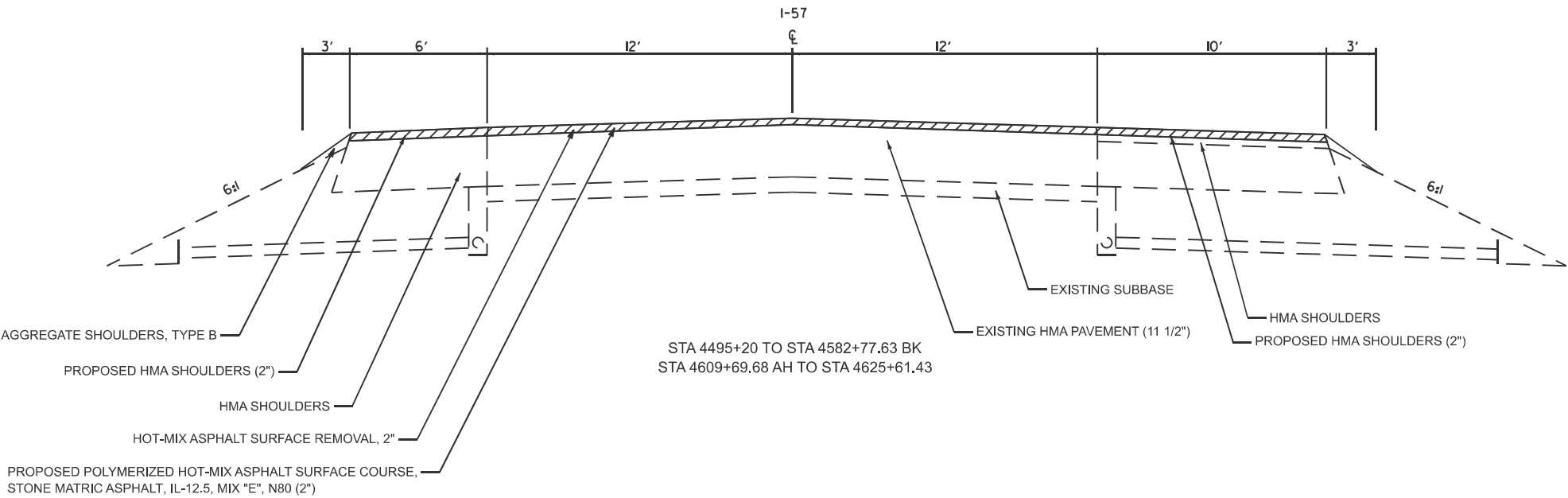
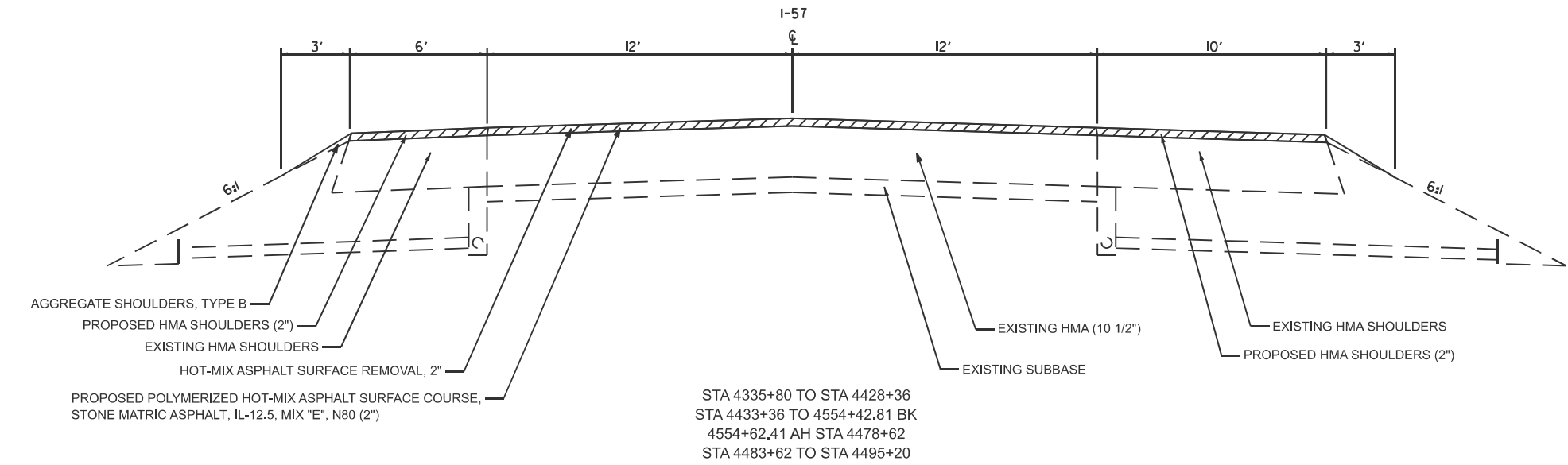

NOTE: TYPICALS NOT TO SCALE

MODEL: Typical 2 (Sheet)
FILE NAME: c:\paw\work\work\lund\ld0910589\ID74C61-ahh-typicals.dgn

USER NAME	= levi.lund	DESIGNED	-	REVISED	-
		DRAWN	-	REVISED	-
		CHECKED	-	REVISED	-
PLOT DATE	= 10/2/2025	DATE	-	REVISED	-

STATE OF ILLINOIS
DEPARTMENT OF TRANSPORTATION

TYPICAL CROSS SECTIONS

SCALE: SHEET 2 OF 3 SHEETS STA. TO STA.

F.A.I RTE.	SECTION	COUNTY	TOTAL SHEETS	SHEET NO.
57	(25-6-1)RS-9 & (13-1)RS-3	*	32	6
CONTRACT NO. 74C61				
ILLINOIS FED. AID PROJECT				

*EFFINGHAM, CLAY

TYPICAL

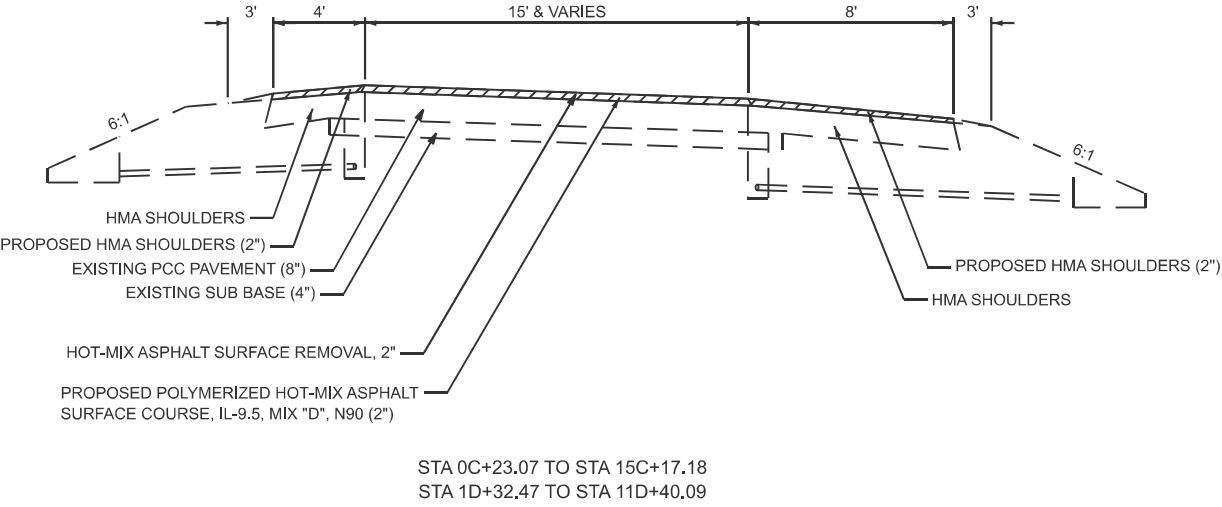

NOTE: TYPICALS NOT TO SCALE

MODEL: Typical 3 (Sheet)
FILE NAME: c:\p\work\wiscott\lund\0910589\074C61-shh-typicals.dgn

	USER NAME = levi.lund	DESIGNED -	REVISED -	STATE OF ILLINOIS DEPARTMENT OF TRANSPORTATION	TYPICAL CROSS SECTIONS			F.A.I RTE.	SECTION	COUNTY	TOTAL SHEETS	SHEET NO.
		DRAWN -	REVISED -					57	(25-6-1)RS-9 & (13-1)RS-3	*	32	7
		CHECKED -	REVISED -					CONTRACT NO. 74C61				
	PLOT DATE = 10/2/2025	DATE -	REVISED -		SCALE:	SHEET 3	OF 3 SHEETS	STA.	TO STA.	ILLINOIS FED. AID PROJECT		

MODEL: Schedule [Sheet]
FILE NAME: c:\paw_work\workitallund\dd0910589\DD74C61-shtschedule.dgn

PAVING SCHEDULE											
STATION	TO	STATION	LENGTH	BITUMINOUS MATERIALS (TACK COAT)	LONGITUDINAL JOINT SEALANT, HALF WIDTH	HOT-MIX ASPHALT SHOULDERS	POLYMERIZED HOT-MIX ASPHALT SURFACE COURSE, IL 9.5, MIX "D" N90	POLYMERIZED HOT-MIX ASPHALT SURFACE COURSE, STONE MATRIX,IL 12.5, MIX "E" N80	HOT - MIX ASPHALT SURFACE REMOVAL, 2"	AGGREGATE WEDGE SHOULDER, TYPE B	SHOULDER RYMBLE STRIPS, 16 INCH
NORTHBOUND			(FOOT)	(POUND)	(FOOT)	(TON)	(TON)	(TON)	(SQ YD)	(TON)	(EACH)
3310+13.00		3319+28.74	915.7	1098.9	1831.5	182.3		317.5	4070.0	39.1	1831.5
3319+28.74		4199+97.27	STATION EQUATION								
4199+97.27		4268+65.75	6868.5	8242.2	13737.0	1367.6		2381.1	30526.6	293.3	13737.0
4268+65.75		4270+90.08	STRUCTURE OMISSION								
4270+90.08		4305+99.41	3509.3	4211.2	7018.7	698.8		1216.6	15597.0	121.5	6355.6
RAMP D			1007.6	1358.9	2748.0	231.6	384.0		5499.8		
4305+99.41		4307+57.91	STRUCTURE OMISSION								
RAMP C			1494.1	1760.6	3852.0	358.8	455.5		7270.5		
4307+57.91		4554+42.81	24684.9	29621.9	49369.8	4915.0		8557.4	109710.7	1013.3	48409.8
4554+42.81		4554+62.41	STATION EQUATION								
4554+62.41		4582+79.08	2816.7	3380.0	5633.3	560.8		976.5	12518.5	120.3	5633.3
4582+79.08		4609+69.68	STATION EQUATION								
4609+69.68		4625+61.43	1591.8	1910.0	7018.7	316.9		1216.6	15597.0	68.0	3183.5
TOTAL:			42889	51583	91209	8632	840	14666	200790	1656	79151

PAVEMENT MARKING SCHEDULE														
STATION	TO	STATION	LENGTH	SHORT TERM PAVEMENT MARKING	SHORT TERM PAVEMENT MARKING REMOVAL	THERMOPLASTIC PAVEMENT MARKING - LINE 6" (W-HITE)	THERMOPLASTIC PAVEMENT MARKING - LINE 6" (YELLOW)	THERMOPLASTIC PAVEMENT MARKING - LINE 8" (W-HITE)	THERMOPLASTIC PAVEMENT MARKING - LINE 12" (WHITE)	THERMOPLASTIC PAVEMENT MARKING - LINE 24" (WHITE)	THERMOPLASTIC PAVEMENT MARKING - LETTERS & SYMBOLS	PREFORMED PLASTIC PAVEMENT MARKING, TYPE D - STANDARD - LINE 6" (WHITE)	RAISED REFLECTIVE PAVEMENT MARKER	RAISED REFLECTIVE PAVEMENT MARKER REMOVAL
NORTH BOUND			FOOT	FOOT	SQ FT	FOOT	FOOT	FOOT	FOOT	FOOT	SQ FT	FOOT	EACH	EACH
3310+13.00		3319+28.74	915.7	171.1	57.0	915.7	915.7					229.0	23.0	23.0
3319+28.74		4199+97.27	STATION EQUATION											
4199+97.27		4268+65.75	6868.5	1283.6	427.9	6868.5	6868.5					1717.0	172.0	172.0
4268+65.75		4270+90.08	STRUCTURE OMISSION											
4270+90.08		4305+99.41	3509.3	581.6	193.9	2846.3	2846.3					1141.0	144.0	144.0
RAMP D			1007.6	110.2	36.7	1743.0	1028.0	839.0	64.0	38.0	32.0			
4305+99.41		4307+57.91	STRUCTURE OMISSION											
RAMP C			1494.1	167.8	55.9	2486.0	1382.0	1500.0						
4307+57.91		4554+42.81	24684.9	4481.7	1493.9	23725.0	23724.9					6172.0	618.0	618.0
4554+42.81		4554+62.41	STATION EQUATION											
4554+62.41		4582+79.08	2816.7	526.4	175.5	2816.7	2816.7					704.0	70.0	70.0
4582+79.08		4609+69.68	STATION EQUATION											
4609+69.68		4625+61.43	1591.8	297.5	99.2	1591.8	1591.8					398.0	40.0	40.0
TOTAL:			42889	7620	2540	42993	41174	2339	64	38	32	10361	1067	1067

	USER NAME = levi.lund	DESIGNED -	REVISED -	STATE OF ILLINOIS DEPARTMENT OF TRANSPORTATION	SCHEDULE OF QUANTITIES			F.A.I RTE.	SECTION	COUNTY	TOTAL SHEETS	SHEET NO.
		DRAWN -	REVISED -					57	(25-6-1)RS-9 & (13-1)RS-3	*	32	8
		CHECKED -	REVISED -		CONTRACT NO. 74C61							
	PLOT DATE = 9/2/2025	DATE -	REVISED -		SCALE:	SHEET 1	OF 1 SHEETS	STA.	TO STA.	ILLINOIS FED. AID PROJECT		

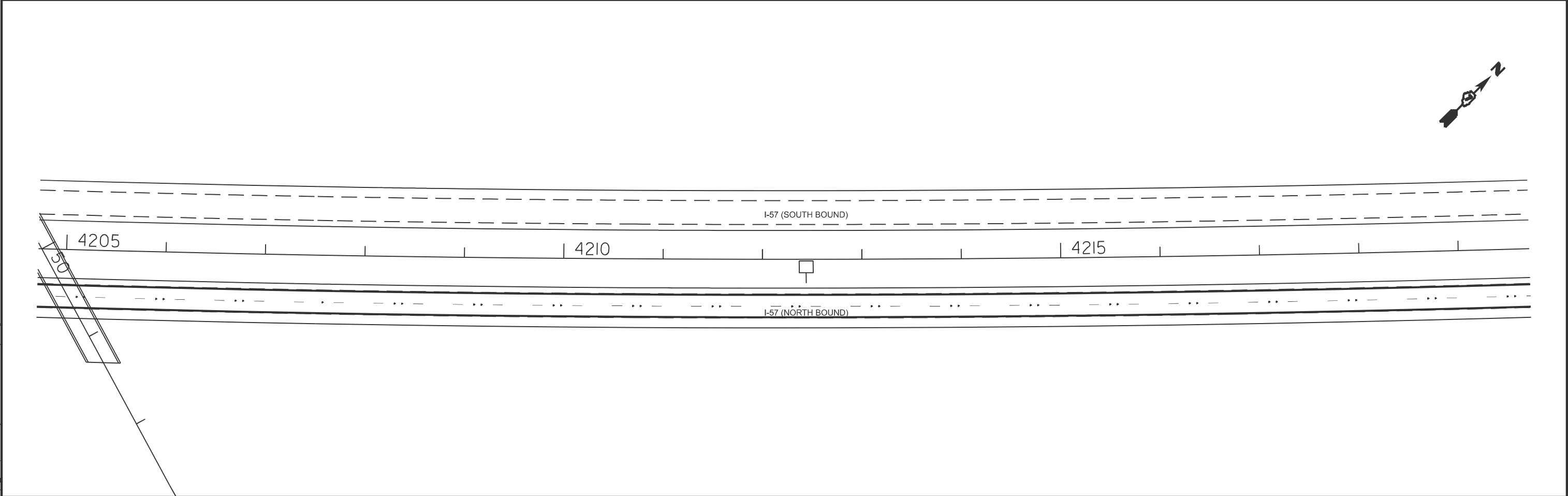
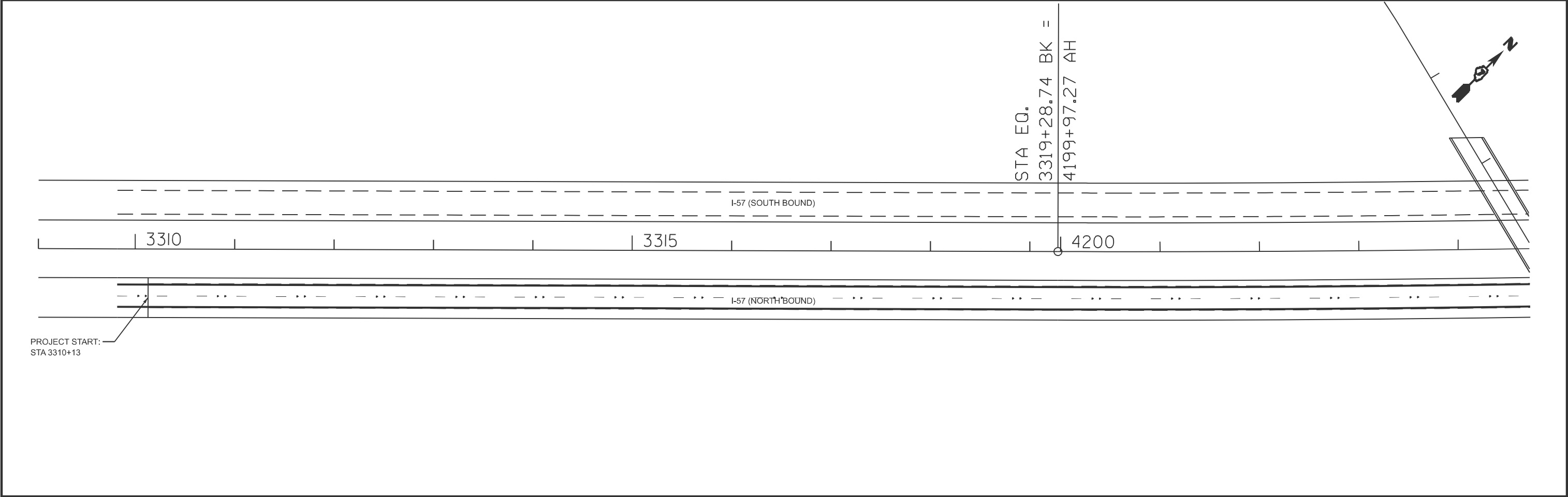

MODEL: GcCut - Plan 1 [Sheet]
FILE NAME: c:\p\work\road\und\dd910589\ID74C61-ah-plan.dgn

	USER NAME = levi.lund	DESIGNED -	REVISED -	STATE OF ILLINOIS DEPARTMENT OF TRANSPORTATION	PLAN SHEET			F.A.I RTE.	SECTION	COUNTY	TOTAL SHEETS	SHEET NO.
		DRAWN -	REVISED -					57	(25-6-1)RS-9 & (13-1)RS-3	*	32	9
		CHECKED -	REVISED -					CONTRACT NO. 74C61				
	PLOT DATE = 10/2/2025	DATE -	REVISED -		SCALE: 1"=50'	SHEET 1	OF 16 SHEETS	STA. 30+87.31	TO STA. 60+87.31	ILLINOIS FED. AID PROJECT		

*EFFINGHAM, CLAY

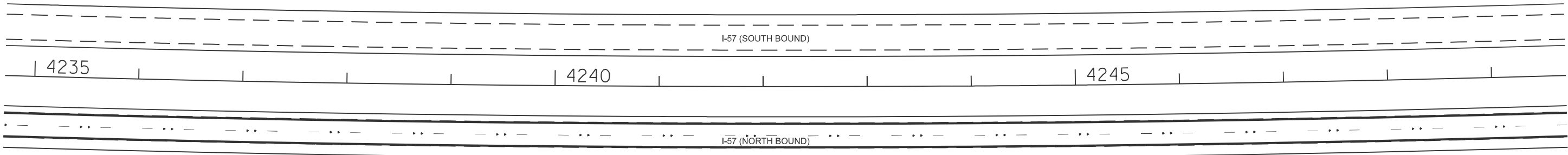
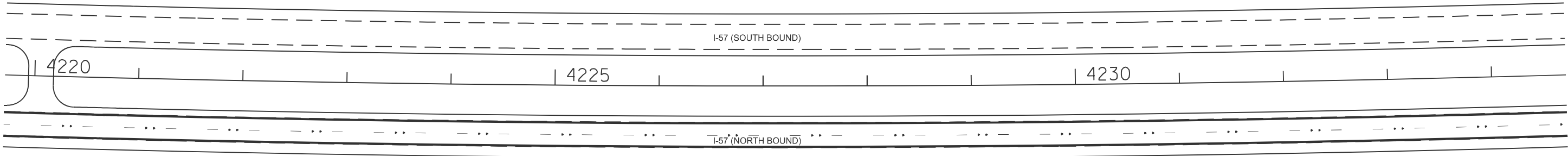
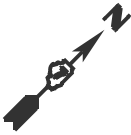

MODEL: GrCut - Plan 3 (Sheet)
FILE NAME: c:\p\work\road\und\dd910589\D74C61-srh-plan.dgn

	USER NAME = levi.lund	DESIGNED -	REVISED -	STATE OF ILLINOIS DEPARTMENT OF TRANSPORTATION	PLAN SHEET			F.A.I RTE.	SECTION	COUNTY	TOTAL SHEETS	SHEET NO.
		DRAWN -	REVISED -					57	(25-6-1)RS-9 & (13-1)RS-3	*	32	10
		CHECKED -	REVISED -					CONTRACT NO. 74C61				
	PLOT DATE = 10/2/2025	DATE -	REVISED -		SCALE: 1"=50'	SHEET 2	OF 16 SHEETS	STA. 60+87.31	TO STA. 90+87.31	ILLINOIS FED. AID PROJECT		

*EFFINGHAM, CLAY

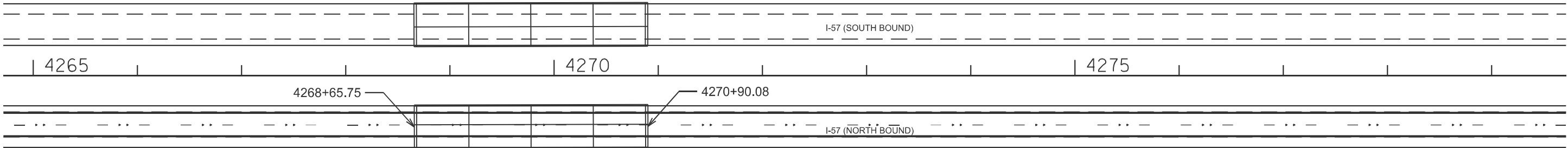
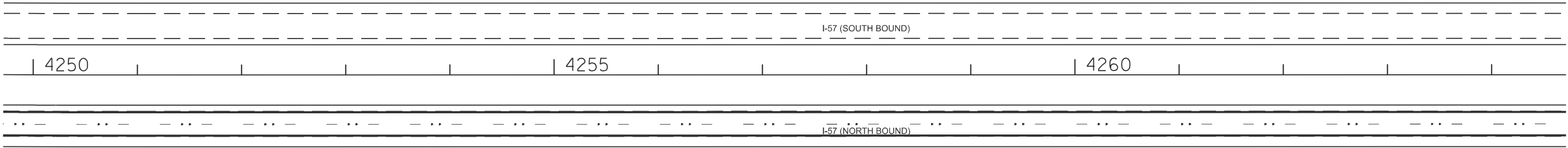

MODEL: GrCut - Plan & Sheet]
FILE NAME: c:\p\work\i57\id910589\ID74C61-srh-plan.dgn

	USER NAME = levi.lund	DESIGNED -	REVISED -	STATE OF ILLINOIS DEPARTMENT OF TRANSPORTATION	PLAN SHEET			F.A.I RTE.	SECTION	COUNTY	TOTAL SHEETS	SHEET NO.
		DRAWN -	REVISED -					57	(25-6-1)RS-9 & (13-1)RS-3	*	32	11
		CHECKED -	REVISED -					CONTRACT NO. 74C61				
	PLOT DATE = 10/2/2025	DATE -	REVISED -		SCALE: 1"=50'	SHEET 3	OF 16 SHEETS	STA. 90+87.31	TO STA. 120+87.31	ILLINOIS FED. AID PROJECT		

*EFFINGHAM, CLAY

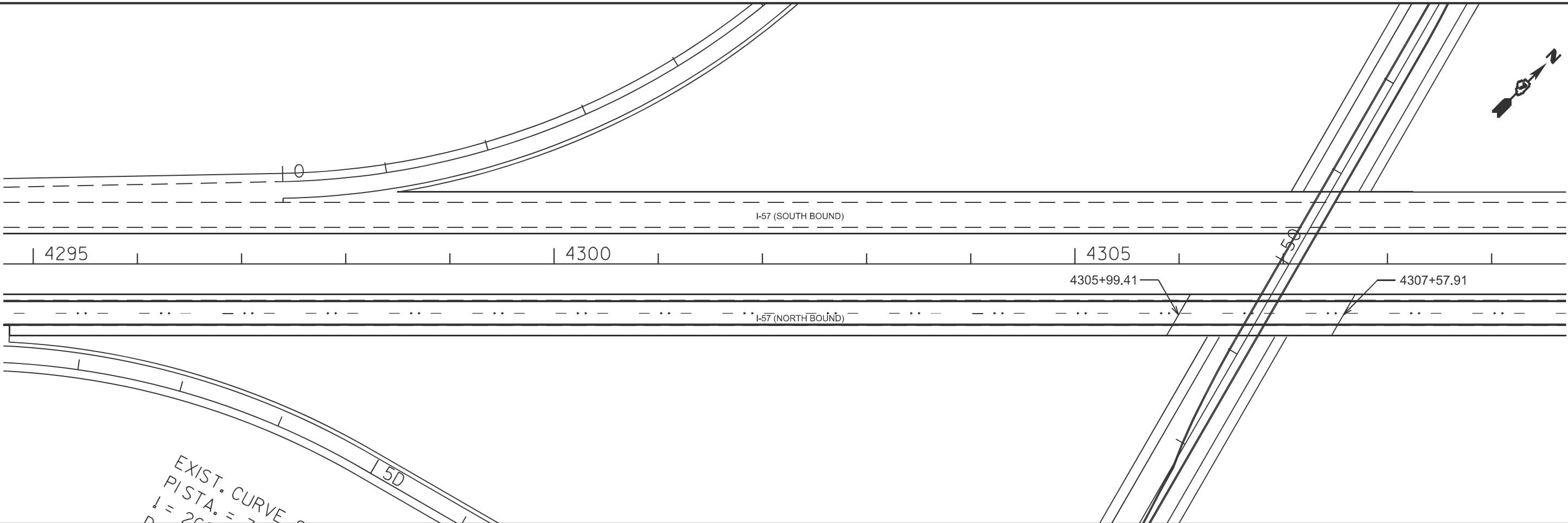
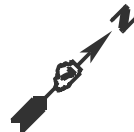
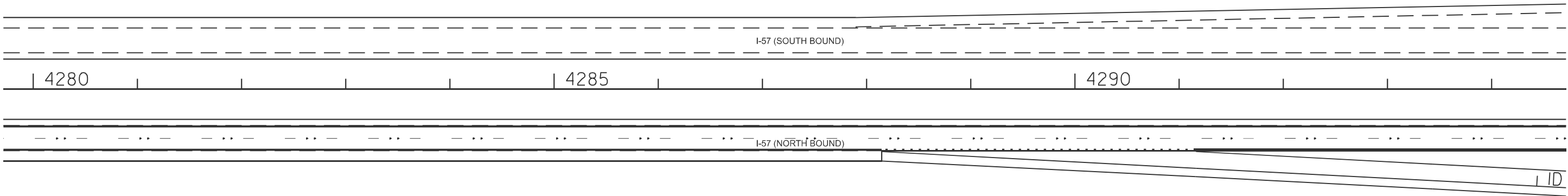
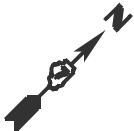

MODEL: GrCut - Plan 7 (Sheet)
FILE NAME: c:\p\work\lund\lund\0589\074C61-ah-plan.dgn

USER NAME	= levi.lund	DESIGNED	-	REVISED	-
		DRAWN	-	REVISED	-
		CHECKED	-	REVISED	-
PLOT DATE	= 10/2/2025	DATE	-	REVISED	-

STATE OF ILLINOIS
DEPARTMENT OF TRANSPORTATION

PLAN SHEET

SCALE: 1"=50' SHEET 4 OF 16 SHEETS STA. 120+87.31 TO STA. 150+87.31

F.A.I RTE.	SECTION	COUNTY	TOTAL SHEETS	SHEET NO.
57	(25-6-1)RS-9 & (13-1)RS-3	*	32	12
CONTRACT NO. 74C61				
ILLINOIS FED. AID PROJECT				

*EFFINGHAM, CLAY

MODEL: GrCut - Plan 9 [Sheet]
FILE NAME: c:\p\work\wis\old\und\0910589\ID74C61-ah-plan.dgn

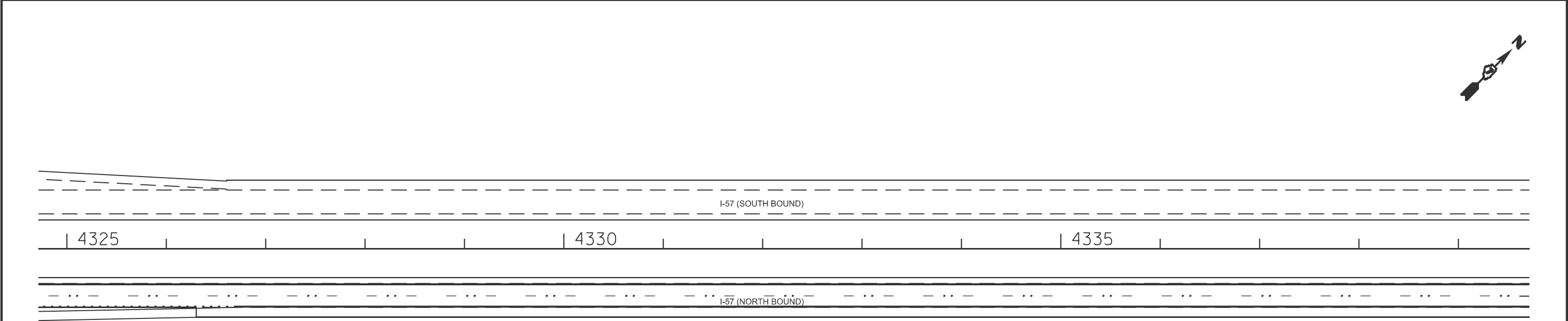
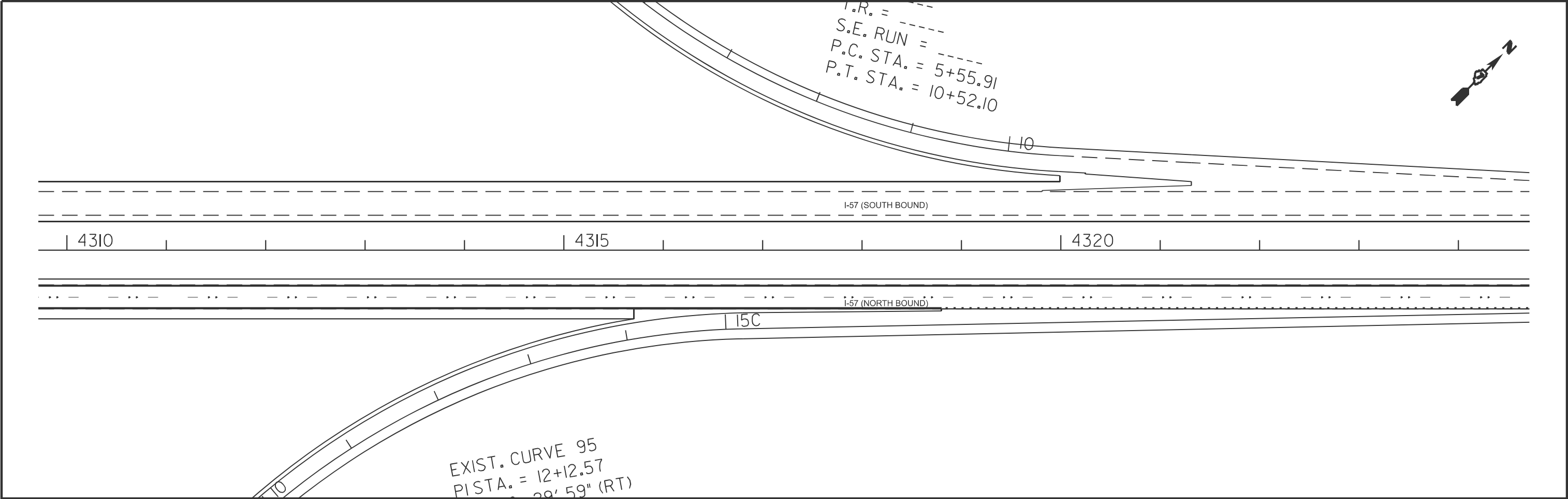

	USER NAME = levi.lund	DESIGNED -	REVISED -	STATE OF ILLINOIS DEPARTMENT OF TRANSPORTATION	PLAN SHEET			F.A.I RTE.	SECTION	COUNTY	TOTAL SHEETS	SHEET NO.
		DRAWN -	REVISED -					57	(25-6-1)RS-9 & (13-1)RS-3	*	32	13
		CHECKED -	REVISED -					CONTRACT NO. 74C61				
	PLOT DATE = 10/2/2025	DATE -	REVISED -		SCALE: 1"=50'	SHEET 5	OF 16 SHEETS	STA. 150+87.31	TO STA. 180+87.31	ILLINOIS	FED. AID PROJECT	*EFFINGHAM, CLAY

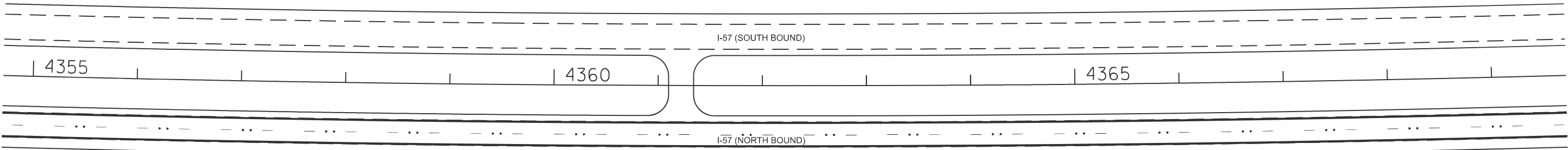
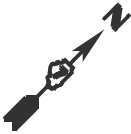
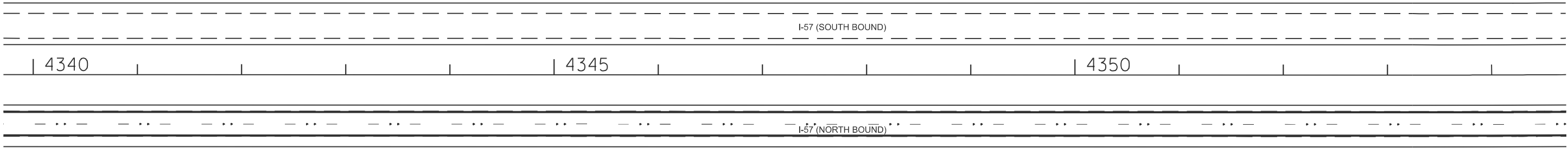
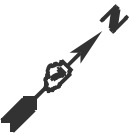

MODEL: GcCut - Plan 11 [Sheet]
FILE NAME: c:\p\work\wiscon\lund\0910589\074C61-srh-plan.dgn

	USER NAME = levi.lund	DESIGNED -	REVISED -	STATE OF ILLINOIS DEPARTMENT OF TRANSPORTATION	PLAN SHEET			F.A.I RTE.	SECTION	COUNTY	TOTAL SHEETS	SHEET NO.
		DRAWN -	REVISED -					57	(25-6-1)RS-9 & (13-1)RS-3	*	32	14
		CHECKED -	REVISED -					CONTRACT NO. 74C61				
	PLOT DATE = 10/2/2025	DATE -	REVISED -		SCALE: 1"=50'	SHEET 6	OF 16 SHEETS	STA. 180+87.31	TO STA. 210+87.31	ILLINOIS FED. AID PROJECT		

*EFFINGHAM, CLAY

MODEL: GcCut - Plan 13 [Sheet]
FILE NAME: c:\p\work\wiscon\lund\0910589\ID74C61-sht-plan.dgn

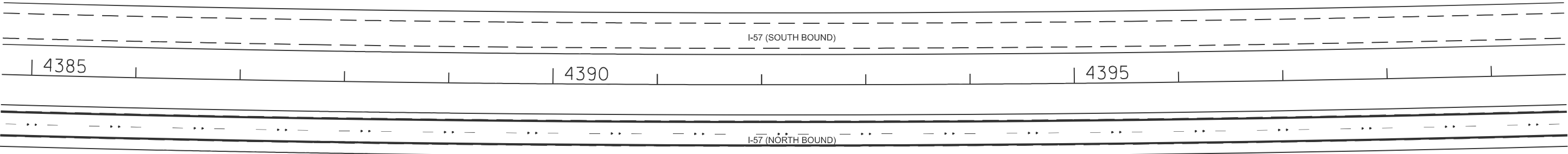
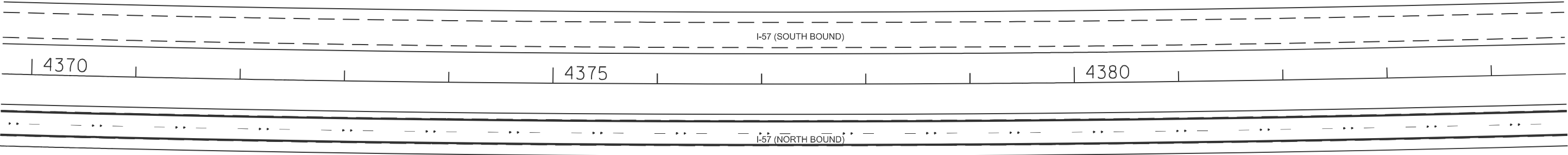

	USER NAME = levi.lund	DESIGNED -	REVISED -	STATE OF ILLINOIS DEPARTMENT OF TRANSPORTATION	PLAN SHEET			F.A.I RTE.	SECTION	COUNTY	TOTAL SHEETS	SHEET NO.
		DRAWN -	REVISED -					57	(25-6-1)RS-9 & (13-1)RS-3	*	32	15
		CHECKED -	REVISED -					CONTRACT NO. 74C61				
	PLOT DATE = 10/2/2025	DATE -	REVISED -		SCALE: 1"=50'	SHEET 7	OF 16 SHEETS	STA. 210+87.31	TO STA. 240+87.31	ILLINOIS FED. AID PROJECT		

*EFFINGHAM, CLAY

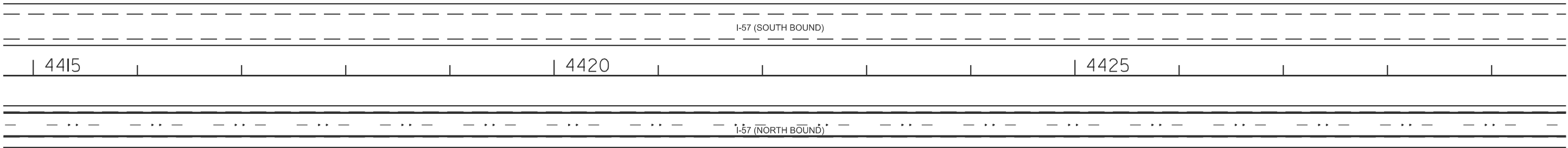
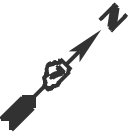
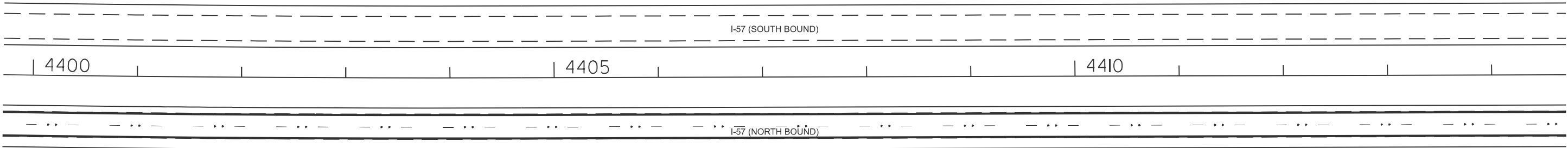
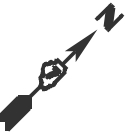

MODEL: GrCut - Plan 15 [Sheet]
FILE NAME: c:\p\work\wiscon\und\dd910589\ID74C61-ah-plan.dgn

	USER NAME = levi.lund	DESIGNED -	REVISED -	STATE OF ILLINOIS DEPARTMENT OF TRANSPORTATION	PLAN SHEET			F.A.I RTE.	SECTION	COUNTY	TOTAL SHEETS	SHEET NO.
		DRAWN -	REVISED -					57	(25-6-1)RS-9 & (13-1)RS-3	*	32	16
		CHECKED -	REVISED -					CONTRACT NO. 74C61				
	PLOT DATE = 10/2/2025	DATE -	REVISED -		SCALE: 1"=50'	SHEET 8	OF 16 SHEETS	STA. 240+87.31	TO STA. 270+87.31	ILLINOIS FED. AID PROJECT		

*EFFINGHAM, CLAY

MODEL: GcCut - Plan 17 [Sheet]
FILE NAME: c:\p\work\wisot\lund\dd910589\ID74C61-srh-plan.dgn

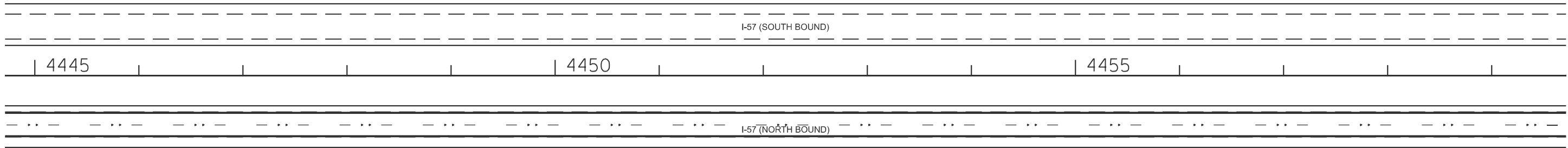
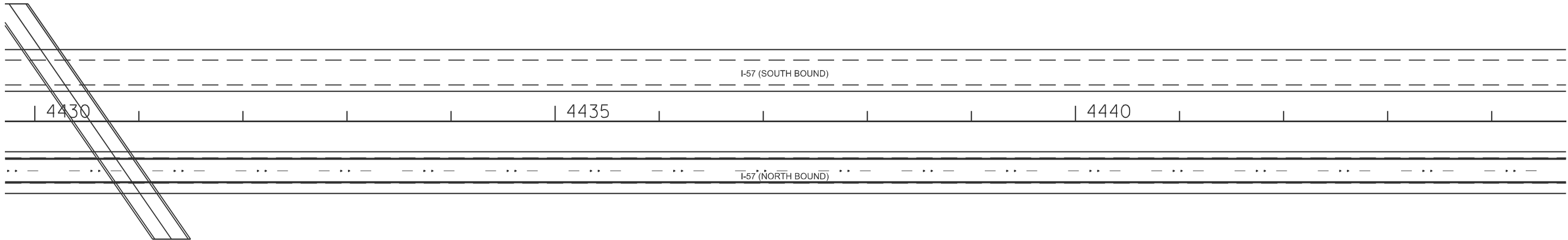

	USER NAME = levi.lund	DESIGNED -	REVISED -	STATE OF ILLINOIS DEPARTMENT OF TRANSPORTATION	PLAN SHEET			F.A.I RTE.	SECTION	COUNTY	TOTAL SHEETS	SHEET NO.
		DRAWN -	REVISED -					57	(25-6-1)RS-9 & (13-1)RS-3	*	32	17
		CHECKED -	REVISED -					CONTRACT NO. 74C61				
	PLOT DATE = 10/2/2025	DATE -	REVISED -		SCALE: 1"=50'	SHEET 9	OF 16 SHEETS	STA. 270+87.31	TO STA. 300+87.31	ILLINOIS FED. AID PROJECT		

*EFFINGHAM, CLAY

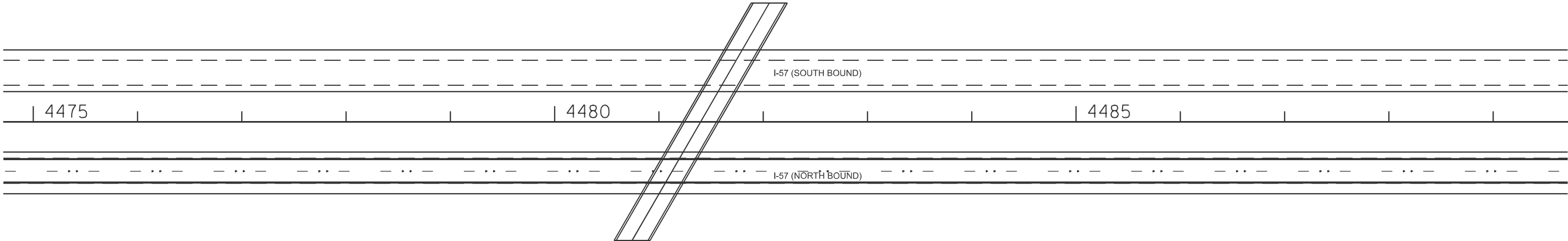
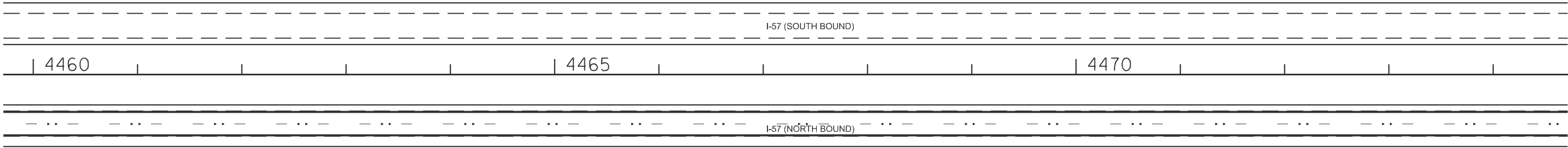

MODEL: Grcut - Plan 19 [Sheet]
FILE NAME: c:\p\work\wiscon\lund\0910589\ID74C61-srh-plan.dgn

	USER NAME = levi.lund	DESIGNED -	REVISED -	STATE OF ILLINOIS DEPARTMENT OF TRANSPORTATION	PLAN SHEET			F.A.I RTE.	SECTION	COUNTY	TOTAL SHEETS	SHEET NO.
		DRAWN -	REVISED -					57	(25-6-1)RS-9 & (13-1)RS-3	*	32	18
		CHECKED -	REVISED -					CONTRACT NO. 74C61				
	PLOT DATE = 10/2/2025	DATE -	REVISED -		SCALE: 1"=50'	SHEET 10	OF 16 SHEETS	STA. 300+87.31	TO STA. 330+87.31	ILLINOIS FED. AID PROJECT		

*EFFINGHAM, CLAY

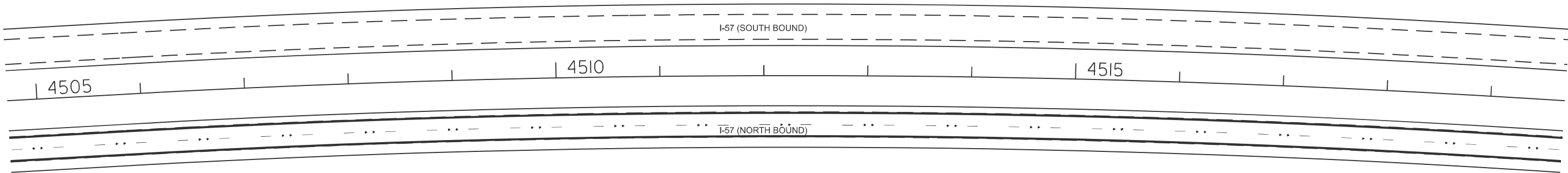
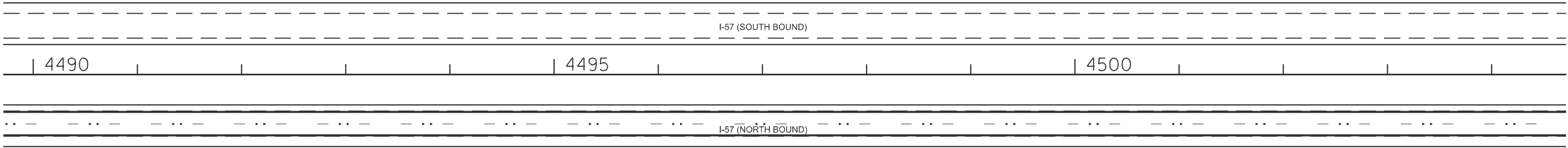

MODEL: GrCut - Plan 21 [Sheet]
FILE NAME: c:\p\work\wisot\lund\dd910589\ID74C61-ahh-plan.dgn

	USER NAME = levi.lund	DESIGNED -	REVISED -	STATE OF ILLINOIS DEPARTMENT OF TRANSPORTATION	PLAN SHEET			F.A.I RTE.	SECTION	COUNTY	TOTAL SHEETS	SHEET NO.
		DRAWN -	REVISED -					57	(25-6-1)RS-9 & (13-1)RS-3	*	32	19
		CHECKED -	REVISED -					CONTRACT NO. 74C61				
	PLOT DATE = 10/2/2025	DATE -	REVISED -		SCALE: 1"=50'	SHEET 11	OF 16 SHEETS	STA. 330+87.31	TO STA. 360+87.31	ILLINOIS	FED. AID PROJECT	

*EFFINGHAM, CLAY

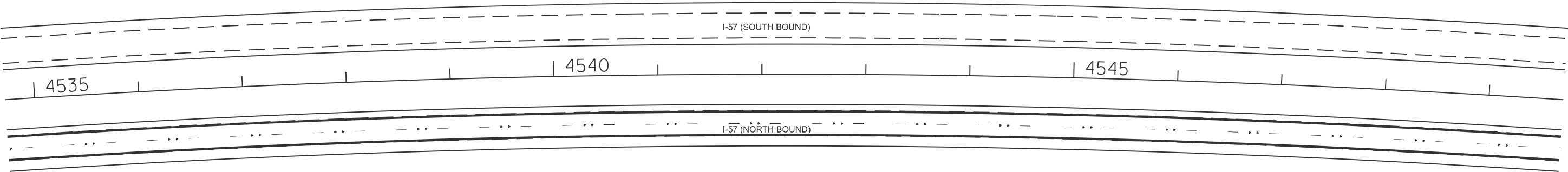
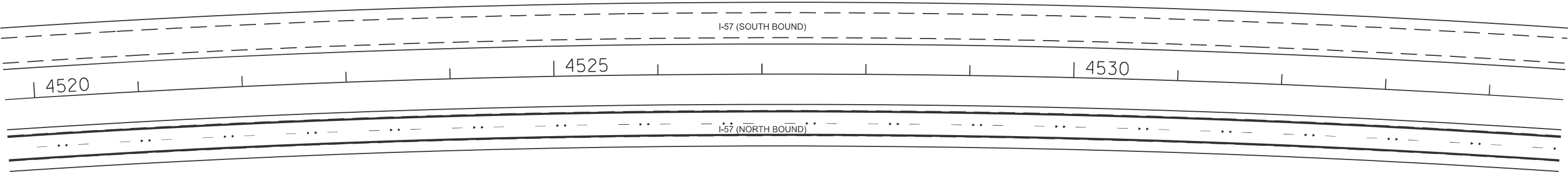

MODEL: Grcut - Plan 23 [Sheet]
FILE NAME: c:\p\work\wis\old\und\0910589\074C61-ahh-plan.dgn

	USER NAME = levi.lund	DESIGNED -	REVISED -	STATE OF ILLINOIS DEPARTMENT OF TRANSPORTATION	PLAN SHEET			F.A.I RTE.	SECTION	COUNTY	TOTAL SHEETS	SHEET NO.
		DRAWN -	REVISED -					57	(25-6-1)RS-9 & (13-1)RS-3	*	32	20
		CHECKED -	REVISED -					CONTRACT NO. 74C61				
	PLOT DATE = 10/2/2025	DATE -	REVISED -		SCALE: 1"=50'	SHEET 12	OF 16 SHEETS	STA. 360+87.31	TO STA. 390+87.31	ILLINOIS FED. AID PROJECT		

*EFFINGHAM, CLAY

MODEL: GcCut - Plan 25 [Sheet]
FILE NAME: c:\p\work\wiscon\lund\0910589\ID74C61-srh-plan.dgn

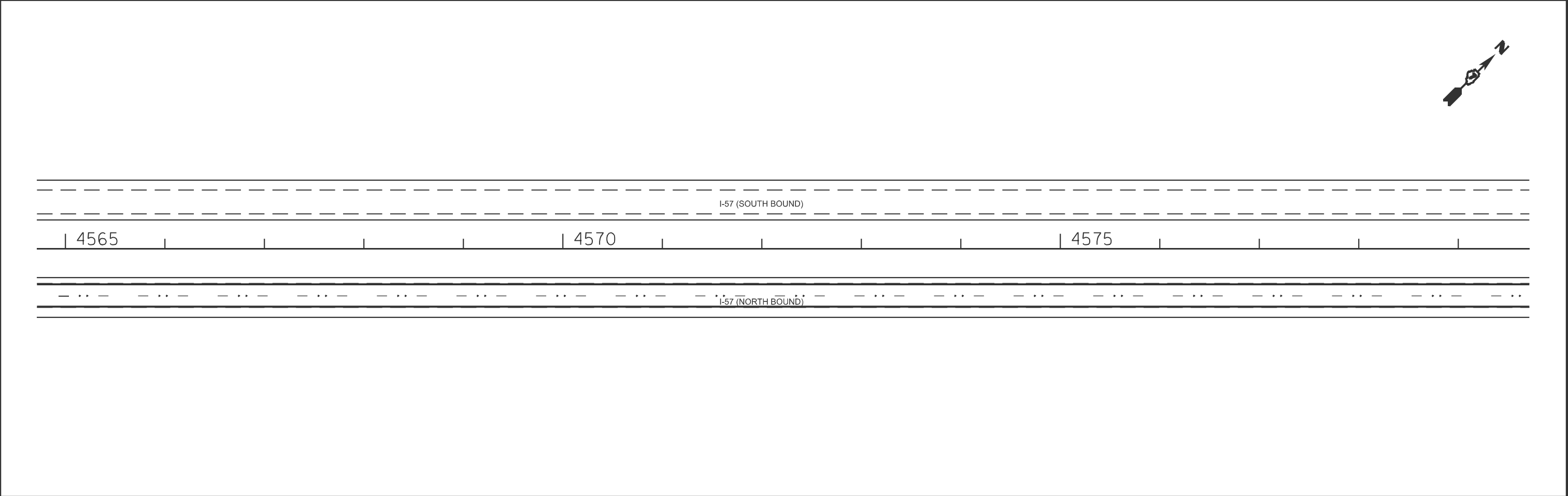
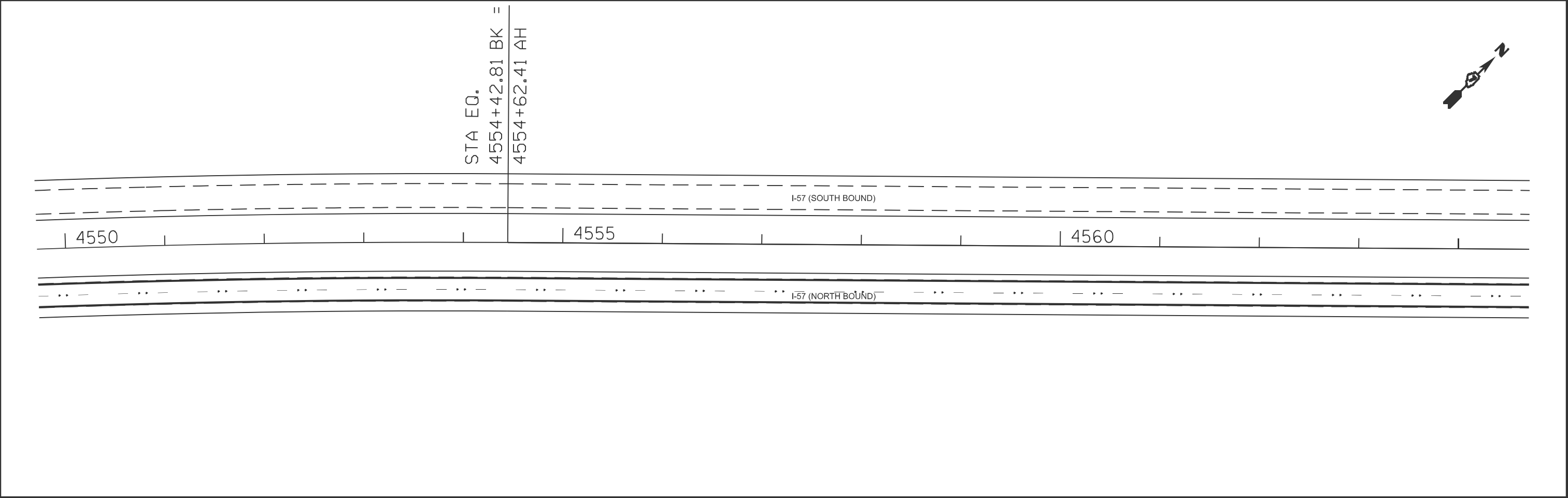

	USER NAME	= levi.lund	DESIGNED	-	REVISED	-	STATE OF ILLINOIS DEPARTMENT OF TRANSPORTATION	PLAN SHEET			F.A.I RTE.	SECTION	COUNTY	TOTAL SHEETS	SHEET NO.
			DRAWN	-	REVISED	-					57	(25-6-1)RS-9 & (13-1)RS-3	*	32	21
			CHECKED	-	REVISED	-					CONTRACT NO. 74C61				
	PLOT DATE	= 10/2/2025	DATE	-	REVISED	-		SCALE: 1"=50'	SHEET 13	OF 16 SHEETS	STA. 390+87.31	TO STA. 420+87.31	ILLINOIS FED. AID PROJECT		

MODEL: GcCut - Plan 27 [Sheet]
FILE NAME: c:\p\work\wiscon\lund\0910589\ID74C61-srh-plan.dgn

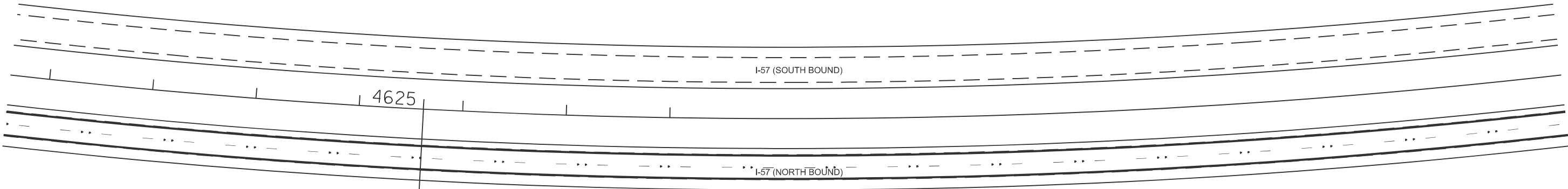
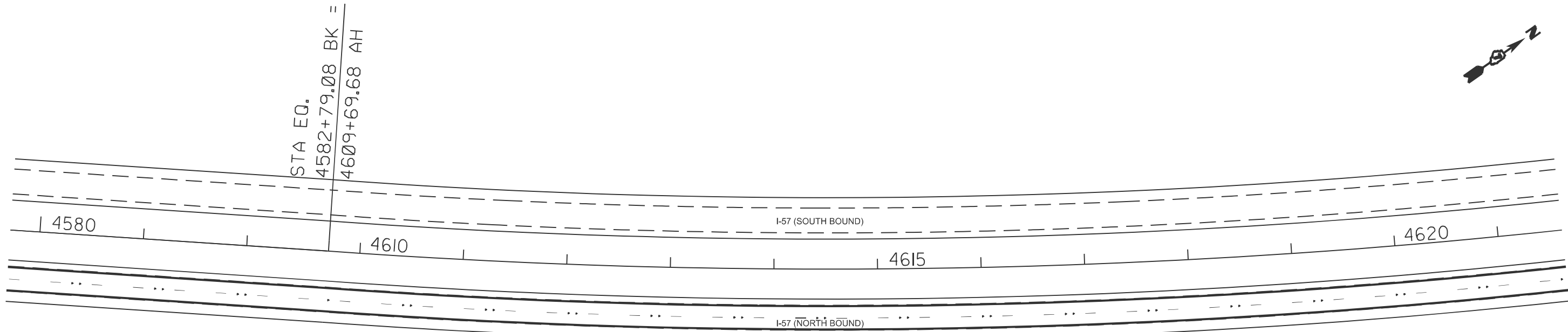

	USER NAME = levi.lund	DESIGNED -	REVISED -	STATE OF ILLINOIS DEPARTMENT OF TRANSPORTATION	PLAN SHEET			F.A.I RTE.	SECTION	COUNTY	TOTAL SHEETS	SHEET NO.
		DRAWN -	REVISED -					57	(25-6-1)RS-9 & (13-1)RS-3	*	32	22
		CHECKED -	REVISED -					CONTRACT NO. 74C61				
	PLOT DATE = 10/2/2025	DATE -	REVISED -		SCALE: 1"=50'	SHEET 14	OF 16 SHEETS	STA. 420+87.31	TO STA. 450+87.31	ILLINOIS FED. AID PROJECT		

*EFFINGHAM, CLAY

MODEL: Plan-Ramp D [Sheet]
FILE NAME: c:\pwworking\levi.lund\105891D74C61-rtb-plan.dgn

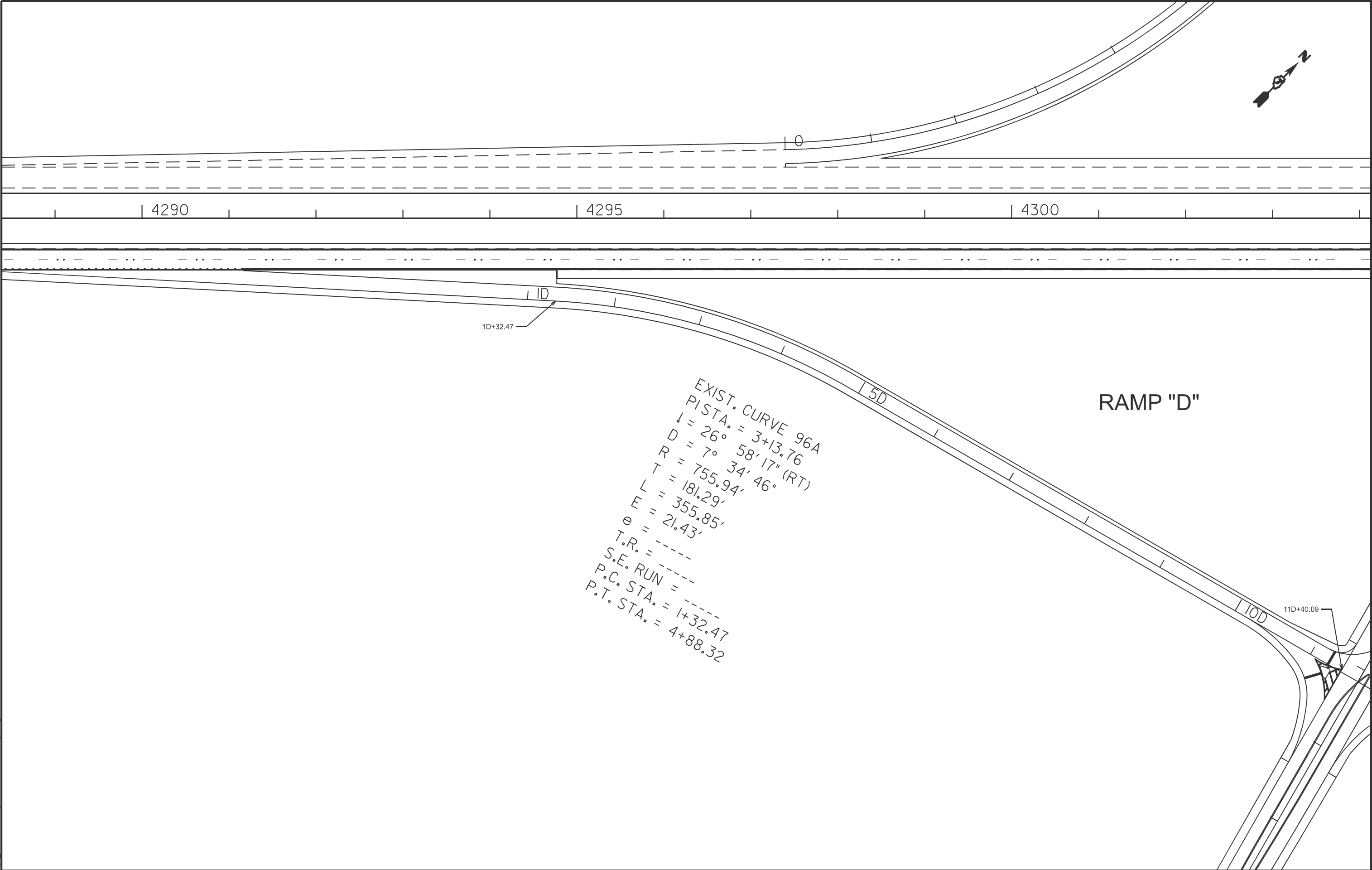

	USER NAME = levi.lund	DESIGNED -	REVISED -	STATE OF ILLINOIS DEPARTMENT OF TRANSPORTATION	RAMP "D" PLAN SHEET			F.A.I RTE.	SECTION	COUNTY	TOTAL SHEETS	SHEET NO.
		DRAWN -	REVISED -					57	(25-6-1)RS-9 & (13-1)RS-3	*	32	23
		CHECKED -	REVISED -					CONTRACT NO. 74C61				
	PLOT DATE = 9/18/2025	DATE -	REVISED -		SCALE:	SHEET 15	OF 16 SHEETS	STA.	TO STA.	ILLINOIS FED. AID PROJECT		

*EFFINGHAM, CLAY

MODEL: Plan-Ramp C (Sheet)
FILE NAME: c:\pwworking\levi.lund\hd0910589\ID74C61-ctb-plan.dgn

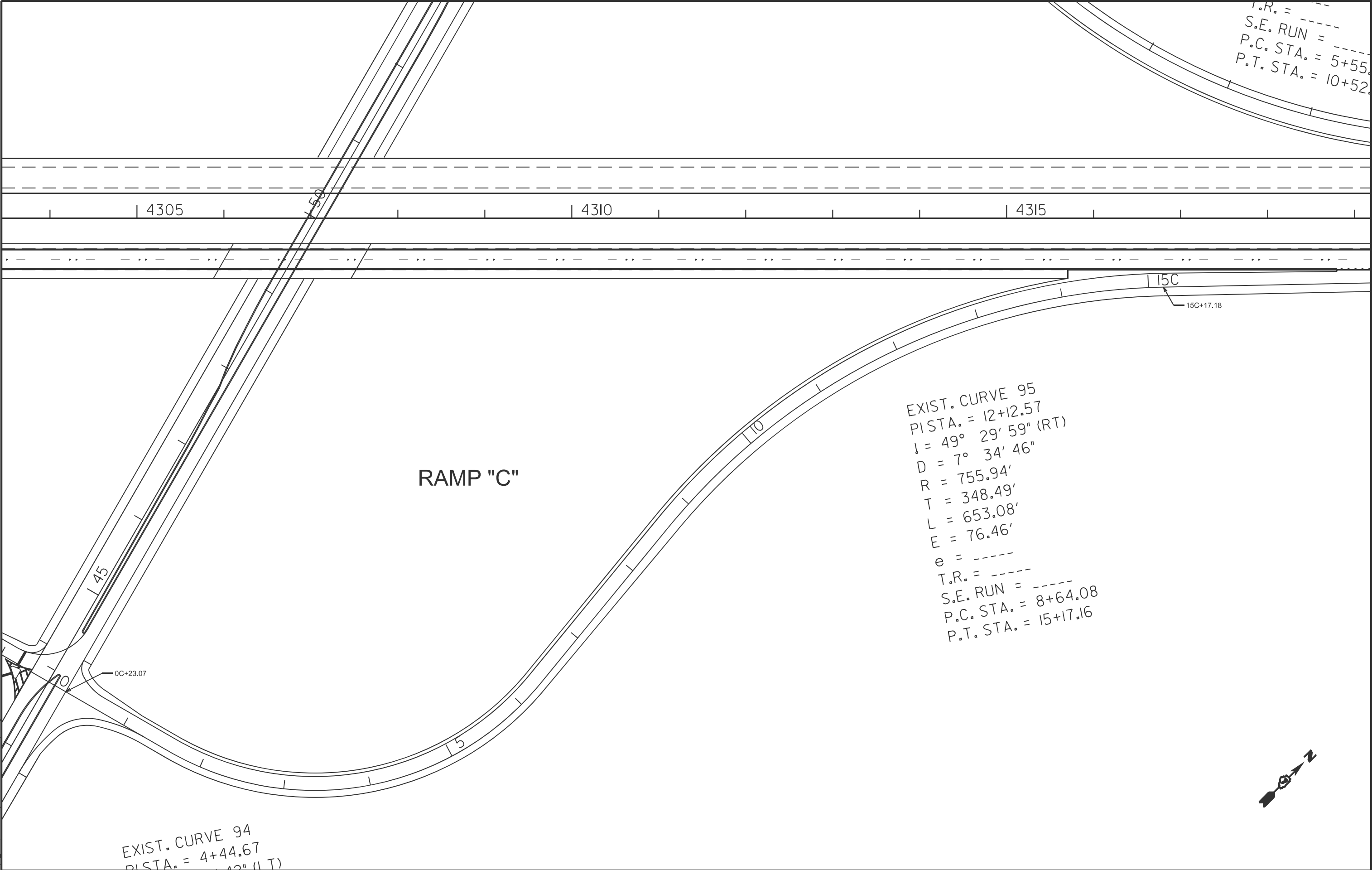

EXIST. CURVE 94
PISTA. = 4+44.67
I = 42° 12' 12" (LT)

EXIST. CURVE 95
PISTA. = 12+12.57
I = 49° 29' 59" (RT)
D = 7° 34' 46"
R = 755.94'
T = 348.49'
L = 653.08'
E = 76.46'
e = ----
T.R. = ----
S.E. RUN = ----
P.C. STA. = 8+64.08
P.T. STA. = 15+17.16

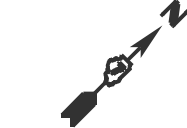

USER NAME = levi.lund	DESIGNED -	REVISED -
	DRAWN -	REVISED -
	CHECKED -	REVISED -
PLOT DATE = 9/18/2025	DATE -	REVISED -

STATE OF ILLINOIS
DEPARTMENT OF TRANSPORTATION

RAMP "C" PLAN SHEET			
SCALE:	SHEET 16	OF 16 SHEETS	STA. TO STA.

F.A.I. RTE.	SECTION	COUNTY	TOTAL SHEETS	SHEET NO.
57	(25-6-1)RS-9 & (13-1)RS-3	*	32	24
CONTRACT NO. 74C61				
ILLINOIS FED. AID PROJECT				

*EFFINGHAM, CLAY



PAVEMENT MARKING LEGEND

- 1

4" (100) SKIP-DASH (YELLOW)

10'

30'

10'

(3.05 m)

(9.15 m)

(3.05 m)
- 2

4" (100) SOLID (YELLOW)

12" (300)

45°

TRAFFIC
- 3

12" (300) DIAGONAL (YELLOW)

TRAFFIC

4" (100)

8" (200) CTS
- 4

4" (100) DOUBLE YELLOW (NARROW)

7" (175)

11" (275) CTS
- 5

12" (300) SOLID (WHITE)

10'

30'

10'

(3.05 m)

(9.15 m)

(3.05 m)
- 6

4" (100) DOUBLE YELLOW (WIDE)

TRAFFIC

45°

12" (300)

45°

12" (300)

8" (200)
- 7

6" (150) SKIP-DASH (WHITE)

TRAFFIC

45°

12" (300)

45°

12" (300)

8" (200)
- 8

4" (100) SOLID (WHITE)

24"

12"

12"

(600)

(300)

(300)
- 9

12" (300) DIAGONAL (WHITE)

24"

12"

12"

(600)

(300)

(300)
- 10

6" (150) SOLID (WHITE)

24"

12"

12"

(600)

(300)

(300)
- 11

24" (600) STOP BAR (WHITE)

24"

12"

12"

(600)

(300)

(300)
- 12

8" (200) SOLID (WHITE)

24"

12"

12"

(600)

(300)

(300)
- 13

4" (100) PARKING (WHITE)

24"

12"

12"

(600)

(300)

(300)
- 14

6" (150) SOLID (YELLOW)

24"

12"

12"

(600)

(300)

(300)

STATE OF ILLINOIS
DEPARTMENT OF TRANSPORTATION

PAVEMENT MARKING PLAN SHEET

F.A.I RTE.	SECTION	COUNTY	TOTAL SHEETS	SHEET NO.
57	(25-6-1)RS-9 & (13-1)RS-3	*	32	25
CONTRACT NO. 74C61				
ILLINOIS FED. AID PROJECT				

*EFFINGHAM, CLAY

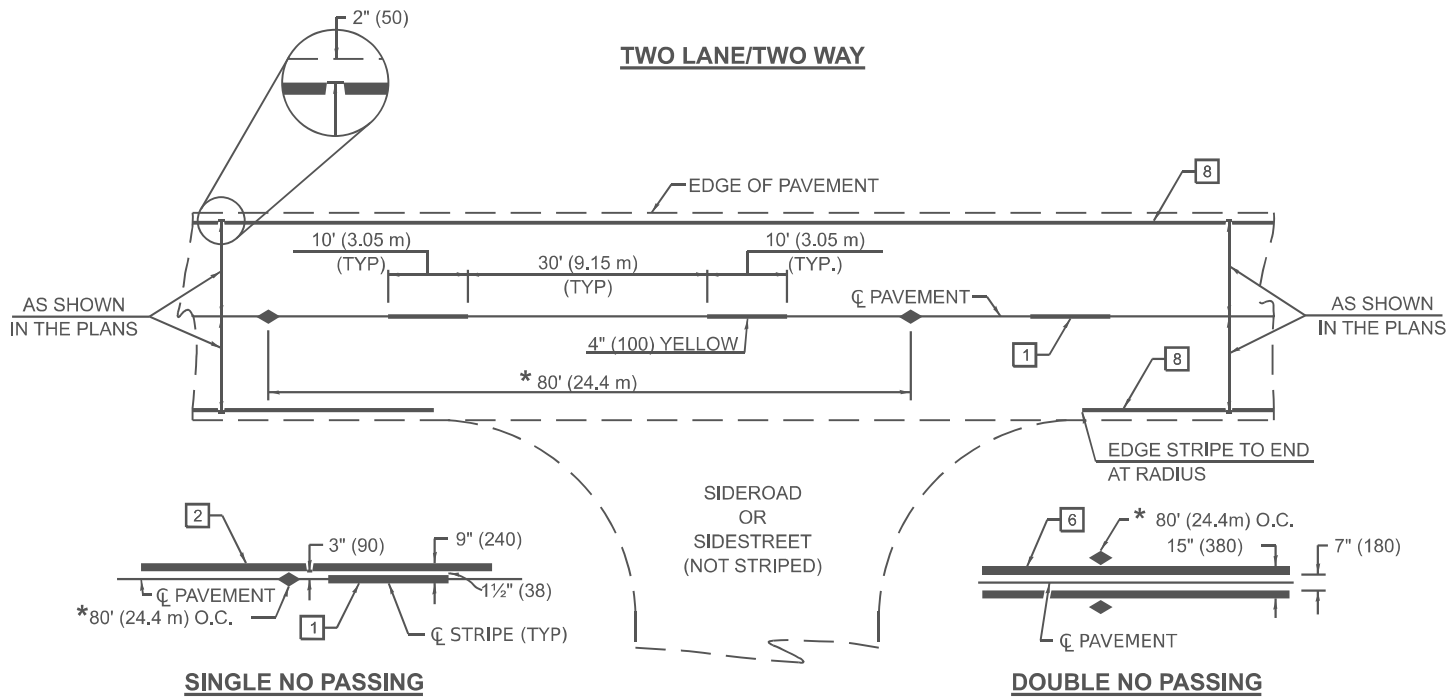

PAVEMENT MARKERS LEGEND

- 1 4" (100) SKIP-DASH (YELLOW)
- 2 4" (100) SOLID (YELLOW)
- 3 12" (300) DIAGONAL (YELLOW)
- 4 4" (100) DOUBLE YELLOW (NARROW)
- 5 12" (300) SOLID (WHITE)
- 6 4" (100) DOUBLE YELLOW (WIDE)
- 7 6" (150) SKIP-DASH (WHITE)
- 8 4" (100) SOLID (WHITE)
- 9 12" (300) DIAGONAL (WHITE)
- 10 6" (150) SOLID (WHITE)
- 11 24" (600) STOP BAR (WHITE)
- 12 8" (200) SOLID (WHITE)
- 13 4" (100) PARKING (WHITE)

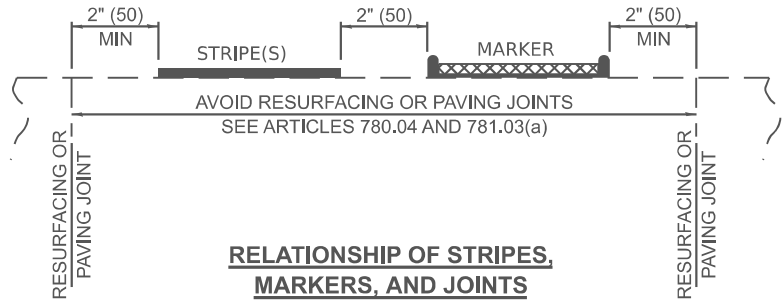
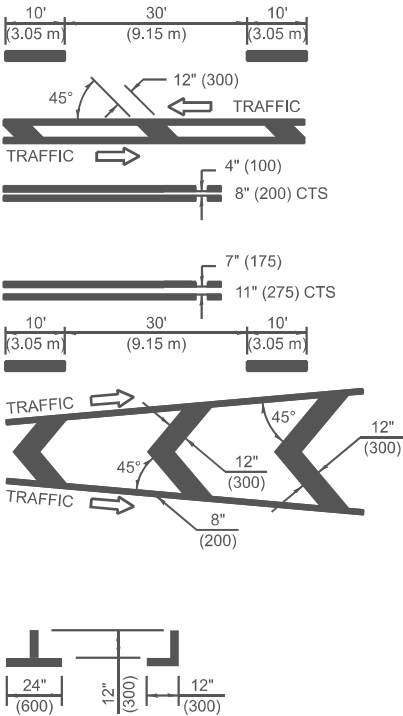

TYPICAL PAVEMENT MARKERS LEGEND

- ◆ TWO-WAY AMBER MARKER
- ▶ ONE-WAY AMBER MARKER
- ▷ ONE-WAY CRYSTAL MARKER

RAISED REFLECTIVE PAVEMENT MARKERS

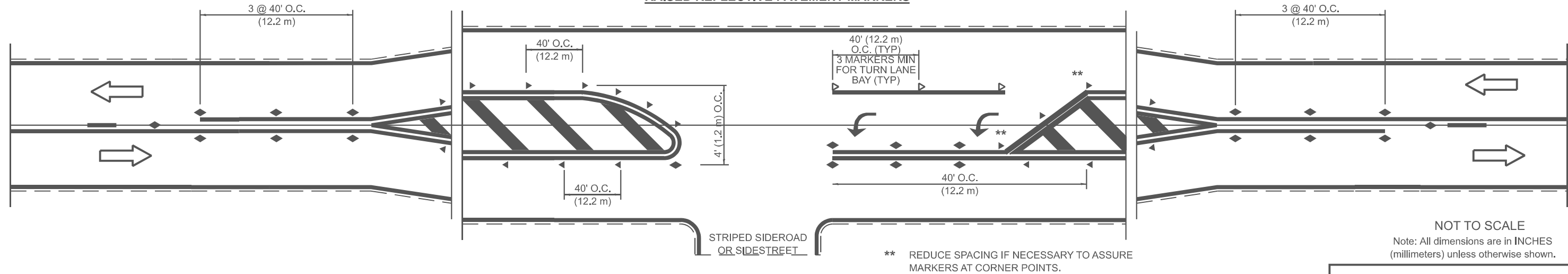

MODEL: Pavement Marking Detail (Sheet)
FILE NAME: c:\pav_work\wtkid\lund\dd0910589D774C61-veh-details.dgn

USER NAME	= levi.lund	DESIGNED	-	REVISED	-
		DRAWN	-	REVISED	-
		CHECKED	-	REVISED	-
PLOT DATE	= 8/26/2025	DATE	-	REVISED	-

STATE OF ILLINOIS
DEPARTMENT OF TRANSPORTATION

PAVEMENT MARKING DETAILS

SCALE: SHEET 2 OF 8 SHEETS STA. TO STA.

DISTRICT 7 DETAIL NO. 78000001

F.A.I RTE.	SECTION	COUNTY	TOTAL SHEETS	SHEET NO.
57	(25-6-1)RS-9 & (13-1)RS-3	*	32	26
CONTRACT NO. 74C61				
ILLINOIS FED. AID PROJECT				

*EFFINGHAM, CLAY

MODEL: Pavement Marking Detail-1 [Sheet]
FILE NAME: c:\pwworking\lund\id910589D774C61-uhh-details.dgn

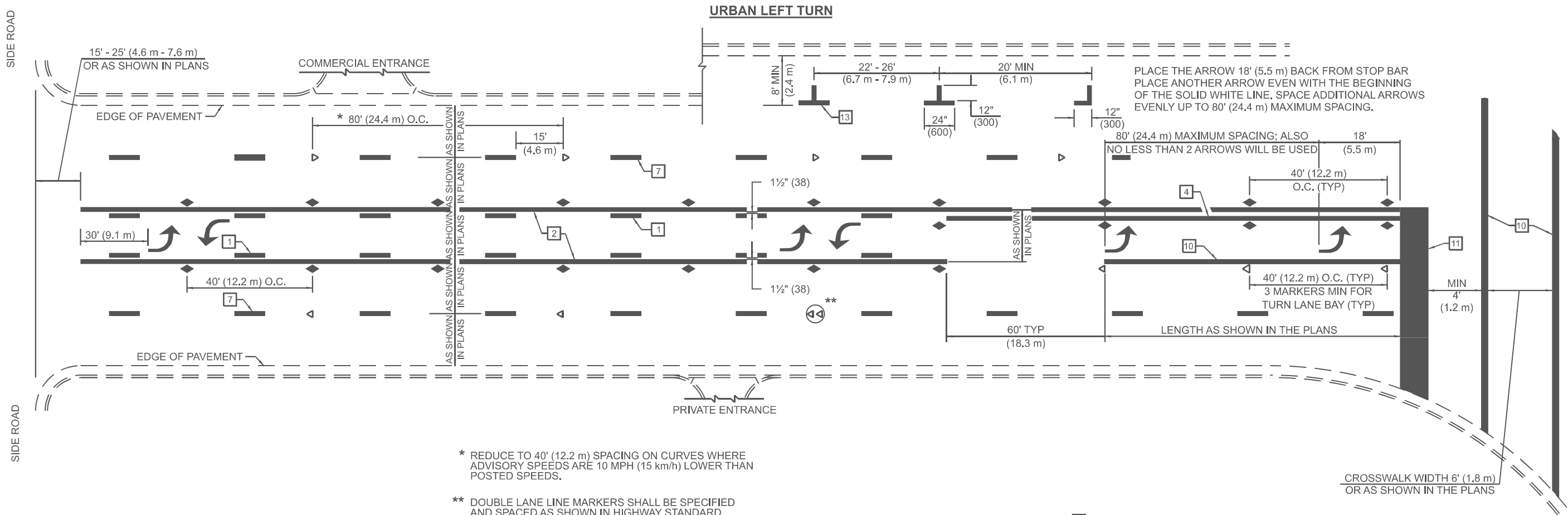

- * REDUCE TO 40' (12.2 m) SPACING ON CURVES WHERE ADVISORY SPEEDS ARE 10 MPH (15 km/h) LOWER THAN POSTED SPEEDS.
- ** DOUBLE LANE LINE MARKERS SHALL BE SPECIFIED AND SPACED AS SHOWN IN HIGHWAY STANDARD 781001 FOR MULTI-LANE DIVIDED AND UNDIVIDED HIGHWAYS.

PAVEMENT MARKING LEGEND

- | | | |
|----|---------------------------------|--|
| 1 | 4" (100) SKIP-DASH (YELLOW) | |
| 2 | 4" (100) SOLID (YELLOW) | |
| 3 | 12" (300) DIAGONAL (YELLOW) | |
| 4 | 4" (100) DOUBLE YELLOW (NARROW) | |
| 5 | 12" (300) SOLID (WHITE) | |
| 6 | 4" (100) DOUBLE YELLOW (WIDE) | |
| 7 | 6" (150) SKIP-DASH (WHITE) | |
| 8 | 4" (100) SOLID (WHITE) | |
| 9 | 12" (300) DIAGONAL (WHITE) | |
| 10 | 6" (150) SOLID (WHITE) | |
| 11 | 24" (600) STOP BAR (WHITE) | |
| 12 | 8" (200) SOLID (WHITE) | |
| 13 | 4" (100) PARKING (WHITE) | |

GENERAL NOTES

- TURN ARROW PAIRS SHALL BE PLACED AT 250' (75 m) INTERVALS AND SHALL BE EVENLY SPACED BETWEEN BOTH ENDS OF THE BIDIRECTIONAL LEFT TURN LANE. USE A MINIMUM OF TWO PAIRS PER BLOCK.
- THE SOLID YELLOW PAVEMENT MARKING [2] SHOULD GENERALLY START OR END NEAR THE RADIUS POINT OF EACH STREET RETURN EXCEPT WHERE ONE OR BOTH ENDS WOULD INCLUDE STOP BARS.
- THE SKIP-DASH PAVEMENT MARKING [1] OR [7] SHOULD BE CENTERED BETWEEN BOTH ENDS OF EACH CITY BLOCK AND SHALL BE PLACED SO THEY LINE UP ACROSS FROM EACH OTHER.
- USE LARGE ARROW SIZE FOR BOTH RURAL AND URBAN LOCATIONS. (SEE SECTION 780 FOR SYMBOLS TABLE)
- LANE LINE EXTENSIONS SHALL BE THE SAME COLOR AND WIDTH AS THE LANE LINE BEING EXTENDED.
- ALL WHITE SKIP-DASH LINES SHALL BE 6" IN WIDTH.

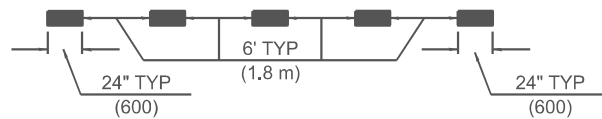

LANE LINE EXTENSIONS

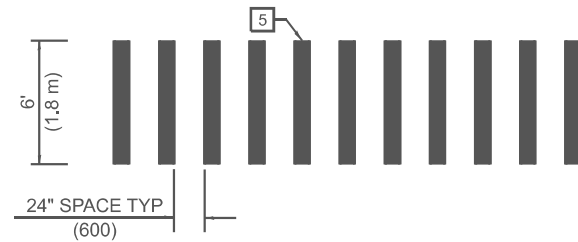

CROSSWALK DETAIL (DECATUR CITY LIMITS ONLY)

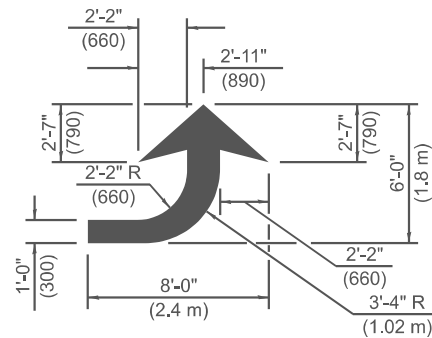

LEFT ARROW

REVERSE FOR RIGHT ARROW
AREA = 15.6 SQ.FT. (1.47 m²)
(WHITE)

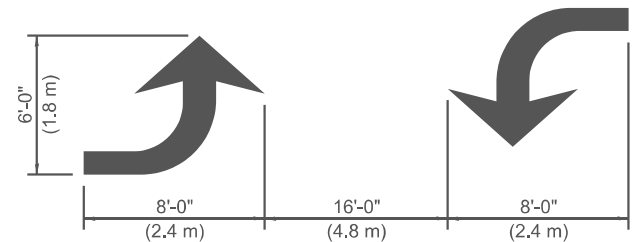

TYPICAL DOUBLE TURN ARROWS (WHITE)

NOT TO SCALE

Note: All dimensions are in INCHES (millimeters) unless otherwise shown.

DISTRICT 7 DETAIL NO. 78000001

USER NAME = levi.lund	DESIGNED -	REVISED -
	DRAWN -	REVISED -
	CHECKED -	REVISED -
PLOT DATE = 9/2/2025	DATE -	REVISED -

STATE OF ILLINOIS
DEPARTMENT OF TRANSPORTATION

PAVEMENT MARKING DETAILS

SCALE: SHEET 3 OF 8 SHEETS STA. TO STA.

F.A.I. RTE.	SECTION	COUNTY	TOTAL SHEETS	SHEET NO.
57	(25-6-1)RS-9 & (13-1)RS-3	*	32	27
CONTRACT NO. 74C61				
ILLINOIS FED. AID PROJECT				

*EFFINGHAM, CLAY

ISLANDS

OPTION 1

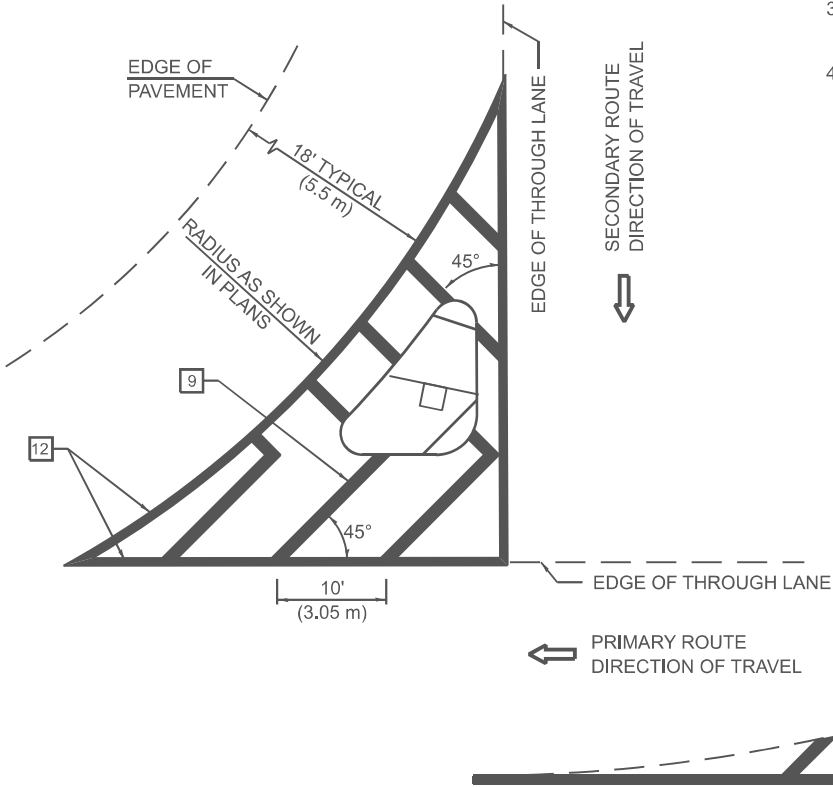

OPTION 2

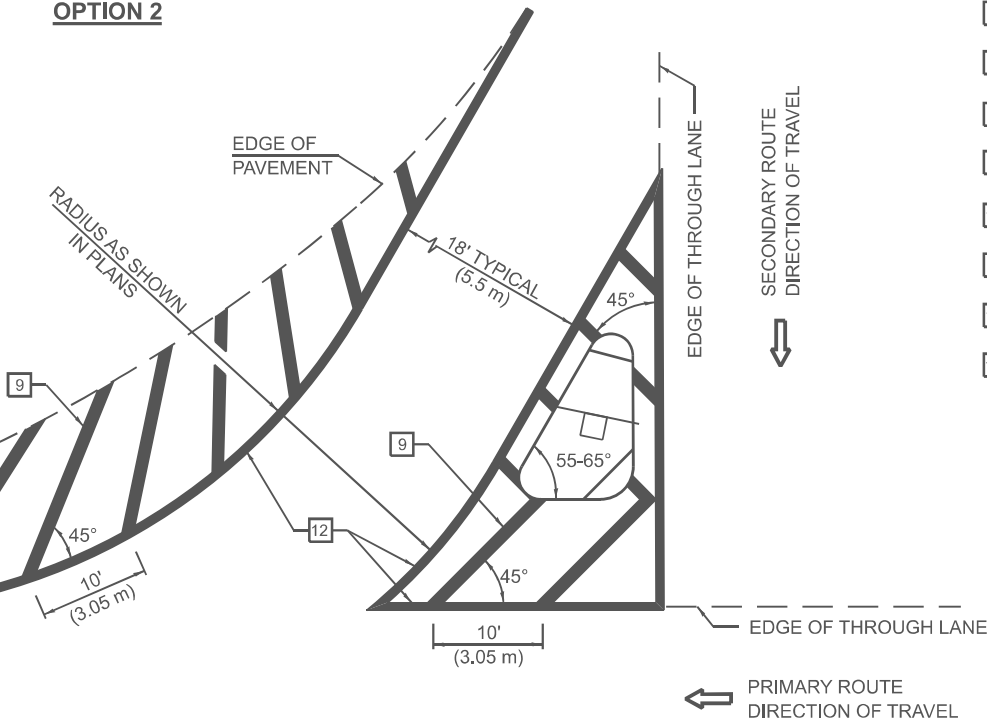

RURAL LEFT TURN STRIPING

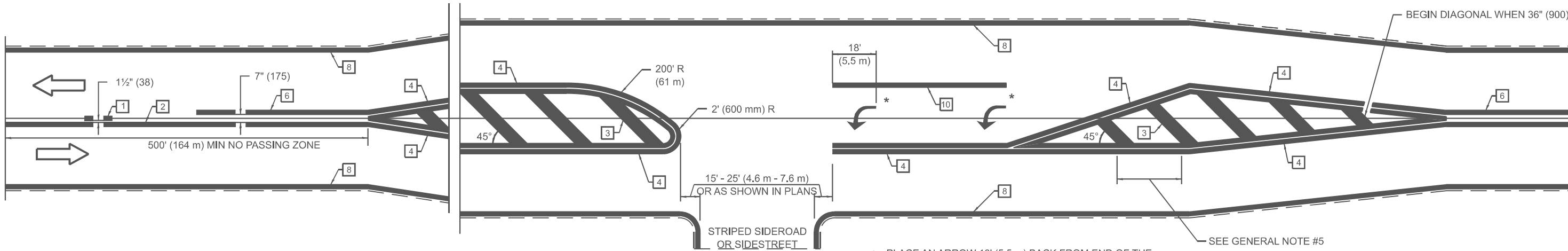

* PLACE AN ARROW 18' (5.5 m) BACK FROM END OF THE SOLID WHITE LINE. PLACE ANOTHER ARROW EVEN WITH THE BEGINNING OF THE SOLID WHITE LINE. SPACE ADDITIONAL ARROWS EVENLY UP TO 80' (24.4 m) MAXIMUM SPACING. USE MINIMUM OF 2 ARROWS.

GENERAL NOTES

1. RAISED AND CORRUGATED MEDIANS SHALL BE OUTLINED WITH [2].
2. SOME OF THE INFORMATION INCLUDED WITH THIS DETAIL MAY NOT BE APPLICABLE TO THIS IMPROVEMENT.
3. PAVEMENT MARKINGS ARE TO BE EXTENDED THROUGH OMISSIONS WHEN APPLICABLE.
4. FINAL PAVEMENT MARKINGS SHALL BE IN PLACE PRIOR TO PLACING ANY RAISED REFLECTIVE PAVEMENT MARKERS.
5. THE FOLLOWING CRITERIA SHALL BE USED FOR SELECTING THE DIAGONAL PAVEMENT MARKING SPACING:

<30 MPH (<50 km/h)	15' (4.5 m)
30-45 MPH (50-75 km/h)	20' (6.0 m)
>45 MPH (>75 km/h)	30' (9.0 m)
6. THE USE OF ISLAND STRIPING OPTION 1 OR OPTION 2 SHALL BE AS SHOWN ON THE PLANS.

PAVEMENT MARKING LEGEND

- | | |
|------|---------------------------------|
| [1] | 4" (100) SKIP-DASH (YELLOW) |
| [2] | 4" (100) SOLID (YELLOW) |
| [3] | 12" (300) DIAGONAL (YELLOW) |
| [4] | 4" (100) DOUBLE YELLOW (NARROW) |
| [5] | 12" (300) SOLID (WHITE) |
| [6] | 4" (100) DOUBLE YELLOW (WIDE) |
| [7] | 6" (150) SKIP-DASH (WHITE) |
| [8] | 4" (100) SOLID (WHITE) |
| [9] | 12" (300) DIAGONAL (WHITE) |
| [10] | 6" (150) SOLID (WHITE) |
| [11] | 24" (600) STOP BAR (WHITE) |
| [12] | 8" (200) SOLID (WHITE) |
| [13] | 4" (100) PARKING (WHITE) |

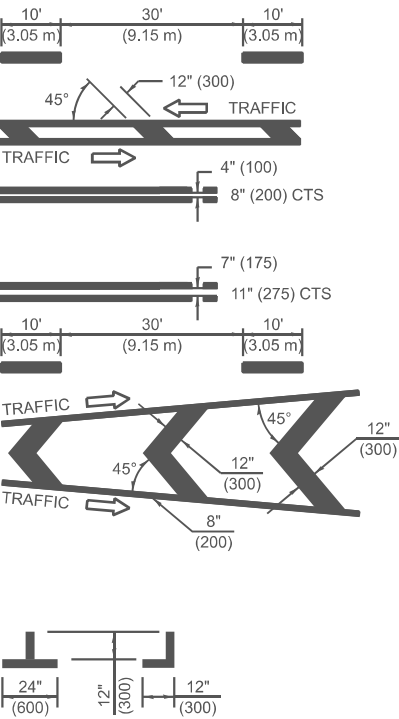

NOT TO SCALE
Note: All dimensions are in INCHES (millimeters) unless otherwise shown.

DISTRICT 7 DETAIL NO. 78000001

F.A.I. RTE.	SECTION	COUNTY	TOTAL SHEETS	SHEET NO.
57	(25-6-1)RS-9 & (13-1)RS-3	*	32	28
CONTRACT NO. 74C61				

ILLINOIS FED. AID PROJECT

*EFFINGHAM, CLAY

STATE OF ILLINOIS
DEPARTMENT OF TRANSPORTATION

PAVEMENT MARKING DETAILS

SCALE: SHEET 4 OF 8 SHEETS STA. TO STA.

USER NAME = levi,lund	DESIGNED -	REVISED -
	DRAWN -	REVISED -
	CHECKED -	REVISED -
PLOT DATE = 9/2/2025	DATE -	REVISED -

PAVEMENT MARKING LEGEND

RAILROAD CROSSING WITH NON-SIGNALIZED INTERSECTION

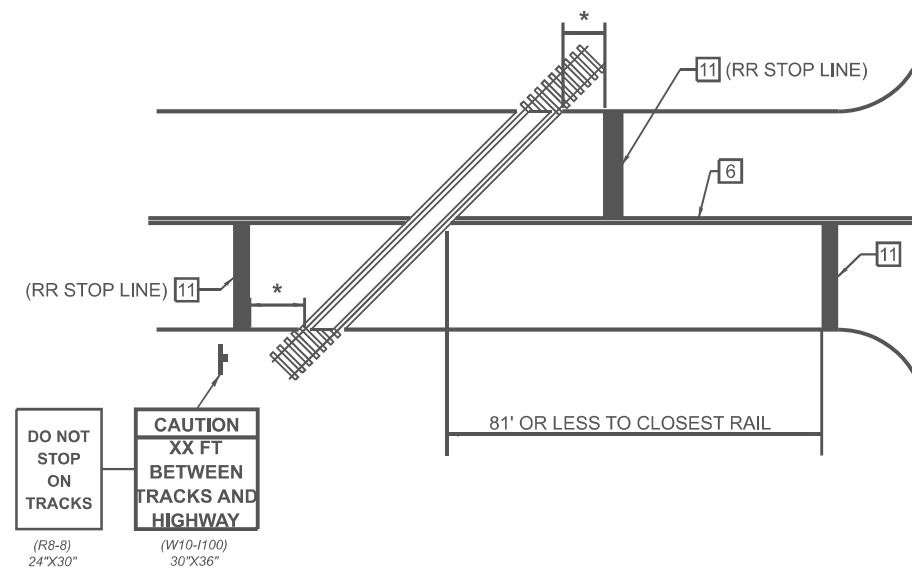

RAILROAD CROSSING WITH INTERCONNECT AND PRE-SIGNALS

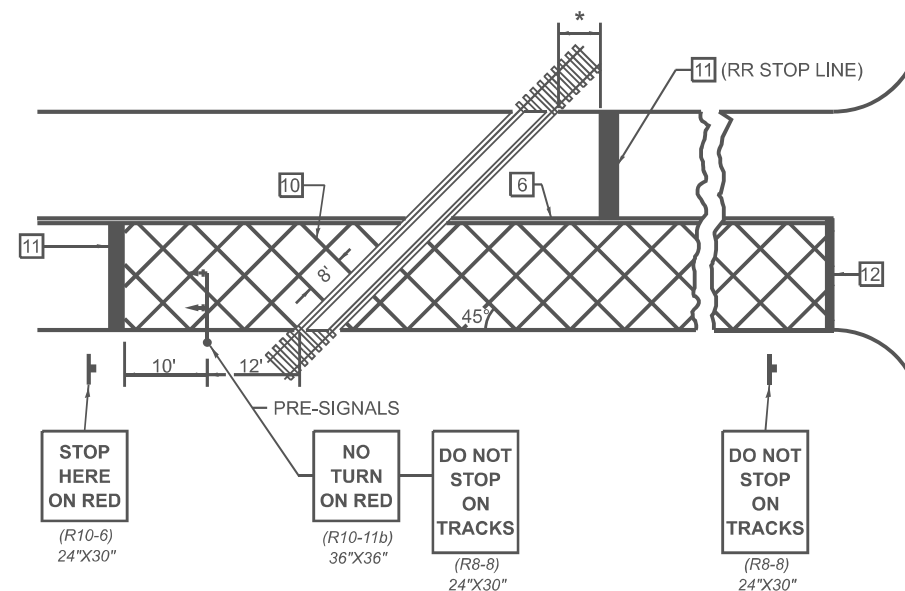

-
- Figure 10-10 illustrates typical cross-sections of a two-lane highway with a 12' travel lane. The figure shows four cross-sections (a, b, c, d) with dimensions in feet and meters.
- (a) Standard section:** 10' (3.05 m) shoulders on both sides, 30' (9.15 m) travel lane, and 10' (3.05 m) shoulders on both sides. Total width is 60' (18.30 m).
 - (b) Section with 10' shoulders and 12' travel lane:** 10' (3.05 m) shoulders on both sides, 30' (9.15 m) travel lane, and 10' (3.05 m) shoulders on both sides. Total width is 60' (18.30 m). Slopes are 45 degrees. Traffic flow is indicated by arrows.
 - (c) Section with 10' shoulders and 12' travel lane:** 10' (3.05 m) shoulders on both sides, 30' (9.15 m) travel lane, and 10' (3.05 m) shoulders on both sides. Total width is 60' (18.30 m). Slopes are 45 degrees. Traffic flow is indicated by arrows.
 - (d) Section with 10' shoulders and 12' travel lane:** 10' (3.05 m) shoulders on both sides, 30' (9.15 m) travel lane, and 10' (3.05 m) shoulders on both sides. Total width is 60' (18.30 m). Slopes are 45 degrees. Traffic flow is indicated by arrows.

1. SUPPLEMENTAL PAVEMENT MARKINGS TO BE INSTALLED ON APPROACHES TO INTERSECTIONS CONTROLLED BY TRAFFIC SIGNALS WHICH ARE INTERCONNECTED WITH THE RAILROAD WARNING SIGNALS.
2. EXTEND PAVEMENT MARKINGS TO THE INTERSECTION ONLY WHERE PRE-SIGNALS ARE USED.
3. WHEN PEDESTRIAN SIGNALS ARE PRESENT WITH INTERCONNECTED SIGNALS, WARNING SIGN W10-1101 (18"x24") SHALL BE PLACED NEAR EACH PEDESTRIAN SIGNAL HEAD. COUNTDOWN PEDESTRIAN SIGNAL HEADS SHALL NOT BE UTILIZED ALONG WITH INTERCONNECTED SIGNALS.
4. PLEASE REFER TO THE IDOT BUREAU OF OPERATION MEMO OPS T-06 DATED DECEMBER 1, 2020 FOR ADDITIONAL INFORMATION.

CAUTION

**WALK TIME
SHORTENED
WHEN TRAIN
APPROACHES**

- * 15' FROM NEAR RAIL OR 8' FROM AND PARALLEL TO GATE IF PRESENT
- ** WARNING SIGN W10-I100 SHALL BE USED AS AN INTERIM MEASURE AT INTERCONNECTED SIGNAL LOCATIONS WHERE PRE-SIGNALS ARE TO BE INSTALLED IN THE FUTURE. THIS SIGN SHALL BE REMOVED WHEN THE PRE-SIGNALS ARE INSTALLED AND THE PAVEMENT MARKINGS ARE EXTENDED TO THE INTERSECTION.

NOT TO SCALE

Note: All dimensions are in INCHES
(millimeters) unless otherwise shown.

DISTRICT 7 DETAIL NO. 78000001

USER NAME = levl.jund	DESIGNED -	REVISED -
	DRAWN -	REVISED -
	CHECKED -	REVISED -
PLOT DATE = 9/2/2025	DATE -	REVISED -

STATE OF ILLINOIS
DEPARTMENT OF TRANSPORTATION

PAVEMENT MARKING DETAILS

SCALE:	SHEET 5	OF 8	SHEETS	STA.	TO STA.
--------	---------	------	--------	------	---------

F.A.I RTE.	SECTION	COUNTY	TOTAL SHEETS	SHEET NO.
57	(25-6-1)RS-9 & (13-1)RS-3	*	32	29
		CONTRACT NO. 74C61		
ILLINOIS LEAD AND PROJECT				

ILLINOIS	FED. AID PROJECT
----------	------------------

*EETINGHAM CLAY

MODEL: Pavement Marking Detail-3 [Sheet]
FILE NAME: c:\pw work\pwidth\lundin\d0910589\D774C61-sht-details.dgn

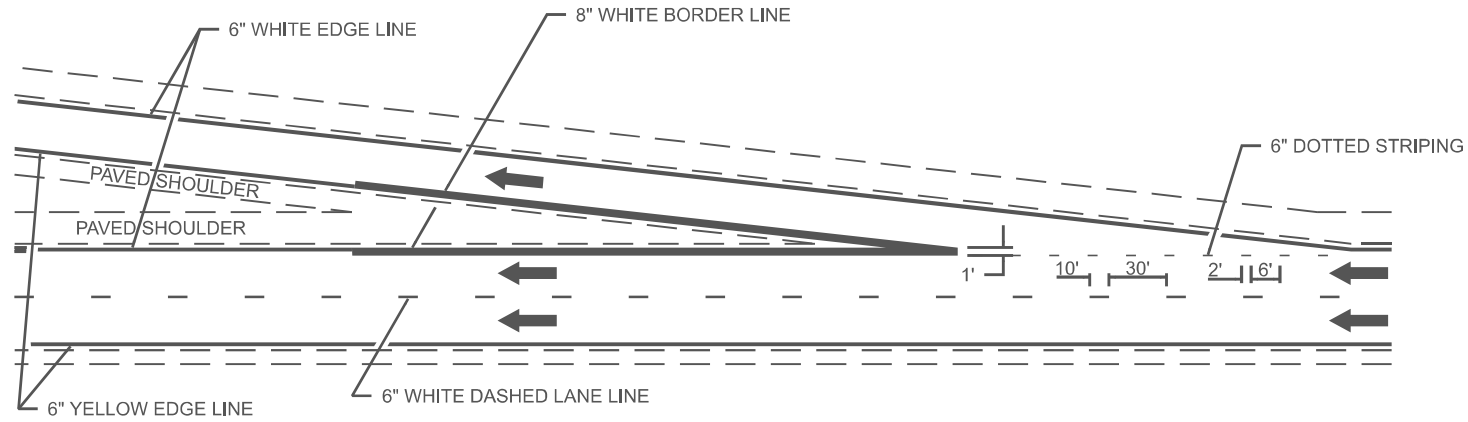

TYPICAL EXIT RAMP MARKING

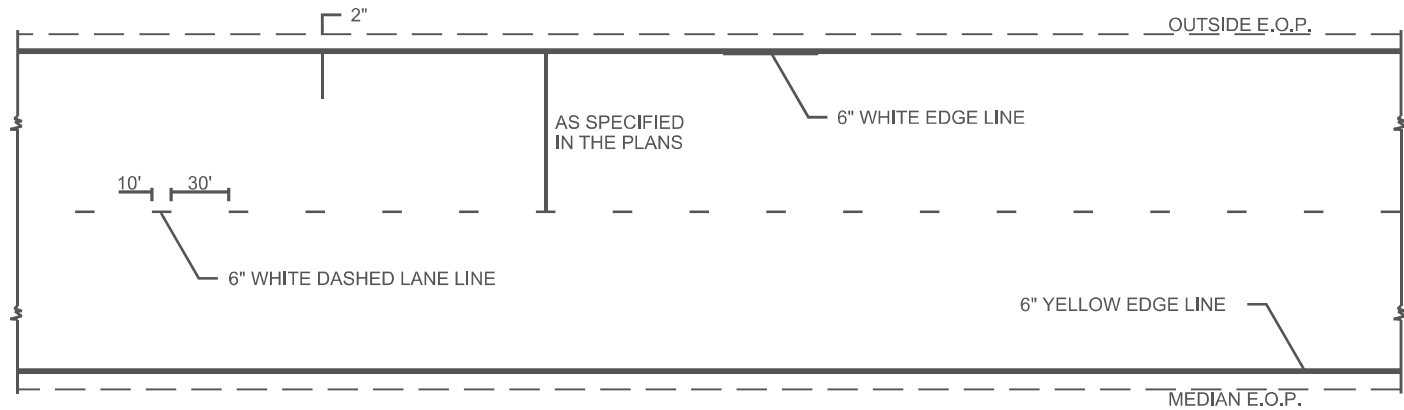

TYPICAL CENTERLINE & EDGELINE MARKINGS

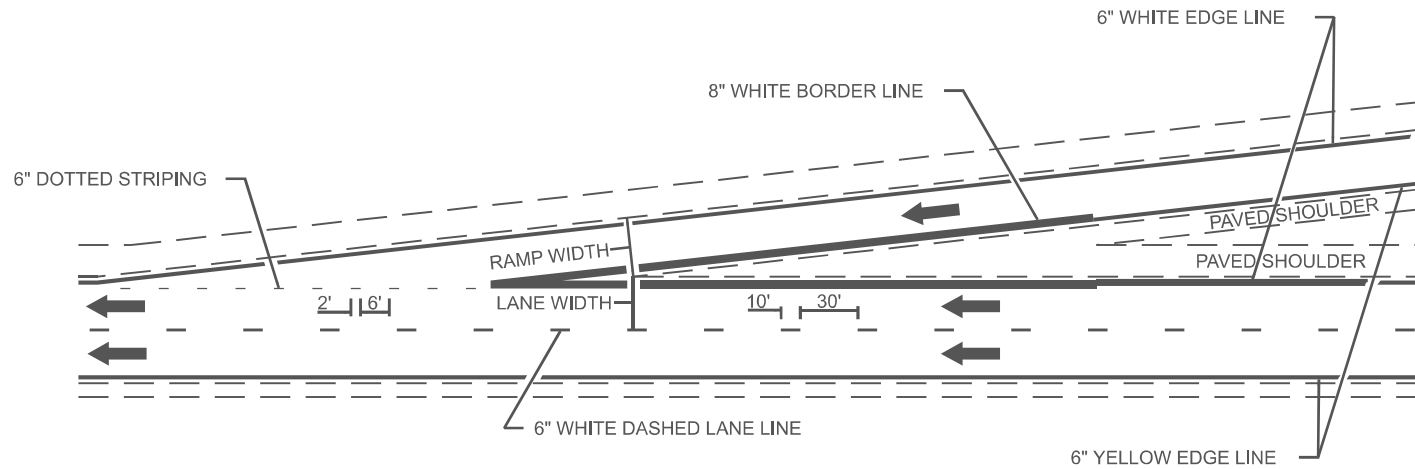

TYPICAL ENTRANCE RAMP MARKING

NOT TO SCALE

DISTRICT 7 DETAIL NO. 78000002

	USER NAME = levi.lund	DESIGNED -	REVISED -	STATE OF ILLINOIS DEPARTMENT OF TRANSPORTATION	PAVEMENT MARKING DETAILS			F.A.I RTE.	SECTION	COUNTY	TOTAL SHEETS	SHEET NO.
		DRAWN -	REVISED -					57	(25-6-1)RS-9 & (13-1)RS-3	*	32	30
		CHECKED -	REVISED -					CONTRACT NO. 74C61				
	PLOT DATE = 9/2/2025	DATE -	REVISED -		SCALE:	SHEET 6	OF 8 SHEETS	STA.	TO STA.	ILLINOIS FED. AID PROJECT		

*EFFINGHAM, CLAY

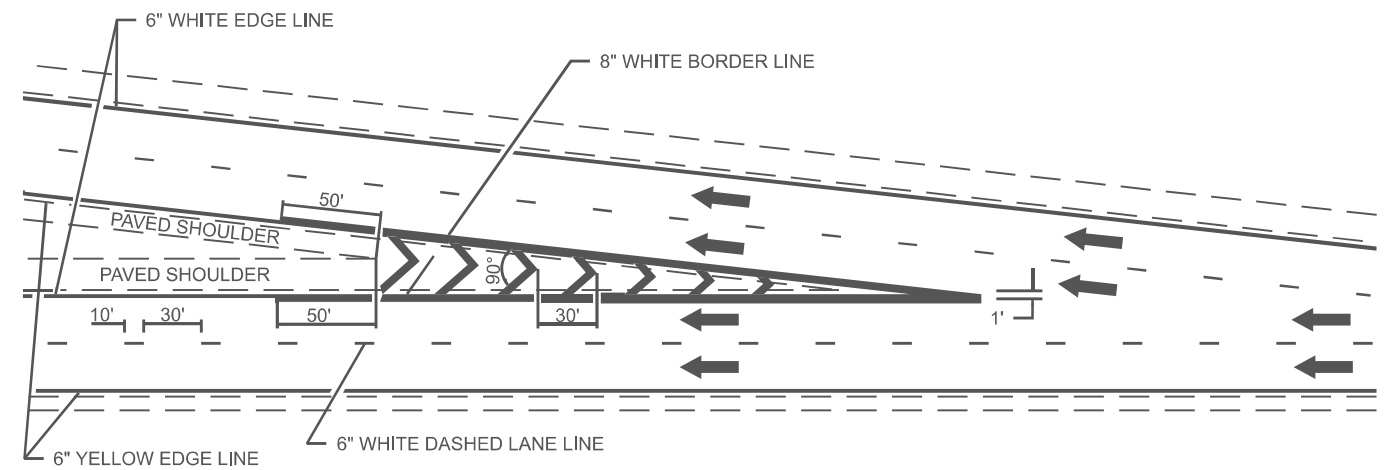
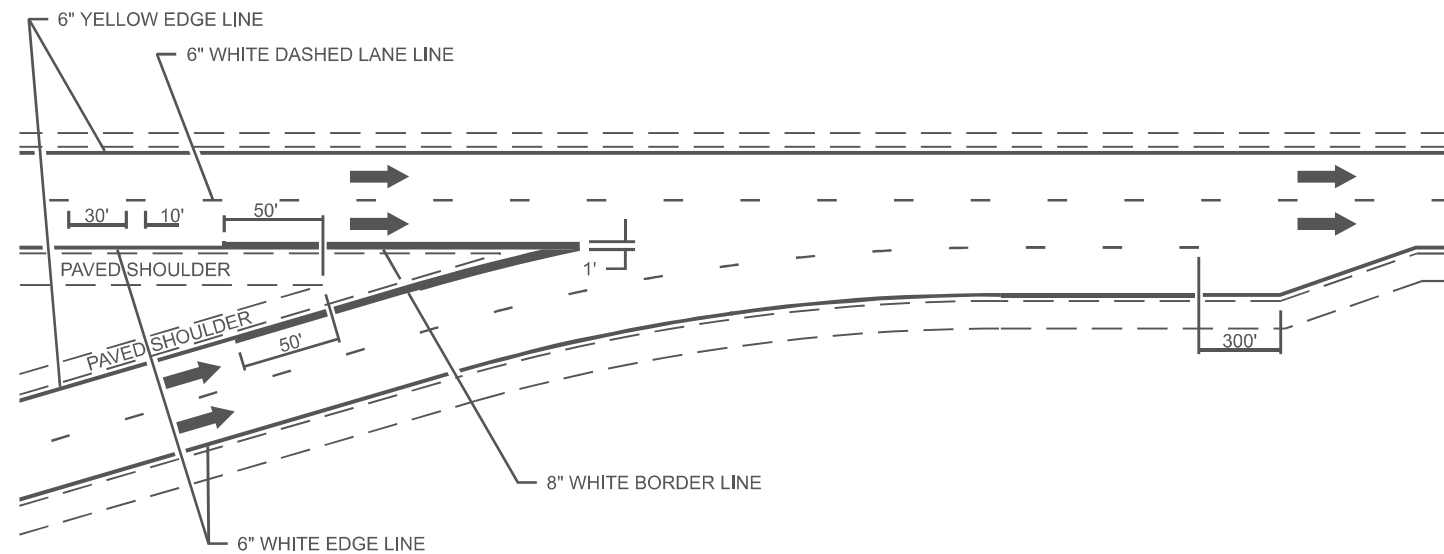

AERIAL SPEED CHECK ZONES

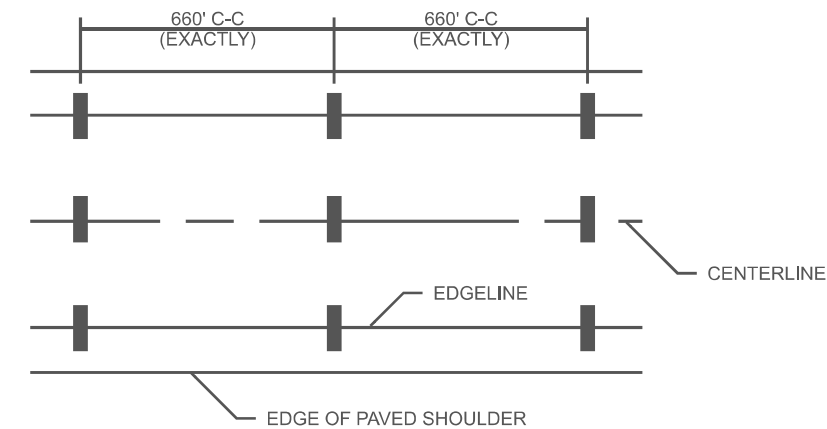

IT WILL BE NECESSARY TO HAVE A REPRESENTATIVE
OF THE STATE POLICE PRESENT SO THAT THE ACCURACY
OF MEASUREMENT CAN BE ATTESTED TO IN COURT.

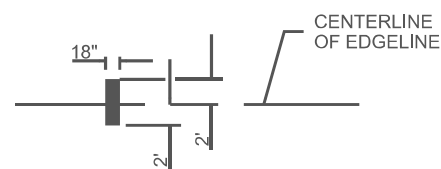

NOT TO SCALE

DISTRICT 7 DETAIL NO. 78000002

F.A.I RTE.	SECTION	COUNTY	TOTAL SHEETS	SHEET NO.
57	(25-6-1)RS-9 & (13-1)RS-3	*	32	31
		CONTRACT NO. 74C61		
		ILLINOIS	FED. AID PROJECT	

FILE NAME:	USER NAME = levj.lund	DESIGNED -	REVISED -	STATE OF ILLINOIS DEPARTMENT OF TRANSPORTATION	PAVEMENT MARKING DETAILS			
		DRAWN -	REVISED -					
		CHECKED -	REVISED -					
	PLOT DATE = 9/2/2025	DATE -	REVISED -		SCALE:	SHEET 7	OF 8 SHEETS	STA.
								TO STA.

*EFFINGHAM,CLAY

