

TEMPORARY RADIO INTERCONNECT TO JOLIET RD. AT BRAINARD AVE. (SEE TEMPORARY INTERCONNECT PLANS)

TEMPORARY RADIO INTERCONNECT TO US RTE 12/20/45 AT COUNTRYSIDE PLAZA (SEE TEMPORARY INTERCONNECT PLANS)

TEMPORARY RADIO INTERCONNECT TO JOLIET RD. AT QUARRY SHOPPING CENTER DRIVEWAY (SEE TEMPORARY INTERCONNECT PLANS)

TEMPORARY RADIO INTERCONNECT TO US RTE 12/20/45 AT 63RD STREET (SEE TEMPORARY INTERCONNECT PLANS)

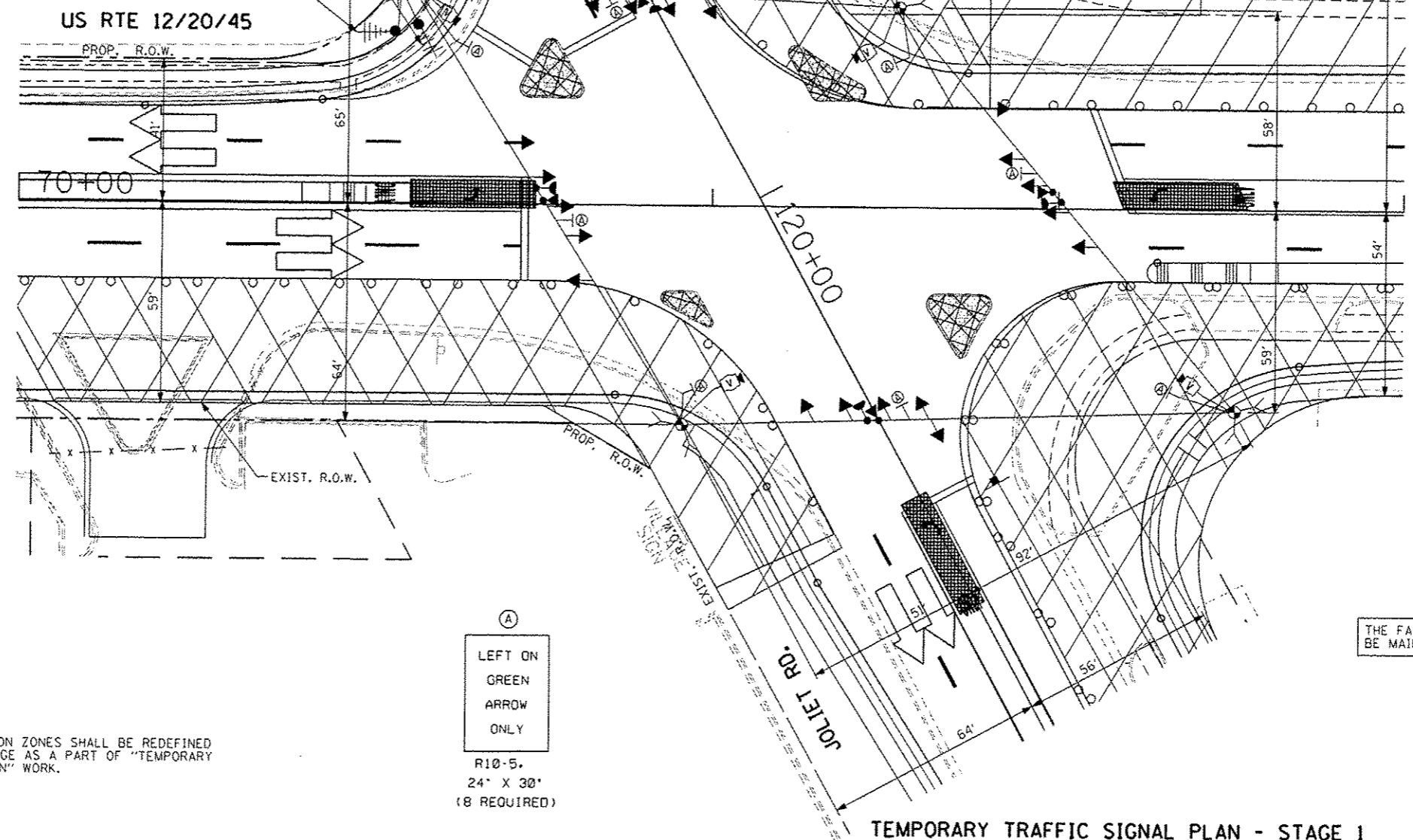

NOTE 1: THE FAR OUT VIDEO DETECTION ZONES SHALL BE REDEFINED FOR EACH CONSTRUCTION STAGE AS A PART OF "TEMPORARY TRAFFIC SIGNAL INSTALLATION" WORK.

(A)
LEFT ON GREEN ARROW ONLY
R10-5.
24" X 30"
(8 REQUIRED)

THE FAR OUT VIDEO DETECTION ZONES WILL BE MAINTAINED AS SHOWN ON SHEET NO. 86

THE TRAFFIC SIGNAL CONTROL EQUIPMENT FOR THIS PROJECT SHALL BE "EAGLE" TO MATCH THE EXISTING ADJACENT SYSTEM.

TEMPORARY TRAFFIC SIGNAL PLAN - STAGE 1

FILE NAME * #FILE#	USER NAME * #USER#	DESIGNED - PKG	REVISED -	AGGENDUM NO. D. 12/26/2013	STATE OF ILLINOIS DEPARTMENT OF TRANSPORTATION	TEMPORARY TRAFFIC SIGNAL INSTALLATION PLAN US RTE 122045 (LAGRANGE RD.) AT JOLIET ROAD STAGE 1 (SHEET 3 OF 5)		F.A.P. R.T.E.	SECTION	COUNTY	TOTAL SHEETS	SHEET NO.
	PLOT SCALE * #SCALE#	CHECKED - PKG	REVISED -			330	2010-082-1	COOK	152	87		
PLOT DATE * #DATE#	DATE - 12/11/2013	REVISED -			SCALE: 1" = 20'	SHEET NO. OF SHEETS	STA. TO STA.	FED. ROAD DIST. NO. . ILLINOIS FED. AID PROJECT CONTRACT NO. 60L73				