

TEMPORARY PAVEMENT TYPICAL SECTION

NOTES:

1. FOR ADDITIONAL TRAFFIC CONTROL AND SIGN DETAILS SEE HIGHWAY STANDARDS 701601, 701701 AND DISTRICT ONE STANDARD TC14.
2. SEE TEMPORARY TRAFFIC SIGNAL PLANS FOR MODIFICATIONS AT IL 64/VILLA AVE AND IL 64/SHOPPING CENTER.
3. ALL WB LEFT TURNING VEHICLES ONTO SB VILLA AVE WILL BE DETOURED. SEE SHEET 20.
4. TEMPORARY RAISED REFLECTIVE PAVEMENT MARKERS WILL BE INSTALLED ALONG ALL TEMPORARY PAVEMENT MARKINGS IN ACCORDANCE WITH DISTRICT ONE DETAIL TC11.

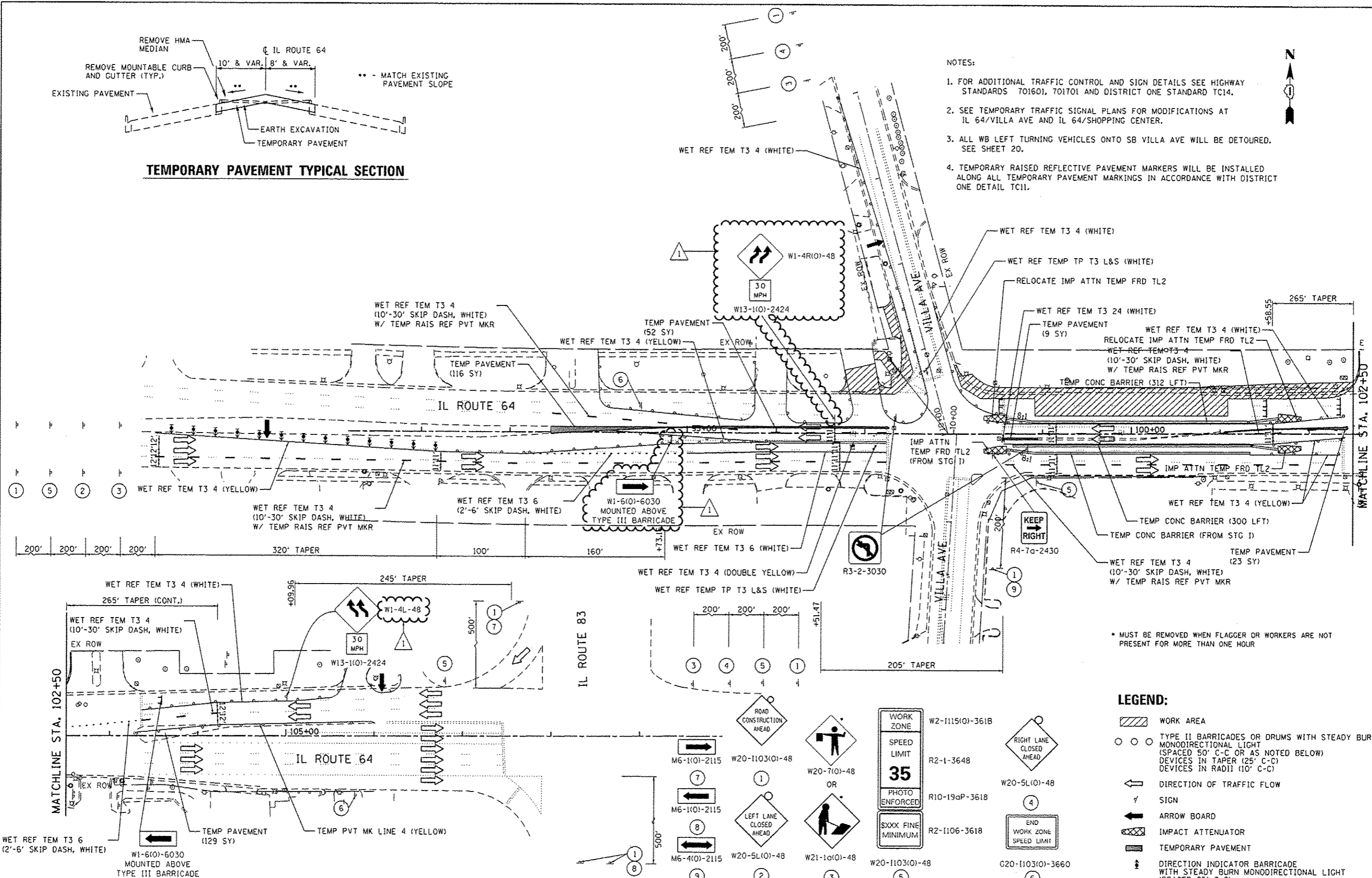

* MUST BE REMOVED WHEN FLAGGER OR WORKERS ARE NOT PRESENT FOR MORE THAN ONE HOUR

LEGEND:

- WORK AREA
- TYPE II BARRICADES OR DRUMS WITH STEADY BURN MONODIRECTIONAL LIGHT (SPACED 50' C-C OR AS NOTED BELOW) DEVICES IN TAPER (25' C-C) DEVICES IN RADII (10' C-C)
- DIRECTION OF TRAFFIC FLOW
- SIGN
- ARROW BOARD
- IMPACT ATTENUATOR
- TEMPORARY PAVEMENT
- DIRECTION INDICATOR BARRICADE WITH STEADY BURN MONODIRECTIONAL LIGHT (SPACED 25' C-C)

FILE NAME = I:\7278\21818 - IL 64 Over Salt Creek\CD\Drawings\Sheets\0180724-v1-1.dwg

COLLINS ENGINEERS
 1111 S. WASHINGTON ST.
 SUITE 200
 CHICAGO, IL 60605
 (312) 467-1100
 WWW.COLLENGEERS.COM

USER NAME: rge11	DESIGNED: -	REVISED: 12/20/2013 R.A.G.
PLOT SCALE: 1/8" = 1'-0"	DRAWN: -	REVISED: -
PLOT DATE: 12/28/2013	CHECKED: -	REVISED: -
	DATE: -	REVISED: -

**STATE OF ILLINOIS
 DEPARTMENT OF TRANSPORTATION**

**ILLINOIS ROUTE 64 (NORTH AVE) OVER SALT CREEK
 MAINTENANCE OF TRAFFIC - STAGE 2**

F.A.P. RTE. 307	SECTION 1318-BR	COUNTY DuPAGE	TOTAL SHEETS 111	SHEET NO. 26
CONTRACT NO. 60V24			ILLINOIS FED. AID PROJECT	

SCALE: SHEET OF SHEETS STA. TO STA.