

**SIGNAL HEAD PLACEMENT FOR STAGE 1**

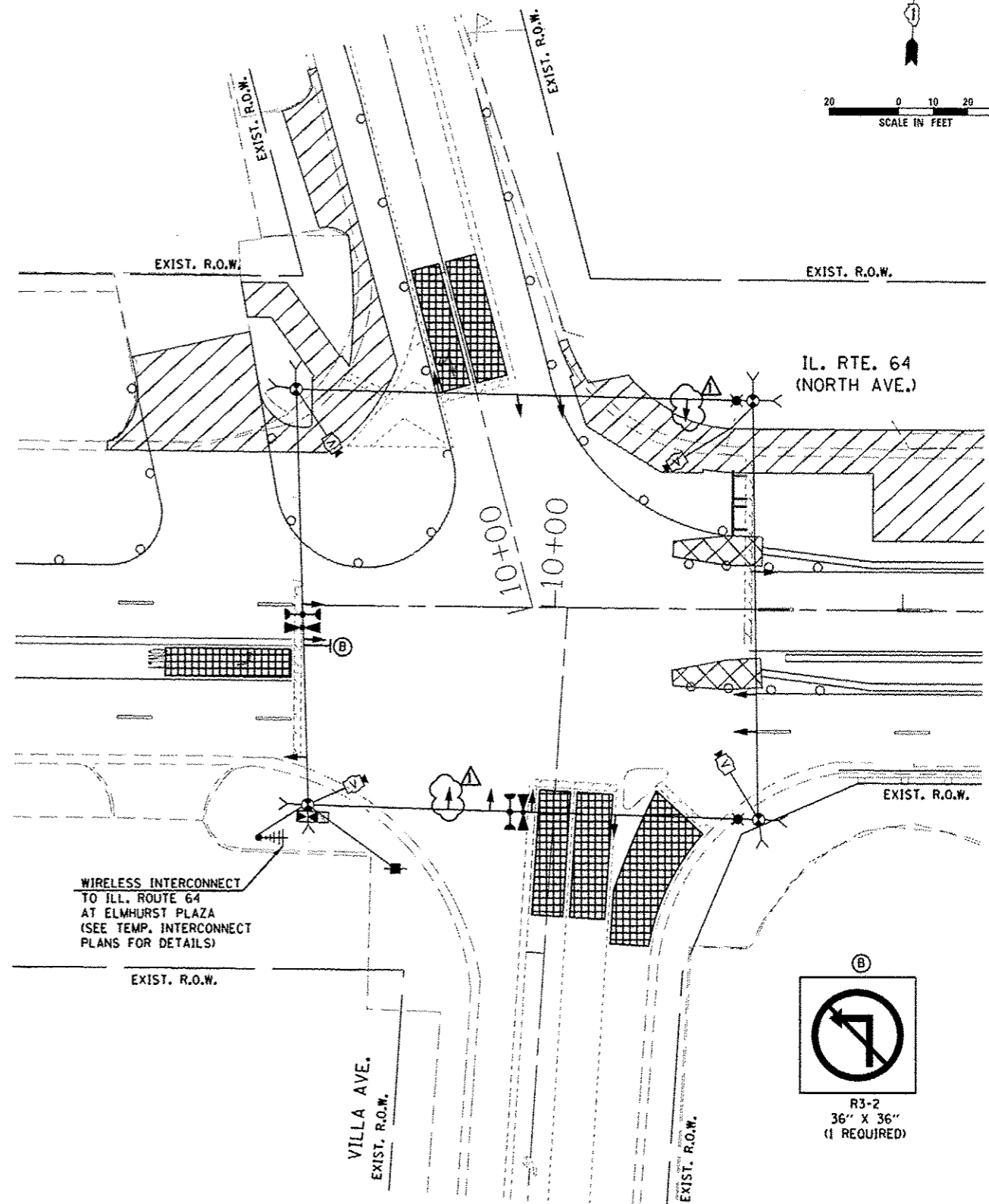

**SIGNAL HEAD PLACEMENT FOR STAGE 2**

THE TRAFFIC SIGNAL CONTROL EQUIPMENT FOR THIS PROJECT SHALL BE "EAGLE" TO MATCH THE EXISTING ADJACENT SYSTEM.

J:\3003\DCM\CADD Sheets\1571-sht-1s-ill.dgn 08-JAN-2014 15:58 TIME\$



|             |                      |
|-------------|----------------------|
| USER NAME   | * mgrv-vids          |
| DESIGNED    | - MG                 |
| DRAWN       | - MG                 |
| CHECKED     | - KGP                |
| DATE        | - 10/25/2013         |
| PLLOT SCALE | * 40.00000001.000000 |
| PLLOT DATE  | * 05-JAN-2014 15:54  |

|          |              |         |                         |
|----------|--------------|---------|-------------------------|
| DESIGNED | - MG         | REVISED | A - ADDENDUM 1 01/08/14 |
| DRAWN    | - MG         | REVISED | -                       |
| CHECKED  | - KGP        | REVISED | -                       |
| DATE     | - 10/25/2013 | REVISED | -                       |

STATE OF ILLINOIS  
DEPARTMENT OF TRANSPORTATION

|  |             |              |              |
|--|-------------|--------------|--------------|
| TEMPORARY TRAFFIC SIGNAL INSTALLATION PLAN       |             |              |              |
| ILLINOIS ROUTE 64 (NORTH AVENUE) AT VILLA AVENUE |             |              |              |
| STAGE 1 AND STAGE 2                              |             |              |              |
| SCALE: AS NOTED                                  | SHEET NO. 9 | OF 26 SHEETS | STA. TO STA. |

|                           |         |        |                    |
|---------------------------|---------|--------|--------------------|
| F.A.P. RTE.               | SECTION | COUNTY | TOTAL SHEET NO.    |
| 307                       | 131B-BR | DUPAGE | 111 52             |
|                           |         |        | CONTRACT NO. 60V24 |
| ILLINOIS FED. AID PROJECT |         |        |                    |