

**IL RTE. 64 EXISTING TYPICAL SECTION**  
STA. 93+46.04 TO STA. 97+27.49

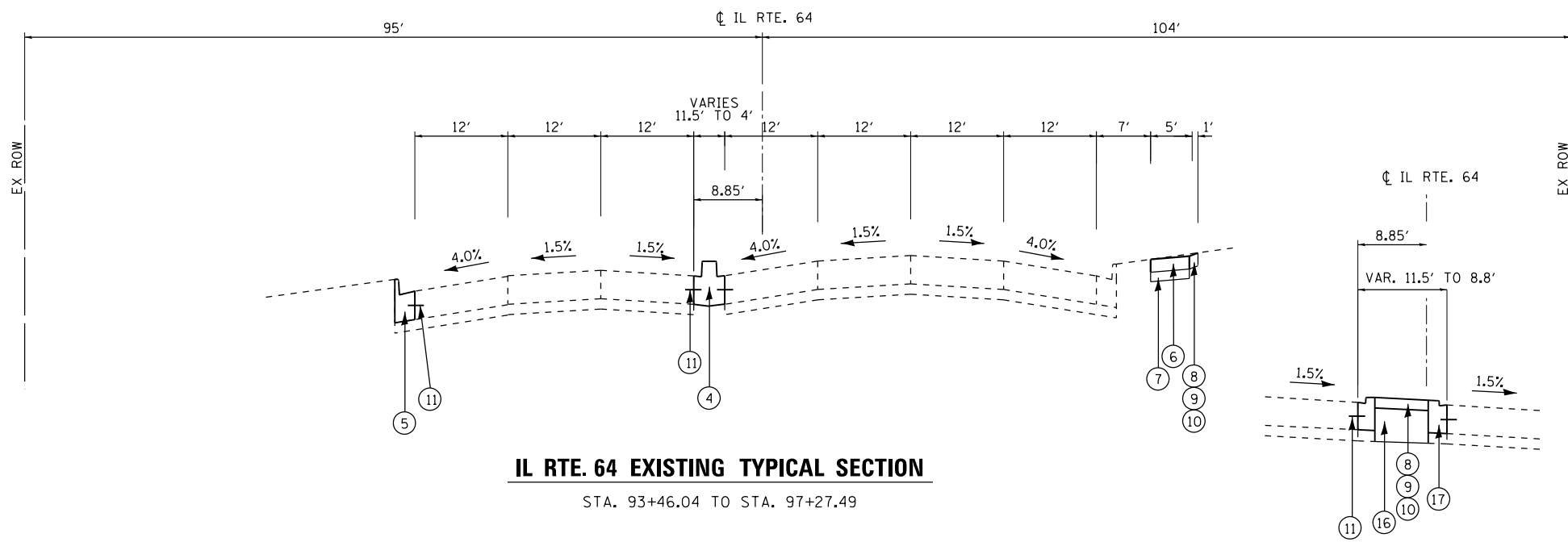

**IL RTE. 64 EXISTING TYPICAL SECTION**  
STA. 93+46.04 TO STA. 97+27.49

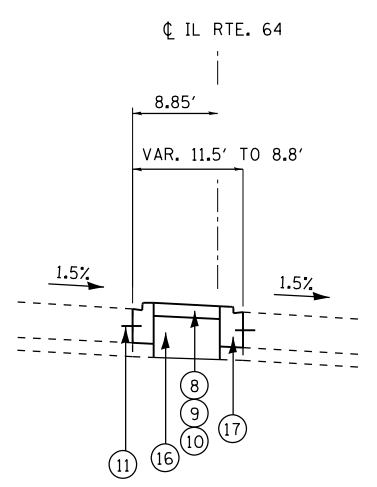

**DETAIL A**  
STA. 93+46.04 TO STA. 93+89.76

**EXISTING LEGEND:**

- (A) EXISTING PCC PAVEMENT, 11 INCH (JOINTED)
  - (B) SAWCUT (INCLUDED IN THE COST OF PAVEMENT REMOVAL)
  - (C) EXISTING PCC SOLID MEDIAN
  - (D) EXISTING SIDEWALK
  - (E) EXISTING GUARDRAIL (SEE PLANS FOR LOCATION)
  - (F) EXISTING CURB & GUTTER
  - (G) EXISTING GROUND
- TO BE REMOVED

**PROPOSED LEGEND:**

- (1) PCC PAVEMENT, 11" (JOINTED)
- (2) STABILIZED SUBBASE - HMA, 4-1/2 INCH
- (3) STEEL PLATE BEAM GUARDRAIL (SEE PLANS FOR LOCATION)
- (4) CONCRETE MEDIAN, TYPE SB 6.12
- (5) COMBINATION CONCRETE CURB AND GUTTER TYPE B-6.24
- (6) PORTLAND CEMENT CONCRETE SIDEWALK, 5 INCH
- (7) SUBBASE GRANULAR TY B, 4 INCH
- (8) EROSION CONTROL BLANKET
- (9) TOPSOIL FURNISH AND PLACE, 4"
- (10) SEEDING, CLASS 2A
- (11) TIE BAR, NO. 6 X 30 @ 24 INCH SPACING
- (12) AGGREGATE SUBGRADE IMPROVEMENT, 12 INCH
- (13) CONCRETE MEDIAN SURFACE, 4"
- (14) AGGREGATE FILL
- (15) COMBINATION CONCRETE CURB AND GUTTER TYPE M-6.12
- (16) EARTH EMBANKMENT
- (17) COMBINATION CONCRETE CURB AND GUTTER TYPE B-6.12

**NOTES:**

AGGREGATE FILL SHALL BE OF THE GRADATION SPECIFIED IN ART 606.09 OF THE STANDARD SPECIFICATIONS AND SHALL BE PLACED IN LAYERS 4 IN THICK AND COMPACTED. THE COST OF THE AGGREGATE FILL SHALL BE INCLUDED IN THE COST OF CONCRETE MEDIAN SURFACE, 4 IN.

TIE BARS USED TO TIE PROP. JOINTED PCC PAVEMENT INTO EXIST. PCC PAVEMENT, SHALL BE INCIDENTAL TO THE COST OF PCC PAVEMENT, 11" (JOINTED).

TIE BARS USED TO TIE PROP. CURB AND GUTTER INTO EXIST. PCC PAVEMENT, TIE BARS USED TO TIE PROP. JOINTED PCC PAVEMENT INTO PROP. CURB AND GUTTER SHALL BE INCIDENTAL TO THE COST OF COMBINATION CONCRETE CURB AND GUTTER, OF THE TYPE SPECIFIED.

FILE NAME = I:\7290\729018 - IL 64 Over Salt Creek\CADD\Cadd Sheets\PI39308-shr-typical.dgn

**COLLINS ENGINEERS**  
123 N. Wacker Dr.  
Suite 300  
Chicago, IL 60606  
Tel: (312) 704-9300  
Fax: (312) 704-9320  
www.collinseng.com  
ILLINOIS PROFESSIONAL DESIGN FIRM LICENSE NO. 084-1000993

|                             |            |           |
|-----------------------------|------------|-----------|
| USER NAME = mpell           | DESIGNED - | REVISED - |
| PLOT SCALE = 20.0000' / in. | DRAWN -    | REVISED - |
| PLOT DATE = 10/25/2013      | CHECKED -  | REVISED - |
|                             | DATE -     | REVISED - |

**STATE OF ILLINOIS  
DEPARTMENT OF TRANSPORTATION**

|  |                              |
|--|------------------------------|
| <b>IL ROUTE 64 (NORTH AVE)<br/>TYPICAL SECTION</b> |                              |
| SCALE:   | SHEET OF SHEETS STA. TO STA. |

|                           |         |        |              |           |
|---------------------------|---------|--------|--------------|-----------|
| F.A.P. RTE.               | SECTION | COUNTY | TOTAL SHEETS | SHEET NO. |
| 307                       | 1318-BR | DuPAGE | 111          | 14        |
| <b>CONTRACT NO. 60V24</b> |         |        |              |           |
| ILLINOIS FED. AID PROJECT |         |        |              |           |