

REMOVAL OF EXISTING TRAFFIC SIGNAL EQUIPMENT

THE FOLLOWING EXISTING TRAFFIC SIGNAL EQUIPMENT SHALL BE REMOVED BY THE CONTRACTOR AND SHALL REMAIN THE PROPERTY OF THE AGENCY LISTED BELOW. THE CONTRACTOR SHALL SAFELY STORE AND ARRANGE FOR PICK UP OF ALL EQUIPMENT TO BE RETURNED TO THE LISTED AGENCY AS PER THE TRAFFIC SIGNAL SPECIFICATIONS.

- AGENCY: VILLAGE OF LYONS
 2 EACH LIGHT DETECTOR AND BEACON
 1 EACH LIGHT DETECTOR AMPLIFIER

THE FOLLOWING ITEMS SHALL BE REMOVED BY THE CONTRACTOR AND SHALL BE DISPOSED OF BY THEM OUTSIDE THE RIGHT-OF-WAY AT THEIR EXPENSE. THE SALVAGE VALUE OF THE REMOVED EQUIPMENT SHALL BE REFLECTED IN THE CONTRACT BID PRICE.

- 4 EACH SIGNAL HEAD, 1 - FACE, 3 - SECTION
- 8 EACH SIGNAL HEAD, 1 - FACE, 5 - SECTION
- 4 EACH PEDESTRIAN SIGNAL HEAD, 1 - FACE
- 1 EACH PEDESTRIAN SIGNAL HEAD, 2 - FACE
- 5 EACH PEDESTRIAN PUSHBUTTON
- 4 EACH TRAFFIC SIGNAL BACKPLATE
- 5 EACH TRAFFIC SIGNAL POST
- 3 EACH ALUMINUM MAST ARM AND POLE
- 1 EACH STEEL MAST ARM AND POLE
- 1 EACH SERVICE INSTALLATION
- 1 EACH CONTROLLER AND CABINET (COMPLETE)

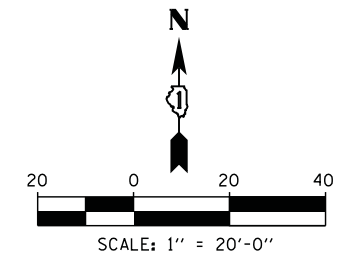

CONSTRUCTION NOTES:

- ① DISCONNECT THE WEST INTERCONNECT FIBER AND TRACER CABLES. COIL THE CABLES AWAY FROM EXPOSED TERMINALS. INSTALL DUST CAPS TO PROTECT THE FIBER OPTIC CABLE CONNECTORS AND PLUGS. PULL EXISTING 24F FIBER OPTIC CABLE AND TRACER BACK TO THE FIRST SYSTEM HANDHOLE WEST OF THE INTERSECTION AND STORE DURING TEMPORARY SIGNAL OPERATION.
- ② DUE TO THE PRESENCE OF A RED LIGHT RUNNING (RLR) CAMERA AT THIS LOCATION, CONTRACTOR SHALL NOTIFY THE VILLAGE AND RLR CAMERA COMPANY PRIOR TO THE START OF CONSTRUCTION. THE VILLAGE OR THE RLR CAMERA COMPANY SHALL MAKE THE CAMERA INOPERATIVE FOR THE TIME OF CONSTRUCTION. ANY RLR CAMERA EQUIPMENT THAT IS IN CONFLICT WITH THE PROPOSED CONSTRUCTION SHALL BE REMOVED BY ITS RESPECTIVE OWNERS PRIOR TO THE START OF CONSTRUCTION.

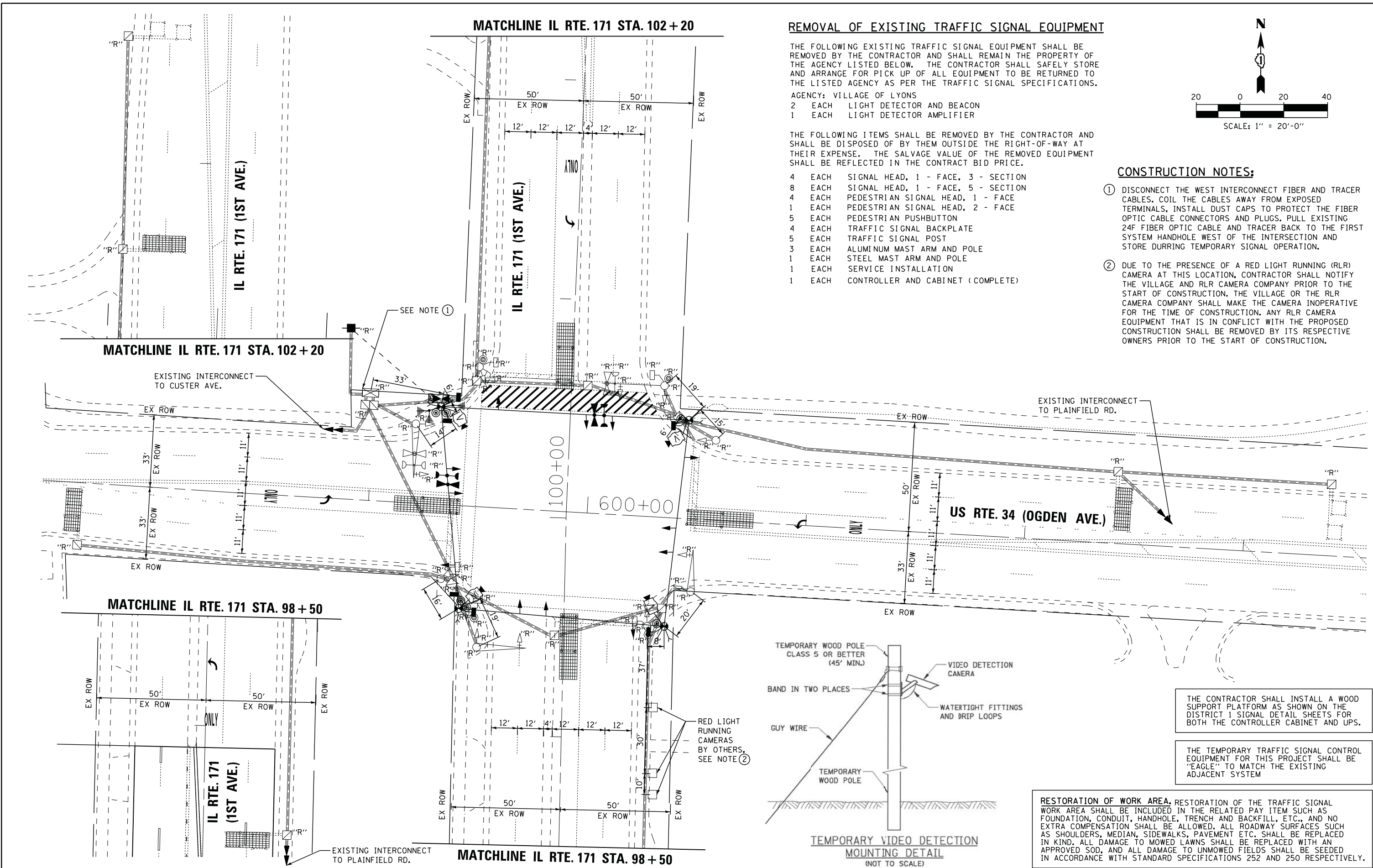

THE CONTRACTOR SHALL INSTALL A WOOD SUPPORT PLATFORM AS SHOWN ON THE DISTRICT 1 SIGNAL DETAIL SHEETS FOR BOTH THE CONTROLLER CABINET AND UPS.

THE TEMPORARY TRAFFIC SIGNAL CONTROL EQUIPMENT FOR THIS PROJECT SHALL BE "EAGLE" TO MATCH THE EXISTING ADJACENT SYSTEM

RESTORATION OF WORK AREA. RESTORATION OF THE TRAFFIC SIGNAL WORK AREA SHALL BE INCLUDED IN THE RELATED PAY ITEM SUCH AS FOUNDATION, CONDUIT, HANDHOLE, TRENCH AND BACKFILL, ETC., AND NO EXTRA COMPENSATION SHALL BE ALLOWED. ALL ROADWAY SURFACES SUCH AS SHOULDERS, MEDIAN, SIDEWALKS, PAVEMENT ETC. SHALL BE REPLACED IN KIND. ALL DAMAGE TO MOWED LAWNS SHALL BE REPLACED WITH AN APPROVED SOD, AND ALL DAMAGE TO UNMOWED FIELDS SHALL BE SEEDED IN ACCORDANCE WITH STANDARD SPECIFICATIONS 252 AND 250 RESPECTIVELY.

FILE NAME =	USER NAME = \$USER\$	DESIGNED - DW	REVISED -
N:\Projects\312055\DesignCAD\Sheet Files\60V34rwa34temp171.dgn		DRAWN - LV	REVISED -
	PLOT SCALE = \$SCALE\$	CHECKED - KM	REVISED -
	PLOT DATE = 10/15/2013	DATE - 9/25/2012	REVISED -

STATE OF ILLINOIS
 DEPARTMENT OF TRANSPORTATION

TEMPORARY TRAFFIC SIGNAL INSTALLATION & REMOVAL PLAN
US ROUTE 34 (OGDEN AVE.) AT IL ROUTE 171 (1ST AVE.)

SCALE: SHEET NO. OF SHEETS STA. TO STA.

TS-15		TOTAL SHEETS		SHEET NO.	
F.A.P. RTE.	SECTION	COUNTY	63	34	
372	2012-047I	COOK	CONTRACT NO. 60V34		
ILLINOIS FED. AID PROJECT					