

REMOVAL OF EXISTING TRAFFIC SIGNAL EQUIPMENT

THE FOLLOWING EXISTING TRAFFIC SIGNAL EQUIPMENT SHALL BE REMOVED BY THE CONTRACTOR AND SHALL REMAIN THE PROPERTY OF THE AGENCY LISTED BELOW. THE CONTRACTOR SHALL SAFELY STORE AND ARRANGE FOR PICK UP OF ALL EQUIPMENT TO BE RETURNED TO THE LISTED AGENCY AS PER THE TRAFFIC SIGNAL SPECIFICATIONS.

AGENCY: VILLAGE OF LYONS
 2 EACH LIGHT DETECTOR AND BEACON
 1 EACH LIGHT DETECTOR AMPLIFIER

THE FOLLOWING ITEMS SHALL BE REMOVED BY THE CONTRACTOR AND SHALL BE DISPOSED OF BY THEM OUTSIDE THE RIGHT-OF-WAY AT THEIR EXPENSE. THE SALVAGE VALUE OF THE REMOVED EQUIPMENT SHALL BE REFLECTED IN THE CONTRACT BID PRICE.

- 7 EACH SIGNAL HEAD, 1 - FACE, 3 - SECTION
- 3 EACH SIGNAL HEAD, 1 - FACE, 5 - SECTION
- 1 EACH SIGNAL HEAD, 2 - FACE, 1 - 3 - SECTION, 1 - 5 - SECTION
- 4 EACH PEDESTRIAN SIGNAL HEAD, 1 - FACE
- 1 EACH PEDESTRIAN SIGNAL HEAD, 2 - FACE
- 5 EACH PEDESTRIAN PUSHBUTTON
- 7 EACH TRAFFIC SIGNAL BACKPLATE
- 3 EACH TRAFFIC SIGNAL POST
- 1 EACH SERVICE INSTALLATION
- 1 EACH CONTROLLER AND CABINET (COMPLETE)

PAVEMENT MARKING AND RAMP REPLACEMENT KEY

- (A) REMOVE AND RESTRIPE EXISTING CROSSWALK. THERMOPLASTIC PAVEMENT MARKING - LINE 6" (WHITE)
- (B) REMOVE AND RESTRIPE EXISTING CROSSWALK. THERMOPLASTIC PAVEMENT MARKING - LINE 12" (WHITE)
- (C) REMOVE AND RESTRIPE EXISTING STOP BAR. THERMOPLASTIC PAVEMENT MARKING - LINE 24" (WHITE)
- (D) REMOVE EXISTING SIDEWALK AND REPLACE WITH NEW PORTLAND CEMENT CONCRETE SIDEWALK, 5"
- (E) DETECTABLE WARNINGS
- (F) REMOVE EXISTING B-6.24 CURB & GUTTER AND REPLACE WITH NEW STANDARD AND/OR DEPRESSED B-6.24 CURB AND GUTTER

SIDEWALK RAMP REPLACEMENT AREAS ARE APPROXIMATE. REMOVAL AND REPLACEMENT OF ANY SIDEWALK AND/OR CURB SHALL BE FIELD VERIFIED BY THE CONTRACTOR AND APPROVED BY THE ENGINEER, AND SHALL MEET THE REQUIREMENTS OF ADAAG.

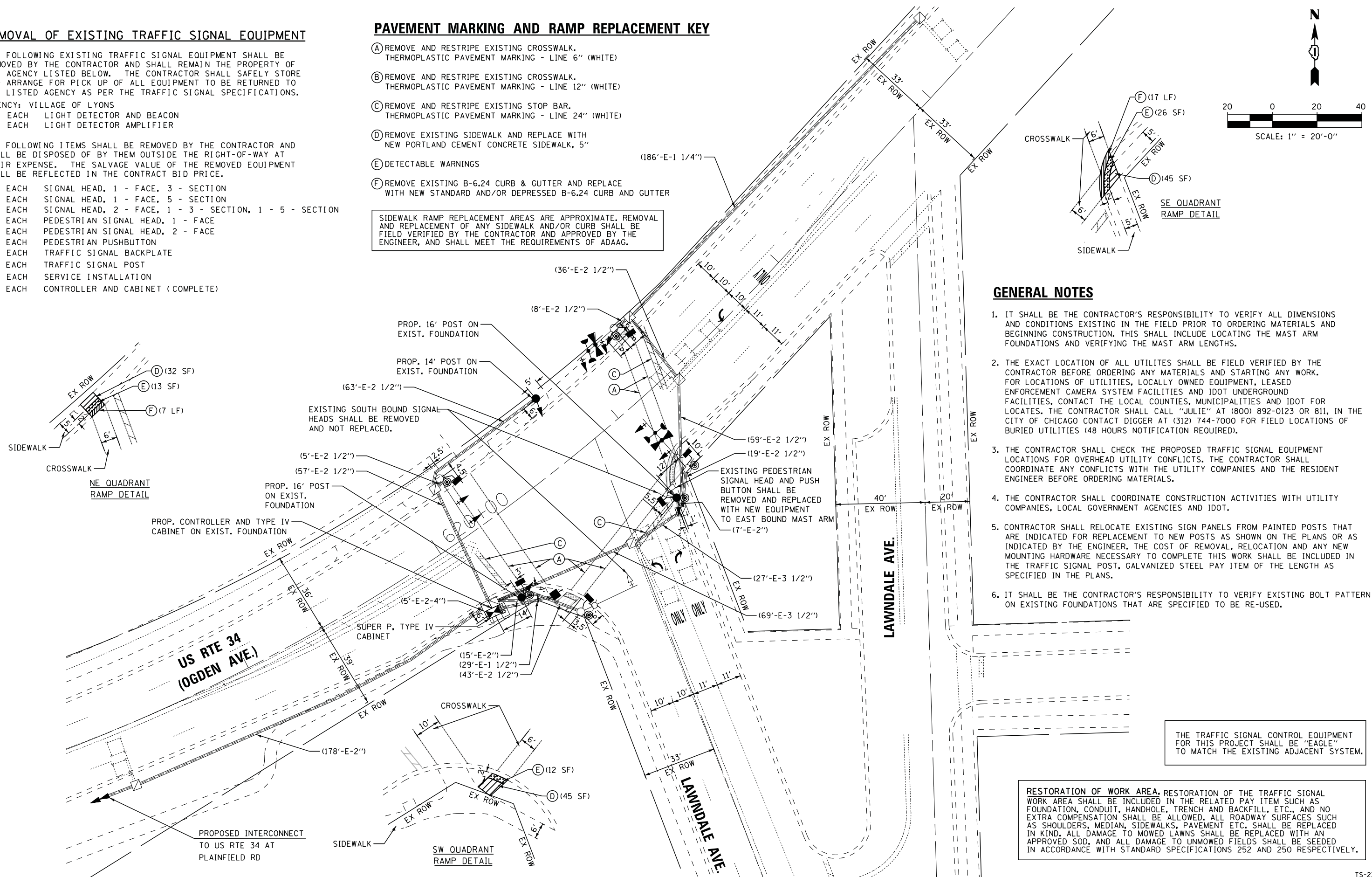

GENERAL NOTES

1. IT SHALL BE THE CONTRACTOR'S RESPONSIBILITY TO VERIFY ALL DIMENSIONS AND CONDITIONS EXISTING IN THE FIELD PRIOR TO ORDERING MATERIALS AND BEGINNING CONSTRUCTION. THIS SHALL INCLUDE LOCATING THE MAST ARM FOUNDATIONS AND VERIFYING THE MAST ARM LENGTHS.
2. THE EXACT LOCATION OF ALL UTILITIES SHALL BE FIELD VERIFIED BY THE CONTRACTOR BEFORE ORDERING ANY MATERIALS AND STARTING ANY WORK. FOR LOCATIONS OF UTILITIES, LOCALLY OWNED EQUIPMENT, LEASED ENFORCEMENT CAMERA SYSTEM FACILITIES AND IDOT UNDERGROUND FACILITIES, CONTACT THE LOCAL COUNTIES, MUNICIPALITIES AND IDOT FOR LOCATES. THE CONTRACTOR SHALL CALL "JULIE" AT (800) 892-0123 OR 811, IN THE CITY OF CHICAGO CONTACT DIGGER AT (312) 744-7000 FOR FIELD LOCATIONS OF BURIED UTILITIES (48 HOURS NOTIFICATION REQUIRED).
3. THE CONTRACTOR SHALL CHECK THE PROPOSED TRAFFIC SIGNAL EQUIPMENT LOCATIONS FOR OVERHEAD UTILITY CONFLICTS. THE CONTRACTOR SHALL COORDINATE ANY CONFLICTS WITH THE UTILITY COMPANIES AND THE RESIDENT ENGINEER BEFORE ORDERING MATERIALS.
4. THE CONTRACTOR SHALL COORDINATE CONSTRUCTION ACTIVITIES WITH UTILITY COMPANIES, LOCAL GOVERNMENT AGENCIES AND IDOT.
5. CONTRACTOR SHALL RELOCATE EXISTING SIGN PANELS FROM PAINTED POSTS THAT ARE INDICATED FOR REPLACEMENT TO NEW POSTS AS SHOWN ON THE PLANS OR AS INDICATED BY THE ENGINEER. THE COST OF REMOVAL, RELOCATION AND ANY NEW MOUNTING HARDWARE NECESSARY TO COMPLETE THIS WORK SHALL BE INCLUDED IN THE TRAFFIC SIGNAL POST, GALVANIZED STEEL PAY ITEM OF THE LENGTH AS SPECIFIED IN THE PLANS.
6. IT SHALL BE THE CONTRACTOR'S RESPONSIBILITY TO VERIFY EXISTING BOLT PATTERN ON EXISTING FOUNDATIONS THAT ARE SPECIFIED TO BE RE-USED.

THE TRAFFIC SIGNAL CONTROL EQUIPMENT FOR THIS PROJECT SHALL BE "EAGLE" TO MATCH THE EXISTING ADJACENT SYSTEM.

RESTORATION OF WORK AREA. RESTORATION OF THE TRAFFIC SIGNAL WORK AREA SHALL BE INCLUDED IN THE RELATED PAY ITEM SUCH AS FOUNDATION, CONDUIT, HANDHOLE, TRENCH AND BACKFILL, ETC., AND NO EXTRA COMPENSATION SHALL BE ALLOWED. ALL ROADWAY SURFACES SUCH AS SHOULDERS, MEDIAN, SIDEWALKS, PAVEMENT ETC. SHALL BE REPLACED IN KIND. ALL DAMAGE TO MOWED LAWNS SHALL BE REPLACED WITH AN APPROVED SOD, AND ALL DAMAGE TO UNMOWED FIELDS SHALL BE SEEDED IN ACCORDANCE WITH STANDARD SPECIFICATIONS 252 AND 250 RESPECTIVELY.

FILE NAME =	USER NAME = *USER*	DESIGNED - DW	REVISED -	STATE OF ILLINOIS DEPARTMENT OF TRANSPORTATION	TRAFFIC SIGNAL MODERNIZATION PLAN US ROUTE 34 (OGDEN AVENUE) AT LAWDALE AVENUE				F.A.P. RTE.	SECTION	COUNTY	TOTAL SHEETS	SHEET NO.
N:\Projects\312055\Design\CAD\Sheet Files\60V34rwa34proLAWDALE.dgn		DRAWN - LV	REVISED -		372	2012-0471	COOK	63	42				
PLOT SCALE = *SCALE*		CHECKED - KM	REVISED -		CONTRACT NO. 60V34								
PLOT DATE = 10/11/2013		DATE - 9/25/2012	REVISED -		ILLINOIS FED. AID PROJECT								
					SCALE:	SHEET NO.	OF SHEETS	STA.	TO STA.				