

NOTES

1. REMOVE EXISTING OVERHEAD SIGN STRUCTURE BRIDGE MOUNTED (WB-01-BM). RELOCATE EXISTING SIGN PANEL TO (STA 347+51, 58' LT). SIGN PANEL SHALL BE PLACED ON WOOD SIGN SUPPORTS. SIGN SHALL REMAIN FOR THE DURATION OF CONSTRUCTION OR UNTIL THE PROPOSED BRIDGE MOUNTED SIGN (WB-02-BM) IS INSTALLED. REFER TO SIGNING PLANS FOR DETAILS.
2. REMOVE EXISTING OVERHEAD SIGN STRUCTURE BRIDGE MOUNTED (EB-03-BM AND EB-04-BM) AFTER PROPOSED SIGNS (EB-01-BM AND EB-02-BM) HAVE BEEN PLACED IN PROPOSED LOCATION. REFER TO SIGNING PLANS FOR DETAILS.
3. TEMPORARY TRAFFIC CONTROL PAVEMENT MARKINGS SHALL MATCH TO THE CURRENT STAGE OF TRAFFIC CONTROL FOR CONTRACT NUMBER 60W26. FURTHER COORDINATION OF TEMP. MARKINGS AND DEVICES ALONG EASTBOUND AND WESTBOUND I-290 WILL BE REQUIRED.

LEGEND

- WORK ZONE
- TEMPORARY IMPACT ATTENUATOR
- TEMPORARY CONCRETE BARRIER
- DIRECTION OF TRAFFIC FLOW
- SIGN
- ARROW BOARD
- TYPE III BARRICADE
- TYPE II BARRICADE OR DRUM WITH FLASHING LIGHT



SEE NOTE 1
Exit 28B
Ashland Ave
Paulina St
3/4 MILE

RAMP CLOSED AHEAD
 STA. 12+75
 (SW RAMP)
MORGAN ST
 W20-30(O)-48
 SEE TEMPORARY INFORMATION SIGN DETAILS

RAMP CLOSED AHEAD
 STA. 18+90
 (NW RAMP)
MORGAN ST
 W20-30(O)-48
 SEE TEMPORARY INFORMATION SIGN DETAILS

EXIT TO MORGAN ST PROHIBITED

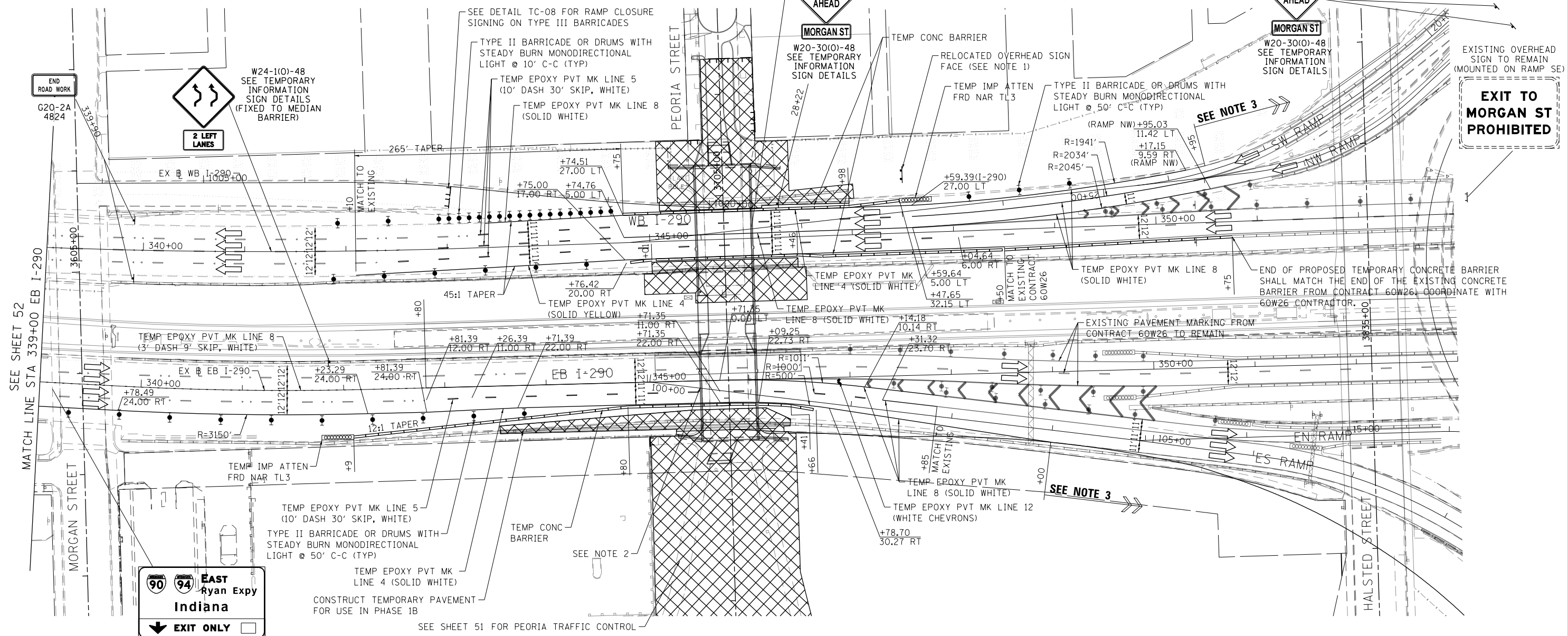

90 94 EAST Ryan Expy Indiana
EXIT ONLY

INSTALL PROPOSED PERMANENT SIGN COVER OUTSIDE LANE ARROW DURING STAGES 1A & 1B

SEE SHEET 51 FOR PEORIA TRAFFIC CONTROL



FILE PATH = p:\388035\pmt\lsc\comon\me\local\p\wec\000\Documents\01_Americas\Transportation\60269938_Circle\Phase 1\1000_CAD\005_Roadway\Sheets\60W26_Sht-5\Stage13.dgn



D:\60W29-Sht-Staging-13.dgn	DESIGNED - JDT	REVISED -
USER NAME = BAWtor1	DRAWN - JTR	REVISED -
PLOT SCALE = 100.0000' / in.	CHECKED - JMG	REVISED -
PLOT DATE = 10/28/2013	DATE - 10/30/2013	REVISED -

STATE OF ILLINOIS
DEPARTMENT OF TRANSPORTATION

SUGGESTED STAGES OF CONSTRUCTION AND TRAFFIC CONTROL PLAN
I-290 STAGE 1A
 SCALE: 1"=50' SHEET 3 OF 3 SHEETS STA. 339+00 TO STA. 353+00

F.A.I. RTE. 90/94/290	SECTION 2013-011R	COUNTY COOK	TOTAL SHEETS 356	SHEET NO. 53
ILLINOIS FED. AID PROJECT			CONTRACT NO. 60W29	