

FILE PATH = p:\388035\pmt\lsc\comon\me\local\p\AECD\00\Documents\01\_Americas\Transportation\60269938\_Circle\Phase\_1\1000\_CAD\006\_Roadway\_Sheets\60W29\_Contract\0160W29-Sht-Scoring-02.dgn

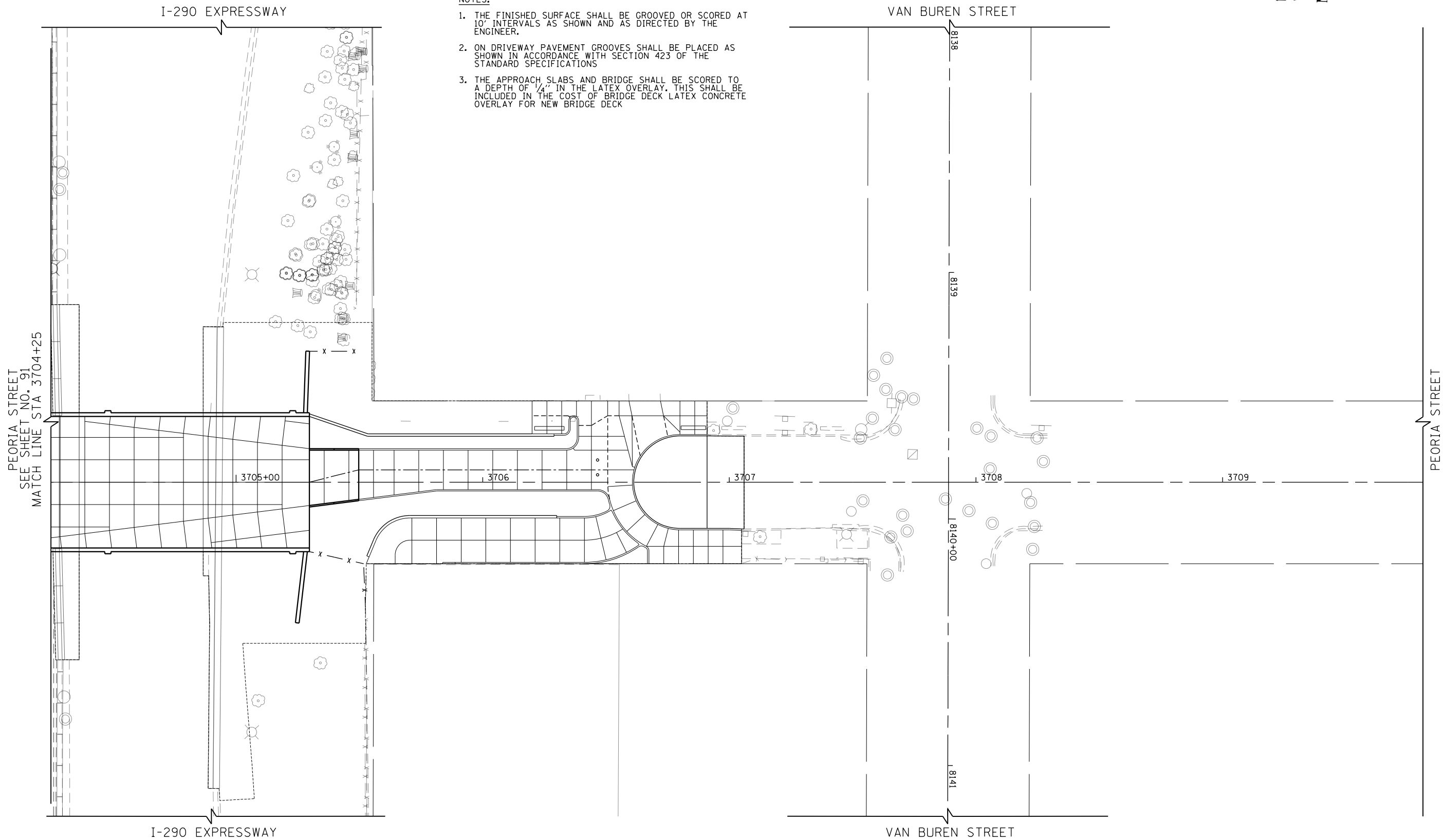

- NOTES:**
1. THE FINISHED SURFACE SHALL BE GROOVED OR SCORED AT 10' INTERVALS AS SHOWN AND AS DIRECTED BY THE ENGINEER.
  2. ON DRIVEWAY PAVEMENT GROOVES SHALL BE PLACED AS SHOWN IN ACCORDANCE WITH SECTION 423 OF THE STANDARD SPECIFICATIONS
  3. THE APPROACH SLABS AND BRIDGE SHALL BE SCORED TO A DEPTH OF 1/4" IN THE LATEX OVERLAY. THIS SHALL BE INCLUDED IN THE COST OF BRIDGE DECK LATEX CONCRETE OVERLAY FOR NEW BRIDGE DECK

NOTE: SCORING PATTERN TO BE FINALIZED UPON COORDINATION WITH U.I.C.

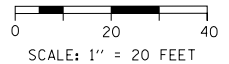

DI60W29-Sht-Scoring-02.dgn	DESIGNED - JLV	REVISED -
USER NAME = BAW:tor t	DRAWN - KAL	REVISED -
PLOT SCALE = 40.0000' / in.	CHECKED - JMG	REVISED -
PLOT DATE = 10/28/2013	DATE - 10/30/2013	REVISED -

**STATE OF ILLINOIS  
DEPARTMENT OF TRANSPORTATION**

**ROADWAY DETAILS  
PEORIA STREET SCORING PLAN**

SCALE: 1"=20' SHEET 2 OF 2 SHEETS STA. 3705+22 TO STA. 3707+40

F.A.I. RTE.	SECTION	COUNTY	TOTAL SHEETS	SHEET NO.
90/94/290	2013-011R	COOK	356	92
CONTRACT NO. 60W29			ILLINOIS FED. AID PROJECT	