

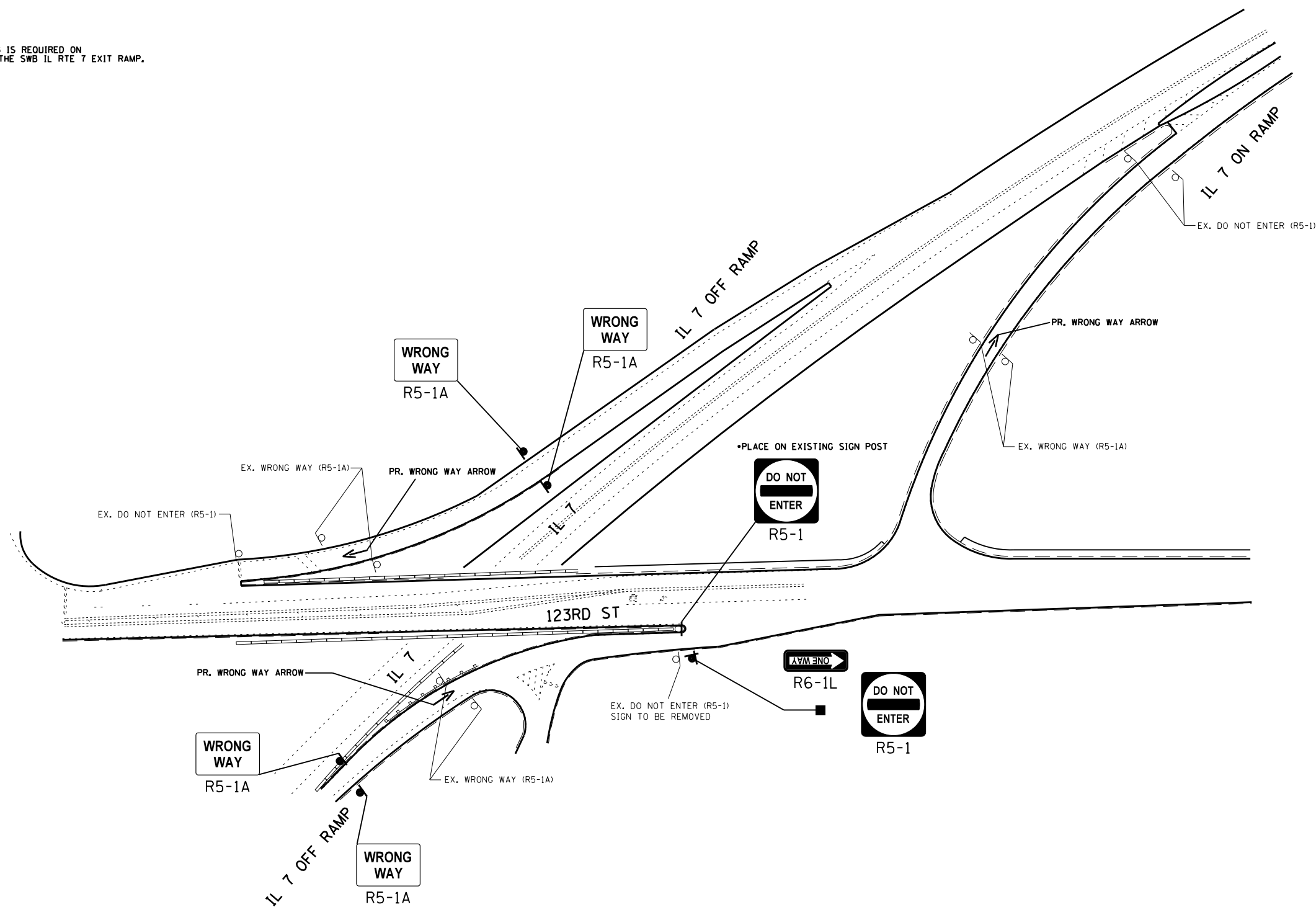

NOTE:
SELECTIVE CLEARING IS REQUIRED ON
THE WEST SIDE OF THE SWB IL RTE 7 EXIT RAMP.



NOTE:
SIGN ASSEMBLIES GREATER THAN 16 SQUARE FEET
REQUIRE TWO TELESCOPING STEEL SIGN SUPPORTS.

COOK COUNTY LOCATION NO. 10

FILE NAME =	USER NAME = SMITHCJ	DESIGNED -	REVISED -	STATE OF ILLINOIS DEPARTMENT OF TRANSPORTATION	IL RTE 7 TO 123RD ST SIGNAGE PLAN				F.A. RTE.	SECTION	COUNTY	TOTAL SHEETS	SHEET NO.
Default	et:\pwork\pwork\smithcjd0355785\Design\sh-t-ARS-Cook.dgn	DRAWN -	REVISED -						SCALE: SHEET OF SHEETS STA. TO STA.				2013-0575G
	PLOT SCALE = 100.0000' / 1".	CHECKED -	REVISED -		ILLINOIS FED. AID PROJECT				CONTRACT NO. 60X31				
	PLOT DATE = 10/18/2013	DATE -	REVISED -										