

STA. 1319+18.74 IL ROUTE 17-
STA. 220+00.00 S5000W ROAD

BEGIN CONSTRUCTION
STA. 1310+72.42

DATE	07/09
BY	CHAMLIN & ASSOCIATES
LAG	JKC
NO.	0366905-00000000
DATE	07/09
BY	CHAMLIN & ASSOCIATES
LAG	JKC
NO.	0366905-00000000

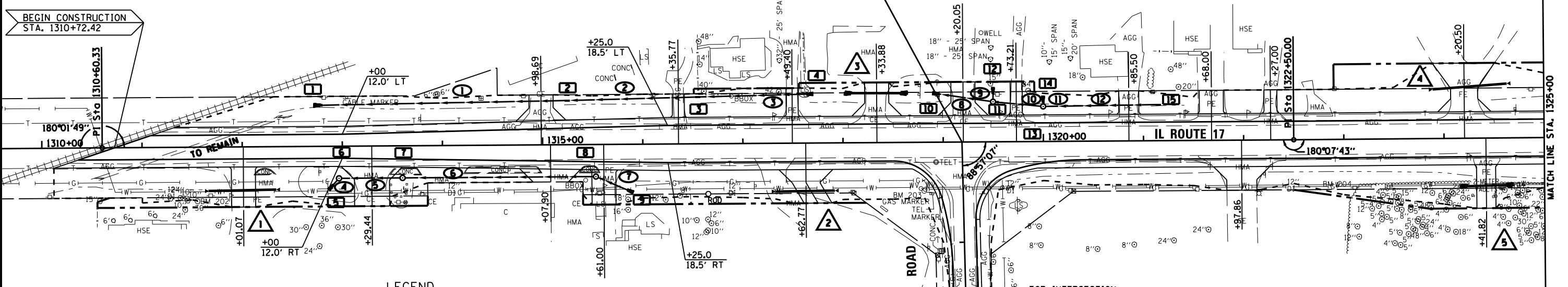

LEGEND

- STORM SEWER STRUCTURE NUMBER
- STORM SEWER PIPE NUMBER
- PIPE CULVERT NUMBER

BENCHMARK #202:
RAILROAD SPIKE IN TELEPHONE POLE NEAR HOUSE #5132
STA. 1311+68.60, 49.97' RT.
ELEV.= 657.57

BENCHMARK #203:
CHISELED X ON TOP N.E. BOLT OF FIRE HYDRANT
IN THE S.W. QUAD OF IL. 17/S5000W RT. HEADING SOUTH
STA. 1318+81.69, 48.47' RT.
ELEV.= 661.87

BENCHMARK #204:
RAILROAD SPIKE IN TELEPHONE POLE
SOUTH SIDE OF IL. 17
STA. 1323+10.68, 48.50' RT.
ELEV.= 665.25

SEE SCHEDULE OF QUANTITIES.

FOR INTERSECTION
DETAILS SEE SHEET 142

DATE	07/09
BY	CHAMLIN & ASSOCIATES
LAG	JKC
NO.	0366905-00000000
DATE	07/09
BY	CHAMLIN & ASSOCIATES
LAG	JKC
NO.	0366905-00000000

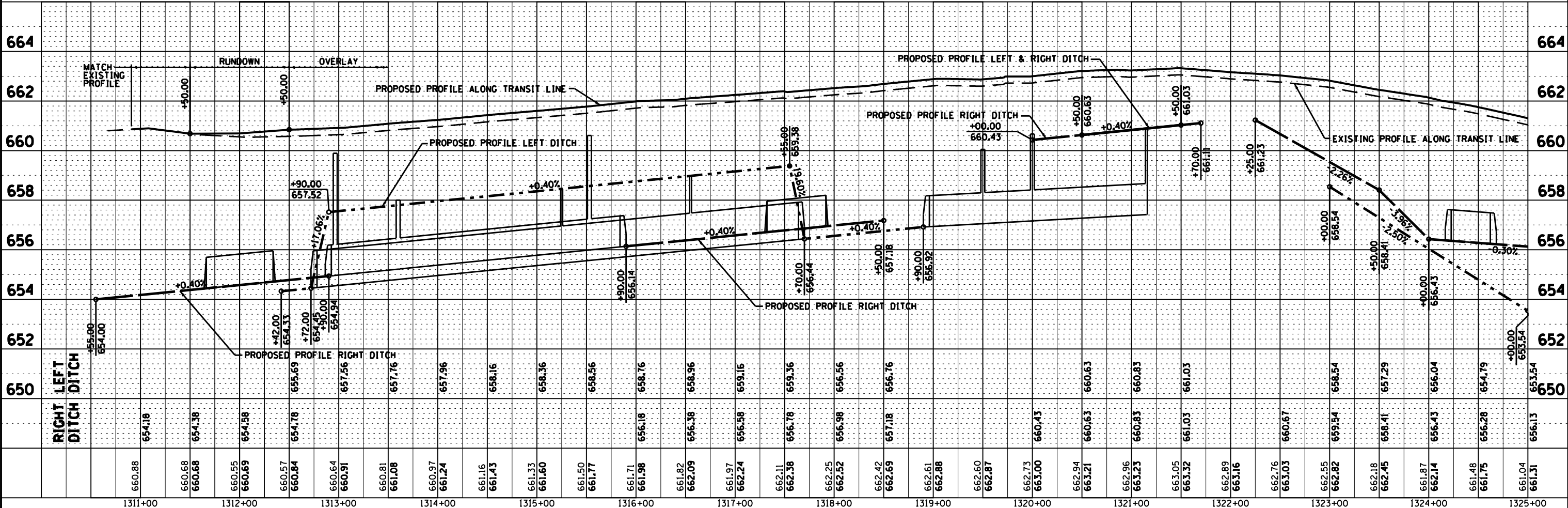

FILE NAME = D366905-SHT-PLNPRF-1310-1325.DGN	USER NAME = --	DESIGNED - JKC	REVISED -	STATE OF ILLINOIS DEPARTMENT OF TRANSPORTATION	PLAN & PROFILE - IL ROUTE 17			F.A. RTE. 41	SECTION (11)W&RS-1	COUNTY KANKAKEE	TOTAL SHEETS 450	SHEET NO. 67
PLOT SCALE = 1"=50'	DATE = 07/13	DRAWN - LAG/NV	REVISED -		SCALE: 1"=50'	SHEET	OF	SHEETS	STA. 1310+00	TO STA. 1325+00	CONTRACT NO. 66905	
		CHECKED - JKC	REVISED -		ILLINOIS FED. AID PROJECT							
		DATE - 07/13	REVISED -									