

PLAN	SURVEYED	DATE
NOTE BOOK	CHAMLIN & ASSOCIATES	07/09
NO.	LAG	07/09
	JKC	07/09
	NY	07/09
	NOTARIS CPID	

PROFILE	SURVEYED	DATE
GRADES CHECKED	CHAMLIN & ASSOCIATES	07/09
STRUCTURE	LAG	07/09
	JKC	07/09
	NY	07/09
	NOTARIS CPID	

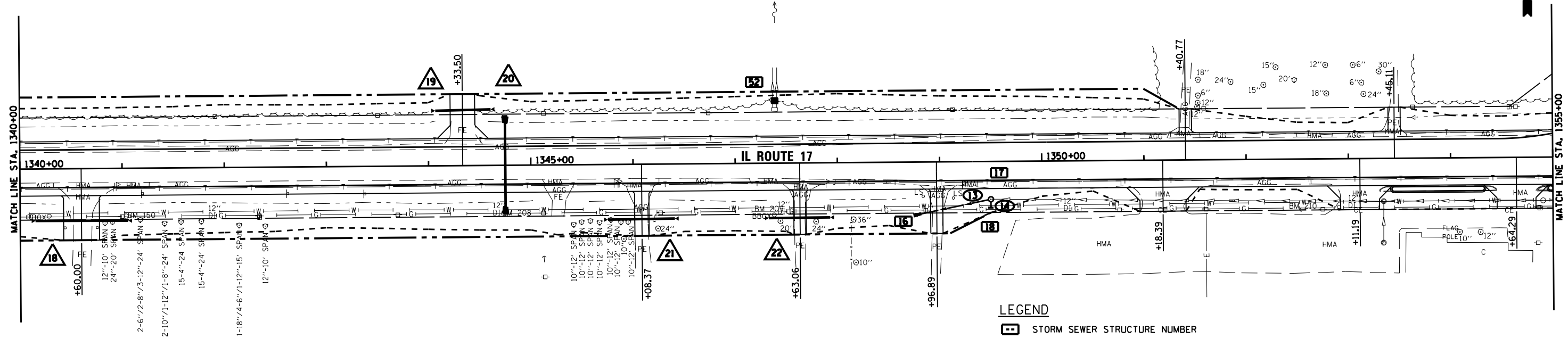
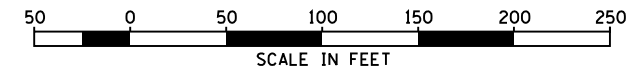

BENCHMARK #150:
RAILROAD SPIKE IN TELEPHONE POLE
SOUTH SIDE OF IL. 17 NEAR HOUSE #4590 B
STA. 1341+00.22, 46.98' RT.
ELEV.= 653.41

BENCHMARK #208:
RAILROAD SPIKE IN TELEPHONE POLE
SOUTH SIDE OF IL. 17 NEAR HOUSE #4490
STA. 1345+11.82, 47.27' RT.
ELEV.= 652.51

BENCHMARK #209:
RAILROAD SPIKE IN TELEPHONE POLE
SOUTH SIDE OF IL. 17 NEAR HOUSE #4460
STA. 1347+51.87, 47.33' RT.
ELEV.= 652.61

BENCHMARK #210:
RAILROAD SPIKE IN TELEPHONE POLE
SOUTH SIDE OF IL. 17 @ KVCC OFFICE ENT.
STA. 1352+74.72, 48.82' RT.
ELEV.= 652.28

- LEGEND**
- STORM SEWER STRUCTURE NUMBER
 - STORM SEWER PIPE NUMBER
 - PIPE CULVERT NUMBER

SEE SCHEDULE OF QUANTITIES.

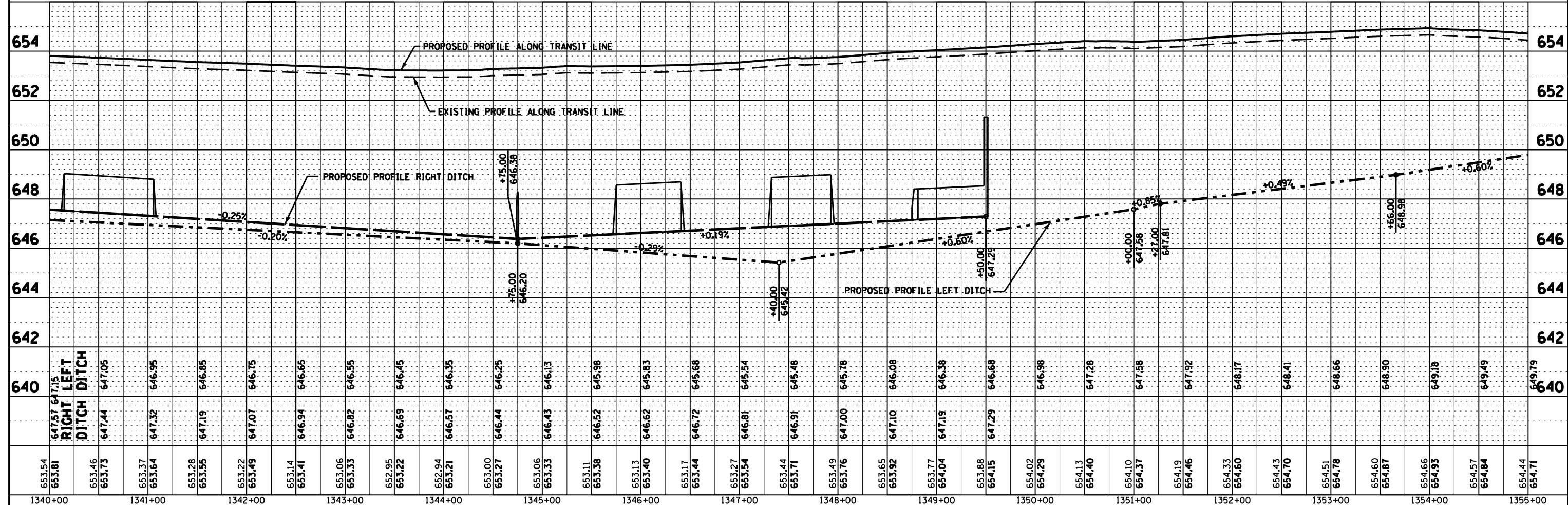

FILE NAME =	USER NAME = --	DESIGNED - JKC	REVISED -	STATE OF ILLINOIS DEPARTMENT OF TRANSPORTATION	PLAN & PROFILE - IL ROUTE 17		F.A.P. RT. 41	SECTION (I)W&RS-1	COUNTY KANKAKEE	TOTAL SHEETS 450	SHEET NO. 69	
D366905-SHT-PLNPRF-1340-1355.DGN	PLOT SCALE = 1"=50'	DRAWN - LAG/NV	REVISED -		SCALE: 1"=50'	SHEET	OF	SHEETS	STA. 1340+00	TO STA. 1355+00	CONTRACT NO. 66905	
	PLOT DATE = 07/13	CHECKED - JKC	REVISED -		ILLINOIS FED. AID PROJECT							
		DATE - 07/13	REVISED -									