

ASTM C1577  
 STA. 1415+50  
 12" x 4' PRECAST CONC. BOX CULVERT  
 DESIGN FILL: 0.8' MIN./1.7' MAX.  
 0° SKEW WITH GRATED CONC. APRON  
 LT. FLOWLINE = 616.50  
 RT. FLOWLINE = 616.80  
 SEE SHEETS 165-166 & 170-171  
 FOR DETAILS

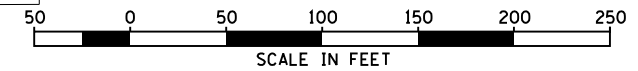

PLAN	SURVEYED	DATE	07/08
	PLOTTED	BY	CHAMLIN & ASSOCIATES
	ALIGNED	LAG	
	CHECKED	JKC	
	NO. 001	NO.	07/08
	NO. 002	NO.	07/08
	NO. 003	NO.	07/08
	NO. 004	NO.	07/08
	NO. 005	NO.	07/08
	NO. 006	NO.	07/08
	NO. 007	NO.	07/08
	NO. 008	NO.	07/08
	NO. 009	NO.	07/08
	NO. 010	NO.	07/08

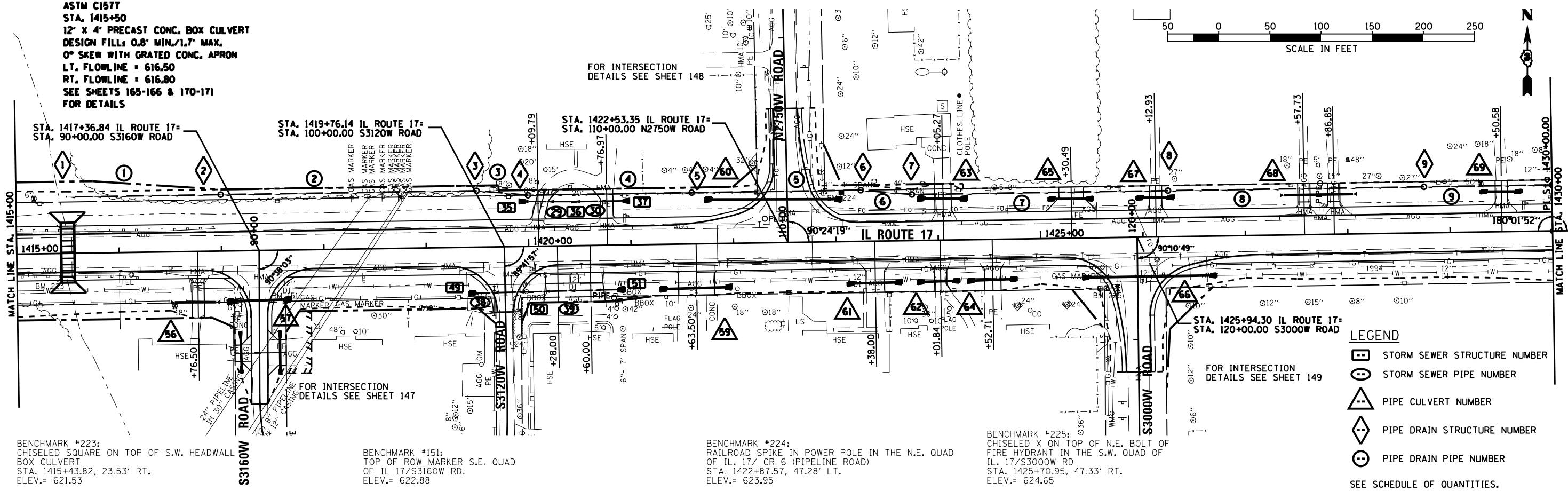

BENCHMARK #223:  
 CHISELED SQUARE ON TOP OF S.W. HEADWALL  
 BOX CULVERT  
 STA. 1415+43.82, 23.53' RT.  
 ELEV.= 621.53

BENCHMARK #151:  
 TOP OF ROW MARKER S.E. QUAD  
 OF IL 17/S3160W RD.  
 ELEV.= 622.88

BENCHMARK #224:  
 RAILROAD SPIKE IN POWER POLE IN THE N.E. QUAD  
 OF IL 17/ CR 6 (PIPELINE ROAD)  
 STA. 1422+87.57, 47.28' LT.  
 ELEV.= 623.95

BENCHMARK #225:  
 CHISELED X ON TOP OF N.E. BOLT OF  
 FIRE HYDRANT IN THE S.W. QUAD OF  
 IL 17/S3000W RD  
 STA. 1425+70.95, 47.33' RT.  
 ELEV.= 624.65

- LEGEND**
- STORM SEWER STRUCTURE NUMBER
  - STORM SEWER PIPE NUMBER
  - PIPE CULVERT NUMBER
  - PIPE DRAIN STRUCTURE NUMBER
  - PIPE DRAIN PIPE NUMBER
- SEE SCHEDULE OF QUANTITIES.

PROFILE	SURVEYED	DATE	07/08
	PLOTTED	BY	CHAMLIN & ASSOCIATES
	GRADES CHECKED	LAG	
	STRUCTURE NOTATIONS CHECKED	NV	
	NO. 001	NO.	07/08
	NO. 002	NO.	07/08
	NO. 003	NO.	07/08
	NO. 004	NO.	07/08
	NO. 005	NO.	07/08
	NO. 006	NO.	07/08
	NO. 007	NO.	07/08
	NO. 008	NO.	07/08
	NO. 009	NO.	07/08
	NO. 010	NO.	07/08

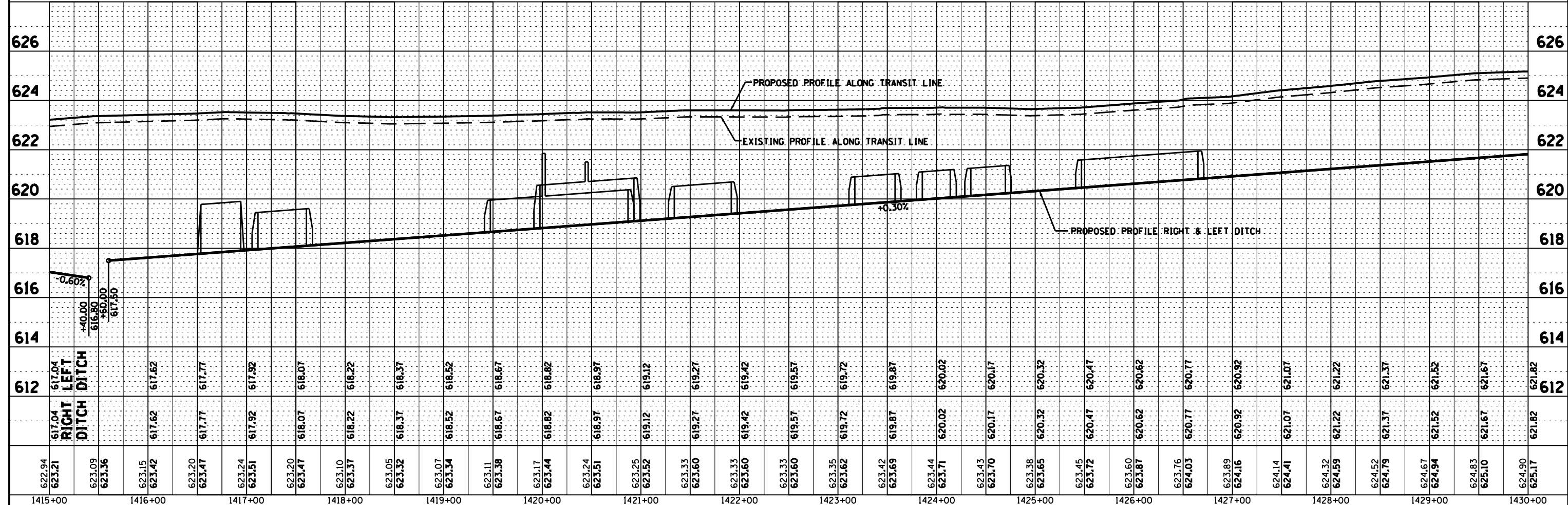

FILE NAME = D366905-SHT-PLNPRF-1415-1430.DGN	USER NAME = --	DESIGNED - JKC	REVISED -	<b>STATE OF ILLINOIS</b> <b>DEPARTMENT OF TRANSPORTATION</b>	<b>PLAN &amp; PROFILE - IL ROUTE 17</b> SCALE: 1"=50' SHEET OF SHEETS STA. 1415+00 TO STA. 1430+00	F.A.P. RT. 41	SECTION (I)W&RS-1	COUNTY KANKAKEE	TOTAL SHEETS 450	SHEET NO. 74	
PLOT SCALE = 1"=50'	DATE = 07/13	DRAWN - LAG/NV	REVISED -			CONTRACT NO. 66905					
		CHECKED - JKC	REVISED -			ILLINOIS FED. AID PROJECT					
		DATE = 07/13	REVISED -								