

PLAN	SURVEYED	DATE
NOTE BOOK NO.	LAG	07/09
CHECKED	JKC	07/09
FILE NAME	0366905-SHT-PLNPRF-S4000W.DGN	07/09

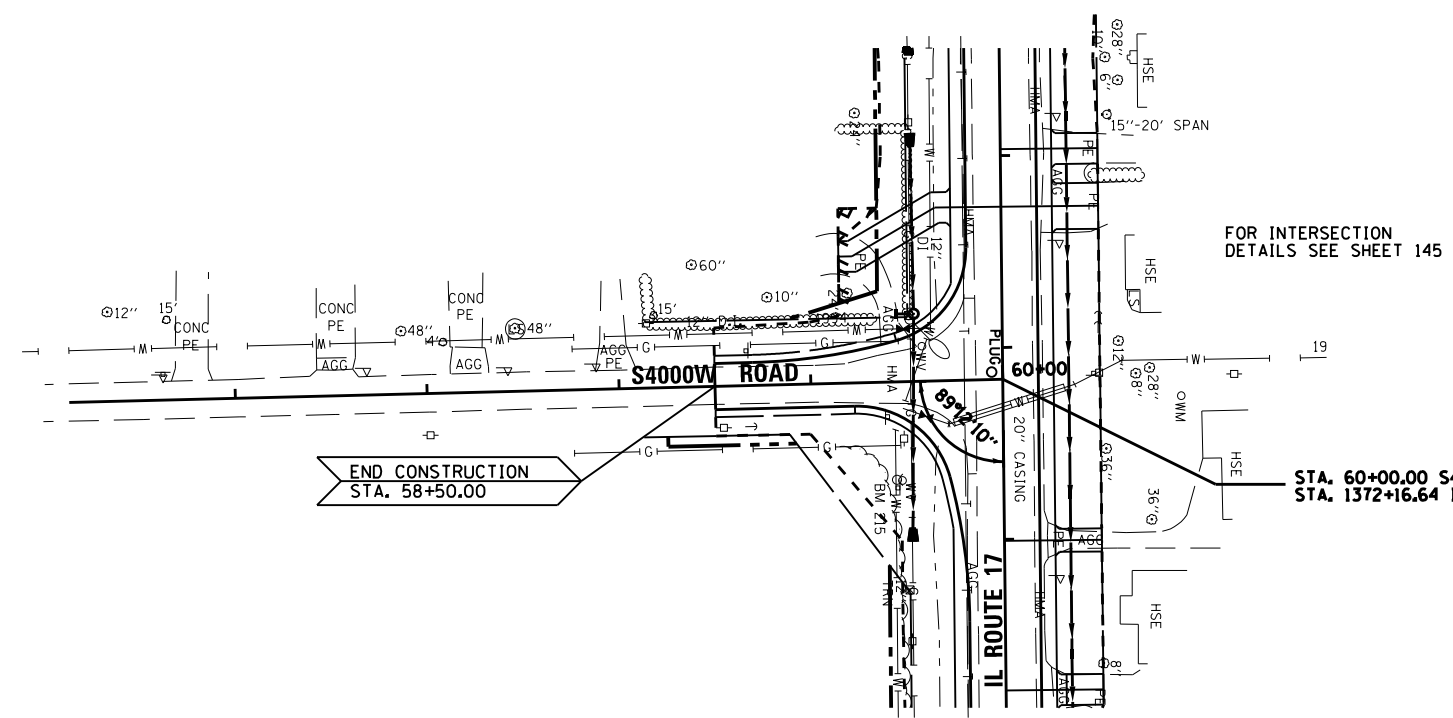

BENCHMARK #214:
RAILROAD SPIKE IN POWER POLE
IN THE S.E. QUAD OF IL 17 / S4080W RD.
STA. 1368+33.20, 49.00' RT.
ELEV.= 636.14

BENCHMARK #215:
CHISELED X ON TOP OF NORTH BOLT OF
FIRE HYDRANT IN THE S.E. QUAD OF
IL 17/S4000W RD.
STA. 1372+68.62, 54.50' RT.
ELEV.= 635.34

PROFILE	SURVEYED	DATE
NOTE BOOK NO.	LAG	07/09
CHECKED	JKC	07/09
FILE NAME	0366905-SHT-PLNPRF-S4000W.DGN	07/09

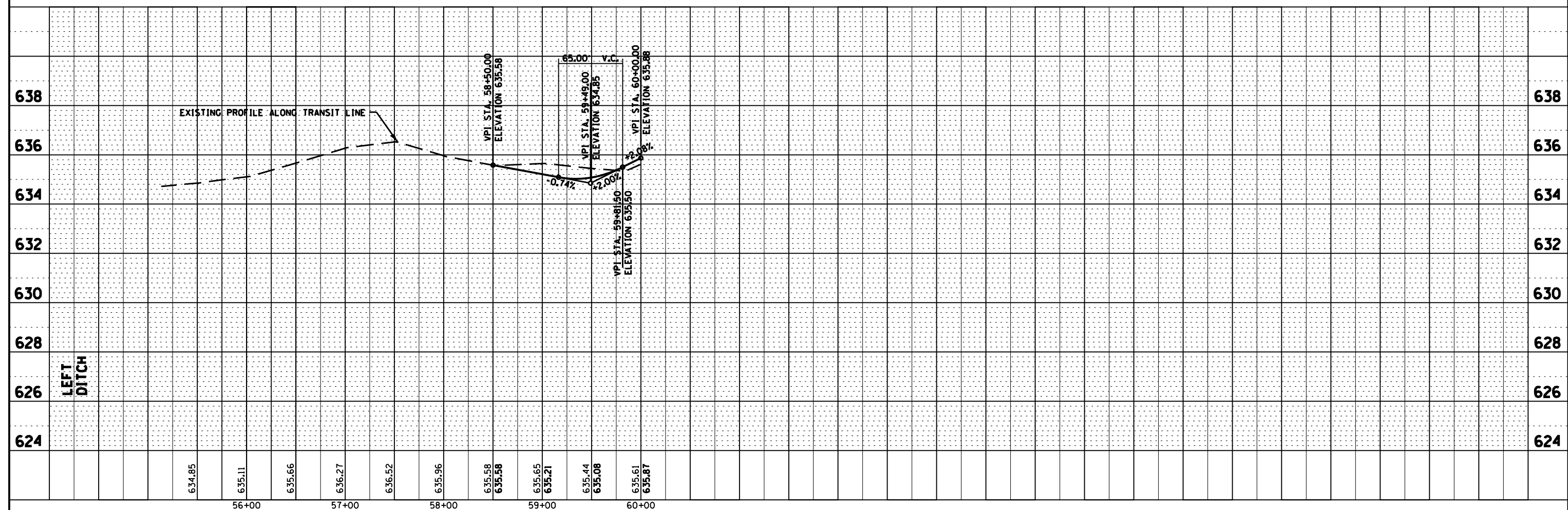

FILE NAME =	USER NAME =	DESIGNED -	REVISIONS	STATE OF ILLINOIS DEPARTMENT OF TRANSPORTATION	PLAN & PROFILE - S4000W ROAD	F.A.P. RTE.	SECTION	COUNTY	TOTAL SHEETS	SHEET NO.	
D366905-SHT-PLNPRF-S4000W.DGN	--	JKC	-			41	(I)W&RS-1	KANKAKEE	450	84	
PLOT SCALE = 1"=50'		LAG/NV	-			CONTRACT NO. 66905					
PLOT DATE = 07/13		JKC	-			ILLINOIS FED. AID PROJECT					