

PLAN	SURVEYED	DATE
NOTE BOOK	LAG	07/09
NO.	NO.	07/09
	NO.	07/09
	NO.	07/09
	NO.	07/09
	NO.	07/09
	NO.	07/09
	NO.	07/09
	NO.	07/09

PROFILE	SURVEYED	DATE
NOTE BOOK	LAG	07/09
NO.	NO.	07/09
	NO.	07/09
	NO.	07/09
	NO.	07/09
	NO.	07/09
	NO.	07/09
	NO.	07/09
	NO.	07/09

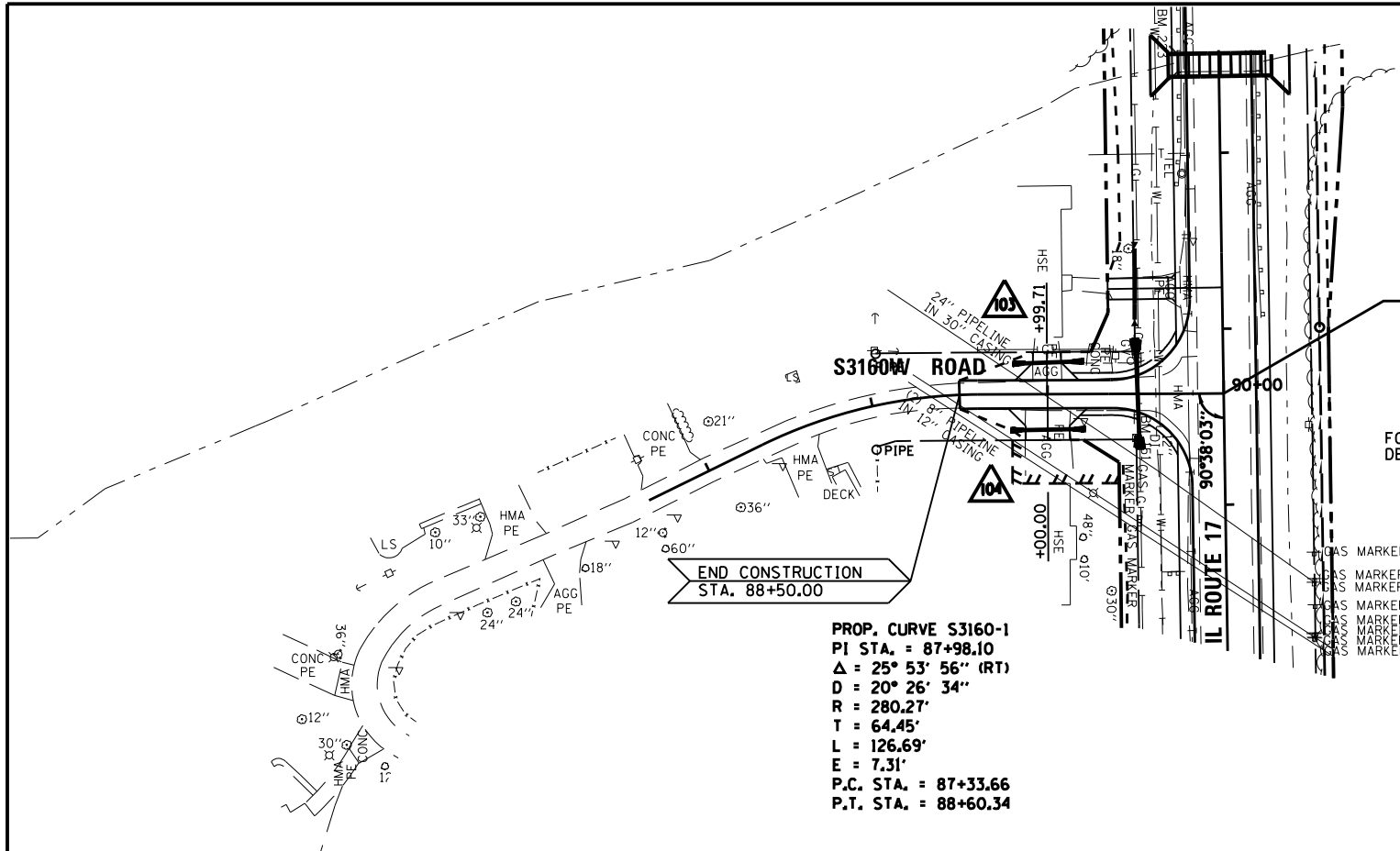

BENCHMARK #223:  
CHISELED SQUARE ON TOP OF S.W. HEADWALL  
BOX CULVERT  
STA. 1415+43.82, 23.53' RT.  
ELEV.= 621.53

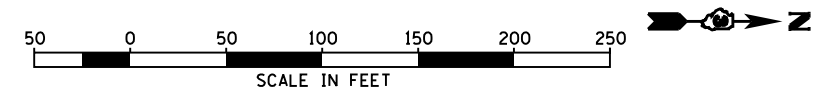

STA. 90+00.00 S3160W ROAD=  
STA. 1417+36.84 IL ROUTE 17

FOR INTERSECTION  
DETAILS SEE SHEET 147

PROP. CURVE S3160-1  
PI STA. = 87+98.10  
Δ = 25° 53' 56" (RT)  
D = 20° 26' 34"  
R = 280.27'  
T = 64.45'  
L = 126.69'  
E = 7.31'  
P.C. STA. = 87+33.66  
P.T. STA. = 88+60.34

BENCHMARK #151:  
TOP OF ROW MARKER S.E. QUAD  
OF IL 17/S3160W RD.  
ELEV.= 622.88

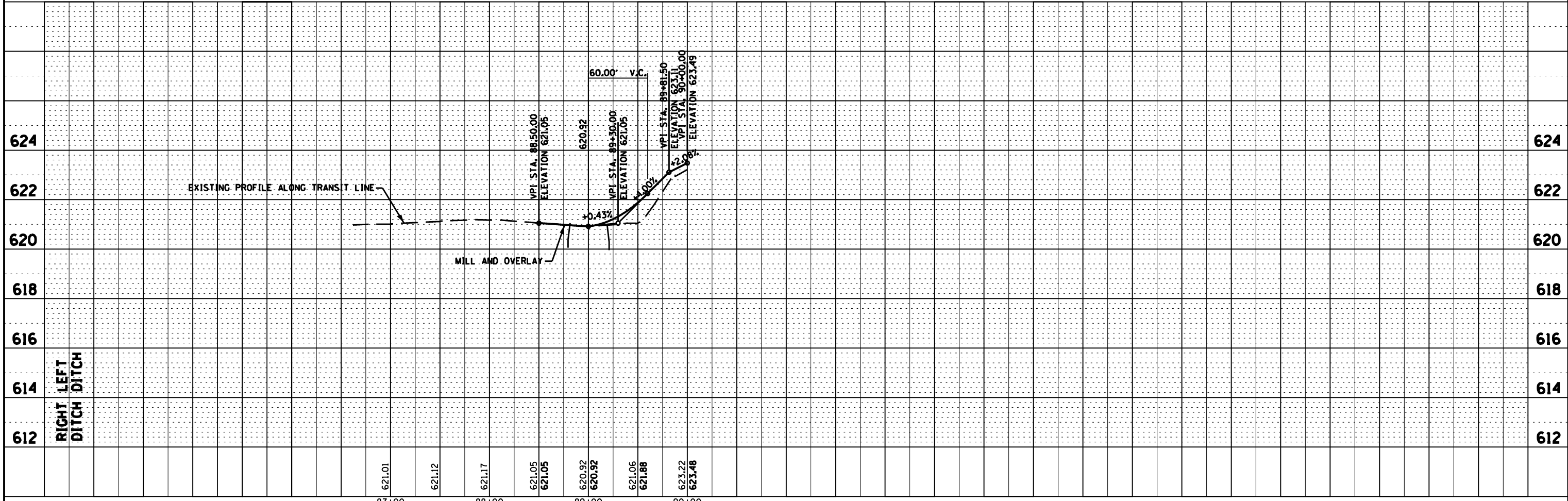

FILE NAME =  
D366905-SHT-PLNPRF-S3160.DGN

USER NAME = --	DESIGNED - JKC	REVISED -
PLOT SCALE = 1"=50'	DRAWN - LAG/NV	REVISED -
PLOT DATE = 07/13	CHECKED - JKC	REVISED -
	DATE - 07/13	REVISED -

STATE OF ILLINOIS  
DEPARTMENT OF TRANSPORTATION

PLAN & PROFILE - S3160W ROAD  
SCALE: 1"=50' SHEET OF SHEETS STA. 86+62 TO STA. 90+00

F.A.P. RTE.	SECTION	COUNTY	TOTAL SHEETS	SHEET NO.
41	(1)W&RS-1	KANKAKEE	450	87
CONTRACT NO. 66905				
ILLINOIS FED. AID PROJECT				