

• TEMPORARY CONCRETE BARRIER ADJACENT TO AREA WHERE PAVEMENT HAS BEEN REMOVED SHALL BE ANCHORED TO ROADWAY PAVEMENT

### SECTION A-A

BASED UPON SOIL BORINGS TAKEN BY THE DEPARTMENT  
TOP OF ROCK ELEVATION IS 618.5±

- WORK ZONE
- TEMPORARY TRAFFIC SIGNALS
- DRUM WITH STEADY-BURNING BIDIRECTIONAL LIGHT
- IMPACT ATTENUATOR
- TYPE III BARRICADE
- TEMPORARY CONCRETE BARRIER

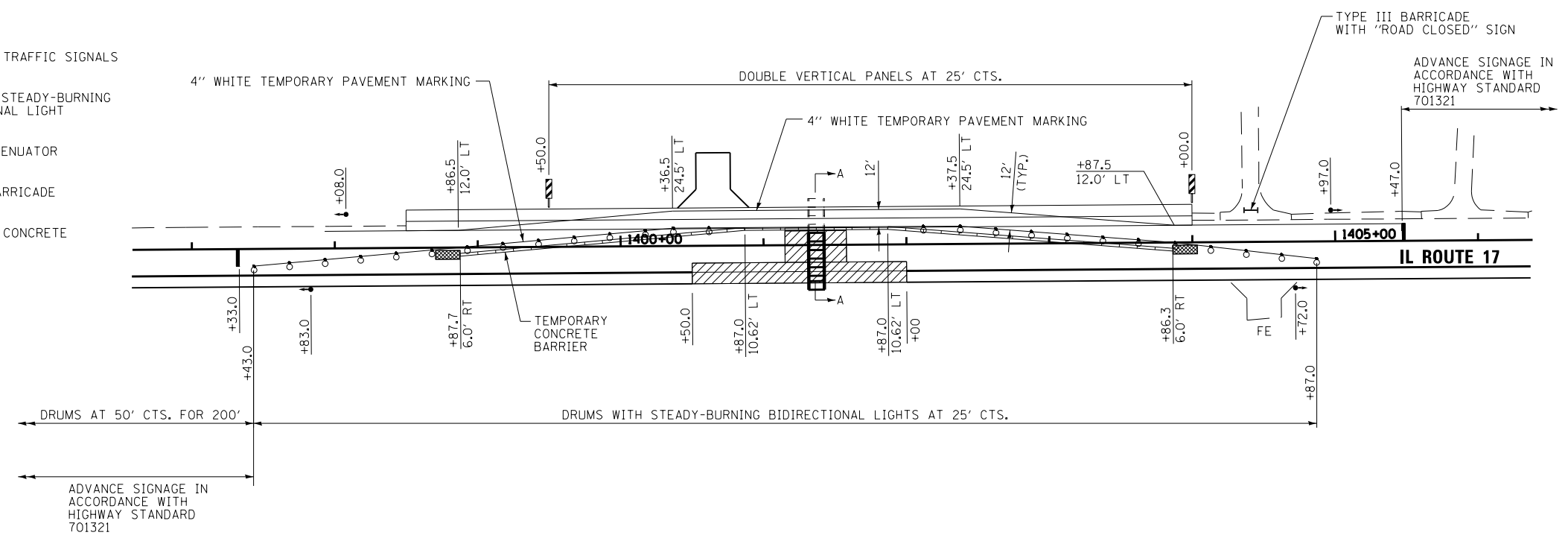

FILE NAME = D366905-SHT-STAGING-1A7.DGN	USER NAME = --	DESIGNED - JKC	REVISED -	<b>STATE OF ILLINOIS DEPARTMENT OF TRANSPORTATION</b>	<b>CONSTRUCTION STAGING &amp; TRAFFIC CONTROL STAGE IA (7)</b>			F.A.P. RTE.	SECTION	COUNTY	TOTAL SHEETS	SHEET NO.
	PLOT SCALE = 1"=50'	DRAWN - LAG/NV	REVISED -					41	(1)W&RS-1	KANKAKEE	450	97
PLOT DATE = 07/13	DATE - 07/13	CHECKED - JKC	REVISED -	SCALE: 1"=50'    SHEET OF SHEETS    STA. - TO STA. -			<b>CONTRACT NO. 66905</b>					
ILLINOIS FED. AID PROJECT												