

B.M. #20 S & W. T. P. Lt. Sta. 313+65
 Elev 673.66
 Old Bridge: 16 Ft. I Beam Span, 14 Ft. Rdy
 To be removed by Bridge Contractor.

STATE OF ILLINOIS
 DEPARTMENT OF PUBLIC WORKS & BUILDINGS
 DIVISION OF HIGHWAYS
R.C. ABUTMENTS FOR SLAB BRIDGE
 HEIGHT OVER ALL 13 FEET 7 INCHES

ROUTE NO.	SEC.	COUNTY	TOTAL SHEETS	SHEET NO.
70A	110B	LA SALLE	20	48

FED. ROAD DIST. NO. 7 ILLINOIS FED. AID PROJECT

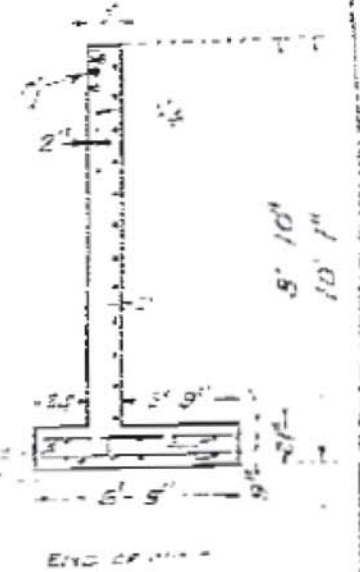
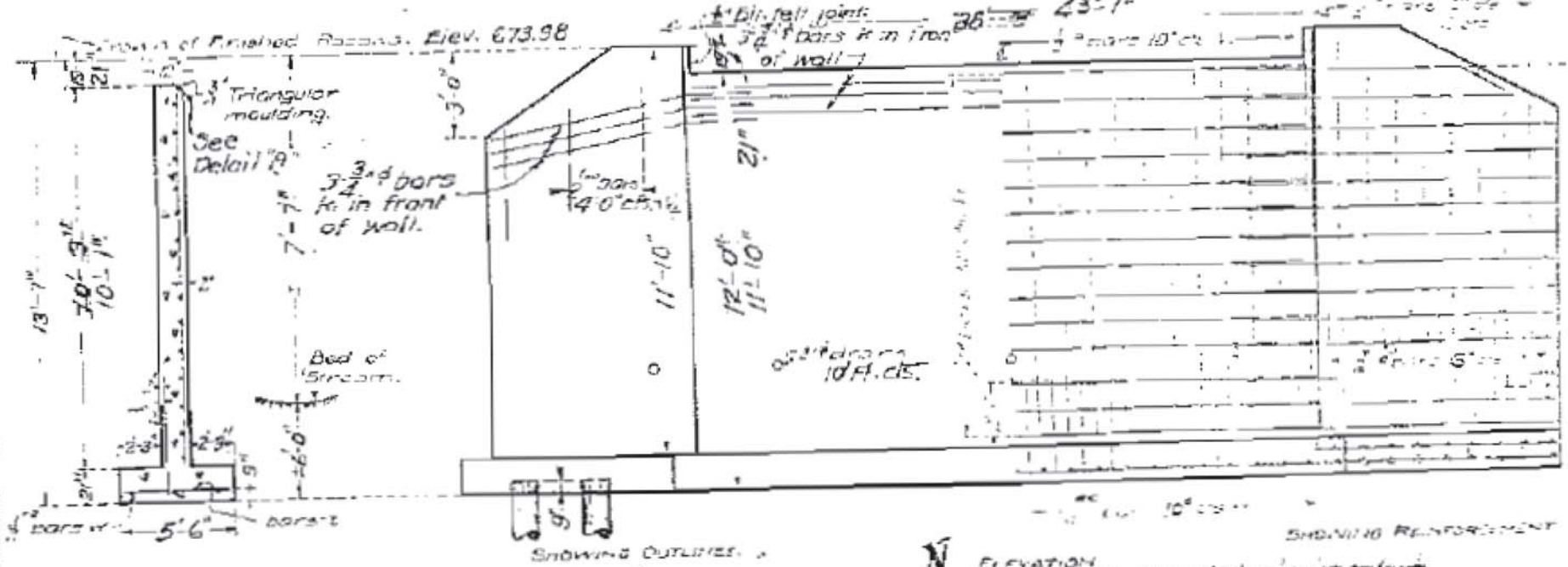

Class X concrete must be used throughout.
 All reinforcing steel shall be accurately wired in place before concrete is poured.
 4' x 5' Notch for Approach Pavement

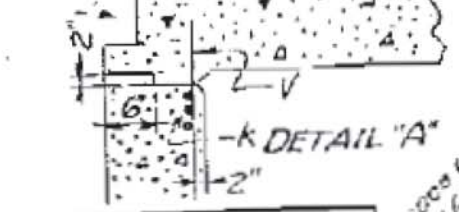

REVISION	DATE	BY	DESCRIPTION
1	9-2-33	H. F. [Signature]	Initial Design

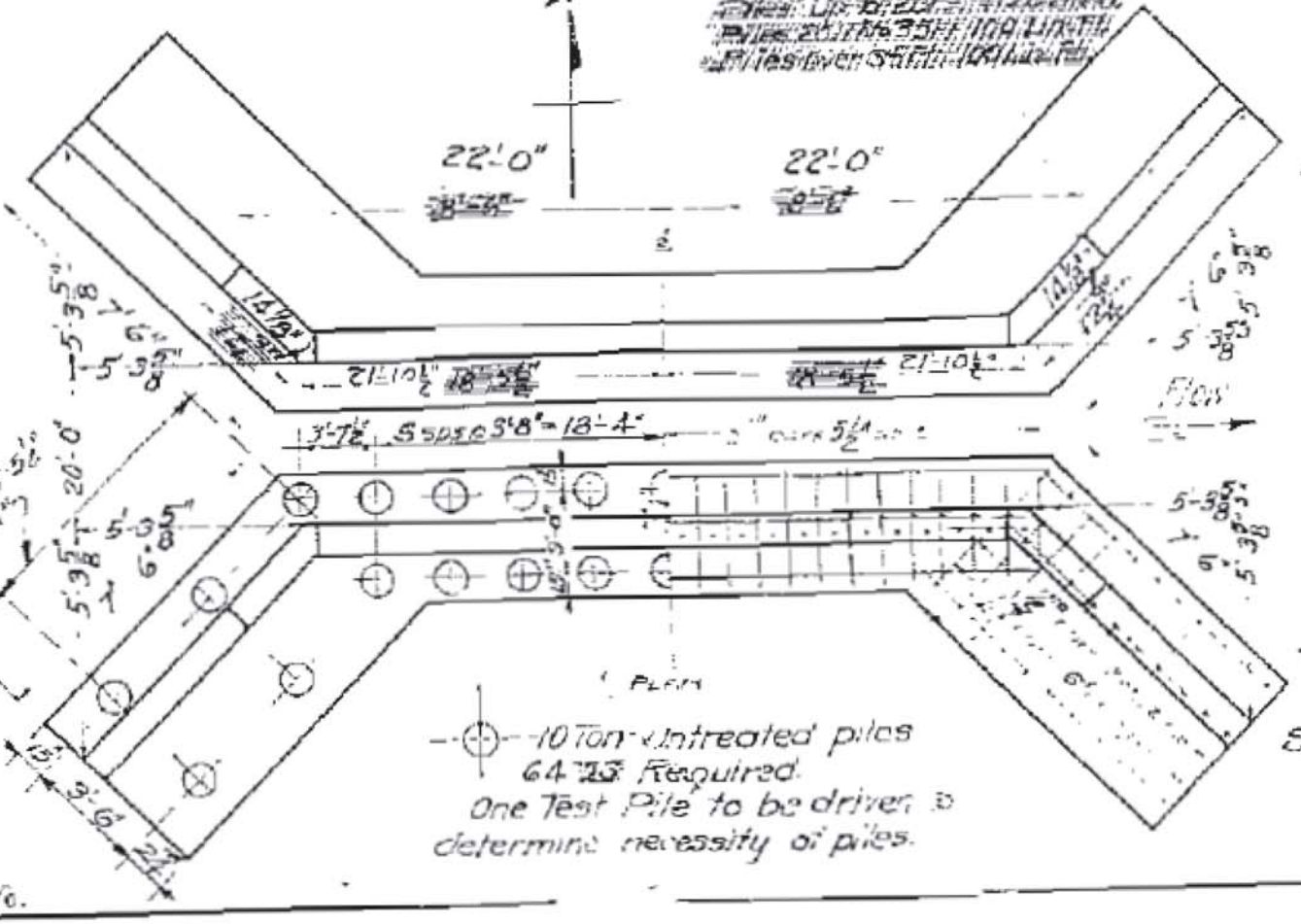

Unit Piling - Lin Ft.
 1280

DEPTH	AREA	PERCENTAGE
1.0	1.0	0.08
2.0	4.0	0.31
3.0	9.0	0.70
4.0	16.0	1.25
5.0	25.0	1.95
6.0	36.0	2.81
7.0	49.0	3.83
8.0	64.0	5.00
9.0	81.0	6.33
10.0	100.0	7.81
11.0	121.0	9.38
12.0	144.0	11.25
13.0	169.0	13.13
14.0	196.0	15.31
15.0	225.0	17.50
16.0	256.0	19.81
17.0	289.0	22.25
18.0	324.0	24.81
19.0	361.0	27.50
20.0	400.0	30.31
21.0	441.0	33.25
22.0	484.0	36.31
23.0	529.0	39.50
24.0	576.0	42.81
25.0	625.0	46.25
26.0	676.0	49.81
27.0	729.0	53.50
28.0	784.0	57.31
29.0	841.0	61.25
30.0	900.0	65.31
31.0	961.0	69.50
32.0	1024.0	73.81
33.0	1089.0	78.25
34.0	1156.0	82.81
35.0	1225.0	87.50
36.0	1296.0	92.31
37.0	1369.0	97.25
38.0	1444.0	102.31
39.0	1521.0	107.50
40.0	1600.0	112.81
41.0	1681.0	118.25
42.0	1764.0	123.81
43.0	1849.0	129.50
44.0	1936.0	135.31
45.0	2025.0	141.25
46.0	2116.0	147.31
47.0	2209.0	153.50
48.0	2304.0	159.81
49.0	2401.0	166.25
50.0	2500.0	172.81
51.0	2601.0	179.50
52.0	2704.0	186.31
53.0	2809.0	193.25
54.0	2916.0	200.31
55.0	3025.0	207.50
56.0	3136.0	214.81
57.0	3249.0	222.25
58.0	3364.0	229.81
59.0	3481.0	237.50
60.0	3600.0	245.31
61.0	3721.0	253.25
62.0	3844.0	261.31
63.0	3969.0	269.50
64.0	4096.0	277.81
65.0	4225.0	286.25
66.0	4356.0	294.81
67.0	4489.0	303.50
68.0	4624.0	312.31
69.0	4761.0	321.25
70.0	4900.0	330.31
71.0	5041.0	339.50
72.0	5184.0	348.81
73.0	5329.0	358.25
74.0	5476.0	367.81
75.0	5625.0	377.50
76.0	5776.0	387.31
77.0	5929.0	397.25
78.0	6084.0	407.31
79.0	6241.0	417.50
80.0	6400.0	427.81
81.0	6561.0	438.25
82.0	6724.0	448.81
83.0	6889.0	459.50
84.0	7056.0	470.31
85.0	7225.0	481.25
86.0	7396.0	492.31
87.0	7569.0	503.50
88.0	7744.0	514.81
89.0	7921.0	526.25
90.0	8100.0	537.81
91.0	8281.0	549.50
92.0	8464.0	561.31
93.0	8649.0	573.25
94.0	8836.0	585.31
95.0	9025.0	597.50
96.0	9216.0	609.81
97.0	9409.0	622.25
98.0	9604.0	634.81
99.0	9801.0	647.50
100.0	10000.0	660.31

S. B. I. ROUTE 70A-SEC. 110B
 LA SALLE COUNTY
 STA 314+05