

STATE OF ILLINOIS
DEPARTMENT OF TRANSPORTATION
DIVISION OF HIGHWAYS

PROPOSED
HIGHWAY PLANS

FAP ROUTE 63 (US 24)
SECTION (1)CR-1, (2)CR
PROJECT ACF-0063 (061)
STRUCTURE RECONSTRUCTION
ADAMS COUNTY

FOR INDEX OF SHEETS, AND HIGHWAY STANDARDS SEE SHEET NO. 2

F.A.P. RTE. 63	SECTION (1)CR-1, (2)CR	COUNTY ADAMS	TOTAL SHEETS 43	SHEET NO. 1
FED. ROAD DIST. NO. 6		ILLINOIS	CONTRACT NO. 72C12	

* 43-2 = 41

D-96-086-08

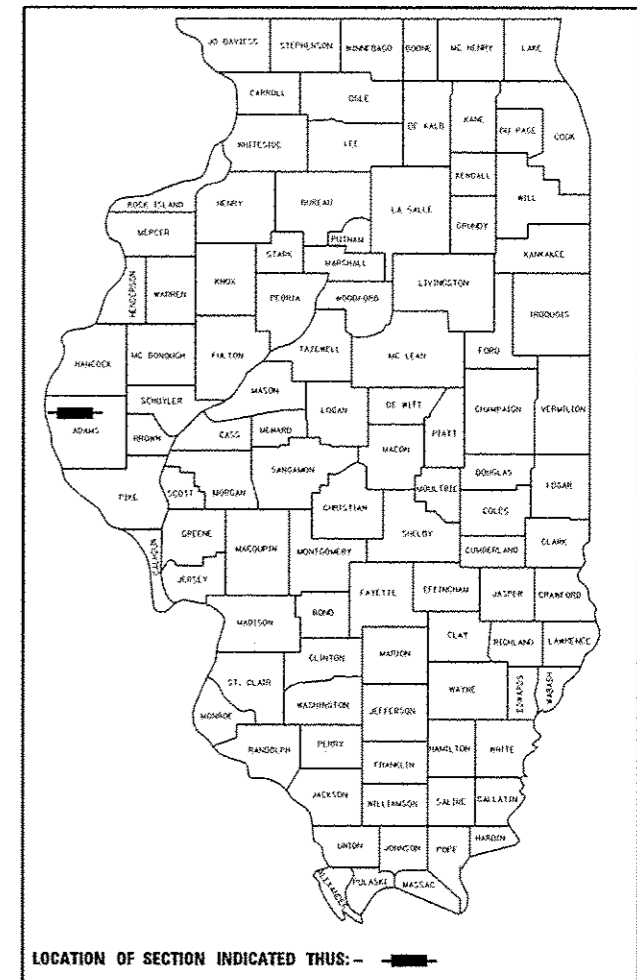

STA. 2259+94.00 (45° SKEW LT AH)
PROPOSED S.N. 001-2509 (FRAZIER CREEK TRIBUTARY)
REINFORCED CONCRETE BOX CULVERT
12'x6' LENGTH=123.1' (OUT TO OUT HEADWALLS)

STA. 2255+86.15 (45° SKEW RT AH)
PROPOSED S.N. 001-7129 (FRAZIER CREEK TRIBUTARY)
REINFORCED CONCRETE BOX CULVERT
10'x6' LENGTH=118.8' (OUT TO OUT HEADWALLS)

DESIGN DESIGNATION:
FAP 63
MINOR ARTERIAL (NON-URBAN)
ADT = 3650 (2012)
PV = 87.12%
SU = 4.66%
MU = 8.22%

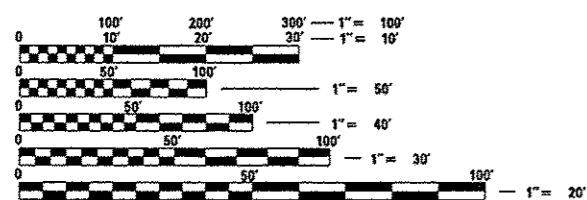

FULL SIZE PLANS HAVE BEEN PREPARED USING STANDARD ENGINEERING SCALES. REDUCED SIZED PLANS WILL NOT CONFORM TO STANDARD SCALES. IN MAKING MEASUREMENTS ON REDUCED PLANS, THE ABOVE SCALES MAY BE USED.

J.U.L.I.E.
JOINT UTILITY LOCATION INFORMATION FOR EXCAVATION
1-800-892-0123
OR 811

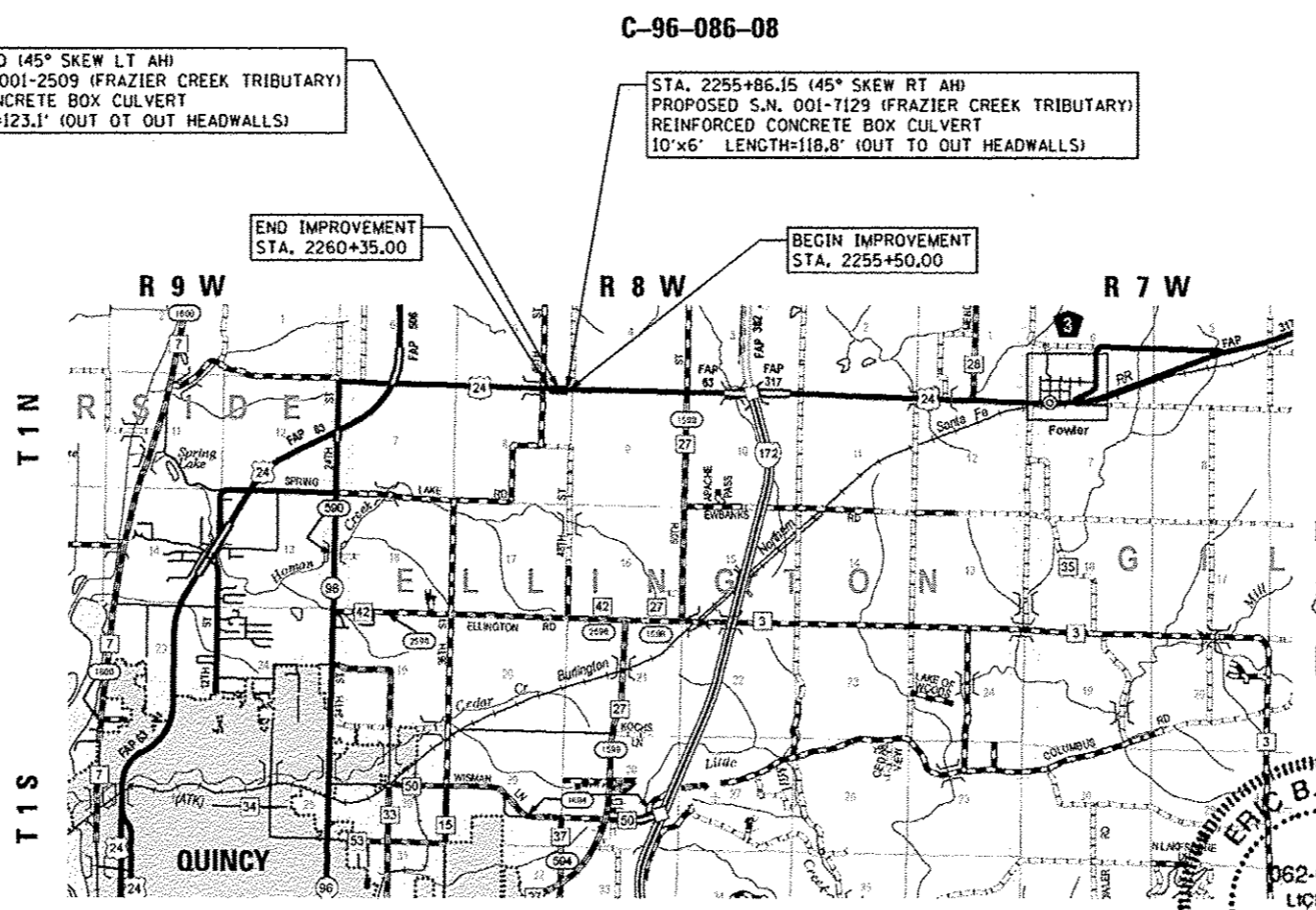

LOCATION MAP

SCALE: 1" = 4000'
GROSS/NET LENGTH OF SECTION = 485.00 FT = 0.092 MILES

ERIC B. BARNES
062-052141
LICENSED PROFESSIONAL ENGINEER

Eric B. Barnes
REGISTERED PROFESSIONAL ENGINEER
STATE OF ILLINOIS NO. 062-052141
LICENSE EXPIRES NOVEMBER 30, 2015

STATE OF ILLINOIS
DEPARTMENT OF TRANSPORTATION
DIVISION OF HIGHWAYS

SUBMITTED *October 25, 2013*

Sagan L. Prichett
DEPUTY DIRECTOR OF HIGHWAYS, REGION ENGINEER

Dec 6, 2013
John D. Baranzello, PE
ENGINEER OF DESIGN AND ENVIRONMENT

Dec 6, 2013
Omer Osman, PE
DIRECTOR OF HIGHWAYS, CHIEF ENGINEER

PLANS PREPARED BY:
KLINGNER & ASSOCIATES, P.C.

Engineers • Architects • Surveyors
158 North 2nd Street, Quincy, IL 62450
1508 Farm Green Road, Normal, IL 61754
1809 N. 4th Street, Suite 100, Burlington, IL 61714
141 North Prairie Street, Salsburg, IL 61754
Ph: (217) 223-3670 • Fax: (217) 223-3683
Ph: (312) 221-0020 • Fax: (312) 221-0012
Ph: (312) 551-3536 • Fax: (312) 551-3535
Ph: (309) 342-4842 • Fax: (309) 342-2781
Internet Address: www.klingner.com

STATE OF ILLINOIS DESIGN FIRM # 1842738

PRINTED BY THE AUTHORITY
OF THE STATE OF ILLINOIS

SENIOR TEAM ENGINEER: MARK DUST (217) 785-0597
TEAM MANAGER: KEN ANDERSON (217) 524-7546

CONTRACT NO. 72C12

12-27-13