

# PART A

## STATE OF ILLINOIS DEPARTMENT OF TRANSPORTATION DIVISION OF HIGHWAYS

# PROPOSED HIGHWAY PLANS

FAI 72 (I-72)  
SECTION (84-10-1)RS-3, (84-10-2)RS-4  
PROJECT  
HMA RESURFACING  
SANGAMON COUNTY

| F.A.I. RTE.        | SECTION                    | COUNTY   | TOTAL SHEETS                       | SHEET NO. |
|--------------------|----------------------------|----------|------------------------------------|-----------|
| I-72               | 84-10-1RS-3, (84-10-2)RS-4 | SANGAMON | 194                                | 14        |
| CONTRACT NO. 72C90 |                            |          | D-96-085-09 PART "A" SHEET 1 OF 45 |           |

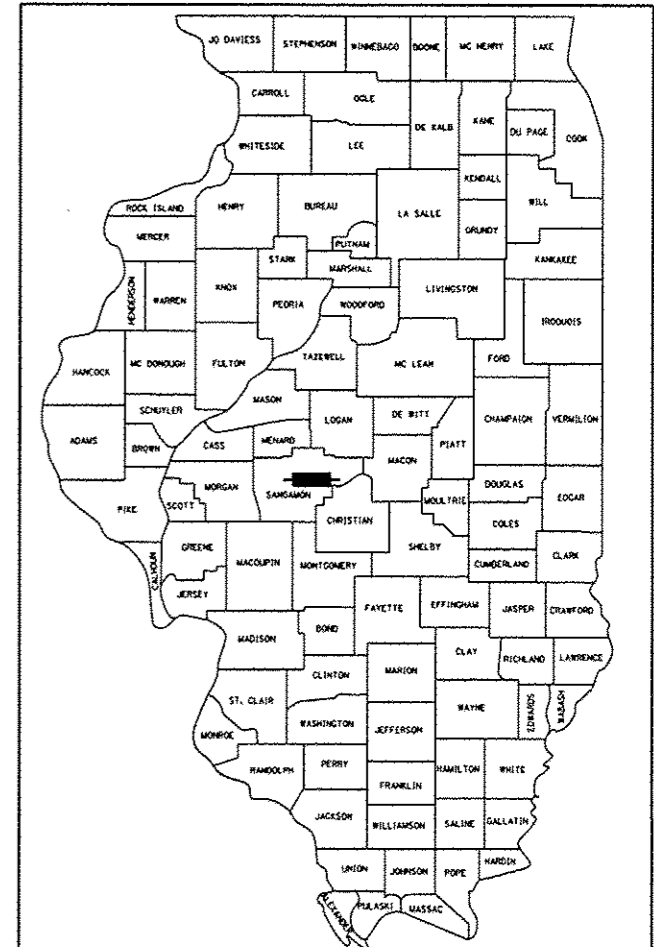

LOCATION OF SECTION INDICATED THUS:

STATE OF ILLINOIS  
DEPARTMENT OF TRANSPORTATION  
DIVISION OF HIGHWAYS

SUBMITTED \_\_\_\_\_ 20 \_\_\_\_\_

DEPUTY DIRECTOR OF HIGHWAYS, REGION ENGINEER  
\_\_\_\_\_ 20 \_\_\_\_\_

ENGINEER OF DESIGN AND ENVIRONMENT  
\_\_\_\_\_ 20 \_\_\_\_\_

DIRECTOR OF HIGHWAYS, CHIEF ENGINEER  
\_\_\_\_\_ 20 \_\_\_\_\_

PRINTED BY THE AUTHORITY  
OF THE STATE OF ILLINOIS

**HOELSCHER ENGINEERING**  
11 Executive Drive Suite 12  
Fairview Heights, Illinois 62208  
(618) 624-0610  
(618) 624-0611 (Fax)

2501 Chatham Road, Suite 120  
Springfield, Illinois 62704  
(217) 698-8070  
(217) 698-0608 (Fax)

DATE: \_\_\_\_\_  
LICENSE EXP. 11/30/2013

### INDEX OF SHEETS

|       |                                 |
|-------|---------------------------------|
| 1     | COVER SHEET                     |
| 2     | GENERAL NOTES AND COMMITMENTS   |
| 3-4   | SUMMARY OF QUANTITIES           |
| 5-7   | TYPICAL SECTIONS                |
| 8-15  | SCHEDULES                       |
| 16-40 | PLAN SHEETS                     |
| 41-42 | SUPERELEVATION DETAILS          |
| 43-44 | BUTT JOINT AND HMA RAMP DETAILS |
| 45    | EMERGENCY CROSSOVER DETAILS     |

### HIGHWAY STANDARDS

|           |           |
|-----------|-----------|
| 000001-06 | 701401-07 |
| 001001-02 | 701406-07 |
| 001006    | 701411-08 |
| 442001-04 | 701421-05 |
| 442101-07 | 701422-05 |
| 635001-01 | 701446-04 |
| 642001-02 | 701456-02 |
| 701101-03 | 701901-02 |
| 701106-02 | 780001-03 |
| 701400-06 | 781001-03 |

- SN 084-0154  
STA. 299+80.31 TR 420 =  
STA. 269+23.08 FAI 72
- BRIDGE OMISSION:  
SN 084-0152 WB STA. 193+08.04 TO  
STA. 201+56.86 FAI 72  
SN 084-0153 EB STA. 193+22.30 TO  
STA. 201+41.12 FAI 72  
OVER SANGAMON RIVER
- SN 084-0151  
STA. 200+00.00 TR 171 =  
STA. 161+04.98 FAI 72
- SN 084-2011  
EXIST. BOX CULV.  
STA. 68+55.02
- SN 084-0150  
STA. 100+01.88 MECHANICSBURG RD. =  
STA. 48+76.46 FAI 72
- BEGIN IMPROVEMENT  
I-72 STA. 13+32.00 EB  
STA. 15+40.00 WB

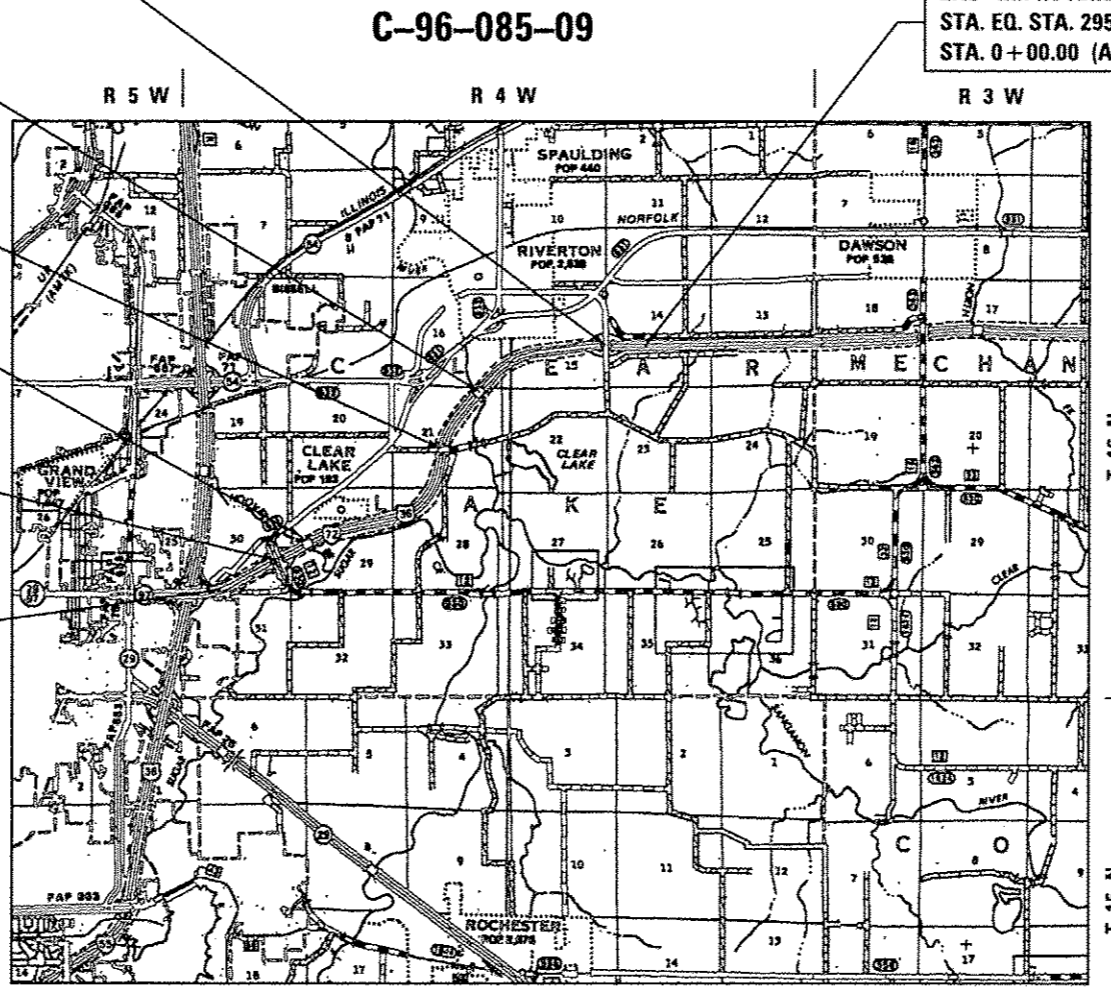

END IMPROVEMENT I-72  
STA. EQ. STA. 295+70.43 (BK) =  
STA. 0+00.00 (AH)

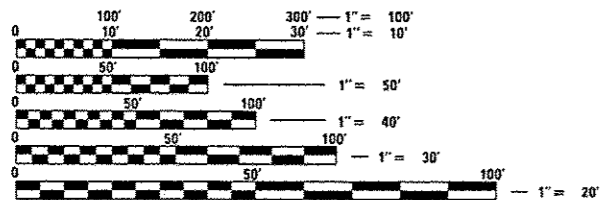

FULL SIZE PLANS HAVE BEEN PREPARED USING STANDARD ENGINEERING SCALES. REDUCED SIZED PLANS WILL NOT CONFORM TO STANDARD SCALES. IN MAKING MEASUREMENTS ON REDUCED PLANS, THE ABOVE SCALES MAY BE USED.

J.U.L.I.E.  
JOINT UTILITY LOCATION INFORMATION FOR EXCAVATION  
1-800-892-0123  
OR 811

PROJECT ENGINEER: **WONN MAUNIA** (217) 783-8800  
PROJECT MANAGER: **WONN MAUNIA** (217) 783-8800  
CONTRACT NO. 72C90

12-30-13

FAI 72  
FUNCTION CLASS=INTERSTATE  
A.D.T. (2012) 13,500  
SU (2012) 610  
MU (2012) 1,430  
PV (2012) 11,460

NET LENGTH OF FAI 72 = 27,389.61 FT = 5.187 MILES  
TOTAL LENGTH OF PROJECT = 27,389.61 FT = 5.187 MILES