

EXIST. CURVE 2, RAMP B
 PI STA. = 213+05.78
 $\Delta = 46^\circ 56' 51''$ (RT)
 $D = 7^\circ 30' 00''$
 $R = 763.94'$
 $T = 331.75'$
 $L = 625.96'$
 $E = 68.93'$
 $e = 8.0\%$
 $T.R. = 48.00'$
 $S.E. RUN = 256.00'$
 $P.C. STA. = 209+74.02$
 $P.T. STA. = 215+99.98$

STA. 36+50.00
 EXISTING 3' DIA.
 PIPE CULV.
 W/END SECTIONS
 EXISTING INLET

PR AGGR WEDGE
 SHLD, TYPE B

PR HMA SHLDS, 2"

PR HMA RAMP
 3 3/4" TO 6"

PR HMA SHLDS, 2 3/4"

PR HMA SHLDS, 2"
 PR AGGR WEDGE
 SHLD, TYPE B

PR HMA SHLDS, 2"

PR AGGR WEDGE
 SHLD, TYPE B

PR HMA RAMP
 6" TO 3 3/4"

PR HMA SHLDS, 2"
 PR AGGR WEDGE SHLD, TYPE B

MEDIAN VARIES FROM 40' AT STA. 22+30.47 TO 88' AT STA. 69+41.50

EXIST. CURVE 1, RAMP C
 PI STA. = 308+14.14
 $\Delta = 22^\circ 28' 08''$ (RT)
 $D = 7^\circ 30' 00''$
 $R = 763.94'$
 $T = 151.74'$
 $L = 299.58'$
 $E = 14.92'$
 $e = 8.0\%$
 $T.R. = 48.00'$
 $S.E. RUN = 256.00'$
 $P.C. STA. = 306+62.40$
 $P.T. STA. = 309+61.98$

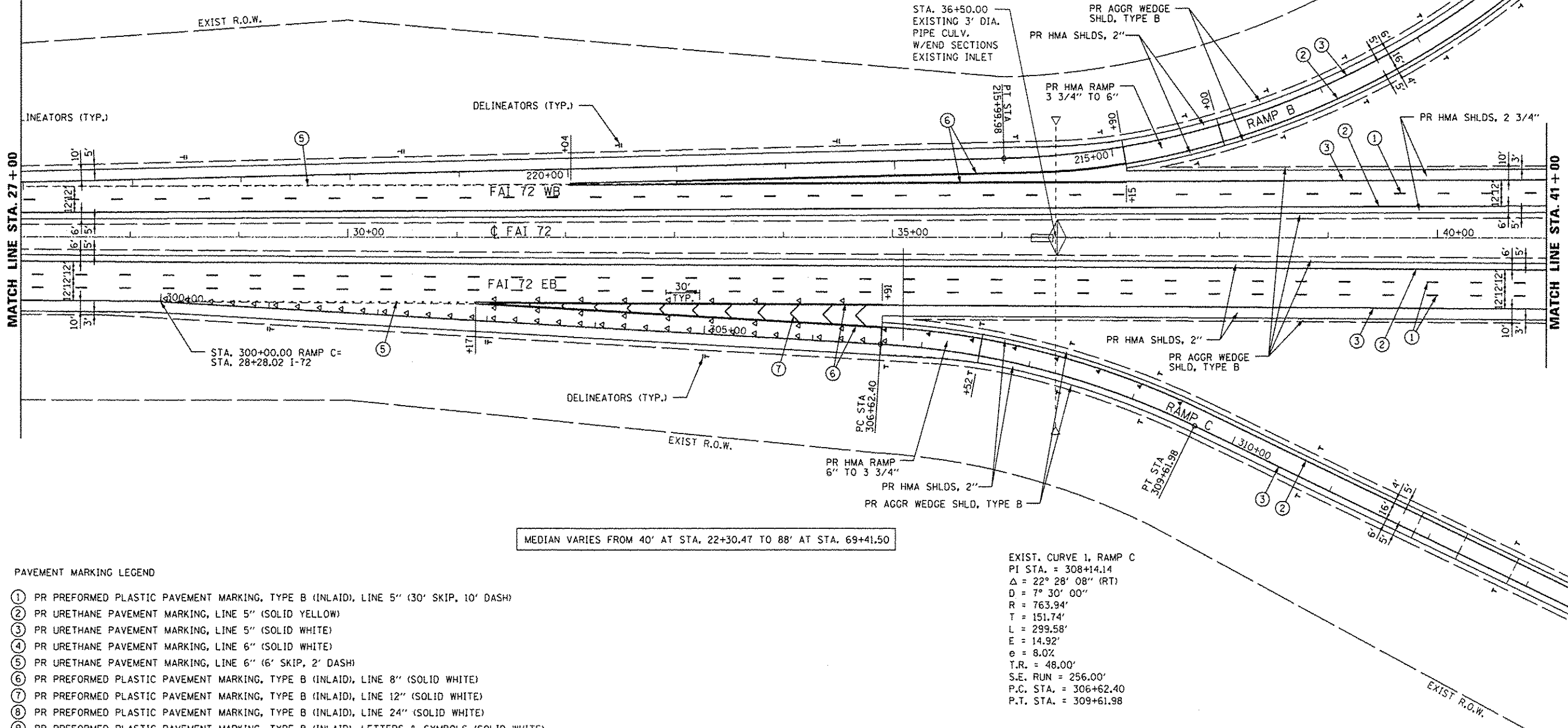

PAVEMENT MARKING LEGEND

- ① PR PREFORMED PLASTIC PAVEMENT MARKING, TYPE B (INLAID), LINE 5" (30' SKIP, 10' DASH)
- ② PR URETHANE PAVEMENT MARKING, LINE 5" (SOLID YELLOW)
- ③ PR URETHANE PAVEMENT MARKING, LINE 5" (SOLID WHITE)
- ④ PR URETHANE PAVEMENT MARKING, LINE 6" (SOLID WHITE)
- ⑤ PR URETHANE PAVEMENT MARKING, LINE 6" (6' SKIP, 2' DASH)
- ⑥ PR PREFORMED PLASTIC PAVEMENT MARKING, TYPE B (INLAID), LINE 8" (SOLID WHITE)
- ⑦ PR PREFORMED PLASTIC PAVEMENT MARKING, TYPE B (INLAID), LINE 12" (SOLID WHITE)
- ⑧ PR PREFORMED PLASTIC PAVEMENT MARKING, TYPE B (INLAID), LINE 24" (SOLID WHITE)
- ⑨ PR PREFORMED PLASTIC PAVEMENT MARKING, TYPE B (INLAID), LETTERS & SYMBOLS (SOLID WHITE)
- ▷ PR RAISED REFLECTIVE PAVEMENT MARKER, ONE-WAY, WHITE
- ◀ PR RAISED REFLECTIVE PAVEMENT MARKER, ONE-WAY, AMBER

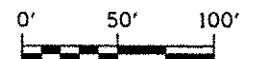

USER NAME = sponksgw	DESIGNED - BTM	REVISED -	STATE OF ILLINOIS DEPARTMENT OF TRANSPORTATION	PLAN SHEETS		F.A.I. RTE. I-72	SECTION *	COUNTY SANGAMON	TOTAL SHEETS 194	SHEET NO. 30
PLOT SCALE = 100.0000' / in.	DRAWN - BTM	REVISED -		SCALE:	SHEET NO. OF SHEETS	STA. TO STA.	* (84-10-1)RS-3, (84-10-2)RS-4		CONTRACT NO. 72C90	
PLOT DATE = Sep-06-2013 07:50:56AM	CHECKED - JSA	REVISED -					ILLINOIS FED. AID PROJECT			
FILE NAME = c:\pvc\work\pvidat\spksgw\0330226\0672C90.sht.pln02.dgn	DATE - 12/19/12	REVISED -								