



PAVEMENT MARKING LEGEND

- ① PR PREFORMED PLASTIC PAVEMENT MARKING, TYPE B (INLAID), LINE 5" (30' SKIP, 10' DASH)
- ② PR URETHANE PAVEMENT MARKING, LINE 5" (SOLID YELLOW)
- ③ PR URETHANE PAVEMENT MARKING, LINE 5" (SOLID WHITE)
- ④ PR URETHANE PAVEMENT MARKING, LINE 6" (SOLID WHITE)
- ⑤ PR URETHANE PAVEMENT MARKING, LINE 6" (6' SKIP, 2' DASH)
- ⑥ PR PREFORMED PLASTIC PAVEMENT MARKING, TYPE B (INLAID), LINE 8" (SOLID WHITE)
- ⑦ PR PREFORMED PLASTIC PAVEMENT MARKING, TYPE B (INLAID), LINE 12" (SOLID WHITE)
- ⑧ PR PREFORMED PLASTIC PAVEMENT MARKING, TYPE B (INLAID), LINE 24" (SOLID WHITE)
- ⑨ PR PREFORMED PLASTIC PAVEMENT MARKING, TYPE B (INLAID), LETTERS & SYMBOLS (SOLID WHITE)
- ▷ PR RAISED REFLECTIVE PAVEMENT MARKER, ONE-WAY, WHITE
- ◀ PR RAISED REFLECTIVE PAVEMENT MARKER, ONE-WAY, AMBER

MATCH LINE
STA. 403+00
RAMP D

EXIST. CURVE 2, RAMP D
PI STA. = 411+06.33
Δ = 44° 21' 48" (RT)
D = 7° 30' 00"
R = 763.94'
T = 311.47'
L = 591.51'
E = 61.06'
e = 8.0%
T.R. = 48.00'
S.E. RUN = 256.00'
P.C. STA. = 407+94.85
P.T. STA. = 413+86.36

EXIST. CURVE 1, RAMP D
PI STA. = 403+91.58
Δ = 41° 02' 12" (LT)
D = 12° 00' 00"
R = 477.46'
T = 178.69'
L = 311.00'
E = 3'
e = 8.0%
T.R. = 41.00'
S.E. RUN = 220.00'
P.C. STA. = 402+12.89
P.T. STA. = 405+54.86

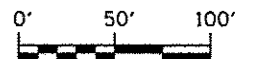
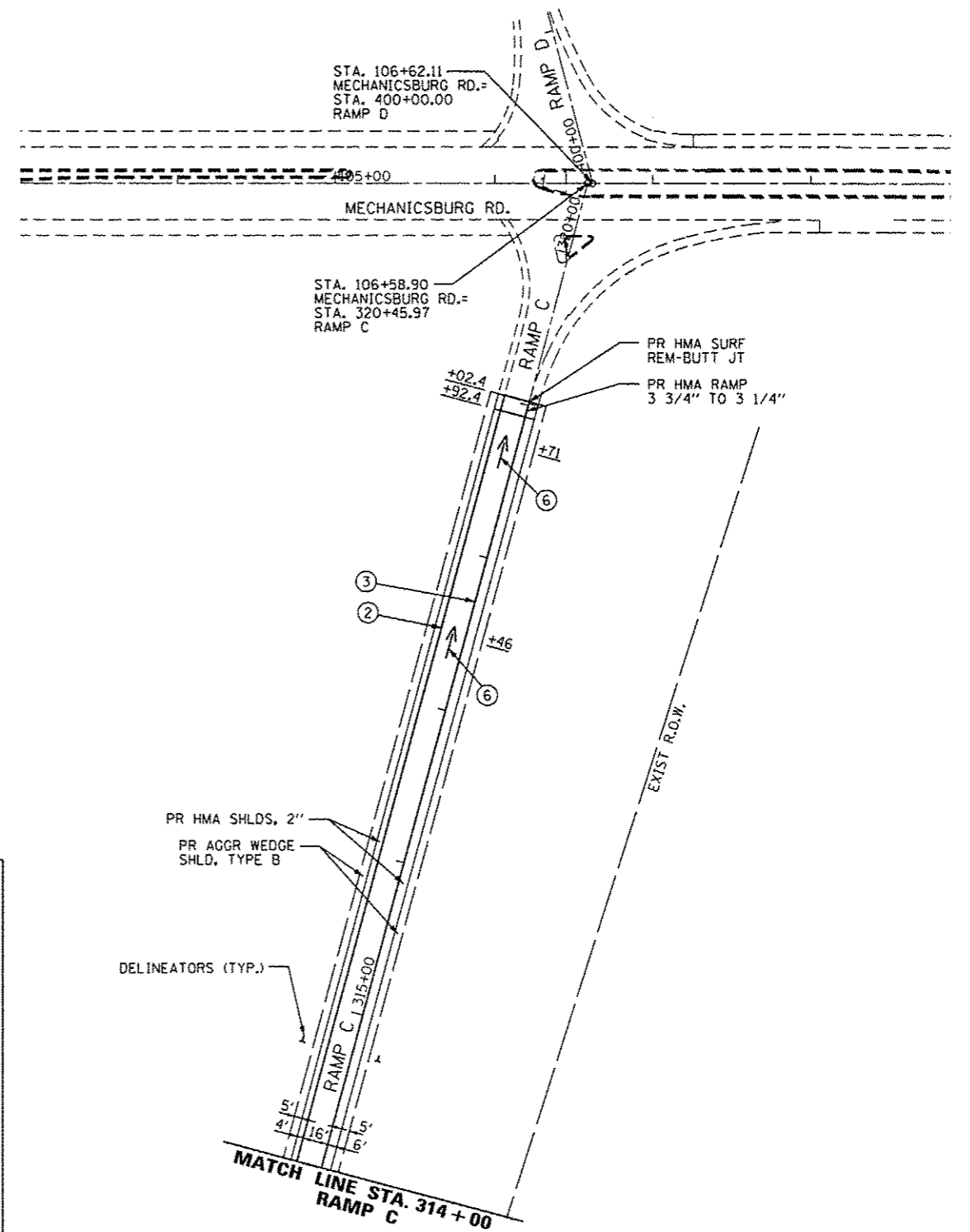
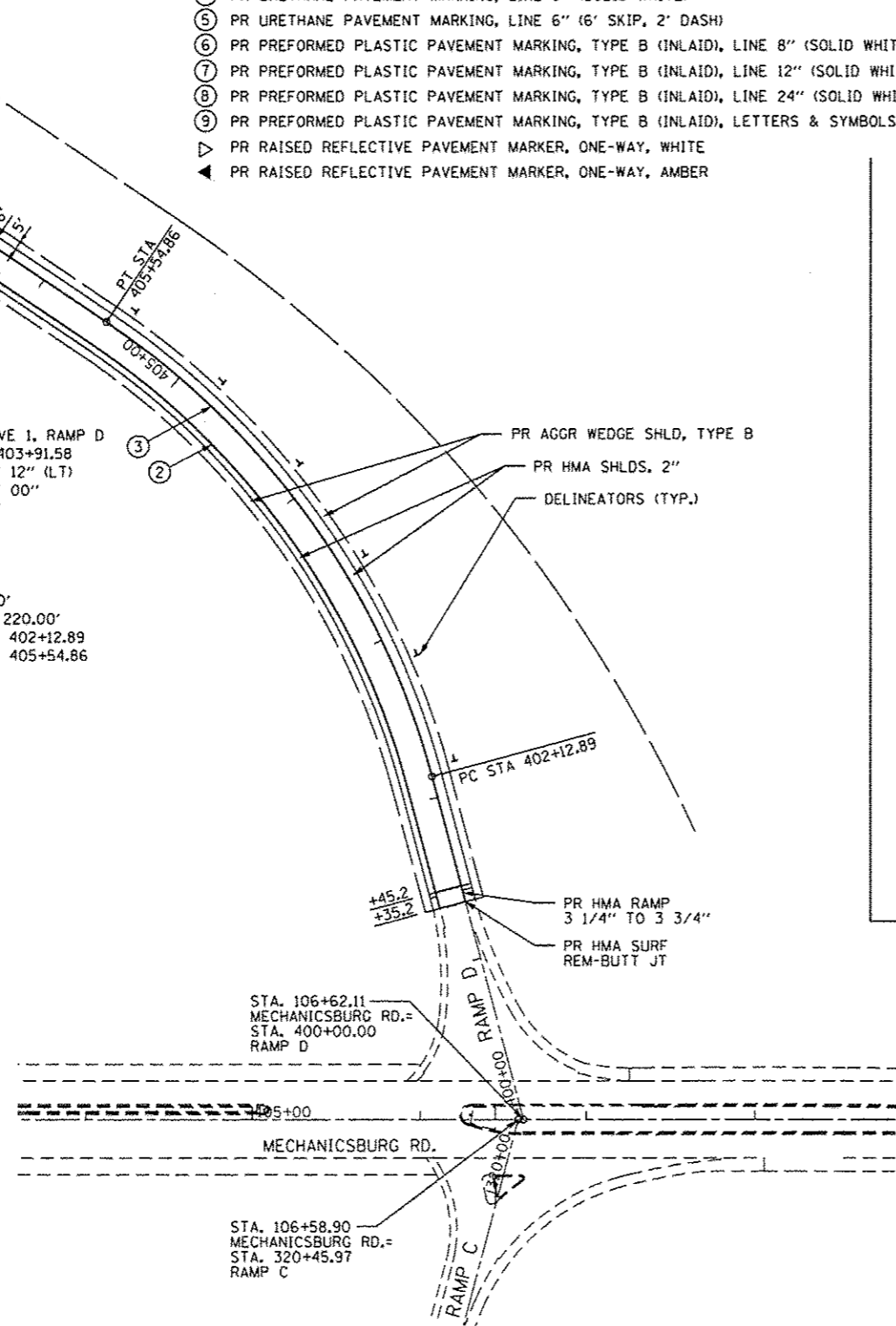

USER NAME = sparkgw	DESIGNED - BTM	REVISIED -
PLOT SCALE = 1/8" = 100'	DRAWN - BTM	REVISIED -
PLOT DATE = Sep-06-2013 09:23:21AM	CHECKED - JSA	REVISIED -
	DATE - 12/19/12	REVISIED -

STATE OF ILLINOIS
DEPARTMENT OF TRANSPORTATION

PLAN SHEETS

SCALE: SHEET NO. OF SHEETS STA. TO STA.

F.A.I. RTE.	SECTION	COUNTY	TOTAL SHEETS	SHEET NO.
I-72	*	SANGAMON	194	51
* (84-10-URS-3, (84-10-2URS-4) CONTRACT NO. 72C90				
ILLINOIS FED. AID PROJECT				