

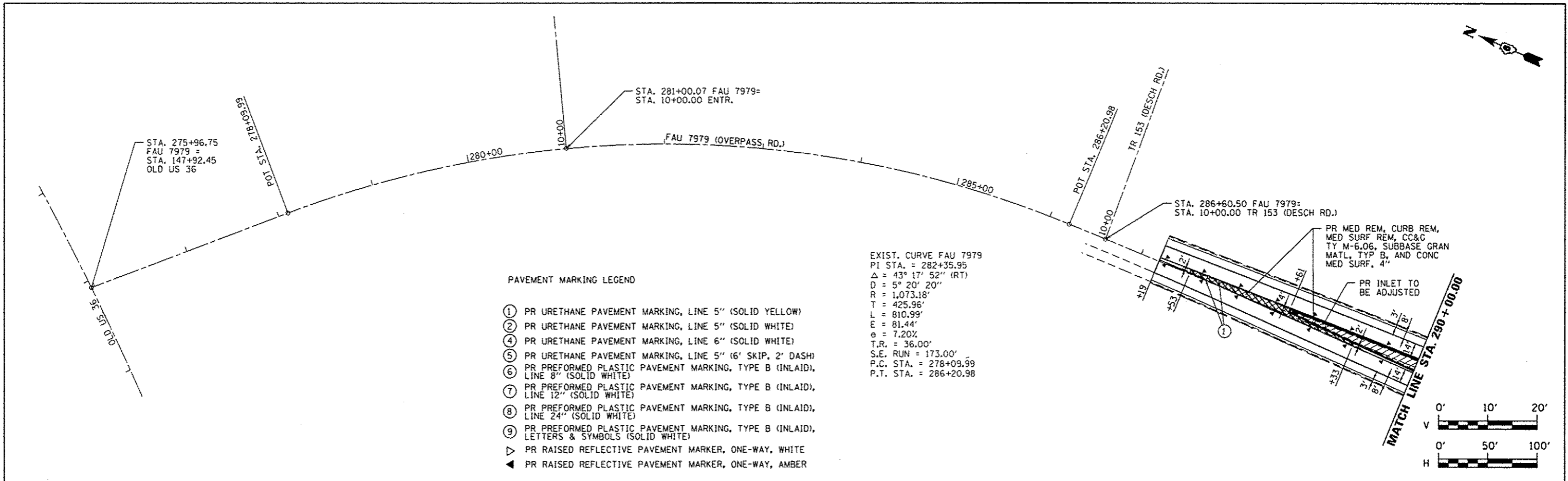

DATE	
BY	
SKETCHED	
DATE	
BY	
ALIGNED	
DATE	
BY	
NOTE BOOK	
NO.	
FILE NAME	

DATE	
BY	
SKETCHED	
DATE	
BY	
GRADES CHECKED	
DATE	
BY	
STRUCTURE NOTATIONS CHECKED	
DATE	
BY	



EXIST. CURVE FAU 7979  
 PI STA. = 282+35.95  
 $\Delta = 43^\circ 17' 52''$  (RT)  
 $D = 5^\circ 20' 20''$   
 $R = 1,073.18'$   
 $T = 425.96'$   
 $L = 810.99'$   
 $E = 81.44'$   
 $e = 7.20\%$   
 $T.R. = 36.00'$   
 $S.E. RUN = 173.00'$   
 $P.C. STA. = 278+09.99$   
 $P.T. STA. = 286+20.98$

- PAVEMENT MARKING LEGEND
- ① PR URETHANE PAVEMENT MARKING, LINE 5" (SOLID YELLOW)
  - ② PR URETHANE PAVEMENT MARKING, LINE 5" (SOLID WHITE)
  - ④ PR URETHANE PAVEMENT MARKING, LINE 6" (SOLID WHITE)
  - ⑤ PR URETHANE PAVEMENT MARKING, LINE 5" (6' SKIP, 2' DASH)
  - ⑥ PR PREFORMED PLASTIC PAVEMENT MARKING, TYPE B (INLAID), LINE 8" (SOLID WHITE)
  - ⑦ PR PREFORMED PLASTIC PAVEMENT MARKING, TYPE B (INLAID), LINE 12" (SOLID WHITE)
  - ⑧ PR PREFORMED PLASTIC PAVEMENT MARKING, TYPE B (INLAID), LINE 24" (SOLID WHITE)
  - ⑨ PR PREFORMED PLASTIC PAVEMENT MARKING, TYPE B (INLAID), LETTERS & SYMBOLS (SOLID WHITE)
  - ▷ PR RAISED REFLECTIVE PAVEMENT MARKER, ONE-WAY, WHITE
  - ◀ PR RAISED REFLECTIVE PAVEMENT MARKER, ONE-WAY, AMBER

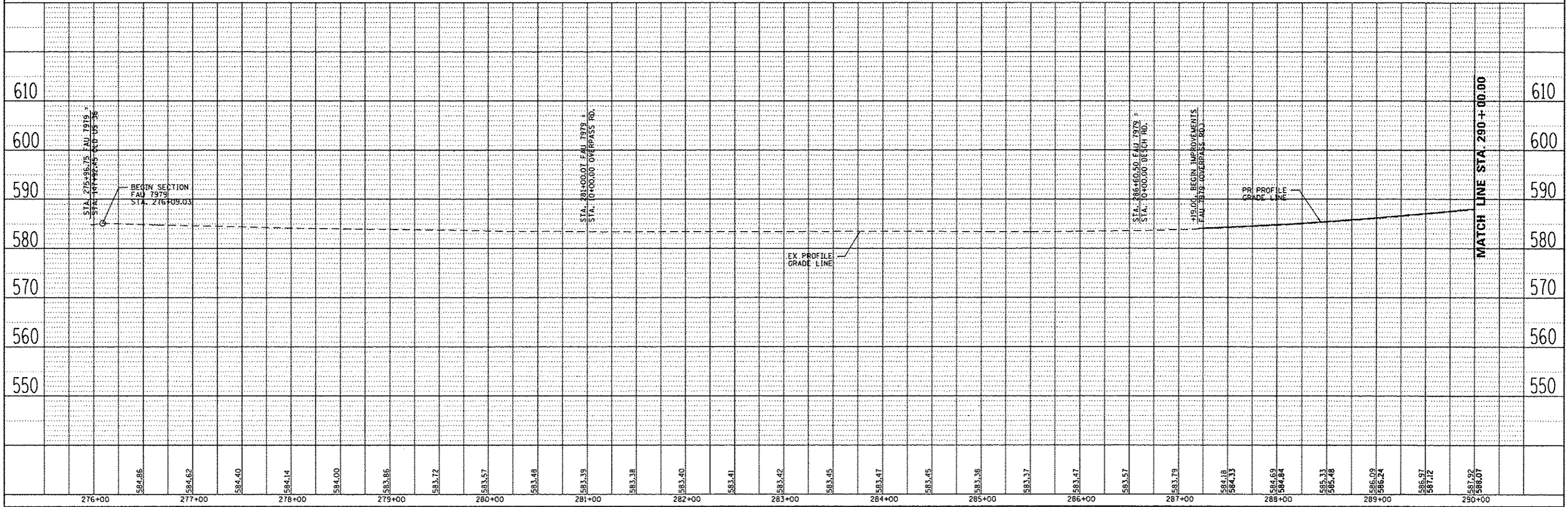
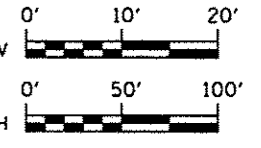

USER NAME = sparkgw	DESIGNED - BTM	REVISED - 8.30.13 TMJ D6 S&P	<b>STATE OF ILLINOIS</b> <b>DEPARTMENT OF TRANSPORTATION</b>	<b>PLAN &amp; PROFILE SHEETS</b> <b>TR 420 (OVERPASS RD.)</b>				F.A.J. RTE.	SECTION	COUNTY	TOTAL SHEETS	SHEET NO.
PLOT SCALE = 100.0000' / 1"	DRAWN - BTM	REVISED -		1-72		SANGAMON	194	89				
PLOT DATE = Sep-06-2013 11:28:17AM	CHECKED - JSA	REVISED -		SCALE: SHEET NO. OF SHEETS STA. TO STA.				CONTRACT NO. 72C90				
DATE - 9/20/12	DATE -	REVISED -		(84-10-IRS-3,84-10-2RS-4)RR-1				ILLINOIS FED. AID PROJECT				