

**LEGEND**

- ↑ SIGN
- DRUM WITH STEADY BURNING LIGHT
- FLEXIBLE DELINEATOR
- ◇ BARRIER WALL/GUARDRAIL MARKERS
- ▬ TEMPORARY CONCRETE BARRIER
- ▨ IMPACT ATTENUATOR, TEMPORARY
- ➔ DIRECTION OF TRAFFIC
- ⊥ TYPE III BARRICADE
- ⊙ TRAFFIC SIGNAL
- ◇ DETECTOR LOOP
- ▨ DOUBLE VERTICAL PANEL

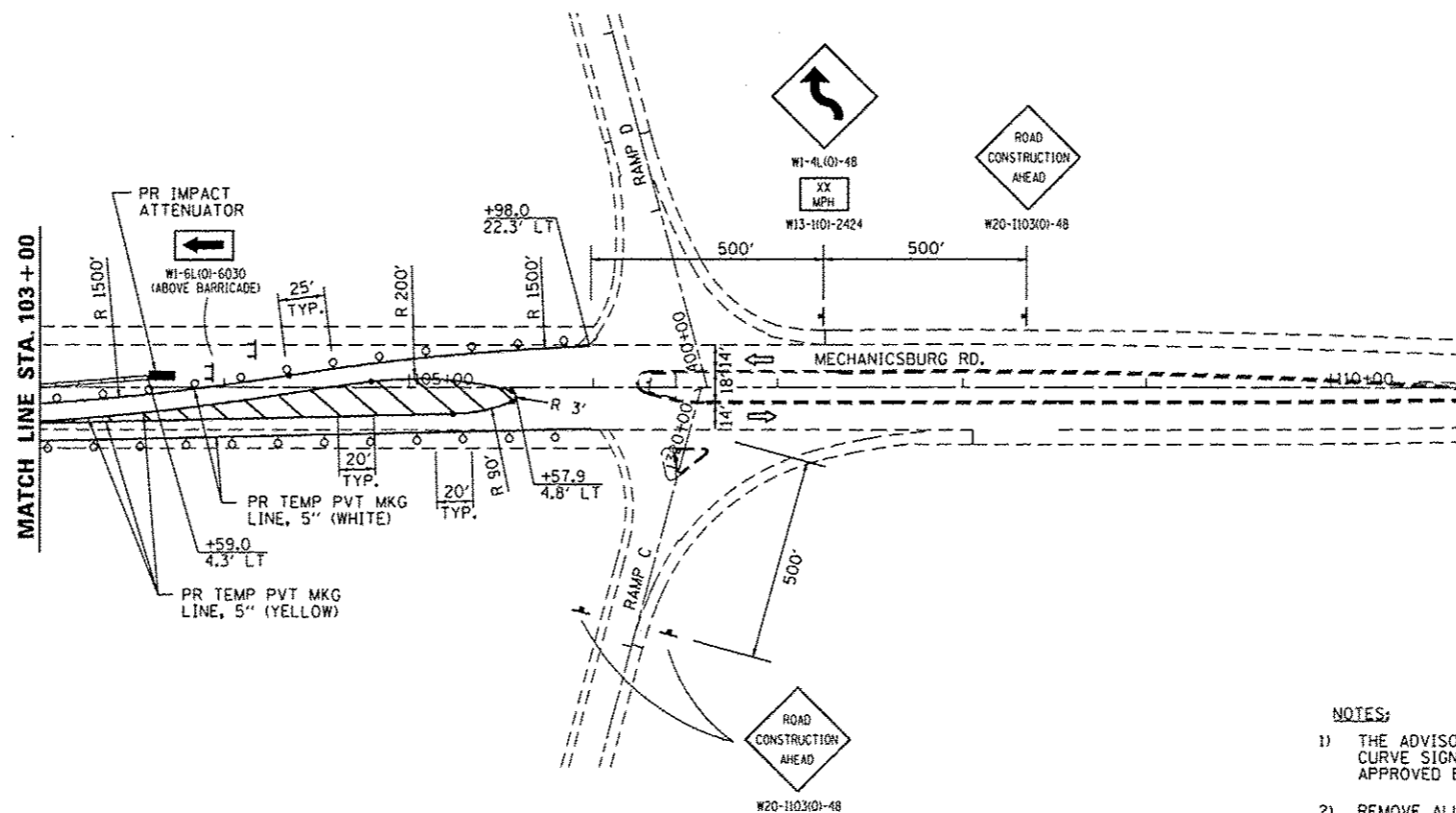

**NOTES:**

- 1) THE ADVISORY SPEED TO BE SHOWN BELOW THE REVERSE CURVE SIGNS SHALL BE DETERMINED AT THE SITE AND APPROVED BY THE ENGINEER.
- 2) REMOVE ALL CONFLICTING PAVEMENT MARKINGS PRIOR TO PLACING TEMPORARY STRIPING.

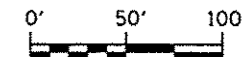

USER NAME = sparkgw	DESIGNED - BTM	REVISED -
PLOT SCALE = 100.0000' / in.	DRAWN - BTM	REVISED -
PLOT DATE = Sep-06-2013 09:28:26AM	CHECKED - JSA	REVISED -
	DATE - 12/19/12	REVISED -

STATE OF ILLINOIS  
DEPARTMENT OF TRANSPORTATION

MAINTENANCE OF TRAFFIC - MECHANICSBURG RD.  
STAGE I

SCALE: SHEET NO. OF SHEETS STA. TO STA.

F.A.I. RTE.	SECTION	COUNTY	TOTAL SHEETS	SHEET NO.
1722	*	SANGAMON	194	102
* (84-10-1RS-3, 84-10-2RS-4) BR. 1			CONTRACT NO. 72C90	
ILLINOIS FED. AID PROJECT				