

**PAVEMENT MARKING LEGEND**

- ① THERMOPLASTIC PAVEMENT MARKING - LINE 5"
- ② THERMOPLASTIC PAVEMENT MARKING - LINE 5" (DOUBLE YELLOW)
- ③ THERMOPLASTIC PAVEMENT MARKING - LINE 6"
- ④ THERMOPLASTIC PAVEMENT MARKING - LINE 6" (6' SKIP, 2' DASH)
- ⑤ THERMOPLASTIC PAVEMENT MARKING - LINE 8"
- ⑥ THERMOPLASTIC PAVEMENT MARKING - LINE 12"
- ⑦ PREFORMED PLASTIC PAVEMENT MARKING, TYPE B - INLAID - 24" LINE
- ⑧ THERMOPLASTIC PAVEMENT MARKING - LINE 5" (30' SKIP, 10' DASH)

-W PAVEMENT MARKING, WHITE  
 -Y PAVEMENT MARKING, YELLOW

PREFORMED PLASTIC PAVEMENT MARKING, TYPE B - INLAID - LETTERS AND SYMBOLS (WHITE)  
 RAISED REFLECTIVE PAVEMENT MARKER (ONE-WAY CRYSTAL)  
 RAISED REFLECTIVE PAVEMENT MARKER (ONE -WAY AMBER)  
 RAISED REFLECTIVE PAVEMENT MARKER (TWO -WAY AMBER)

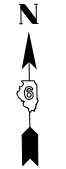
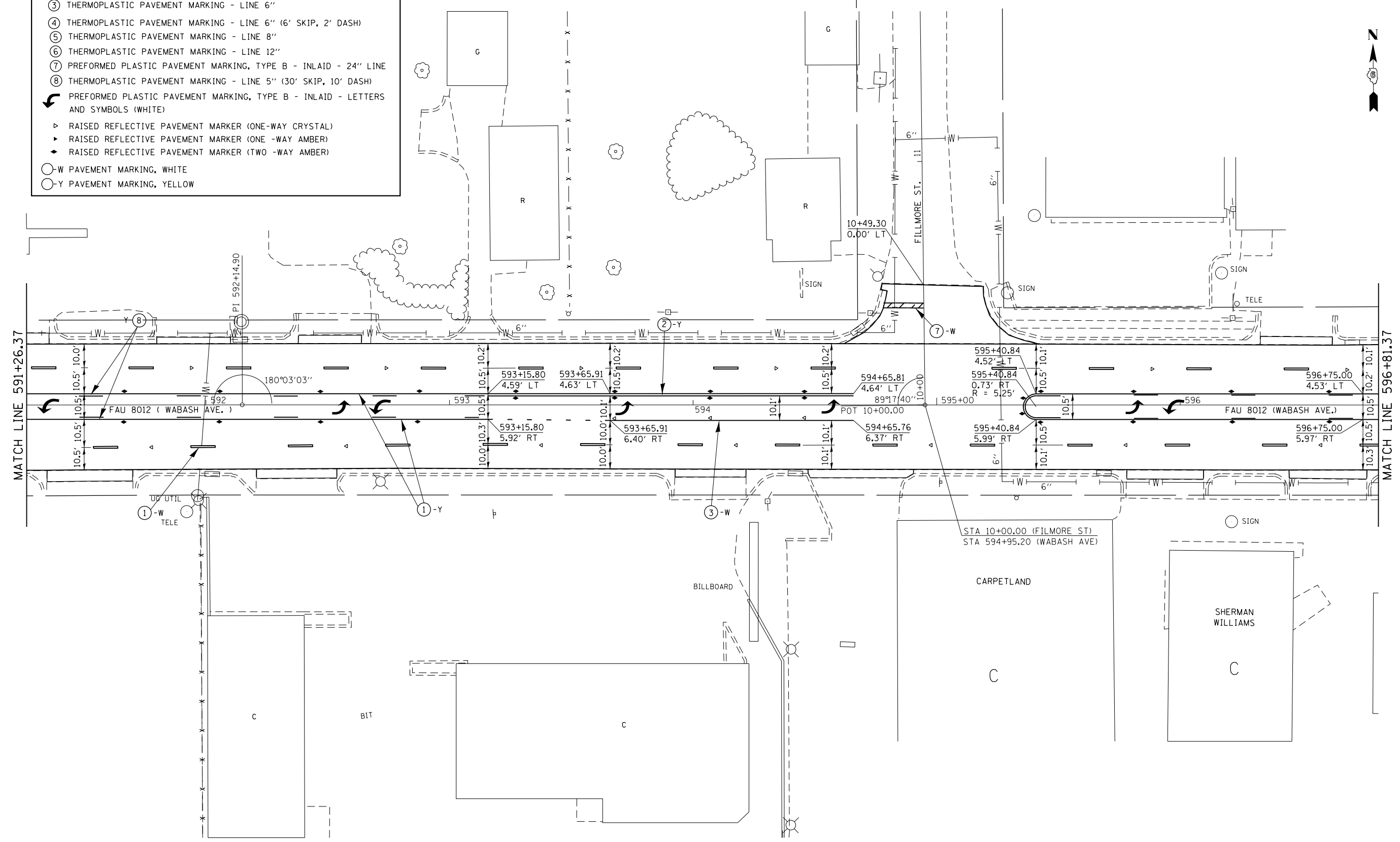

FILE NAME =	USER NAME = sparksgw	DESIGNED - RTS	REVISED -	<b>STATE OF ILLINOIS DEPARTMENT OF TRANSPORTATION</b>	<b>PAVEMENT MARKING - WABASH AVE.</b>		F.A.P. RTE.	SECTION	COUNTY	TOTAL SHEETS	SHEET NO.			
Default	Plot Scale = 40.0000' / in.	DRAWN - RTS	REVISED -		SCALE:	SHEET 19 OF 21 SHEETS	STA.	TO STA.	664	.	SANGAMON	126	75	
	PLOT DATE = Nov-08-2013 12:09:09PM	CHECKED -	REVISED -									CONTRACT NO. 72F29		
		DATE - 10-11-2013	REVISED -									ILLINOIS FED. AID PROJECT		