

**LEGEND**

- ① REMOVE EXISTING CONCRETE FOUNDATION
  - ② REMOVE EXISTING HANDHOLE
  - \* REMOVE EXISTING TRAFFIC SIGNAL EQUIPMENT
- | QTY. | EQUIPMENT                        |
|------|----------------------------------|
| 2    | STEEL MAST-ARM ASSEMBLY AND POLE |
| 1    | TRAFFIC SIGNAL POST              |
| 2    | SIGNAL HEAD, LED, 1 F, 3 S, MM   |
| 3    | SIGNAL HEAD, LED, 1 F, 3 S, BM   |
| 1    | SIGNAL HEAD, LED, 1 F, 4 S, BM   |
| 2    | SIGNAL HEAD, LED, 1 F, 5 S, MM   |
| 2    | SIGNAL HEAD, LED, 1 F, 5 S, BM   |
| 8    | PEDESTRIAN SIGNAL HEAD           |
| 8    | PEDESTRIAN PUSHBUTTON            |

E - EXISTING  
P - PVC CONDUIT

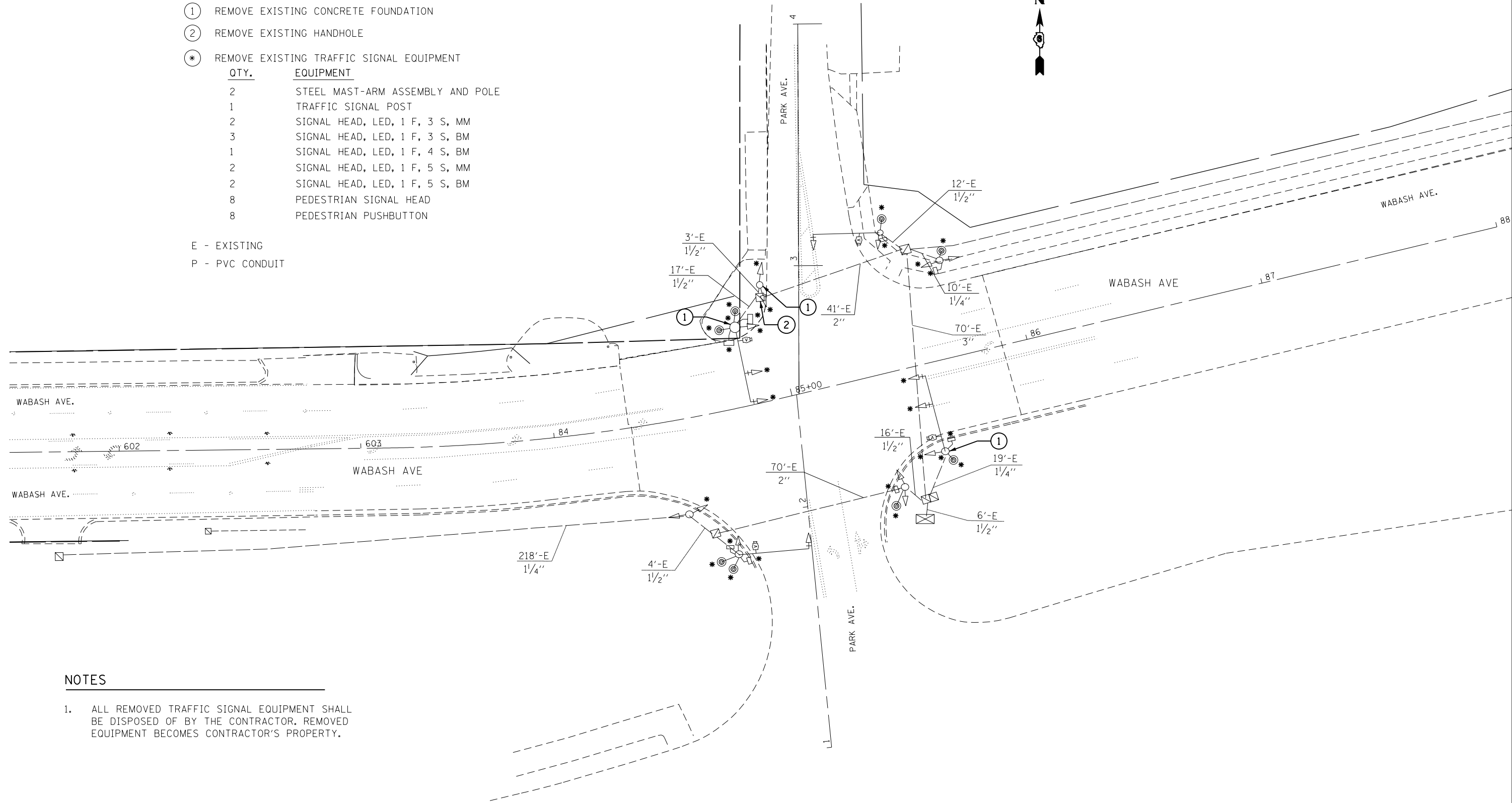

**NOTES**

1. ALL REMOVED TRAFFIC SIGNAL EQUIPMENT SHALL BE DISPOSED OF BY THE CONTRACTOR. REMOVED EQUIPMENT BECOMES CONTRACTOR'S PROPERTY.

FILE NAME =	USER NAME = sparksgw	DESIGNED - DMS	REVISED -
ct:\pw\work\p\idot\sparksgw\10296742\06729\sh-t-traffic\signal.dgn		DRAWN - DMS	REVISED -
Default	PLOT SCALE = 40.0000' / in.	CHECKED -	REVISED -
	PLOT DATE = Nov-08-2013 12:09:26PM	DATE -	REVISED -

**STATE OF ILLINOIS  
DEPARTMENT OF TRANSPORTATION**

**EXISTING TRAFFIC SIGNAL PLAN SHEET  
WABASH AVE. & PARK AVE.**

SCALE: SHEET OF SHEETS STA. TO STA.

F.A.P. RTE.	SECTION	COUNTY	TOTAL SHEETS	SHEET NO.
664	.	SANGAMON	126	95
			CONTRACT NO. 72F29	
ILLINOIS FED. AID PROJECT				