

CODE NO.	ITEM	UNIT	TOTAL QUANTITY
81028350	UNDERGROUND CONDUIT, PVC, 2" DIA.	FOOT	16
81028370	UNDERGROUND CONDUIT, PVC, 3" DIA.	FOOT	65
81400100	HANDHOLE	EACH	1
82102250	LUMINAIRE, SODIUM VAPOR, HORIZONTAL MOUNT, 250 WATT	EACH	2
85000200	MAINTENANCE OF EXISTING TRAFFIC SIGNAL INSTALLATION	EACH	1
87300010	GROUNDING EXISTING HANDHOLE FRAME AND COVER	EACH	3
87301245	ELECTRIC CABLE IN CONDUIT, SIGNAL NO. 14 5C	FOOT	1110
87301900	ELECTRIC CABLE IN CONDUIT, EQUIPMENT GROUNDING CONDUCTOR, NO. 6 1C	FOOT	340
87502700	TRAFFIC SIGNAL POST, ALUMINUM 16 FT.	EACH	1
87600100	PEDESTRIAN PUSH-BUTTON POST, TYPE I	EACH	2
87702920	STEEL COMBINATION MAST ARM ASSEMBLY AND POLE, 38 FT.	EACH	1
87702960	STEEL COMBINATION MAST ARM ASSEMBLY AND POLE, 46 FT.	EACH	1
87800100	CONCRETE FOUNDATION, TYPE A	FOOT	3
87800415	CONCRETE FOUNDATION, TYPE E 36-INCH DIAMETER	FOOT	24
87900200	DRILL EXISTING HANDHOLE	EACH	2
88040090	SIGNAL HEAD, POLYCARBONATE, LED, 1-FACE, 3-SECTION, MAST ARM MOUNTED	EACH	4
88040110	SIGNAL HEAD, POLYCARBONATE, LED, 1-FACE, 4-SECTION, BRACKET MOUNTED	EACH	2
88040120	SIGNAL HEAD, POLYCARBONATE, LED, 1-FACE, 4-SECTION, MAST ARM MOUNTED	EACH	2
88040250	SIGNAL HEAD, POLYCARBONATE, LED, 2-FACE, 1-3 SECTION, 1-4 SECTION, BRACKET MOUNTED	EACH	1
88102825	PEDESTRIAN SIGNAL HEAD, POLYCARBONATE, LED, 1-FACE, BRACKET MOUNTED WITH COUNT DOWN TIMER	EACH	4
88102845	PEDESTRIAN SIGNAL HEAD, POLYCARBONATE, LED, 2-FACE, BRACKET MOUNTED WITH COUNT DOWN TIMER	EACH	2

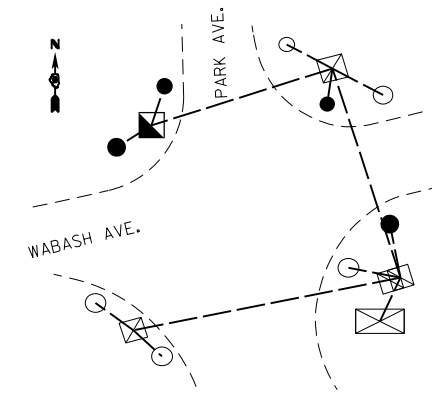

PROPOSED GROUNDING DIAGRAM

WABASH AVE.

WABASH AVE.

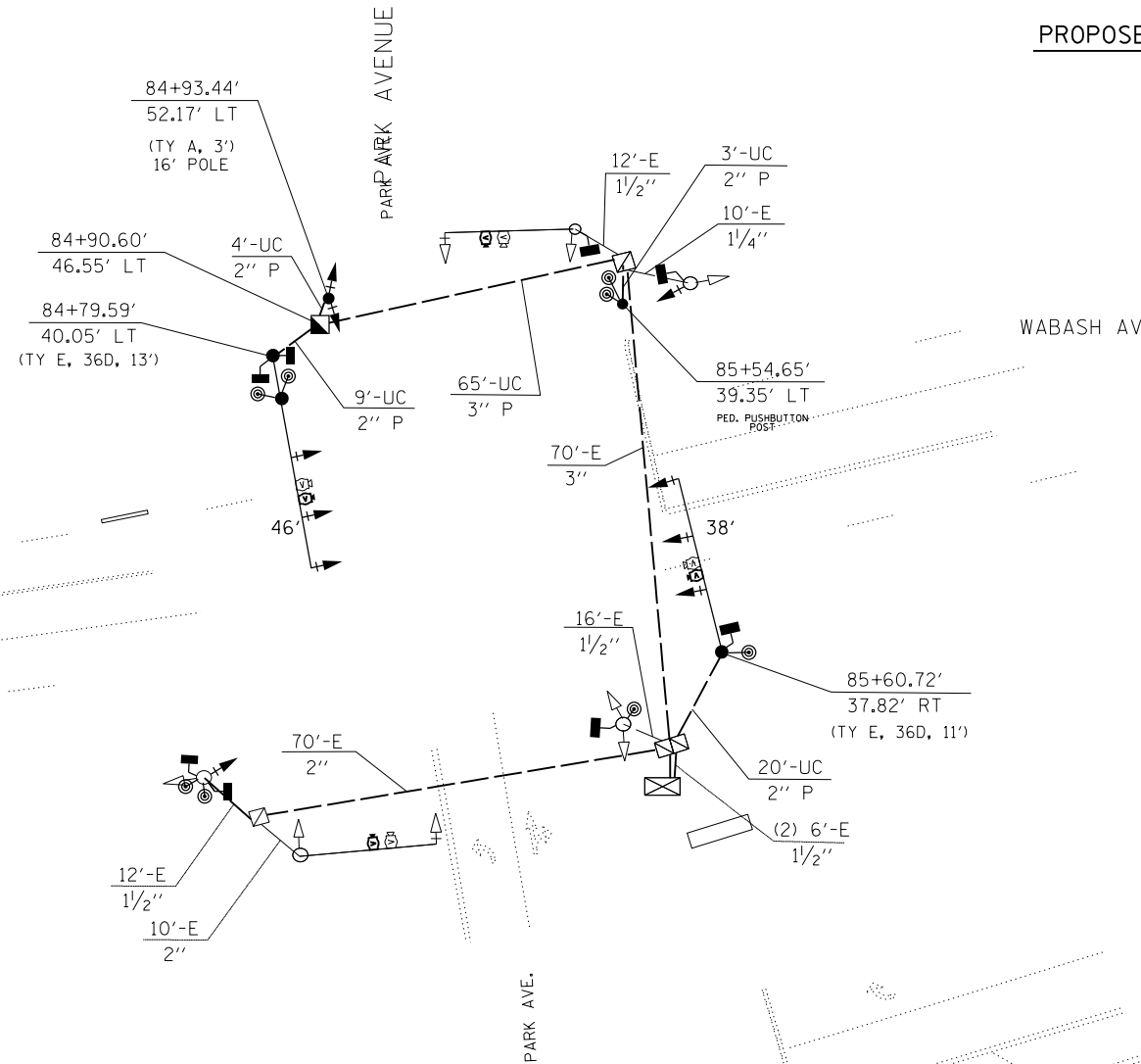

CONTINUE

88200510	TRAFFIC SIGNAL BACKPLATE, RETROREFLECTIVE	EACH	10
88800100	PEDESTRIAN PUSH-BUTTON	EACH	8
89000100	TEMPORARY TRAFFIC SIGNAL INSTALLATION	EACH	1
89501250	RELOCATE EXISTING TRAFFIC SIGNAL EQUIPMENT	EACH	4
89502200	MODIFY EXISTING CONTROLLER	EACH	1
89502210	MODIFY EXISTING CONTROLLER CABINET	EACH	1
89502300	REMOVE ELECTRIC CABLE FROM CONDUIT	FOOT	1135
89502350	REMOVE AND REINSTALL ELECTRIC CABLE FROM CONDUIT	FOOT	355
89502375	REMOVE EXISTING TRAFFIC SIGNAL EQUIPMENT	EACH	29
89502380	REMOVE EXISTING HANDHOLE	EACH	1
89502385	REMOVE EXISTING CONCRETE FOUNDATION	EACH	3
Z0010688	CAMERA MOUNTING ASSEMBLY	EACH	4
Z0033072	VIDEO VEHICLE DETECTION SYSTEM	EACH	1

FILE NAME =	USER NAME = sparksgw	DESIGNED - DMS	REVISED -
ci:\pw\work\p\dot\sparksgw\10296742\06729-sht-trefsignal.dgn		DRAWN - DMS	REVISED -
Default	PLOT SCALE = 40.0000' / in.	CHECKED -	REVISED -
	PLOT DATE = Nov-08-2013 12:09:27PM	DATE -	REVISED -

STATE OF ILLINOIS
DEPARTMENT OF TRANSPORTATION

PROPOSED TRAFFIC SIGNAL PLAN SHEET
WABASH AVE. & PARK AVE.

SCALE: SHEET OF SHEETS STA. TO STA.

F.A.P. RTE.	SECTION	COUNTY	TOTAL SHEETS	SHEET NO.
664	.	SANGAMON	126	96
ILLINOIS FED. AID PROJECT			CONTRACT NO. 72F29	