

STAGE CONSTRUCTION PLAN:

PRE STAGE I - REMOVE EXISTING HMA SHOULDERS AND PLACE COMB. CONC. CURB AND GUTTER, AND PCC BASE COURSE WIDENING

STAGE I - REPLACE NORTH HALF OF EXPANSION JOINT, MILL WB LANE, PLACE WATERPROOFING MEMBRANE ON DECK, AND RESURFACE WB LANE

STAGE II - REPLACE SOUTH HALF OF EXPANSION JOINT, MILL EB LANE, PLACE WATERPROOFING MEMBRANE ON DECK, AND RESURFACE EB LANE

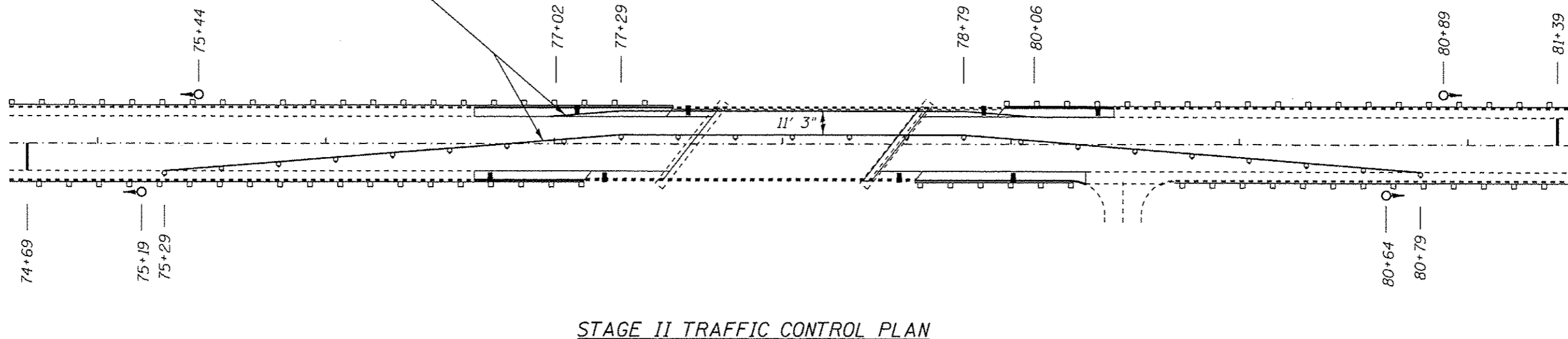
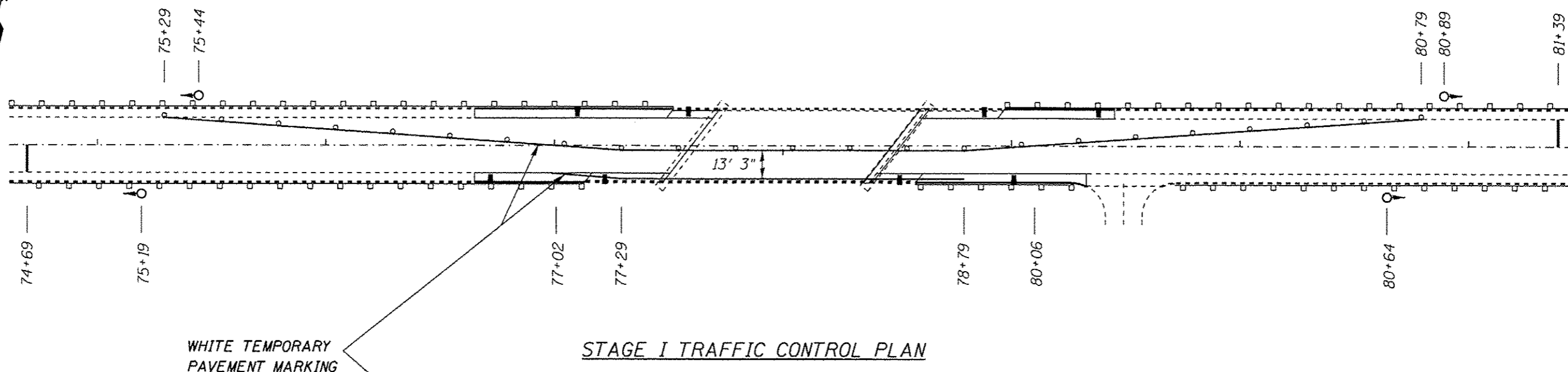

WHITE TEMPORARY
PAVEMENT MARKING

STAGE I TRAFFIC CONTROL PLAN

STAGE II TRAFFIC CONTROL PLAN

NOTES:

TRAFFIC CONTROL SHALL FOLLOW STANDARD 701316 EXCEPT AS OUTLINED ON THIS SHEET. ALL MATERIAL AND WORK DETAILED ON THIS SHEET SHALL BE CONSIDERED INCIDENTAL TO THE STANDARD AND SHALL NOT BE MEASURED FOR PAYMENT SEPARATELY.

THE CONTRACTOR SHALL USE STEEL PLATES TO COVER ALL OPEN AREAS OF JOINT REMOVAL OVERNIGHT. THE COST OF FURNISHING PLATES AND ALL WORK INVOLVED WITH MOVING, SETTING, AND RESETTING THEM SHALL BE INCLUDED IN THE BID PRICE FOR TRAFFIC CONTROL AND PROTECTION STANDARD 701316.

SYMBOLS SHOWN ON THIS SHEET CORRESPOND WITH THE LEGEND SHOWN IN STANDARD 701316.

TRAFFIC STAGING DETAIL
FAP 612 (IL 103)
SECTION (101) I-2
SCHUYLER COUNTY