

STATE OF ILLINOIS  
DEPARTMENT OF TRANSPORTATION  
DIVISION OF HIGHWAYS

**PROPOSED  
HIGHWAY PLANS**

S.B.I. ROUTE 11 (OLD US 40)  
SECTION D7 HMA RESURF 2014-4

RESURFACE  
CLARK COUNTY  
C-97-086-13

FOR INDEX OF SHEETS, SEE SHEET NO. 2

ADT = 1,250

| S.B.I. RTE. | SECTION              | COUNTY   | TOTAL SHEETS       | SHEET NO. |
|-------------|----------------------|----------|--------------------|-----------|
| 11          | D7 HMA RESURF 2014-4 | CLARK    | 13                 | 1         |
|             |                      | ILLINOIS | CONTRACT NO. 74640 |           |

D-97-040-13

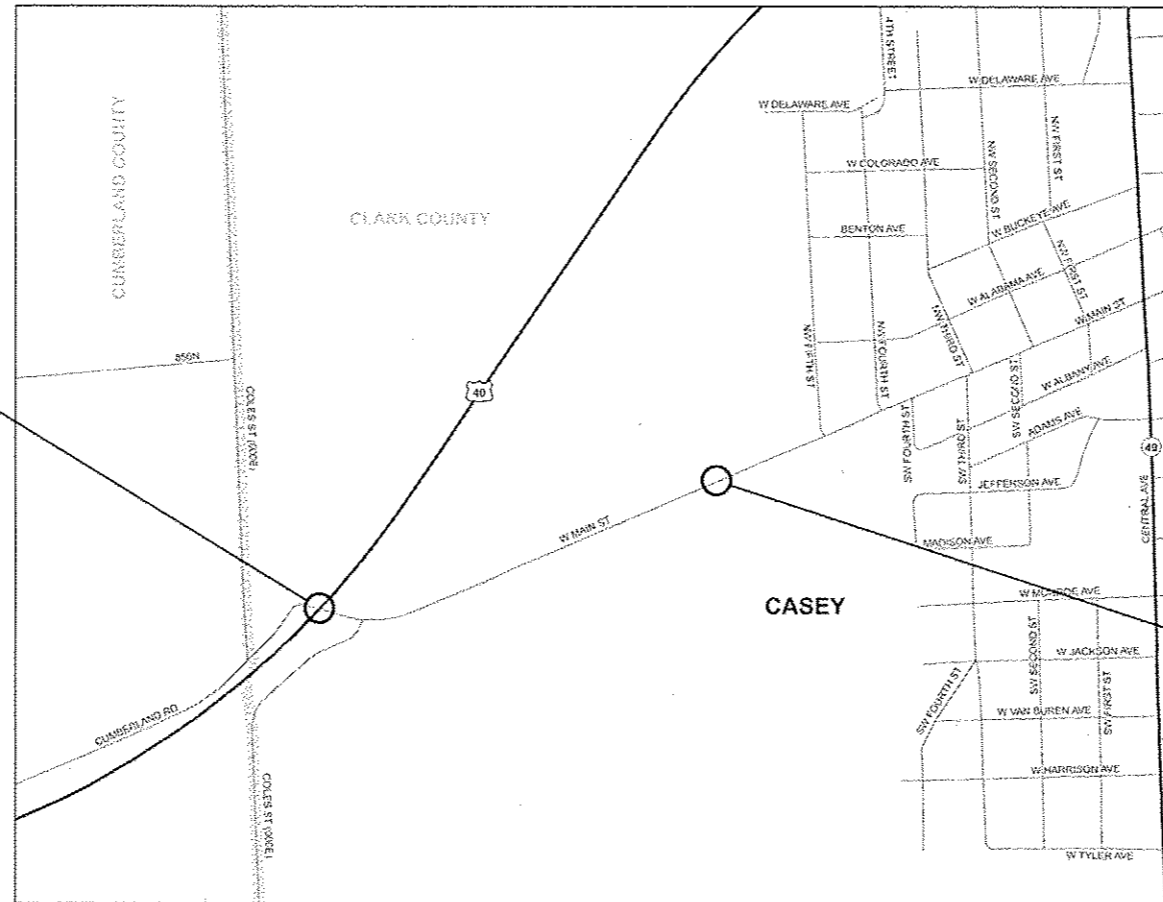
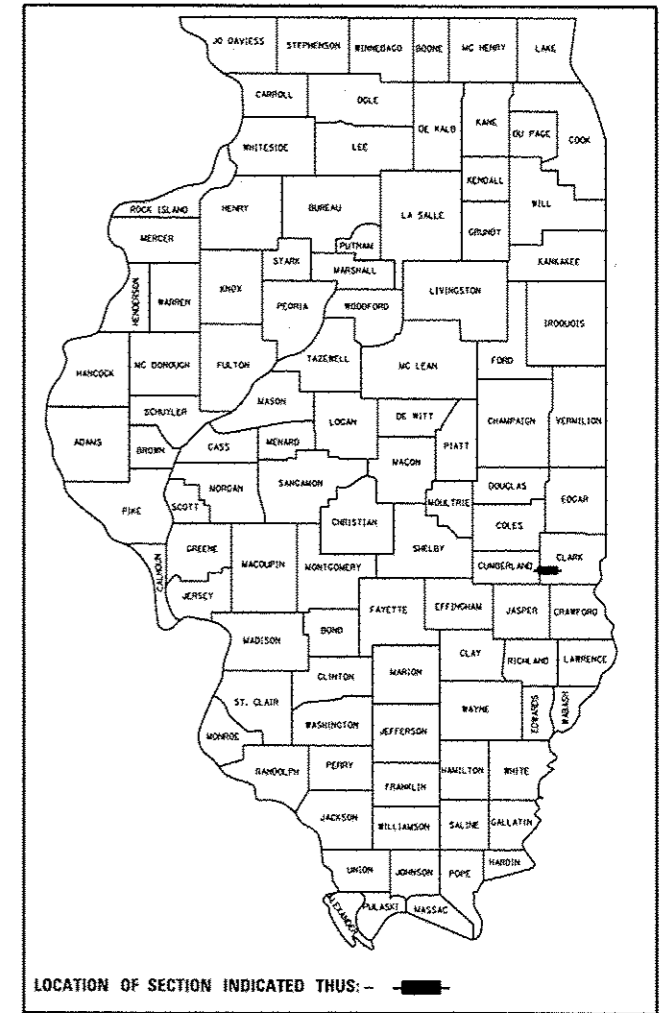

PROJECT ENDS:  
STA. 415 + 83

PROJECT BEGINS:  
STA. 395 + 16

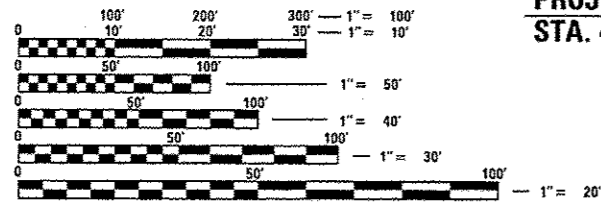

FULL SIZE PLANS HAVE BEEN PREPARED USING STANDARD ENGINEERING SCALES. REDUCED SIZED PLANS WILL NOT CONFORM TO STANDARD SCALES. IN MAKING MEASUREMENTS ON REDUCED PLANS, THE ABOVE SCALES MAY BE USED.

J.U.L.I.E.  
JOINT UTILITY LOCATION INFORMATION FOR EXCAVATION  
1-800-892-0123  
OR 811

PROJECT ENGINEER: TOM RONAN  
PROJECT MANAGER: TOM RONAN  
PHONE: (217)-342-8314  
CONTRACT NO. 74640

GROSS LENGTH = 2067 FT. = 0.39 MILE  
NET LENGTH = 2067 FT. = 0.39 MILE

STATE OF ILLINOIS  
DEPARTMENT OF TRANSPORTATION  
DIVISION OF HIGHWAYS

SUBMITTED SEPT 26 20 13  
Roger L. Drishell, P.E.  
DEPUTY DIRECTOR OF HIGHWAYS, REGION ENGINEER

Dec 6 20 13  
John D. Baranzelli, P.E.  
ENGINEER OF DESIGN AND ENVIRONMENT

Dec 6 20 13  
Omer Osman, P.E.  
DIRECTOR OF HIGHWAYS, CHIEF ENGINEER

PRINTED BY THE AUTHORITY  
OF THE STATE OF ILLINOIS