

STATE OF ILLINOIS
DEPARTMENT OF TRANSPORTATION
DIVISION OF HIGHWAYS

**PROPOSED
HIGHWAY PLANS**

FAP 42 (IL 127)
SECTION 102-1RS-3, 102-TS
PROJECT ACF-0042 (107)
RESURFACING & TRAFFIC SIGNALS
WASHINGTON COUNTY

C-98-031-13

F.A.P. RTE.	SECTION	COUNTY	TOTAL SHEETS	SHEET NO.
42	102-1RS-3, 102-TS	WASHINGTON	* 46	1

ILLINOIS CONTRACT NO. 76F47

* 46 + 1 = 47

D-98-036-12

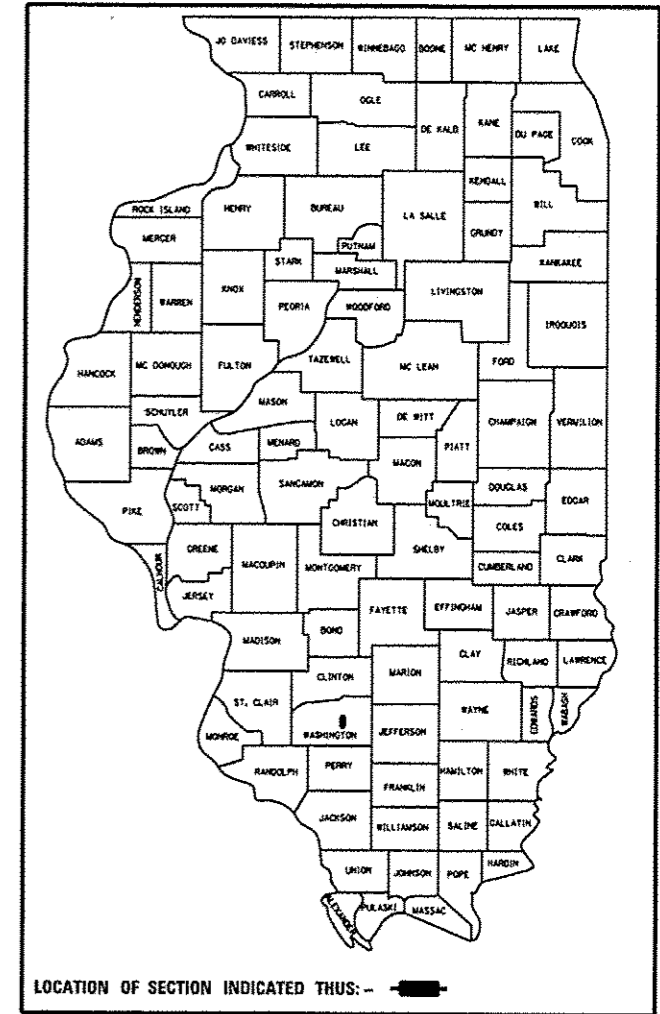

LOCATION OF SECTION INDICATED THUS:

FOR INDEX OF SHEETS, SEE SHEET NO. 2

IL 127 (HOLZHAUER ST. TO IL 15)

ADT = 8900 (2012) (ACTUAL)
ADT = 9150 (2015) (ESTIMATED)
ADT = 11150 (2035) (ESTIMATED)
SU = 2.2%
MU = 3.9%

IL 127 (IL 15 TO MOCKINGBIRD DR.)

ADT = 8900 (2012) (ACTUAL)
ADT = 9150 (2015) (ESTIMATED)
ADT = 11150 (2035) (ESTIMATED)
SU = 3.1%
MU = 4.2%

IL 127 (MOCKINGBIRD TO STA. 1523+39.18)

ADT = 8900 (2012) (ACTUAL)
ADT = 9150 (2015) (ESTIMATED)
ADT = 11150 (2035) (ESTIMATED)
SU = 3.4%
MU = 8.4%

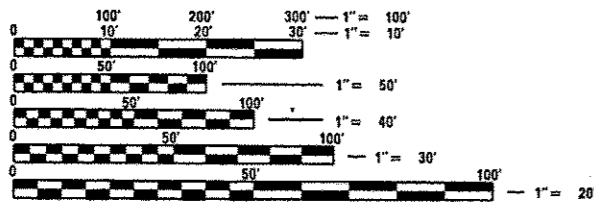

FULL SIZE PLANS HAVE BEEN PREPARED USING STANDARD ENGINEERING SCALES. REDUCED SIZED PLANS WILL NOT CONFORM TO STANDARD SCALES. IN MAKING MEASUREMENTS ON REDUCED PLANS, THE ABOVE SCALES MAY BE USED.

J.U.L.I.E.
JOINT UTILITY LOCATION INFORMATION FOR EXCAVATION
1-800-892-0123
OR 811

PROJECT ENGINEER: PATTI LEBEAU (618) 346-3179
PROJECT MANAGER: REBECCA THARP (618) 346-3323

CONTRACT NO. 76F47

END PROJECT
STA. 1523 + 40
LAT: + 38.38221
LONG: -89.37100

STA. EQUATION
1400 + 66.93 BK =
1408 + 51.90 AH

BEGIN PROJECT
STA. 927 + 60.00
LAT: + 38.33251
LONG: -89.38094

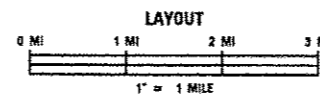
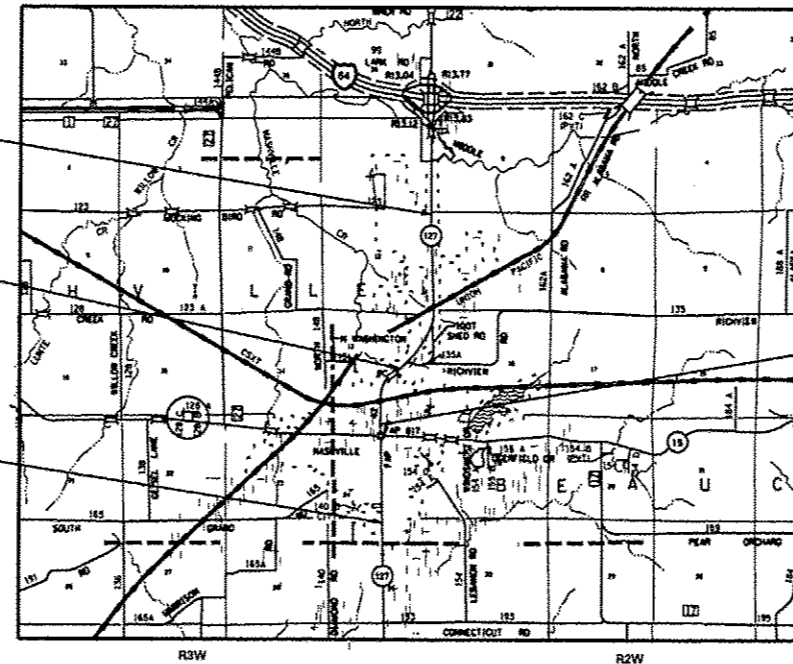

GROSS LENGTH = 19,087 FT. = 3.615 MILE

NET LENGTH = 19,087 FT. = 3.615 MILE

DESIGN DESIGNATION
IVA

12-23-13

STATE OF ILLINOIS
DEPARTMENT OF TRANSPORTATION
DIVISION OF HIGHWAYS

SUBMITTED October 17, 2013
John D. Baranzelli, P.E.
DEPUTY DIRECTOR OF HIGHWAYS, REGION 5 ENGINEER

Dec 6, 2013
John D. Baranzelli, P.E.
acting ENGINEER OF DESIGN AND ENVIRONMENT

Dec 6, 2013
Omer Osman, P.E.
DIRECTOR OF HIGHWAYS, CHIEF ENGINEER

PRINTED BY THE AUTHORITY
OF THE STATE OF ILLINOIS