

F.A.U. RTE. 8885 & 8884A	SECTION 12-00007-00-SP	COUNTY MADISON	TOTAL SHEETS 14	SHEET NO. 1
FEDERAL AID PROJECT ILLINOIS		CONTRACT NO. 97542		

1-17-14 LETTING ITEM 133
INDEX OF SHEETS

SHEET NO.	ITEM
1	COVER SHEET
2	GENERAL NOTES & UTILITIES
3-4	SUMMARY OF QUANTITIES
5	TYPICAL SECTIONS
6	SCHEDULE OF QUANTITIES
7	PLAN SHEET
8	TRAFFIC CONTROL PLAN
9	EROSION CONTROL PLAN
10	INTERSECTION DETAILS
11	PAVEMENT JOINT LAYOUT
12	PAVEMENT MARKING & SIGN DETAILS
13	CONSTRUCTION DETAILS
14	CROSS SECTIONS

HIGHWAY STANDARDS

000001-06	STANDARD SYMBOLS, ABBREVIATIONS AND PATTERNS
280001-07	TEMPORARY EROSION CONTROL SYSTEMS
420001-07	PAVEMENT JOINTS
420101-04	24' JOINTED PCC PAVEMENT
420701-02	PAVEMENT FABRIC
482006-03	HMA SHOULDER ADJACENT TO RIGID PAVEMENT
542301-03	PRECAST REINFORCED CONCRETE FLARED END SECTION
602701-02	MANHOLE STEPS
630001-10	STEEL PLATE BEAM GUARDRAIL
701101-04	OFF-RD OPERATIONS, MULTILANE, 15' TO 24" FROM PAVEMENT EDGE
701106-02	OFF-RD OPERATIONS, MULTILANE, MORE THAN 15' AWAY
701421-06	LANE CLOSURE, MULTILANE, DAY OPERATIONS ONLY, FOR SPEEDS ≥ 45 MPH TO 55 MPH
701422-06	LANE CLOSURE, MULTILANE, FOR SPEEDS ≥ 45 MPH TO 55 MPH
701901-03	TRAFFIC CONTROL DEVICES
720001-01	SIGN PANEL MOUNTING DETAILS
720006-04	SIGN PANEL ERECTION DETAILS
720011-01	METAL POSTS FOR SIGNS, MARKERS & DELINEATORS
729001-01	APPLICATIONS OF TYPES A & B METAL POSTS
780001-04	TYPICAL PAVEMENT MARKINGS

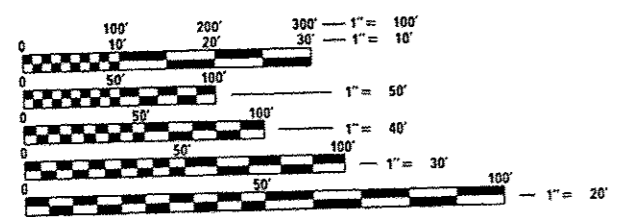

FULL SIZE PLANS HAVE BEEN PREPARED USING STANDARD ENGINEERING SCALES. REDUCED SIZED PLANS WILL NOT CONFORM TO STANDARD SCALES. IN MAKING MEASUREMENTS ON REDUCED PLANS, THE ABOVE SCALES MAY BE USED.

J.U.L.I.E.
JOINT UTILITY LOCATION INFORMATION FOR EXCAVATION
1-800-892-0123
OR 811

ADT:
SOUTH UNIVERSITY DR = 6950
STADIUM DRIVE = 3400

CONTRACT NO. 97542

STATE OF ILLINOIS
DEPARTMENT OF TRANSPORTATION
PLANS FOR PROPOSED

**SOUTHERN ILLINOIS UNIVERSITY EDWARDSVILLE
STADIUM DRIVE AND SOUTH UNIVERSITY DRIVE
MEDIAN CROSSOVER RECONSTRUCTION
FAU ROUTE 8885 (SOUTH UNIVERSITY DRIVE)
FAU ROUTE 8884A (STADIUM DRIVE)
SECTION 12-00007-00-SP
MADISON COUNTY
PROJECT HSIP-5011 (396)
JOB NO. C-98-303-13**

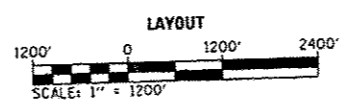
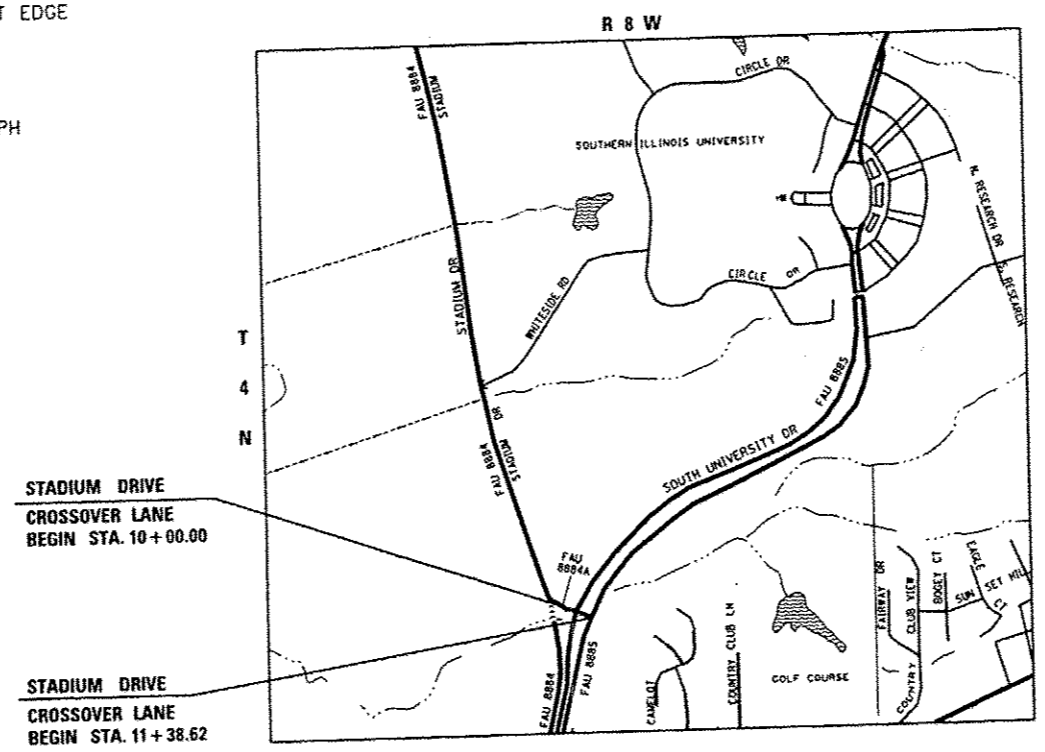
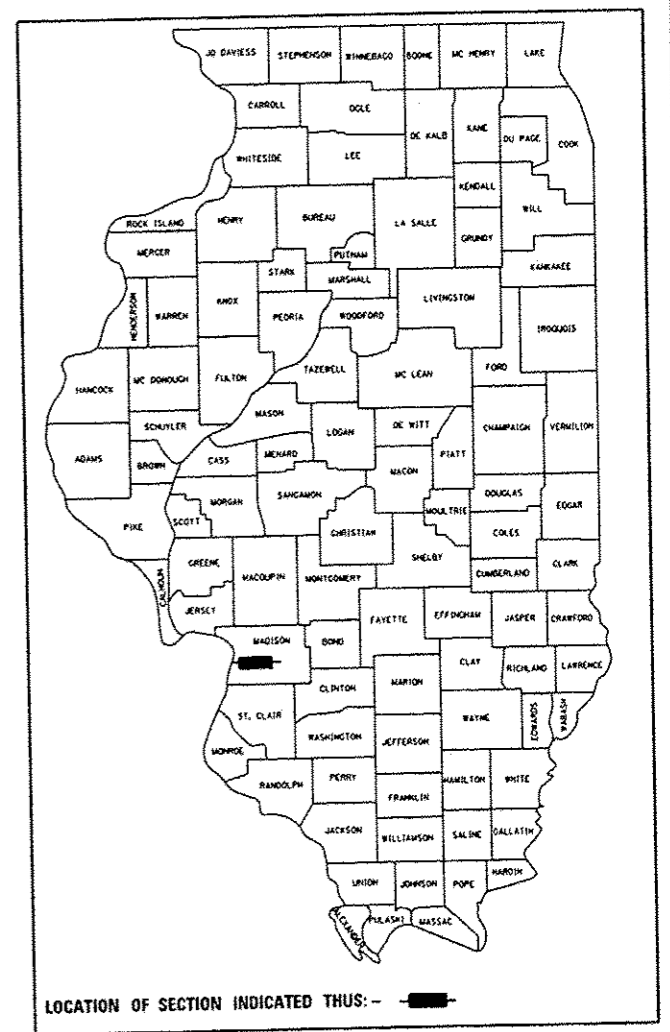

DESIGN DESIGNATION
MINOR ARTERIAL (SOUTH UNIVERSITY DRIVE)
URBAN COLLECTOR (STADIUM DRIVE)

GROSS LENGTH = 138.6 FT. = 0.026 MILE
NET LENGTH = 138.6 FT. = 0.026 MILE

THOMAS L. CISSELL, P.E.
LICENSED PROFESSIONAL ENGINEER
10/28/13
Date

STATE OF ILLINOIS
DEPARTMENT OF TRANSPORTATION
DIVISION OF HIGHWAYS

APPROVED: *Kenneth Neher* DATE: 10/25/13
KENNETH NEHER, VICE CHANCELLOR OF ADMINISTRATION

PASSED: *John P. Calk* DATE: Oct 31 2013
DISTRICT PROJECT IMPLEMENTATION ENGINEER

RELEASING FOR BID
BASED ON LIMITED
REVIEW: *John P. Keimig* DATE: Oct 31 2013
DEPUTY DIRECTOR OF HIGHWAYS, REGION 5 ENGINEER

OATES ASSOCIATES
Engineering + Architecture
ILLINOIS: Eastport Business Center 1, 100 Lanter Court, Suite 1, Collinsville, IL 62234, tel: 618.345.2200, fax: 618.345.7233
MISSOURI: Laclede Gas Building, 720 Olive, Suite 1680, St. Louis, MO 63101, tel: 314.588.8381, fax: 314.588.9605
www.oatesassociates.com

**PRINTED BY THE AUTHORITY
OF THE STATE OF ILLINOIS**

CODE NO.	ITEM	UNIT	TOTAL QUANTITY
72000100	SIGN PANEL - TYPE 1	SO FT	22
72400310	REMOVE SIGN PANEL - TYPE 1	SO FT	7.6
72400710	RELOCATE SIGN PANEL - TYPE 1	SO FT	21.6
72900200	METAL POST - TYPE B	FOOT	23
73000100	WOOD SIGN SUPPORT	FOOT	30
* 78008200	POLYUREA PAVEMENT MARKING TYPE I - LETTERS AND SYMBOLS	SO FT	72.8
* 78008210	POLYUREA PAVEMENT MARKING TYPE I - LINE 4"	FOOT	894
* 78008270	POLYUREA PAVEMENT MARKING TYPE I - LINE 24"	FOOT	27
78300100	PAVEMENT MARKING REMOVAL	SO FT	124
Z0013798	CONSTRUCTION LAYOUT	L SUM	1
S X0327008	REMOVE AND RELOCATE SIGN (SPECIAL)	EACH	2
S X6026800	INLETS TO BE RECONSTRUCTED (SPECIAL)	EACH	1
S X7010216	TRAFFIC CONTROL AND PROTECTION, (SPECIAL)	L SUM	1
* S XX008728	SOLAR POWERED LED FLASHING WARNING SIGN	EACH	2

S - SEE PROJECT SPECIFIC SPECIAL PROVISION
 * - SPECIALTY ITEM

FILE NAME * D011028.033-shi-500.dgn	USER NAME * andy.mueller	DESIGNED -	REVISED -	STATE OF ILLINOIS DEPARTMENT OF TRANSPORTATION	SUMMARY OF QUANTITIES				F.A.U. RTE. 8885 & 8884A	SECTION 12-00007-00-SP	COUNTY MADISON	TOTAL SHEETS 14	SHEET NO. 4
Default	PLOT SCALE * 20.0000' / 1" =	DRAWN -	REVISED -		SCALE: N.T.S.	SHEET 2	OF 2	SHEETS	STA.	TO STA.	ILLINOIS FED. AID PROJECT		
	PLOT DATE * 10/4/2013	CHECKED -	REVISED -										
		DATE -	REVISED -										

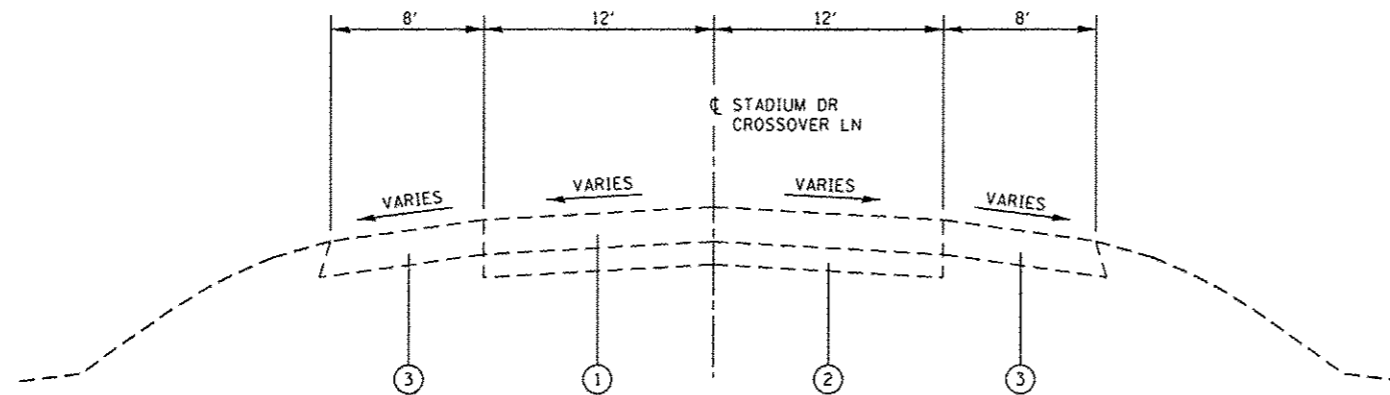

**EXISTING TYPICAL SECTION
STADIUM DRIVE MEDIAN CROSSOVER**

STA. 10+00.00 TO STA. 11+38.62
(NOT TO SCALE)

- TYPICAL SECTION LEGEND**
- ① EXISTING PORTLAND CEMENT CONCRETE PAVEMENT, 8"
 - ② EXISTING AGGREGATE BASE COURSE, 6"
 - ③ EXISTING HOT-MIX ASPHALT SHOULDER
 - ④ PROPOSED PORTLAND CEMENT CONCRETE PAVEMENT, 8"
 - a. SEE HIGHWAY STANDARD 420101 FOR: -PAVEMENT JOINT LAYOUT
 - b. SEE HIGHWAY STANDARD 420001 FOR: -LONGITUDINAL JOINT DETAIL -TRANSVERSE JOINT DETAIL
 - c. SEE HIGHWAY STANDARD 420701 FOR: -TYPE A PAVEMENT FABRIC LAYOUT
 - d. PORTLAND CEMENT CONCRETE PAVEMENT SHALL HAVE A TYPE B FINISH
 - e. EXISTING PAVEMENT SHALL BE TIED INTO PROPOSED PCC PAVEMENT USING 30" LONG #6 EPOXY COATED TIE BARS, SPACED 30" ON CENTER
 - ⑤ PROPOSED SUBBASE GRANULAR MATERIAL, TYPE A 12"
 - ⑥ PROPOSED HOT-MIX ASPHALT SHOULDERS, 8"
 - ⑦ PROPOSED AGGREGATE SHOULDER, TYPE B
 - ⑧ PROPOSED COMPOST FURNISH AND PLACE, 2"
 - ⑨ EARTH EXCAVATION
 - ⑩ EMBANKMENT

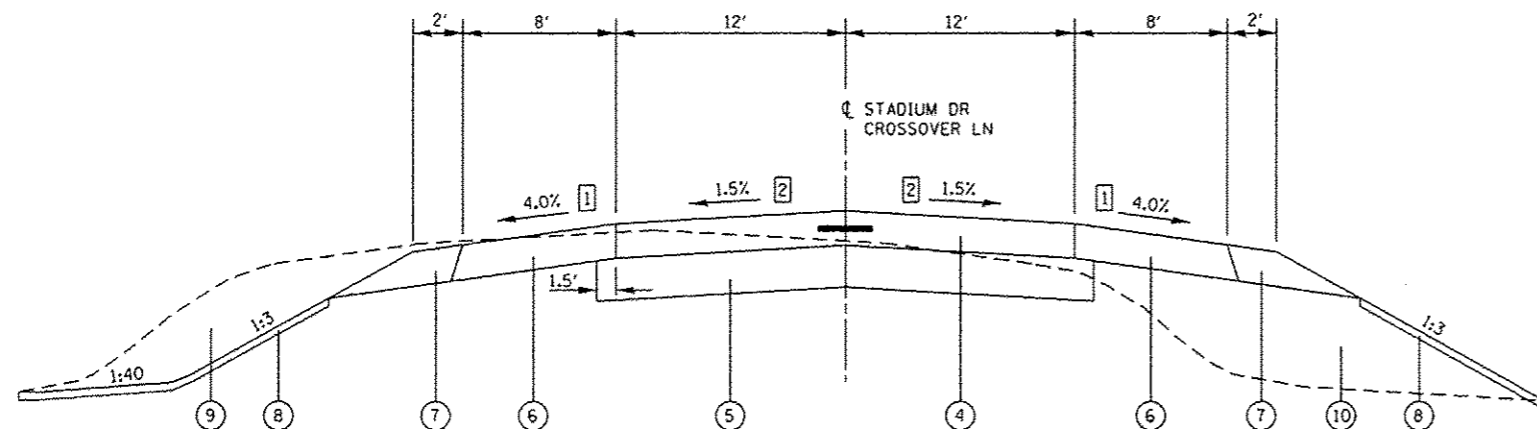

**PROPOSED TYPICAL SECTION
STADIUM DRIVE MEDIAN CROSSOVER**

STA. 10+00.00 TO STA. 11+38.62
(NOT TO SCALE)

TYPICAL SECTION NOTES

- ① TRANSITION SHOULDER SLOPE TO MATCH EXISTING SHOULDER ALONG SOUTH UNIVERSITY DRIVE OVER 20'.
- ② VARIES 1.7% TO -1.7%. SEE INTERSECTION DETAIL SHEET FOR CROSS-SLOPES.

HOT-MIX ASPHALT MIXTURE REQUIREMENTS TABLE

MIXTURE USE(S):	SHOULDERS
AC/PG:	PG 64-22
RAP% (MAX)	30%
DESIGN AIR VOIDS:	2% @ NDES = 30

STRUCTURAL DESIGN DATA

STADIUM DRIVE RIGID PAVEMENT DESIGN FOR CLASS II ROADWAY		
STRUCTURAL DESIGN TRAFFIC:	YEAR 2023	
PV = 2898	SU = 158	MU = 95
PERCENT OF STRUCTURAL DESIGN TRAFFIC IN DESIGN LANE:		
P = 50%	S = 50%	M = 50%
TRAFFIC FACTOR:	0.76	
SUBGRADE SUPPORT RATING	IBR = 80	
USE:	8" PCC PAVEMENT (REINFORCED) 12" GRANULAR SUBBASE	

EARTHWORK SCHEDULE

STATION	STATION	EARTH EXCAVATION	EARTH EXCAVATION ADJUSTED FOR SHRINKAGE (NOTE 1)	EMBANKMENT (NOTE 2)	EARTHWORK BALANCE WASTE (+) OR SHORTAGE (-) (NOTE 3)	COMPOST F & P 2
		(CU YD)	(CU YD)	(CU YD)	(CU YD)	(SQ YD)
10+00.00	11+38.62	415	312	175	137	798
TOTAL		415	312	175	137	798

EARTHWORK NOTES:

1. ESTIMATED SHRINKAGE FACTOR = 25%.
2. APPROXIMATE EMBANKMENT QUANTITY IS SHOWN FOR INFORMATION ONLY.
3. APPROXIMATE EARTHWORK BALANCE IS SHOWN FOR INFORMATION ONLY.

PAVEMENT SCHEDULE

STATION	STATION	OFFSET	SUB GRAN MAT A 12 (SQ YD)	PCC PVT 8 (SQ YD)	PAVEMENT REM (SQ YD)	PAVED SHLD REMOVAL (SQ YD)	AGGREGATE SHLDS B (NOTE 1) (TON)	HMA SHOULDER B (SQ YD)
10+00.00	11+38.62	LT	551	502	577	149	29	146
10+00.00	11+38.62	RT				172	22	136
TOTAL			551	502	577	321	51	282

PAVEMENT NOTES:

1. AGGREGATE SHOULDERS TONAGE RATE IS FOR INFORMATION ONLY AND IS CALCULATED USING AN ASSUMED RATE OF 2.1 TON CU YD.

SEEDING SCHEDULE

STATION	STATION	OFFSET	SEEDING CL 1A (ACRE)	NITROGEN FERT NUTR (NOTE 1) (POUND)	PHOSPHORUS FERT NUTR (NOTE 1) (POUND)	POTASSIUM FERT NUTR (NOTE 1) (POUND)	MULCH METHOD 2 (ACRE)	TEMP EROS CONT SEED (NOTE 2) (POUND)
10+00.00	11+38.62	LT	0.15	14.0	14.0	14.0	0.15	30
10+00.00	11+38.62	RT	0.05	5.0	5.0	5.0	0.05	10
TOTAL			0.2	19	19	19	0.2	40

SEEDING NOTES:

1. APPLICATION RATE OF 90 LBS PER ACRE
2. ESTIMATE 2 APPLICATIONS AT A RATE OF 100 LBS PER ACRE

SIGN PANEL AND POST SCHEDULE

STATION	OFFSET	PR MUTCD TYPE	PR SIGN DESCRIPTION	PR SIGN SIZE	SIGN PANEL T1 (SQ FT)	REMOV SIGN PANEL T1 (SQ FT)	RELOC SIGN PANEL T1 (SQ FT)	METAL POST TY B (FOOT)	WOOD SIN SUPPORT (FOOT)	REM/REL SIGN SPECIAL (EACH)	SP LED FL WARN SIGN (EACH)	NOTES
9+65.77	205' LT	W13-1P	ADVISORY SPEED	36"x18"							1	INSTALL NEW SOLAR POWERED LED FLASHING WARNING SIGN
10+19.74	25' LT	W4-4P	CROSS TRAFFIC DOES NOT STOP	36"x18"	4.5	3.8				1		RELOCATE SIGN ASSEMBLY, REMOVE AND REPLACE CROSS TRAFFIC SIGNS
10+25.74	25' RT	W4-4P	CROSS TRAFFIC DOES NOT STOP	36"x18"	4.5					1		RELOCATE SIGN ASSEMBLY, INSTALL NEW CROSS TRAFFIC SIGN
10+26.83	198' LT	W13-1P	ADVISORY SPEED	24"x24"							1	INSTALL NEW SOLAR POWERED LED FLASHING WARNING SIGN
10+94.76	25' RT	W4-4P	CROSS TRAFFIC DOES NOT STOP	36"x18"	4.5	3.8	10.3		16			RELOCATE SIGN PANELS, REMOVE AND REPLACE CROSS TRAFFIC SIGNS, INSTALL NEW METAL POST
10+98.76	25' LT	W4-4P	CROSS TRAFFIC DOES NOT STOP	36"x18"	4.5		6.3		14			RELOCATE SIGN PANEL, INSTALL NEW CROSS TRAFFIC SIGN, INSTALL NEW METAL POST
11+17.50	116' RT	R3-I100	LEFT TURN LANE	36"x18"	4.0			11				INSTALL NEW SIGN PANEL, INSTALL NEW METAL POST
11+73.34	6' RT	---	---	---			5.0	12				RELOCATE SIGN PANEL, INSTALL NEW METAL POST
					22	7.6	21.6	23	30	2	2	

C.P. #1 - N. 769476.19, E. 2342157.09
 IRON BAR WITH CAP STA. 10+20.42, 48.65' LT
 ELEV. 465.08

C.P. #2 - N. 769961.33, E. 2342425.96
 PK NAIL STA. 10+37.86, 603.04' LT
 ELEV. 476.76
 (LOCATED NORTH OF INTERSECTION ALONG
 SOUTHBOUND SOUTH UNIVERSITY DR)

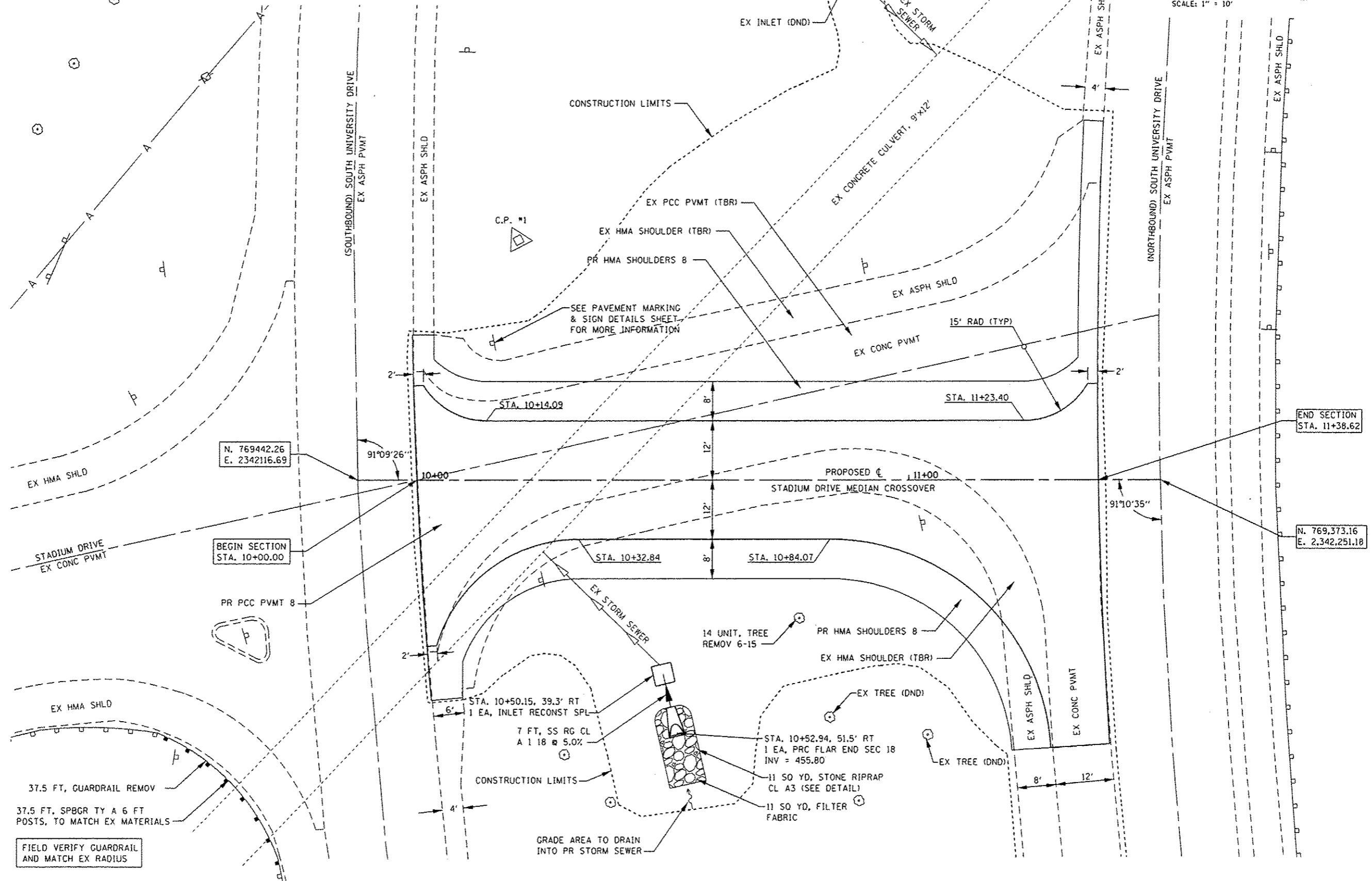
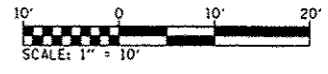

FIELD VERIFY GUARDRAIL
 AND MATCH EX RADIUS

FILE NAME *
 0811028.033-sht-plan.dgn
 0811028-sht-plan1

USER NAME * andy.mueller
 PLOT SCALE = 20.0000 / in.
 PLOT DATE = 10/14/2013

DESIGNED -
 DRAWN -
 CHECKED -
 DATE -

REVISED -
 REVISED -
 REVISED -
 REVISED -

STATE OF ILLINOIS
 DEPARTMENT OF TRANSPORTATION

PLAN SHEET
 SCALE: 1" = 10'
 SHEET 1 OF 1 SHEETS
 STA. 10+00.00 TO STA. 11+38.62

P.A.U. RTE.	SECTION	COUNTY	TOTAL SHEETS	SHEET NO.
8885 & 8884A	12-00007-00-SP	MADISON	14	7
CONTRACT NO. 97542				
ILLINOIS FED. AID PROJECT				

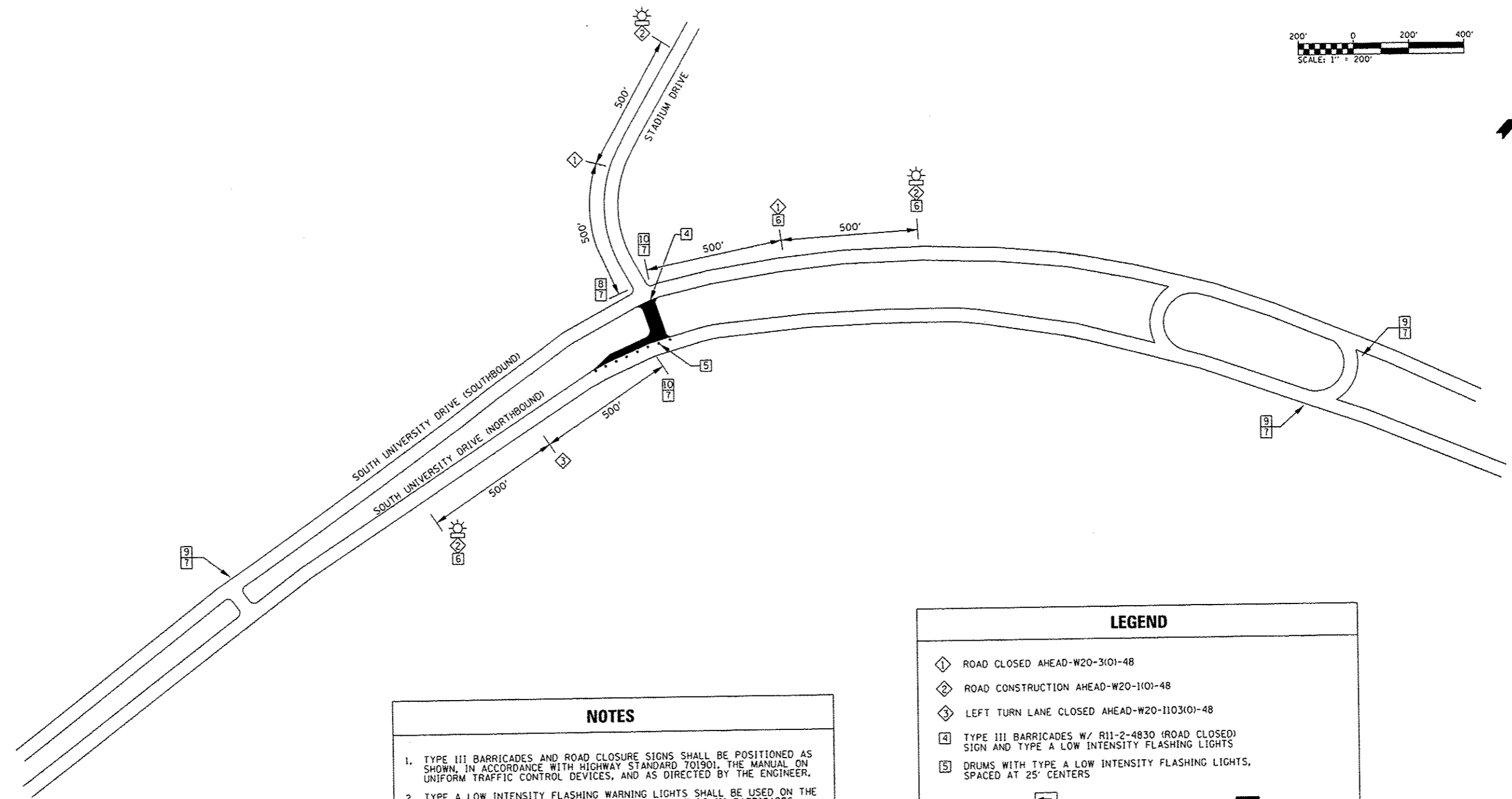
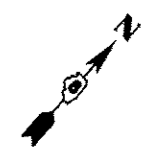
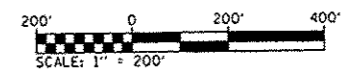

NOTES

1. TYPE III BARRICADES AND ROAD CLOSURE SIGNS SHALL BE POSITIONED AS SHOWN, IN ACCORDANCE WITH HIGHWAY STANDARD 701901, THE MANUAL ON UNIFORM TRAFFIC CONTROL DEVICES, AND AS DIRECTED BY THE ENGINEER.
2. TYPE A LOW INTENSITY FLASHING WARNING LIGHTS SHALL BE USED ON THE FIRST SIGN IN ADVANCE OF THE WORK SITE AND TYPE III BARRICADES DURING HOURS OF DARKNESS.
3. ALL WARNING SIGNS SHALL BE A MINIMUM OF 48" x 48" AND HAVE A BLACK LEGEND AND BORDER ON A FLUORESCENT ORANGE REFLECTORIZED BACKGROUND.
4. EXACT LOCATION OF WARNING SIGNS AND BARRICADES SHALL BE STAKED IN THE FIELD FOR APPROVAL BY THE ENGINEER PRIOR TO INSTALLATION.
5. CONTRACTOR SHALL NOTIFY THE SIUE POLICE, SIUE FACILITIES DEPARTMENT, AND CITY OF EDWARDSVILLE FIRE DEPARTMENT AT LEAST 48 HOURS BEFORE INSTALLING TRAFFIC CONTROL.
6. SEE HIGHWAY STANDARDS 701421 AND 701422 FOR SINGLE LANE, LANE CLOSURES ALONG SOUTH UNIVERSITY DRIVE.
7. SEE HIGHWAY STANDARD 701901 FOR ADDITIONAL TRAFFIC CONTROL GUIDELINES

LEGEND

- ① ROAD CLOSED AHEAD-W20-3(O)-48
- ② ROAD CONSTRUCTION AHEAD-W20-1(O)-48
- ③ LEFT TURN LANE CLOSED AHEAD-W20-1103(O)-48
- ④ TYPE III BARRICADES W/ R11-2-4830 (ROAD CLOSED) SIGN AND TYPE A LOW INTENSITY FLASHING LIGHTS
- ⑤ DRUMS WITH TYPE A LOW INTENSITY FLASHING LIGHTS, SPACED AT 25' CENTERS
- ⑥ 24" x 24" WORK ZONE
- ⑦ 36" x 6" STADIUM DR
- ⑧ DETOUR RIGHT M4-9R(O) 30" x 24"
- ⑨ DETOUR LEFT M4-9L(O) 30" x 24"
- ⑩ DETOUR STRAIGHT M4-9S(O) 30" x 24"
- TYPE A LOW INTENSITY FLASHING LIGHT

48" x 48"
FLUORESCENT
ORANGE

FILE NAME *	USER NAME * andymveller	DESIGNED -	REVISED -	STATE OF ILLINOIS DEPARTMENT OF TRANSPORTATION	TRAFFIC CONTROL PLAN	F.A.U. RTE.	SECTION	COUNTY	TOTAL SHEETS	SHEET NO.	
DB11828.033-shc-staging.dgn		DRAWN -	REVISED -			8885 & 8884A	12-00007-00-SP	MADISON	14	8	
		CHECKED -	REVISED -			CONTRACT NO. 97542					
DB11828-shc-plan1		DATE -	REVISED -			ILLINOIS FED. AID PROJECT					
				SCALE: 1" = 200'		SHEET 1 OF 1 SHEETS		STA. TO STA.			

EROSION CONTROL LEGEND

- LIMITS OF CONSTRUCTION
- ===== PERIMETER EROSION BARRIER
- ⊕ INLET AND PIPE PROTECTION
- ▨ EROSION CONTROL BLANKET
- CONC WASH ••• CONCRETE WASHOUT AREA, INCLUDED IN COST FOR PCC PAVEMENT

NOTES: ALL ITEMS SHALL BE CONSTRUCTED AS SHOWN ON STANDARD 280001, AS SHOWN IN CONSTRUCTION DETAILS, AND AS DIRECTED BY THE ENGINEER.

TEMPORARY EROSION CONTROL SEEDING INCLUDES 2 APPLICATIONS AT 100 LBS PER ACRE

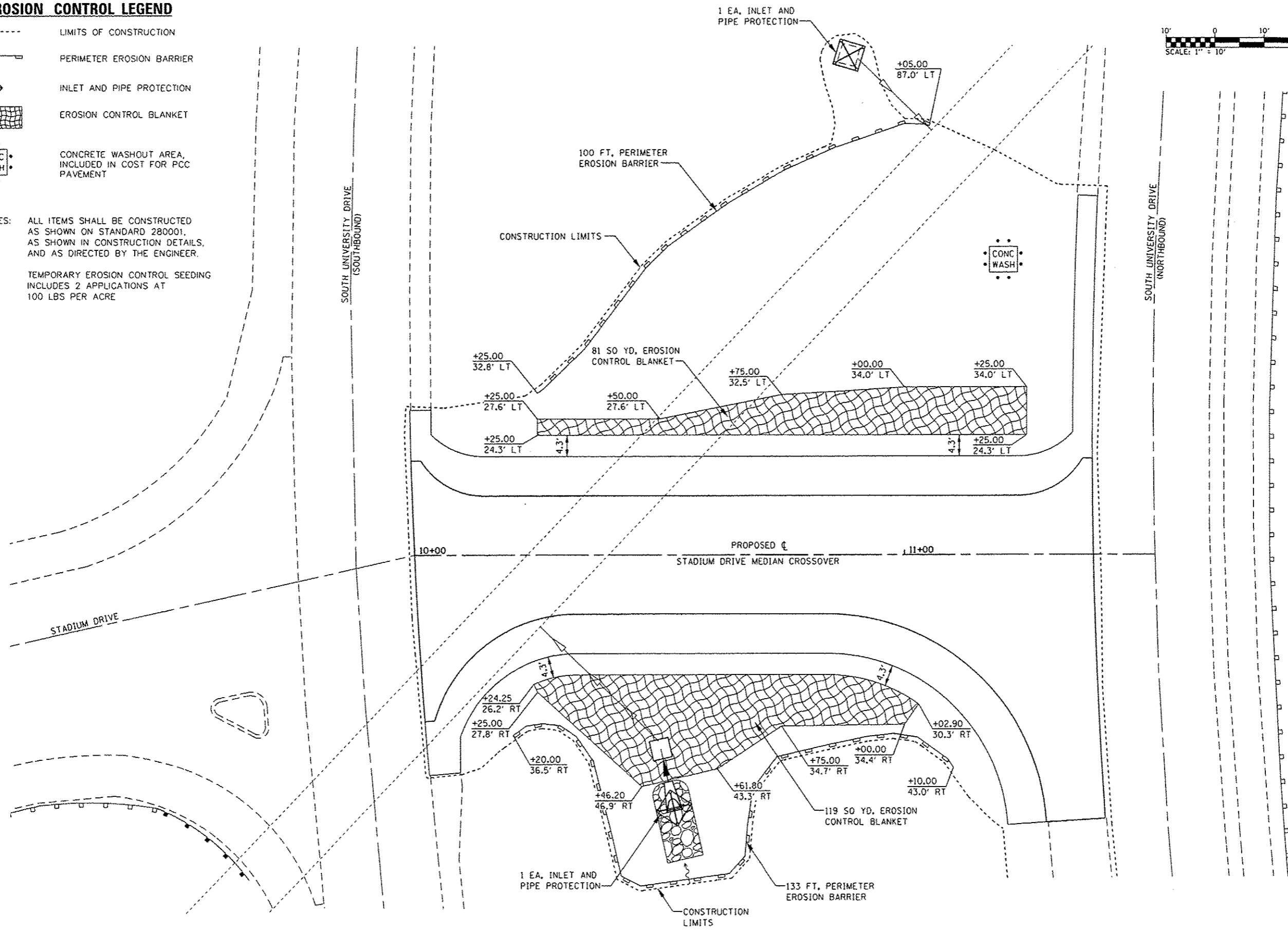
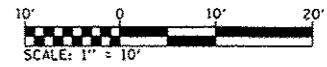

FILE NAME *	USER NAME * andy.mueller
0811028.033-shr-eros.dgn	
0811028-shr-plan1	

DESIGNED -	REVISD -
DRAWN -	REVISD -
CHECKED -	REVISD -
DATE -	REVISD -
PLOT SCALE * 20.0000 / 1 in.	
PLOT DATE * 10/1/2013	

DESIGNED -	REVISD -
DRAWN -	REVISD -
CHECKED -	REVISD -
DATE -	REVISD -

**STATE OF ILLINOIS
DEPARTMENT OF TRANSPORTATION**

EROSION CONTROL PLAN

SCALE: 1" = 10' SHEET 1 OF 1 SHEETS STA. 10+00.00 TO STA. 11+38.62

F.A.U. RITE, INC. 88924	SECTION 12-00007-00-5P	COUNTY MADISON	TOTAL SHEETS 14	SHEET NO. 9
CONTRACT NO. 97542			ILLINOIS FED. AID PROJECT	

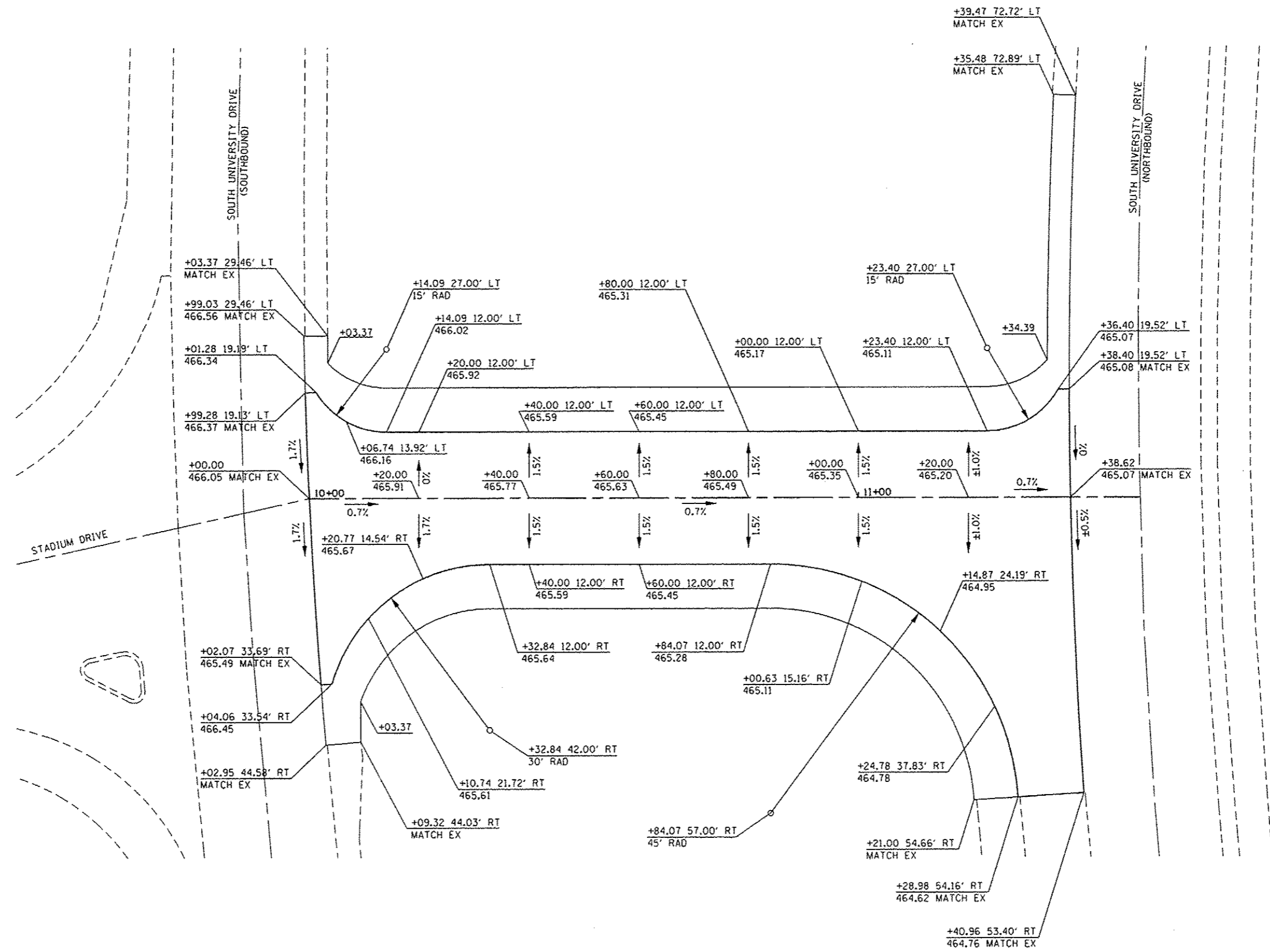
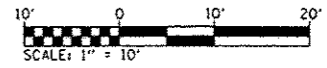

FILE NAME *
 DB11028-shr-intersec.dgn
 DB11028-shr-plant

USER NAME * andymueller
 PLLOT SCALE * 20.0000 / in.
 PLOT DATE * 10/4/2013

DESIGNED -
 DRAWN -
 CHECKED -
 DATE -

REVISED -
 REVISED -
 REVISED -
 REVISED -

**STATE OF ILLINOIS
 DEPARTMENT OF TRANSPORTATION**

INTERSECTION DETAILS

SCALE: 1" = 10' SHEET 1 OF 1 SHEETS STA. 10+00.00 TO STA. 11+38.62

F.A.U. RTE.	SECTION	COUNTY	TOTAL SHEETS	SHEET NO.
888 & 888A	12-00007-00-SP	MADISON	14	10
CONTRACT NO. 97542				
ILLINOIS FED. AID PROJECT				

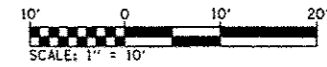

EX PAVEMENT SHALL BE TIED INTO PR PCC PAVEMENT USING 30" LONG #6 EPOXY COATED TIE BARS, SPACED 30" ON CENTER. THIS WORK SHALL BE INCLUDED IN THE COST OF PCC PAVEMENT, 8"

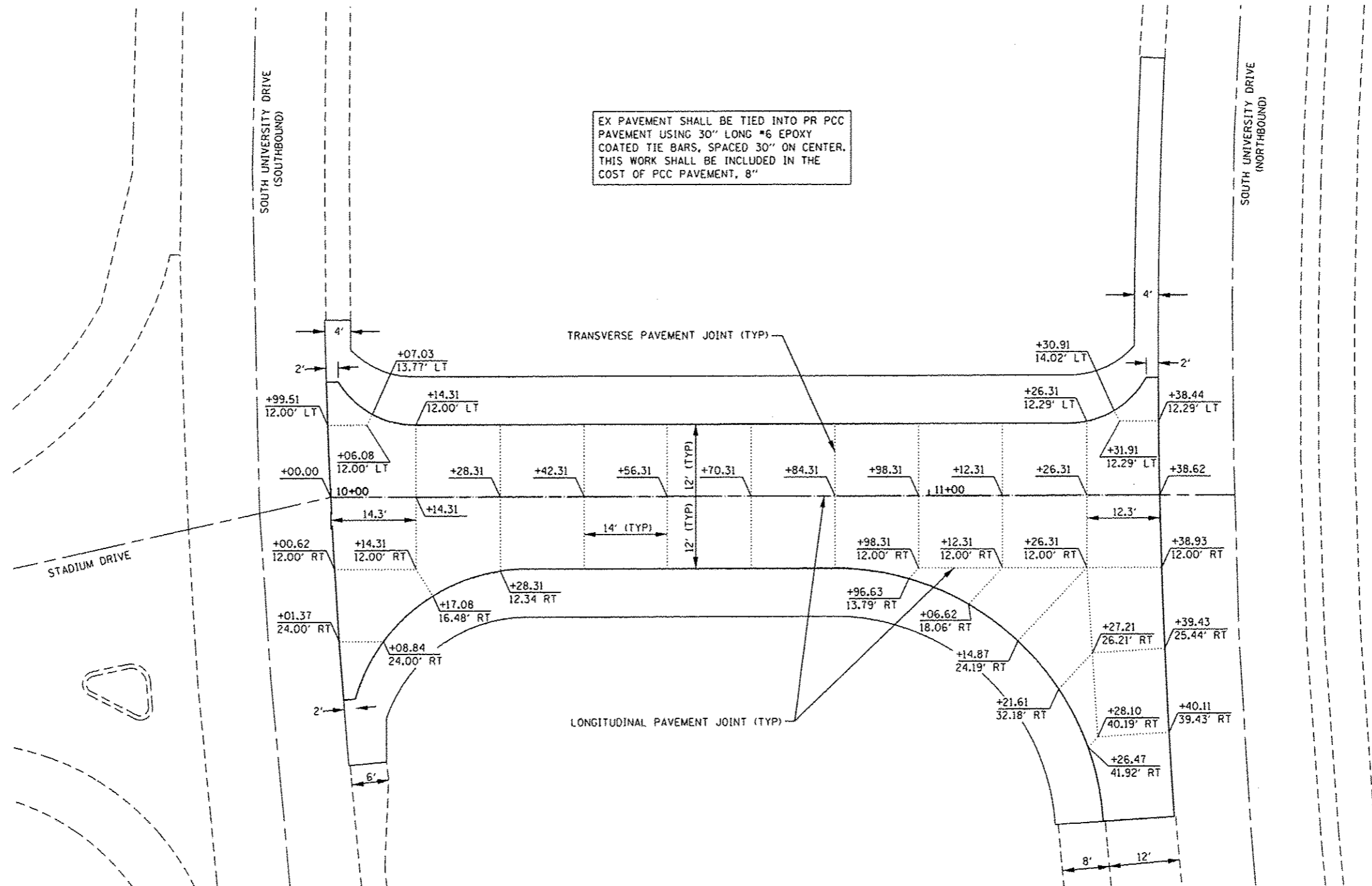

FILE NAME *	USER NAME *	DESIGNED -	REVISED -
0811028-033-shc-joint.dgn	andy.muller	DRAWN -	REVISED -
		CHECKED -	REVISED -
		DATE -	REVISED -
0811028-shc-plan1			

**STATE OF ILLINOIS
DEPARTMENT OF TRANSPORTATION**

PAVEMENT JOINT LAYOUT

SCALE: 1" = 10' SHEET 1 OF 1 SHEETS STA. 10+00.00 TO STA. 11+38.62

F.A.U. RTE. 1885 & 8884A	SECTION 12-00007-00-SP	COUNTY MADISON	TOTAL SHEETS 14	SHEET NO. 11
CONTRACT NO. 97542				
ILLINOIS FED. AID PROJECT				

STADIUM DRIVE MEDIAN CROSSOVER

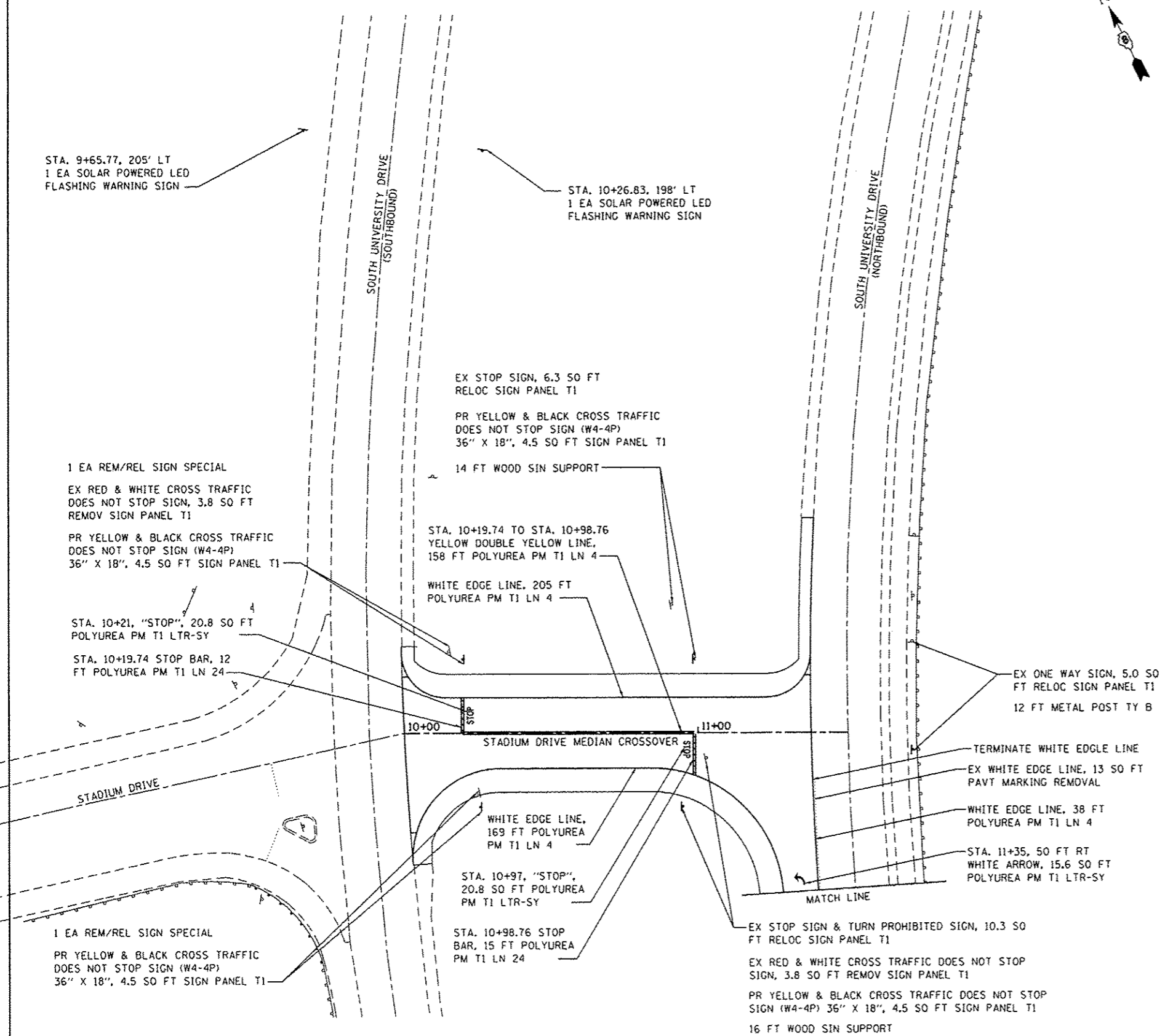
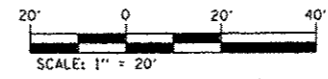

**SOUTH UNIVERSITY DRIVE
(NORTHBOUND) TURN LANE**

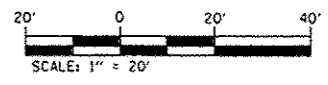
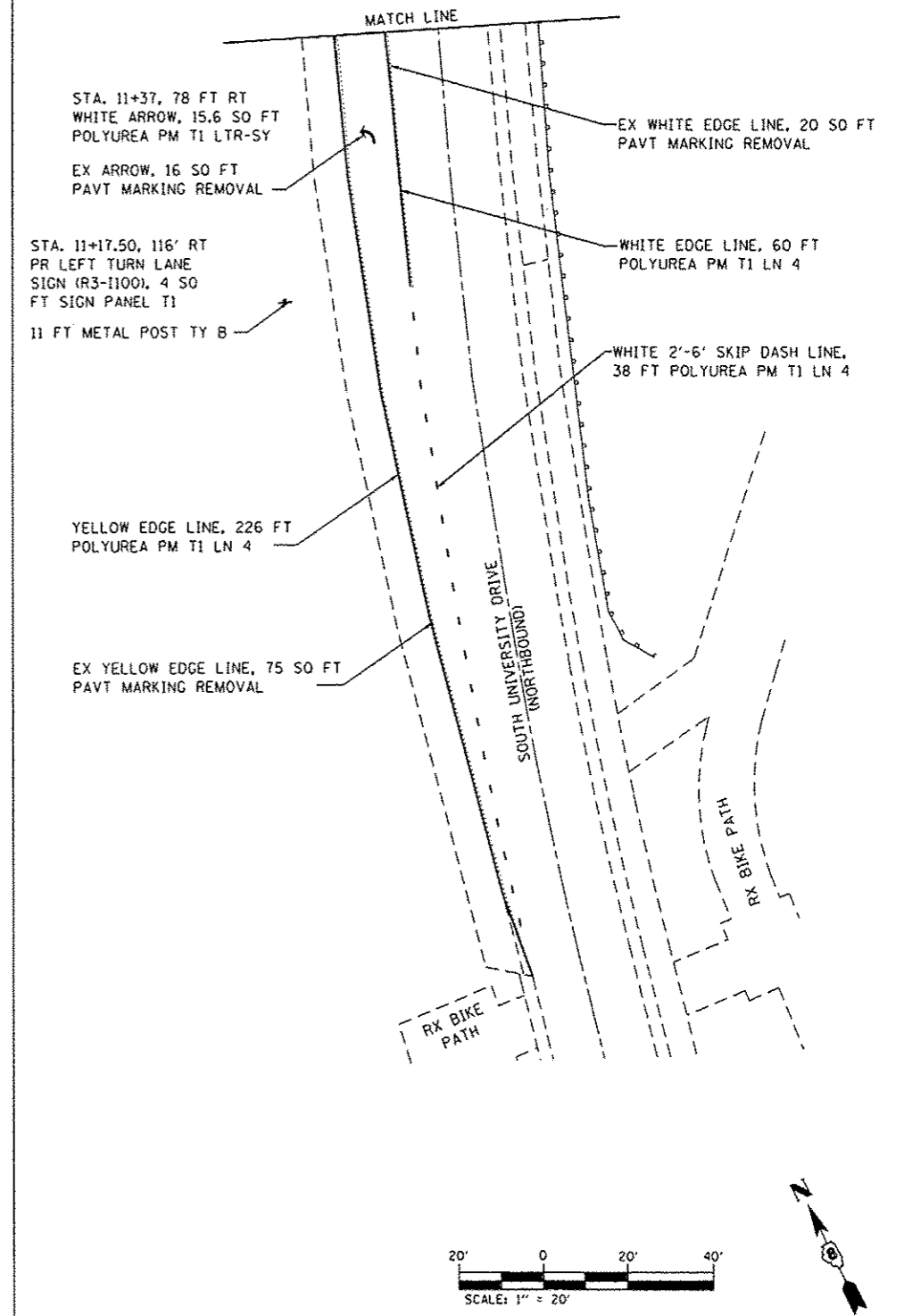

FILE NAME - 0811028-033-shr-pmk.dgn	USER NAME - andymueller	DESIGNED -	REVISED -
		DRAWN -	REVISED -
		CHECKED -	REVISED -
		DATE -	REVISED -
0811028-shr-plan1	PLOT DATE - 10/4/2013		

**STATE OF ILLINOIS
DEPARTMENT OF TRANSPORTATION**

PAVEMENT MARKING & SIGN DETAILS			
SCALE: 1" = 20'	SHEET 1 OF 1 SHEETS	STA. 10+00.00 TO STA. 11+38.62	

F.A.U. RTE. 12-00007-00-SP	SECTION 14	COUNTY MADISON	TOTAL SHEETS 14	SHEET NO. 12
CONTRACT NO. 97542				
ILLINOIS FED. AID PROJECT				

DATE	
BY	
ENR SURVEY	
ADJUSTED	
NOTED	
REVISIONS	
AREAS CHECKED	
NO.	

DATE	
BY	
ENR SURVEY	
ADJUSTED	
NOTED	
REVISIONS	
AREAS CHECKED	
NO.	

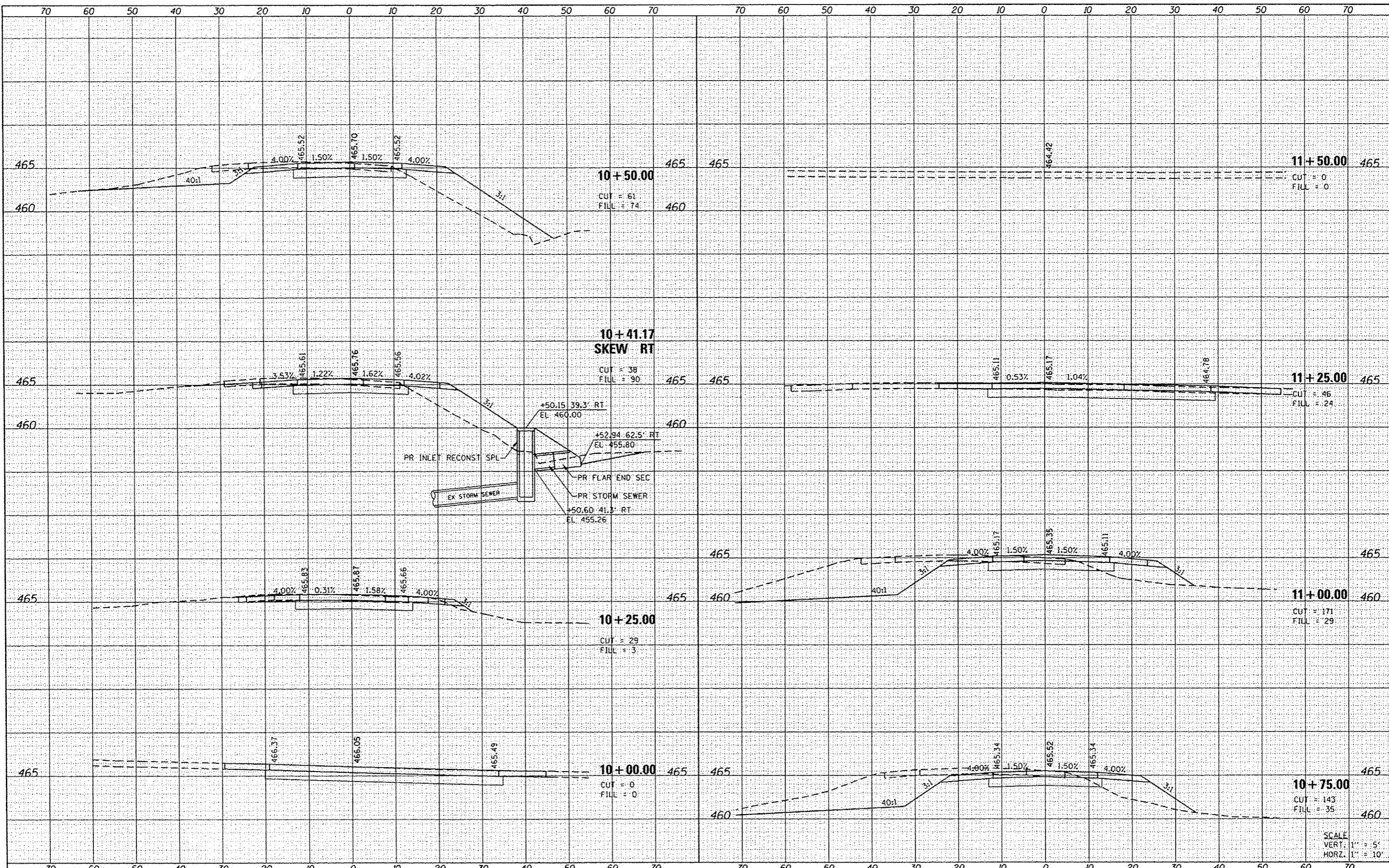

FILE NAME: DB11028.033-shc-wash.dgn
 USER NAME: andy.mueller
 PLOT SCALE: 20.0000' / in.
 PLOT DATE: 10/24/2013

DESIGNED -	REVISD -
DRAWN -	REVISD -
CHECKED -	REVISD -
DATE -	REVISD -

STATE OF ILLINOIS
 DEPARTMENT OF TRANSPORTATION

CROSS SECTIONS
 STADIUM DRIVE MEDIAN CROSSOVER
 SCALE: 1"=10'H 5'V SHEET 1 OF 1 SHEETS STA. 10+00.00 TO STA. 11+50.00

F.A.U. RTE. 8885 & 8884A	SECTION 12-00007-00-SP	COUNTY MADISON	TOTAL SHEETS 14	SHEET NO. 14
CONTRACT NO. 97542			ILLINOIS FED. AID PROJECT	