

GENERAL NOTES

- THE SCOPE OF WORK SHEET IS INTENDED ONLY AS A GENERAL DESCRIPTION OF WORK ITEMS AND THEIR APPROXIMATE LOCATIONS AND LIMITS, FOR THE PURPOSE OF UNDERSTANDING THE SCOPE OF THE PROJECT. THIS SHEET SHALL NOT BE USED AS A CONSTRUCTION PLAN. REFER TO THE FOLLOWING PLAN SHEETS FOR DETAILED CONSTRUCTION REQUIREMENTS, LOCATIONS, AND ITEMS OF WORK.
- WORK FOR THIS PROJECT SHALL CONSIST OF, BUT IS NOT LIMITED TO, PAVEMENT MILLING, PLACEMENT OF BITUMINOUS PAVEMENT, CRACK CONTROL FABRIC, PAVEMENT MARKING, EROSION CONTROL, SEEDING, SODDING, AND OTHER ASSOCIATED ITEMS.
- THE PROJECT PAY ITEMS ARE INTENDED TO BE INCLUSIVE OF ALL WORK TO BE PERFORMED AS SHOWN IN THESE PLANS. ALL INCIDENTAL WORK REQUIRED TO COMPLETE THE PROJECT TO THE SATISFACTION OF THE ENGINEER IS TO BE INCLUDED IN THE COSTS OF PERFORMING THESE ITEMS. THE CONTRACTOR SHALL FURNISH ALL LABOR, MATERIAL, EQUIPMENT, AND TRANSPORTATION NECESSARY TO CONSTRUCT ALL ELEMENTS OF THE PROJECT AS DESCRIBED IN THE CONSTRUCTION PLANS AND SPECIFICATIONS.
- NO EQUIPMENT SHALL BE PERMITTED TO CROSS OR USE ANY EXISTING PAVEMENT OUTSIDE THE GENERAL PROJECT AREA OR HAUL ROUTE. ACCESS TO THE PROJECT AREA FOR ALL HAULING OF MATERIALS AND EQUIPMENT SHALL BE RESTRICTED TO THE DESIGNATED CONSTRUCTION ENTRANCE, STAGING AREA AND HAUL ROUTE.
- IT SHALL BE THE RESPONSIBILITY OF THE CONTRACTOR TO PROTECT, PRESERVE AND REPAIR THE EXISTING AIRFIELD AND ROADWAY (PUBLIC OR PRIVATE) PAVEMENTS AT ALL TIMES. THE CONTRACTOR SHALL REPAIR ANY DAMAGE TO EXISTING ELECTRICAL, DRAINAGE, AND PAVEMENT STRUCTURES AT NO ADDITIONAL COST TO THE CONTRACT. THE CONTRACTOR SHALL BE RESPONSIBLE FOR OBTAINING PERMITS FOR HAULING ON PUBLIC ROADS, AS APPLICABLE.
- CONTRACTOR IS REQUIRED TO PROVIDE THEIR OWN RESTROOM FACILITIES.
- THE OWNER SHALL HAVE THE RIGHT OF FIRST REFUSAL FOR ALL SALVAGEABLE MATERIAL REMOVED ON THE PROJECT.
- THE CONTRACTOR SHALL PROVIDE ONE SET OF REDLINED RECORD DRAWINGS TO THE RESIDENT ENGINEER AT THE COMPLETION OF THE PROJECT.
- APPROXIMATE LOCATIONS OF UNDERGROUND UTILITIES ARE SHOWN THROUGHOUT THESE PLANS. THE CONTRACTOR SHALL DETERMINE EXACT LOCATIONS AND PROTECT THESE UTILITIES DURING CONSTRUCTION. ANY UTILITIES DAMAGED DURING CONSTRUCTION SHALL BE REPAIRED AT THE CONTRACTOR'S EXPENSE. CONTRACTOR SHALL COORDINATE WITH THE PROPER AUTHORITIES FOR THE PURPOSE OF LOCATING AND PROTECTING EXISTING UNDERGROUND UTILITIES.
- THE CONTRACTOR MUST AT ALL TIMES MAINTAIN PROPER DRAINAGE AND EROSION CONTROL FOR ALL AREAS AFFECTED BY HIS WORK.
- ALL WORKED PERFORMED SHALL BE DONE IN AN ORDERLY AND EFFECTIVE MANNER TO MINIMIZE RUNWAY CLOSURES.
- NO TRENCHES OR HOLES OR PAVEMENT DROP-OFF'S GREATER THAN 3 INCHES ARE ALLOWED TO REMAIN WITHIN THE RUNWAY SAFETY AREA WHEN IT IS TO BE OPENED TO AIRCRAFT TRAFFIC.
- THE LOCATION OF THE ENGINEER'S FIELD OFFICE WILL BE DETERMINED AT THE PRE-CONSTRUCTION MEETING.
- THIS PROJECT WILL DISTURB MORE THAN 1 ACRE OF LAND, THEREFORE A NPDES PERMIT IS REQUIRED. THE CONTRACTOR IS RESPONSIBLE FOR IMPLEMENTING AND MAINTAINING THE EROSION CONTROL MEASURES AS SHOWN IN THE STORMWATER POLLUTION PREVENTION PLAN (SWPPP) AND IN ACCORDANCE WITH THE STANDARDS AND SPECIFICATIONS FOR SOIL EROSION AND SEDIMENT CONTROL, ILLINOIS ENVIRONMENTAL PROTECTION AGENCY, CURRENT ISSUE.
- A PORTION OF THE HAUL ROUTE AND STAGING AREA SHALL REMAIN IN PLACE AT THE CONCLUSION OF THE PROJECT AS NOTED ON THIS SHEET. ALL OTHER DISTURBED AREAS SHALL BE RESTORED TO ORIGINAL CONDITION. REFER TO AR150540 "HAUL ROUTE" SPECIAL PROVISION.

UTILITY NOTE

THE LOCATION, SIZE, AND TYPE OF MATERIAL OF EXISTING UNDERGROUND AND/OR ABOVEGROUND UTILITIES INDICATED ON THE PLANS ARE NOT REPRESENTED AS BEING ACCURATE, SUFFICIENT OR COMPLETE. NEITHER THE OWNER NOR THE ENGINEER ASSUMES ANY RESPONSIBILITY WHATEVER IN RESPECT TO THE ACCURACY, COMPLETENESS, OR SUFFICIENCY OF THE INFORMATION. THERE IS NO GUARANTEE, EITHER EXPRESSED OR IMPLIED, THAT THE LOCATIONS, SIZE AND TYPE OF MATERIAL OF EXISTING UNDERGROUND UTILITIES INDICATED ARE REPRESENTATIVE OF THOSE TO BE ENCOUNTERED IN THE CONSTRUCTION. IT SHALL BE THE CONTRACTOR'S RESPONSIBILITY TO DETERMINE THE ACTUAL LOCATION OF ALL SUCH FACILITIES, INCLUDING SERVICE CONNECTIONS TO UNDERGROUND UTILITIES. PRIOR TO CONSTRUCTION, THE CONTRACTOR SHALL NOTIFY THE UTILITY COMPANIES OF HIS OPERATIONAL PLANS AND SHALL OBTAIN FROM THE RESPECTIVE UTILITY COMPANIES DETAILED INFORMATION AND ASSISTANCE RELATIVE TO THE LOCATION OF THEIR FACILITIES AND THE WORKING SCHEDULE OF THE COMPANIES FOR REMOVAL OR ADJUSTMENT WHERE REQUIRED. IN THE EVENT AN UNEXPECTED UTILITY INTERFERENCE IS ENCOUNTERED DURING CONSTRUCTION, THE CONTRACTOR SHALL IMMEDIATELY NOTIFY THE UTILITY COMPANY OF JURISDICTION. THE OWNER'S REPRESENTATIVE AND/OR THE RESIDENT ENGINEER SHALL ALSO BE IMMEDIATELY NOTIFIED. ANY DAMAGE TO SUCH MAINS AND SERVICES SHALL BE RESTORED TO SERVICE AT ONCE AND PAID FOR BY THE CONTRACTOR AT NO ADDITIONAL COST TO THE CONTRACT. ALL UTILITY CABLES AND LINES SHALL BE LOCATED BY THE RESPECTIVE UTILITY. **CONTACT JULIE (JOINT UTILITY LOCATION INFORMATION FOR EXCAVATORS) FOR UTILITY INFORMATION, PHONE: 1-800-892-0123.** ALSO CONTACT AIRPORT DIRECTOR/MANAGER AND AIRPORT PERSONNEL FOR ASSISTANCE IN LOCATING UNDERGROUND AIRPORT CABLES AND/OR UTILITIES.

NOTES

- SODDING IS TO BE PLACED IN LIEU OF SEEDING/MULCHING IN MIDDLE 100' OF TURF RUNWAY INTERSECTION.
- PAVEMENT CROSS-SLOPE VARIES AT THE FOLLOWING STATION RANGES:
123+60-124+00
127+25-128+50
132+50-134+50
150+00-150+53

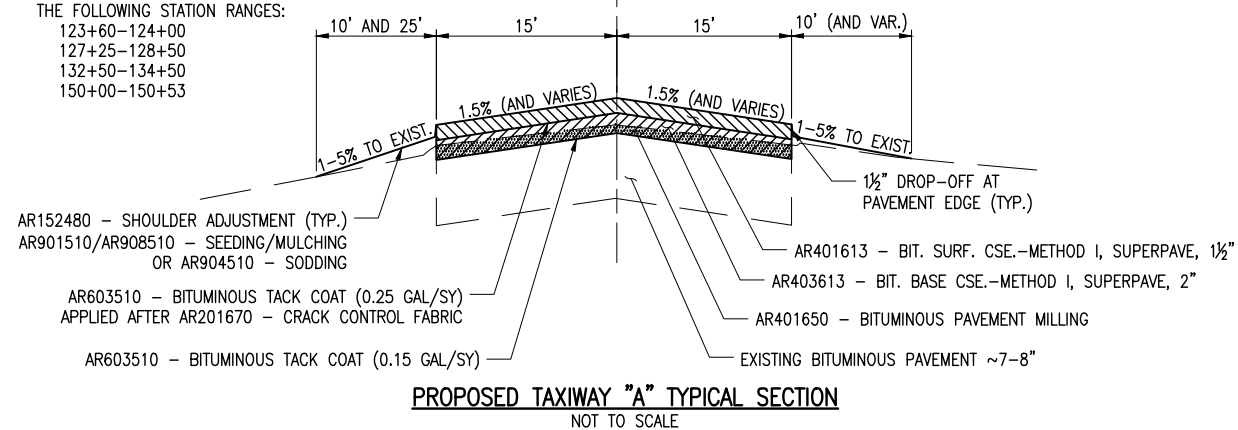

CERTIFIED PAYROLLS

THE RESIDENT ENGINEER CANNOT FORWARD CONSTRUCTION REPORTS FOR PAYMENT TO THE IDOT - DIVISION OF AERONAUTICS FOR PROCESSING UNTIL ALL CERTIFIED PAYROLLS FOR THE PERIOD HAVE BEEN RECEIVED.

MATERIAL CERTIFICATION

COMPLETED WORK CANNOT BE PLACED ON A CONSTRUCTION REPORT FOR PAYMENT UNTIL ALL MATERIAL CERTIFICATIONS FOR THAT PAY ITEM HAVE BEEN RECEIVED, REVIEWED AND ACCEPTED BY THE RESIDENT ENGINEER.

J.U.L.I.E. INFORMATION

COUNTY _____ WILL
CITY _____ JOLIET
TOWNSHIP _____ TROY
SECTION NO. _____ 14 & 15
ADDRESS _____ JOLIET REGIONAL AIRPORT
3000 WEST JEFFERSON STREET
JOLIET, ILLINOIS 60435

| HORIZONTAL AND VERTICAL CONTROL DATA | | | | |
|--------------------------------------|----------------------------------------------------------------------------------------------------|--------------|--------------|--------|
| NO. | DESCRIPTION | NORTHING | EASTING | ELEV. |
| ① | NGS BRASS MONUMENT "G142 1947" NAVD 88. LOCATED ON THE N.E. FACE OF THE AIRPORT TERMINAL BUILDING. | *** | *** | 583.15 |
| ② | NGS BRASS MONUMENT "JOLIPOINT" NAD83 (2007) IL. E. ZONE. | 1,767,814.89 | 1,026,441.63 | 579.87 |
| ③ | NGS BRASS MONUMENT "JOLIPOINT AZ MK" NAD83 (2007), IL. E. ZONE. | 1,766,728.01 | 1,027,868.33 | 581.29 |

LEGEND

- EXISTING PAVEMENT
- PROPOSED IMPROVEMENTS
- EXISTING BUILDINGS
- PROPOSED HAUL ROUTE
- AIRPORT PROPERTY LINE

0' 100' 200' 400'
HALF SIZE SCALE: 1" = 400'
FULL SIZE SCALE: 1" = 200'

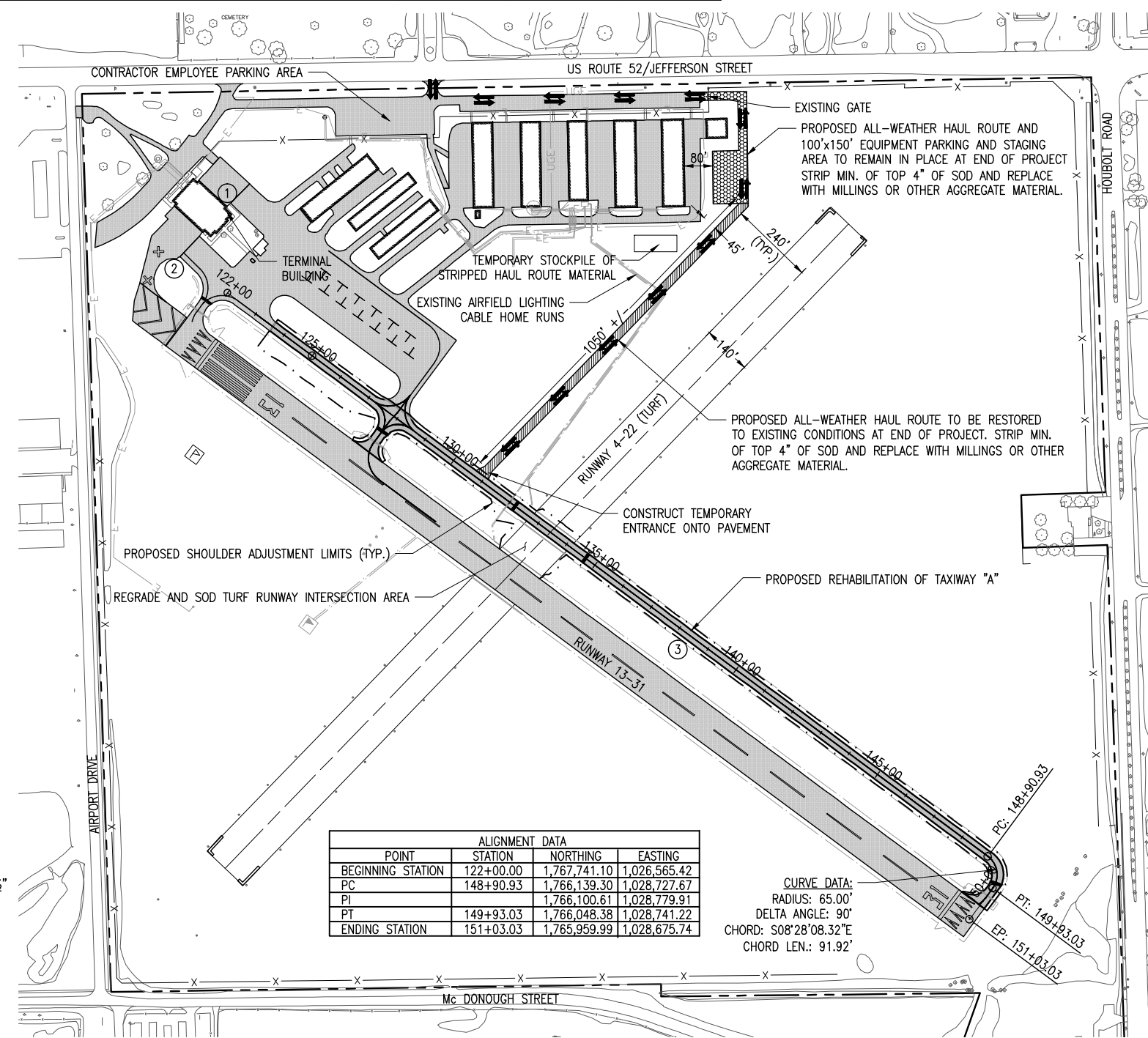

| ALIGNMENT DATA | | | |
|-------------------|-----------|--------------|--------------|
| POINT | STATION | NORTHING | EASTING |
| BEGINNING STATION | 122+00.00 | 1,767,741.10 | 1,026,565.42 |
| PC | 148+90.93 | 1,766,139.30 | 1,028,727.67 |
| PI | | 1,766,100.61 | 1,028,779.91 |
| PT | 149+93.03 | 1,766,048.38 | 1,028,741.22 |
| ENDING STATION | 151+03.03 | 1,765,959.99 | 1,028,675.74 |

CURVE DATA:
RADIUS: 65.00'
DELTA ANGLE: 90°
CHORD: S08°28'08.32"E
CHORD LEN.: 91.92'

JO022

REVISION

DATE

**JOLIET REGIONAL AIRPORT
JOLIET PARK DISTRICT
JOLIET, ILLINOIS**

IL. PROJ.: JOT-4233 | S.B.G. PROJ.: 3-17-SBGP-XX

Hanson Project No. _____
Filename: C-003-SOM.DWG
Scale: 1"=200'
Date: 11/1/13

| | | |
|----------|-----|---------|
| LAYOUT | KBS | 4/30/13 |
| DRAWN | KBS | 4/30/13 |
| REVIEWED | CAH | 11/1/13 |

HANSON
© Copyright Hanson Professional Services Inc. 2013
Hanson Professional Services Inc.
1525 South Sixth Street
Springfield, Illinois 62703-2886
Ph: (217) 788-2450 Fax: (217) 788-2503
www.hanson-inc.com
Offices Nationwide

REHABILITATE TAXIWAY "A"

SCOPE OF WORK,
GENERAL NOTES,
TYPICAL SECTION

3

3 of 17 sheets