

098

STATE OF ILLINOIS
DEPARTMENT OF TRANSPORTATION

F.A.I. RTE.	SECTION	COUNTY	TOTAL SHEETS	SHEET NO.
VAR	D5 CM INLAY 2020-2	ILLINOIS	#32	1
CHAMPAIGN & VERMILION COUNTY			CONTRACT NO. 70E37	
* F.A.I. ST. F.A.I. 74 & F.A.S. 331				
*32 + 2 = 34 TOTAL SHEETS ANYWHERE ON 70E37				
D-95-022-20				

FOR INDEX OF SHEETS, SEE SHEET NO. 2
FOR SUMMARY OF QUANTITIES, SEE SHEETS NO. 4-5

PROPOSED HIGHWAY PLANS

ROUTE: F.A.I. 57, F.A.I. 74 & F.A.S. 331
SECTION D5 CM INLAY 2020-2
PROJECT

STANDARD OVERLAY AND COLD MILLING
CHAMPAIGN & VERMILION COUNTY

C-95-022-20

I-57 AT I-74 RAMPS; I-74 AT THE OAKWOOD RAMPS;
OAKWOOD RD S OF I-74 INTERCHANGE

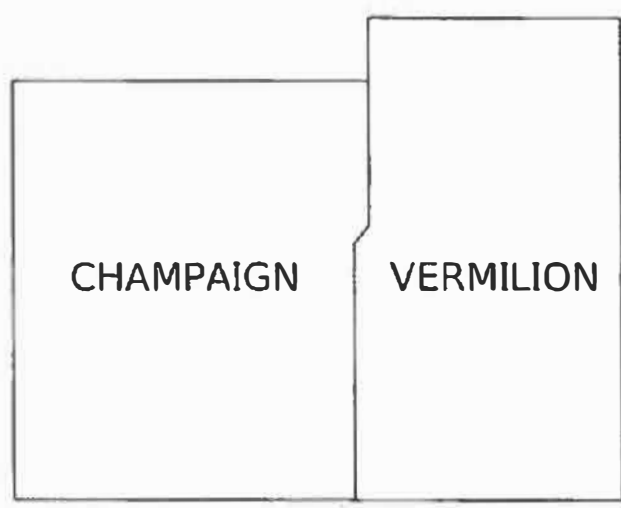
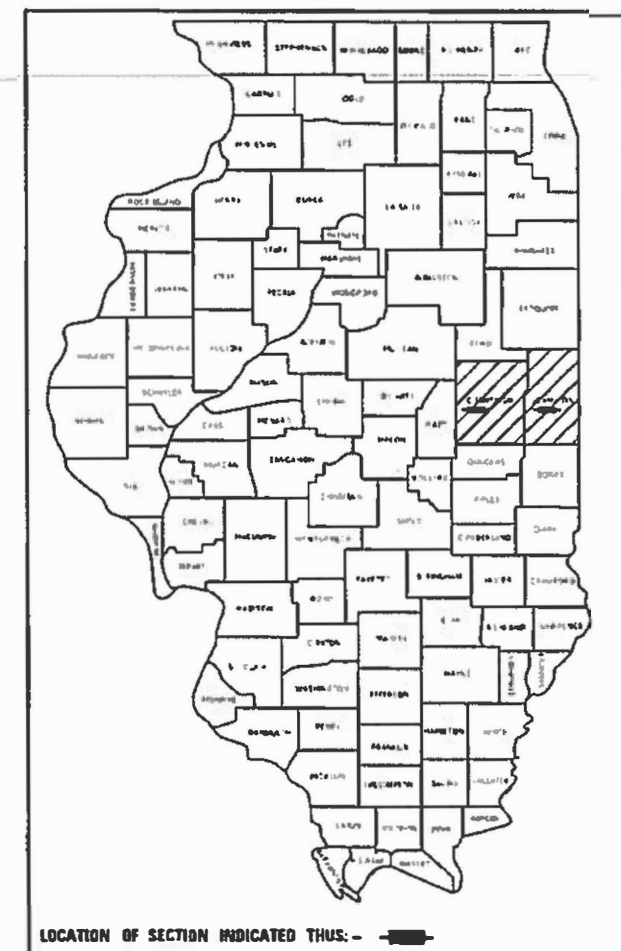

SEE SHEET NO. 3
FOR LOCATION MAP

GROSS LENGTH = 2,135.89 FT. = 0.405 MILE
NET LENGTH = 2,135.89 FT. = 0.405 MILE

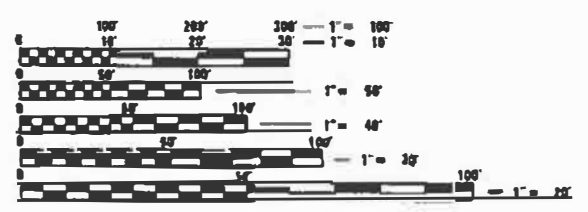

FULL SIZE PLANS HAVE BEEN PREPARED USING STANDARD
ENGINEERING SCALES. REDUCED SIZED PLANS WILL NOT
CONFORM TO STANDARD SCALES. IN MAKING MEASUREMENTS
ON REDUCED PLANS, THE ABOVE SCALES MAY BE USED.

J.U.L.I.E.
JOINT UTILITY LOCATION INFORMATION FOR EXCAVATORS
1-800-892-0123
OR 811 TOWNSHIPS: CHAMPAIGN & OAKWOOD

PROJECT ENGINEER: JASON STULTS
SQUAD LEADER: RYAN CARROLL
DESIGNER: CHRISTINA GOSNELL
PHONE: 217-465-4181
CONTRACT NO. 70E37

STATE OF ILLINOIS
DEPARTMENT OF TRANSPORTATION

SUBMITTED 10/18/19 TO 19
Kensil A. Barnett, Regional Engineer
Dec 10/19 E.A. Etk
ENGINEER OF DESIGN AND ENVIRONMENT
Dec 6/19 Paul C. Chy
DIRECTOR OF HIGHWAYS PROJECT IMPLEMENTATION

PRINTED BY THE AUTHORITY
OF THE STATE OF ILLINOIS

INDEX OF SHEETS

SHEET NO.	DESCRIPTION
1	COVER SHEET
2	INDEX OF SHEETS
2	LIST OF HIGHWAY STANDARDS
2	GENERAL NOTES
3	LOCATION MAP
4-5	SUMMARY OF QUANTITIES
6-11	EXISTING AND PROPOSED TYPICAL CROSS SECTIONS
12-15	SCHEDULE OF QUANTITIES
16-24	PLAN SHEETS
25-27	DETOUR SIGNING
28-34	DISTRICT DETAILS

HIGHWAY STANDARDS

STANDARD NO.	DESCRIPTION
000001-07	Standard Symbols, Abbreviations and Patterns
001006	Decimal of an Inch and of a Foot
701101-05	Off-Road Operations, Multilane, 15' (4.5 m) to 24' (600 mm) From Pavement Edge
701106-02	Off-Road Operations, Multilane, More Than 15* (4.5 m) Away
701301-04	Lane Closure, 2L, 2W, Short Time Operations
701400-09	Approach to Lane Closure, Freeway/Expressway
701401-12	Lane Closure, Freeway/Expressway
701426-09	Lane Closure, Multilane, Intermittent or Moving Operation, for Speeds ≥ 45 MPH
701427-05	Lane Closure, Multilane, Intermittent or Moving Operation, for Speeds ≤ 40 MPH
701428-01	Traffic Control, Setup and Removal, Freeway/Expressway
701451-05	Ramp Closure Freeway/Expressway
701501-06	Urban Lane Closure, 2L, 2W, Undivided
701901-08	Traffic Control Devices
780001-05	Typical Pavement Markings
781001-04	Typical Applications Raised Reflective Pavement Markers

COMMITMENTS

THERE ARE NO COMMITMENTS FOR THIS CONTRACT

GENERAL NOTES

G.N.-100A
ELECTRONIC FILES AND/OR ELECTRONIC SURVEY INFORMATION INCLUDING CADD FILES WILL NOT BE AVAILABLE TO THE CONTRACTOR.

G.N.-105.09A
ALL ELEVATIONS SHOWN IN THE PLANS ARE BASED ON NORTH AMERICAN VERTICAL DATUM OF 1988. (NAVD 88)

G.N.- 406H MIXTURE REQUIREMENTS

LOCATION	FAI 57 AT FAI 74 RAMPS, FAI 74 AT FAS 331 RAMPS & FAS 331 (LANES AND SHOULDERS) S OF INTERCHANGE; I-74 W OF I-57/ I-74 INTERCHANGE
MIXTURE USE	POLYMER SURFACE
AC/PG	SBS PG 76-22
DESIGN AIR VOIDS	4.0% @ NDES=80
MIX COMP (GRADATION)	SMA 12.5
FRICTION AGGREGATE	MIX E
MIXTURE WEIGHT	112
QUALITY MANAGEMENT PROGRAM	QC/OA
SUBLOT SIZE	N.A.

G.N.-440M

THE HMA BEING MILLED WITHIN THE I-57 AT I-74 INTERCHANGE RAMPS CONTAIN A HIGH FRICTION SURFACE TREATMENT CONSISTING OF EPOXY BINDER AND CALCINED BAUXITE SAND PARTICLES WITH AN APPROXIMATE THICKNESS OF 1/4" - 3/8". THIS MATERIAL SHALL NOT BE USED AS RAP/FRAP IN FUTURE HMA WORK. THIS MATERIAL WILL BE SUITABLE FOR USE AS AGGREGATE WEDGE SHOULDER, TYPE B. ON THIS OR FUTURE IDOT CONTRACTS.

G.N.- 667

THE RESIDENT ENGINEER SHALL CONTACT THE PROGRAM DEVELOPMENT CHIEF OF SURVEYS PRIOR TO THE PRE-CONSTRUCTION CONFERENCE FOR INSTRUCTION AS TO SETTING OF TEMPORARY OR PERMANENT TIES FOR CENTERLINE ALIGNMENT CONTROL SURVEY MARKERS (PC'S, PT'S, AND PI'S). PROJECT IMPLEMENTATION PERSONNEL WILL BE RESPONSIBLE FOR LAYOUT OF THESE MARKERS.

G.N.- 703A

SHORT TERM PAVEMENT MARKING SHALL BE APPLIED TO THE PAVEMENT AFTER ANY OF THE FOLLOWING: COLD MILLING AND/OR PLACING BITUMINOUS MATERIALS (TACK COAT), LEVELING BINDER (MACHINE METHOD), BINDER AND SURFACE COURSES. SHORT TERM PAVEMENT MARKING PLACED ON THE SURFACE SHALL COINCIDE WITH THE FINAL PAVEMENT STRIPING. SHORT TERM PAVEMENT MARKING PLACED PRIOR TO THE SURFACE SHALL COINCIDE WITH THE EXISTING PAVEMENT MARKINGS. USE 4 FEET PER 40 FEET (OR 10% PER STATION).

G.N.- 781

THE FINAL PAVEMENT MARKINGS SHALL BE IN PLACE PRIOR TO PLACING THE RAISED REFLECTIVE PAVEMENT MARKERS.

G.N.-1004.01

COURSE AGGREGATE GRADATION CA-10 MAY BE USED WHENEVER COURSE AGGREGATE CA-6 IS SPECIFIED IN THE STANDARD SPECIFICATIONS.

MODEL: I:\MODEL\MHFE
FILE: MHFE.dwg
S:\projects\0570E37\CADD\DATA\CAD\papers\0570E37-rlt-Gen\title.dgn

** F.A.I. 57, F.A.I. 74 & F.A.S. 331

USER NAME = gosnellc1	DESIGNED -	REVISED -	STATE OF ILLINOIS DEPARTMENT OF TRANSPORTATION	INDEX OF SHEETS, HIGHWAY STANDARDS & GENERAL NOTES			SCALE:		SHEET 1	OF 1	SHEETS	STA.	TO STA.	CONTRACT NO. 70E37		
PLOT SCALE = 40.0000 ' / in.	DRAWN -	REVISED -		F.A.** RTE.		SECTION	COUNTY	TOTAL SHEETS	SHEET NO.							
PLOT DATE = 10/31/2019	CHECKED -	REVISED -		VAR.		D5 CM INLAY 2020-2	-	34	2							
	DATE -	REVISED -		ILLINOIS		FED. AID PROJECT										

SUMMARY OF QUANTITIES

LOCATION OF WORK:	FAI 57 (I-57)	FAI 74 (I-74)	FAS 331 (OAKWOOD RD)	FAI 74 (I-74)
	RAMPS	RAMPS	2LANE-2WAY	INTERSTATE
	URBAN	RURAL	RURAL	URBAN
COUNTY:	CHAMPAIGN	VERMILION	VERMILION	CHAMPAIGN
FUNDING BREAKOUT:	100% STATE	100% STATE	100% STATE	100% STATE
CONSTRUCTION TYPE CODE:	0005	0005	0005	0005

CODE NO.	ITEM DESCRIPTION	UNIT	TOTAL QUANTITY	QUANTITY	QUANTITY	QUANTITY	QUANTITY
40600290	BITUMINOUS MATERIAL (TACK COAT)	POUND	2,129.0	844.0	393.0	794.0	98.0
40605034	POLYMERIZED HOT-MIX ASPHALT SURFACE COURSE, STONE MATRIX ASPHALT, 12.5, MIX "E", N80	TON	540.0	263.0	98.0	142.0	37.0
44000157	HOT-MIX ASPHALT SURFACE REMOVAL, 2"	SQ YD	2,638.0	0.0	873.0	1,765.0	0.0
44000159	HOT-MIX ASPHALT SURFACE REMOVAL, 2.5"	SQ YD	1,876.0	1,876.0	0.0	0.0	0.0
44000161	HOT-MIX ASPHALT SURFACE REMOVAL, 3"	SQ YD	218.0	0.0	0.0	0.0	218.0
48203005	HMA SHOULDERS, 2"	SQ YD	495.0	0.0	0.0	495.0	0.0
67100100	MOBILIZATION	L SUM	1.0	0.5	0.2	0.2	0.1
70100800	TRAFFIC CONTROL AND PROTECTION, STANDARD 701401	L SUM	1.0	0.0	0.0	0.0	1.0
70100820	TRAFFIC CONTROL AND PROTECTION, STANDARD 701451	L SUM	1.0	0.7	0.3	0.0	0.0
70102620	TRAFFIC CONTROL AND PROTECTION, STANDARD 701501	L SUM	1.0	0.0	0.0	1.0	0.0
70107025	CHANGEABLE MESSAGE SIGN	CAL DA	25.0	12.0	8.0	0.0	5.0
70200100	NIGHTTIME WORK ZONE LIGHTING	LSUM	1.0	0.7	0.2	0.0	0.1
70300100	SHORT TERM PAVEMENT MARKING	FOOT	353.0	85.0	45.0	187.0	36.0
70300150	SHORT TERM PAVEMENT MARKING REMOVAL	SQ FT	117.0	28.0	15.0	62.0	12.0

* DENOTES SPECIALTY ITEM

MODEL: \\MODEL\MHMS
 FILE: \\MAILS_P\pub\mcomada\at\links\gov\PIWDOT\Documents\DOT_Offices\Director_5\Projects\0570E37\CADDData\CAD\Sheet\0570E37-CH-500.dgn

USER NAME = gosnellc1	DESIGNED -	REVISED -
	DRAWN -	REVISED -
PLOT SCALE = 40.0000 ' / in.	CHECKED -	REVISED -
PLOT DATE = 10/31/2019	DATE -	REVISED -

**STATE OF ILLINOIS
DEPARTMENT OF TRANSPORTATION**

SUMMARY OF QUANTITIES

SCALE: SHEET 1 OF 2 SHEETS STA. TO STA.

** F.A.I. 57, F.A.I. 74 & F.A.S. 331

F.A. ** RTE.	SECTION	COUNTY	TOTAL SHEETS	SHEET NO.
VAR.	D5 CM INLAY 2020-2	*	34	4
CONTRACT NO. 70E37				

ILLINOIS FED. AID PROJECT

EXISTING TYPICAL CROSS SECTION

	STATION	TO	STATION
RAMP I-CA:	212+89.00		215+51.00
RAMP I-CA:	217+05.00		217+25.00
RAMP I-CA:	217+87.00		218+97.00
RAMP I-CA:	221+15.00		221+32.00
RAMP I-DA:	23+33.00		24+66.00

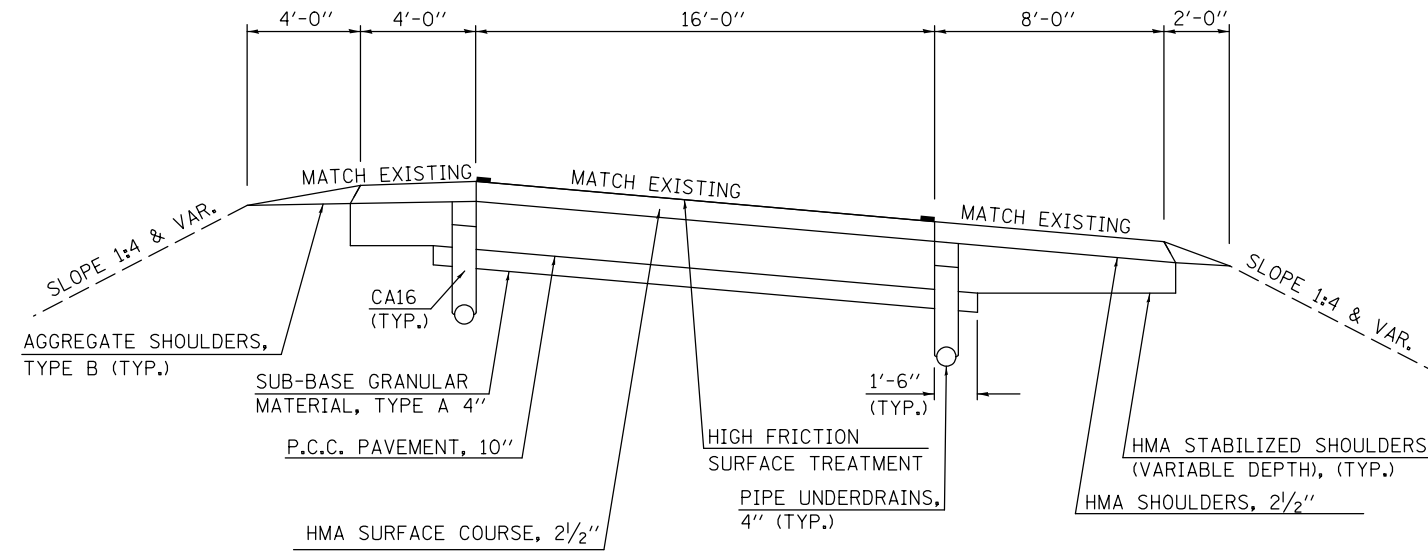

PROPOSED TYPICAL CROSS SECTION

	STATION	TO	STATION
RAMP I-CA:	212+89.00		215+51.00
RAMP I-CA:	217+05.00		217+25.00
RAMP I-CA:	217+87.00		218+97.00
RAMP I-CA:	221+15.00		221+32.00
RAMP I-DA:	23+33.00		24+66.00

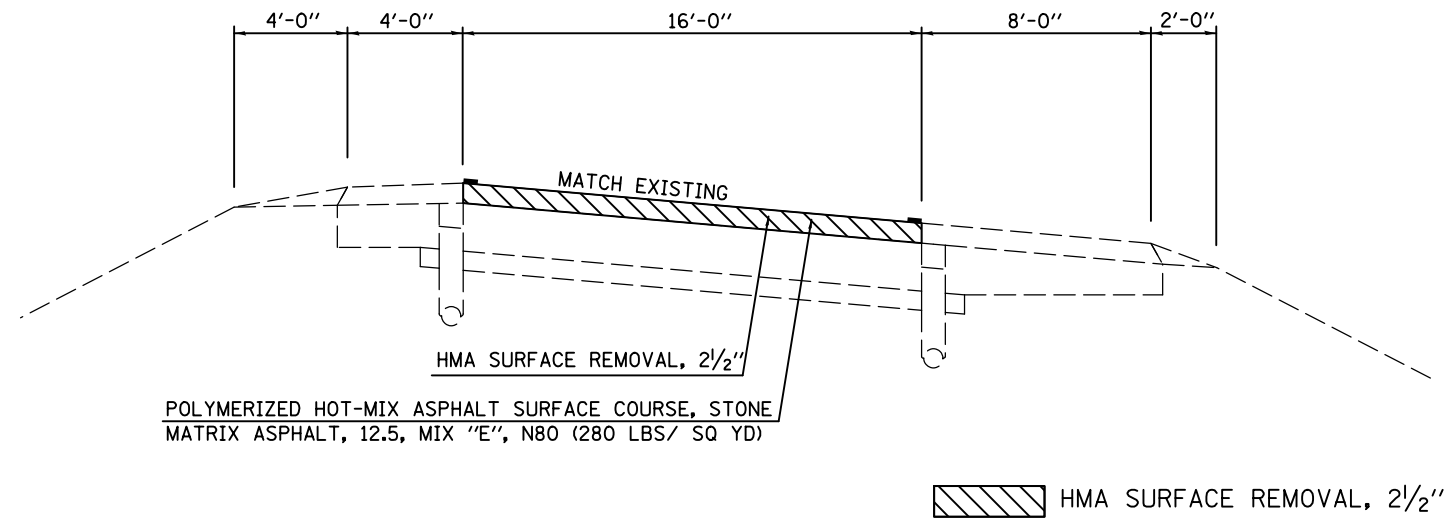

MODEL: \\MODEL\NAME: FILE: \\NAME: \\PROJECT\DATA\ILLINOIS\DOT\Documents\DOT Office\Drawings\Projects\70E37\CADDData\CAD\Sheet\0570E37-CHC-Typical.dgn

USER NAME = gosnell	DESIGNED -	REVISED -
	DRAWN -	REVISED -
PLOT SCALE = 40.0000' / in.	CHECKED -	REVISED -
PLOT DATE = 10/30/2019	DATE -	REVISED -

**STATE OF ILLINOIS
DEPARTMENT OF TRANSPORTATION**

**TYPICAL CROSS SECTIONS
I-57 & I-74 RAMPS**

SCALE: SHEET 2 OF 6 SHEETS STA. TO STA.

** F.A.I. 57, F.A.I. 74 & F.A.S. 331			
F.A. ** RTE.	SECTION	COUNTY	TOTAL SHEETS
VAR.	D5 CM INLAY 2020-2	-	34
			SHEET NO. 7
CONTRACT NO. 70E37			
ILLINOIS		FED. AID PROJECT	

EXISTING TYPICAL CROSS SECTION

	STATION	TO	STATION
RAMP I-AD:	89+12.00		90+58.00
RAMP I-AD:	93+26.00		93+46.00
RAMP I-AD:	93+89.00		94+66.00
RAMP I-AD:	97+84.00		99+45.00
RAMP I-AD:	101+44.00		102+53.00

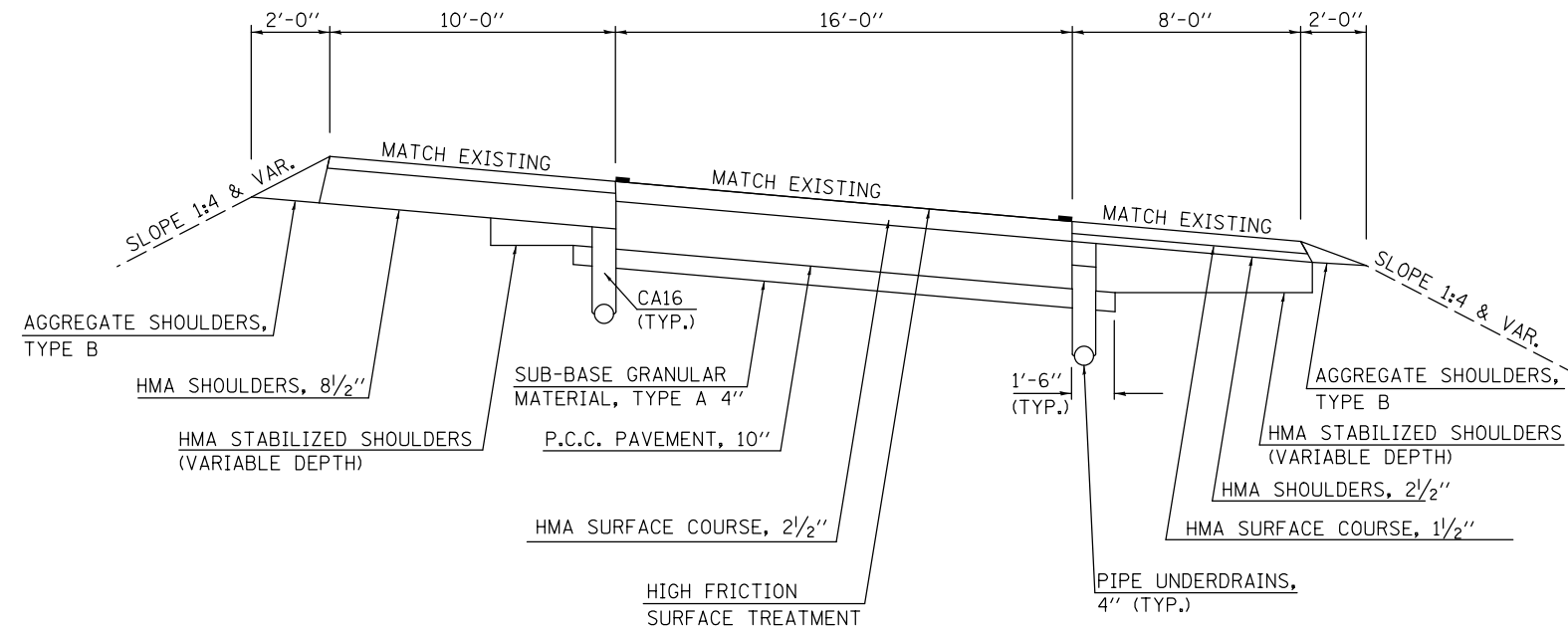

PROPOSED TYPICAL CROSS SECTION

	STATION	TO	STATION
RAMP I-AD:	89+12.00		90+58.00
RAMP I-AD:	93+26.00		93+46.00
RAMP I-AD:	93+89.00		94+66.00
RAMP I-AD:	97+84.00		99+45.00
RAMP I-AD:	101+44.00		102+53.00

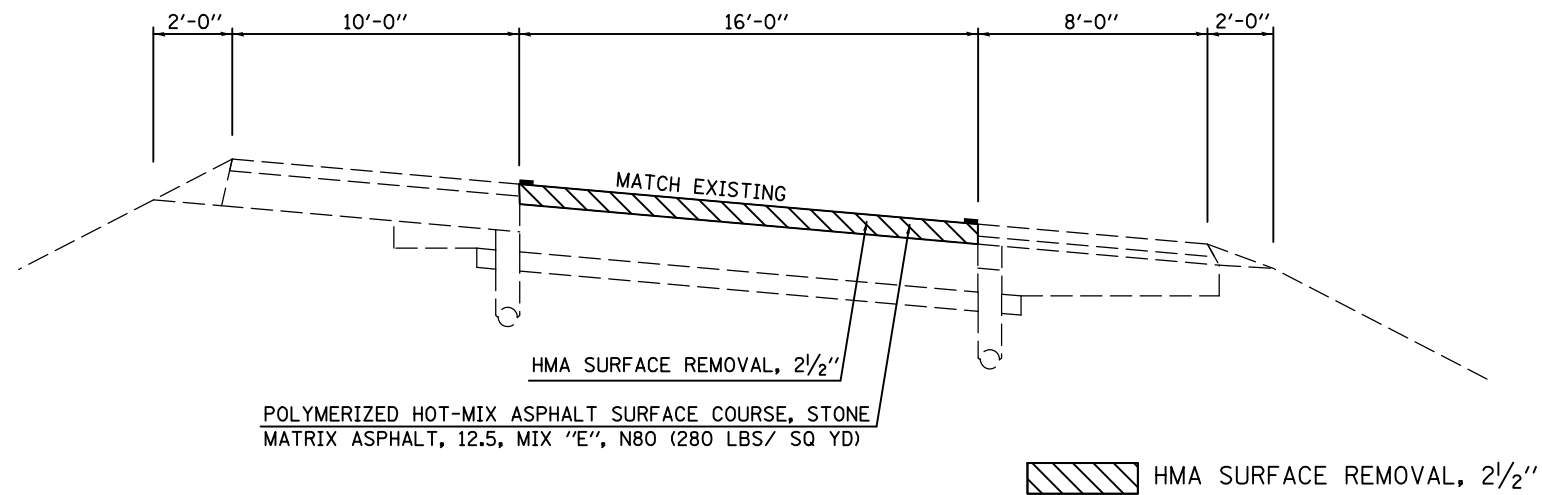

MODEL: \\MODEL\MATF
 FILE: \\matf:pub\pblm\com\data\illinois\pwr\pww\DOT\Documents\DOT - Offices\District 5\Projects\0570E37\CADDData\CAD\Sheet\0570E37-01b-Typical.dgn

USER NAME = gosnellc1	DESIGNED -	REVISED -	
	DRAWN -	REVISED -	
PLOT SCALE = 40.0000' / in.	CHECKED -	REVISED -	
PLOT DATE = 10/30/2019	DATE -	REVISED -	

**STATE OF ILLINOIS
DEPARTMENT OF TRANSPORTATION**

**TYPICAL CROSS SECTIONS
I-57 & I-74 RAMPS**

SCALE: SHEET 3 OF 6 SHEETS STA. TO STA.

** F.A.I. 57, F.A.I. 74 & F.A.S. 331

F.A. ** RTE.	SECTION	COUNTY	TOTAL SHEETS	SHEET NO.
VAR.	D5 CM INLAY 2020-2	-	34	8
CONTRACT NO. 70E37				

ILLINOIS FED. AID PROJECT

EXISTING TYPICAL CROSS SECTION

	STATION	TO	STATION
RAMP I-A:	103+08.00		104+84.00
RAMP I-D:	111+22.00		112+97.00
RAMP I-D:	114+81.00		116+91.00

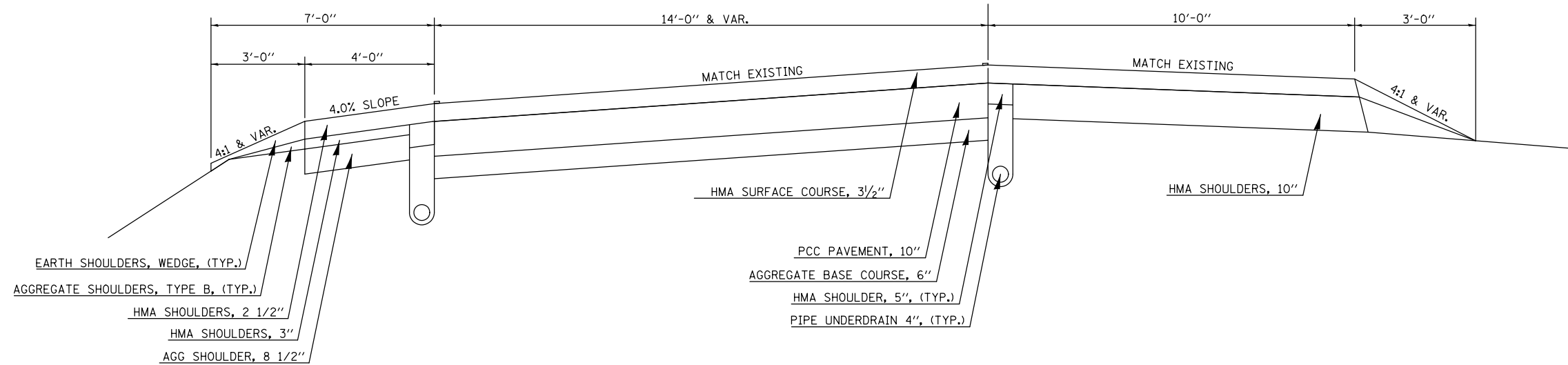

PROPOSED TYPICAL CROSS SECTION

	STATION	TO	STATION
RAMP I-A:	103+08.00		104+84.00
RAMP I-D:	111+22.00		112+97.00
RAMP I-D:	114+81.00		116+91.00

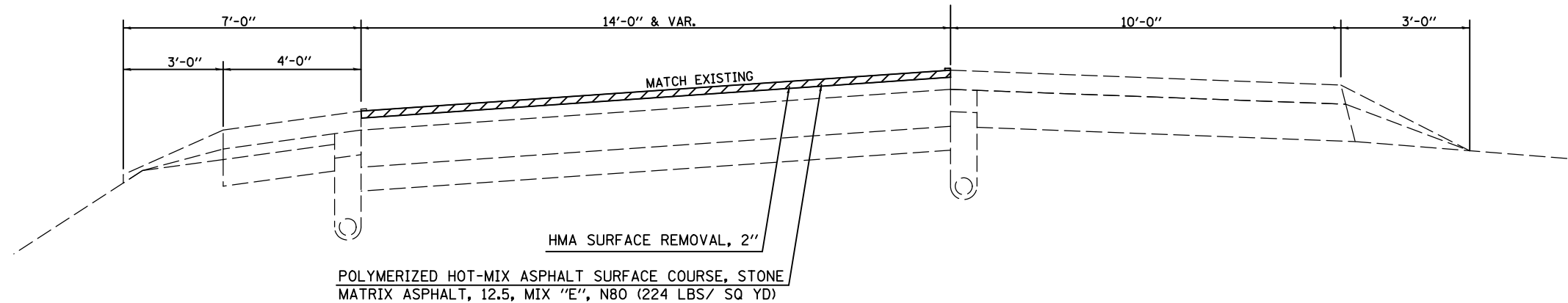

HMA SURFACE REMOVAL, 2"

MODEL: \\MODEL\MHMS
FILE: \\models\pav\champaign\70E37\CADDData\CAD\Sheet\0570E37-4b1-Typical.dgn

** F.A.I. 57, F.A.I. 74 & F.A.S. 331

USER NAME = gosnell	DESIGNED -	REVISED -
	DRAWN -	REVISED -
PLOT SCALE = 40.0000 ' / in.	CHECKED -	REVISED -
PLOT DATE = 10/30/2019	DATE -	REVISED -

STATE OF ILLINOIS
DEPARTMENT OF TRANSPORTATION

TYPICAL CROSS SECTIONS
I-74 & OAKWOOD RAMPS

SCALE: SHEET 4 OF 6 SHEETS STA. TO STA.

F.A. ** RTE.	SECTION	COUNTY	TOTAL SHEETS	SHEET NO.
VAR.	D5 CM INLAY 2020-2	-	34	9
			CONTRACT NO. 70E37	

ILLINOIS FED. AID PROJECT

CHAMPAIGN & VERMILION
REV. 1/3/20

1 EXISTING TYPICAL CROSS SECTION

STATION 57+93.59 TO STATION 60+03.00 (AH) ②

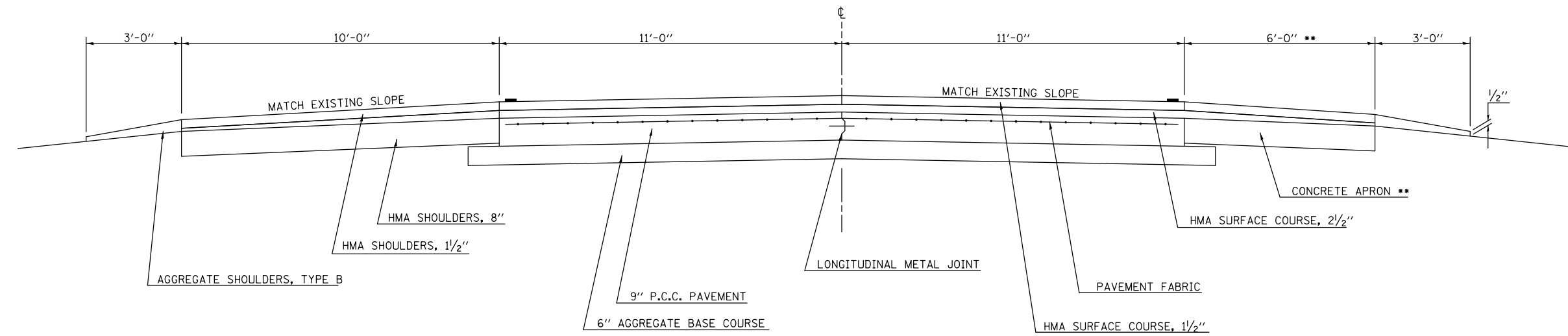

STATION EQUATION: 60+03 (AHEAD) = 61+55.45 (BACK)

** FROM STATION 80+85.0 RT. TO STATION 41+10.0 RT. 10' BITUMINOUS SHOULDER, 8" WITH BITUMINOUS OVERLAY IN PLACE OF 6'-0" CONCRETE APRON

1 PROPOSED TYPICAL CROSS SECTION

STATION 57+93.59 TO STATION 60+03.00 (AH) ②

STATION EQUATION: 60+03 (AH) = 61+55.45 (BK)

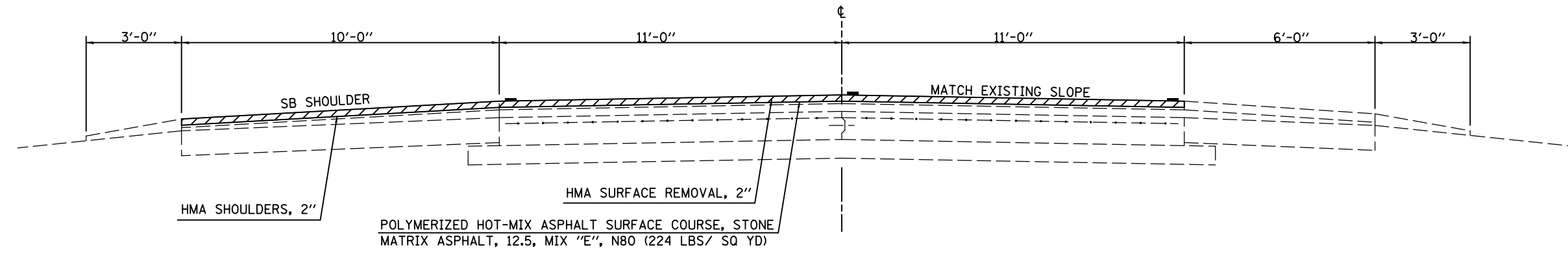

HMA SURFACE REMOVAL, 2"

MODEL: \\MODEL\NAME: FILE: \\NAME: ...

USER NAME = gosnellcl	DESIGNED -	REVISED -
	DRAWN -	REVISED -
PLOT SCALE = 40.0000' / in.	CHECKED -	REVISED -
PLOT DATE = 10/30/2019	DATE -	REVISED -

STATE OF ILLINOIS
DEPARTMENT OF TRANSPORTATION

TYPICAL CROSS SECTIONS
FAS 331 (OAKWOOD ROAD)

SCALE: SHEET 5 OF 6 SHEETS STA. TO STA.

F.A. ** RTE.	SECTION	COUNTY	TOTAL SHEETS	SHEET NO.
VAR.	D5 CM INLAY 2020-2	-	34	10
CONTRACT NO. 70E37				

** F.A.I. 57, F.A.I. 74 & F.A.S. 331

SCHEDULE OF QUANTITIES

ROUTE	DIRECTION	RAMP	STATION	TO	STATION	AVG LENGTH FOOT	70300100			70300150			70300220			70300250	
							SHORT TERM PAVEMENT MARKING			SHORT TERM PAVEMENT MARKING REMOVAL			TEMPORARY PAVEMENT MARKING - LINE 4"			TEMPORARY PAVEMENT MARKING - LINE 8"	
							FOOT			SQ FT			FOOT			FOOT	
							SOLID YELLOW LEFT EDGE	SOLID WHITE RIGHT EDGE	SKIP-DASH YELLOW CENTERLINE	SOLID YELLOW LEFT EDGE	SOLID WHITE RIGHT EDGE	SKIP-DASH YELLOW CENTERLINE	SOLID YELLOW LEFT EDGE	SOLID WHITE RIGHT EDGE	SKIP-DASH YELLOW CENTERLINE	SOLID WHITE LEFT EDGE	SOLID WHITE RIGHT EDGE
I-57/ I-74	EB TO SB	I-CA	212+89.00		215+51.00	262.00	10.48	10.48	-	3.46	3.46	-	262.00	262.00	-	-	-
I-57/ I-74	EB TO SB	I-CA	217+05.00		217+25.00	20.00	0.80	0.80	-	0.26	0.26	-	20.00	20.00	-	-	-
I-57/ I-74	EB TO SB	I-CA	217+87.00		218+97.00	110.00	4.40	4.40	-	1.45	1.45	-	110.00	110.00	-	-	-
I-57/ I-74	EB TO SB	I-CA	221+15.00		221+32.00	17.00	0.68	0.68	-	0.22	0.22	-	17.00	17.00	-	-	-
I-57/ I-74	NB TO EB	I-AD	89+12.00		90+58.00	146.00	5.84	5.84	-	1.93	1.93	-	146.00	146.00	-	-	-
I-57/ I-74	NB TO EB	I-AD	93+26.00		93+46.00	20.00	0.80	0.80	-	0.26	0.26	-	20.00	20.00	-	-	-
I-57/ I-74	NB TO EB	I-AD	93+89.00		94+66.00	77.00	3.08	3.08	-	1.02	1.02	-	77.00	77.00	-	-	-
I-57/ I-74	NB TO EB	I-AD	97+84.00		99+45.00	161.00	6.44	6.44	-	2.13	2.13	-	161.00	161.00	-	-	-
I-57/ I-74	NB TO EB	I-AD	101+44.00		102+53.00	109.00	4.36	4.36	-	1.44	1.44	-	-	-	-	109.00	109.00
I-57/ I-74	WB TO SB	I-DA	23+33.00		24+66.00	133.00	5.32	5.32	-	1.76	1.76	-	133.00	133.00	-	-	-
OAKWOOD RD	NB DL		57+93.59		60+03.00	209.41	-	16.75	41.88	-	5.53	13.82	-	209.41	60.00	-	-
STATION EQUATION - STA. 60+03.00 (AH) = STA. 61+55.45 (BK)																	
OAKWOOD RD	NB DL		61+55.45		58+45.00	310.45	-	24.84	62.09	-	8.20	20.49	-	310.45	80.00	-	-
OAKWOOD RD	SB DL		57+93.59		60+03.00	209.41	-	16.75	-	-	5.53	-	-	209.41	-	-	-
STATION EQUATION - STA. 60+03.00 (AH) = STA. 61+55.45 (BK)																	
OAKWOOD RD	SB DL		61+55.45		58+45.00	310.45	-	24.84	-	-	8.20	-	-	310.45	-	-	-
I-74/ OAKWOOD	EB EXIT RAMP	A	103+08.00		104+84.00	176.00	7.04	7.04	-	2.32	2.32	-	176.00	176.00	-	-	-
I-74/ OAKWOOD	WB EXIT RAMP	D	111+22.00		112+97.00	175.00	7.00	7.00	-	2.31	2.31	-	175.00	175.00	-	-	-
I-74/ OAKWOOD	WB EXIT RAMP	D	114+81.00		116+91.00	210.00	8.40	8.40	-	2.77	2.77	-	210.00	210.00	-	-	-
I-74	EB DL		1036+94.00		1038+07.00	113.00	-	9.04	22.60	-	2.98	7.46	-	113.00	30.00	-	-
I-74	EB PL		1036+94.00		1037+44.00	50.00	4.00	-	-	1.32	-	-	50.00	-	-	-	-
SUBTOTAL =							68.64	156.86	126.57	22.65	51.76	41.77	1,557.00	2,659.72	170.00	109.00	109.00
PROJECT TOTAL =							353.00			117.00			4,387.00			218.00	

MODEL: \\MODEL\MHFS
FILE: \\MAILS_PUB\pub\mcom\mdata\illinois\gov\PWIDOT\Documents\DOT_Offices\Illinet\5\Projects\0570E37\CADDData\CAD\Sheet\0570E37_SHT-SCHEDULES.dgn

USER NAME = gosnellc1	DESIGNED -	REVISED -
	DRAWN -	REVISED -
PLOT SCALE = 40.0000 ' / in.	CHECKED -	REVISED -
PLOT DATE = 10/30/2019	DATE -	REVISED -

**STATE OF ILLINOIS
DEPARTMENT OF TRANSPORTATION**

SCHEDULE OF QUANTITIES

SCALE: SHEET 2 OF 4 SHEETS STA. TO STA.

** F.A.I. 57, F.A.I. 74 & F.A.S. 331

F.A. ** RTE.	SECTION	COUNTY	TOTAL SHEETS	SHEET NO.
VAR.	D5 CM INLAY 2020-2	-	34	13
CONTRACT NO. 70E37				

ILLINOIS FED. AID PROJECT

MODEL: \\MODEL\NAMES
 FILE: \\NAME: P:\p\1865\1865.dgn
 S:\projects\0570E37\CADD\data\CAD\pkcs\0570E37\SUR\PLAN_157.dgn

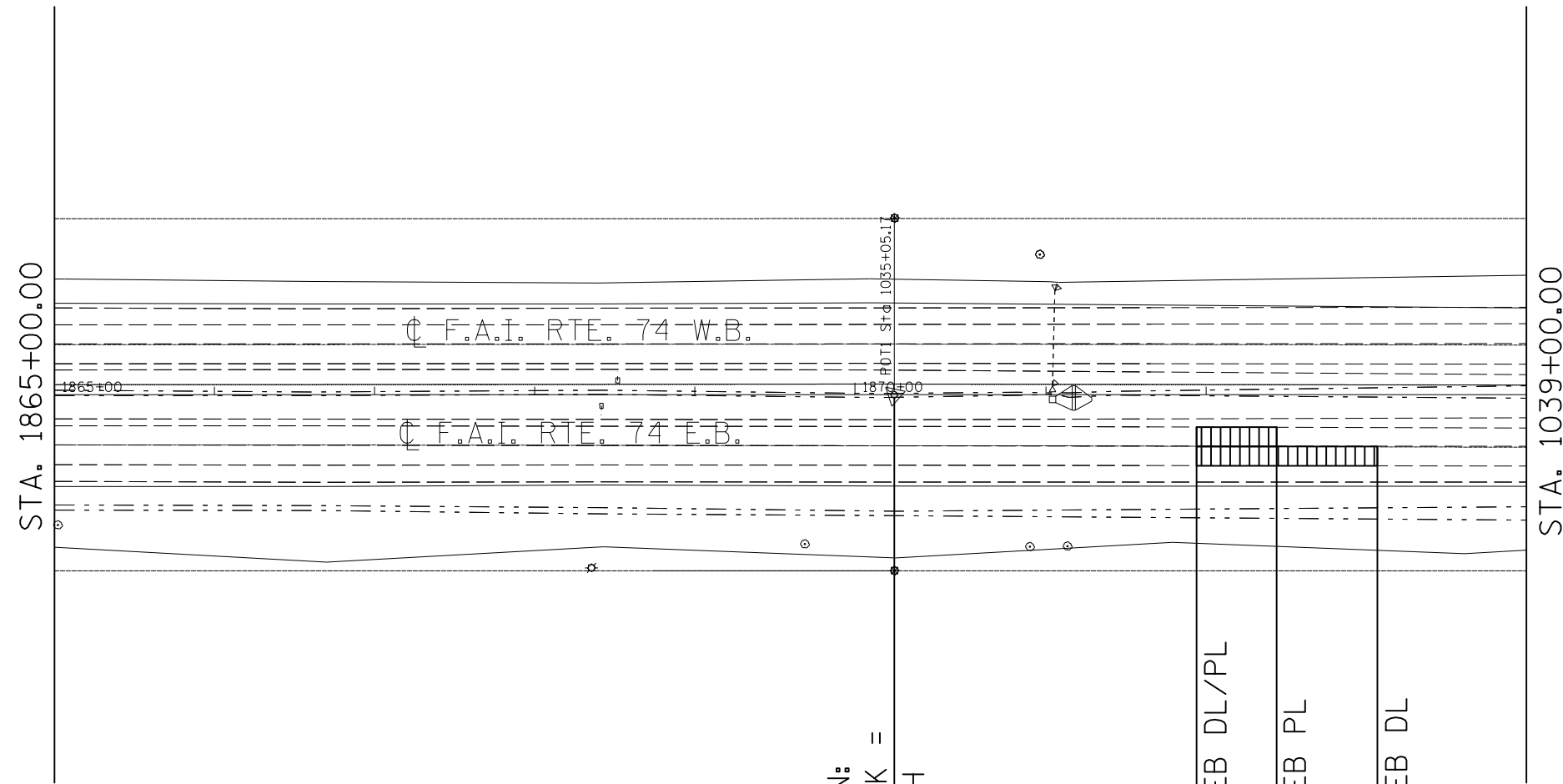

STATION EQUATION:
 STA 1870+24.62 BK =
 STA 1035+05.17 AH

PROJECT BEGINS:
 STA. 1036+94.00 EB DL/PL
 PROJECT ENDS:
 STA. 1037+44.00 EB PL
 PROJECT ENDS:
 STA. 1038+07.00 EB DL



HMA SURFACE REMOVAL, 3" AND POLYMERIZED
 HOT-MIX ASPHALT SURFACE COURSE, STONE
 MATRIX ASPHALT, 12.5, MIX "E", N80

USER NAME = g0snelkl	DESIGNED -	REVISED -
	DRAWN -	REVISED -
PLOT SCALE = 100.0000' / in.	CHECKED -	REVISED -
PLOT DATE = 10/30/2019	DATE -	REVISED -

**STATE OF ILLINOIS
 DEPARTMENT OF TRANSPORTATION**

I-74 W OF I-57/I-74 INTERCHANGE

SCALE: SHEET 1 OF 9 SHEETS STA. TO STA.

** F.A.I. 57, F.A.I. 74 & F.A.S. 331

F.A. RTE.	SECTION	COUNTY	TOTAL SHEETS	SHEET NO.
VAR.	D5 CM INLAY 2020-2	-	34	16
CONTRACT NO. 70E37				

☉ F.A.I. 74

1050+00

1055+00

1060+00

5+00

210+00

150+00

40+00

RAMP I-CA

EXIT 237A

RAMP I-BD

+89.0

145+00

+85.0

+25.0

+87.0

+97.0

220+00

+15.0

+32.0

STATION 588+50.00

☉ F.A.I. 57

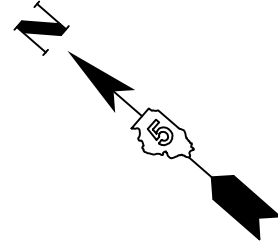

HMA SURFACE REMOVAL, 2 1/2" AND POLYMERIZED HOT-MIX ASPHALT SURFACE COURSE, STONE MATRIX ASPHALT, 12.5, MIX "E", N80

MODEL: \\MODELNAME
FILE NAME: \\PUB\mcoms\data\illinois\gov\PIWDOT\Documents\DOT Offices\District 5\Projects\0570E37\CADDData\CAD\Projects\0570E37-01-RAMP DETAIL 1-57.dgn

USER NAME = gosnellc1	DESIGNED -	REVISED -
	DRAWN -	REVISED -
PLOT SCALE = 100.0000' / in.	CHECKED -	REVISED -
PLOT DATE = 10/30/2019	DATE -	REVISED -

STATE OF ILLINOIS
DEPARTMENT OF TRANSPORTATION

PLAN SHEET
I-57 & I-74 RAMP I-CA

SCALE: SHEET 3 OF 9 SHEETS STA. TO STA.

** F.A.I. 57, F.A.I. 74 & F.A.S. 331

F.A. RTE.	SECTION	COUNTY	TOTAL SHEETS	SHEET NO.
VAR.	D5 CM INLAY 2020-2	-	34	18
CONTRACT NO. 70E37				

CHAMPAIGN & VERMILION
REV. 1/3/20

 HMA SURFACE REMOVAL, 2 1/2" AND POLYMERIZED HOT-MIX ASPHALT SURFACE COURSE, STONE MATRIX ASPHALT, 12.5, MIX "E", N80

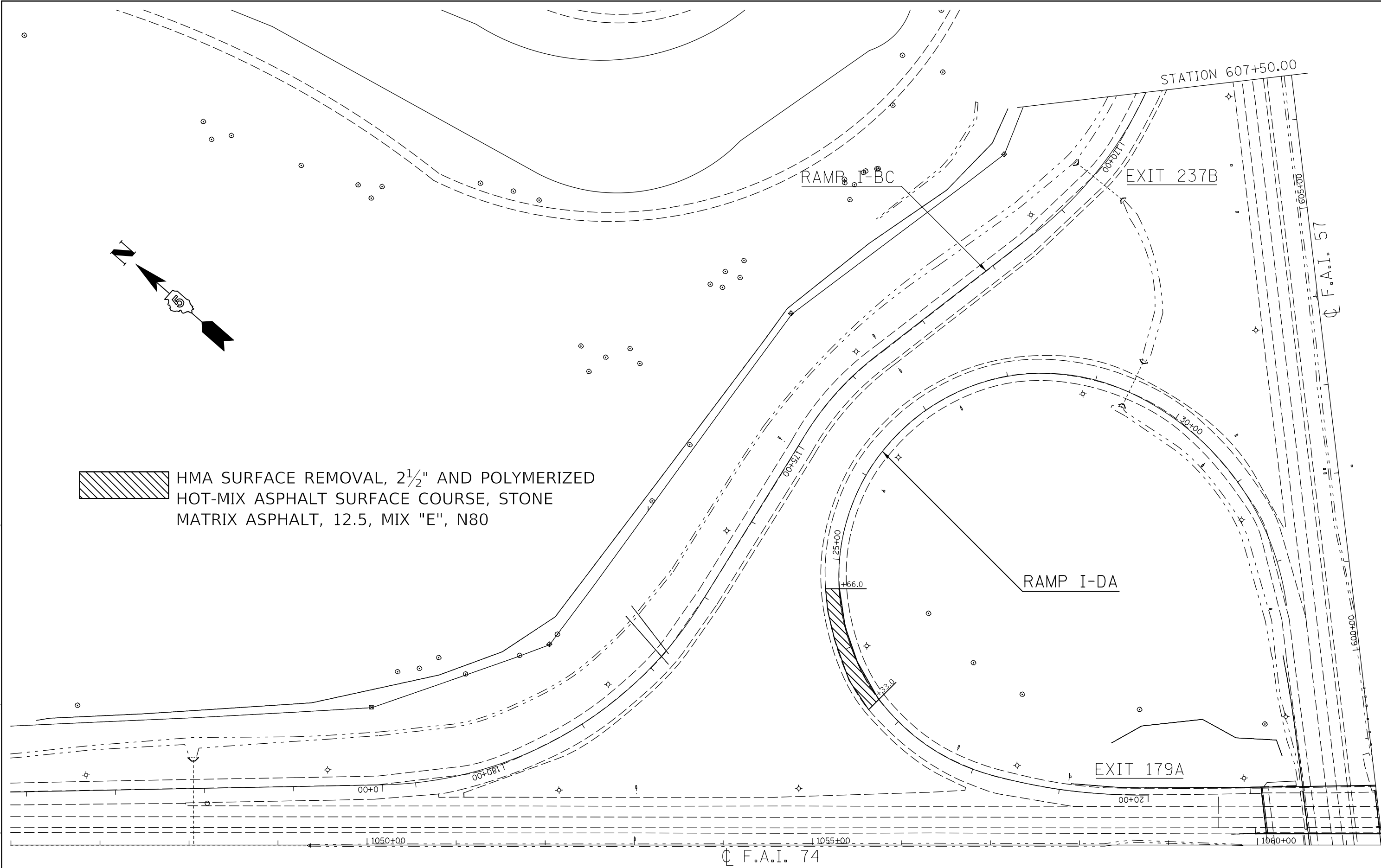
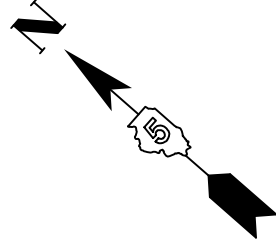

MODEL: \\MODEL\NAME
 FILE: \\NAME: \\PUB\INFORM\DATA\ILLINOIS\DOT\Documents\DOT Office\District 5\Projects\0570E37\CADD\DATA\CAD\PROJECTS\0570E37-4-11-BA-RAMP DETAIL 1-57.dgn

USER NAME = gosnellc1	DESIGNED -	REVISED -
DRAWN -	REVISED -	
PLOT SCALE = 100,0000' / in.	CHECKED -	REVISED -
PLOT DATE = 10/30/2019	DATE -	REVISED -

**STATE OF ILLINOIS
DEPARTMENT OF TRANSPORTATION**

PLAN SHEET			
I-57 & I-74 RAMP I-DA			
SCALE:	SHEET 5	OF 9 SHEETS	STA. TO STA.

** F.A.I. 57, F.A.I. 74 & F.A.S. 331

F.A. ** RTE.	SECTION	COUNTY	TOTAL SHEETS	SHEET NO.
VAR.	D5 CM INLAY 2020-2		34	20
CONTRACT NO. 70E37				

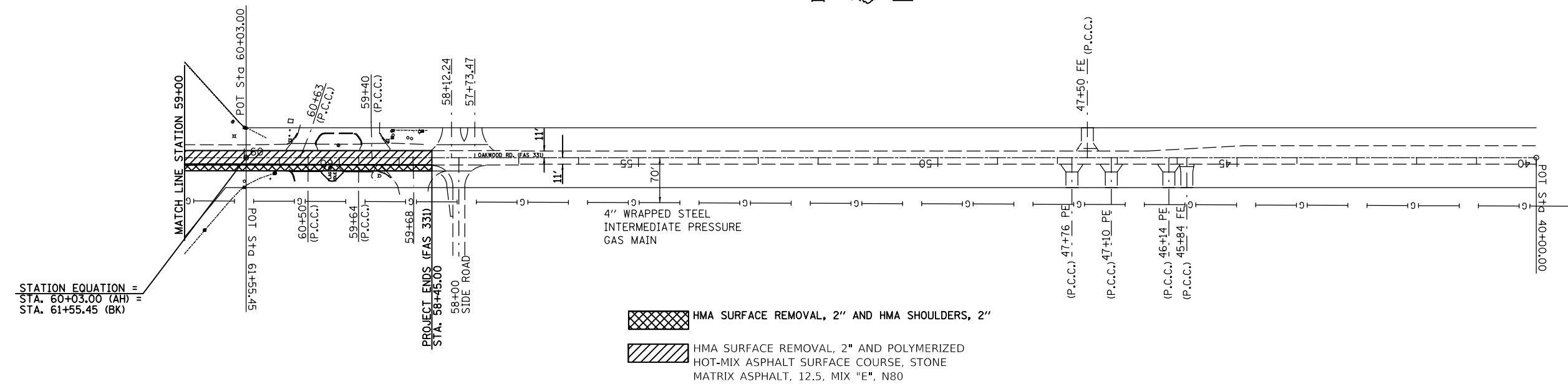

STATION EQUATION =
 STA. 60+03.00 (AH) =
 STA. 61+55.45 (BK)

- HMA SURFACE REMOVAL, 2" AND HMA SHOULDERS, 2"
- HMA SURFACE REMOVAL, 2" AND POLYMERIZED HOT-MIX ASPHALT SURFACE COURSE, STONE MATRIX ASPHALT, 12.5, MIX "E", N80

MODEL: \\MODEL\NAME
 FILE: NAME: P:\pub\hmc\omaha.dwg
 PROJECT: 0570E37\CADD\DATA\CAD\PROJECTS\0570E37\chc_Plan_17.dwg
 OFFICE: IDIR: 5\Projects\0570E37\CADD\DATA\CAD\PROJECTS\0570E37\chc_Plan_17.dwg

**F.A.I. 57, F.A.I. 74 & F.A.S. 331

USER NAME = gosnellc1	DESIGNED -	REVISED -
	DRAWN -	REVISED -
PLOT SCALE = 200.0000' / in.	CHECKED -	REVISED -
PLOT DATE = 10/30/2019	DATE -	REVISED -

**STATE OF ILLINOIS
 DEPARTMENT OF TRANSPORTATION**

OAKWOOD ROAD

SCALE: 1"=100' SHEET 7 OF 9 SHEETS STA. TO STA.

F.A. RTE.	SECTION	COUNTY	TOTAL SHEETS	SHEET NO.
VAR.	D5 CM INLAY 2020-2	-	34	22
CONTRACT NO. 70E37				
ILLINOIS FED. AID PROJECT				

MODEL: \\MODELNAME
 FILE NAME: \\PUB\GIS\DATA\ILLINOIS\DOT\Projects\DOT\Office\Detail\I-74\CADD\DATA\CAD\PROJECTS\70E37-RAMP DETAIL.dgn

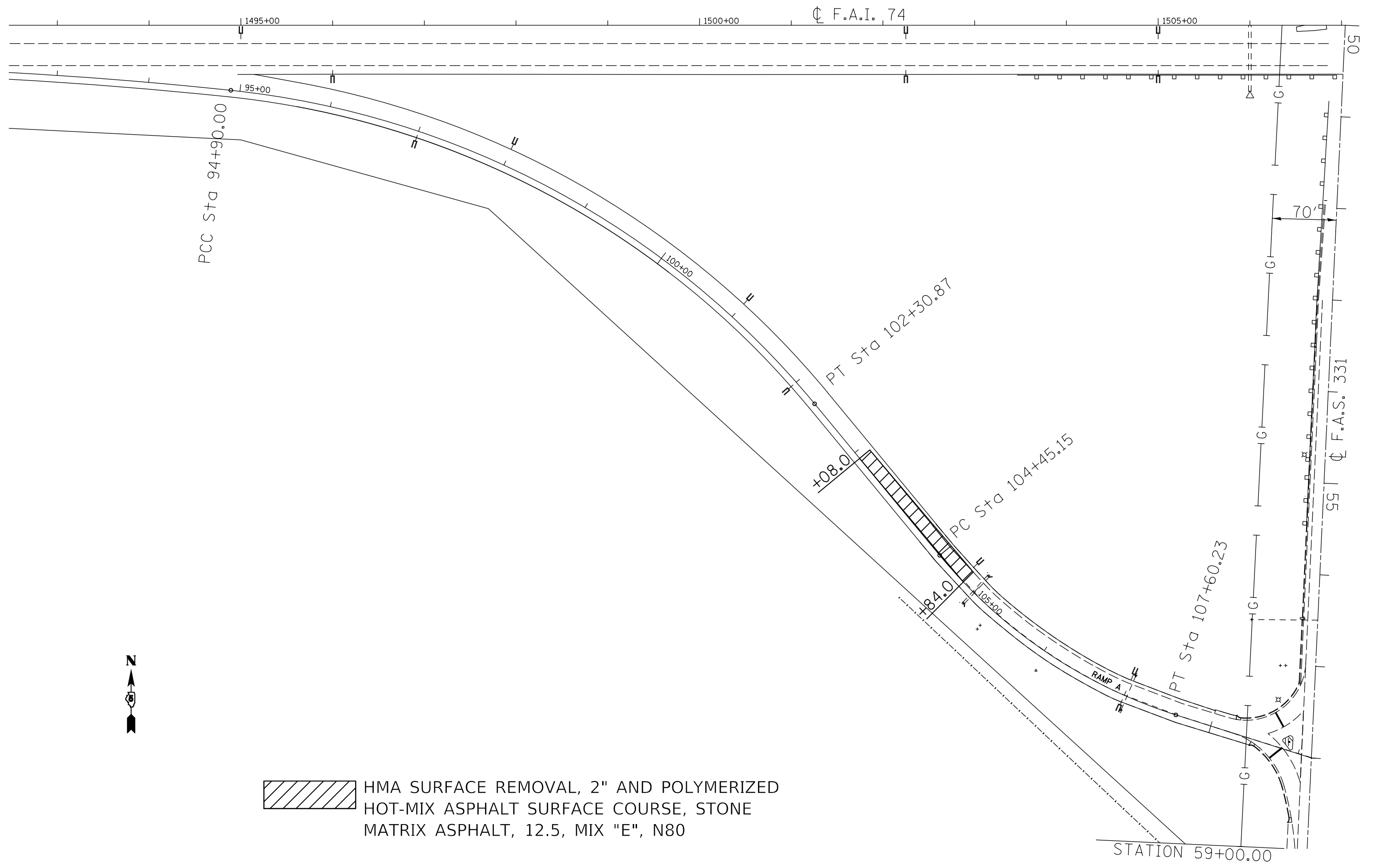

 HMA SURFACE REMOVAL, 2" AND POLYMERIZED
 HOT-MIX ASPHALT SURFACE COURSE, STONE
 MATRIX ASPHALT, 12.5, MIX "E", N80

** F.A.I. 57, F.A.I. 74 & F.A.S. 331

USER NAME = gosnellc1	DESIGNED -	REVISED -
	DRAWN -	REVISED -
PLOT SCALE = 100.0000' / in.	CHECKED -	REVISED -
PLOT DATE = 10/30/2019	DATE -	REVISED -

STATE OF ILLINOIS
DEPARTMENT OF TRANSPORTATION

RAMP DETAIL
I-74 & OAKWOOD RAMP A

SCALE: SHEET 8 OF 9 SHEETS STA. TO STA.

F.A. RTE.	SECTION	COUNTY	TOTAL SHEETS	SHEET NO.
VAR.	D5 CM INLAY 2020-2	-	34	23
			CONTRACT NO. 70E37	
		ILLINOIS	FED. AID PROJECT	

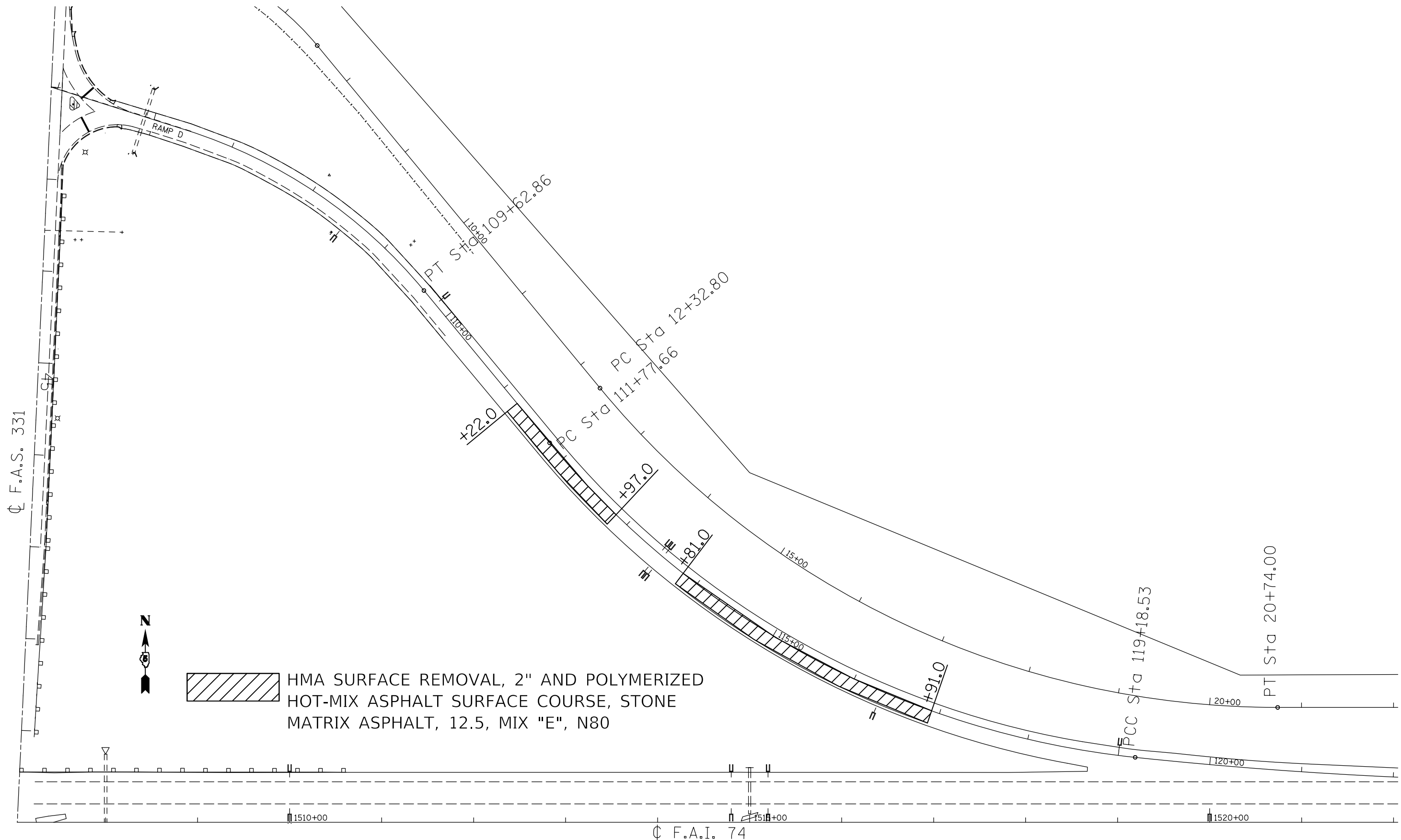

 HMA SURFACE REMOVAL, 2" AND POLYMERIZED HOT-MIX ASPHALT SURFACE COURSE, STONE MATRIX ASPHALT, 12.5, MIX "E", N80



MODEL: \\MODELNAME
 FILE: \\NAME.Plot
 \\path\name\state\illinois\gov\pwwdot\Documents\DOT - Offices\District 5\Projects\D570E37\CADD\DATA\CAD\PROJECTS\D570E37-CH-RAMP DETAIL.dgn

USER NAME = gosnellc1	DESIGNED -	REVISED -
	DRAWN -	REVISED -
PLOT SCALE = 100.0000' / in.	CHECKED -	REVISED -
PLOT DATE = 10/30/2019	DATE -	REVISED -

**STATE OF ILLINOIS
DEPARTMENT OF TRANSPORTATION**

RAMP DETAIL			
I-74 & OAKWOOD RAMP D			
SCALE:	SHEET 9	OF 9 SHEETS	STA. TO STA.

** F.A.I. 57, F.A.I. 74 & F.A.S. 331				
F.A. ** RTE.	SECTION	COUNTY	TOTAL SHEETS	SHEET NO.
VAR.	D5 CM INLAY 2020-2	-	34	24
				CONTRACT NO. 70E37

DETOUR SIGNING FOR RAMP I-AD

LEGEND

- DETOUR EAST INTERSTATE 74: M4-8 (24x12) (0), M3-4 (24x12) WHITE ON BLUE, M1-1 (24x24) WHITE ON BLUE
- ALL ARROW SIGNS (21x15) BLACK ON ORANGE
- END DETOUR: M4-8A (24x18) (0)

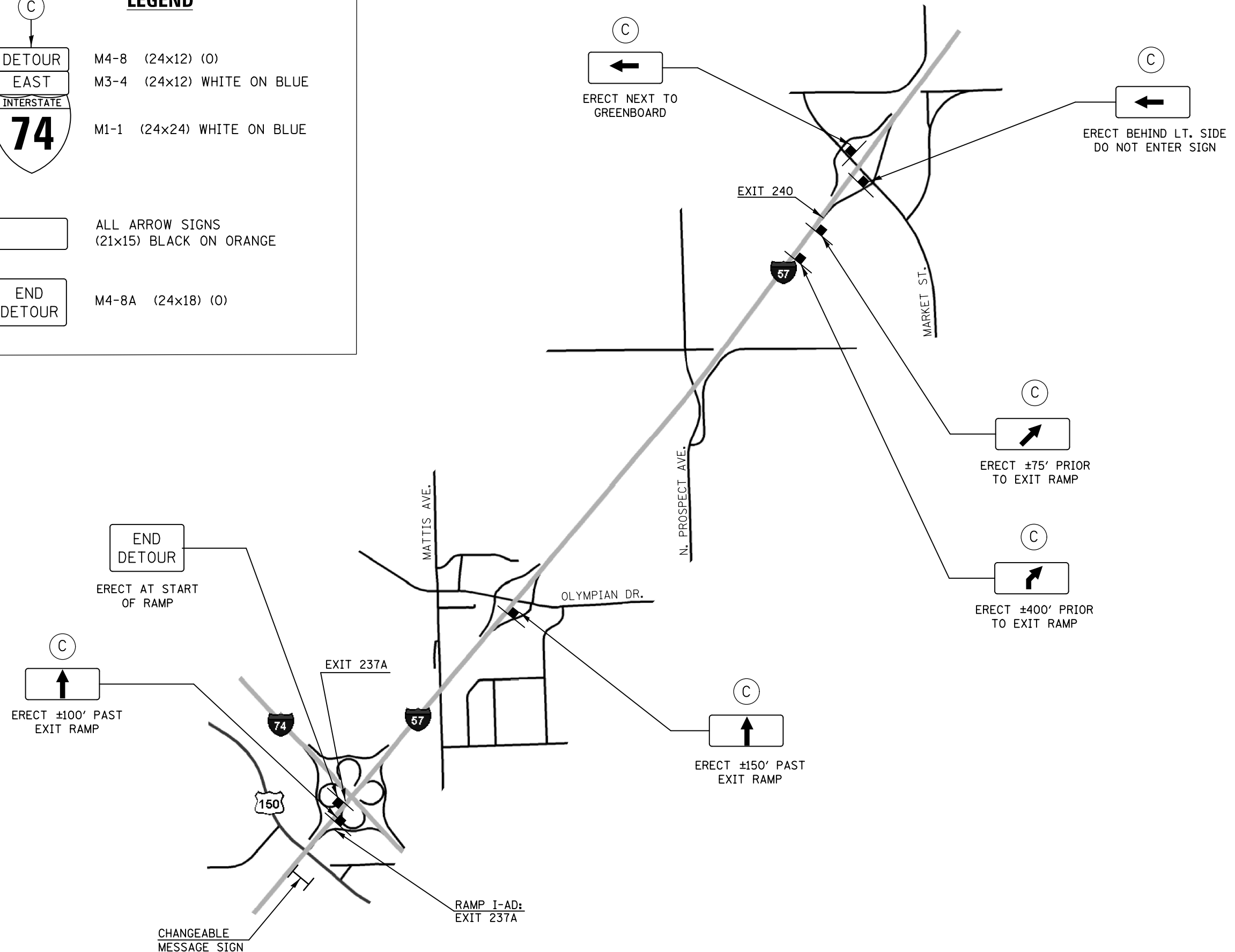

RAMP I-AD - EXIT 237A:
 TAKE I-57 NORTH TO EXIT 240,
 THEN COME BACK SOUTH ON I-57
 TO EXIT 237A.

MODEL: \\MODEL\MARF...
 FILE: MARF...
 PROJECT: 70E37...
 DATE: 10/30/2019

USER NAME = gnosnell	DESIGNED -	REVISED -
PLOT SCALE = 40,0000 ' / in.	DRAWN -	REVISED -
PLOT DATE = 10/30/2019	CHECKED -	REVISED -
	DATE -	REVISED -

**STATE OF ILLINOIS
 DEPARTMENT OF TRANSPORTATION**

DETOUR SIGNING I-57/I-74 RAMP I-AD			
SCALE:	SHEET 2	OF 3 SHEETS	STA. TO STA.

** F.A.I. 57, F.A.I. 74 & F.A.S. 331				
F.A. RTE.	SECTION	COUNTY	TOTAL SHEETS	SHEET NO.
VAR.	D5 CM INLAY 2020-2	-	34	26
CONTRACT NO. 70E37				
ILLINOIS FED. AID PROJECT				

DETOUR SIGNING FOR RAMP I-DA

LEGEND

(A) ↓
 DETOUR SOUTH INTERSTATE 57
 M4-8 (24x12) (0)
 M3-4 (24x12) WHITE ON BLUE
 M1-1 (24x24) WHITE ON BLUE

ALL ARROW SIGNS (21x15) BLACK ON ORANGE

END DETOUR M4-8A (24x18) (0)

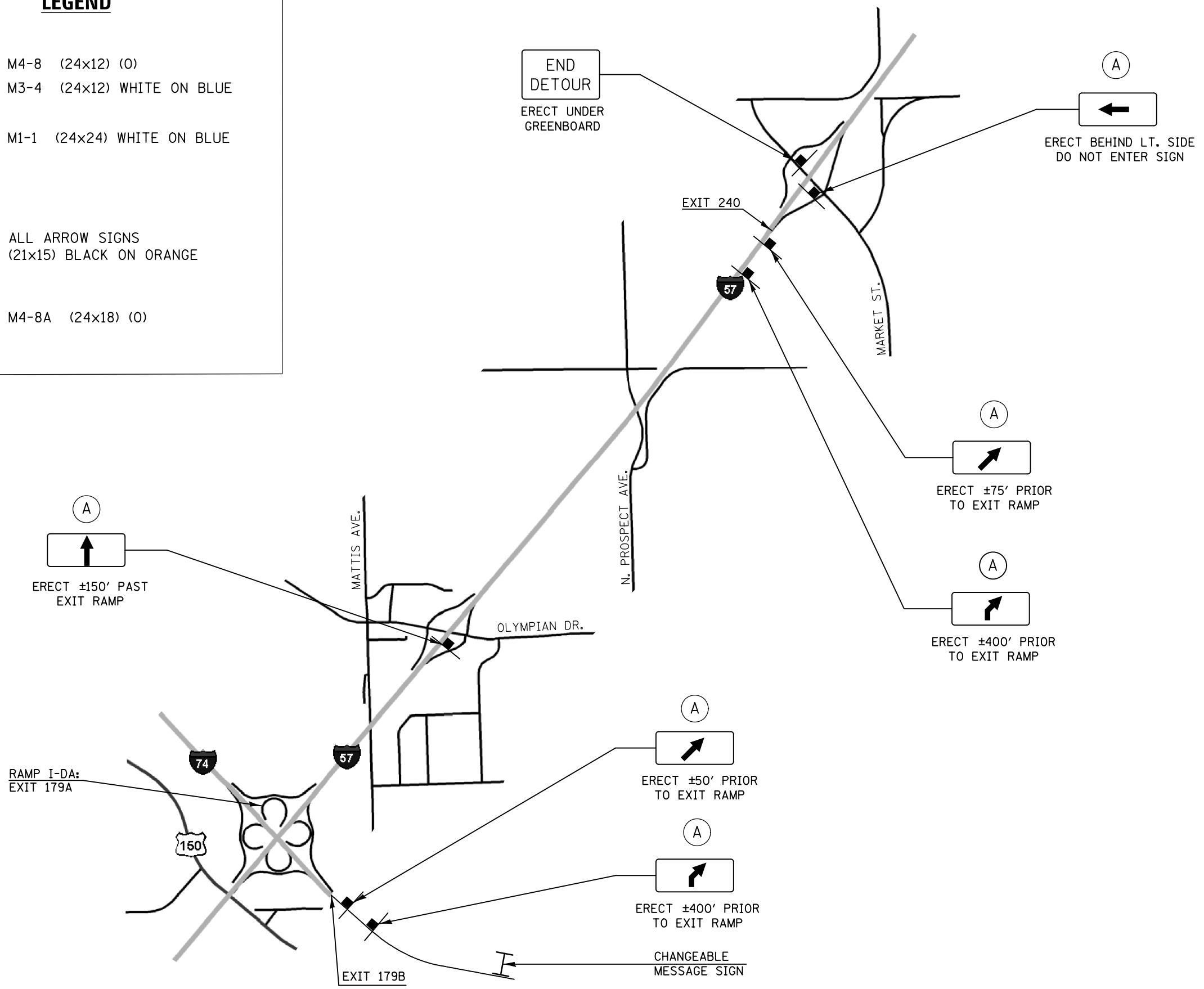

RAMP I-DA - EXIT 179A:
 TAKE I-74 WEST TO EXIT 179B AND GO NORTH ON I-57 TO EXIT 240, THEN COME BACK SOUTH ON I-57.

MODEL: \\MODEL\NAME: FILE: \\NAME: ... \Projects\DOT\Documents\DOT - Office\179A\179A-Detour.L57.dgn

USER NAME = gosnellc1	DESIGNED -	REVISED -
PLOT SCALE = 40.0000 ' / in.	DRAWN -	REVISED -
PLOT DATE = 10/30/2019	CHECKED -	REVISED -
	DATE -	REVISED -

**STATE OF ILLINOIS
 DEPARTMENT OF TRANSPORTATION**

DETOUR SIGNING I-57/I-74 RAMP I-DA			
SCALE:	SHEET 3	OF 3 SHEETS	STA. TO STA.

** F.A.I. 57, F.A.I. 74 & F.A.S. 331				
F.A. RTE.	SECTION	COUNTY	TOTAL SHEETS	SHEET NO.
VAR.	D5 CM INLAY 2020-2	-	34	27
CONTRACT NO. 70E37				

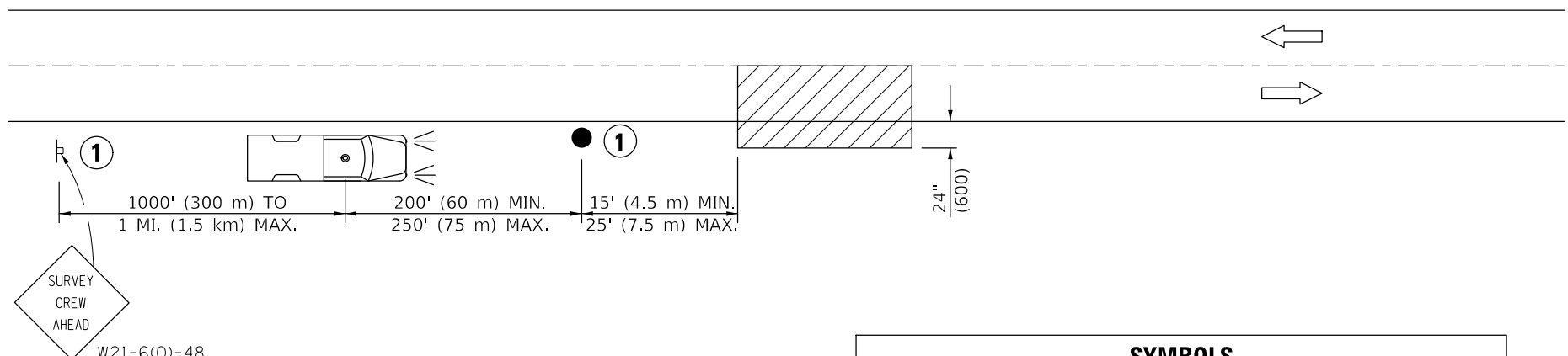

TYPICAL APPLICATIONS
UTILITY OPERATIONS

SYMBOLS	
	WORK AREA
	SIGN ON PORTABLE OR PERMANENT SUPPORT
	TRUCK WITH FLASHING AMBER LIGHT AND DUAL EMERGENCY FLASHERS
	FLAGGER WITH TRAFFIC CONTROL SIGN

1 NOT REQUIRED FOR WORK ACTIVITIES IN OR WITHIN 2' OF TRAVELED LANE IN ONE LOCATION FOR LESS THAN 15 MINUTES (BRIEF ENCROACHMENT).

Note: All dimensions are in INCHES (millimeters) unless otherwise shown.

DISTRICT 5 DETAIL NO. 70100000

MODEL: s:\MODEL\MAR18
FILE: MAR18 - 2019\Illinois\gpc\PROJECTS\DOT - Office\District 5\Projects\DOT-70E37-CH-District 5 Details.dgn

USER NAME = gosnellc1	DESIGNED -	REVISED - 11/06
	DRAWN -	REVISED -
PLOT SCALE = 40,0000 ' / in.	CHECKED -	REVISED -
PLOT DATE = 10/30/2019	DATE -	REVISED -

**STATE OF ILLINOIS
DEPARTMENT OF TRANSPORTATION**

NIGHT TIME INSPECTION OF ROADWAY LIGHTING

SCALE: SHEET 1 OF 1 SHEETS STA. TO STA.

F.A.** RTE.	SECTION	COUNTY	TOTAL SHEETS	SHEET NO.
VAR.	D5 CM INLAY 2020-2	-	34	28
CONTRACT NO. 70E37				

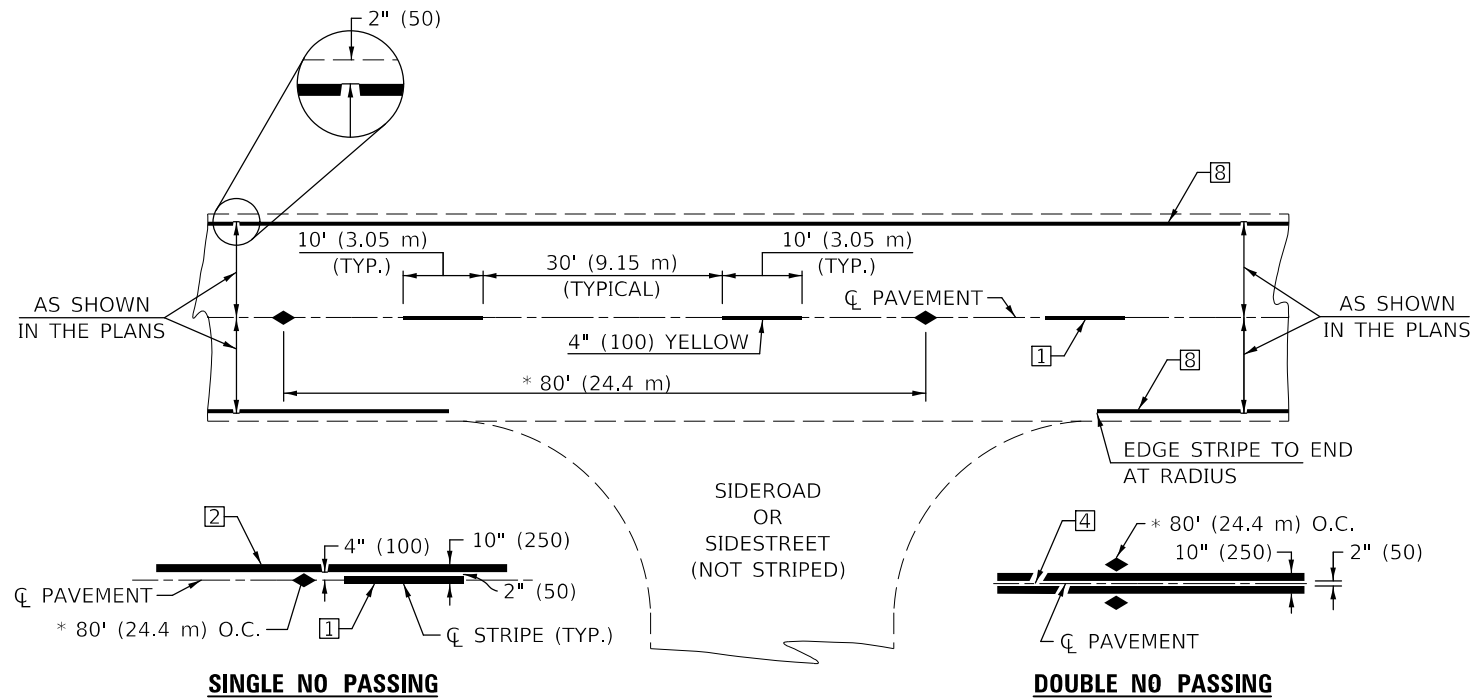

TWO LANE/TWO WAY

TYPICAL PAVEMENT MARKING LEGEND

- 1 4" (100) SKIP-DASH (YELLOW)
- 2 4" (100) SOLID (YELLOW)
- 3 12" (300) DIAGONAL (YELLOW)
- 4 4" (100) DOUBLE YELLOW (NARROW)
- 5 RESERVED
- 6 RESERVED
- 7 4" (100) SKIP-DASH (WHITE)
- 8 4" (100) SOLID (WHITE)
- 9 12" (300) DIAGONAL (WHITE)
- 10 6" (150) SOLID (WHITE)
- 11 24" (600) STOP BAR (WHITE)
- 12 8" (200) SOLID (WHITE)
- 13 4" (100) LANE LINE EXTENSIONS (WHITE)
- 14 4" (100) PARKING WHITE

TYPICAL PAVEMENT MARKERS LEGEND

- ◆ TWO-WAY AMBER MARKER
- ▶ ONE-WAY AMBER MARKER
- ▷ ONE-WAY CRYSTAL MARKER

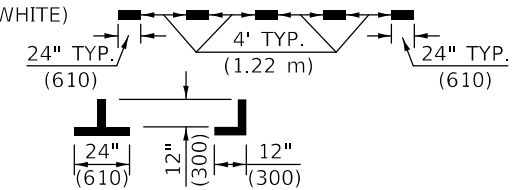
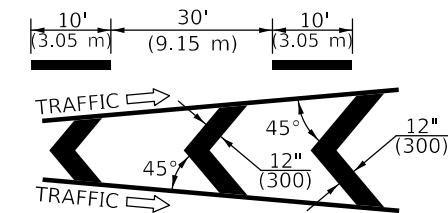
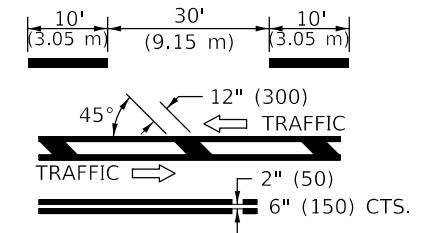

RURAL LEFT TURN

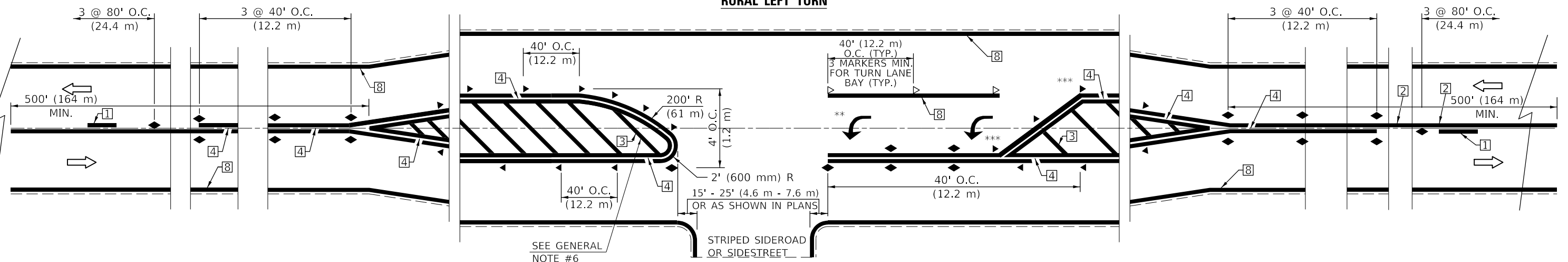

- *** REDUCE SPACING IF NECESSARY TO ASSURE MARKERS AT CORNER POINTS.
- ** TURN ARROWS SHALL BE PLACED AS SHOWN ON SHEET #2.

Note: All dimensions are in INCHES (millimeters) unless otherwise shown.

DISTRICT 5 DETAIL NO. 7800AAAA

USER NAME = gosnellc1	DESIGNED -	REVISED - 11/06
	DRAWN -	REVISED - 9/2009 KJT
PLOT SCALE = 40.0000 "/td> <td>CHECKED -</td> <td>REVISED - 04/14 JLA</td>	CHECKED -	REVISED - 04/14 JLA
PLOT DATE = 10/30/2019	DATE -	REVISED - 3/2019 SWN

**STATE OF ILLINOIS
DEPARTMENT OF TRANSPORTATION**

**PAVEMENT MARKING AND MARKERS
(RURAL & URBAN APPLICATIONS)**

SCALE: SHEET 1 OF 4 SHEETS STA. TO STA.

F.A. ** RTE.	SECTION	COUNTY	TOTAL SHEETS	SHEET NO.
VAR.	D5 CM INLAY 2020-2	-	34	30
CONTRACT NO. 70E37				

ILLINOIS FED. AID PROJECT CHAMPAIGN & VERMILION

** F.A.I. 57, F.A.I. 74 & F.A.S. 331

REV. 1/3/20

MODEL: \\MODEL\MARF... FILE: \\MARF... \Projects\70E37\CADD\Drawings\DOT Office\Detail\5-Pavement\70E37-PAV-Detail.dwg

MODEL: s:\MODEL\MAR15...
FILE: MAR15...
PROJECT: 0570E37...
OFFICE: DISTRICT 5...
DRAWN: JLA...
CHECKED: JLA...
DATE: 10/30/2019

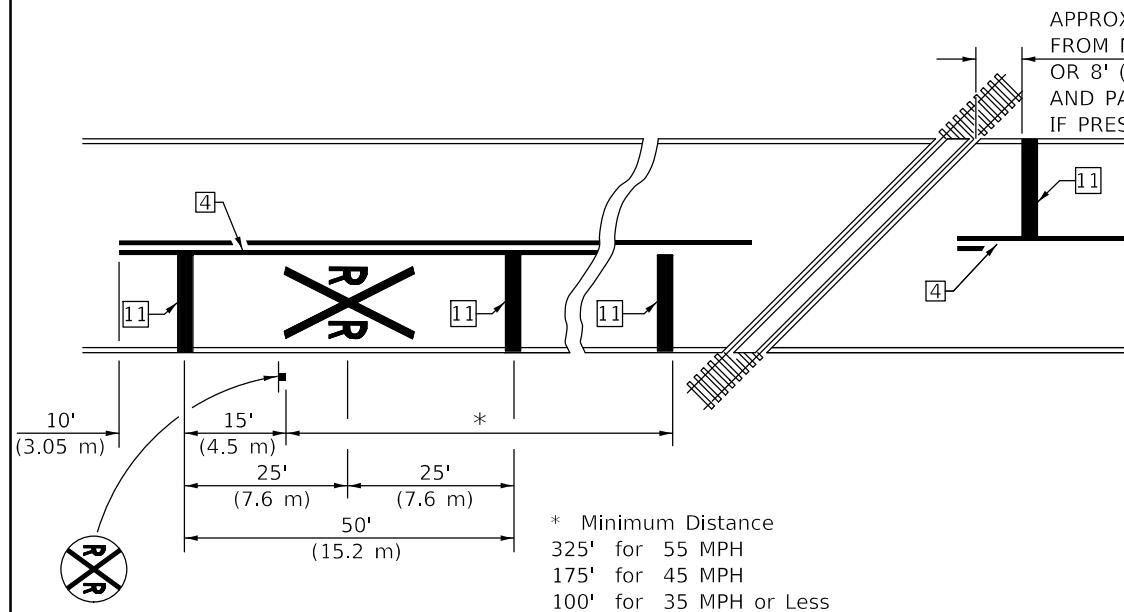

PAVEMENT MARKINGS AT RAILROAD-HIGHWAY GRADE CROSSING

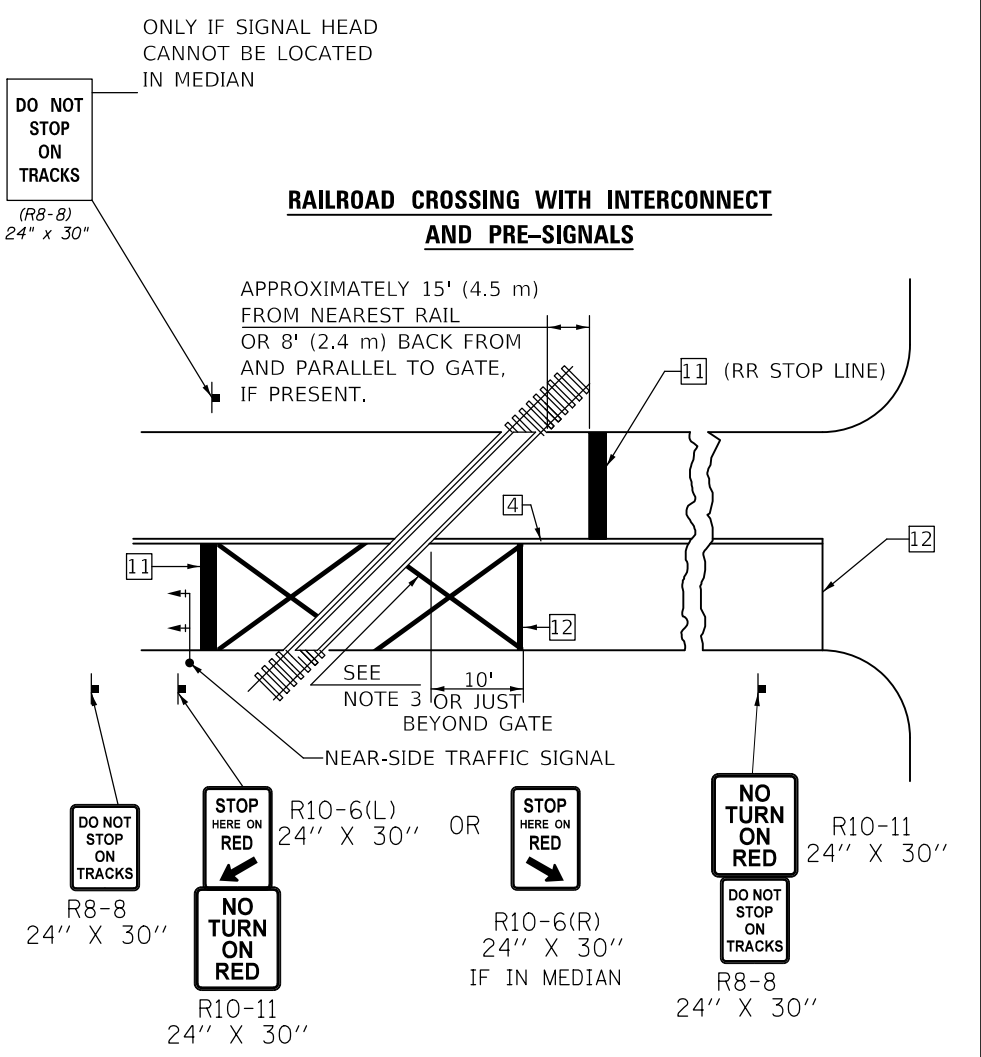
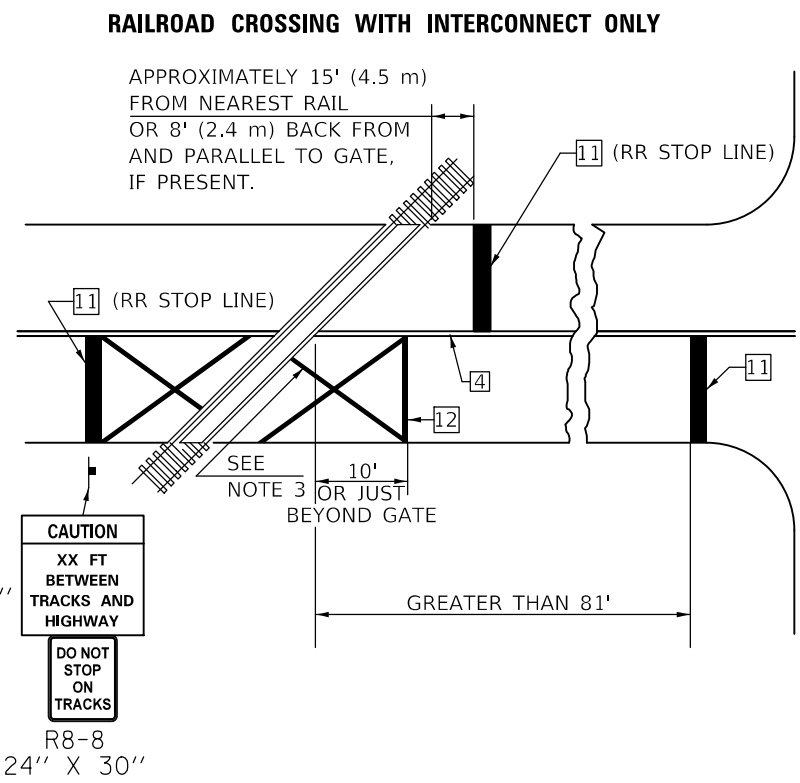

SUPPLEMENTAL PAVEMENT MARKING TREATMENT FOR RAILROAD-HIGHWAY GRADE CROSSING

ALTERNATE SIGNS

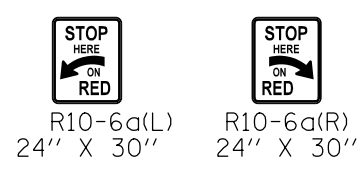

NOTES

- THE TRAVERSE SPREAD OF THE "X" MAY VARY ACCORDING TO LANE WIDTH.
- ON MULTI-LANE ROADS, THE STOP LINES SHALL EXTEND ACROSS ALL APPROACH LANES AND SEPARATE RXR SYMBOLS SHALL BE PLACED ADJACENT TO EACH OTHER IN EACH LANE.
- WHEN THE PAVEMENT MARKING SYMBOL IS USED, A PORTION OF THE SYMBOL SHOULD BE LOCATED DIRECTLY ADJACENT TO THE ADVANCE WARNING SIGN (W10-1) AS PLACED BY TABLE II-1, CONDITION B OF THE MUTCD.

GENERAL NOTES

- SUPPLEMENTAL PAVEMENT MARKINGS TO BE INSTALLED ONLY ON APPROACHES TO INTERSECTIONS CONTROLLED BY TRAFFIC SIGNALS WHICH ARE INTERCONNECTED WITH THE RAILROAD WARNING SIGNALS.
- EXTEND PAVEMENT MARKINGS TO THE INTERSECTION ONLY WHERE NEAR-SIDE TRAFFIC SIGNALS ARE USED.
- 6" WHITE PAVEMENT MARKINGS AT 45° TO PAVEMENT, 8' CENTER TO CENTER.
- XX DISTANCE TO BE SHOWN ON SIGN MEASURED FROM A POINT 6 FEET FROM THE RAIL CLOSEST TO THE INTERSECTION OR FROM THE CLOSEST POINT ALONG THE EXIT GATE IF PRESENT OVER THE ROADWAY WHEN IN THE LOWERED POSITION TO THE STOP BAR OR CROSSWALK, WHICH EVER IS CLOSEST, ROUNDED DOWN TO NEAREST 5 FEET. WHERE THERE IS NO STOP LINE, MEASURE TO POINT WHERE DRIVER HAS A VIEW OF APPROACHING TRAFFIC.
- THE CLEARANCE SIGN IS ALSO TO BE USED AS AN INTERIM MEASURE AT LOCATIONS WITH INTERCONNECTED INTERSECTION TRAFFIC SIGNALS WHERE IT IS PLANNED TO CHANGE THEM TO NEAR-SIDE SIGNALS AT A FUTURE TIME. IN THIS CASE, THE DISTANCE TO BE SHOWN ON THE SIGN IS MEASURED FROM THE EDGE OF THE STRIPED-OUT AREA INSTEAD OF 6 FEET FROM THE RAIL. THE SIGN IS TO BE REMOVED WHEN THE NEAR-SIDE SIGNALS ARE INSTALLED AND THE PAVEMENT MARKINGS EXTENDED TO THE INTERSECTION.

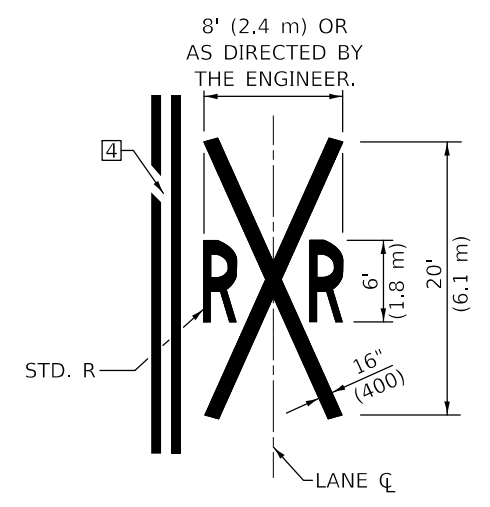

Note: All dimensions are in INCHES (millimeters) unless otherwise shown.

DISTRICT 5 DETAIL NO. 7800AAAA

USER NAME = goslntcl	DESIGNED -	REVISED - 11/06
	DRAWN -	REVISED - 9/2009 KJT
PLOT SCALE = 40.0000 ' / in.	CHECKED -	REVISED - 04/14 JLA
PLOT DATE = 10/30/2019	DATE -	REVISED - 3/2019 SWN

STATE OF ILLINOIS DEPARTMENT OF TRANSPORTATION

PAVEMENT MARKING AND MARKERS (RURAL & URBAN APPLICATIONS)

SCALE: SHEET 4 OF 4 SHEETS STA. TO STA.

F.A. ** RTE.	SECTION	COUNTY	TOTAL SHEETS	SHEET NO.
VAR.	D5 CM INLAY 2020-2	-	34	33
CONTRACT NO. 70E37				

CENTERLINE INTERSTATE OR MULTI-LANE TWO WAY DIVIDED HIGHWAY

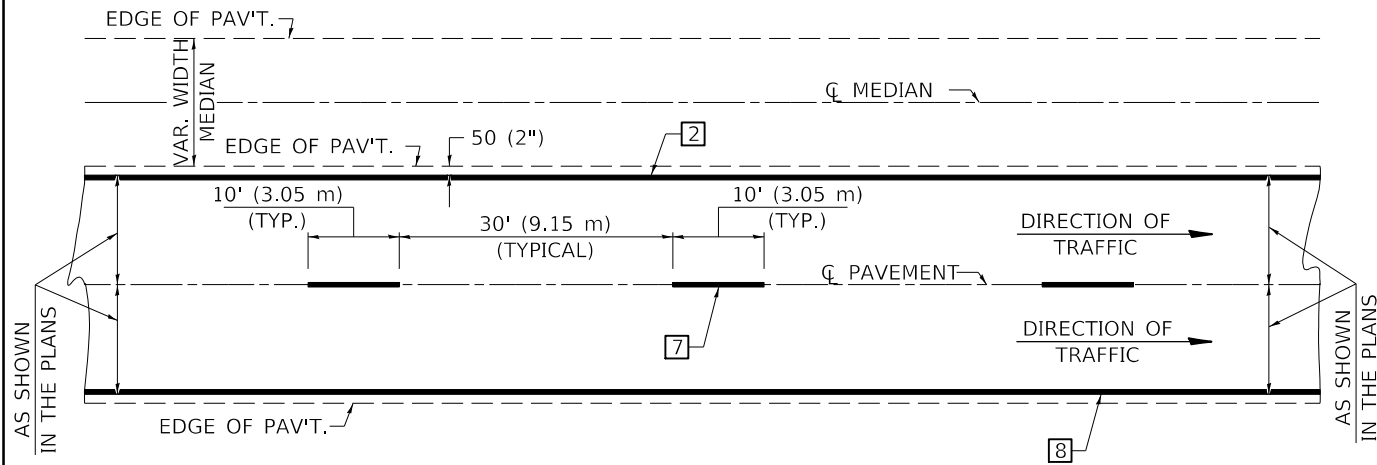

NOTE: PAVEMENT MARKINGS ARE TO BE EXTENDED THROUGH OMISSIONS WHEN APPLICABLE.

NOTE: SEE ARTICLES 780.04 & 781.03 FOR LOCATION OF STRIPES AND MARKERS RELATIVE TO EDGES OR JOINTS.

FOR RAISED REFLECTIVE PAVEMENT MARKERS, REFER TO STANDARD 781001.

TYPICAL PAVEMENT MARKING LEGEND

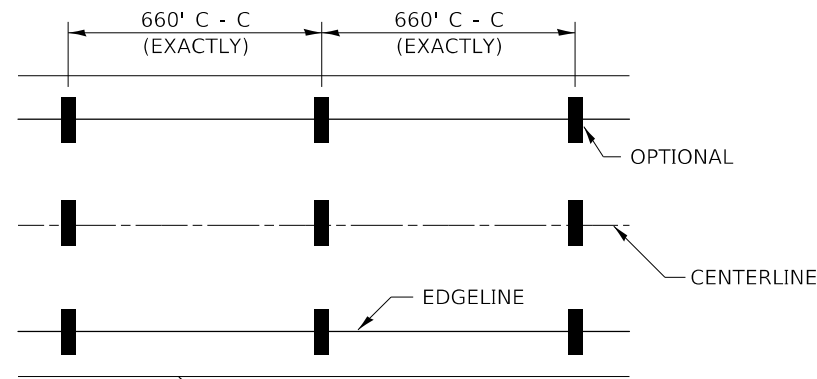

- 1 4" (100) SKIP-DASH (YELLOW)
- 2 4" (100) SOLID (YELLOW)
- 3 12" (300) DIAGONAL (YELLOW)
- 4 4" (100) DOUBLE YELLOW (NARROW)
- 5 RESERVED
- 6 RESERVED
- 7 4" (100) SKIP-DASH (WHITE)
- 8 4" (100) SOLID (WHITE)
- 9 12" (300) DIAGONAL (WHITE)
- 10 6" (150) SOLID (WHITE)
- 11 24" (600) STOP BAR (WHITE)
- 12 8" (200) SOLID (WHITE)
- 13 4" (100) LANE LINE EXTENSIONS (WHITE)

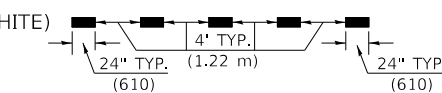
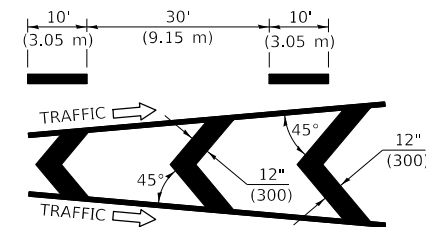
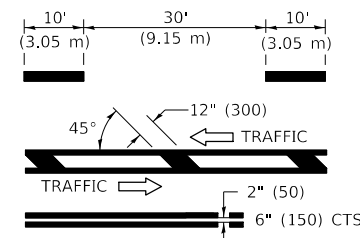

TYPICAL EXIT RAMP TERMINAL

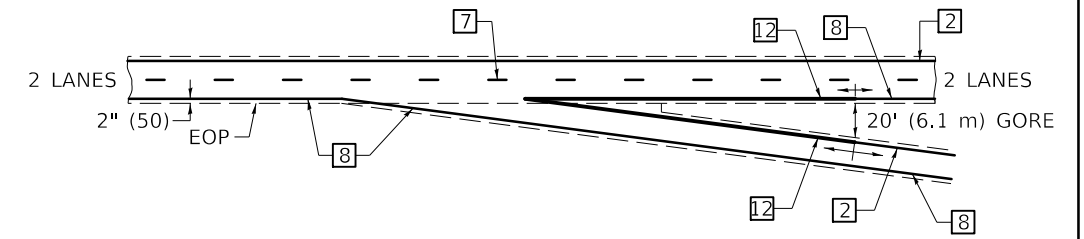

EXIT RAMP TERMINAL with EXCLUSIVE (auxiliary) LANE

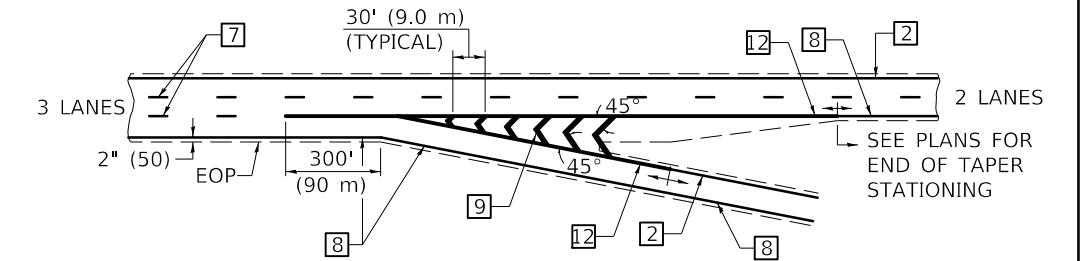

TYPICAL ENTRANCE RAMP TERMINAL

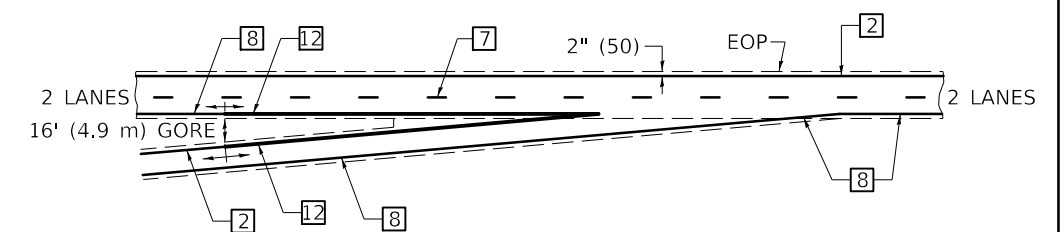

ENTRANCE RAMP TERMINAL with EXCLUSIVE LANE

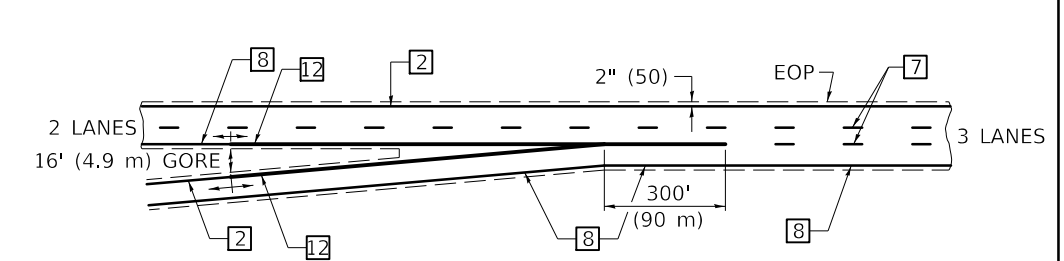

IT WILL BE NECESSARY TO HAVE A REPRESENTATIVE OF THE STATE POLICE PRESENT SO THAT THE ACCURACY OF MEASUREMENT CAN BE ATTESTED TO IN COURT.

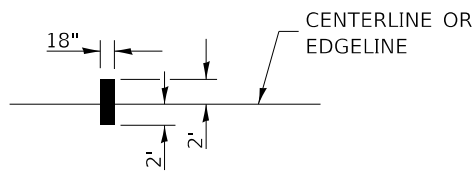

AERIAL SPEED CHECK ZONES

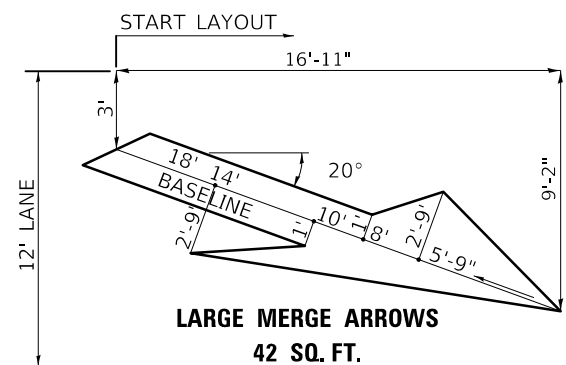

Note: All dimensions are in INCHES (millimeters) unless otherwise shown.

DISTRICT 5 DETAIL NO. 7800BBBB

USER NAME = gnosnellc1	DESIGNED -	REVISED - 11/06
PLOT SCALE = 40.0000 "/in.	DRAWN -	REVISED -
PLOT DATE = 10/30/2019	CHECKED -	REVISED -
	DATE -	REVISED -

**STATE OF ILLINOIS
DEPARTMENT OF TRANSPORTATION**

PAVEMENT MARKING (INTERSTATE & MULTI-LANE APPLICATIONS)

SCALE: SHEET 1 OF 1 SHEETS STA. TO STA.

F.A. ** RTE.	SECTION	COUNTY	TOTAL SHEETS	SHEET NO.
VAR.	D5 CM INLAY 2020-2	-	34	34
CONTRACT NO. 70E37				

ILLINOIS FED. AID PROJECT CHAMPAIGN & VERMILION