

106

01-17-2020 LETTING ITEM 106

STATE OF ILLINOIS
DEPARTMENT OF TRANSPORTATION

F.A.P. ROUTE	SECTION	COUNTY	TOTAL SHEETS	SHEET NO.
331/841	D9 BRIDGE REPAIR 2020-4	VARIOUS	21	1
		ILLINOIS	CONTRACT NO. 78738	

FOR INDEX OF SHEETS, SEE SHEET NO. 2

FOR SUMMARY OF QUANTITIES, SEE SHEETS NO. 4-5

PROPOSED HIGHWAY PLANS

F.A.P. ROUTE 331 & F.A.P. 841 (IL 13 & IL 154)
SECTION D9 BRIDGE REPAIR 2020-4
PROJECT STP-WDDJ(631)
BRIDGE REPAIRS
VARIOUS COUNTIES

C-99-077-19

IMPROVEMENT LOCATION
PERRY COUNTY
STRUCTURE 073-0035 (E)
IL 154 OVER HOG CREEK

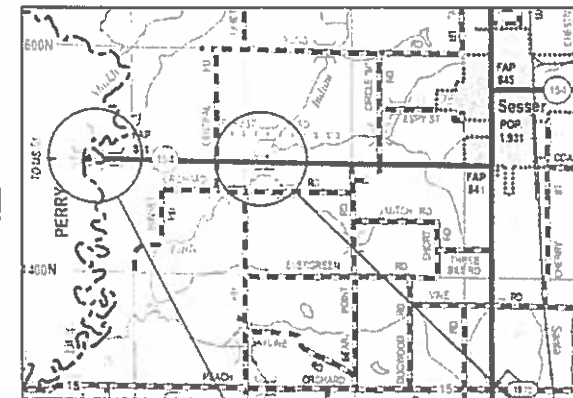
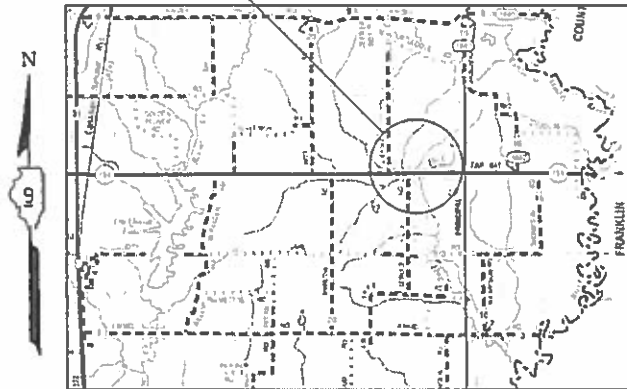

IMPROVEMENT LOCATION
FRANKLIN COUNTY
STRUCTURE 028-0071 (E)
IL 154 OVER LITTLE INDIAN CREEK

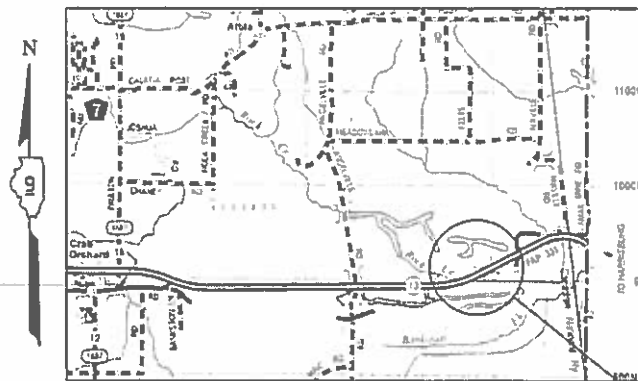

IMPROVEMENT LOCATION
FRANKLIN COUNTY
STRUCTURE 028-0068 (E)
IL 154 OVER LITTLE MUDDY RIVER
STRUCTURE 028-0072 (E)
IL 154 OVER LITTLE MUDDY RIVER OVERFLOW

IMPROVEMENT LOCATION
WILLIAMSON COUNTY
STRUCTURES 100-0068(71) (E)
IL 13 OVER BANKSTON FORK

J.U.L.I.E.
JOINT UTILITY LOCATION INFORMATION FOR EXCAVATORS
1-800-892-0123
OR 811

PROJECT ENGINEER: DAVID PICHE
DESIGN ENGINEER: ADRIAN ADAMS

CONTRACT NO. 78738

GROSS LENGTH = 676.70 FT. = 0.128 MILE
NET LENGTH = 676.70 FT. = 0.128 MILE

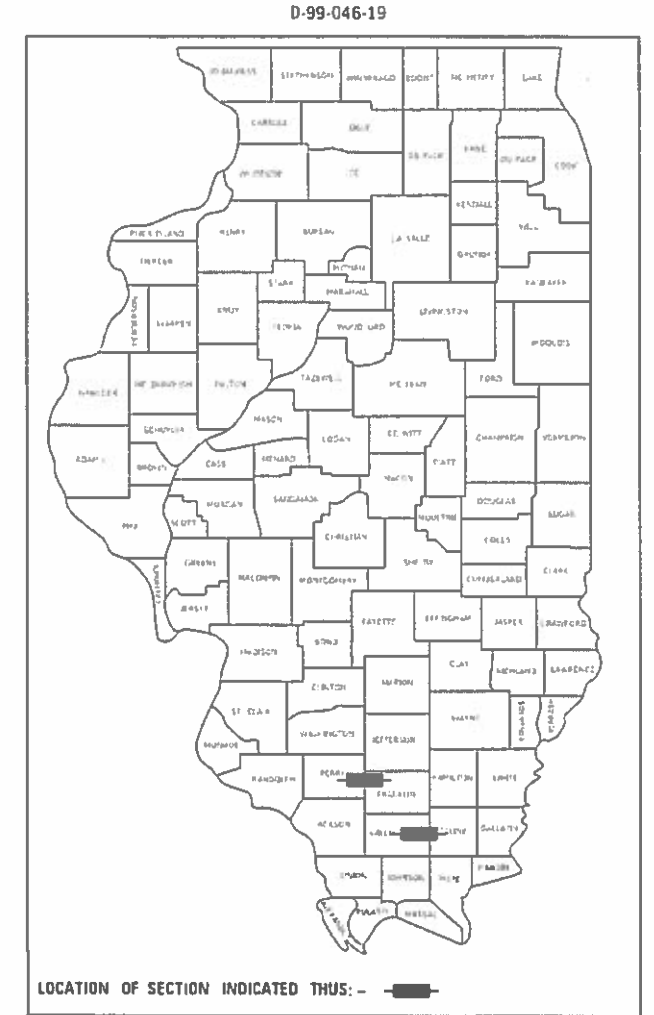

STATE OF ILLINOIS
DEPARTMENT OF TRANSPORTATION
SUBMITTED 10-13-2019
REGION FIVE ENGINEER
ENGINEER OF DESIGN AND ENVIRONMENT
DIRECTOR OF HIGHWAYS PROJECT IMPLEMENTATION

PRINTED BY THE AUTHORITY
OF THE STATE OF ILLINOIS

REV. - MS

INDEX OF SHEETS

1	COVER SHEET
2	GENERAL NOTES, INDEX OF SHEETS, AND STANDARDS
3	SIGNATURE SHEET
4-5	SUMMARY OF QUANTITIES
6	SCHEDULES
7	GENERAL PLAN AND ELEVATION SN 028-0068
8	STAGING DETAILS SN 028-0068
9	PARTIAL DEPTH DECK SLAB REPAIRS SN 028-0068
10	GENERAL PLAN AND ELEVATION SN 028-0071
11	STAGING DETAILS SN 028-0071
12	PARTIAL DEPTCH DECK SLAB REPAIRS SN 028-0071
13	GENERAL PLAN AND ELEVATION SN 028-0072
14	STAGING DETAILS SN 028-0072
15	PARTIAL DEPTH DECK SLAB REPAIRS SN 028-0072
16	GENERAL PLAN AND ELEVATION SN 073-0035
17	STAGING DETAILS SN 073-0035
18	PARTIAL DEPTH APPROACH SLAB REPAIRS SN 073-0035
19	GENERAL PLAN AND ELEVATION SN 100-0068(71)
20	STAGING DETAILS SN 100-0068(71)
21	PARTIAL DEPTH APPROACH PATCH SLAB REPAIRS SN 100-0068(71)

STANDARDS

000001-07	STANDARD SYMBOLS, ABBREVIATIONS AND PATTERNS
001006	DECIMAL OF AN INCH AND OF A FOOT
701001-02	OFF-RD OPERATIONS, 2L, 2W, MORE THAN 15' AWAY
701011-04	OFF-RD MOVING OPERATIONS, 2L, 2W, DAY ONLY
701101-05	OFF-RD MOVING OPERATIONS, MULTILANE, 15' TO 24" FROM PAVEMENT EDGE
701106-02	OFF-RD MOVING OPERATIONS, MULTILANE, MORE THAN 15' AWAY
701201-05	LANE CLOSURE, 2L, 2W, DAY ONLY, FOR SPEEDS \geq 45 MPH
701301-04	LANE CLOSURE, 2L, 2W, SHORT TIME OPERATIONS
701311-03	LANE CLOSURE, 2L, 2W, MOVING OPERATIONS - DAY ONLY
701316-13	LANE CLOSURE, 2L, 2W, BRIDGE REPAIR, FOR SPEEDS \geq 45 MPH
701421-08	LANE CLOSURE, MULTILANE, DAY OPERATIONS ONLY, FOR SPEEDS \geq 45 MPH TO 55 MPH
701426-09	LANE CLOSURE, MULTILANE, INTERMITTENT OR MOVING OPER., FOR SPEEDS \geq 45 MPH
701901-08	TRAFFIC CONTROL DEVICES
780001-05	TYPICAL PAVEMENT MARKINGS
862001-01	UNINTERRUPTIBLE POWER SUPPLY

GENERAL NOTES

- 1) THE THICKNESS OF HOT-MIX ASPHALT MIXTURE SHOWN ON THE PLANS IS THE NOMINAL THICKNESS. DEVIATIONS FROM THE NOMINAL THICKNESS WILL BE PERMITTED WHEN SUCH DEVIATIONS OCCUR DUE TO IRREGULARITIES IN THE EXISTING SURFACE OR BASE ON WHICH THE HOT-MIX ASPHALT MIXTURE IS PLACED.
- 2) PRIOR TO PLACEMENT OF FINAL PAVEMENT MARKINGS THE RESIDENT ENGINEER SHALL CONTACT THE BUREAU OF OPERATIONS AND ARRANGE FOR INSPECTION AND APPROVAL OF THE PAVEMENT MARKING LAYOUT.
- 3) THERE ARE NO AVAILABLE WASTE SITES ON THE EXISTING RIGHT OF WAY WITHIN THE PROJECT LIMITS. DISPOSAL WILL BE THE RESPONSIBILITY OF THE CONTRACTOR AND WASTE MUST BE DISPOSED OF IN ACCORDANCE WITH ARTICLE 202.03 OF THE STANDARD SPECIFICATIONS.

COMMITMENTS

NONE

STATE OF ILLINOIS
DEPARTMENT OF TRANSPORTATION

GENERAL NOTES, INDEX OF SHEETS,
AND STANDARDS

SCALE: SHEET OF SHEETS STA. TO STA.

F.A.P. RTE.	SECTION	COUNTY	TOTAL SHEETS	SHEET NO.
*	D9 BRIDGE REPAIR 2020-4	VARIOUS	21	2
* 331/841			CONTRACT NO. 78738	
		ILLINOIS	FED. AID PROJECT	

MODE: D:\evr\...
 FILE NAME: ...
 USER: ...

Prepared By: Charles Stein
 DISTRICT STUDIES & PLANS ENGINEER

Examined By: Nancy Stein
 DISTRICT LAND ACQUISITION ENGINEER

Examined By: _____
 DISTRICT PROGRAM DEVELOPMENT ENGINEER

Examined By: Kelley
 DISTRICT OPERATIONS ENGINEER

Examined By: [Signature]
 DISTRICT PROJECT IMPLEMENTATION ENGINEER

Examined By: Douglas [Signature]
 DISTRICT CONSTRUCTION ENGINEER

Examined By: [Signature]
 DISTRICT MATERIALS ENGINEER

USER NAME = gdamian	DESIGNED - _____	REVISED - _____
	DRAWN - _____	REVISED - _____
PLOT SCALE = 100.0000' / in.	CHECKED - _____	REVISED - _____
PLOT DATE = 9/26/2019	DATE = _____	REVISED - _____

**STATE OF ILLINOIS
 DEPARTMENT OF TRANSPORTATION**

SIGNATURE SHEET
 SCALE: _____ SHEET ___ OF ___ SHEETS STA. _____ TO STA. _____

F.A.P. RTE.	SECTION	COUNTY	TOTAL SHEETS	SHEET NO.
*	D9 BRIDGE REPAIR 2020-4	VARIOUS	21	3
* 331/841			CONTRACT NO. 78738	
ILLINOIS FED. AID PROJECT				

VARIOUS COUNTIES
0013

SUMMARY OF QUANTITIES

			COUNTY:	FRANKLIN			PERRY	WILLIAMSON	
			ROUTE:	IL 154			IL 154	IL 13	
			FUNDING:	STP 80% FEDERAL 20% STATE	STP 80% FEDERAL 20% STATE	STP 80% FEDERAL 20% STATE	STP 80% FEDERAL 20% STATE	NHPP 80% FEDERAL 20% STATE	NHPP 80% FEDERAL 20% STATE
			LOCATION:	RURAL	RURAL	RURAL	RURAL	RURAL	RURAL
CODE NUMBER	ITEM DESCRIPTION	UNIT	TOTAL QUANTITY	028-0068	028-0071	028-0072	073-0035	100-0068	100-0071
				0013	0013	0013	0013	0013	0013
67100100	MOBILIZATION	L SUM	1	0.17	0.17	0.17	0.17	0.16	0.16
70100100	TRAFFIC CONTROL AND PROTECTION, STANDARD 701316	EACH	4	1	1	1	1		
70100310	TRAFFIC CONTROL AND PROTECTION, STANDARD 701421	LSUM	1					0.50	0.50
70100450	TRAFFIC CONTROL AND PROTECTION, STANDARD 701201	LSUM	1	0.25	0.25	0.25	0.25		
70106500	TEMPORARY BRIDGE TRAFFIC SIGNALS	EACH	4	1	1	1	1		
70106700	TEMPORARY RUMBLE STRIPS	EACH	24	6	6	6	6		
70107025	CHANGEABLE MESSAGE SIGN	CAL DA	140	28	28	28	28	14	14
70300100	SHORT TERM PAVEMENT MARKING	FOOT	56	12	8	8	12	8	8
70300150	SHORT TERM PAVEMENT MARKING REMOVAL	SQ FT	20	4	3	3	4	3	3
* 78001110	PAINT PAVEMENT MARKING - LINE 4''	FOOT	1656	390	174	166	250	338	338
78300200	RAISED REFLECTIVE PAVEMENT MARKER REMOVAL	EACH	4	1	1		2		
* 86200300	UNINTERRUPTIBLE POWER SUPPLY, EXTENDED	EACH	4	1	1	1	1		

* SPECIALTY ITEM

REV. - MS

MODEL: Default
FILE NAME: P:\uplanroom.dat\illinois.gov\PROJECTS\DOT\Office\District 9\Projects\78738\CADDData\CAD\Sheets\DS-78738-Sheets.dgn

USER NAME = adamsam	DESIGNED -	REVISED -
	DRAWN -	REVISED -
PLOT SCALE = 100.0000' / in.	CHECKED -	REVISED -
PLOT DATE = 10/18/2019	DATE -	REVISED -

STATE OF ILLINOIS
DEPARTMENT OF TRANSPORTATION

SUMMARY OF QUANTITIES

SCALE: SHEET OF SHEETS STA. TO STA.

F.A.P. RTE.	SECTION	COUNTY	TOTAL SHEETS	SHEET NO.
* D9 BRIDGE REPAIR 2020-4		VARIOUS	21	4
* 331/841		CONTRACT NO. 78738		
		ILLINOIS	FED. AID PROJECT	

VARIOUS COUNTIES
0013

SUMMARY OF QUANTITIES CONT'D				COUNTY:	FRANKLIN			PERRY	WILLIAMSON	
				ROUTE:	IL 154			IL 154	IL 13	
				FUNDING:	STP 80% FEDERAL 20% STATE	STP 80% FEDERAL 20% STATE	STP 80% FEDERAL 20% STATE	STP 80% FEDERAL 20% STATE	NHPP 80% FEDERAL 20% STATE	NHPP 80% FEDERAL 20% STATE
				LOCATION:	RURAL	RURAL	RURAL	RURAL	RURAL	RURAL
CODE NUMBER	ITEM DESCRIPTION	UNIT	TOTAL QUANTITY	028-0068	028-0071	028-0072	073-0035	100-0068	100-0071	
				0013	0013	0013	0013	0013	0013	
X0325747	BRIDGE DECK CONCRETE CRACK SEALER	FOOT	2600	625	650	250	850	100	125	
X0327980	PAVEMENT MARKING REMOVAL - WATER BLASTING	SQ FT	554	130	58	56	84	113	113	
Z0001800	APPROACH SLAB REPAIR (PARTIAL DEPTH)	SQ YD	13		4	3	2	2	2	
Z0012102	CONCRETE BRIDGE DECK SCARIFICATION 3/8 INCH	SQ YD	2697	427	274	260	414	661	661	
Z0012193	BRIDGE DECK THIN POLYMER OVERLAY 3/8''	SQ YD	2697	427	274	260	414	661	661	
Z0016200	DECK SLAB REPAIR (PARTIAL)	SQ YD	5	1	2	2				

MODEL: Default
FILE: \\nrcs-pub\pubroom\data\illinois.gov\PWIDOT\Documents\DOT_Offices\District_9\Projects\78738\CAAD\Bids\CAAD\Bids\78738-Sheets.dgn

USER NAME = adamsam	DESIGNED -	REVISED -
	DRAWN -	REVISED -
PLOT SCALE = 100.0000' / in.	CHECKED -	REVISED -
PLOT DATE = 10/18/2019	DATE -	REVISED -

**STATE OF ILLINOIS
DEPARTMENT OF TRANSPORTATION**

SUMMARY OF QUANTITIES

SCALE: SHEET OF SHEETS STA. TO STA.

F.A.P. RTE.	SECTION	COUNTY	TOTAL SHEETS	SHEET NO.
*	D9 BRIDGE REPAIR 2020-4	VARIOUS	21	5
* 331/841			CONTRACT NO. 78738	
ILLINOIS FED. AID PROJECT				

PAVEMENT MARKING SCHEDULE											
STATION				NOTES				PAINT PAVEMENT MARKING - LINE 4''			S-T PAVT MARKING
								SOLID WHITE	WHITE SKIP DASH	SOLID YELLOW	WHITE SKIP DASH
								FOOT	FOOT	FOOT	FOOT
SN 028-0068											
343+50.00	RT	TO	344+70.00	RT				120			
343+50.00			344+70.00		ALONG CENTERLINE				30	120	12
343+50.00	LT	TO	344+70.00	LT				120			
SN 028-0071											
431+87.50	RT	TO	432+64.50	RT				77			
431+87.50			432+64.50		ALONG CENTERLINE				20		8
431+87.50	LT	TO	432+64.50	LT				77			
SN 028-0072											
353+55.50	RT	TO	354+28.50	RT				73			
353+55.50			354+28.50		ALONG CENTERLINE				20		8
353+55.50	LT	TO	354+28.50	LT				73			
SN 073-0035											
231+63.25	RT	TO	232+72.75	RT				110			
231+63.25			232+72.75		ALONG CENTERLINE				30		12
231+63.25	LT	TO	232+72.75	LT				110			
SN 100-0068											
477+37.87	RT	TO	478+86.52	RT				149			
477+37.87			478+86.52		ALONG CENTERLINE				40		8
477+37.87	LT	TO	478+86.52	LT				149			
SN 100-0071											
477+66.74	RT	TO	479+15.39	RT				149			
477+66.74			479+15.39		ALONG CENTERLINE				40		8
477+66.74	LT	TO	479+15.39	LT				149			
SUBTOTAL								1356	180	120	56
TOTAL									1656		56

OVERLAY SCHEDULE									
STATION				NOTES				BRIDGE DECK SCARIFICATION, 3/8'' (SQ YD)	BRIDGE DECK THIN POLYMER OVERLAY, 3/8'' (SQ YD)
343+50.00	RT	TO	344+70.00	RT				214	214
343+50.00			344+70.00		ALONG CENTERLINE				
343+50.00	LT	TO	344+70.00	LT				214	214
SN 028-0071									
431+87.50	RT	TO	432+64.50	RT				137	137
431+87.50			432+64.50		ALONG CENTERLINE				
431+87.50	LT	TO	432+64.50	LT				137	137
SN 028-0072									
353+55.50	RT	TO	354+28.50	RT				130	130
353+55.50			354+28.50		ALONG CENTERLINE				
353+55.50	LT	TO	354+28.50	LT				130	130
SN 073-0035									
231+63.25	RT	TO	232+72.75	RT				219	219
231+63.25			232+72.75		ALONG CENTERLINE				
231+63.25	LT	TO	232+72.75	LT				195	195
SN 100-0068									
477+37.87	RT	TO	478+86.52	RT				331	331
477+37.87			478+86.52		ALONG CENTERLINE				
477+37.87	LT	TO	478+86.52	LT				331	331
SN 100-0071									
477+66.74	RT	TO	479+15.39	RT				364	364
477+66.74			479+15.39		ALONG CENTERLINE				
477+66.74	LT	TO	479+15.39	LT				298	298
TOTAL								2700	2700

MODEL: Default
 FILE: \\blm1c1.pw.uspbarn.com\data\illinois.gov\PWIDOT\Documents\DOT_Offices\Illinet\9\Projects\78738\CADD\data\CAD\Sheet\09-78738-Sheets.dgn

USER NAME = adamsm	DESIGNED -	REVISED -
	DRAWN -	REVISED -
PLOT SCALE = 100.0000' / in.	CHECKED -	REVISED -
PLOT DATE = 10/18/2019	DATE -	REVISED -

STATE OF ILLINOIS
DEPARTMENT OF TRANSPORTATION

SCHEDULES			
SCALE:	SHEET	OF	SHEETS
	STA.	TO	STA.

F.A.P. RTE.	SECTION	COUNTY	TOTAL SHEETS	SHEET NO.
*	D9 BRIDGE REPAIR 2020-4	VARIOUS	21	6
* 331/841			CONTRACT NO. 78738	
ILLINOIS		FED. AID PROJECT		

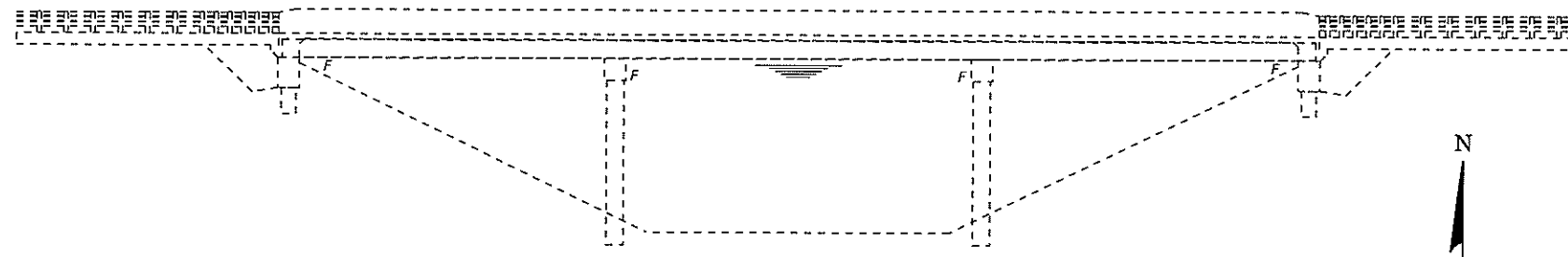

ELEVATION

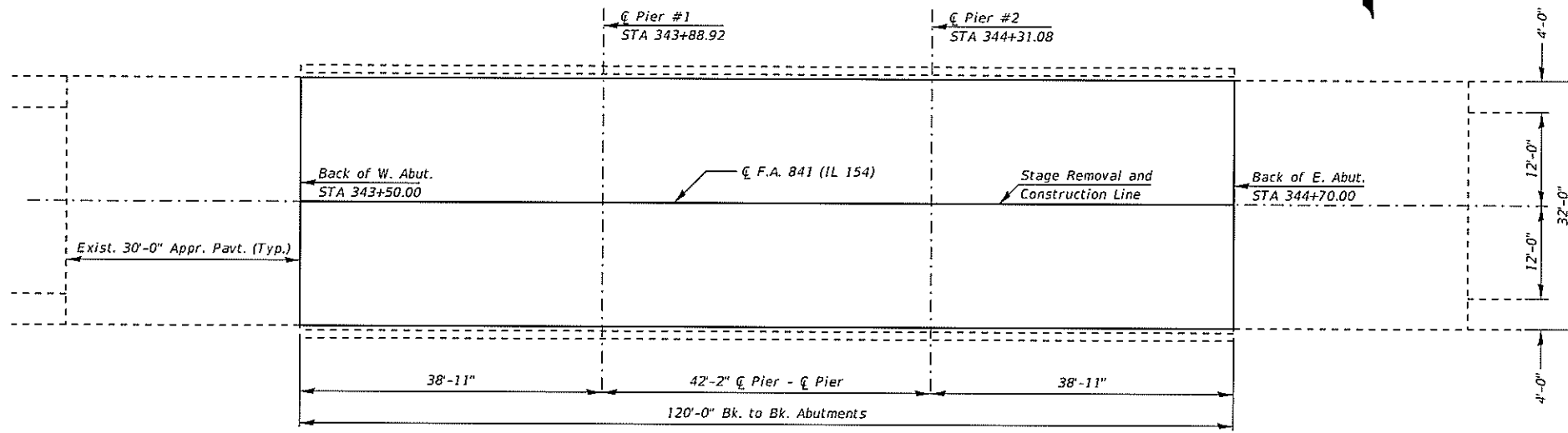

PLAN

GENERAL NOTES

Plan dimensions and details relative to existing plans are subject to nominal construction variations. The Contractor shall field verify existing dimensions and details affecting new construction and make necessary approved adjustments prior to construction or ordering of materials. Such variations shall not be cause for additional compensation for a change in scope of the work, however, the Contractor will be paid for the quantity actually furnished at the unit price bid for the work.

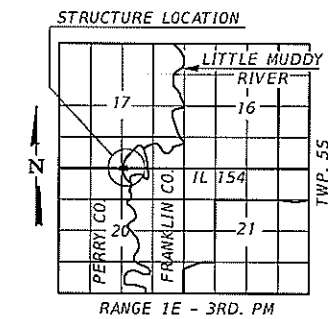

LOCATION PLAN

TOTAL BILL OF MATERIAL

ITEM	UNIT	QUANTITY
Bridge Deck Concrete Crack Sealer	Foot	625
Concrete Bridge Deck Scarification, 3/8"	Sq. Yd.	427
Bridge Deck Thin Polymer Overlay, 3/8"	Sq. Yd.	427
Deck Slab Repair (Partial)	Sq. Yd.	1

**BRIDGE DECK POLYMER OVERLAY
 IL 154 OVER LITTLE MUDDY RIVER
 F.A.P. RTE 841 - D9 BRIDGE REPAIR 2020-4
 FRANKLIN COUNTY
 STATION 344+10
 STRUCTURE NO. 028-0068**

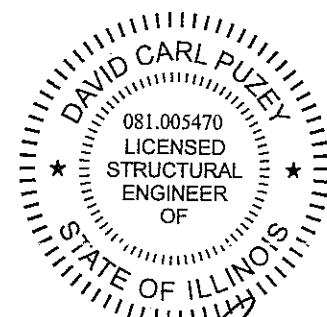

David Carl Puzey 11/26/19
 Expires 11/30/20

MODEL: Default
 FILE NAME: s:\projects\2020\2020-4\028-0068\028-0068.dwg
 PLOT DATE: 10/18/2019

USER NAME = adamsam	DESIGNED - <i>AHA</i>	REVISD -
PLOT SCALE = 20.0000' / in.	DRAWN - <i>DSP</i>	REVISD -
PLOT DATE = 10/18/2019	CHECKED -	REVISD -
	DATE -	REVISD -

**STATE OF ILLINOIS
 DEPARTMENT OF TRANSPORTATION**

GENERAL PLAN AND ELEVATION	
SN 028-0068	
SCALE:	SHEET 1 OF 3 SHEETS STA. TO STA.

F.A.P. RTE.	SECTION	COUNTY	TOTAL SHEETS	SHEET NO.
* 331/841	D9 BRIDGE REPAIR 2020-4	VARIOUS	21	7
ILLINOIS FED. AID PROJECT			CONTRACT NO. 78738	

STAGE 1 REMOVAL

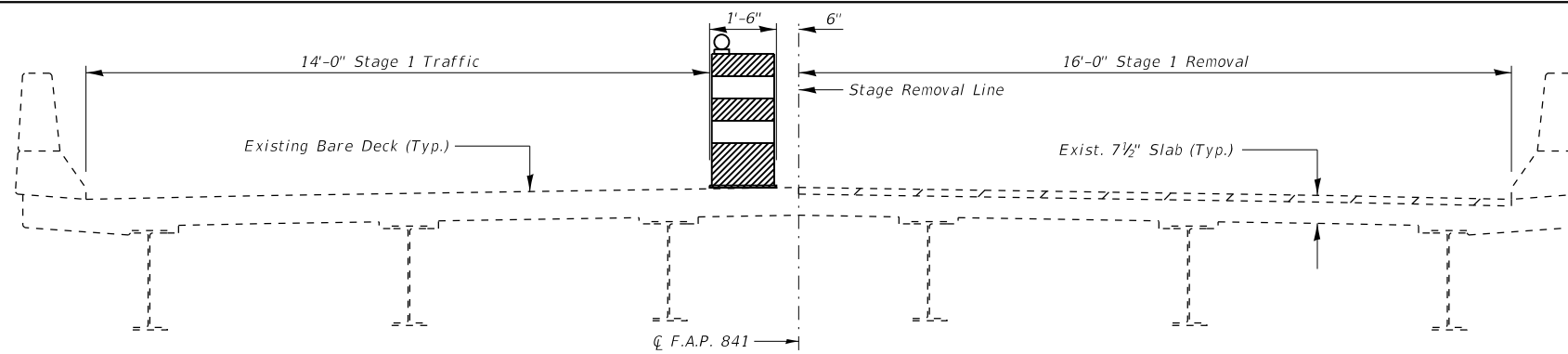

STAGE 1 CONSTRUCTION

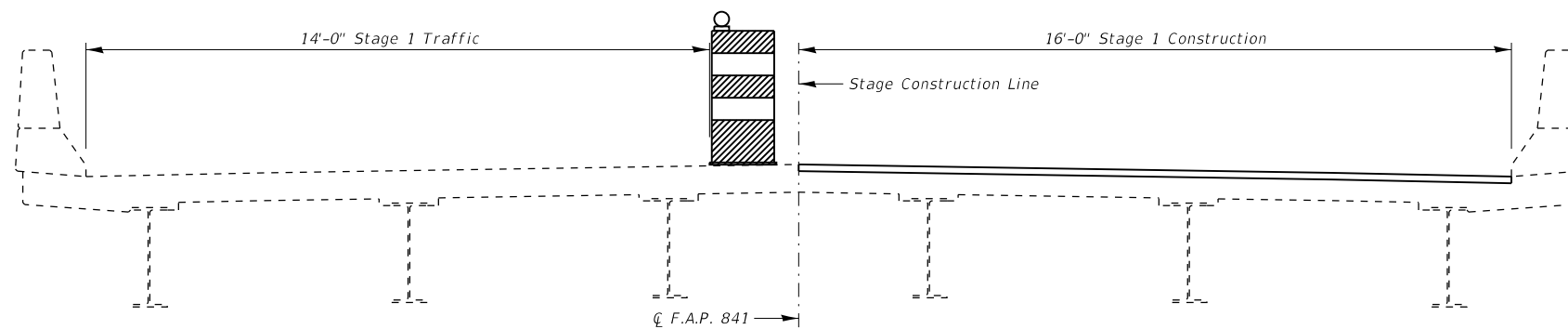

STAGE 2 REMOVAL

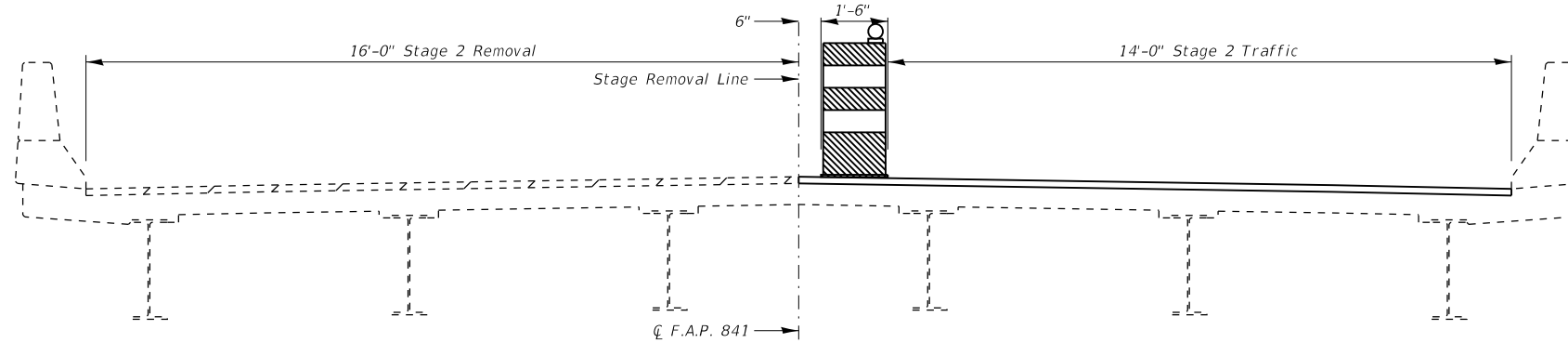

STAGE 2 CONSTRUCTION

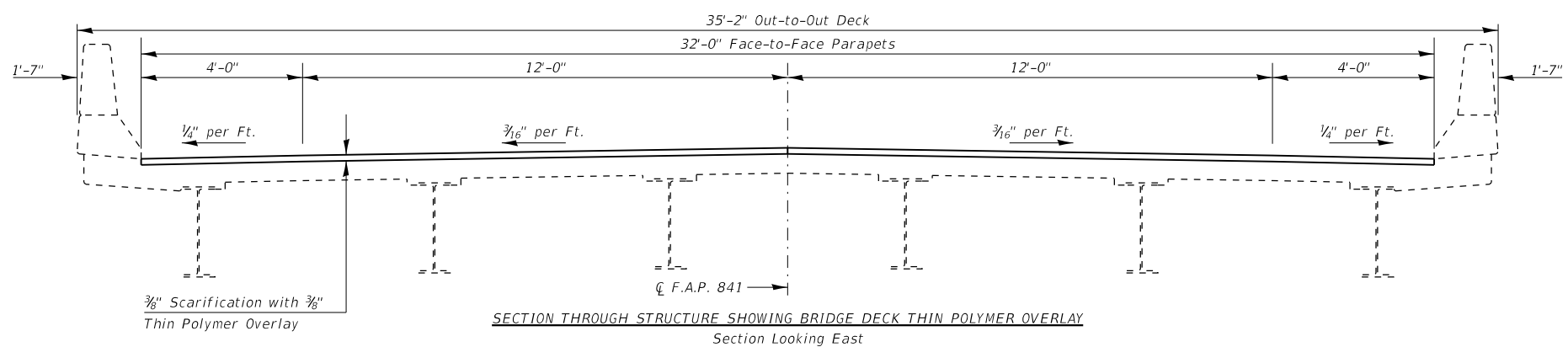
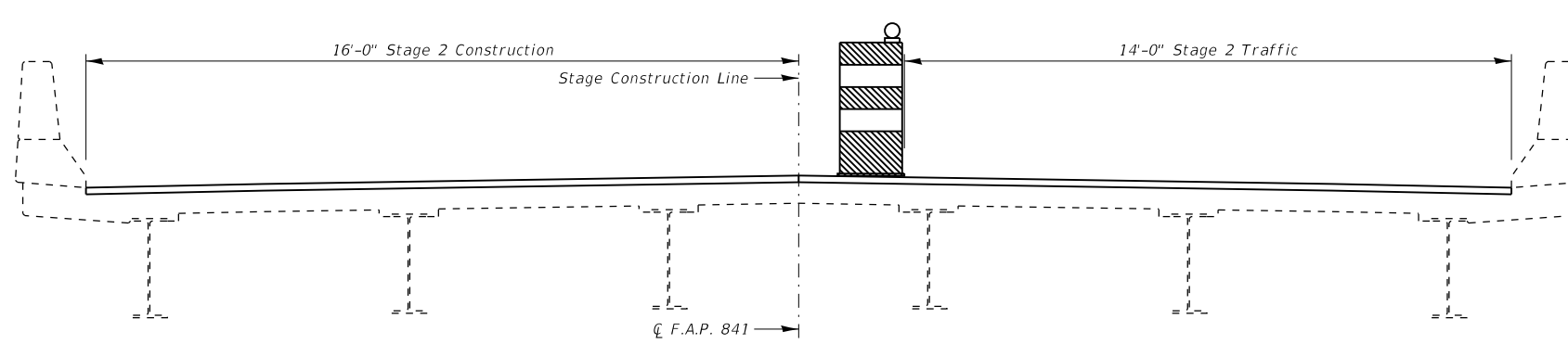

STAGING DETAILS
 IL 154 OVER LITTLE MUDDY RIVER
 F.A.P. RTE 841 - D9 BRIDGE REPAIR 2020-4
 FRANKLIN COUNTY
 STATION 344+10
 STRUCTURE NO. 028-0068

MODEL: Default
 FILE: \\nashville.pw.state.il.us\pub\harcourt\adams\dot\Documents\DOT_Offices\District 9\Projects\78738\CAAD\Drawings\9-78738-Sheets.dgn

USER NAME = adamsam	DESIGNED -	REVISED -
PLOT SCALE = 4.0000' / in.	DRAWN -	REVISOR -
PLOT DATE = 10/18/2019	CHECKED -	REVISOR -
	DATE -	REVISOR -

STATE OF ILLINOIS
 DEPARTMENT OF TRANSPORTATION

STAGING DETAILS			
SN 028-0068			
SCALE:	SHEET 2	OF 3 SHEETS	STA. TO STA.

F.A.P. RTE.	SECTION	COUNTY	TOTAL SHEETS	SHEET NO.
* 331/841	D9 BRIDGE REPAIR 2020-4	VARIOUS	21	8
ILLINOIS FED. AID PROJECT			CONTRACT NO. 78738	

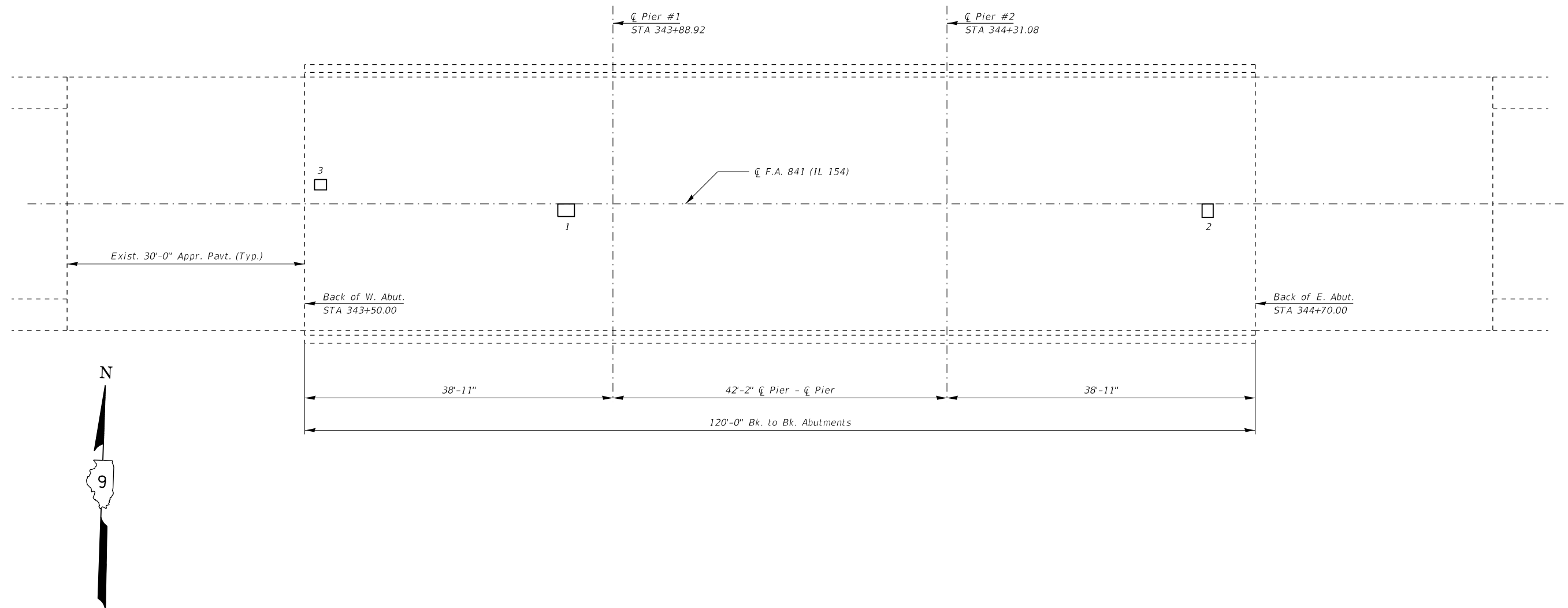

Notes: Deck Sounding was performed in April 2019.
The Resident Engineer will determine final patch locations and quantities in the field before bridge deck patching operations begin and mark on as-built plans.

DECK SLAB REPAIR (PARTIAL)

PATCH NO.	Dist. from C	LENGTH	WIDTH	AREA
#1		2.1'	1.6'	3.4 Sq Ft
#2		1.4'	1.7'	2.4 Sq Ft
#3	4'	1.5'	1.3'	2.0 Sq Ft
TOTAL				1 Sq Yd

**PARTIAL DEPTH DECK SLAB REPAIRS
IL 154 OVER LITTLE MUDDY RIVER
F.A.P. RTE 841 - D9 BRIDGE REPAIR 2020-4
FRANKLIN COUNTY
STATION 344+10
STRUCTURE NO. 028-0068**

MODEL: Default
FILE: \\hpc\p\pub\hpcroom\dat\illinois.gov\RWIDOT\Documents\DOT_Offices\District 9\Projects\78738\CAD\data\CAD\Drawings\09-78738-Sheets.dgn

USER NAME = adamsam	DESIGNED -	REVISED -
	DRAWN -	REVISED -
PLOT SCALE = 14.0000 ' / in.	CHECKED -	REVISED -
PLOT DATE = 10/18/2019	DATE -	REVISED -

**STATE OF ILLINOIS
DEPARTMENT OF TRANSPORTATION**

**PARTIAL DEPTH DECK SLAB REPAIRS
SN 028-0068**

SCALE: SHEET 3 OF 3 SHEETS STA. TO STA.

F.A.P. RTE.	SECTION	COUNTY	TOTAL SHEETS	SHEET NO.
* 331/841	D9 BRIDGE REPAIR 2020-4	VARIOUS	21	9
			CONTRACT NO. 78738	
		ILLINOIS	FED. AID PROJECT	

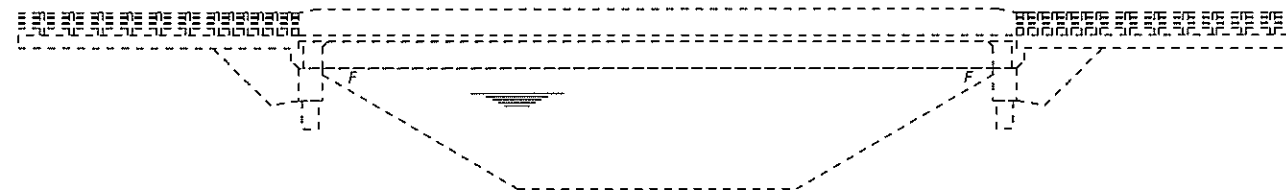

ELEVATION

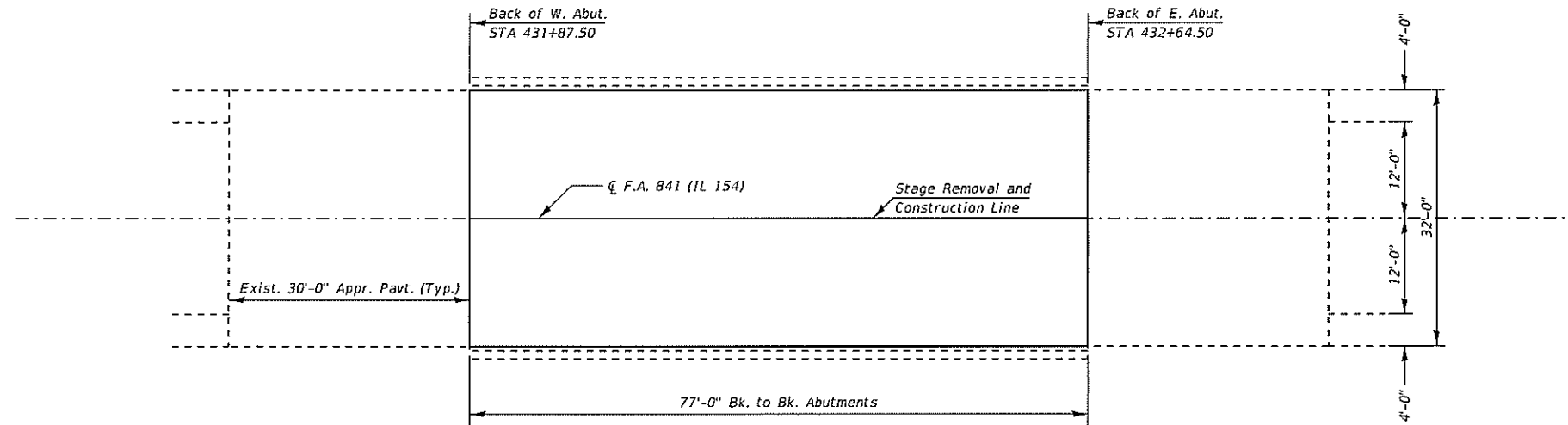

PLAN

GENERAL NOTES

Plan dimensions and details relative to existing plans are subject to nominal construction variations. The Contractor shall field verify existing dimensions and details affecting new construction and make necessary approved adjustments prior to construction or ordering of materials. Such variations shall not be cause for additional compensation for a change in scope of the work, however, the Contractor will be paid for the quantity actually furnished at the unit price bid for the work.

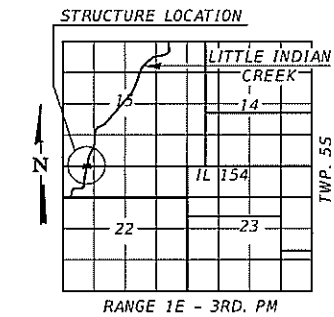

LOCATION PLAN

TOTAL BILL OF MATERIAL

ITEM	UNIT	QUANTITY
Bridge Deck Concrete Crack Sealer	Foot	650
Concrete Bridge Deck Scarification, 3/8"	Sq. Yd.	274
Bridge Deck Thin Polymer Overlay, 3/8"	Sq. Yd.	274
Approach Slab Repair (Partial)	Sq. Yd.	4
Deck Slab Repair (Partial)	Sq. Yd.	2

BRIDGE DECK POLYMER OVERLAY
IL 154 OVER LITTLE INDIAN CREEK
F.A.P. RTE 841 - D9 BRIDGE REPAIR 2020-4
FRANKLIN COUNTY
STATION 432+26
STRUCTURE NO. 028-0071

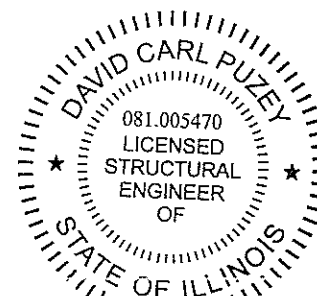

Dr. Carl Puzey 11/26/19
Expires 11/30/20

MODEL: Default
FILE NAME: ew\10\lanroom\dot\illinois.apr\PROJECTS\Documents\DOT Offices\DOT\028-0071\028-0071-D9-841\028-0071-01.dwg

USER NAME = adamsam	DESIGNED - ARA	REVISED -
PLOT SCALE = 20,000' / in.	DRAWN -	REVISED -
PLOT DATE = 10/18/2019	CHECKED - DSP	REVISED -
	DATE -	REVISED -

STATE OF ILLINOIS
DEPARTMENT OF TRANSPORTATION

GENERAL PLAN AND ELEVATION
SN 028-0071

SCALE: SHEET 1 OF 3 SHEETS STA. TO STA.

F.A.P. RTE.	SECTION	COUNTY	TOTAL SHEETS	SHEET NO.
D9 BRIDGE REPAIR 2020-4		VARIOUS	21	10
* 331/841				CONTRACT NO. 78738

STAGE 1 REMOVAL

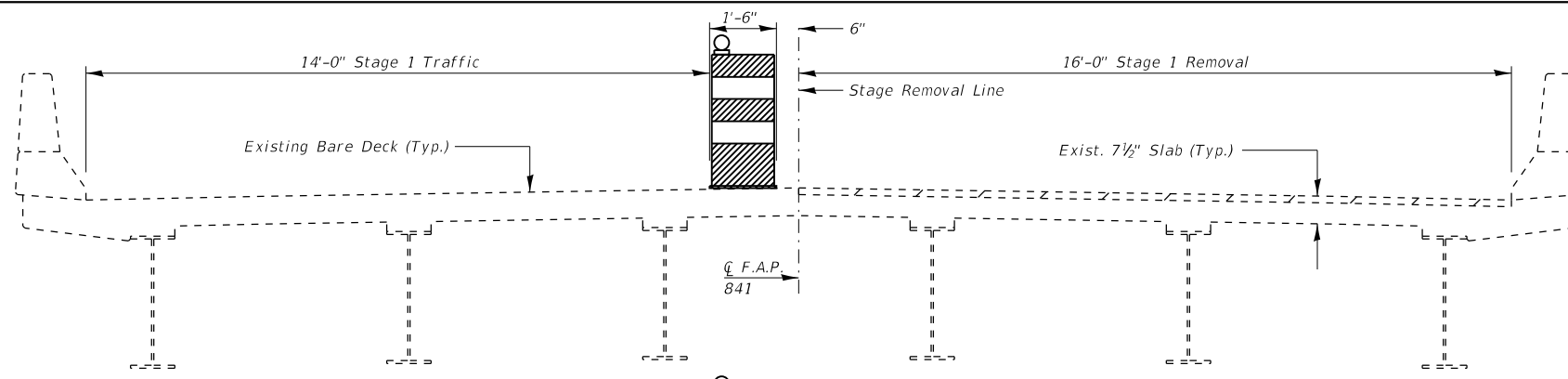

STAGE 1 CONSTRUCTION

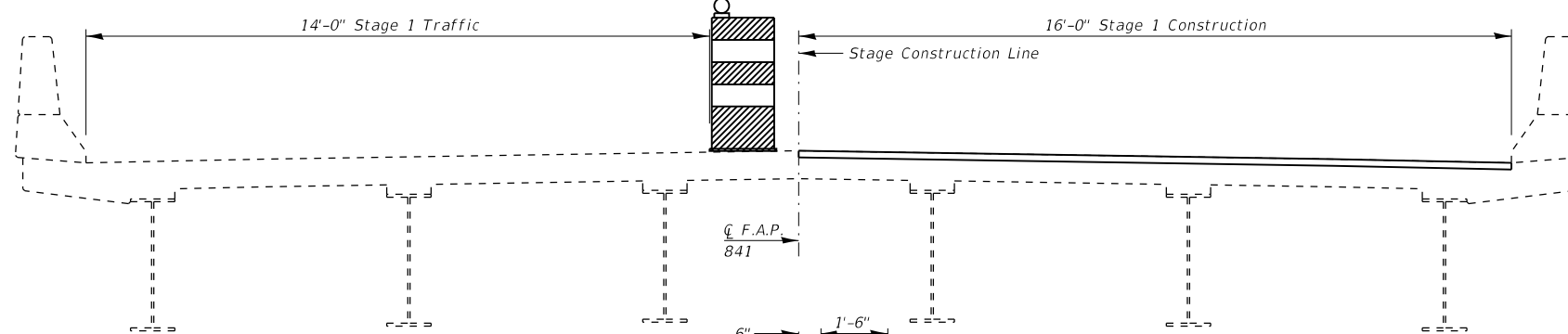

STAGE 2 REMOVAL

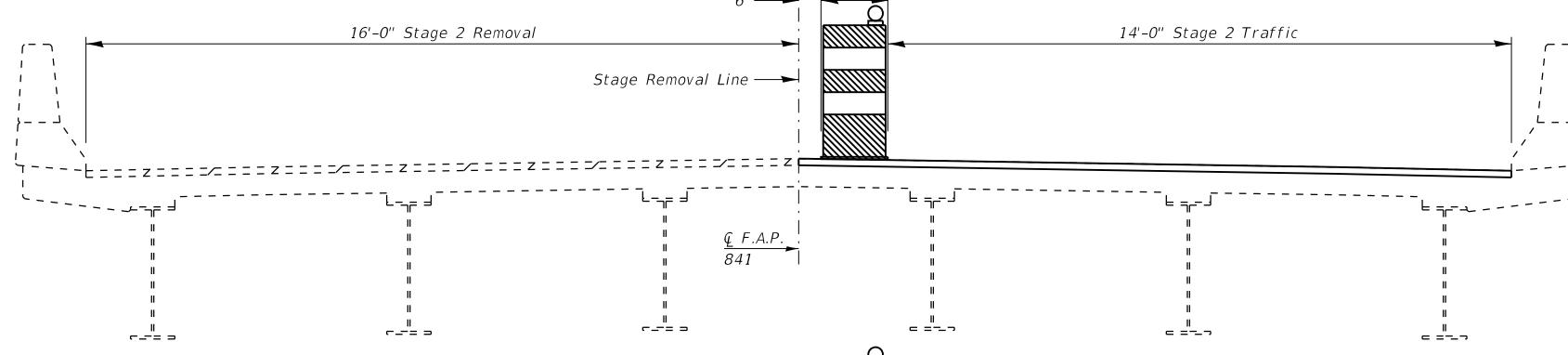

STAGE 2 CONSTRUCTION

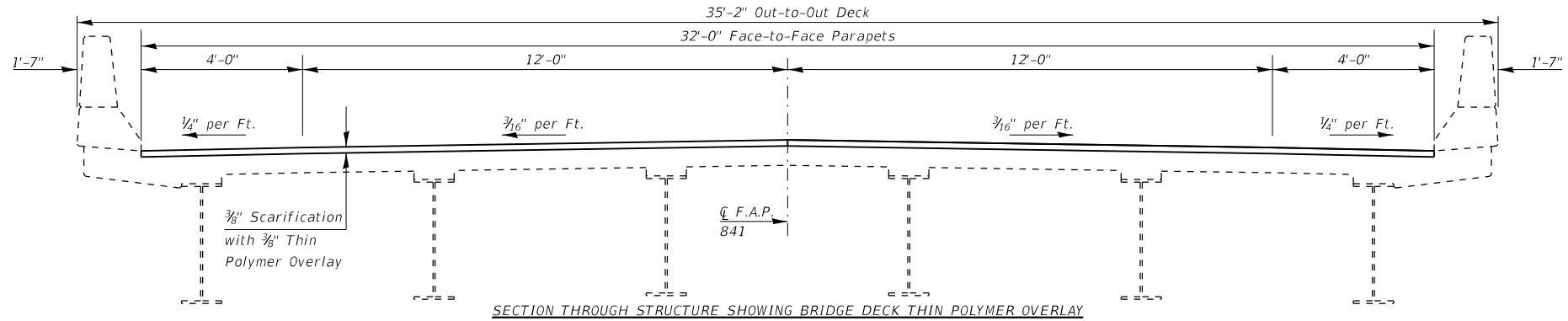
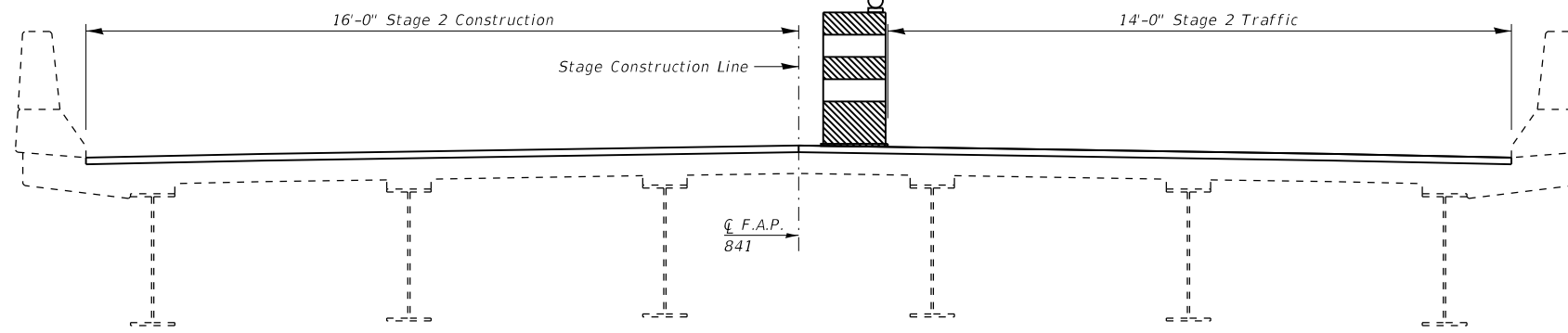

SECTION THROUGH STRUCTURE SHOWING BRIDGE DECK THIN POLYMER OVERLAY
Section Looking East

STAGING DETAILS
 IL 154 OVER LITTLE INDIAN CREEK
 F.A.P. RTE 841 - D9 BRIDGE REPAIR 2020-4
 FRANKLIN COUNTY
 STATION 432+26
 STRUCTURE NO. 028-0071

MODEL: Default
 FILE: \\nrcs\pub\lhamon.dwg
 PROJECT: 78738\CAAD\Drawings\DOT\Office\Drawings\9\Projects\78738\CAAD\Drawings\DOT\9\78738-Sheets.dgn

USER NAME = adamsam	DESIGNED -	REVISED -
	DRAWN -	REVISED -
PLOT SCALE = 4.0000' / in.	CHECKED -	REVISED -
PLOT DATE = 10/18/2019	DATE -	REVISED -

STATE OF ILLINOIS
 DEPARTMENT OF TRANSPORTATION

STAGING DETAILS
 SN 028-0071

SCALE: SHEET 2 OF 3 SHEETS STA. TO STA.

F.A.P. RTE.	SECTION	COUNTY	TOTAL SHEETS	SHEET NO.
* 331/841	D9 BRIDGE REPAIR 2020-4	VARIOUS	21	11
ILLINOIS FED. AID PROJECT			CONTRACT NO. 78738	

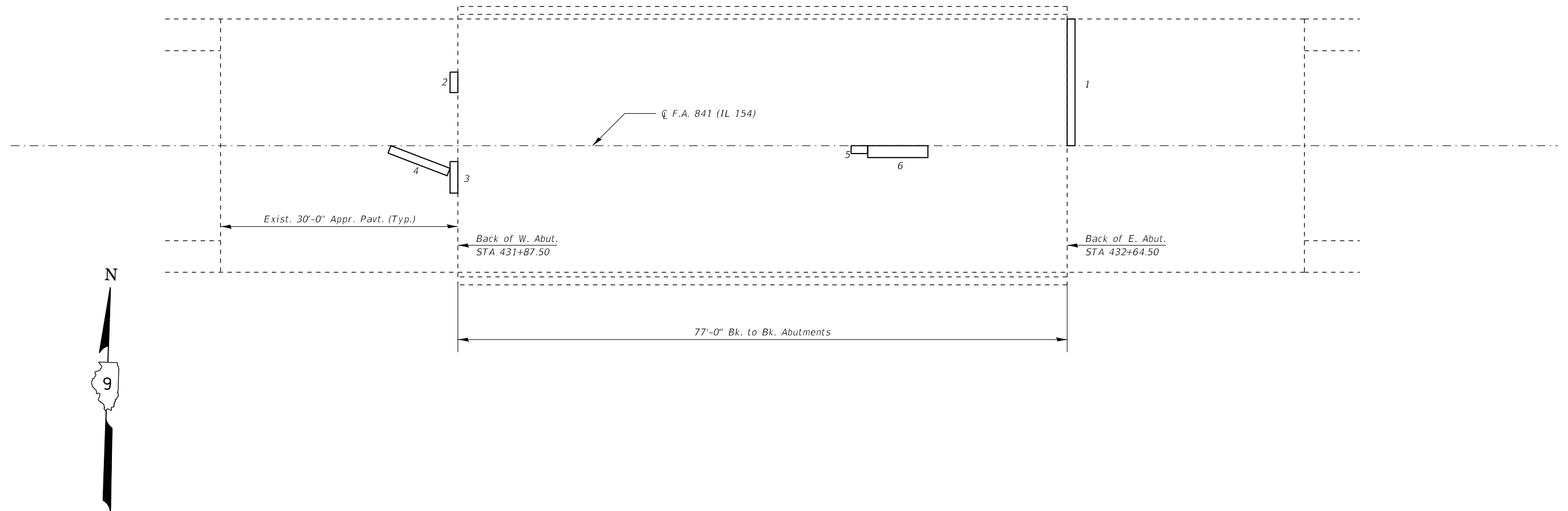

Notes: Deck Sounding was performed in April 2019.
 The Resident Engineer will determine final patch locations and quantities in the field before bridge deck patching operations begin and mark on as-built plans.

APPROACH SLAB REPAIR (PARTIAL)

PATCH NO.	Dist. from C	LENGTH	WIDTH	AREA
#1		1.0'	16.0'	16.0 Sq Ft
#2	8'	1.0'	2.6'	2.6 Sq Ft
#3	4'	1.0'	4.0'	4.0 Sq Ft
#4		8.0'	1.0'	8.0 Sq Ft
TOTAL				4 Sq Yd

DECK SLAB REPAIR (PARTIAL)

PATCH NO.	Dist. from C	LENGTH	WIDTH	AREA
#5		2.1'	1.0'	2.1 Sq Ft
#6		7.6'	1.5'	11.4 Sq Ft
TOTAL				2 Sq Yd

**PARTIAL DEPTH DECK SLAB REPAIRS
 IL 154 OVER LITTLE INDIAN CREEK
 F.A.P. RTE 841 - D9 BRIDGE REPAIR 2020-4
 FRANKLIN COUNTY
 STATION 432+26
 STRUCTURE NO. 028-0071**

MODEL: Default
 FILE: h:\m\c\p\pub\h\m\room\dat\illinois.gov\p\w\DOT\Documents\DOT - Offices\District 9\Projects\78738\CAD\DATA\CAD\Sheets\D9-78738-Sheets.dgn

USER NAME = adamsam	DESIGNED -	REVISED -
	DRAWN -	REVISED -
PLOT SCALE = 14.0000 ' / in.	CHECKED -	REVISED -
PLOT DATE = 10/18/2019	DATE -	REVISED -

**STATE OF ILLINOIS
 DEPARTMENT OF TRANSPORTATION**

PARTIAL DEPTH DECK SLAB REPAIRS SN 028-0071			
SCALE:	SHEET 3	OF 3 SHEETS	STA. TO STA.

F.A.P. RTE.	SECTION	COUNTY	TOTAL SHEETS	SHEET NO.
* 331/841	D9 BRIDGE REPAIR 2020-4	VARIOUS	21	12
			CONTRACT NO. 78738	
		ILLINOIS	FED. AID PROJECT	

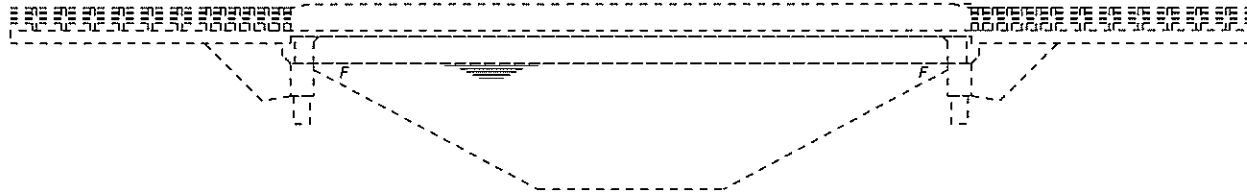

ELEVATION

GENERAL NOTES

Plan dimensions and details relative to existing plans are subject to nominal construction variations. The Contractor shall field verify existing dimensions and details affecting new construction and make necessary approved adjustments prior to construction or ordering of materials. Such variations shall not be cause for additional compensation for a change in scope of the work, however, the Contractor will be paid for the quantity actually furnished at the unit price bid for the work.

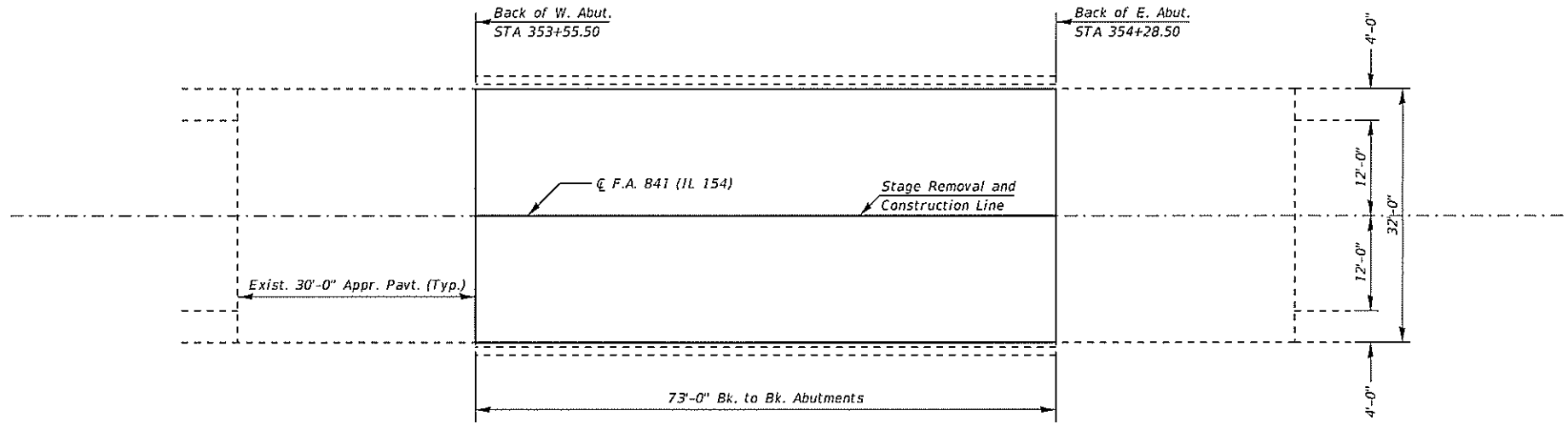

PLAN

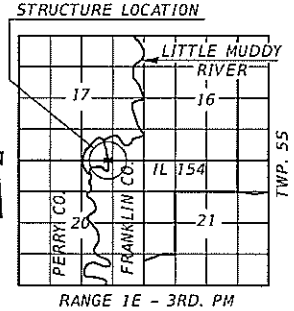

LOCATION PLAN

TOTAL BILL OF MATERIAL

ITEM	UNIT	QUANTITY
Bridge Deck Concrete Crack Sealer	Foot	250
Concrete Bridge Deck Scarification, 3/8"	Sq. Yd.	260
Bridge Deck Thin Polymer Overlay, 3/8"	Sq. Yd.	260
Deck Slab Repair (Partial)	Sq. Yd.	2
Approach Slab Repair (Partial)	Sq. Yd.	3

**BRIDGE DECK POLYMER OVERLAY
IL 154 OVER LITTLE MUDDY RIVER OVERFLOW
F.A.P. RTE 841 - D9 BRIDGE REPAIR 2020-4
FRANKLIN COUNTY
STATION 353+92
STRUCTURE NO. 028-0072**

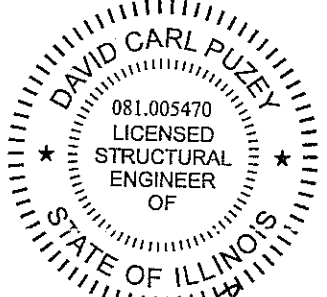

David Carl Puzey 11/26/19
Expires 11/30/20

USER NAME = adamsam	DESIGNED - AKA	REVISED -
PLOT SCALE = 20.0000' / in.	DRAWN -	REVISED -
PLOT DATE = 10/18/2019	CHECKED - DSF	REVISED -
	DATE -	REVISED -

**STATE OF ILLINOIS
DEPARTMENT OF TRANSPORTATION**

**GENERAL PLAN AND ELEVATION
SN 028-0072**

SCALE: SHEET 1 OF 3 SHEETS STA. TO STA.

F.A.P. RTE.	SECTION	COUNTY	TOTAL SHEETS	SHEET NO.
*	D9 BRIDGE REPAIR 2020-4	VARIOUS	21	13
* 331/841				

ILLINOIS FED. AID PROJECT

MODEL: Drawn
FILE NAME: s:\work\arizona\dal\litedt\pvt\pvt\DOT\assummen_all\DOT_Offices\GIS\GIS_9\Projects\72738\CADD\DWG\CDR\90505-78738_Sheets.dgn

STAGE 1 REMOVAL

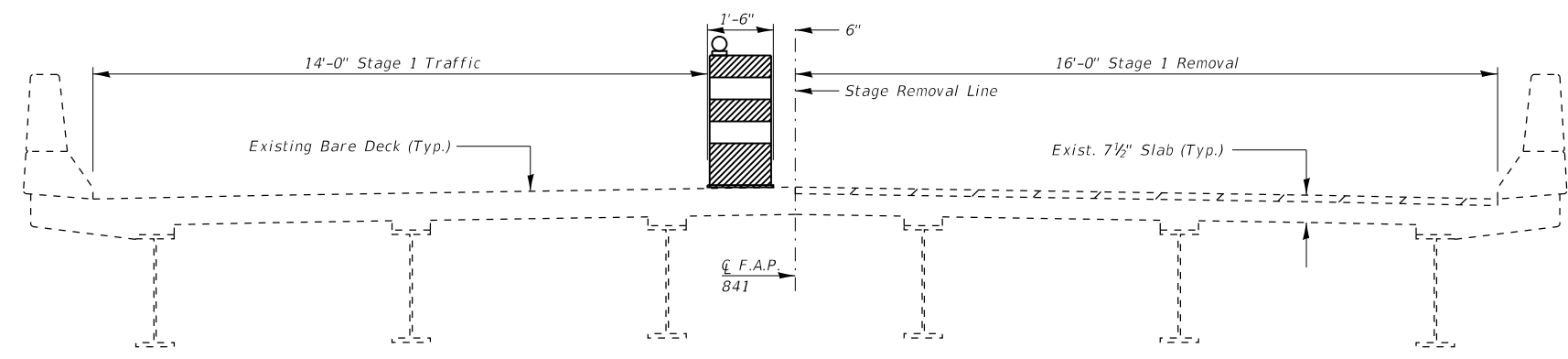

STAGE 1 CONSTRUCTION

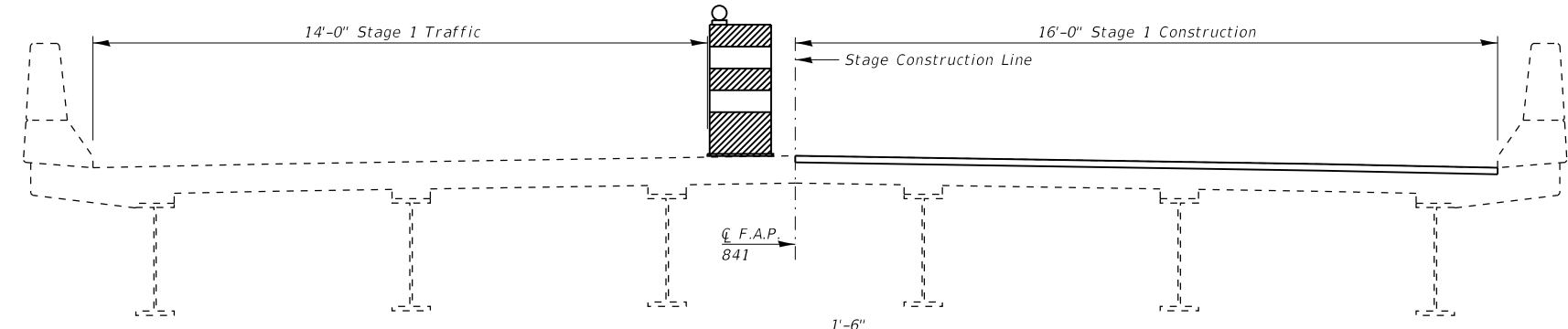

STAGE 2 REMOVAL

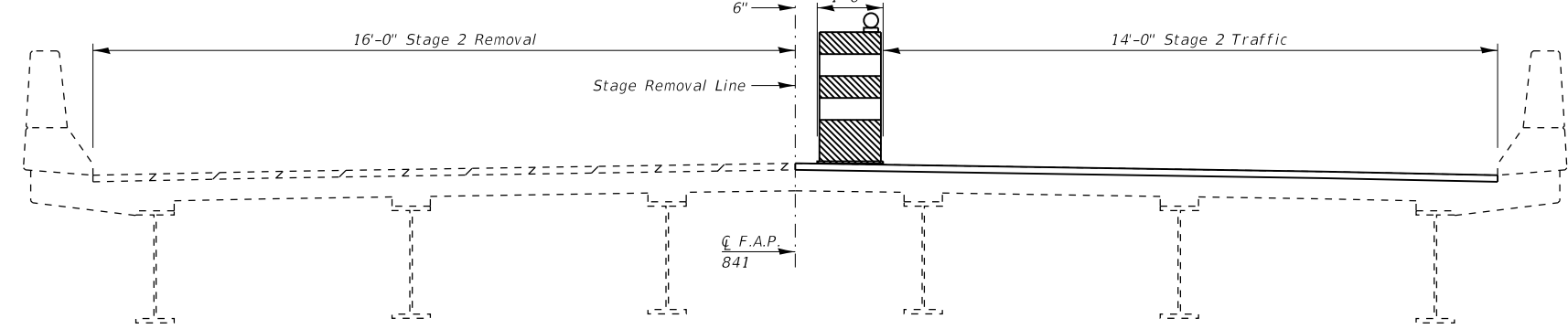

STAGE 2 CONSTRUCTION

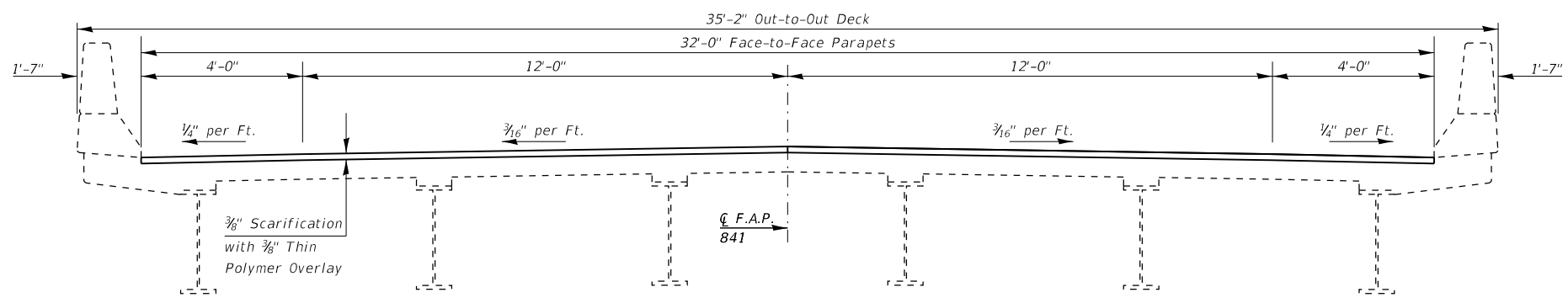
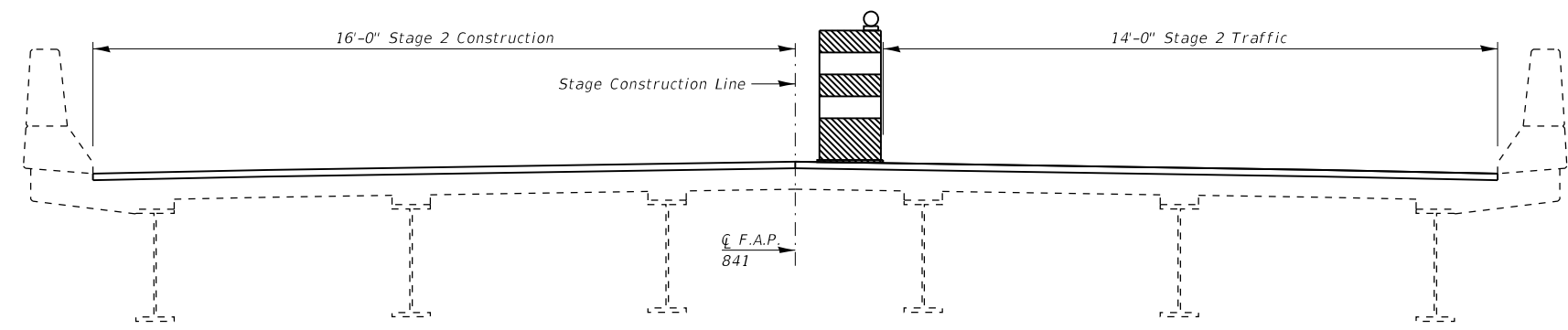

SECTION THROUGH STRUCTURE SHOWING BRIDGE DECK THIN POLYMER OVERLAY
Section Looking East

STAGING DETAILS
IL 154 OVER LITTLE MUDDY RIVER OVERFLOW
F.A.P. RTE 841 - D9 BRIDGE REPAIR 2020-4
FRANKLIN COUNTY
STATION 353+92
STRUCTURE NO. 028-0072

MODEL: Default
 FILE: \\nashville.pw.org\pubshare\room.dca\illinois.gov\pww\DOT\Documents\DOT - Offices\District 9\Projects\78738\CADD\Drawings\9-17-2019-Sheets.dgn

USER NAME = adamsam	DESIGNED -	REVISED -
PLOT SCALE = 4.0000' / in.	DRAWN -	REVISED -
PLOT DATE = 10/18/2019	CHECKED -	REVISED -
	DATE -	REVISED -

STATE OF ILLINOIS
DEPARTMENT OF TRANSPORTATION

STAGING DETAILS
SN 028-0072

SCALE: SHEET 2 OF 3 SHEETS STA. TO STA.

F.A.P. RTE.	SECTION	COUNTY	TOTAL SHEETS	SHEET NO.
* 331/841	D9 BRIDGE REPAIR 2020-4	VARIOUS	21	14
ILLINOIS FED. AID PROJECT			CONTRACT NO. 78738	

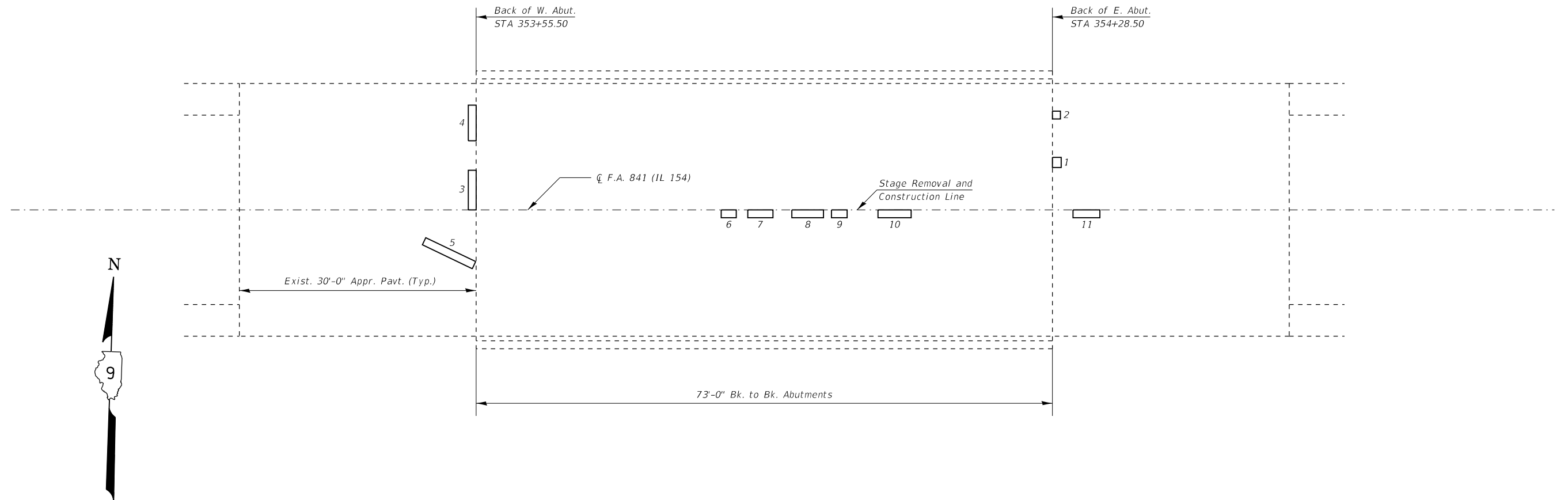

Notes: Deck Sounding was performed in April 2019.
 The Resident Engineer will determine final patch locations and quantities in the field before bridge deck patching operations begin and mark on as-built plans.

APPROACH SLAB REPAIR (PARTIAL)

PATCH NO.	Dist. from CL	LENGTH	WIDTH	AREA
#1	6'	1.1'	1.3'	1.4 Sq Ft
#2	12'	1.0'	1.6'	1.6 Sq Ft
#3	1.0'	5.0'	5.0'	5.0 Sq Ft
#4	11'	1.0'	4.5'	4.5 Sq Ft
#5	7'	7.0'	1.0'	7.0 Sq Ft
#11	3.4'	1.0'	3.4'	3.4 Sq Ft
TOTAL				3 Sq Yd

DECK SLAB REPAIR (PARTIAL)

PATCH NO.	Dist. from CL	LENGTH	WIDTH	AREA
#6		1.9'	1.0'	1.9 Sq Ft
#7		3.2'	1.0'	3.2 Sq Ft
#8		4.0'	1.0'	4.0 Sq Ft
#9		2.8'	1.0'	2.8 Sq Ft
#10		4.2'	1.0'	4.2 Sq Ft
TOTAL				2 Sq Yd

**PARTIAL DEPTH DECK SLAB REPAIRS
 IL 154 OVER LITTLE MUDDY RIVER OVERFLOW
 F.A.P. RTE 841 - D9 BRIDGE REPAIR 2020-4
 FRANKLIN COUNTY
 STATION 353+92
 STRUCTURE NO. 028-0072**

MODEL: Default
 FILE: h:\mhc\p\pub\harramoa.dwg
 PROJECT: 78738\CAD\DATA\CAD\Drawings\DOT_Offices\Drawings\9\Projects\78738\CAD\DATA\CAD\Drawings\9\78738-Sheets.dgn

USER NAME = adamsam	DESIGNED -	REVISED -
	DRAWN -	REVISED -
PLOT SCALE = 14.0000 ' / in.	CHECKED -	REVISED -
PLOT DATE = 10/18/2019	DATE -	REVISED -

**STATE OF ILLINOIS
 DEPARTMENT OF TRANSPORTATION**

**PARTIAL DEPTH DECK SLAB REPAIRS
 SN 028-0072**

SCALE: SHEET 3 OF 3 SHEETS STA. TO STA.

F.A.P. RTE.	SECTION	COUNTY	TOTAL SHEETS	SHEET NO.
* 331/841	D9 BRIDGE REPAIR 2020-4	VARIOUS	21	15
			CONTRACT NO. 78738	
		ILLINOIS	FED. AID PROJECT	

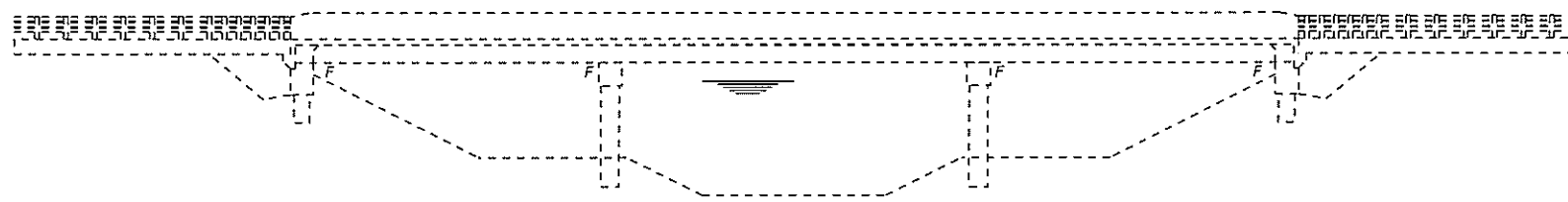

ELEVATION



GENERAL NOTES

Plan dimensions and details relative to existing plans are subject to nominal construction variations. The Contractor shall field verify existing dimensions and details affecting new construction and make necessary approved adjustments prior to construction or ordering of materials. Such variations shall not be cause for additional compensation for a change in scope of the work, however, the Contractor will be paid for the quantity actually furnished at the unit price bid for the work.

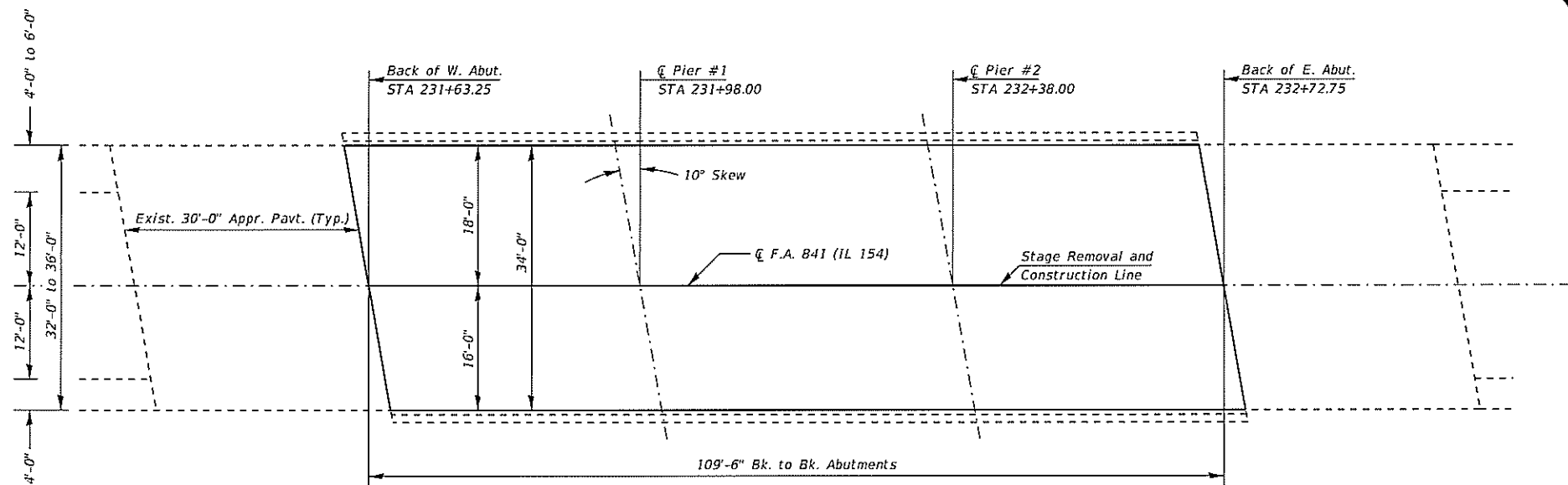

PLAN

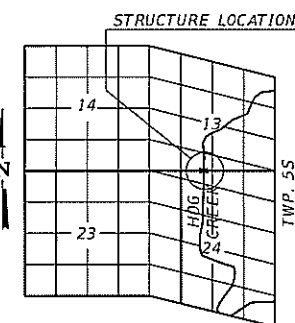

RANGE 1W - 3RD. PM

LOCATION PLAN

TOTAL BILL OF MATERIAL

ITEM	UNIT	QUANTITY
Bridge Deck Concrete Crack Sealer	Foot	850
Concrete Bridge Deck Scarification, 3/8"	Sq. Yd.	414
Bridge Deck Thin Polymer Overlay, 3/8"	Sq. Yd.	414
Approach Slab Repair (Partial)	Sq. Yd.	2

**BRIDGE DECK POLYMER OVERLAY
IL 154 OVER HOG CREEK
F.A.P. RTE 841 - D9 BRIDGE REPAIR 2020-4
PERRY COUNTY
STATION 232+18
STRUCTURE NO. 073-0035**

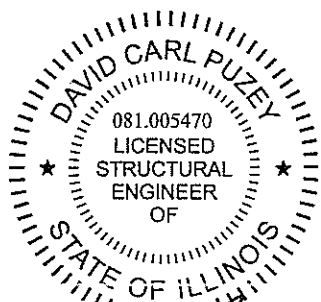

*David Carl Puzey 11/26/19
Expires 11/30/20*

MODEL: Default
FILE NAME: env:\lab\arcsm\dot\illinois.dot\illinois.dwg
PROJECT: 331841
DOCUMENT: D9 BRIDGE REPAIR 2020-4
SHEET: 1 OF 3

USER NAME = adamsam	DESIGNED - AKA	REVISIONS -
PLOT SCALE = 26.0000" / 1"	CHECKED - DSP	REVISIONS -
PLOT DATE = 10/18/2019	DATE -	REVISIONS -

**STATE OF ILLINOIS
DEPARTMENT OF TRANSPORTATION**

**GENERAL PLAN AND ELEVATION
SN 073-0035**

SCALE: SHEET 1 OF 3 SHEETS STA. TO STA.

F.A.P. RTE.	SECTION	COUNTY	TOTAL SHEETS	SHEET NO.
331841	D9 BRIDGE REPAIR 2020-4	VARIOUS	21	16
ILLINOIS FED. AID PROJECT			CONTRACT NO. 78738	

STAGE 1 REMOVAL

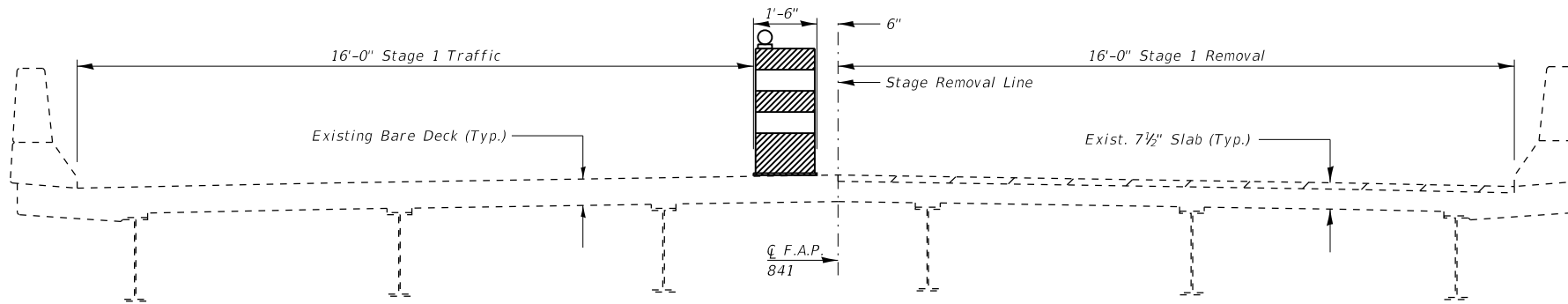

STAGE 1 CONSTRUCTION

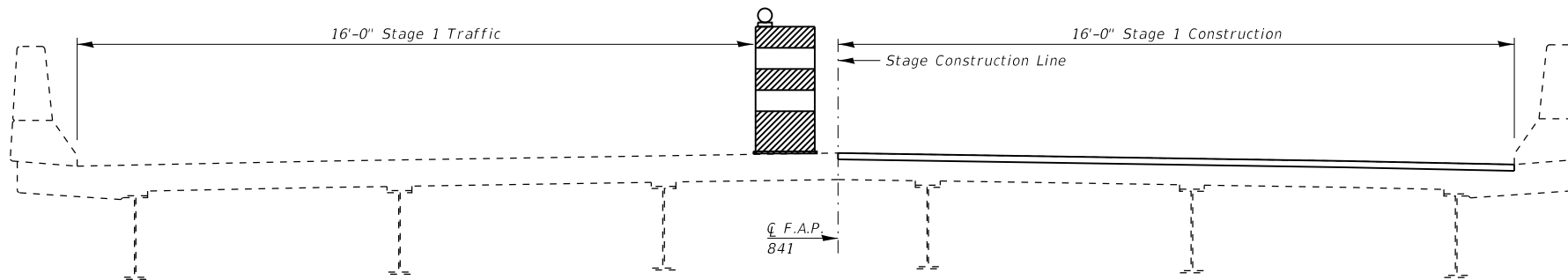

STAGE 2 REMOVAL

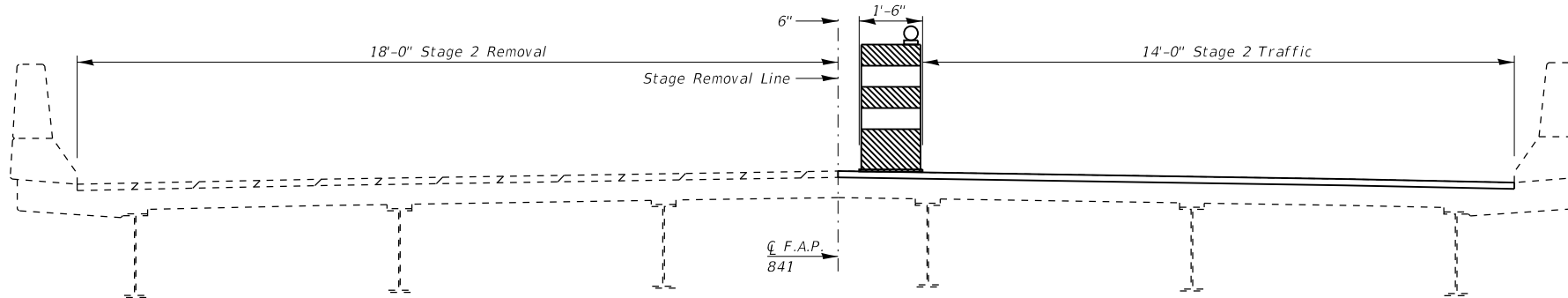

STAGE 2 CONSTRUCTION

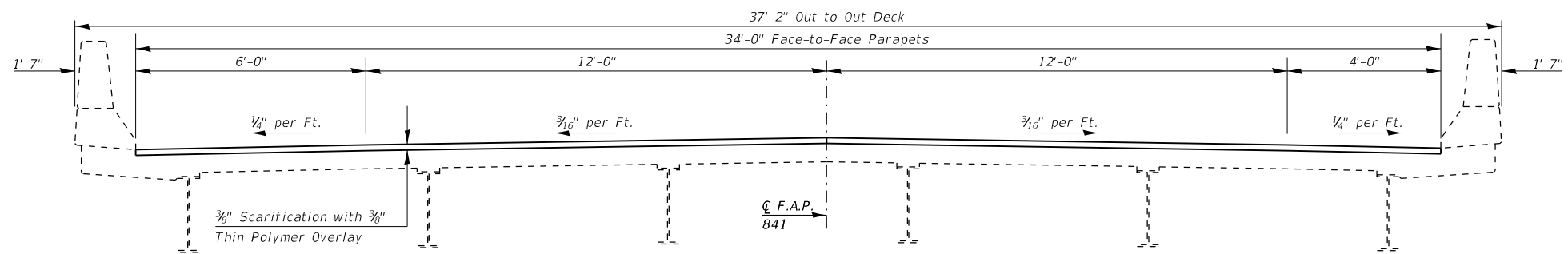
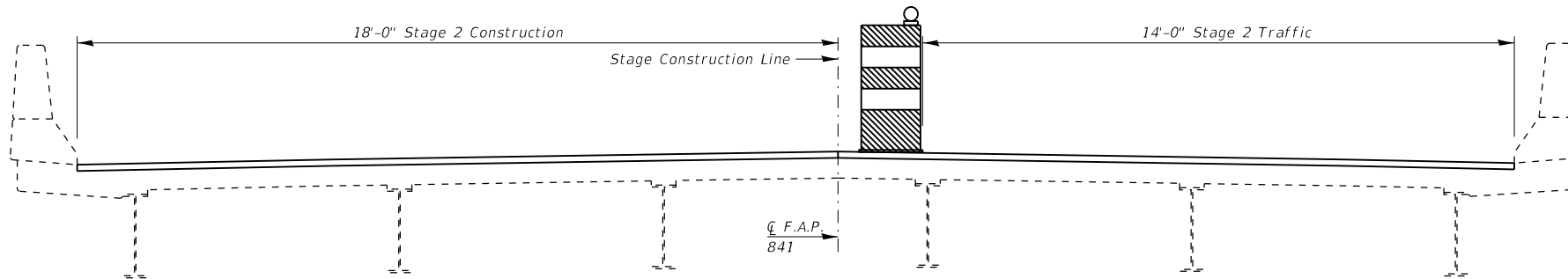

SECTION THROUGH STRUCTURE SHOWING BRIDGE DECK THIN POLYMER OVERLAY
Section Looking East

STAGING DETAILS
IL 154 OVER HOG CREEK
F.A.P. RTE 841 - D9 BRIDGE REPAIR 2020-4
PERRY COUNTY
STATION 232+18
STRUCTURE NO. 073-0035

MODEL: Default
 FILE: \\hpc\p\pub\hpc\room\ada\illinois.gov\PI\DOT\Documents\DOT_Offices\Dist\ct_9\Projects\78738\CADD\Drawings\09-78738-Sheets.dgn

USER NAME = adamsam	DESIGNED -	REVISED -
	DRAWN -	REVISED -
PLOT SCALE = 4.0000' / in.	CHECKED -	REVISED -
PLOT DATE = 10/18/2019	DATE -	REVISED -

STATE OF ILLINOIS
DEPARTMENT OF TRANSPORTATION

STAGING DETAILS
SN 073-0035

SCALE: SHEET 2 OF 3 SHEETS STA. TO STA.

F.A.P. RTE.	SECTION	COUNTY	TOTAL SHEETS	SHEET NO.
*	D9 BRIDGE REPAIR 2020-4	VARIOUS	21	17
* 331/841			CONTRACT NO. 78738	

ILLINOIS FED. AID PROJECT

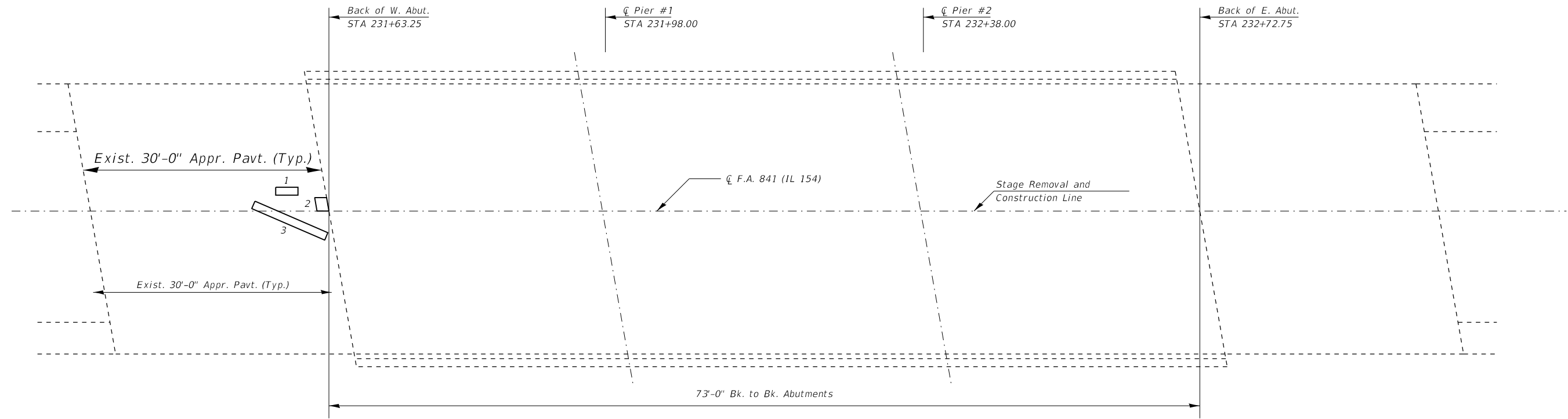

PLAN

Notes: Deck Sounding was performed in April 2019.
The Resident Engineer will determine final patch locations and quantities in the field before bridge deck patching operations begin and mark on as-built plans.

APPROACH SLAB REPAIR (PARTIAL)

PATCH NO.	Dist. from C.L.	LENGTH	WIDTH	AREA
#1	2'	2.8'	1.0'	2.8 Sq Ft
#2	1.5'	1.5'	1.7'	2.6 Sq Ft
#3		10.0'	1.0'	10.0 Sq Ft
TOTAL				2 Sq Yd

PARTIAL DEPTH APPROACH SLAB REPAIRS
IL 154 OVER HOG CREEK
F.A.P. RTE 841 - D9 BRIDGE REPAIR 2020-4
PERRY COUNTY
STATION 232+18
STRUCTURE NO. 073-0035

MODEL: Default
FILE: A:\mhc_p\pub\haronom.dwg
PROJECT: 78738\CAD\DATA\CAD\Drawings\DOT_Offices\Drawings\9\Projects\78738\CAD\DATA\CAD\Drawings\DOT_Offices\Drawings\9\Projects\78738\Sheets.dgn

USER NAME = adamsam	DESIGNED -	REVISED -
	DRAWN -	REVISED -
PLOT SCALE = 14.0000 ' / in.	CHECKED -	REVISED -
PLOT DATE = 10/18/2019	DATE -	REVISED -

STATE OF ILLINOIS
DEPARTMENT OF TRANSPORTATION

PARTIAL DEPTH APPROACH SLAB REPAIRS
SN 073-0035

SCALE: SHEET 3 OF 3 SHEETS STA. TO STA.

F.A.P. RTE.	SECTION	COUNTY	TOTAL SHEETS	SHEET NO.
* 331/841	D9 BRIDGE REPAIR 2020-4	VARIOUS	21	18
			CONTRACT NO. 78738	
		ILLINOIS	FED. AID PROJECT	

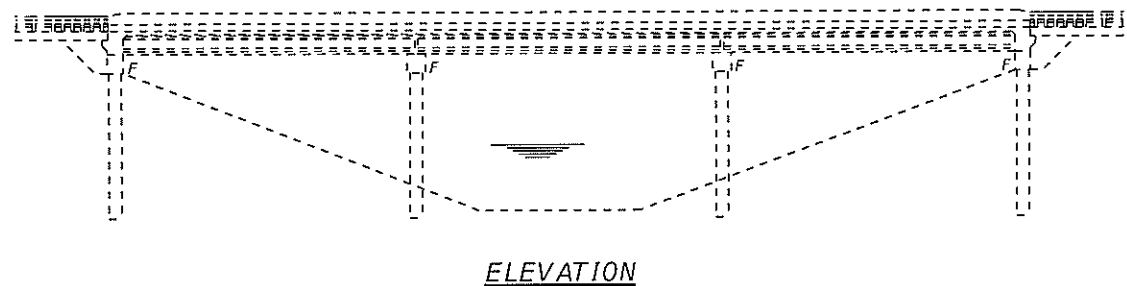

ELEVATION

GENERAL NOTES

Plan dimensions and details relative to existing plans are subject to nominal construction variations. The Contractor shall field verify existing dimensions and details affecting new construction and make necessary approved adjustments prior to construction or ordering of materials. Such variations shall not be cause for additional compensation for a change in scope of the work, however, the Contractor will be paid for the quantity actually furnished at the unit price bid for the work.

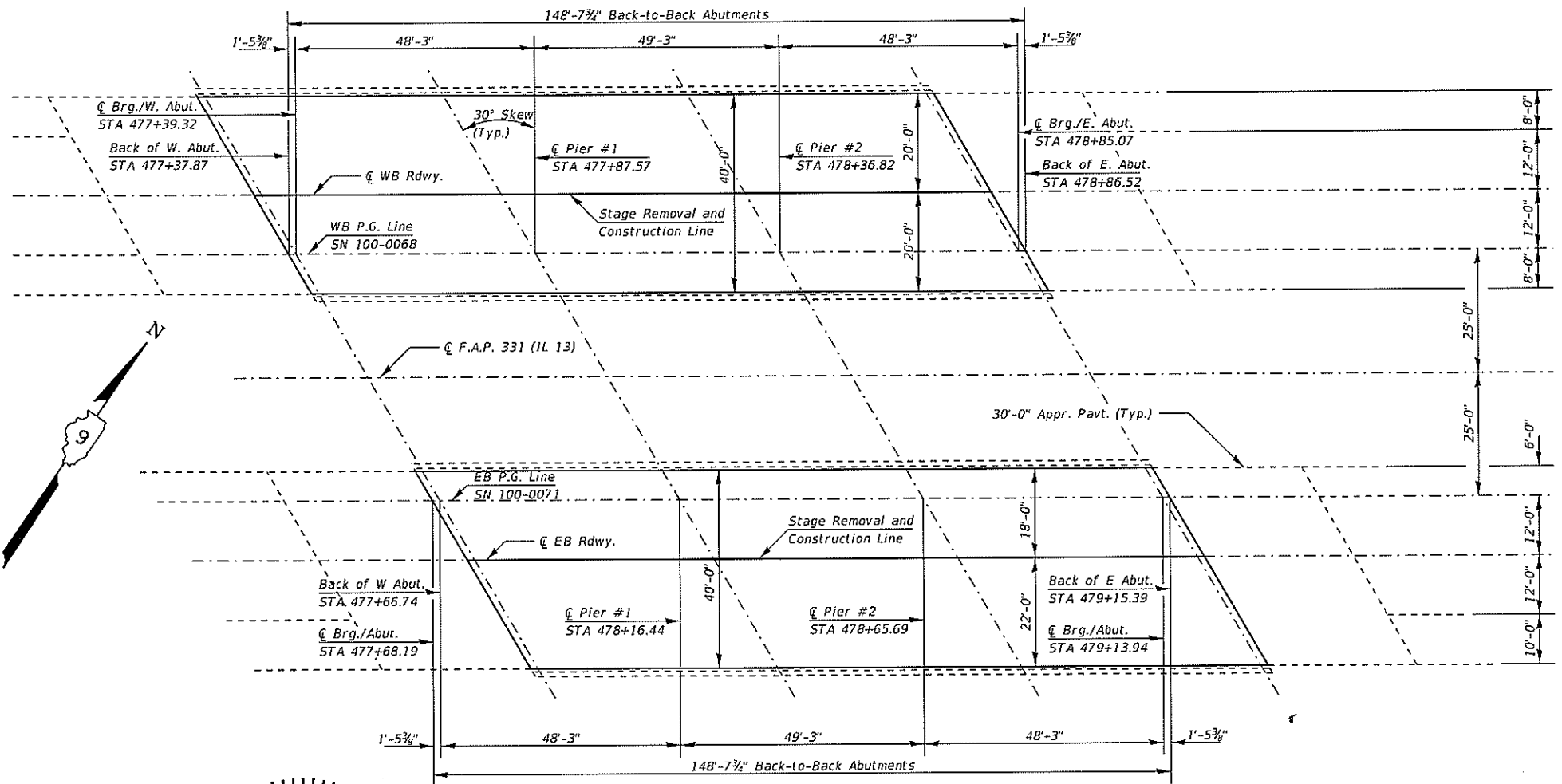

PLAN

STRUCTURES LOCATION

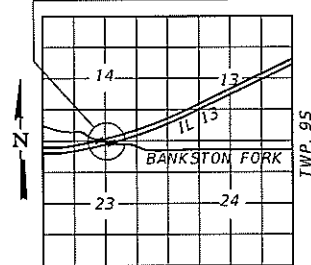

LOCATION PLAN

TOTAL BILL OF MATERIAL

ITEM	UNIT	QUANTITY
Bridge Deck Concrete Crack Sealer	Foot	225
Concrete Bridge Deck Scarification, 3/8"	Sq. Yd.	1322
Bridge Deck Thin Polymer Overlay, 3/8"	Sq. Yd.	1322
Approach Slab Repair (Partial)	Sq. Yd.	4

**BRIDGE DECK POLYMER OVERLAY
IL 13 OVER BANKSTON FORK
F.A.P. RTE 331 - D9 BRIDGE REPAIR 2020-4
WILLIAMSON COUNTY
STATION 478+26.63
STRUCTURE NO. 100-0068(71)**

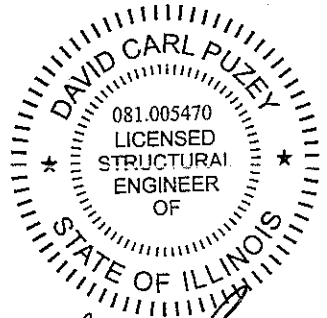

David Carl Puzey 11/26/19
Expires 11/30/20

MODEL: Detail
 FILE NAME: s:\h\j\uncom\il\il\ind\m\p\p\DOT\Documents\DOT\Office\0151\K1\9\Project\178738\CADD\A\A\01\Sheet\09-78738-Sheets.dwg

USER NAME = adamsam	DESIGNED - <i>AKA</i>	REVISED -
PLOT SCALE = 30.0000' / in.	DRAWN -	REVISED -
PLOT DATE = 10/18/2019	CHECKED - <i>DSP.</i>	REVISED -
	DATE -	REVISED -

**STATE OF ILLINOIS
DEPARTMENT OF TRANSPORTATION**

**GENERAL PLAN AND ELEVATION
SN 100-0068(71)**

SCALE: SHEET 1 OF 3 SHEETS STA. TO STA.

F.A.P. RTE.	SECTION	COUNTY	TOTAL SHEETS	SHEET NO.
331/841	D9 BRIDGE REPAIR 2020-4	VARIOUS	21	19
ILLINOIS FED. AID PROJECT			CONTRACT NO. 78738	

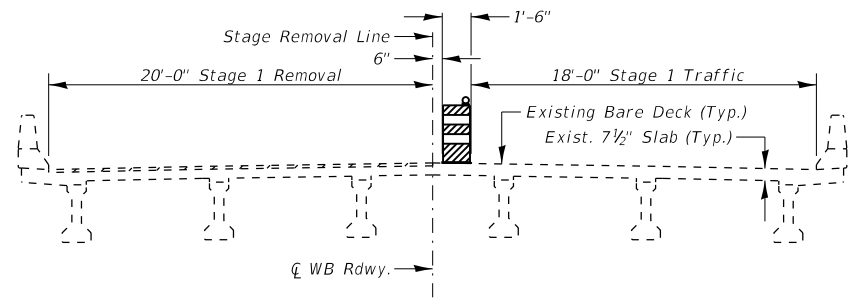

STAGE 1 REMOVAL

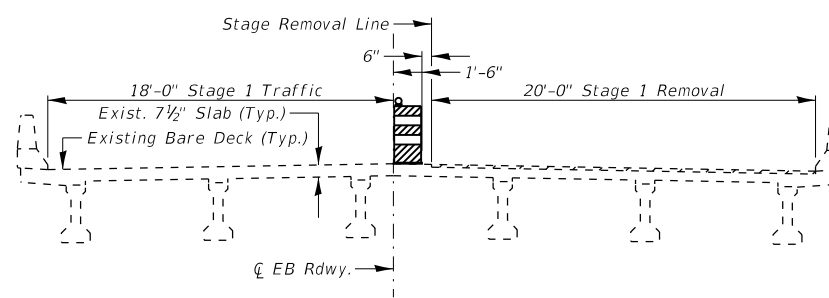

STAGE 1 REMOVAL

Concrete Bridge Deck Scarification 3/8"

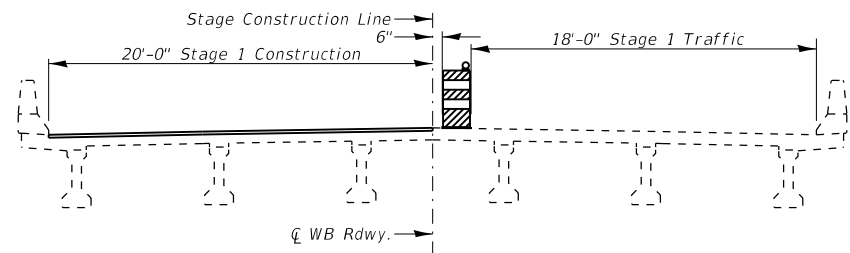

STAGE 1 CONSTRUCTION

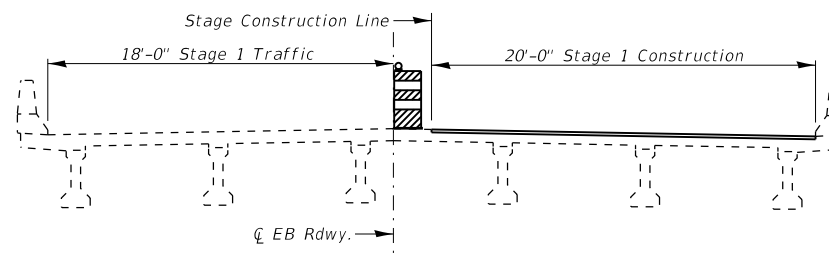

STAGE 1 CONSTRUCTION

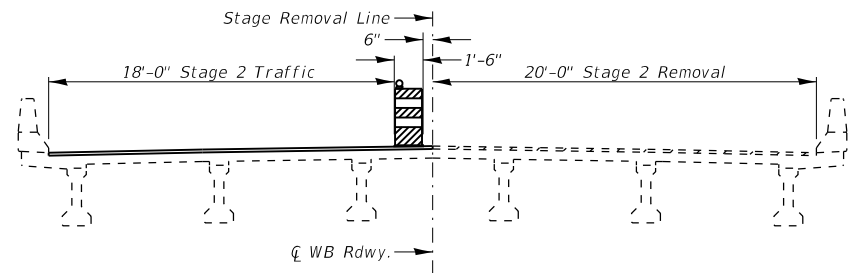

STAGE 2 REMOVAL

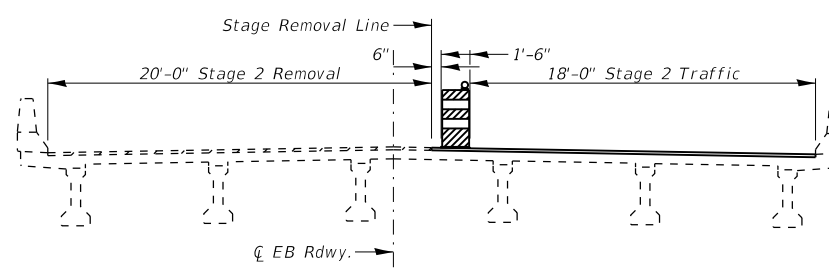

STAGE 2 REMOVAL

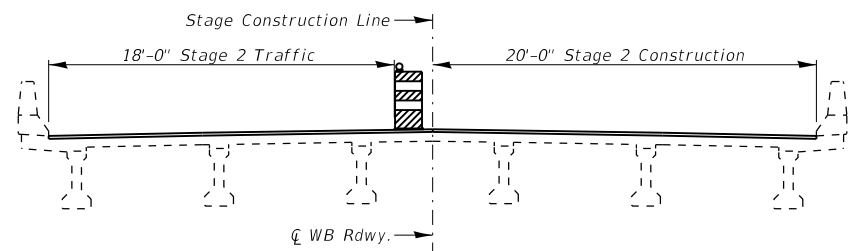

STAGE 2 CONSTRUCTION

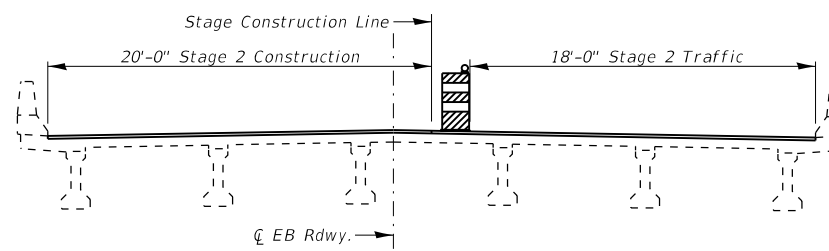

STAGE 2 CONSTRUCTION

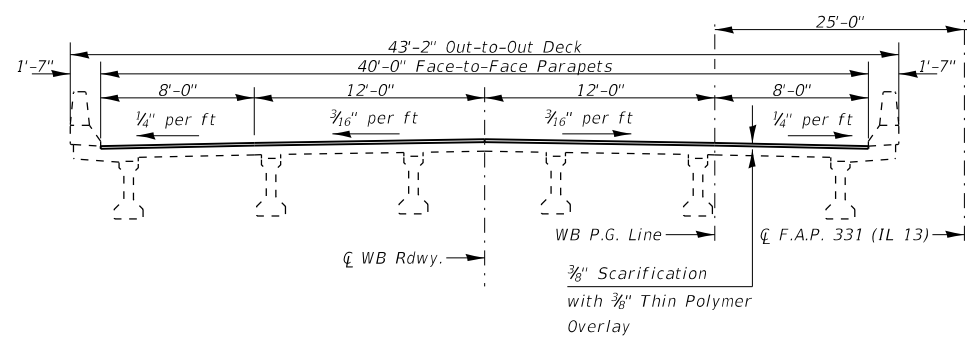

SECTION THROUGH STRUCTURE SHOWING BRIDGE DECK THIN POLYMER OVERLAY
All Sections Looking East

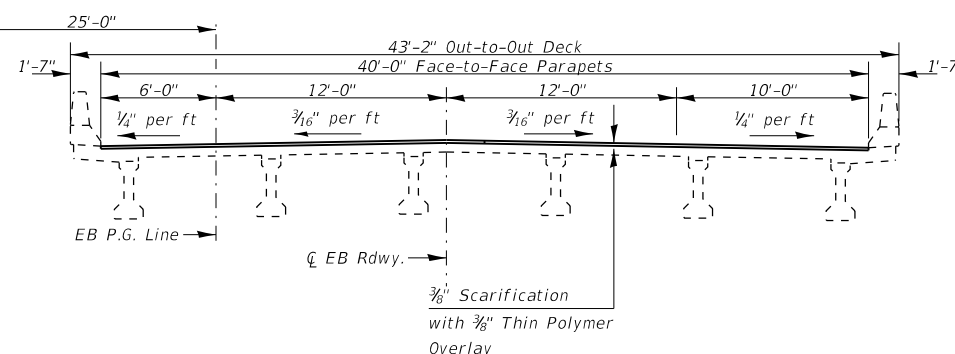

SECTION THROUGH STRUCTURE SHOWING BRIDGE DECK THIN POLYMER OVERLAY
All Sections Looking East

STAGING DETAILS
IL 13 OVER BANKSTON FORK
F.A.P. RTE 331 - D9 BRIDGE REPAIR 2020-4
WILLIAMSON COUNTY
STATION 478+26.63
STRUCTURE NO. 100-0068(71)

MODEL: Default
 FILE: \\hpc101\pub\hpc\room\adam\illinois.gov\PROJECTS\DOT Documents\DOT Office\Drawings\9\Projects\78738\CADD\Drawings\9\78738-Sheets.dgn

USER NAME = adamsm	DESIGNED -	REVISED -
PLOT SCALE = 10.0000' / in.	DRAWN -	REVISED -
PLOT DATE = 10/18/2019	CHECKED -	REVISED -
	DATE -	REVISED -

STATE OF ILLINOIS
DEPARTMENT OF TRANSPORTATION

STAGING DETAILS
SN 100-0068(71)

SCALE: SHEET 2 OF 3 SHEETS STA. TO STA.

F.A.P. RTE.	SECTION	COUNTY	TOTAL SHEETS	SHEET NO.
*	D9 BRIDGE REPAIR 2020-4	VARIOUS	21	20
* 331/841			CONTRACT NO. 78738	
		ILLINOIS	FED. AID PROJECT	

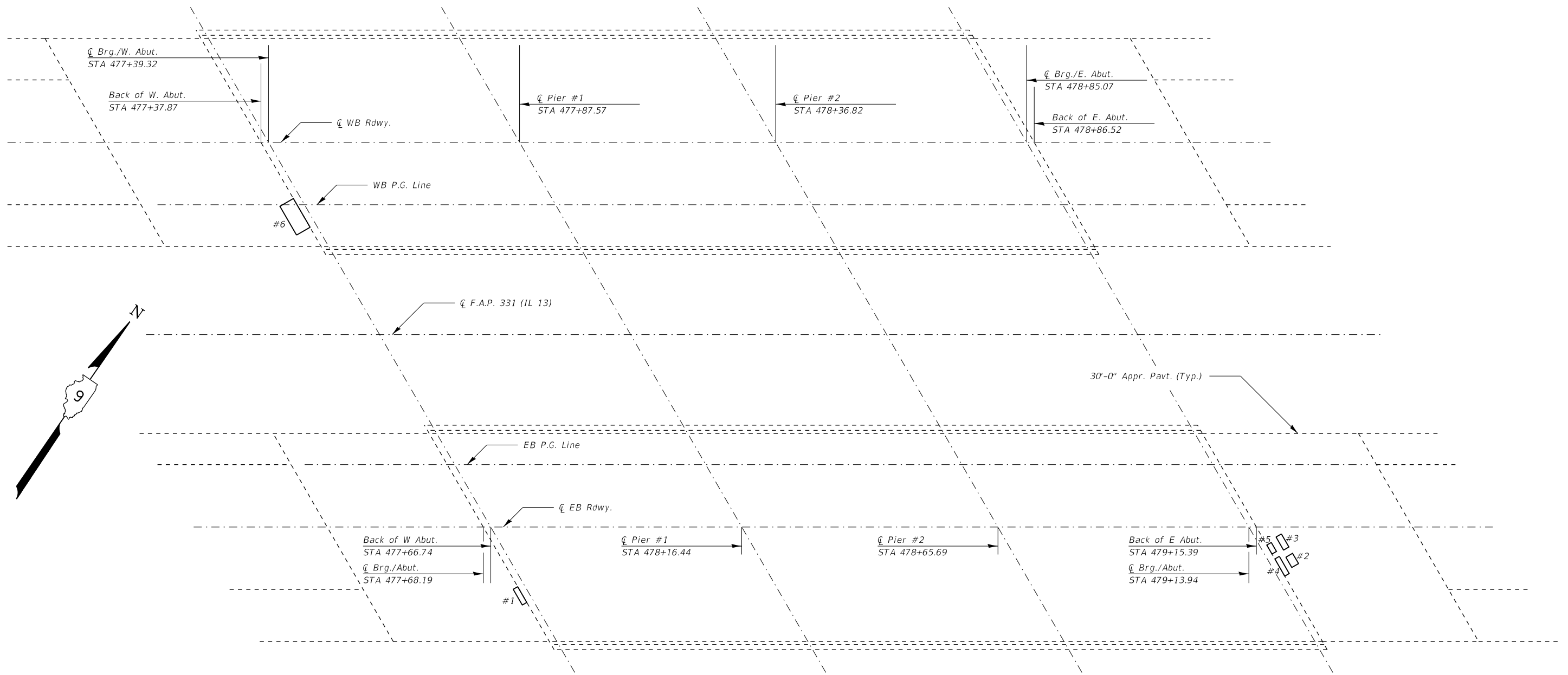

Notes: Deck Sounding was performed in April 2019.
 The Resident Engineer will determine final patch locations and quantities in the field before bridge deck patching operations begin and mark on as-built plans.

APPROACH SLAB REPAIR (PARTIAL)

PATCH NO.	Dist. from ζ	LENGTH	WIDTH	AREA
#1	15'	1.0'	3.5'	3.5 Sq Ft
#2	9'	1.5'	2.3'	3.5 Sq Ft
#3	5'	1.2'	2.9'	3.5 Sq Ft
#4	9'	1.0'	3.8'	3.8 Sq Ft
#5	5'	1.0'	2.0'	2.0 Sq Ft
#6	15'	3'	6.4'	19.2 Sq Ft
TOTAL				4 Sq Yd

**PARTIAL DEPTH APPROACH SLAB REPAIRS
 IL 13 OVER BANKSTON FORK
 F.A.P. RTE 331 - D9 BRIDGE REPAIR 2020-4
 WILLIAMSON COUNTY
 STATION 478+26.63
 STRUCTURE NO. 100-0068(71)**

MODEL: Default
 FILE: \\blm01\p00\pub\blm0000\dot\Documents\DOT - Offices\blm01\dot\Projects\78738\CADD\blm0000\CADD\blm0000\78738-Sheets.dgn

USER NAME = adamsam	DESIGNED -	REVISED -
	DRAWN -	REVISED -
PLOT SCALE = 20.0000' / in.	CHECKED -	REVISED -
PLOT DATE = 10/18/2019	DATE -	REVISED -

**STATE OF ILLINOIS
 DEPARTMENT OF TRANSPORTATION**

**PARTIAL DEPTH APPROACH PATCH SLAB REPAIRS
 SN 100-0068(71)**

SCALE: SHEET 3 OF 3 SHEETS STA. TO STA.

F.A.P. RTE.	SECTION	COUNTY	TOTAL SHEETS	SHEET NO.
* 331/841	D9 BRIDGE REPAIR 2020-4	VARIOUS	21	21
			CONTRACT NO. 78738	
		ILLINOIS	FED. AID PROJECT	