

STATE OF ILLINOIS  
DEPARTMENT OF TRANSPORTATION

F.A.U. R.T.E.	SECTION	COUNTY	TOTAL SHEETS	SHEET NO.
9105	119B-1BDS-4	MADISON	15	1
		ILLINOIS	CONTRACT NO. 76R13	

FOR INDEX OF SHEETS, SEE SHEET NO. 2

PROPOSED  
HIGHWAY PLANS

FAU ROUTE 9105 (SALISBURY ST.)  
SECTION 119B-1BDS-4  
PROJECT NHPP-7QIA(833)  
BRIDGE DECK SEALING  
MADISON COUNTY

C-98-098-22

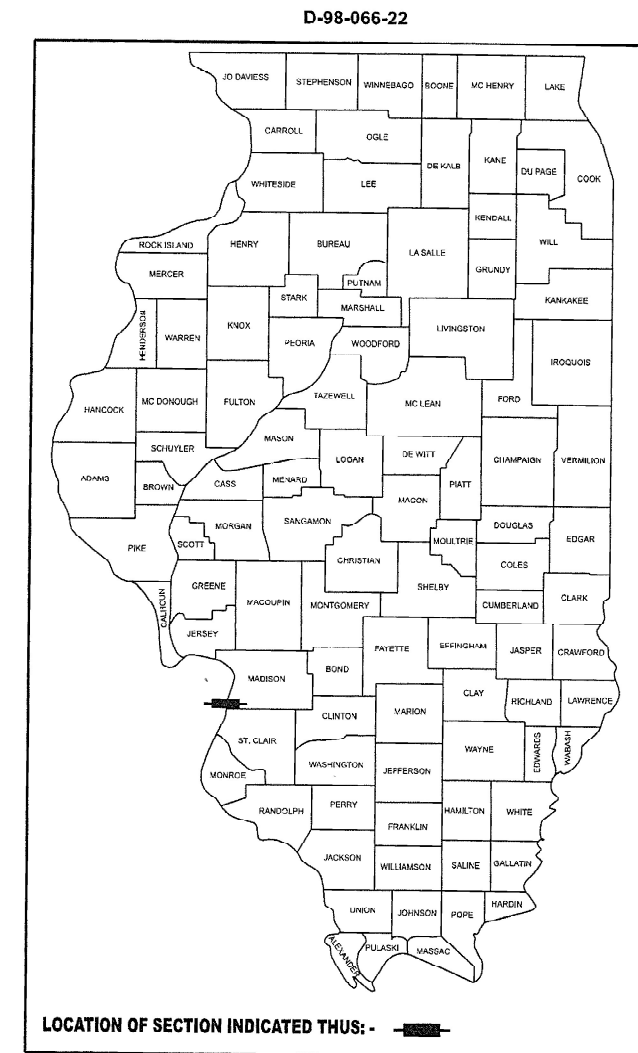

PROJECT LOCATION  
MCKINLEY BRIDGE  
SN 060-6002  
LAT: 38.66511  
LONG: -90.18257

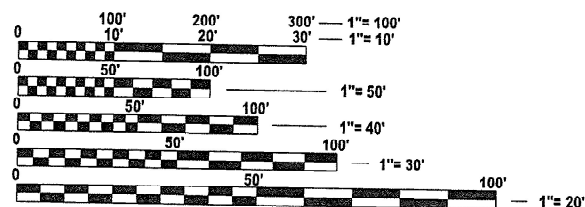

FULL SIZE PLANS HAVE BEEN PREPARED USING STANDARD ENGINEERING SCALES. REDUCED SIZED PLANS WILL NOT CONFORM TO STANDARD SCALES. IN MAKING MEASUREMENTS ON REDUCED PLANS, THE ABOVE SCALES MAY BE USED.

J.U.L.I.E.  
JOINT UTILITY LOCATION INFORMATION FOR EXCAVATION  
1-800-892-0123  
OR 811

PROJECT ENGINEER: BILLIE OWEN  
PROJECT MANAGER: MICHAEL BERG

CONTRACT NO. 76R13

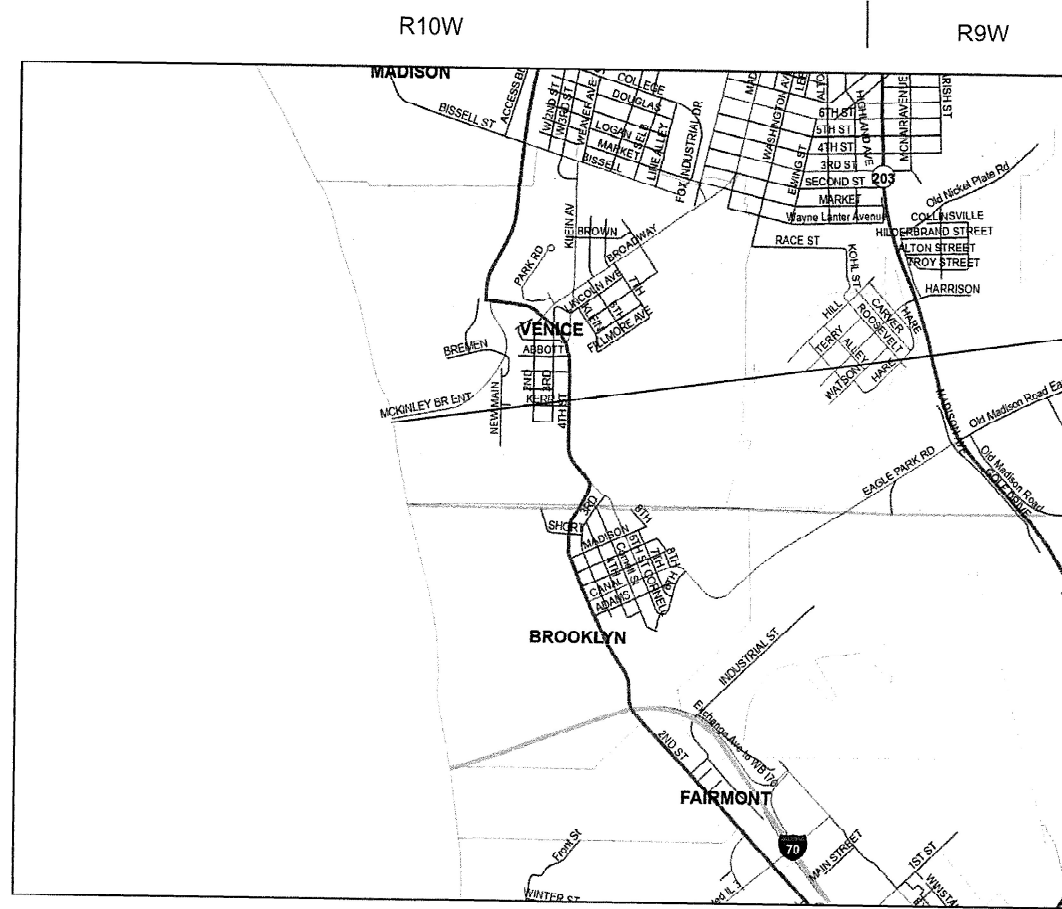

GROSS / NET LENGTH = 5734.25 FT. = 1.086 MILE

STATE OF ILLINOIS  
DEPARTMENT OF TRANSPORTATION

SUBMITTED Oct 1, 2024  
Kil HR  
REGIONAL ENGINEER

December 6, 2024  
See E.A. Elk  
ENGINEER OF DESIGN AND ENVIRONMENT

December 6, 2024  
James J. [Signature]  
DIRECTOR OF HIGHWAYS PROJECT IMPLEMENTATION

PRINTED BY THE AUTHORITY  
OF THE STATE OF ILLINOIS

## INDEX OF SHEETS

1	COVER SHEET
2	INDEX OF SHEETS, HIGHWAY STANDARDS, GENERAL NOTES AND COMMITMENTS
3	SUMMARY OF QUANTITIES
4-9	TYPICAL SECTIONS
10	SCHEDULE OF QUANTITIES
11	EXISTING PLAN AND ELEVATION
12-15	TRAFFIC CONTROL DETAILS

## HIGHWAY STANDARDS

00001-08	STANDARD SYMBOLS, ABBREVIATIONS AND PATTERNS
001006	DECIMAL OF AN INCH AND OF A FOOT
701901-10	TRAFFIC CONTROL DEVICES
BLR21-9	TYPICAL APPLICATION OF TRAFFIC CONTROL DEVICES FOR CONSTRUCTION OF RURAL LOCAL HIGHWAYS

## GENERAL NOTES

- UTILITIES KNOWN TO HAVE FACILITIES WITHIN THE PROJECT AREA:  
 AMEREN ILLINOIS  
 AT&T ILLINOIS  
 EXPLORER PIPELINE COMPANY  
 METRO EAST SANITARY DISTRICT  
 SPIRE NGL
- NO SURVEY WAS PERFORMED FOR THIS PROJECT AND THE PLANS WERE CREATED USING MICROFILM AND FIELD MEASUREMENTS.
- THE RESIDENT ENGINEER SHALL VERIFY THE EXISTENCE OF HIGHWAY LIGHTING, INTELLIGENT TRANSPORTATION SYSTEMS (I.T.S.) UTILITIES, AND/OR ELECTRICAL CABLES ASSOCIATED WITH TRAFFIC SIGNALS WITHIN THE PROJECT LIMITS. IF ANY OF THESE EXIST WITHIN THE PROJECT LIMITS, AND IF THESE ITEMS REQUIRE LOCATING, THE CONTRACTOR SHALL BE DIRECTED TO DO SO ACCORDING TO SECTION 803 OF THE STANDARD SPECIFICATIONS. THIS WORK SHALL BE PAID FOR ACCORDING TO ARTICLE 109.04 OF THE STANDARD SPECIFICATIONS.
- THE DEPARTMENT STRONGLY ENCOURAGES THE PRIME CONTRACTOR AND THEIR APPROVED SUB-CONTRACTORS TO HIRE MINORITY, WOMEN AND DISADVANTAGED INDIVIDUALS FROM ITS FEDERALLY FUNDED HIGHWAY CONSTRUCTION CAREERS TRAINING PROGRAM (HCCTP) TO HELP MEET WORKFORCE AND TRAINEE GOALS. THIS PROGRAM IS TRAINING MINORITIES, WOMEN AND DISADVANTAGED INDIVIDUALS IN HIGHWAY CONSTRUCTION-RELATED SKILLS, E.G., MATH FOR THE TRADES, JOB READINESS, TECHNICAL SKILLS COURSEWORK (CARPENTRY, CONCRETE FLATWORK, BLUEPRINT READING, SITE PLANS, SITE WORK, TOOLS USE, ETC.) AND OSHA 10 HOUR CERTIFICATION, TO PREPARE THEM FOR A CAREER IN THE HIGHWAY CONSTRUCTION TRADES. GRADUATES ARE WELL-TRAINED AND READY TO BECOME PRODUCTIVE ENTRY-LEVEL CONSTRUCTION WORKERS. CONTACT THE DISTRICT 8 EEO OFFICE AT 618-346-3360 AND/OR THE HCCTP COORDINATOR AT 618-874-6528 TO LEARN MORE ABOUT THE PROGRAM AND FOR ASSISTANCE IN MEETING WORKFORCE AND TRAINEE GOALS.
- 6 CHANGEABLE MESSAGE SIGNS SHALL BE REQUIRED FOR THIS PROJECT. THEY SHALL BE PLACED 2 WEEKS PRIOR TO ANY LANE CLOSURE AND SHALL REMAIN UP FOR THE DURATION OF THE PROJECT. THE CHANGEABLE MESSAGE SIGNS SHALL BE PLACED AT THE DIRECTION OF THE ENGINEER.
- THE BIKE TRAIL SHALL NOT BE SEALED.
- THE GAP BETWEEN THE IMPACT ATTENUATORS FROM STA. 89+97 TO STA. 90+54 AND FROM STA. 109+47.5 TO STA. 110+12.5 SHALL BE SEALED UP TO THE PAVEMENT JOINT.
- DELINEATOR FOR MEDIAN BARRIER SEPARATOR ARE TO BE INSTALLED AT THE DIRECTION OF THE ENGINEER.

## COMMITMENTS

NONE

MODEL: Untitled-2 [Sheet]  
 FILE NAME: c:\pwworking\challandes\1022286\0876R13-sh-hgmmnole.dgn

USER NAME = karen.challandes	DESIGNED -	REVISED -	<b>STATE OF ILLINOIS DEPARTMENT OF TRANSPORTATION</b>	<b>INDEX OF SHEETS, HIGHWAY STANDARDS, GENERAL NOTES AND COMMITMENTS</b>	FAU RTE	SECTION	COUNTY	TOTAL SHEETS	SHEET NO.	
	DRAWN -	REVISED -			9105	119B-1BDS-4	MADISON	15	2	
	CHECKED -	REVISED -			CONTRACT NO. 76R13					
PLOT DATE = 7/25/2024	DATE -	REVISED -			SCALE:	SHEET	OF	SHEETS	STA.	TO STA.
					ILLINOIS   FED. AID PROJECT					

80% FED  
20% STATE

CODE NO.	ITEM	UNIT	TOTAL QUANTITY	CONSTR. CODE
				BRIDGE 0047 S.N. 060-6002
67100100	MOBILIZATION	L SUM	1	1
70107025	CHANGEABLE MESSAGE SIGN	CAL DA	102	102
78100300	REPLACEMENT REFLECTOR	EACH	72	72
X5870015	BRIDGE DECK CONCRETE SEALER	SQ FT	240964	240964
X6350010	DELINEATOR FOR MEDIAN BARRIER SEPARATOR	EACH	79	79
X7010216	TRAFFIC CONTROL AND PROTECTION, (SPECIAL)	L SUM	1	1

MODEL: [Untitled (Sheet)]  
 FILE NAME: c:\p\work\pww\challandes\1022296\0876R13-sh-500.dgn

USER NAME = karen.challandes	DESIGNED -	REVISED -
	DRAWN -	REVISED -
	CHECKED -	REVISED -
PLOT DATE = 9/11/2024	DATE -	REVISED -

**STATE OF ILLINOIS**  
**DEPARTMENT OF TRANSPORTATION**

**SUMMARY OF QUANTITIES**

SCALE: SHEET OF SHEETS STA. TO STA.

F.A.U. RTE.	SECTION	COUNTY	TOTAL SHEETS	SHEET NO.
9105	119B-BDS-4	MADISON	15	3
CONTRACT NO. 76R13				
ILLINOIS FED. AID PROJECT				

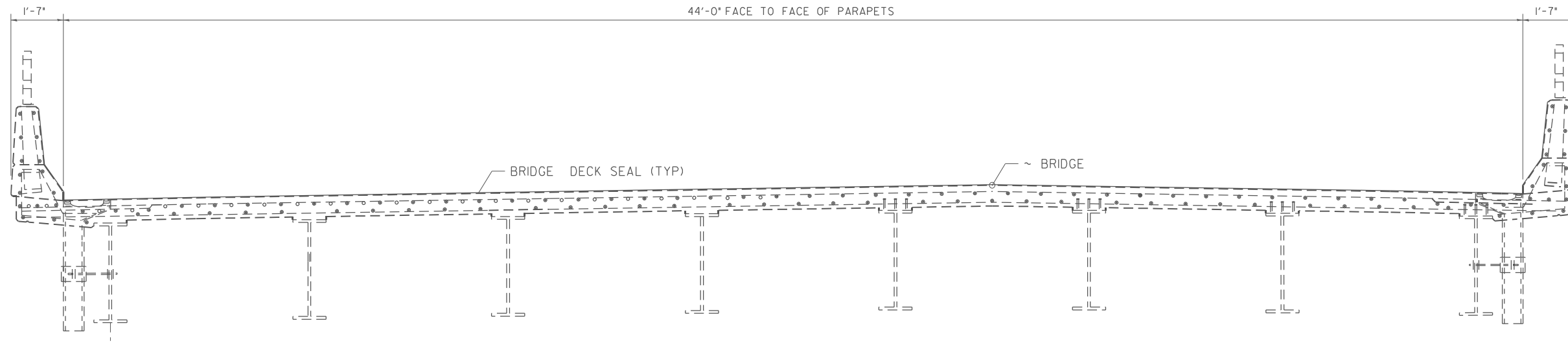

**TYPICAL SECTION**

STA. 61+02 TO STA. 62+47.5

(NOT TO SCALE)

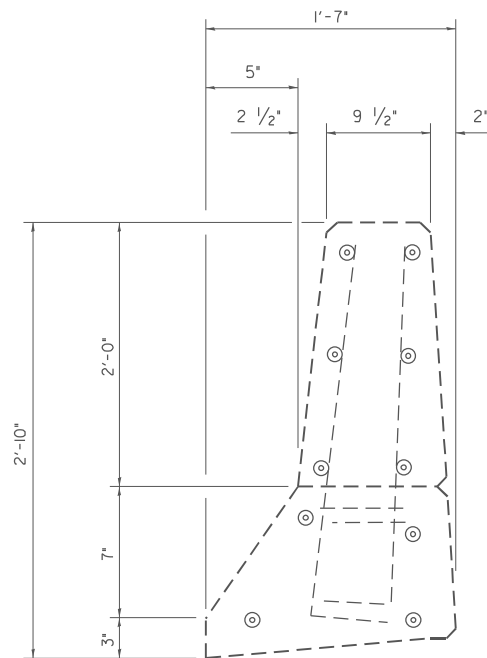

**TYPICAL PARAPET SECTION**

MODEL: Untitled (Sheet)  
FILE NAME: c:\p\work\wifidichallandes\ed1022286\0876R13-sh-typical.dgn

USER NAME = karen.challandes	DESIGNED -	REVISED -
	DRAWN -	REVISED -
	CHECKED -	REVISED -
PLOT DATE = 7/24/2024	DATE -	REVISED -

**STATE OF ILLINOIS  
DEPARTMENT OF TRANSPORTATION**

**TYPICAL SECTIONS**

SCALE: SHEET OF SHEETS STA. TO STA.

F.A.U. RTE.	SECTION	COUNTY	TOTAL SHEETS	SHEET NO.
9105	119B-1BDS-4	MADISON	15	4
CONTRACT NO. 76R13				
ILLINOIS FED. AID PROJECT				



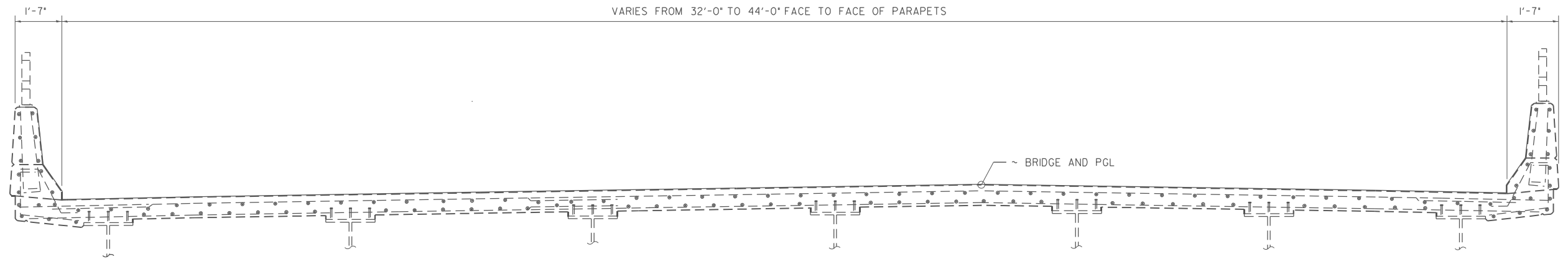

TYPICAL SECTION

STA. 62+47.5 TO 63+54.5

(NOT TO SCALE)

MODEL: Untitled-1 [Sheet]  
FILE NAME: c:\p\work\wv\challandes\022286\0876R13-sh-typical.dgn

USER NAME = karen.challandes	DESIGNED -	REVISED -
	DRAWN -	REVISED -
	CHECKED -	REVISED -
PLOT DATE = 7/24/2024	DATE -	REVISED -

**STATE OF ILLINOIS  
DEPARTMENT OF TRANSPORTATION**

**TYPICAL SECTIONS**

SCALE: SHEET OF SHEETS STA. TO STA.

F.A.U. RTE.	SECTION	COUNTY	TOTAL SHEETS	SHEET NO.
9105	119B-1BDS-4	MADISON	15	5
CONTRACT NO. 76R13				
ILLINOIS FED. AID PROJECT				

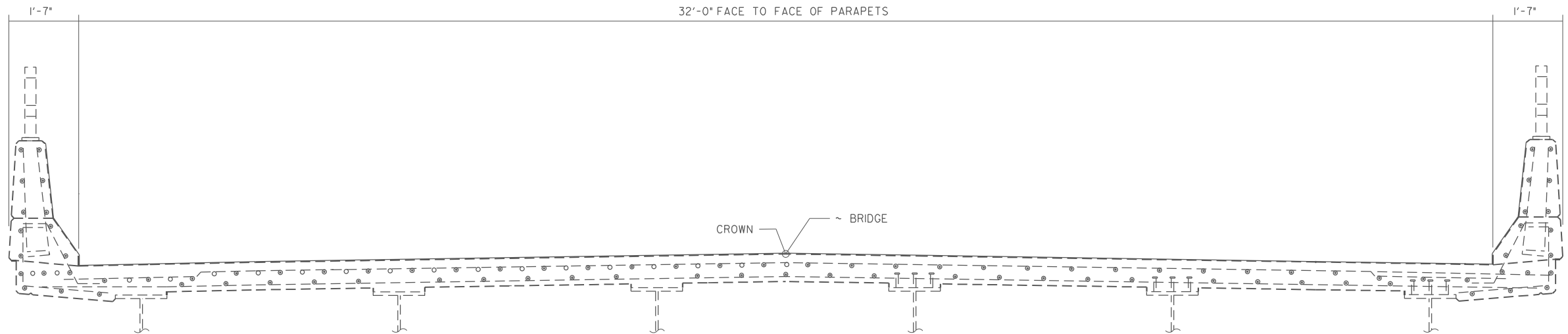

**TYPICAL SECTION**

STA. 63+54.5 TO 89+67.5

(NOT TO SCALE)

MODEL: Untitled2 [Sheet]  
FILE NAME: c:\p\work\challandes\022286\0876R13-sh-typical.dgn

USER NAME = karen.challandes	DESIGNED -	REVISED -
	DRAWN -	REVISED -
	CHECKED -	REVISED -
PLOT DATE = 7/24/2024	DATE -	REVISED -

**STATE OF ILLINOIS  
DEPARTMENT OF TRANSPORTATION**

**TYPICAL SECTIONS**

SCALE: SHEET OF SHEETS STA. TO STA.

F.A.U. RTE.	SECTION	COUNTY	TOTAL SHEETS	SHEET NO.
9105	119B-1BDS-4	MADISON	15	6
CONTRACT NO. 76R13				
ILLINOIS FED. AID PROJECT				

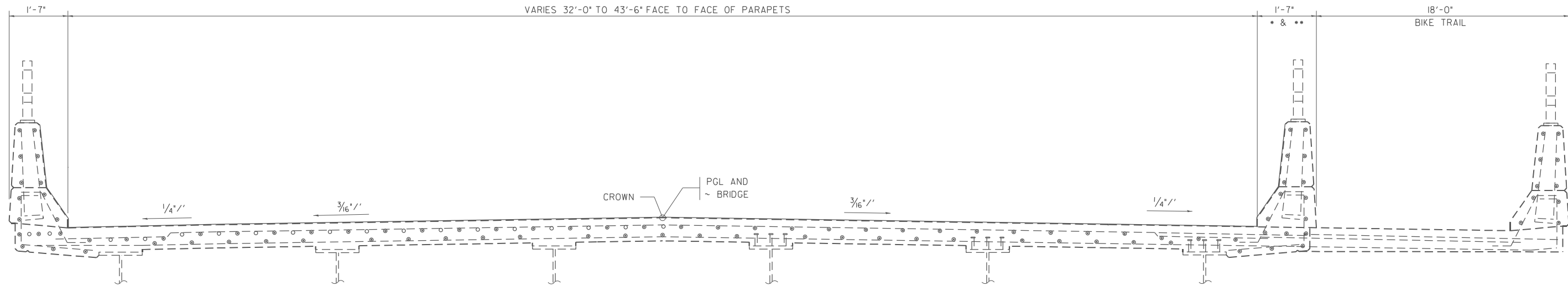

**TYPICAL SECTION**

STA. 89+67.5 TO STA. 92+17.5\*  
 STA. 107+82.5 TO STA. 110+32.5\*\*

\*IMPACT ATTENUATOR FROM STA. 89+77.5 TO STA. 89+94 AND FROM STA. 90+57 TO STA. 90+73.5 AND GAP FROM STA. 89+94 TO STA. 90+57  
 \*\*IMPACT ATTENUATOR FROM STA. 109+31 TO STA. 109+47.5 AND FROM STA. 110+12.5 TO STA. 110+29 AND GAP FROM STA. 109+47.5 TO STA. 110+12.5

MODEL: Untitled-3 [Sheet]  
 FILE NAME: c:\p\work\wv\challandes\022286\0876R13-sh-typical.dgn

USER NAME = karen.challandes	DESIGNED -	REVISED -
	DRAWN -	REVISED -
	CHECKED -	REVISED -
PLOT DATE = 7/24/2024	DATE -	REVISED -

**STATE OF ILLINOIS  
 DEPARTMENT OF TRANSPORTATION**

TYPICAL SECTIONS			
SCALE:	SHEET	OF SHEETS	STA. TO STA.

F.A.U. RTE.	SECTION	COUNTY	TOTAL SHEETS	SHEET NO.
9105	119B-1BDS-4	MADISON	15	7
CONTRACT NO. 76R13				
ILLINOIS FED. AID PROJECT				

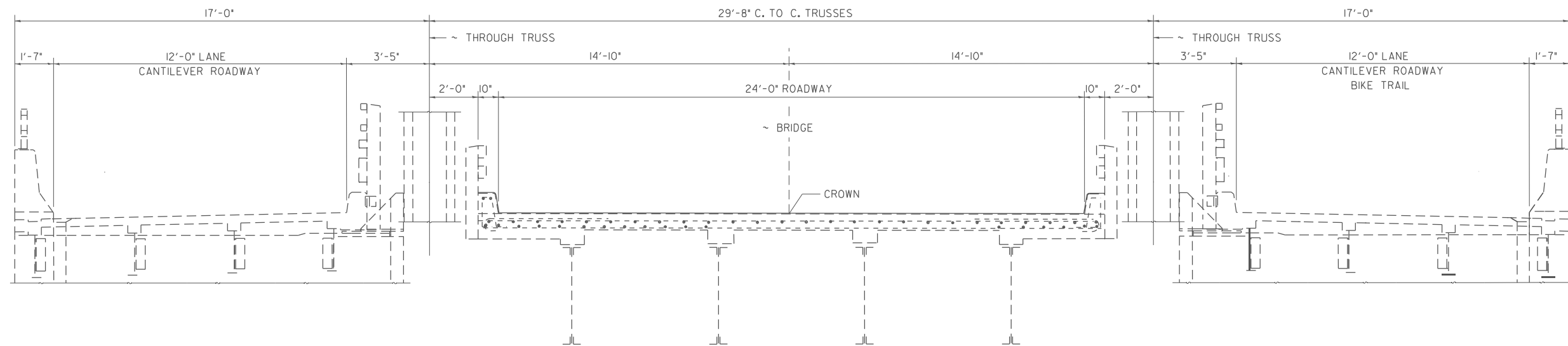

**TYPICAL SECTION**

STA. 92+17.5 TO STA. 107+82.5

(NOT TO SCALE)

NOTE: APPLY SEALER TO CURBS

MODEL: Untitled4 [Sheet]  
FILE NAME: c:\p\work\challandes\1022286\0876R13-sh-typical.dgn

USER NAME = karen.challandes	DESIGNED -	REVISED -
	DRAWN -	REVISED -
	CHECKED -	REVISED -
PLOT DATE = 7/24/2024	DATE -	REVISED -

**STATE OF ILLINOIS  
DEPARTMENT OF TRANSPORTATION**

**TYPICAL SECTIONS**

SCALE: SHEET OF SHEETS STA. TO STA.

F.A.U. RTE.	SECTION	COUNTY	TOTAL SHEETS	SHEET NO.
9105	119B-1BDS-4	MADISON	15	8
CONTRACT NO. 76R13				
ILLINOIS FED. AID PROJECT				

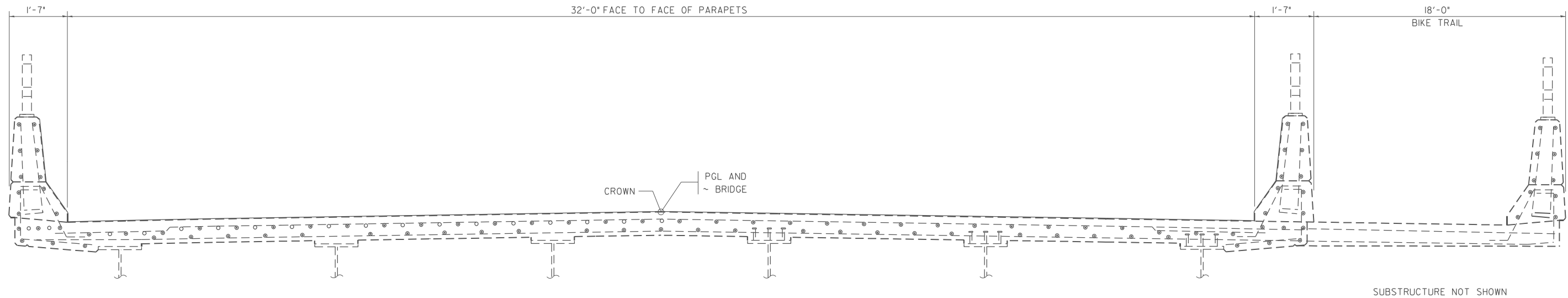

**TYPICAL SECTION**

STA. 110+32.5 TO STA. 118+36.25

(NOT TO SCALE)

MODEL: Untitled5 (Sheet)  
 FILE NAME: c:\p\work\w101challandes\1022286\0876R13-sh-typical.dgn

USER NAME = karen.challandes	DESIGNED -	REVISED -
	DRAWN -	REVISED -
	CHECKED -	REVISED -
PLOT DATE = 7/24/2024	DATE -	REVISED -

**STATE OF ILLINOIS**  
**DEPARTMENT OF TRANSPORTATION**

**TYPICAL SECTIONS**

SCALE: SHEET OF SHEETS STA. TO STA.

F.A.U. RTE.	SECTION	COUNTY	TOTAL SHEETS	SHEET NO.
9105	119B-1BDS-4	MADISON	15	9
CONTRACT NO. 76R13				
ILLINOIS FED. AID PROJECT				

### BRIDGE DECK CONCRETE SEALER

STA		STA	LENGTH FOOT	AVG WIDTH FOOT	DECK AREA	PARAPET HEIGHT	TOTAL PARAPET AREA	GAP TO
					TO BE SEALED	TO BE SEALED	TO BE SEALED	BE SEALED
					SQ FT	FOOT	SQ FT	SQ FT
61+02.00	TO	62+47.50	145.5	44	6402	3.8	1097.1	
62+47.50	TO	63+54.50	107.0	38	4066	3.8	806.8	
63+54.50	TO	89+67.50	2613.0	32	83616	3.8	19702.0	
89+67.50	TO	92+17.50	250.0	38	9500	3.8	1885.0	378
92+17.50	TO	107+82.50	1565.0	36	56340	4.4	13615.5	
107+82.50	TO	110+32.50	250.0	38	9500	3.8	1885.0	390
110+32.50	TO	118+36.25	803.8	32	25770	3.8	6060.3	
SUBTOTAL (SQ. FT.) =					195144		45051.6	768
BRIDGE DECK CONCRETE SEALER (SQ. FT.) =							240964	

### REFLECTORS

STATION	TO	STATION	RAISED REFLECTIVE
			PAVEMENT MARKER, REFLECTOR REPLACEMENT EACH
61+02	TO	118+36	72
			72

MODEL: Unlited.s (Sheet)  
FILE NAME: c:\p\work\wifidichallandes\022286\0876R13-sh-schedule.dgn

USER NAME = karen.challandes	DESIGNED -	REVISED -	<b>STATE OF ILLINOIS DEPARTMENT OF TRANSPORTATION</b>	<b>SCHEDULES OF QUANTITIES</b>				F.A.U. RTE.	SECTION	COUNTY	TOTAL SHEETS	SHEET NO.
	DRAWN -	REVISED -		SCALE:      SHEET      OF      SHEETS      STA.      TO STA.				9105	119B-1BDS-4	MADISON	15	10
	CHECKED -	REVISED -		CONTRACT NO. 76R13								
PLOT DATE = 9/10/2024	DATE -	REVISED -		ILLINOIS FED. AID PROJECT								

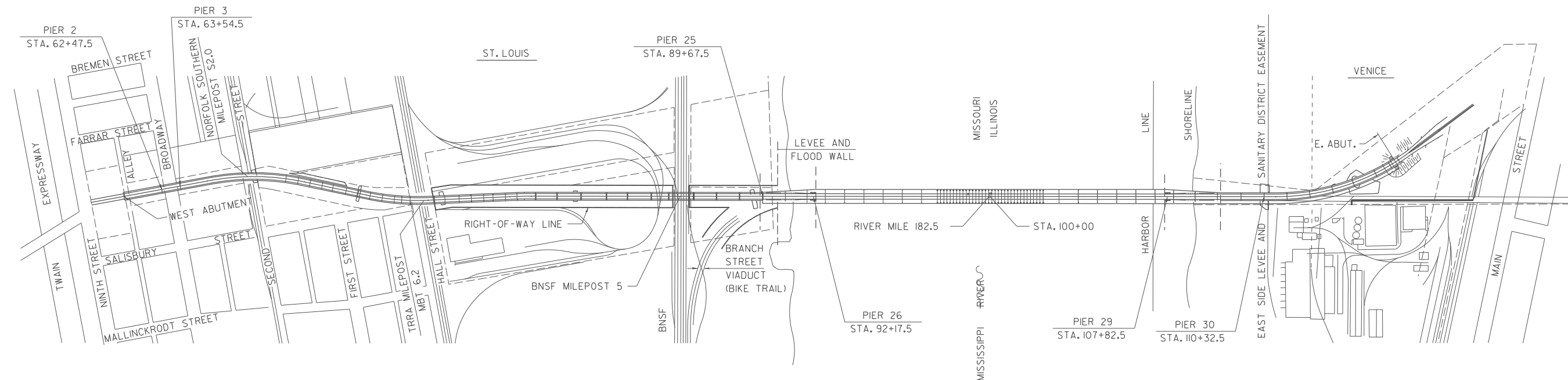

EXISTING PLAN

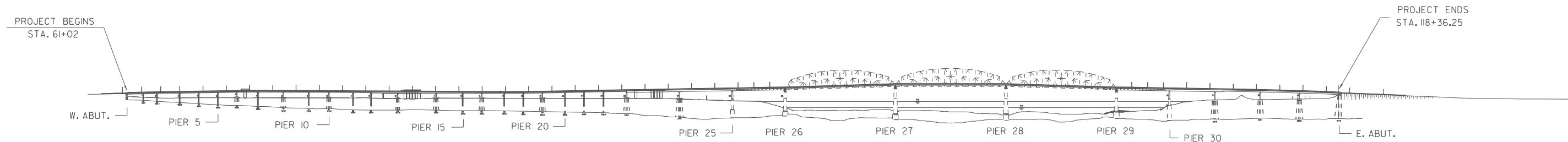

EXISTING ELEVATION

MODEL: Unlited66 (Sheet)  
 FILE NAME: c:\p\work\w101challandes\022226\0876R13-sh1-cyplcal.dgn

USER NAME = karen.challandes	DESIGNED -	REVISED -
	DRAWN -	REVISED -
	CHECKED -	REVISED -
PLOT DATE = 7/24/2024	DATE -	REVISED -

STATE OF ILLINOIS  
DEPARTMENT OF TRANSPORTATION

EXISTING PLAN AND ELEVATION

SCALE: SHEET OF SHEETS STA. TO STA.

F.A.U. RTE.	SECTION	COUNTY	TOTAL SHEETS	SHEET NO.
9105	119B-1BDS-4	MADISON	15	11
CONTRACT NO. 76R13				
ILLINOIS FED. AID PROJECT				



PROPOSED CHANGEABLE MESSAGE SIGN TO BE LOCATED ON EB I-70 1/2 MILE BEFORE EXIT 248A

CITY OF ST. LOUIS

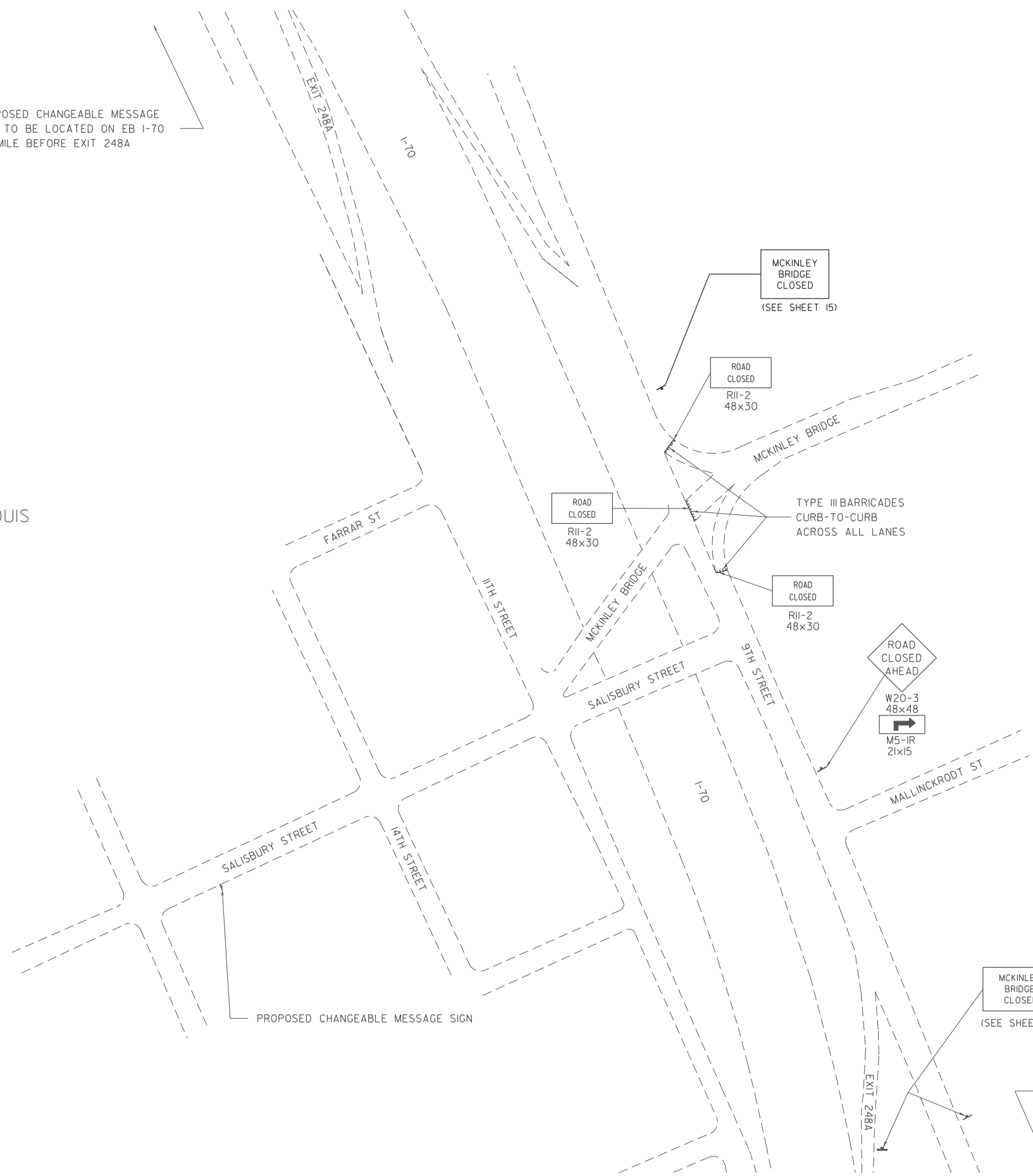

PROPOSED CHANGEABLE MESSAGE SIGN

MCKINLEY BRIDGE CLOSED (SEE SHEET 15)

PROPOSED CHANGEABLE MESSAGE SIGN TO BE LOCATED ON WB I-70 1/2 MILE BEFORE EXIT 248A

NOTE: ALL SIGN DIMENSIONS IN INCHES

MODEL: Unlited.dwg (Sheet)  
FILE NAME: c:\pwworking\challandes\1022286\0876R13-sh-detailed.dgn

USER NAME = karen.challandes	DESIGNED -	REVISED -
	DRAWN -	REVISED -
	CHECKED -	REVISED -
PLOT DATE = 9/4/2024	DATE -	REVISED -

**STATE OF ILLINOIS  
DEPARTMENT OF TRANSPORTATION**

**TRAFFIC CONTROL & PROTECTION  
(MISSOURI)**

SCALE: SHEET OF SHEETS STA. TO STA.

F.A.U. RTE.	SECTION	COUNTY	TOTAL SHEETS	SHEET NO.
9105	119B-1BDS-4	MADISON	15	12
CONTRACT NO. 76R13				
ILLINOIS FED. AID PROJECT				



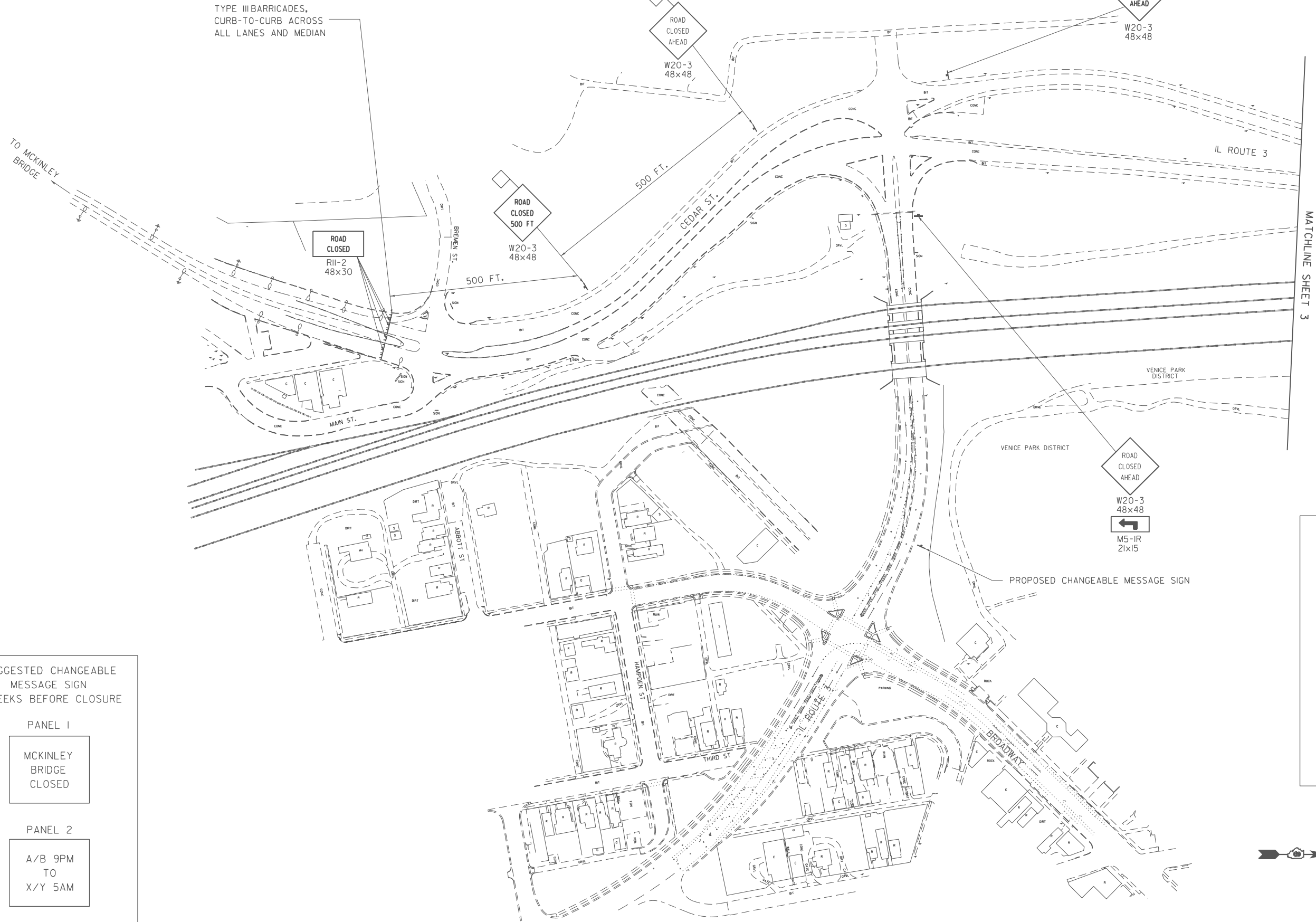

SUGGESTED CHANGEABLE MESSAGE SIGN  
2 WEEKS BEFORE CLOSURE

PANEL 1

MCKINLEY BRIDGE CLOSED

PANEL 2

A/B 9PM TO X/Y 5AM

SUGGESTED CHANGEABLE MESSAGE SIGN  
DURING CLOSURE

PANEL 1

MCKINLEY BRIDGE CLOSED

PANEL 2

USE ALT ROUTE

NOTE: ALL SIGN DIMENSIONS IN INCHES

MODEL: Unlited-7 (Sheet)  
FILE NAME: c:\p\work\wv\challandes\01022296\0876R13-shi-details.dgn

USER NAME = karen.challandes	DESIGNED -	REVISED -
	DRAWN -	REVISED -
	CHECKED -	REVISED -
PLOT DATE = 7/24/2024	DATE -	REVISED -

STATE OF ILLINOIS  
DEPARTMENT OF TRANSPORTATION

TRAFFIC CONTROL & PROTECTION  
(ILLINOIS)

SCALE: SHEET OF SHEETS STA. TO STA.

F.A.U. RTE.	SECTION	COUNTY	TOTAL SHEETS	SHEET NO.
9105	119B-1BDS-4	MADISON	15	13
CONTRACT NO. 76R13				
ILLINOIS FED. AID PROJECT				



PROPOSED CHANGEABLE MESSAGE SIGN

PROPOSED CHANGEABLE MESSAGE SIGN TO BE LOCATED ON SOUTHBOUND IL ROUTE 3, SOUTH OF I-270 RAMP (FINAL LOCATION TO BE DETERMINED BY THE ENGINEER)

MATCHLINE SHEET 2

TO I-270

MODEL: Untitled-8 (Sheet)  
FILE NAME: c:\pwwork\karenchallandes\1022286\0876R13-sh-detailed.dgn

USER NAME = karen.challandes	DESIGNED -	REVISED -
	DRAWN -	REVISED -
	CHECKED -	REVISED -
PLOT DATE = 7/24/2024	DATE -	REVISED -

**STATE OF ILLINOIS  
DEPARTMENT OF TRANSPORTATION**

**TRAFFIC CONTROL & PROTECTION  
ILLINOIS**

SCALE: SHEET OF SHEETS STA. TO STA.

F.A.U. RTE.	SECTION	COUNTY	TOTAL SHEETS	SHEET NO.
9105	119B-1BDS-4	MADISON	15	14
CONTRACT NO. 76R13				
ILLINOIS FED. AID PROJECT				

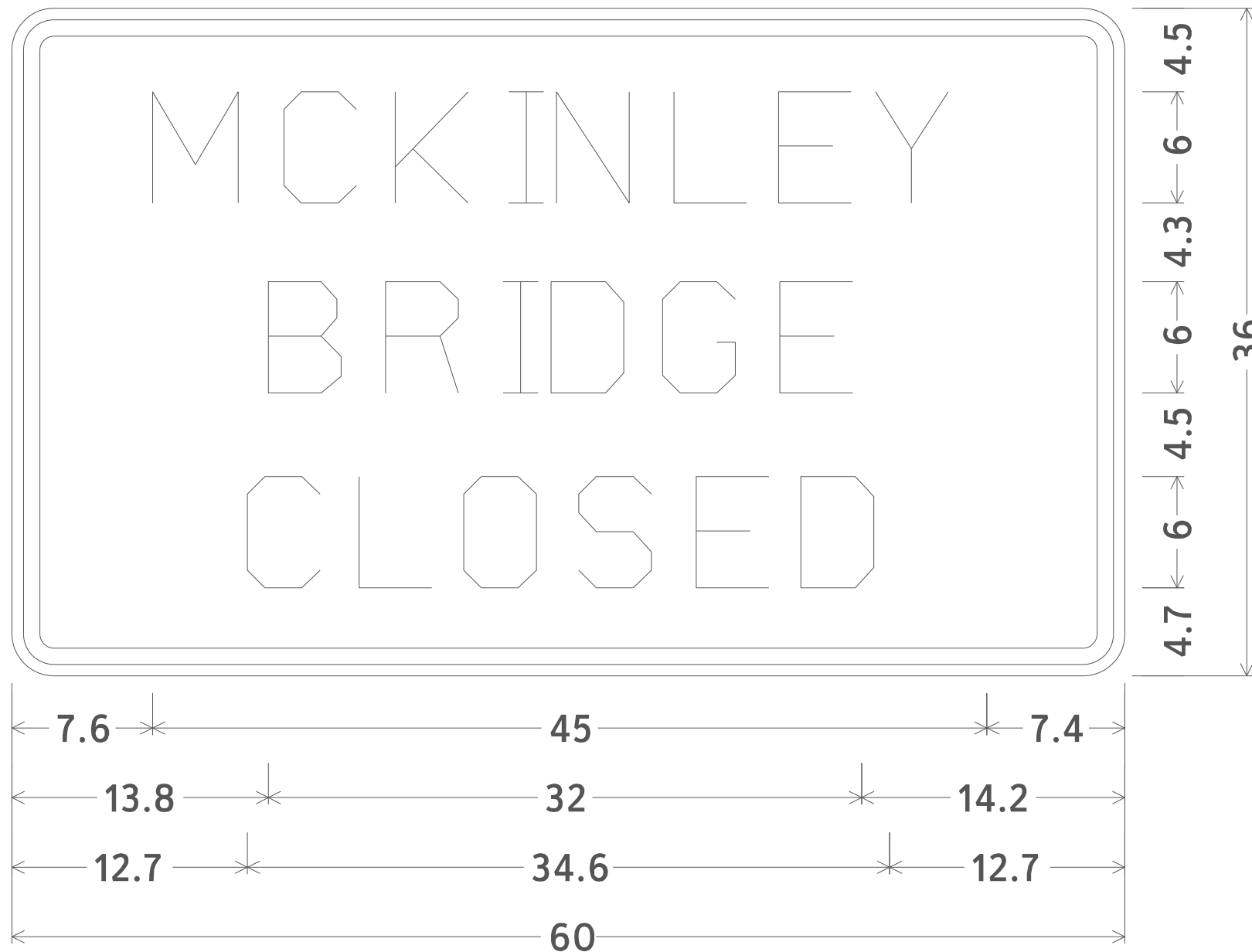

2.3" Radius, 0.9" Border, 0.6" Indent, Black on Orange;  
 [MCKINLEY] E; [BRIDGE] E; [CLOSED] E;

MODEL: Unlited.dwg (Sheet)  
 FILE NAME: c:\p\work\wv\challandes\01022256\0876R13-sh-detailed.dgn

USER NAME = karen.challandes	DESIGNED -	REVISED -
	DRAWN -	REVISED -
	CHECKED -	REVISED -
PLOT DATE = 7/24/2024	DATE -	REVISED -

STATE OF ILLINOIS  
 DEPARTMENT OF TRANSPORTATION

TRAFFIC CONTROL & PROTECTION  
 (MCKINLEY BRIDGE CLOSED SIGN DETAIL)

SCALE: SHEET OF SHEETS STA. TO STA.

F.A.U. RTE.	SECTION	COUNTY	TOTAL SHEETS	SHEET NO.
9105	119B-1BDS-4	MADISON	15	15
CONTRACT NO. 76R13			ILLINOIS FED. AID PROJECT	