

CHAMLIN & ASSOCIATES, INC. © 2023
 Drawing Name: G:\Users\1111489-00-Walnut Street Bridge Superstructure Replacement\CAD\002-GENERAL NOTES AND TYPICAL SECTIONS.dwg Last Modified: Tuesday, November 26, 2024 10:09:11 AM Plotted On: Monday, January 06, 2025 2:19:06 PM by Jim Cloward

INDEX OF SHEETS

- 1 COVER SHEET
- 2 GENERAL NOTES AND TYPICAL SECTION
- 3-5 SUMMARY OF QUANTITIES
- 6 SCHEDULE OF QUANTITIES
- 7 PLAN & PROFILE
- 8-10 STAGE CONSTRUCTION AND TRAFFIC CONTROL PLANS
- 11-42 BRIDGE PLANS
- 43 DETAILS

HIGHWAY STANDARDS

- 000001-08 STANDARD SYMBOLS, ABBREVIATIONS AND PATTERNS
- 001006 DECIMAL OF AN INCH AND OF A FOOT
- 515001-04 NAME PLATE FOR BRIDGES
- 606001-08 CONCRETE CURB TYPE B AND COMBINATION CONCRETE CURB AND GUTTER
- 701006-05 OFF-ROAD OPERATIONS, 2L, 2W, 15' TO 24" FROM PAVEMENT EDGE
- 701311-03 LANE CLOSURE, 2L, 2W, MOVING OPERATIONS - DAY ONLY
- 701316-14 LANE CLOSURE, 2L, 2W, BRIDGE REPAIR
- 701321-19 LANE CLOSURE, 2L, 2W, BRIDGE REPAIR WITH BARRIER
- 701501-06 URBAN LANE CLOSURE, 2L, 2W, UNDIVIDED
- 701801-06 SIDEWALK, CORNER OR CROSSWALK CLOSURE
- 701901-10 TRAFFIC CONTROL DEVICES
- 704001-08 TEMPORARY CONCRETE BARRIER
- 780001-05 TYPICAL PAVEMENT MARKINGS
- 782006-01 GUARDRAIL AND BARRIER WALL REFLECTOR MOUNTING DETAILS

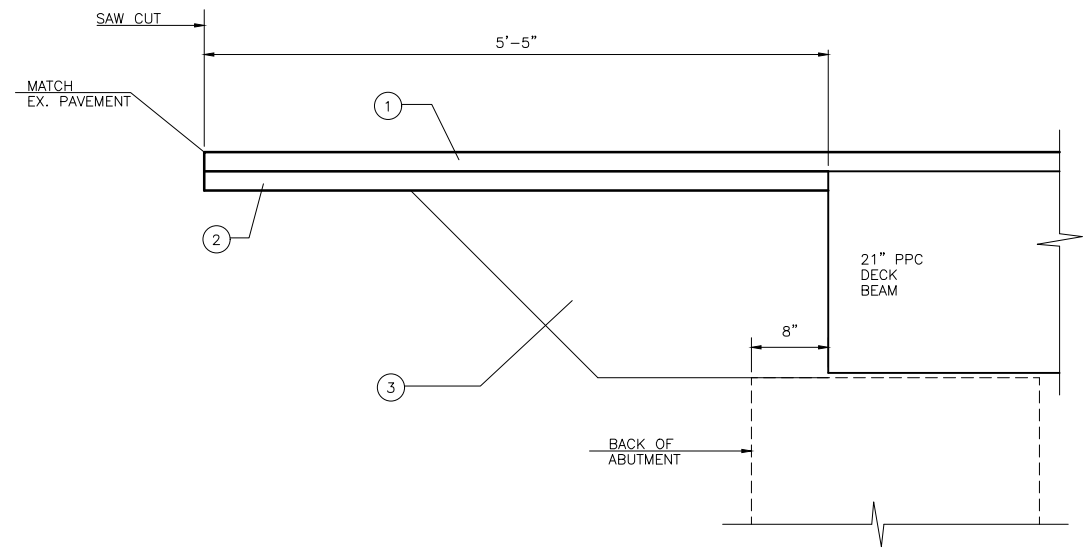

TYPICAL SECTION AT END OF DECK

LEGEND

- ① POLYMERIZED, HOT-MIX ASPHALT SURFACE COURSE, STONE MATRIX ASPHALT, 9.5 MIX "C" N50 1 1/2"
- ② POLYMERIZED HOT-MIX ASPHALT BINDER COURSE, IL 4.75, N50 2 1/2"
- ③ AGGREGATE BASE COURSE, TYPE A

HMA MIXTURE REQUIREMENT TABLE

LOCATIONS:	ENTIRE PROJECT	ENTIRE PROJECT
MIXTURE USE(S):	HMA	HMA
BINDER	BINDER	SURFACE
BINDER GRADE (PG):	SBS PG70-28	SBS PG70-28
DESIGN AIR VOIDS:	4.0% @ N50	4.0% @ N50
MIXTURE COMPOSITION:	IL 4.75	SMA 9.5
(MIXTURE GRADATION)		
FRICTION AGGREGATE:		MIXTURE C
MIXTURE WEIGHT:	112.0 LB/SY/IN	112.0 LB/SY/IN
QUALITY MANAGEMENT PROGRAM:	QCQA	QCQA
SUBLOT SIZE:	NA	NA
DENSITY TEST METHOD:	NUCLEAR	NUCLEAR
MATERIAL TRANSFER DEVICE (REQUIRED):	NO	NO

GENERAL NOTES

THE ENGINEER WILL BE THE SOLE JUDGE CONCERNING CURING TIME FOR THE VARIOUS HMA LIFTS.

ALL ELEVATIONS REFERRING TO U.S.G.S. MEAN SEA LEVEL DATUM.

THE FOLLOWING RATES OF APPLICATION HAVE BEEN USED IN CALCULATING PLAN QUANTITIES:

GRANULAR MATERIALS	2.05	TONS / CU YD
HMA RESURFACING	112	LBS / SQ YD / IN

COMMITMENTS

NO WORK SHALL BE DONE OVER THE RAILROAD BETWEEN JANUARY 1 AND MARCH 31.

"CONTRACT NO. 87852

DRAWN BY: JJW	LEVEL	BY	DATE	REVISIONS	DESCRIPTION
CHECKED BY: JKC			1/6/2025	1	
DATE: 01/2024					

CA
 Chamlin & Associates
 PERU MORRIS
 OTTAWA MORTON
 ILLINOIS

**WALNUT STREET BRIDGE
 SECTION 20-00821-00-BR
 LASALLE COUNTY**

**INDEX OF SHEETS
 GENERAL NOTES AND TYPICAL SECTION**

**CONSTRUCTION
 PLANS**

CURRENT AS OF: 10/21/2024	
SCALE: AS NOTED	SHEET 2
FILE NO.: 111489.00 Y-	OF 43