



Illinois Department of Transportation

Office of Intermodal Project Implementation / Division of Aeronautics
1 Langhorne Bond Drive / Springfield, Illinois 62707-8415

January 7, 2025

SUBJECT: St. Louis Downtown Airport
Cahokia Heights, Illinois
St. Clair County
Illinois Project Number: CPS-5078
SBG Project Number: 3-17-SBGP-TBD
Contract No. SD064
Item No. 09A, January 17, 2025 Letting
Addendum A

NOTICE TO PROSPECTIVE BIDDERS

Attached is an addendum to the plans or proposal. This addendum involves revised and/or added material.

Reason for Addendum:

Modifications/Additions to Pavement Marking work items

To All Plan Holders:

Plan Changes:

On Plan Sheet No. 3, Summary of Quantities, the AR620 pay items and quantities are revised as noted below in "Schedule of Prices Changes".

On Plan Sheet Nos. 45, 46 and 47, Proposed Marking Plans and Details, revisions change the proposed 12" wide yellow taxiway centerline markings to 6" wide, and add pavement marking removal and painting on the Runway 12R/30L pavement.

Special Provision Changes:

In Special Provision Item 620, a new pay item, AR620900, has been added.

Schedule of Prices Changes:

The quantity for pay item AR620520, Pavement Marking-Waterborne, is revised to read **3,381 SQ FT.**

The quantity for pay item AR620525, Pavement Marking-Black Border, is revised to read **4,259 SQ FT.**

The quantity for pay item AR620900, Pavement Marking Removal, is added to read **308 SQ FT.**

Prime contractors must utilize the enclosed material when preparing their bid and must include any Schedule of Prices changes in their bidding proposal.

Bidders using computer-generated bids are cautioned to reflect any and all Schedule of Prices changes, if involved, into their computer programs.

Questions on this addendum may be directed to Barry Stolz, P.E., of Hanson Professional Services at 314.942.5288.



**ST. LOUIS
DOWNTOWN AIRPORT**
BI-STATE DEVELOPMENT
ST. LOUIS DOWNTOWN AIRPORT
6100 Archview Drive
Cahokia Heights, Illinois 62206

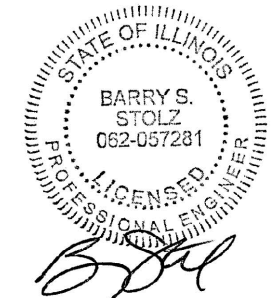

DATE SIGNED: 11/22/2024 LICENSE EXPIRES: 11/30/2025

TAXIWAY B RELOCATION,
PHASE 3: SOUTHEAST &
TAXIWAY B1 INTERSECTION

IDA NO.: CPS-5078
CONTRACT NO.: SD064

NO.	DATE	DESCRIPTION			
		DES	DWN	REV	
△	01/06/25	LEAD-IN MARKING	JRH	JRH	BSS

ISSUE: NOVEMBER 22, 2024

PROJECT NO: 23A0001D

CAD FILE: G-002-FLP.DWG

DESIGN BY: JRH 1/16/2024

DRAWN BY: NLD 1/16/2024

REVIEWED BY: BSS 4/19/2024

SHEET TITLE

SUMMARY OF
QUANTITIES

SUMMARY OF QUANTITIES - BASE BID

ITEM NO.	DESCRIPTION	UNIT	TOTAL QUANTITY	AS-BUILT QUANTITY
AR107508	L-806 WC 8' INTERNALLY LIT	EACH	1	
AR108066	REIL CABLE	FOOT	540	
AR108108	1/C #8 5 KV UG CABLE	FOOT	25,260	
AR109200	INSTALL ELECTRICAL EQUIPMENT	L SUM	1	
AR110012	2" DIRECTIONAL BORE	FOOT	960	
AR110202	2" PVC DUCT, DIRECT BURY	FOOT	13,590	
AR125416	MITL-BASE MOUNTED-LED	EACH	98	
AR125565	SPLICE CAN	EACH	21	
AR125964	RELOCATE TAXI GUIDANCE SIGN	EACH	7	
AR150510	ENGINEER'S FIELD OFFICE	L SUM	1	
AR150520	MOBILIZATION	L SUM	1	
AR150530	TRAFFIC MAINTENANCE	L SUM	1	
AR152410	UNCLASSIFIED EXCAVATION	CU YD	17,221	
AR156500	TEMPORARY EROSION CONTROL	L SUM	1	
AR156530	TEMPORARY SEEDING	ACRE	7.21	
AR208540	OVERSIZE AGGREGATE	TON	21,073	
AR209510	CRUSHED AGGREGATE BASE COURSE	TON	7,306	
AR306606	LEAN CONCRETE BASE COURSE - 6"	SQ YD	11,744	
AR401613	BIT. SURF. CSE.-METHOD I, SUPERPAVE	TON	945	
AR401650	BITUMINOUS PAVEMENT MILLING	SQ YD	3,857	
AR403613	BIT. BASE CSE.-METHOD I, SUPERPAVE	TON	638	
AR501512	12" PCC PAVEMENT	SQ YD	11,399	
AR501530	PCC TEST BATCH	EACH	1	
AR501910	REMOVE & REPLACE PCC PAVEMENT	SQ YD	192	
AR602510	BITUMINOUS PRIME COAT	GALLON	779	
AR603510	BITUMINOUS JACK COAT	GALLON	512	
AR620520	PAVEMENT MARKING-WATERBORNE	SQ FT	3,381	
AR620525	PAVEMENT MARKING-BLACK BORDER	SQ FT	4,259	
AR620900	PAVEMENT MARKING REMOVAL	SQ FT	308	
AR701900	REMOVE PIPE	FOOT	810	
AR705506	6" PERFORATED UNDERDRAIN	FOOT	4,186	
AR705548	8" NON PERFORATED UNDERDRAIN	FOOT	210	
AR705620	UNDERDRAIN END SECTION	EACH	2	
AR705635	UNDERDRAIN COLLECTION STRUCTURE	EACH	2	
AR705640	UNDERDRAIN CLEANOUT	EACH	8	
AR800469	REMOVE BITUMINOUS & PCC PAVEMENT	SQ YD	11,473	
AR800476	REMOVE AIRFIELD LIGHTING	L SUM	1	
AR800538	TAXI SIGN 2 MODULE, LED UPGRADE	EACH	11	
AR800539	TAXI SIGN 3 MODULE, LED UPGRADE	EACH	7	
AR800540	TAXI SIGN 4 MODULE, LED UPGRADE	EACH	2	
AR800564	CABLE & CCR TESTING & CALIBRATION	L SUM	1	
AR901510	SEEDING	ACRE	7.21	
AR908514	LIGHT-DUTY HYDRAULIC MULCH	ACRE	7.21	

SUMMARY OF QUANTITIES - ADDITIVE ALTERNATE BID

ITEM NO.	DESCRIPTION	UNIT	TOTAL QUANTITY	AS-BUILT QUANTITY
AS109200	INSTALL ELECTRICAL EQUIPMENT	L SUM	1	

EARTHWORK QUANTITY SUMMARY

CALCULATION	CUT (CY)	FILL (CY)	FILL + 20% (CY)	NET (CY)
CPS-5078	17,221	5,338	6,405	10,816 (EXCESS)
TOTAL	17,221**	5,338	6,405	10,816 (EXCESS)

** USED TO CALCULATE AR152410 PAY ITEM QUANTITY

EARTHWORK NOTES:

- EARTHWORK QUANTITIES (CUT/FILL VOLUMES) SHOWN ABOVE WERE CALCULATED UTILIZING AUTODESK CIVIL3D SOFTWARE THROUGH AUTOCAD. THE CALCULATION METHOD WAS BY A COMPARISON OF SURFACE MODELS CREATED WITH EXISTING SURVEY DATA AND PROPOSED DESIGN GRADES. THE VOLUMES WERE CALCULATED IN TWO PARTS: THE CUT/FILL VOLUME REQUIRED TO CORE OUT AND FILL FOR THE PROPOSED PAVEMENT SECTION AS COMPARED TO THE EXISTING SUBGRADE DATUM, AND THE CUT/FILL VOLUMES REQUIRED FOR PROPOSED GRADING WORK OUTSIDE OF THE PROPOSED PAVEMENT LIMITS AS COMPARED TO THE EXISTING GROUND SURFACE. THE NUMBERS IN THE SUMMARY TABLES ABOVE REPRESENT A TOTAL OF THESE TWO PARTS ADDED TOGETHER FOR CLARITY.
- ANOTHER PROJECT (CPS-4839) WITHIN THIS PROJECT'S CONSTRUCTION AREA IS ANTICIPATED TO BE CONSTRUCTED PRIOR TO OR CONCURRENT WITH THIS PROJECT. THE PROPOSED DRAINAGE IMPROVEMENTS AND GRADING HAVE BEEN REFLECTED IN THIS PROJECT AS EXISTING, HOWEVER THE ACTUAL ITEMS LOCATION AND ELEVATIONS MAY VARY SLIGHTLY. THE CONTRACTOR WILL BE PROVIDED A COPY OF THE RECORD DRAWINGS ONCE AVAILABLE.
- FOLLOWING THE PROJECT AWARD, THE ENGINEER CAN PROVIDE THE RELEVANT AUTOCAD AND CIVIL 3D SURFACE MODEL FILES TO THE AWARDED CONTRACTOR UPON REQUEST TO ASSIST WITH CONSTRUCTION LAYOUT.
- EXCESS MATERIAL TO BE PLACED ON STOCKPILE AS IDENTIFIED ON THE PLANS, AND GRADED TO DRAIN AT A MAINTAINABLE SLOPE (MAX 4:1). DISTURBED AREAS OF STOCKPILE SHALL BE RESTORED WITH TEMPORARY SEEDING, SEEDING AND MULCHING IN ACCORDANCE WITH THE SPECIFICATIONS AND PAID FOR UNDER THE RESPECTIVE 156, 901 AND 908 PAY ITEMS. AN ESTIMATED QUANTITY OF 1.50 ACRES OF TEMPORARY SEEDING, SEEDING AND MULCHING EACH HAVE BEEN INCLUDED WITHIN THE BID QUANTITIES FOR STOCKPILE RESTORATION.
- IF THE CONTRACTOR DOES NOT AGREE TO THE QUANTITIES DERIVED WITH THIS METHOD, THE CONTRACTOR MAY ELECT TO SURVEY THE EXISTING GRADES PRIOR TO BEGINNING EARTHWORK OPERATIONS AS PART OF THE PROJECT FOR THE ENGINEER TO REVIEW FOR A POTENTIAL ADJUSTMENT TO THE PAY ITEM QUANTITY. ANY COSTS ASSOCIATED WITH THE CONTRACTOR-PROVIDED SURVEY SHALL BE INCLUDED IN THE ORIGINAL BID AMOUNT, AND NO ADDITIONAL PAYMENT SHALL BE MADE. FOLLOWING THE CONTRACTOR'S VERIFICATION OF THE QUANTITIES, IF A DISAGREEMENT STILL EXISTS, THE MEASUREMENT OF THE EARTHWORK FOR PAYMENT SHALL BE MADE BY THE RESIDENT ENGINEER, PER THE 152 SPECIFICATION, WHO SHALL TAKE CROSS-SECTIONAL ELEVATIONS AND MEASUREMENTS OF THE EXISTING GROUND SURFACE AND THE FINAL GROUND GRADED SURFACE FOR COMPARISON.



ST. LOUIS DOWNTOWN AIRPORT
BI-STATE DEVELOPMENT
ST. LOUIS DOWNTOWN AIRPORT
6100 Archview Drive
Cahokia Heights, Illinois 62206

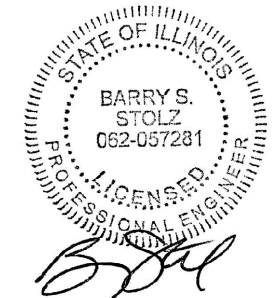

DATE: 11/22/2024
LICENSE: 062-057281
SIGNED: 11/22/2024
EXPIRES: 11/30/2025

TAXIWAY B RELOCATION,
PHASE 3: SOUTHEAST &
TAXIWAY B1 INTERSECTION

IDA NO.: CPS-5078
CONTRACT NO.: SD064

NO.	DATE	DESCRIPTION		
		DES	DWN	REV
△	01/06/25	JRH	JRH	BSS

ISSUE: NOVEMBER 22, 2024

PROJECT NO: 23A0001D

CAD FILE: C-151-MRK.DWG

DESIGN BY: JRH 3/17/2024

DRAWN BY: AJL 3/18/2024

REVIEWED BY: BSS 4/19/2024

SHEET TITLE

PROPOSED MARKING
PLAN STA. 150+50 TO
STA. 160+50

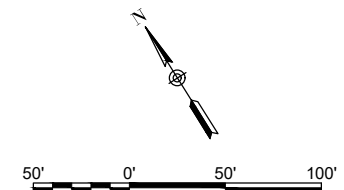
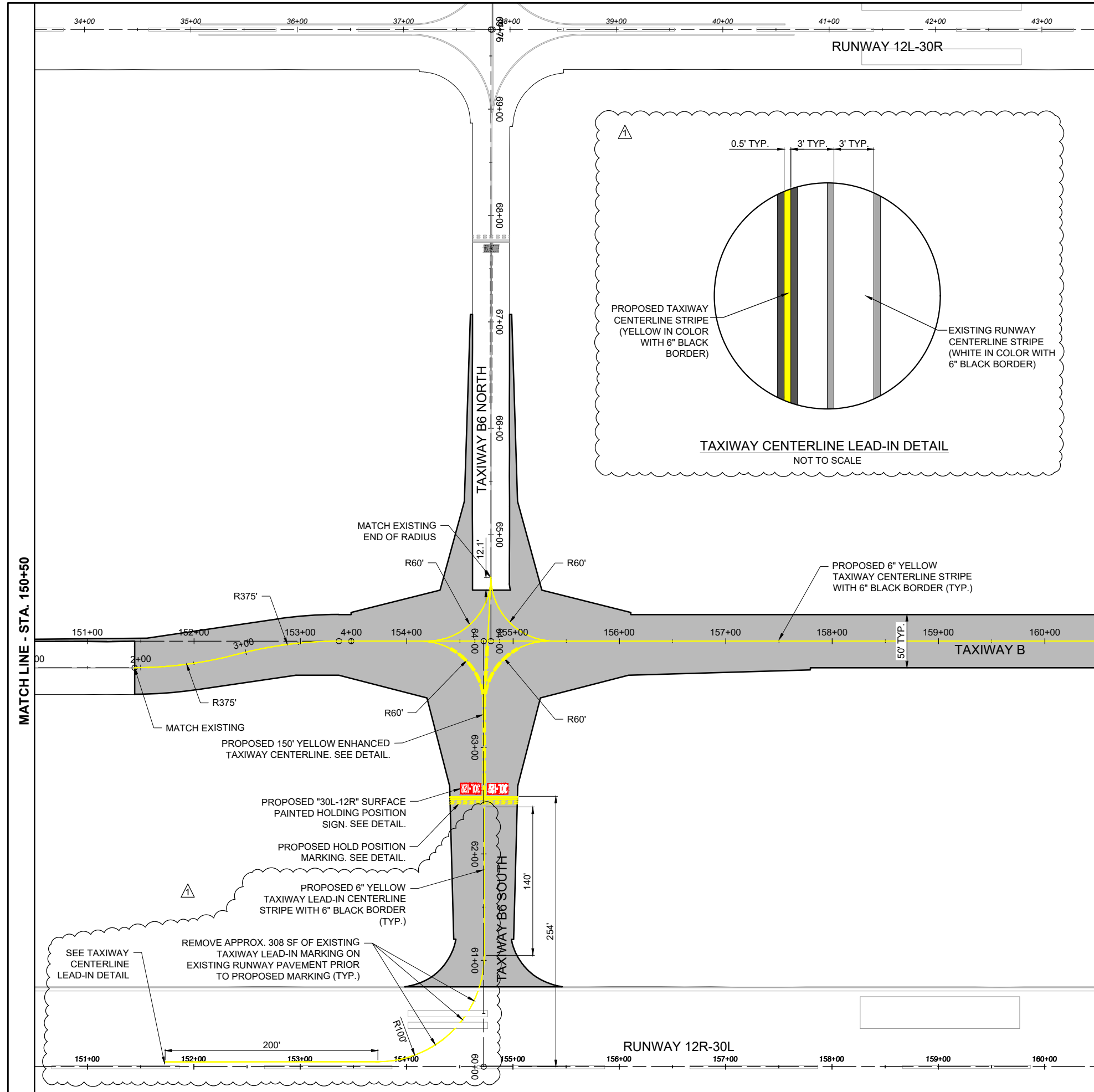

- LEGEND**
- EXISTING AIRPORT PROPERTY LINE
 - x- EXISTING FENCE
 - EXISTING PAVEMENT
 - >- EXISTING DITCH
 - w- EXISTING WATER
 - ss- EXISTING STORM SEWER
 - ud- EXISTING UNDERDRAIN
 - fo- EXISTING FIBER OPTIC
 - t- EXISTING TELEPHONE
 - c- EXISTING COMMUNICATION
 - █ PROPOSED PAVEMENT

MATCH LINE - STA. 160+50

MATCH LINE - STA. 150+50

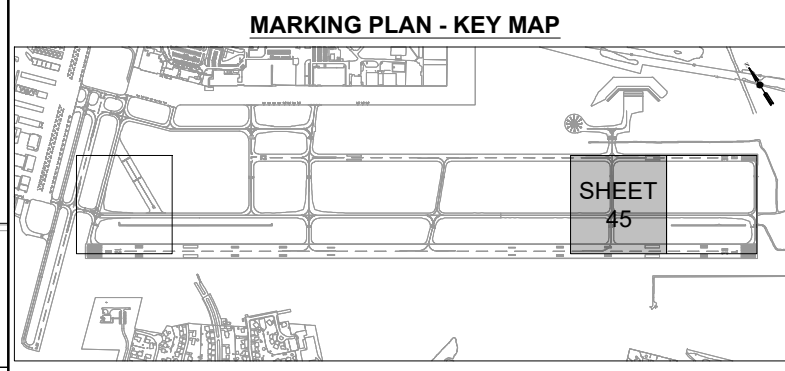

FOR BID

JAN 06, 2025 2:14 PM HERN001562
I:\23\JOBS\23A0001D\CAD\AIRPORT\LIBRARY\2024 CPS-5078 LIBRARY\G-BS-22X34_BORDER

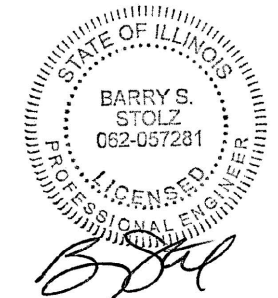

DATE: 11/22/2024
LICENSE: 11/30/2025

TAXIWAY B RELOCATION,
PHASE 3: SOUTHEAST &
TAXIWAY B1 INTERSECTION

IDA NO.: CPS-5078
CONTRACT NO.: SD064

NO.	DATE	DESCRIPTION		
		DES	DWN	REV
△	01/06/25	LEAD-IN MARKING		
		JRH	JRH	BSS

ISSUE: NOVEMBER 22, 2024
PROJECT NO: 23A0001D
CAD FILE: C-151-MRK.DWG
DESIGN BY: JRH 3/17/2024
DRAWN BY: AJL 3/18/2024
REVIEWED BY: BSS 4/19/2024

SHEET TITLE

PROPOSED MARKING
PLAN STA. 160+50 TO
STA. 170+50

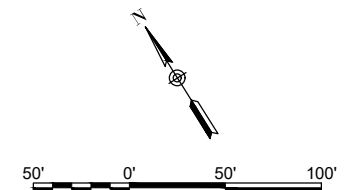
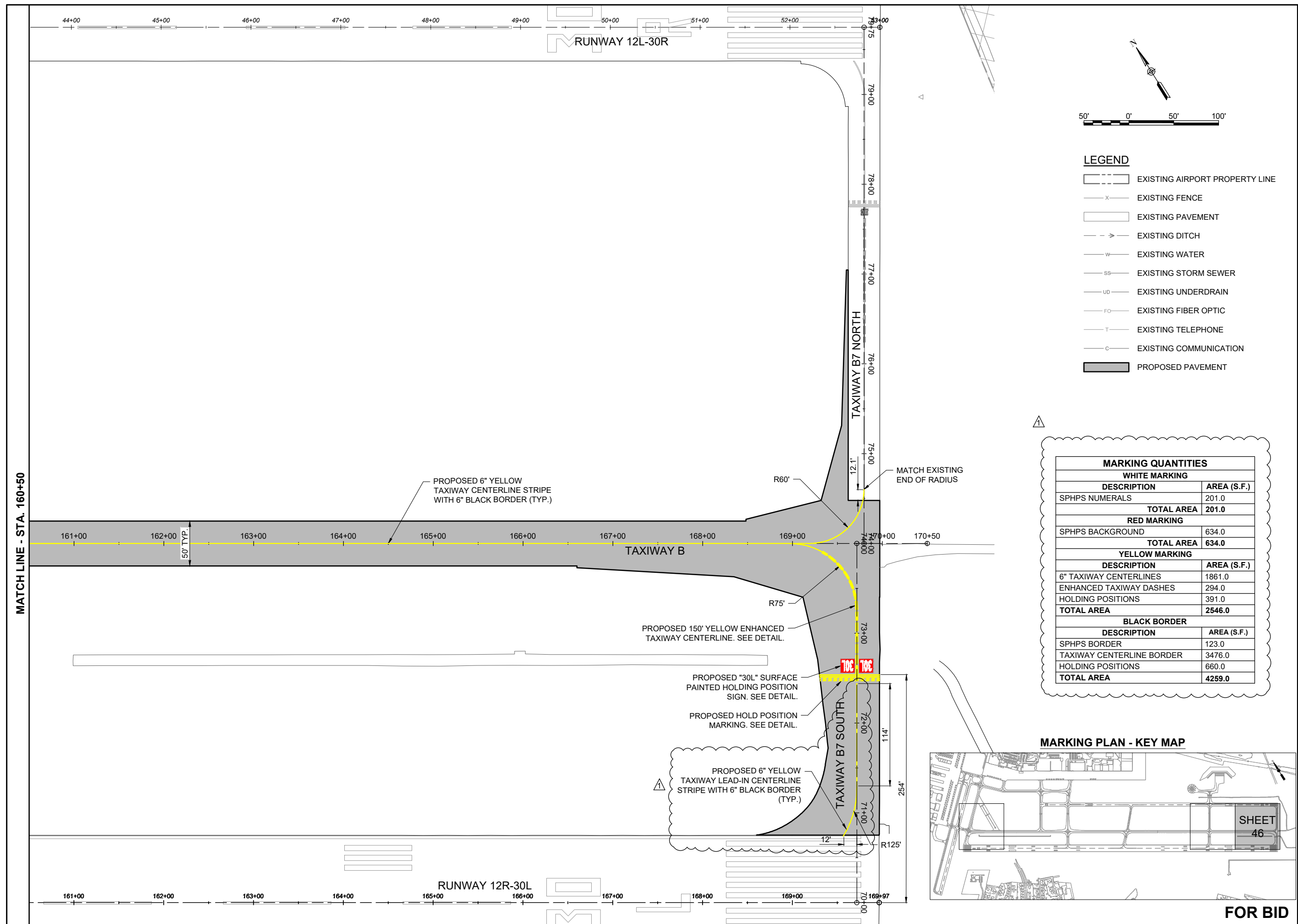

LEGEND

- EXISTING AIRPORT PROPERTY LINE
- EXISTING FENCE
- EXISTING PAVEMENT
- EXISTING DITCH
- EXISTING WATER
- EXISTING STORM SEWER
- EXISTING UNDERDRAIN
- EXISTING FIBER OPTIC
- EXISTING TELEPHONE
- EXISTING COMMUNICATION
- PROPOSED PAVEMENT

MARKING QUANTITIES

WHITE MARKING	
DESCRIPTION	AREA (S.F.)
SPHPS NUMERALS	201.0
TOTAL AREA	201.0
RED MARKING	
SPHPS BACKGROUND	634.0
TOTAL AREA	634.0
YELLOW MARKING	
6" TAXIWAY CENTERLINES	1861.0
ENHANCED TAXIWAY DASHES	294.0
HOLDING POSITIONS	391.0
TOTAL AREA	2546.0
BLACK BORDER	
DESCRIPTION	AREA (S.F.)
SPHPS BORDER	123.0
TAXIWAY CENTERLINE BORDER	3476.0
HOLDING POSITIONS	660.0
TOTAL AREA	4259.0

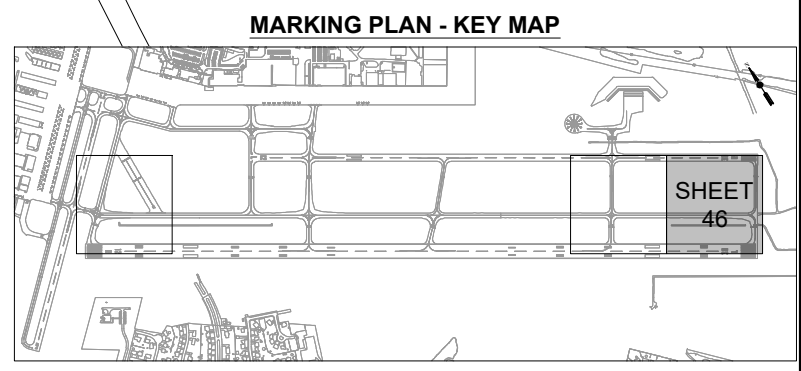

FOR BID

JAN 06 2025 2:15 PM HERN001562
I:\23\JOBS\23A0001\DCAD\AIRPORT\LIBRARY\2024\CPS-5078\LIBRARY\G-BS-22\34_BORDER

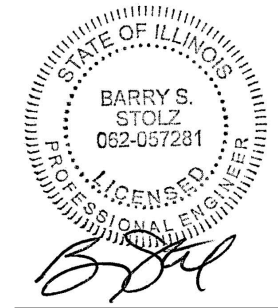

DATE SIGNED: 11/22/2024 LICENSE EXPIRES: 11/30/2025

TAXIWAY B RELOCATION,
PHASE 3: SOUTHEAST &
TAXIWAY B1 INTERSECTION

IDA NO.: CPS-5078
CONTRACT NO.: SD064

NO.	DATE	DESCRIPTION		
		DES	DWN	REV
△	01/06/25	JRH	JRH	BSS

ISSUE: NOVEMBER 22, 2024

PROJECT NO: 23A0001D

CAD FILE: C-501-MRK.DWG

DESIGN BY: JRH 3/18/2024

DRAWN BY: AJL 3/19/2024

REVIEWED BY: BSS 4/19/2024

SHEET TITLE

PAVEMENT MARKING
DETAILS - SHEET 1

FOR BID

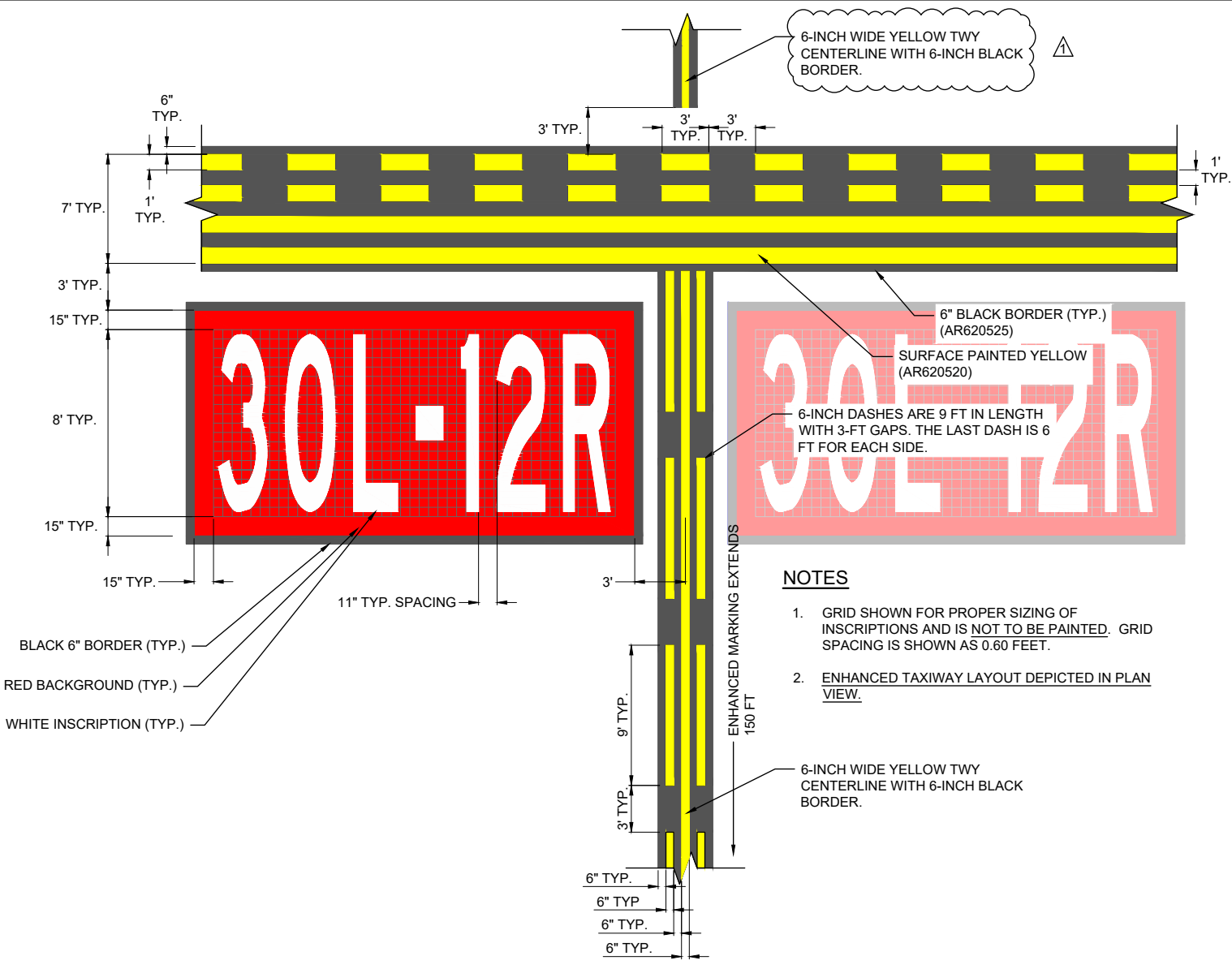

TAXIWAY B-6 HOLDING POSITION AND ENHANCED TAXIWAY CENTERLINE DETAIL
NOT TO SCALE

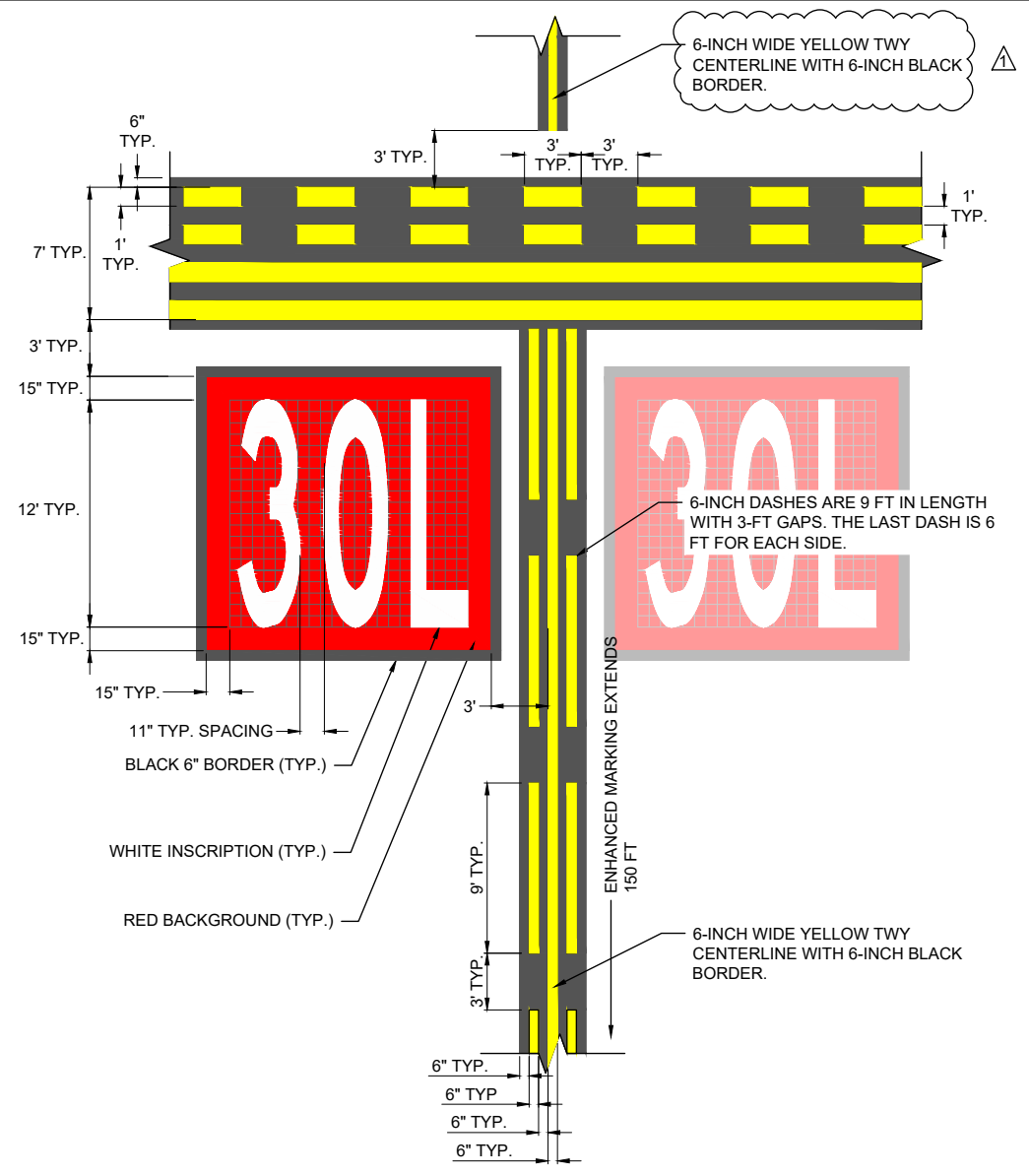

TAXIWAY B-7 HOLDING POSITION AND ENHANCED TAXIWAY CENTERLINE DETAIL
NOT TO SCALE

NOTES

1. GRID SHOWN FOR PROPER SIZING OF INSCRIPTIONS AND IS NOT TO BE PAINTED. GRID SPACING IS SHOWN AS 0.60 FEET.
2. ENHANCED TAXIWAY LAYOUT DEPICTED IN PLAN VIEW.

SURFACE PAINTED HOLDING POSITION SIGN NOTES:

1. SURFACE PAINTED HOLDING POSITION SIGNS SHALL BE PAINTED AT THE LOCATIONS SHOWN ON THE PAVEMENT MARKING PLAN SHEETS. THE CONTRACTOR SHALL FIELD VERIFY THAT THE SURFACE PAINTED HOLDING POSITION SIGNS MEET THE STANDARD DIMENSIONS SHOWN. THE CONTRACTOR SHALL NOTIFY THE RESIDENT ENGINEER OF ANY VARIATION FROM THE DIMENSIONS AND LOCATIONS SHOWN.
2. THE STENCILS FOR THE SURFACE PAINTED HOLDING POSITION SIGNS SHALL BE THE RESPONSIBILITY OF THE CONTRACTOR. AT THE CONCLUSION OF THE PROJECT, THE CONTRACTOR SHALL BE RESPONSIBLE FOR PROVIDING A SET OF STENCILS TO THE AIRPORT THAT MATCH THE SIGN DIMENSIONS PAINTED AT THIS AIRPORT.
3. THE SURFACE PAINTED HOLDING POSITION SIGNS SHALL BE ORIENTED PARALLEL TO THE RUNWAY HOLDING POSITION MARKING.
4. SURFACE PAINTED HOLDING POSITIONS SIGNS SHALL BE LOCATED BASED ON DIMENSIONS FROM THE TAXIWAY CENTERLINE AND RUNWAY HOLDING POSITION MARKING. IF THE TAXIWAY CENTERLINE AND THE RUNWAY HOLDING POSITION MARKING ARE NOT PERPENDICULAR TO TO EACH OTHER, THE DIMENSION FROM THE CENTERLINE SHALL BE MEASURED TO THE NEAREST POINT ON THE SURFACE PAINTED SIGN.

JAN 06 2025 10:56 PM STOLZ01547
I:\23\JOBS\23A0001\DCAD\AIRPORT\SHEET\024 CPS-5078 SHEETS\C-501-MRK

ITEM 620 RUNWAY AND TAXIWAY MARKING

MATERIALS

620-1.1 Add the following to this section:

“The paint used to mark the proposed pavements shall be Waterborne paint, Type II, in accordance with Item 620, section 620-2.3.a. The reflective media used in the permanent white and yellow paint shall meet the requirements for Federal Specification TT-B-1325D Type III. Reflective media shall not be used with temporary paint.”

CONSTRUCTION METHODS

620-3.8 Retro-reflectance. This section does not apply for this project.

BASIS OF PAYMENT

620-5.1 Add the following to this section:

“Payment will be made under:

Item AR620520 - Pavement Marking – Waterborne - per square foot
Item AR620525 - Pavement Marking – Black Border - per square foot
Item AR620900 - Pavement Marking Removal – per square foot.”

END OF ITEM 620