

F.A.U. RTE.	SECTION	COUNTY	TOTAL SHEETS
1321	31 RS-5	DUPAGE	19

STATE OF ILLINOIS
DEPARTMENT OF TRANSPORTATION
DIVISION OF HIGHWAYS

**PROPOSED
HIGHWAY PLANS**

F.A.U. 1321: IL ROUTE 19 (IRVING PARK RD.)
SECTION: 31 RS-5
WALNUT STREET TO EMMERSON AVENUE
RESURFACING (3P)
DUPAGE COUNTY
C-91-061-06

FOR INDEX OF SHEETS, SEE SHEET NO. 2

IMPROVEMENT LOCATED IN
THE VILLAGE OF ITASCA

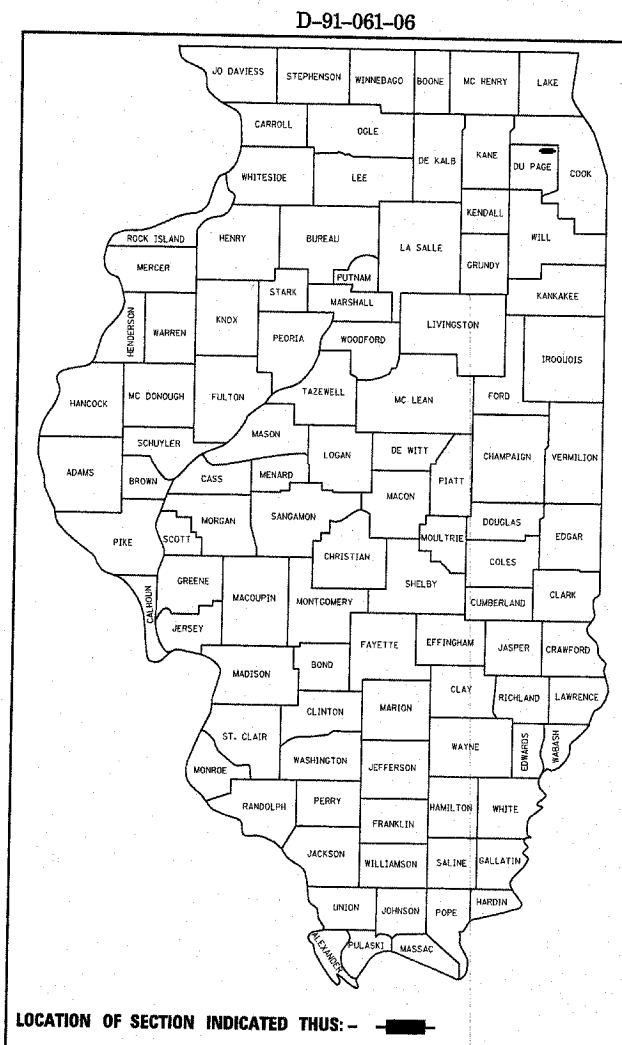

DISTRICT 1 DESIGN PLAN PREPARATION ENGINEER: KEN ENG /LONG TRAN (847) 705-4240

OMISSION:
STA 192+13 TO STA 211+50

IMPROVEMENT BEGINS
STATION 188+70

IMPROVEMENT ENDS
STATION 225+25

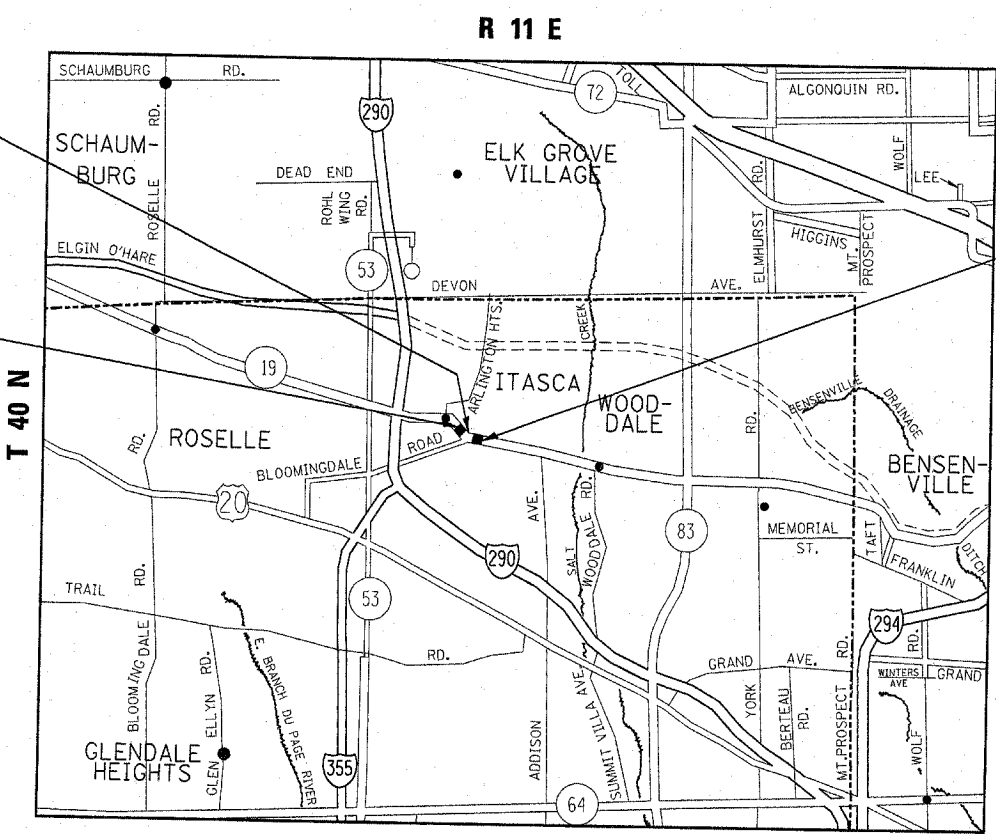

TRAFFIC DATA
2005 ADT = 21,400
POSTED SPEED LIMIT = 30-35 MPH



MAP SCALE
NOT TO SCALE

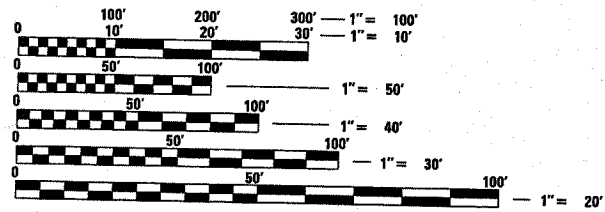

FULL SIZE PLANS HAVE BEEN PREPARED USING STANDARD ENGINEERING SCALES. REDUCED SIZED PLANS WILL NOT CONFORM TO STANDARD SCALES. IN MAKING MEASUREMENTS ON REDUCED PLANS, THE ABOVE SCALES MAY BE USED.

J.U.L.I.E.
JOINT UTILITY LOCATION INFORMATION FOR EXCAVATION
1-800-892-0123
OR 811

ADDISON TOWNSHIP

GROSS LENGTH OF IMPROVEMENT = 3,655 LINEAL FEET = 0.69 MILE
NET LENGTH OF IMPROVEMENT = 1,718 LINEAL FEET = 0.32 MILE

STATE OF ILLINOIS
DEPARTMENT OF TRANSPORTATION
DIVISION OF HIGHWAYS

SUBMITTED October 22, 2007

Diane O'Keefe
DEPUTY DIRECTOR OF HIGHWAYS, REGION ENGINEER
December 7, 2007

Eric E. Harn
Interim ENGINEER OF DESIGN AND ENVIRONMENT
December 7, 2007

Christine M. Reed
DIRECTOR OF HIGHWAYS, CHIEF ENGINEER

PRINTED BY THE AUTHORITY
OF THE STATE OF ILLINOIS