

F.A.P. RYE	SECTION	COUNTY	TOTAL SHEETS	SHEET NO.
850 339	2006-007	KANE/KENDALL	38	6
STA.	TO STA.			
FED. ROAD DIST. NO.	ILLINOIS FED. AID PROJECT			

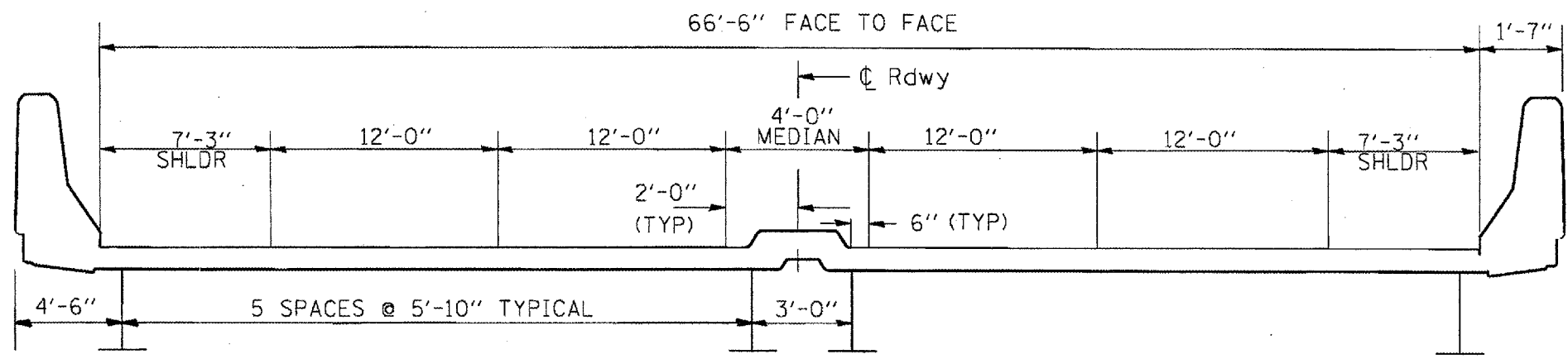

EXISTING CROSS SECTION

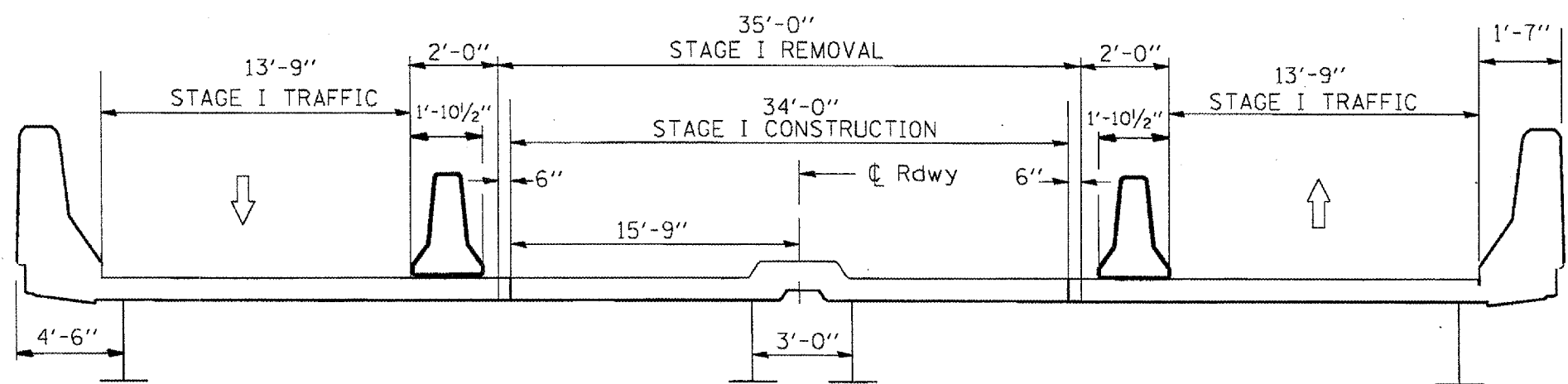

STAGE I CROSS SECTION

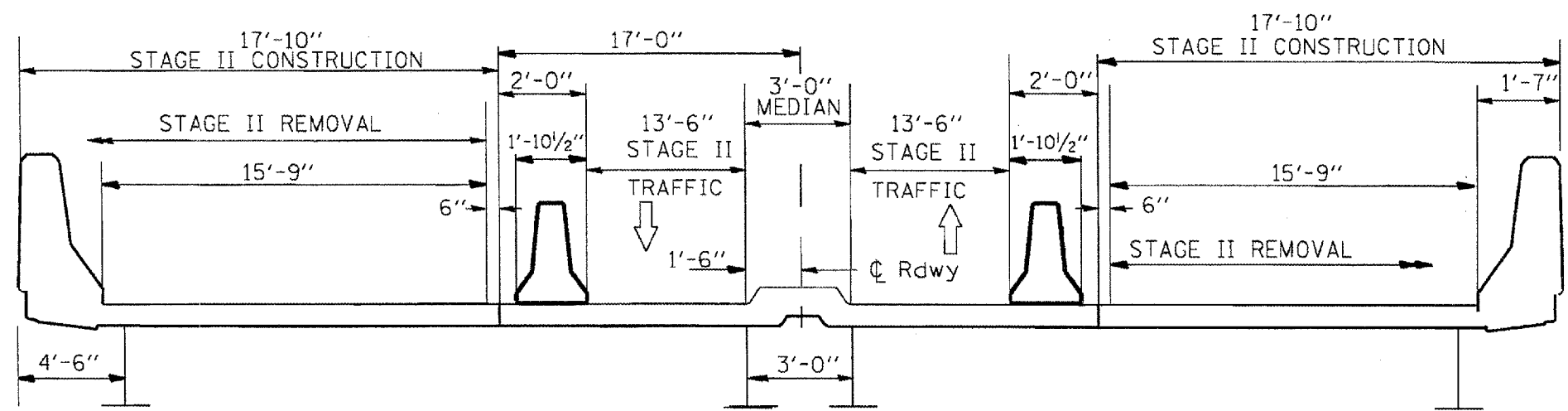

STAGE II CROSS SECTION

PLOT DATE: 12/18/2007
 FILE NAME: I:\projects\2006\007\121807\121807.dwg
 PLOT SCALE: 1/8" = 1'-0"
 USER: JWB

REVISIONS	
NAME	DATE

ILLINOIS DEPARTMENT OF TRANSPORTATION

TRAFFIC STAGING
LOCATION 1
IL 31 OVER BNSF RR
SN 047-0006

SCALE: VERT. _____
HORIZ. _____

DATE _____

DRAWN BY _____
CHECKED BY _____