

CONTRACT NO. 60880

F.A.P. RTE.	SECTION	COUNTY	TOTAL SHEETS	SHEET NO.
330	104B-3-BR	WILL	42	4
FED. ROAD DIST. NO. 1		ILLINOIS	HIGHWAY PROJECT	

SUMMARY OF QUANTITIES			CONSTRUCTION TYPE CODE						
CODE NO	ITEM	UNIT	100% STATE TOTAL QUANTITIES	ROADWAY 1000 - 2A	BRIDGE X028-2A				
67000400	ENGINEER'S FIELD OFFICE, TYPE A	CAL MO	10	10					
67100100	MOBILIZATION	L SUM	1	1					
70100450	TRAFFIC CONTROL AND PROTECTION, STANDARD 701201	L SUM	1	1					
70101800	TRAFFIC CONTROL AND PROTECTION (SPECIAL)	L SUM	1	1					
70106705	TEMPORARY RUMBLE STRIP	FOOT	405	405					
70300220	TEMPORARY PAVEMENT MARKING - LINE 4"	FOOT	2120	2120					
70400100	TEMPORARY CONCRETE BARRIER	FOOT	410	410					
70400200	RELOCATE TEMPORARY CONCRETE BARRIER	FOOT	410	410					
* 78000200	THERMOPLASTIC PAVEMENT MARKING - LINE 4"	FOOT	2200	2200					
* 78100100	RAISED REFLECTIVE PAVEMENT MARKER	EACH	30	30					
* 78201000	TERMINAL MARKER - DIRECT APPLIED	EACH	4	4					
* 78300200	RAISED REFLECTIVE PAVEMENT MARKER REMOVAL	EACH	25	25					
80400100	ELECTRIC SERVICE INSTALLATION	EACH	1	1					
80400200	ELECTRIC UTILITY SERVICE CONNECTION	L SUM	1	1					
* 81800320	AERIAL CABLE, 3-1/C NO. 4 WITH MESSENGER WIRE	FOOT	1600	1600					
* 82103400	LUMINAIRE, SODIUM VAPOR, HORIZONTAL MOUNT, PHOTO-CELL CONTROL, 400 WATT	EACH	6	6					
* 84100110	REMOVAL OF TEMPORARY LIGHTING UNITS	EACH	6	6					
* 84500110	REMOVAL OF LIGHTING CONTROLLER	EACH	1	1					
* 84500120	REMOVAL OF ELECTRIC SERVICE INSTALLATION	EACH	1	1					
X0322256	TEMPORARY INFORMATION SIGNING	SQ FT	51.4	51.4					
* X0323574	MAINTENANCE OF LIGHTING SYSTEM	CAL MO	6	6					
X0325239	TEMPORARY PAVEMENT 10"	SQ YD	305	305					
* X8250090	COMBINATION POLE LIGHTING CONTROLLER	EACH	1	1					
* XX006937	GROUND ROD, 5/8" DIA. X 10 FT.	EACH	3	3					
Z0001050	AGGREGATE SUBGRADE 12"	SQ YD	400	400					
X8900005	TEMPORARY BRIDGE TRAFFIC SIGNAL INSTALLATION	EACH	1	1					

* SPECIALTY ITEMS

SUMMARY OF QUANTITIES				CONSTRUCTION TYPE CODE						
CODE NO	ITEM	UNIT	TOTAL QUANTITIES							

Rev. 1-9-08

REVISIONS	
NAME	DATE

ILLINOIS DEPARTMENT OF TRANSPORTATION
SUMMARY OF QUANTITIES

10/30/2007
c:\bce\sect\801\52028-das\sm_00.dgn

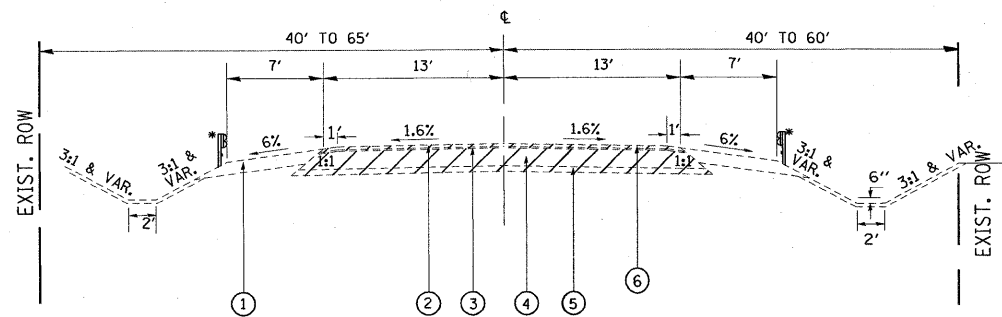

EXISTING TYPICAL SECTION
US 45

STATION
146+50 TO 149+69
149+43 TO 152+00

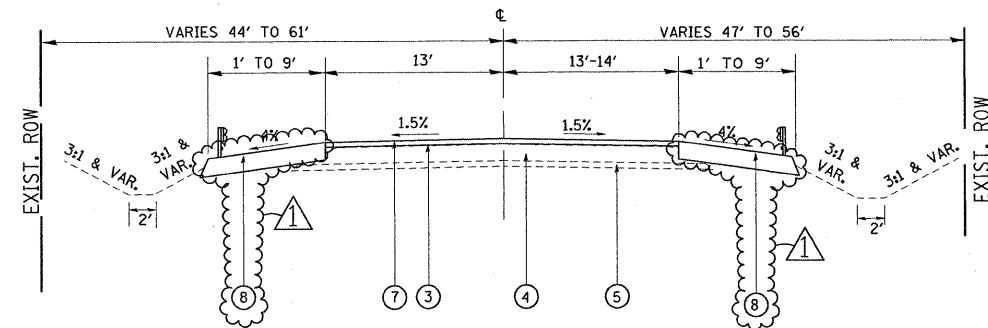

PROPOSED TYPICAL SECTION
US 45

STATION
146+50 TO 148+49
149+63 TO 152+00

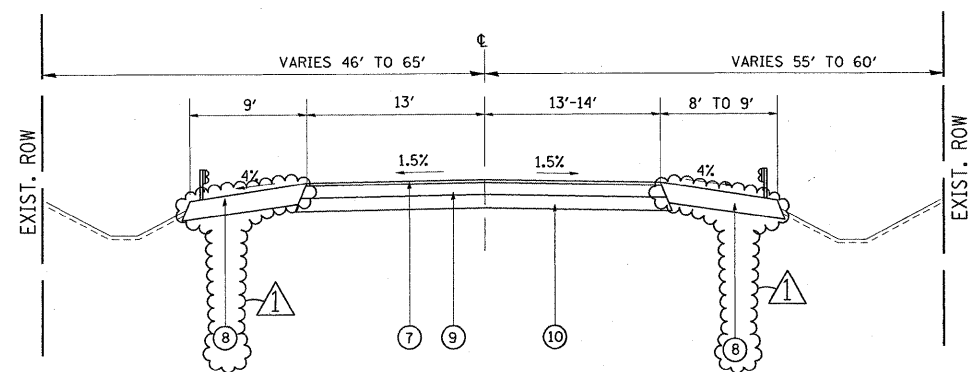

PROPOSED TYPICAL SECTION
US 45

STATION
148+49 TO 148+90
149+22 TO 149+63

LEGEND

- ① EXIST. AGGREGATE SHOULDER, (6")
- ② EXIST. HMA CONCRETE SURFACE COURSE MIXTURE D (CLASS I) (1 1/2")
- ③ EXIST. HMA CONCRETE BINDER COURSE (CLASS I) (1 1/2")
- ④ EXIST. HMA BASE COURSE (9")
- ⑤ EXIST. SUB-BASE GRANULAR MATERIAL TYPE A (4")
- ⑥ PROP. HMA SURFACE REMOVAL, 2" (STA. 146+50-148+49 AND STA. 149+63-152+00)
- ⑥ PROP. PAVEMENT REMOVAL (STA. 148+50-148+90 AND STA. 149+23-149+63)
- ⑦ PROP. HOT-MIX ASPHALT SURFACE COURSE, MIX "D", N70, 2"
- ⑧ PROP. HMA SHOULDER, 10"
- ⑨ PROP. HMA BINDER COURSE, IL - 19, N70, 11"
- ⑩ PROP. AGGREGATE SUBGRADE, 12"

- * STA 147+76 TO STA 148+90(LT)
- * STA 149+23 TO STA 150+38(LT)
- * STA 147+76 TO STA 148+90(RT)
- * STA 149+23 TO STA 150+37(RT)

NOTES:

FOR EXISTING APPROACH PAVEMENT DETAIL, SEE DETAILS OF APPROACH PAVEMENT SHEET
FOR TEMPORARY PAVEMENT LOCATIONS, SEE PRE-STAGE CONSTRUCTION SHEET

PROP. AGGREGATE WEDGE SHOULDER, TYPE B (STA. 146+50 - STA. 147+00 AND STA. 151+50 - STA. 152+00) - SEE ALSO SHEET 8

FOR SUB-BASE GRANULAR MATERIAL, TYPE A, (4") LOCATIONS, SEE HIGHWAY STANDARD 4B2001

FILE NAME = c:\projects\p135202\design_00.dgn	USER NAME = smthk1	DESIGNED -	REVISED - Δ ADDENDUM 1	STATE OF ILLINOIS DEPARTMENT OF TRANSPORTATION	EXISTING AND PROPOSED TYPICAL SECTIONS U.S. RTE. 45 OVER JACKSON CREEK - S.N. 099-4649	F.A.P. RTE. 330	SECTION 104B-3-BR	COUNTY WILL	TOTAL SHEETS 42	SHEET NO. 5	
PLOT SCALE = 50,000' / IN.	CHECKED -	REVISED - 12/31/07 K.S.	SCALE: 1" = 50'			SHEET NO. OF	SHEETS	STA.	TO STA.	FED. ROAD DIST. NO. 1	ILLINOIS FED. AID PROJECT
PLOT DATE = 12/31/2007	DATE -	REVISED -	Rev. 1-9-08								
CONTRACT NO. 60B80											

SCHEDULE OF QUANTITIES (EARTHWORK)						
1	2	3	4	5	6	7
US 45 OVER JACKSON CREEK	EARTH EXCAVATION (CU YD)	UNSUITABLE MATERIAL (CU YD)	EMBANKMENT (CU YD)	ADJUSTMENT FOR SHRINKAGE (CU YD)	FURNISHED EXCAVATION (CU YD)	TOP SOIL FURNISH AND PLACE (SQ YD)
US 45 - STA. 146+50 TO 152+00	122	389	118	104	-14	1,760
COLUMN 1: LOCATION FROM PLANS COLUMN 2: CUT QUANTITIES AFTER UNSUITABLE MATERIAL IS REMOVED COLUMN 3: MATERIAL THAT IS DETERMINED TO BE EITHER UNSTABLE OR UNSUITABLE FOR USE IN EMBANKMENT (TOP SOIL EXCAVATED AT 6" (150 MM) AVERAGE DEPTH) COLUMN 4: FILL QUANTITIES AFTER UNSUITABLE MATERIAL IS REMOVED			COLUMN 5: EARTH EXCAVATION THAT IS TO BE USED AS FILL MATERIAL IN THE EMBANKMENT, SHRINKAGE FACTOR WAS DETERMINED TO BE 15% COLUMN 6: COLUMN 5 - COLUMN 4, POSITIVE QUANTITY= EXTRA EXCAVATION, NEGATIVE QUANTITY= FURNISHED EXCAVATION COLUMN 7: TOPSOIL FURNISH AND PLACE= AREA OF SODDING			

NOTE: THE TOP 6" OF TOPSOIL IS TO BE REMOVED AND PAID FOR AS REMOVAL AND DISPOSAL OF UNSUITABLE MATERIAL.

HOT-MIX ASPHALT MIXTURE REQUIREMENTS

MIXTURE TYPE	AC TYPE	AIR VOIDS (%)
HMA SHOULDER		
HOT-MIX ASPHALT SHOULDER, [△] 10"	PG 64-22*	2% @ 30 GYR
TEMPORARY PAVEMENT		
TEMP. PAVEMENT, (HMA BINDER IL-19mm) 10"	PG 64-22*	4% @ 50 GYR
FULL DEPTH PAVEMENT		
HOT-MIX ASPHALT SURFACE COURSE, MIX "D", N70, 2"	PG 64-22	4% @ 70 GYR
HOT-MIX ASPHALT BINDER COURSE, IL-19.0, N70, 11"	PG 64-22*	4% @ 70 GYR
DRIVEWAY		
HOT-MIX ASPHALT BASE COURSE, (HMA BINDER IL-19mm) 6"	PG 64-22*	4% @ 50 GYR
HOT-MIX ASPHALT SURFACE COURSE, MIX "D", N70, 2"	PG 64-22	4% @ [△] 70 GYR

THE UNIT WEIGHT USED TO CALCULATE ALL HOT-MIX ASPHALT SURFACE MIXTURE QUANTITIES IS 112 LBS/SQ YD/IN

* WHEN RAP EXCEEDS 20%, THE NEW ASPHALT BINDER IN THE MIX SHALL BE PG 58-22

FILE NAME = c:\projects\pl35202\design.aa.dgn	USER NAME = smithk1	DESIGNED -	REVISED -	STATE OF ILLINOIS DEPARTMENT OF TRANSPORTATION	SCHEDULE OF QUANTITIES			F.A.P. RTE. 330	SECTION 104B-3-BR	COUNTY WILL	TOTAL SHEETS 42	SHEET NO. 7
	PLOT SCALE = 50.000' / IN.	CHECKED -	REVISED -		U.S. RTE. 45 OVER JACKSON CREEK - S.N. 099-4649			CONTRACT NO. 60B80				
	PLOT DATE = 12/4/2007	DATE -	REVISED -		SCALE: 1" = 50'			SHEET NO.	OF SHEETS	STA.	TO STA.	FED. ROAD DIST. NO. 1 ILLINOIS FED. AID PROJECT
Rev. 1-9-08												

DATE	
BY	
REVIEWED	
PLANNED	
NOTED	
FILE NAME	

DATE	
BY	
REVIEWED	
PLANNED	
NOTED	
FILE NAME	

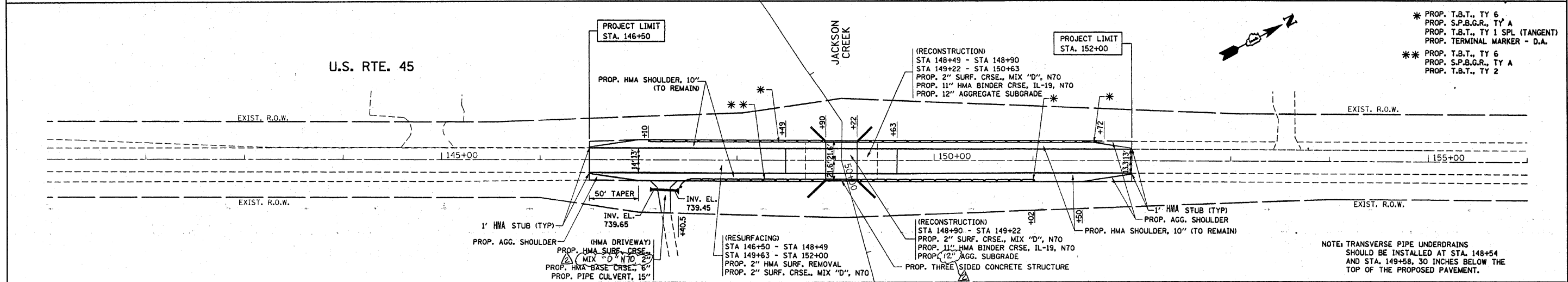
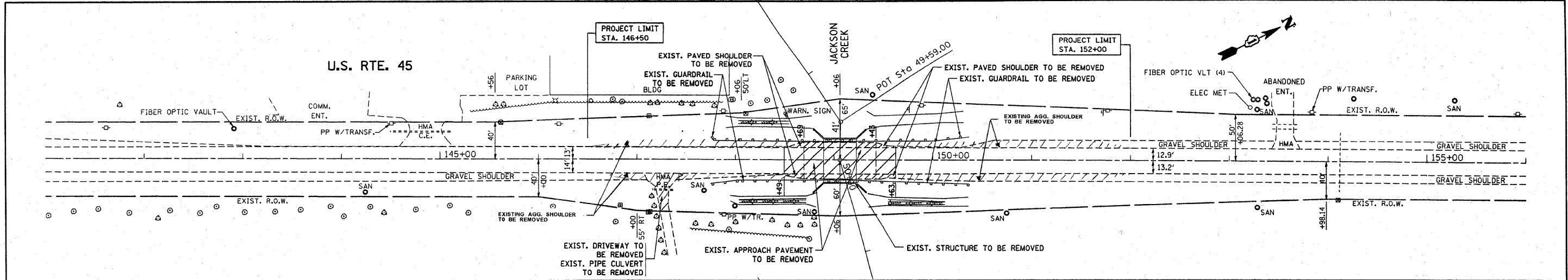

- * PROP. T.B.T., TY 6
- * PROP. S.P.B.G.R., TY A
- * PROP. T.B.T., TY 1 SPL (TANGENT)
- * PROP. TERMINAL MARKER - D.A.
- ** PROP. T.B.T., TY 6
- ** PROP. S.P.B.G.R., TY A
- ** PROP. T.B.T., TY 2

NOTE: TRANSVERSE PIPE UNDERDRAINS SHOULD BE INSTALLED AT STA. 148+54 AND STA. 149+58, 30 INCHES BELOW THE TOP OF THE PROPOSED PAVEMENT.

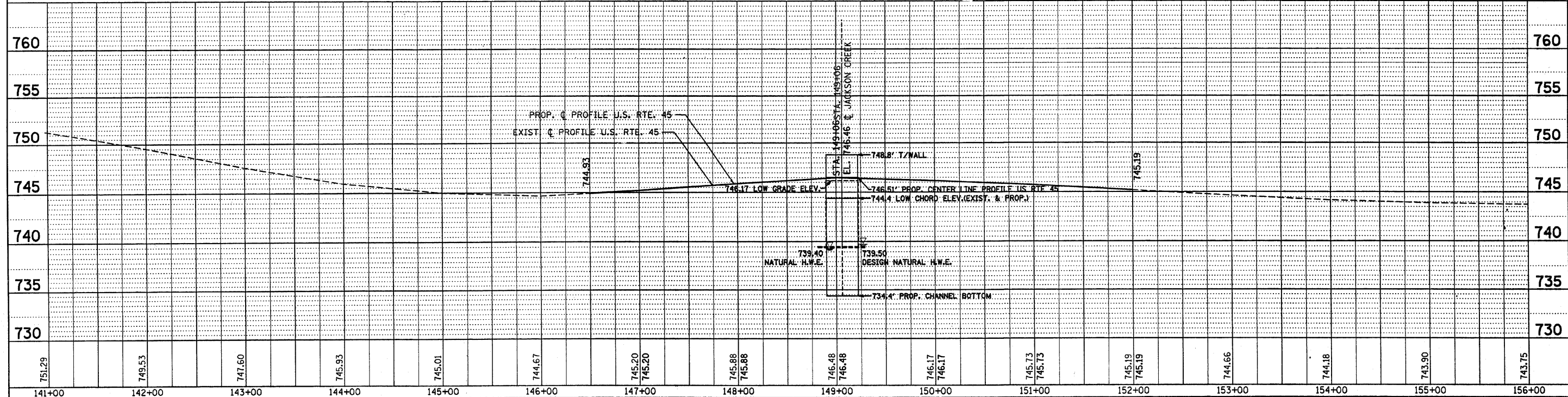

FILE NAME =	USER NAME = bauerdl	DESIGNED -	REVISED -	STATE OF ILLINOIS DEPARTMENT OF TRANSPORTATION		EXISTING & PROPOSED ROADWAY PLAN U.S. RTE. 45 OVER JACKSON CREEK - S.N. 099-4649		F.A.P. RTE.	SECTION	COUNTY	TOTAL SHEETS	SHEET NO.	
ca\proj\state\p135282\sh_rdwj.dgn		DRAWN -	REVISED -					330	104B-3-BR	WILL	42	8	
PLOT SCALE = 50.000' / IN.		CHECKED -	REVISED -					SCALE: 1"=50'		SHEET NO. OF SHEETS STA. TO STA.		FED. ROAD DIST. NO. 1 ILLINOIS FED. AID PROJECT	
PLOT DATE = 10/24/2007		DATE -	REVISED -										

Rev. 1-9-08