

STATE OF ILLINOIS
DEPARTMENT OF TRANSPORTATION

ROUTE NO.	SECTION	COUNTY	TOTAL SHEETS	SHEET	SHEET NO.
FAU 1312	0707-B	Cook	80	44	10
FED. ROAD DIST. NO.		ILLINOIS	FED. AID PROJECT		32 SHEETS

Contract # 60B98

* Order a(E) and a₁(E) bars full length.
Cut to fit skew and use remainder
of bars in opposite end.

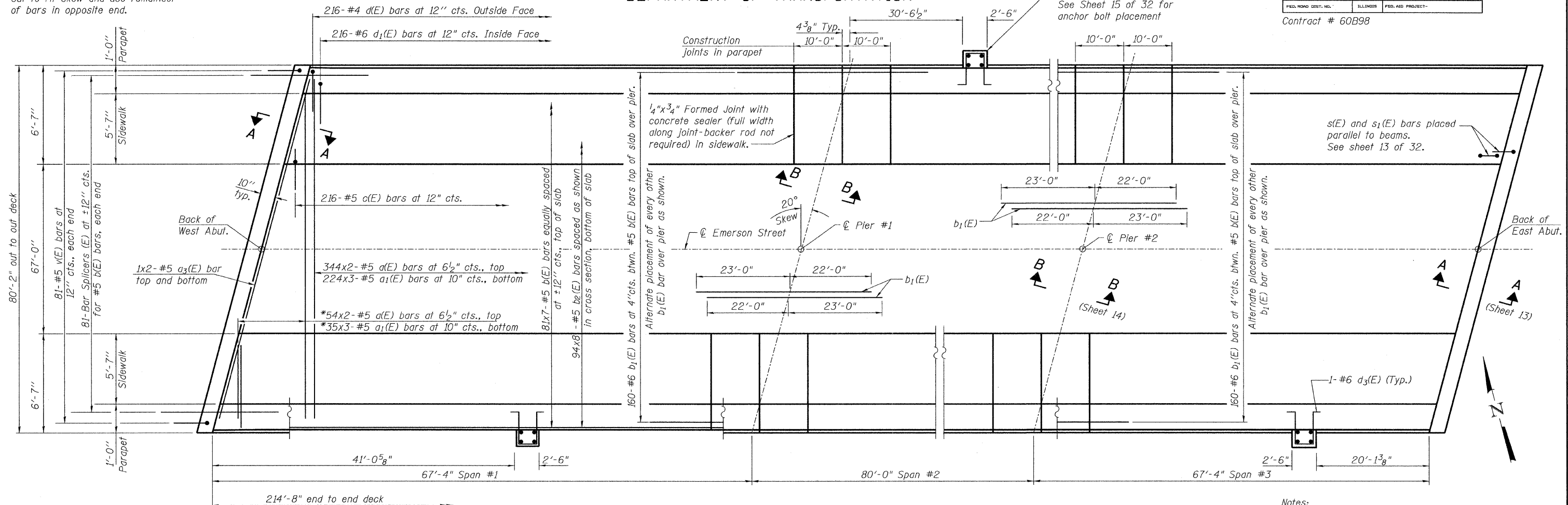

PLAN

Notes:
See Sheet 15 of 32 for superstructure details and Bill of Material.
Bars indicated thus 81 x 7-#5 etc. indicates 81 lines of bars with 7 lengths per line.
See Sheet 12 of 32 for parapet reinforcement.
For Section A-A, see sheet 13 of 32.
For Section B-B, see sheet 14 of 32.
Minimum Lap #5 bar = 1'-8"

Notes:
Concrete deck slab segments shall be poured in numerical order as shown.
Transverse construction joint shall be parallel with the skew.
When the deck pour is stopped for the day at the transverse bonded construction joint in the deck pouring sequence as shown, the next pour shall not be made until both of the following are met:
1) At least 72 hours shall have elapsed from the end of the previous pour.
2) The concrete strength shall have attained a minimum flexural strength of 650 psi or a minimum compressive strength of 3500 psi.

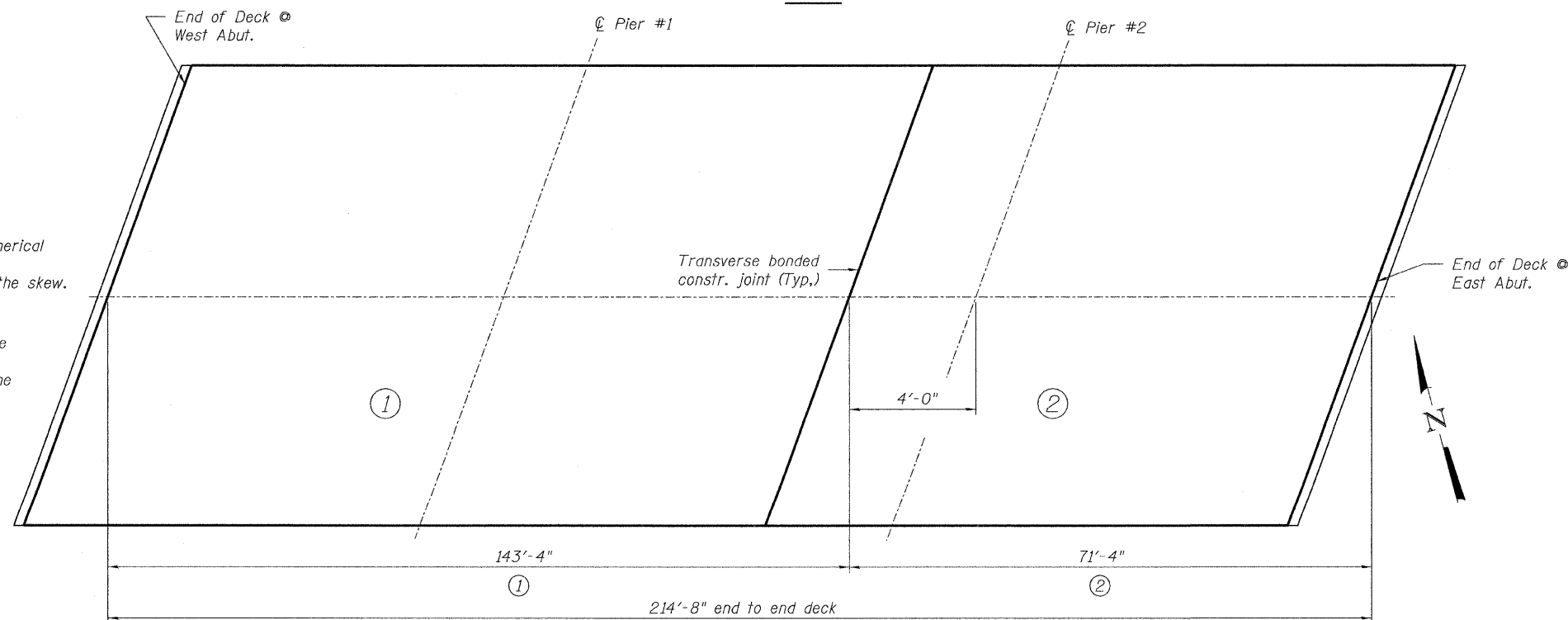

DECK POURING SEQUENCE

DESIGNED	SRT
CHECKED	JJI
DRAWN	JSS
CHECKED	JJI

BL Bollinger, Lach & Associates, Inc.

PII-2-L 11-1-06

SUPERSTRUCTURE PLAN
EMERSON STREET OVER
NORTH SHORE CHANNEL
(PUBLIC BODY OF WATER)
F.A.U. ROUTE 1312 SECTION 0707-B
COOK COUNTY STA. 102+84.62
STRUCTURE NUMBER 016-2858