

F.A.I. RTE.	SECTION	COUNTY	TOTAL SHEETS	SHEET NO.
90/94	2007-056 SG	COOK	30	10
STA. 20+00		TO STA. 35+00		
FED. ROAD DIST. NO.		ILLINOIS FED. AID PROJECT		

STAGE 2 CONSTRUCTION

CONSTRUCT LEFT SIDE OF SIGNING FRAME FOUNDATION, CURB AND GUTTER AND GUARDRAIL.

STAGE 2 TRAFFIC

USE DISTRICT STANDARD TC-17, TRAFFIC CONTROL DETAILS FOR FREEWAY SHOULDER CLOSURES PARTIAL RAMP CLOSURES TO CONSTRUCT LEFT SIDE OF SIGNING FRAME, CURB AND GUTTER AND GUARDRAIL.

THE ENGINEER SHALL PROVIDE ADDITIONAL TRAFFIC CONTROL FOR THE CLOSING OF ALL LANES OF I-90/94 IN ACCORDANCE WITH THE SPECIAL PROVISION TRAFFIC CONTROL AND PROTECTION (EXPRESSWAYS) TO INSTALL OVERHEAD PORTION OF SIGNING FRAME.

THE ENGINEER SHALL PROVIDE ADDITIONAL TRAFFIC CONTROL FOR ASSEMBLING THE OVERHEAD PORTION OF THE SIGNING FRAME PRIOR TO INSTALLATION.

STAGE 2 NOTES

ADDITIONAL TRAFFIC CONTROL PROVIDED BY THE ENGINEER SHALL BE PAID FOR IN ACCORDANCE WITH ARTICLE 109.04 OF THE STANDARD SPECIFICATIONS

DATE	BY	REVISION
		1. INITIAL CHECKED
		2. ADD. F.F. NAME

DATE	BY	REVISION
		1. INITIAL CHECKED
		2. ADD. F.F. NAME

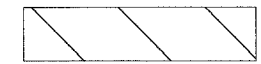
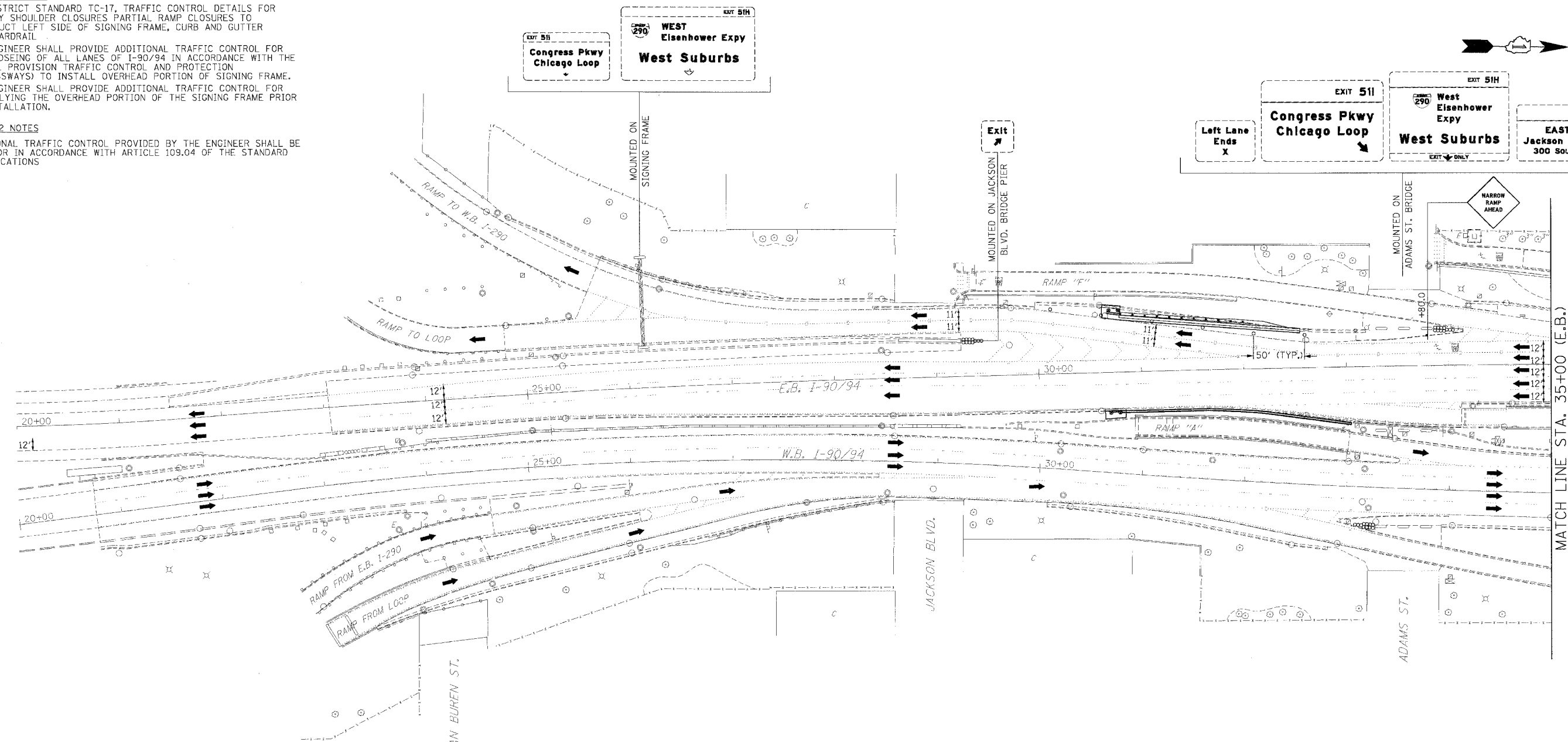

CONSTRUCTION AREA



TYPE II BARRICADE, DRUM OR VERTICAL BARRICADE WITH STEADY BURN MONODIRECTIONAL LIGHT



DIRECTION INDICATOR BARRICADE WITH STEADY BURN MONODIRECTIONAL LIGHT



CONE, DRUM OR BARRICADE

ILLINOIS DEPARTMENT OF TRANSPORTATION

MAINTENANCE OF TRAFFIC

I-90/94 KENNEDY EXPRESSWAY

STAGE 2

STA. 20+00 TO STA. 35+00

SCALE : 1" = 50'

DATE : 10/31/07

DRAWN BY : DLZ

CHECKED BY : GB