

ALL DIMENSIONS IN METERS EXCEPT PAY ITEMS AND UNLESS NOTED OTHERWISE

F.A.I. RTE.	SECTION	COUNTY	TOTAL SHEETS	SHEET NO.
80/94	2003-106LS	COOK	59	35
STA.		TO STA.		
FED. ROAD DIST. NO.		ILLINOIS FED. AID PROJECT		
CONTRACT NO. 62699				

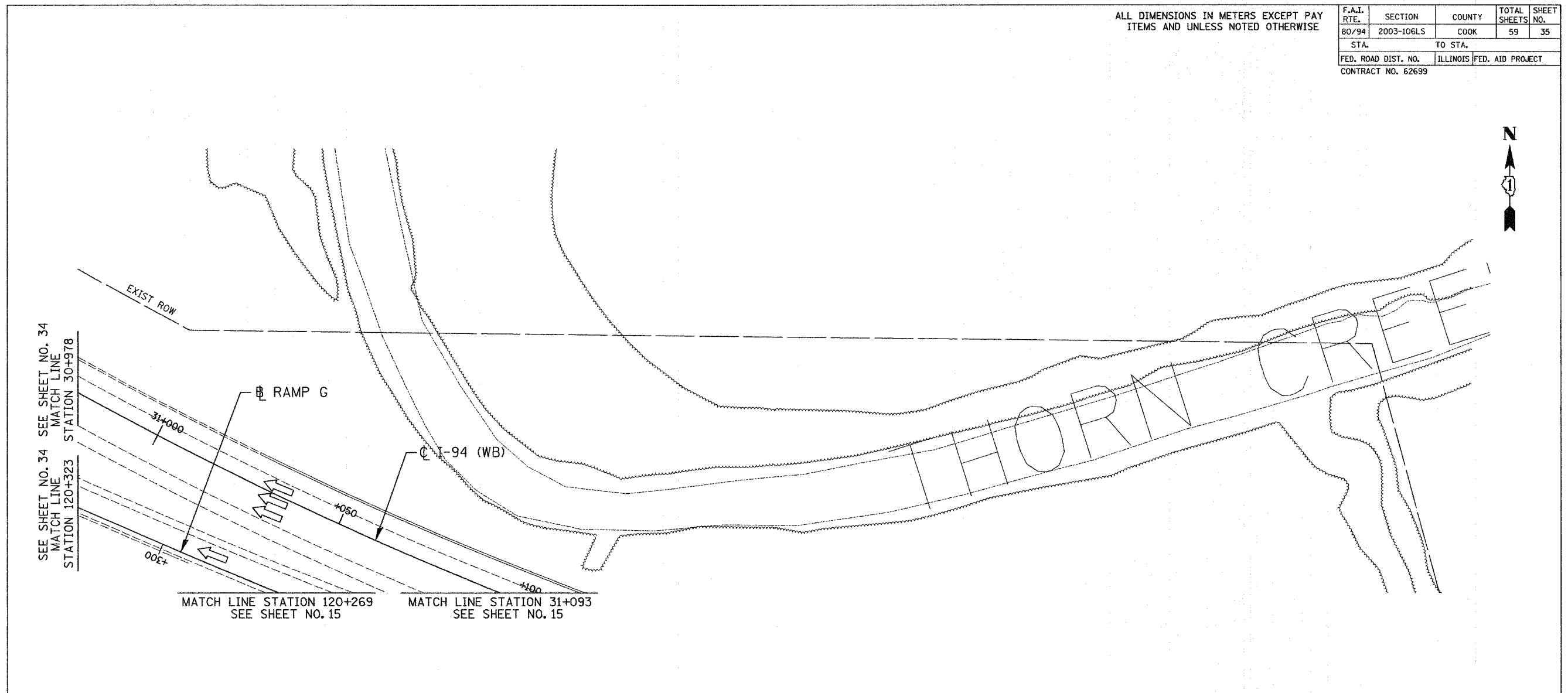

SEE SHEET NO. 34
MATCH LINE
STATION 120+323

MATCH LINE STATION 120+269
SEE SHEET NO. 15

MATCH LINE STATION 31+093
SEE SHEET NO. 15

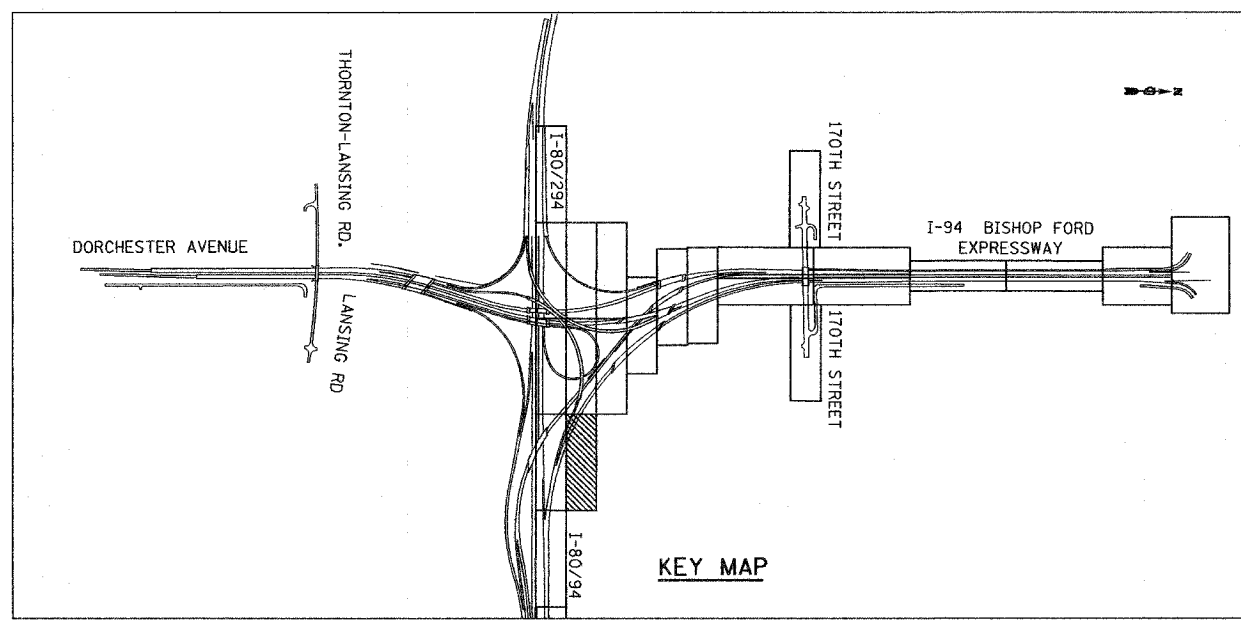

KEY MAP

**NO CONTRACT WORK
ON THIS SHEET**

LSNS - 25

REVISIONS	
NAME	DATE

ILLINOIS DEPARTMENT OF TRANSPORTATION
I-80/94/US 6
KINGERY-BORMAN EXPRESSWAY
BURNHAM ROAD TO US 41
LANDSCAPING PLAN
I-94 BISHOP FORD EXPWAY

SCALE 1:500
DATE 06/07

DRAWN BY ACE/CAD
CHECKED BY TJW

06/26/07 1:28:48 PM g:\Project\20140601\CADD\Contract\WB\LS_25.rds