

ALL DIMENSIONS IN METERS EXCEPT PAVEMENT ITEMS AND UNLESS NOTED OTHERWISE

F.A.I. RTE.	SECTION	COUNTY	TOTAL SHEETS	SHEET NO.
80/94	2003-106LS	COOK	59	47
STA.	TO STA.			
FED. ROAD DIST. NO.	ILLINOIS FED. AID PROJECT			
CONTRACT NO. 62699				

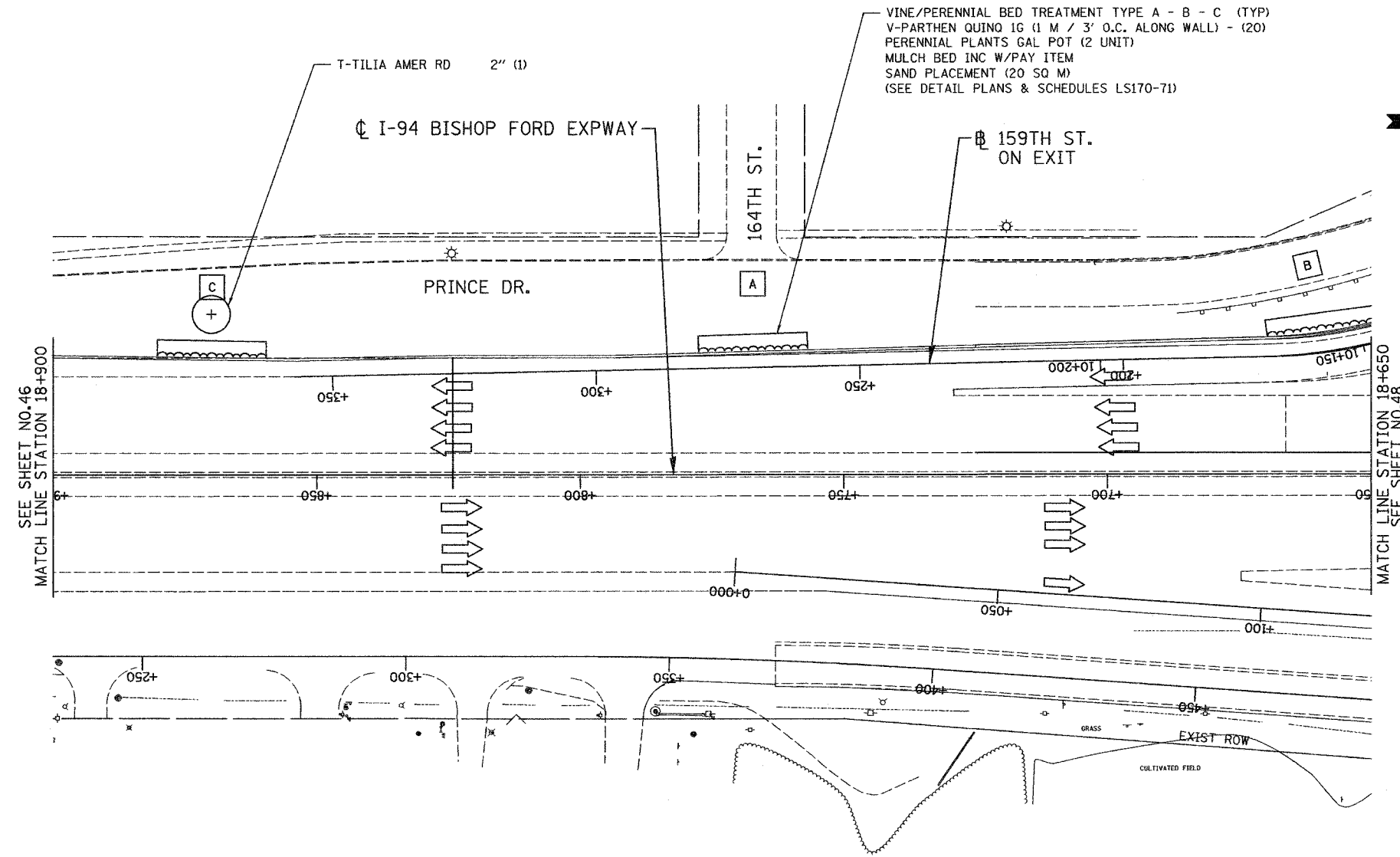

VINE/PERENNIAL BED TREATMENT TYPE A - B - C (TYP)
 V-PARTHEN QUINO 1G (1 M / 3' O.C. ALONG WALL) - (20)
 PERENNIAL PLANTS GAL POT (2 UNIT)
 MULCH BED INC W/PAY ITEM
 SAND PLACEMENT (20 SQ M)
 (SEE DETAIL PLANS & SCHEDULES LS170-71)

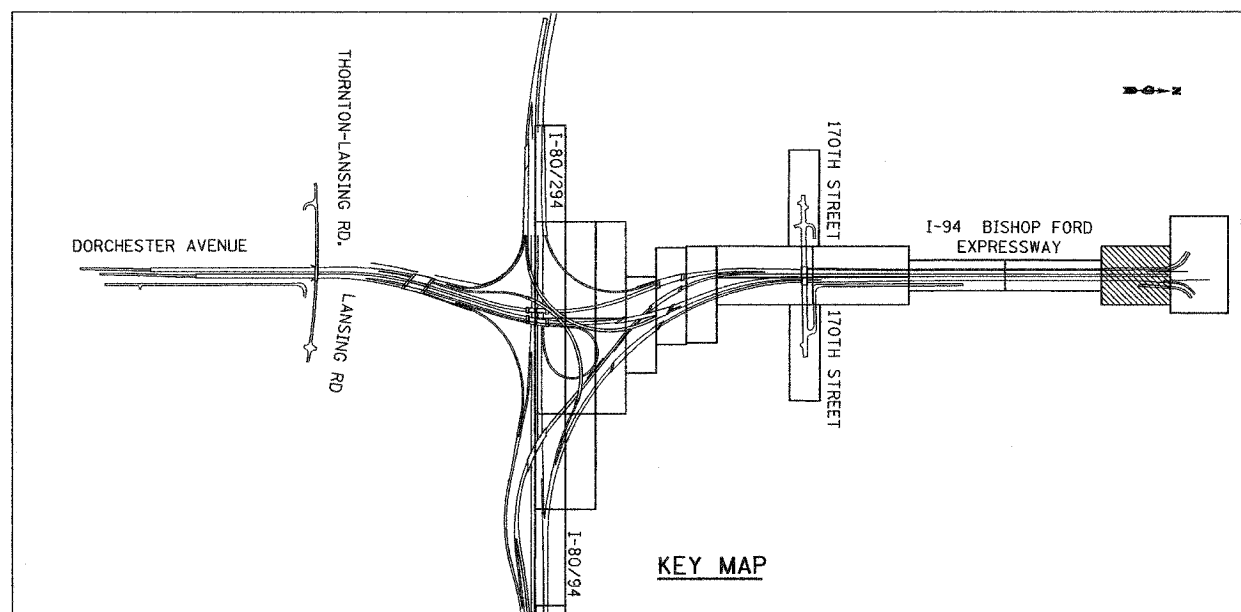

LSNS - 37

ILLINOIS DEPARTMENT OF TRANSPORTATION
 I-80/94/US 6
 KINGERY-BORMAN EXPRESSWAY
 BURNHAM ROAD TO US 41
LANDSCAPING PLAN
I-94 BISHOP FORD EXPWAY

REVISIONS	
NAME	DATE

SCALE 1:500
 DATE 06/07
 DRAWN BY ACE/CAD
 CHECKED BY TJW



06/26/2007 1:37:20 PM
 G:\Project\2014090_CADD\Contract\WB LS 37.rdb