

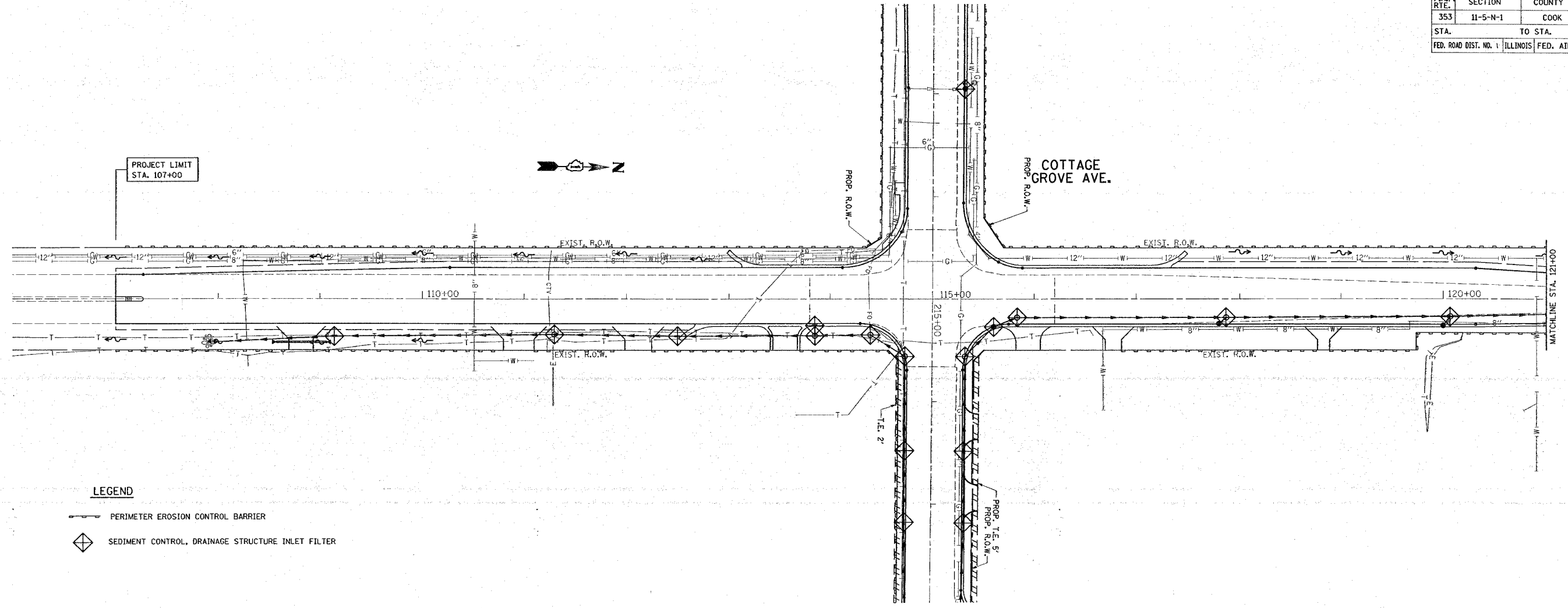

*REF-er001
*REF-er002

CONTRACT NO. 62949

F.A.P. RTE.	SECTION	COUNTY	TOTAL SHEETS	SHEET NO.
353	11-5-N-1	COOK	79	26
STA. TO STA.				
FED. ROAD DIST. NO. 1 ILLINOIS FED. AID PROJECT				



LEGEND

-  PERIMETER EROSION CONTROL BARRIER
-  SEDIMENT CONTROL, DRAINAGE STRUCTURE INLET FILTER

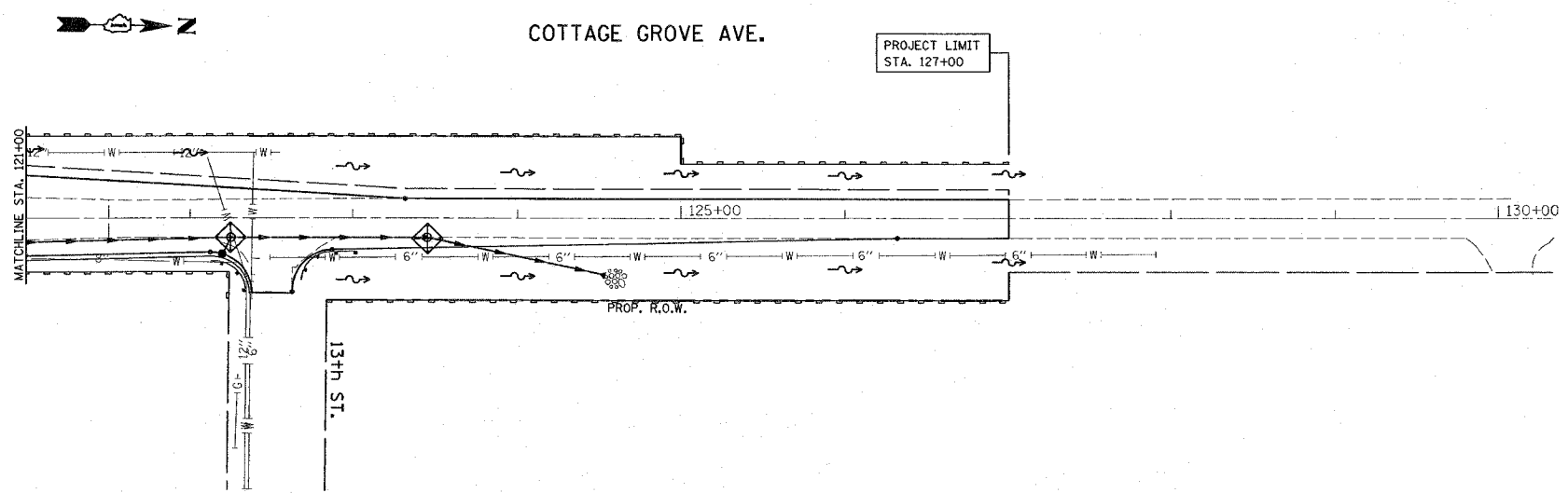

NOTES:

- ① TEMPORARY EROSION CONTROL SEEDING TO BE PROVIDED AT ALL ERODIBLE BARE EARTH AREAS, REFER TO SPECIAL PROVISIONS.
- ② LOCATIONS OF TEMPORARY DITCH CHECKS TO BE DETERMINED BY THE ENGINEER.
- ③ NPDES PERMIT IS REQUIRED FOR THIS PROJECT.
- ④ ALL EROSION CONTROL MEASURES SHALL BE IN ACCORDANCE WITH THE REQUIREMENTS OF THE STANDARD SPECIFICATIONS AND OF THE APPLICABLE STATE STANDARDS FOR THE ENTIRE DURATION OF THE CONTRACT, OR UNTIL SUCH A TIME AS DIRECTED BY THE ENGINEER.
- ⑤ THE PERIMETER EROSION BARRIER SHALL BE INSTALLED AT THE LOCATIONS SHOWN ON THE PLANS OR AS DIRECTED BY THE ENGINEER.

REVISIONS	
NAME	DATE

ILLINOIS DEPARTMENT OF TRANSPORTATION
COTTAGE GROVE AVENUE
@ U.S. RTE. 30 (LINCOLN HIGHWAY)
EROSION CONTROL PLAN

SCALE: 1"= 50'
DATE: 1/3/2008

DRAWN BY
CHECKED BY

PLOT DATE = 1/3/2008
FILE NAME = c:\projects\110823\er001.dwg
PLOT SCALE = 50.0000 / IN.
USER NAME = drakecsgn

Rev. 1-7-08

REV. 2