

U.S.G.S. DATUM  
5th G.A. 1929

# FOR INFORMATION ONLY

ROUTE NO.	SECTION	COUNTY	TOTAL SHEETS	SHEET NO.
E.A. 18	3048Y18R	CARROLL	40	28

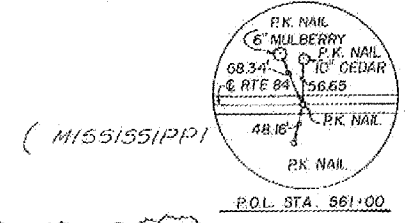

Benchmark: U.S.G.S., Top of Northwest Wingwall of Existing Structure, Elev. 599.72

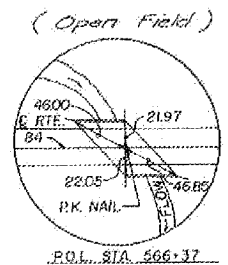
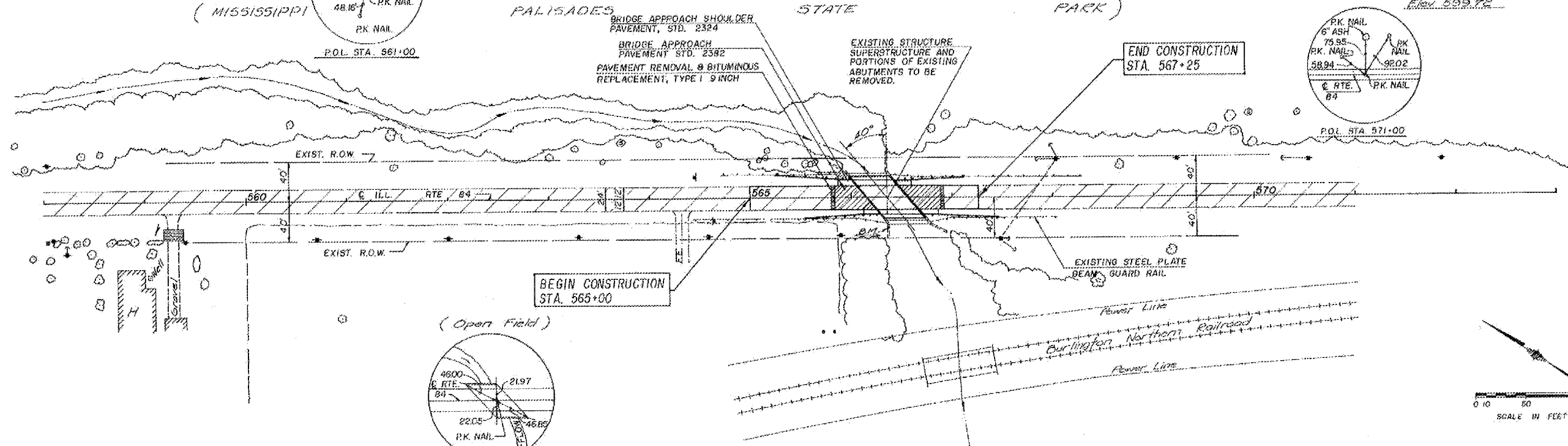
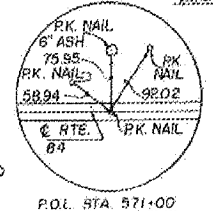

BENCHMARK - STANDARD BRASS DISC IMBEDDED IN CONCRETE WING WALL, N.W. CORNER BRIDGE ON ROUTE 84, 26.50' WEST OF C. ELEVATION 599.72

T.B.M. CHISELED "a" ON CONC HEADWALL 32' RT. STA. 556+60 FIRST PRIVATE ENT. SOUTH OF PALISADES STATE PARK RIVER ACCESS TO HOME OF GEORGE MILLER ELEVATION 598.70

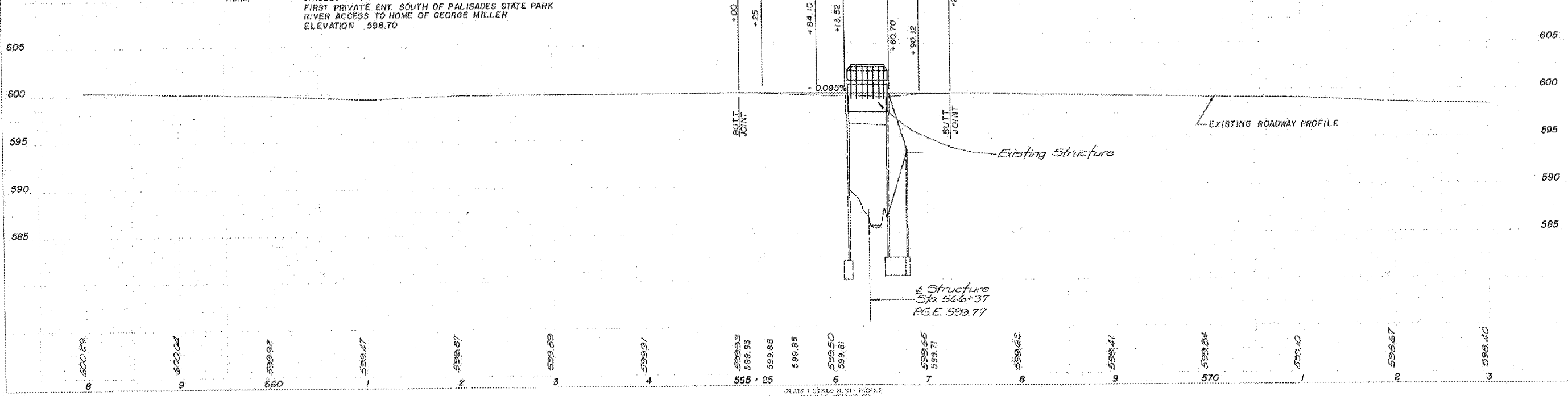

PLAN  
DATE: 1929  
BY: [Signature]

PROFILE  
DATE: 1929  
BY: [Signature]