

F.A.I. RY.	SECTION	COUNTY	TOTAL SHEETS	SHEET NO.
80	(50-5) HBK-2	LASALLE	331	40
STA. TO STA.		ILLINOIS FED. AID PROJECT		

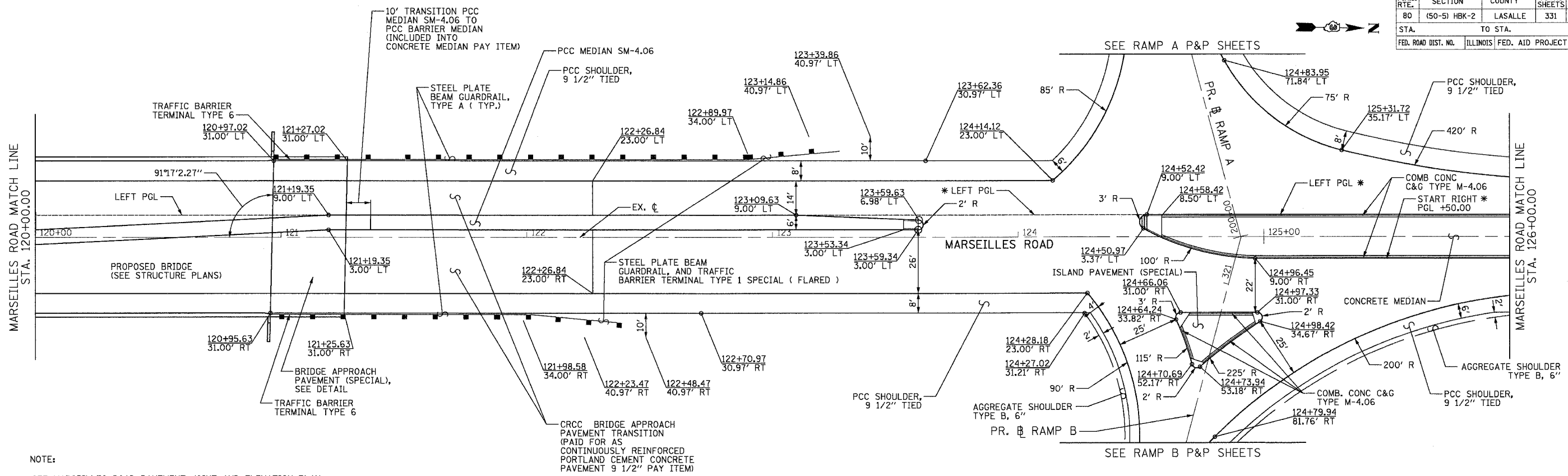

NOTE:  
 \* SEE MARSEILLES ROAD PAVEMENT JOINT AND ELEVATION PLAN RAMP A & B FOR DETAILS

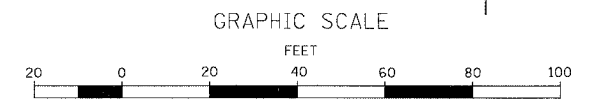
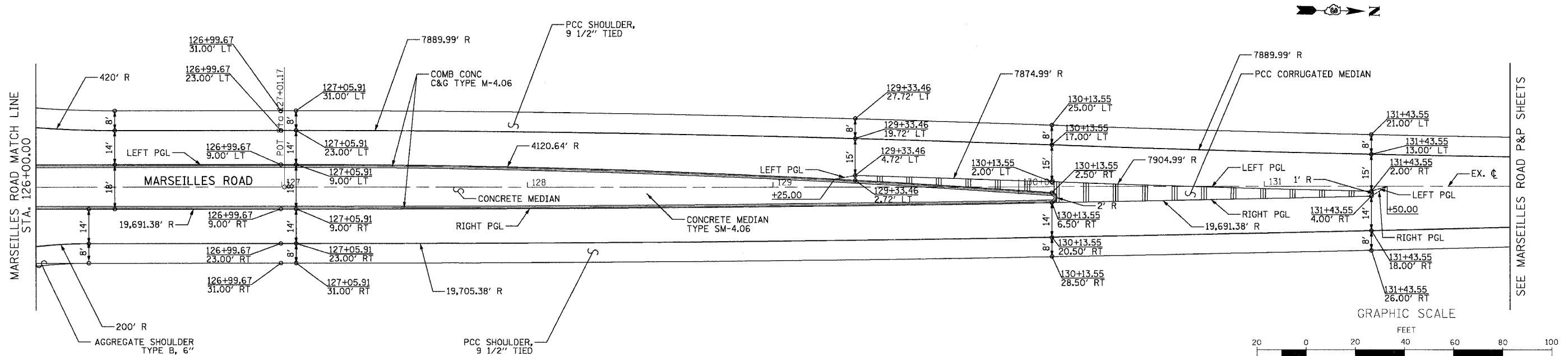

NOTE:  
 FOR TRANSITIONAL APPROACH STATIONS AND OFFSETS SEE TABLES ON SHEET DET-03.



REVISIONS	
NAME	DATE

ILLINOIS DEPARTMENT OF TRANSPORTATION  
**ROADWAY AND INTERSECTION DETAILS**  
 MARSEILLES ROAD STA. 120+00 TO STA. 132+00  
 SCALE: 1"=20'  
 DATE: 11/02/07  
 DRAWN BY: KM  
 CHECKED BY: SE