

F.A.I. RTE.	SECTION	COUNTY	TOTAL SHEETS	SHEET NO.
80	(50-5) HBK-2	LASALLE	331	51
STA. 300+00.00		TO STA. 321+20.18		
FED. ROAD DIST. NO.		ILLINOIS	FED. AID PROJECT	

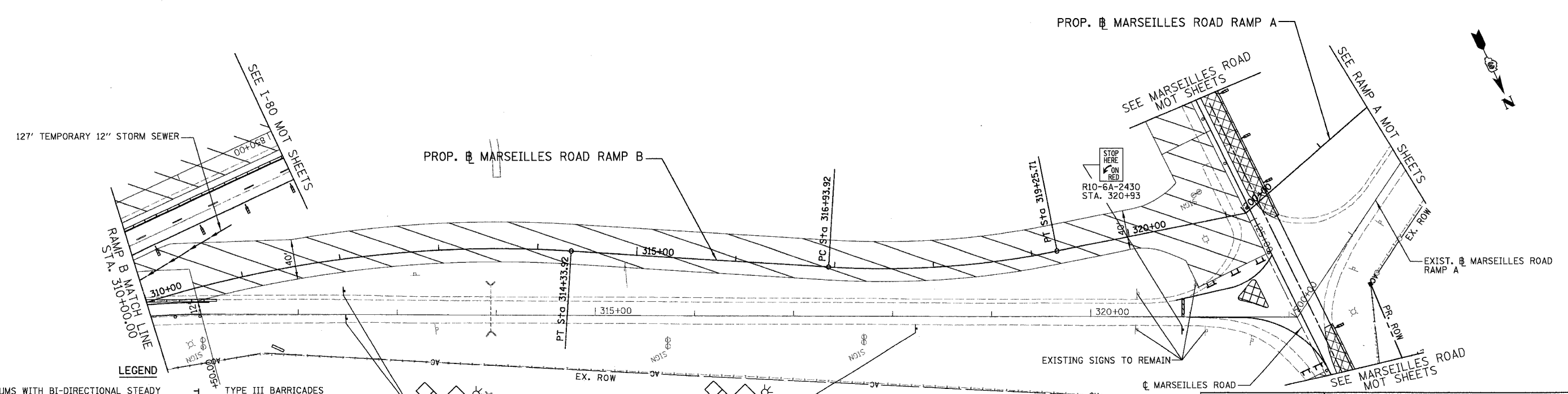

- LEGEND**
- DRUMS WITH BI-DIRECTIONAL STEADY BURN LIGHTS @ 50' CENTERS, 25' CENTERS ALONG TAPERS AND 12' CENTERS ALONG RADIUS RETURNS
 - ➔ TRAFFIC DIRECTION
 - ▬ DOUBLE VERTICAL PANELS (BACK TO BACK) WITH BI-DIRECTIONAL STEADY BURNING LIGHTS
 - ⊥ TYPE III BARRICADES WITH FLASHING LIGHTS
 - ▨ WORK ZONE
 - ▩ TEMPORARY PAVEMENT
 - ▬ ARROW BOARD
 - ▬ TEMP. CONCRETE BARRI

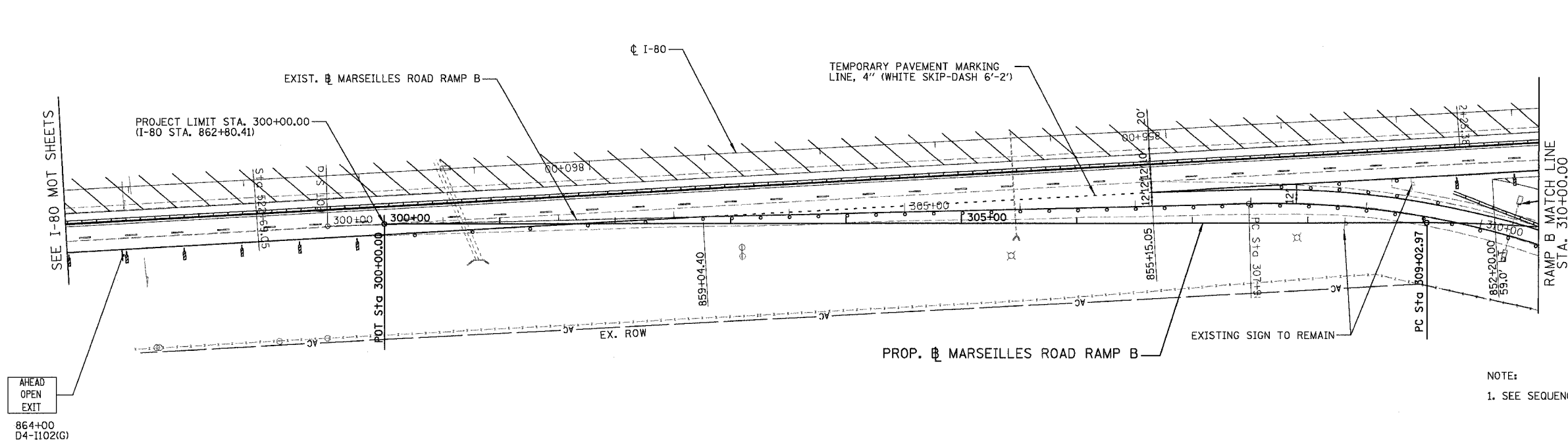
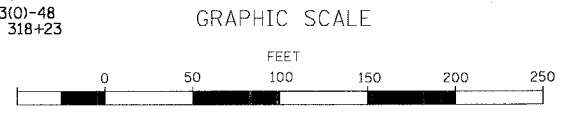

Baker
 Baker Engineering, Inc.

REVISIONS	
NAME	DATE

ILLINOIS DEPARTMENT OF TRANSPORTATION
MAINTENANCE OF TRAFFIC STAGE 1A
 MARSEILLES ROAD RAMP B
 SCALE: 1"=50'
 DATE: 11/02/07
 DRAWN BY: KM
 CHECKED BY: SE