

F.A.I. RTE.	SECTION	COUNTY	TOTAL SHEETS	SHEET NO.
80	(50-5) HBK-2	LASALLE	331	76
STA. 2000+00.00 TO STA. 2014+00.00				
FED. ROAD DIST. NO. ILLINOIS FED. AID PROJECT				

PROP. CURVE TMRAMPA1  
 PI STA. = 2003+60.47  
 $\Delta = 35^\circ 28' 10''$  (RT)  
 $D = 12^\circ 03' 44''$   
 $R = 475.00'$   
 $T = 151.91'$   
 $L = 294.05'$   
 $E = 23.70'$   
 P.C. STA. = 2002+08.56  
 P.T. STA. = 2005+02.61

PC STA 2002+08.56 =  
 PROPOSED RAMP A STA 207+79.06, 22.1' LT

POT STA 2013+98.52 =  
 I-80 STA 822+80.95, 32.0' LT

POT STA 2011+58.22 =  
 I-80 STA 825+20.92, 44.0' LT

PT STA 2005+02.61 =  
 I-80 STA 831+76.53, 44.0' LT

PROPOSED RAMP A STA 205+73.63 =  
 TEMPORARY RAMP A STA 2000+00.00

PLAN	REVISIONS	DATE
NO. 1	BY	
NO. 2	BY	
NO. 3	BY	
NO. 4	BY	
NO. 5	BY	
NO. 6	BY	
NO. 7	BY	
NO. 8	BY	
NO. 9	BY	
NO. 10	BY	

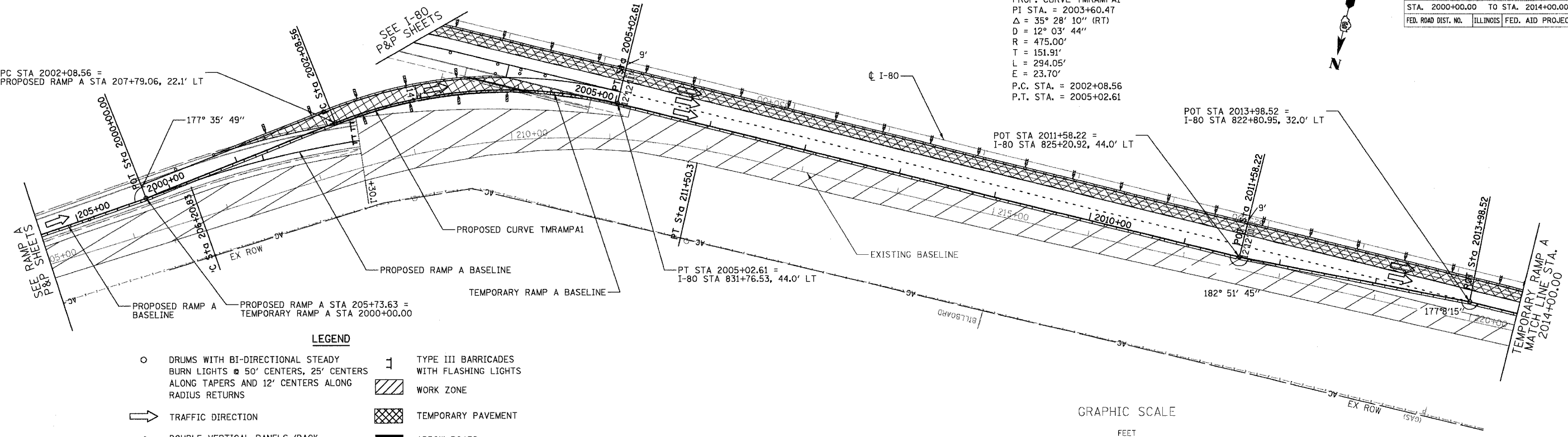

- LEGEND**
- DRUMS WITH BI-DIRECTIONAL STEADY BURN LIGHTS @ 50' CENTERS, 25' CENTERS ALONG TAPERS AND 12' CENTERS ALONG RADIUS RETURNS
  - ➔ TRAFFIC DIRECTION
  - ▬ DOUBLE VERTICAL PANELS (BACK TO BACK) WITH BI-DIRECTIONAL STEADY BURNING LIGHTS
  - ⊥ TYPE III BARRICADES WITH FLASHING LIGHTS
  - ▨ WORK ZONE
  - ▩ TEMPORARY PAVEMENT
  - ▬ ARROW BOARD
  - ▬ TEMP. CONCRETE BARRIER

GRAPHIC SCALE



PROFILE	REVISIONS	DATE
NO. 1	BY	
NO. 2	BY	
NO. 3	BY	
NO. 4	BY	
NO. 5	BY	
NO. 6	BY	
NO. 7	BY	
NO. 8	BY	
NO. 9	BY	
NO. 10	BY	

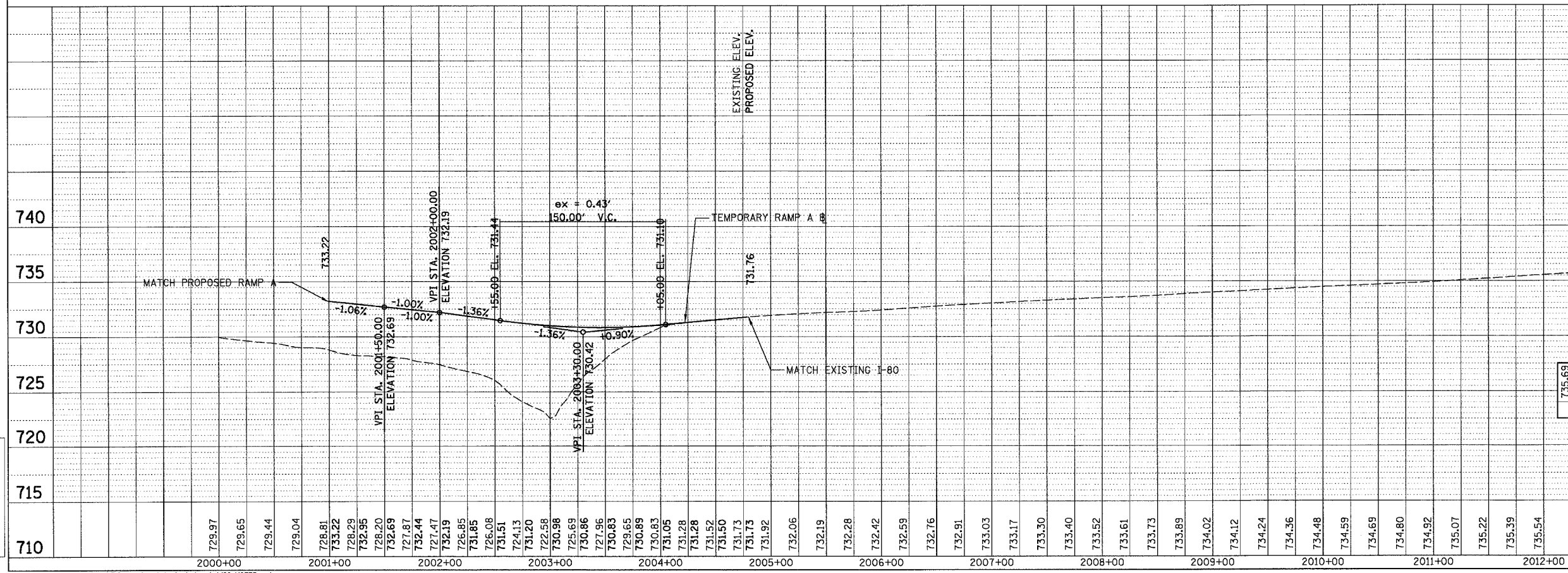

735.69	735.84	735.99	736.09	736.22	736.37	736.49	736.58
2013+00				2014+00			

ILLINOIS DEPARTMENT OF TRANSPORTATION  
**PLAN & PROFILE**  
**RAMP A AND**  
**TEMPORARY RAMP A TO I-80**

SCALE: HORIZ 1"=50'  
 VERT 1"=5'  
 DATE: 11/02/07  
 DRAWN BY: KM  
 CHECKED BY: SE



h:\07496\3.0 deliverables\3.2 roadway\design\sheet\I80\_MOT35.mot  
 1/9/2007